

VIZIO | Quick Start Guide



Inside the box

- Smart TV
- Power Cable
- Remote with Batteries
- 2 or 4" x Screws for Stands
- TV Stands

IMPORTANT!

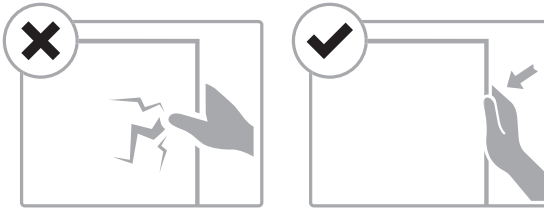

DO NOT TOUCH THE SCREEN



For more information, including the product's full User Manual, visit VIZIO.com

1

Flat surface should be as large/larger than TV to avoid panel damage.

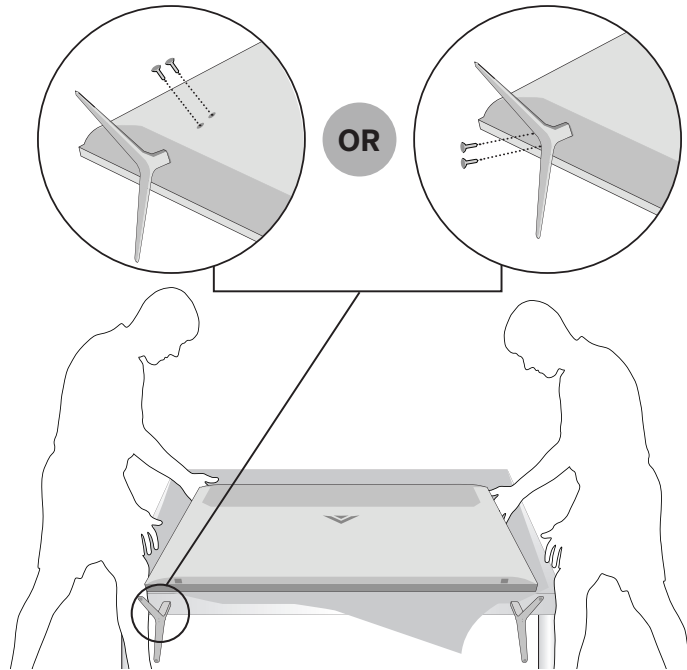

**Number of screws and stand type may vary depending on model.*

2

Plug the TV power cord into a wall outlet and connect any devices.

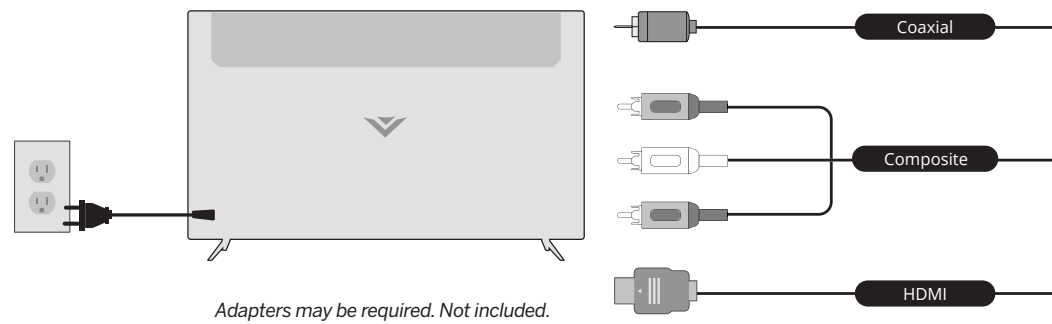

3

Aim directly at the IR sensor on your TV. The power indicator will flash on when the TV turns on. Follow the on-screen instructions to complete setup.

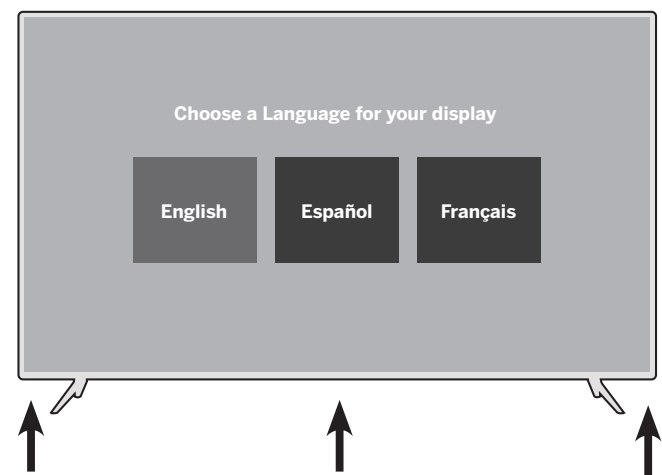
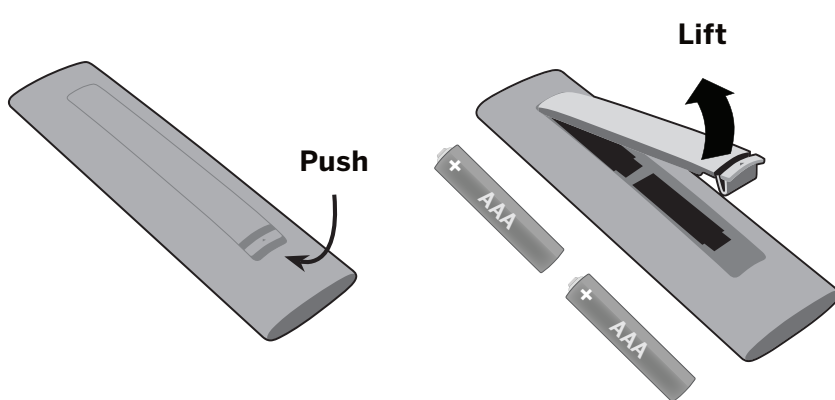
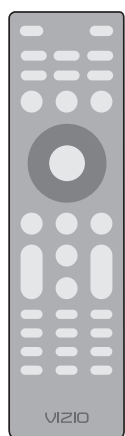

IR sensor location will depend on TV model.

4

Press the INPUT button on the remote to highlight the input you wish to view.

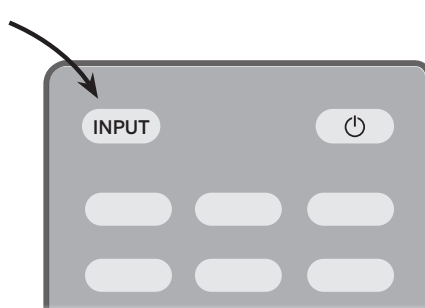
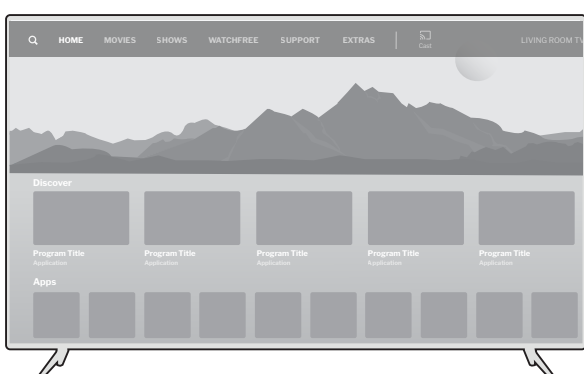

For more help, including how to repack your TV, visit: support.vizio.com