

F90 Multifunctional Frame

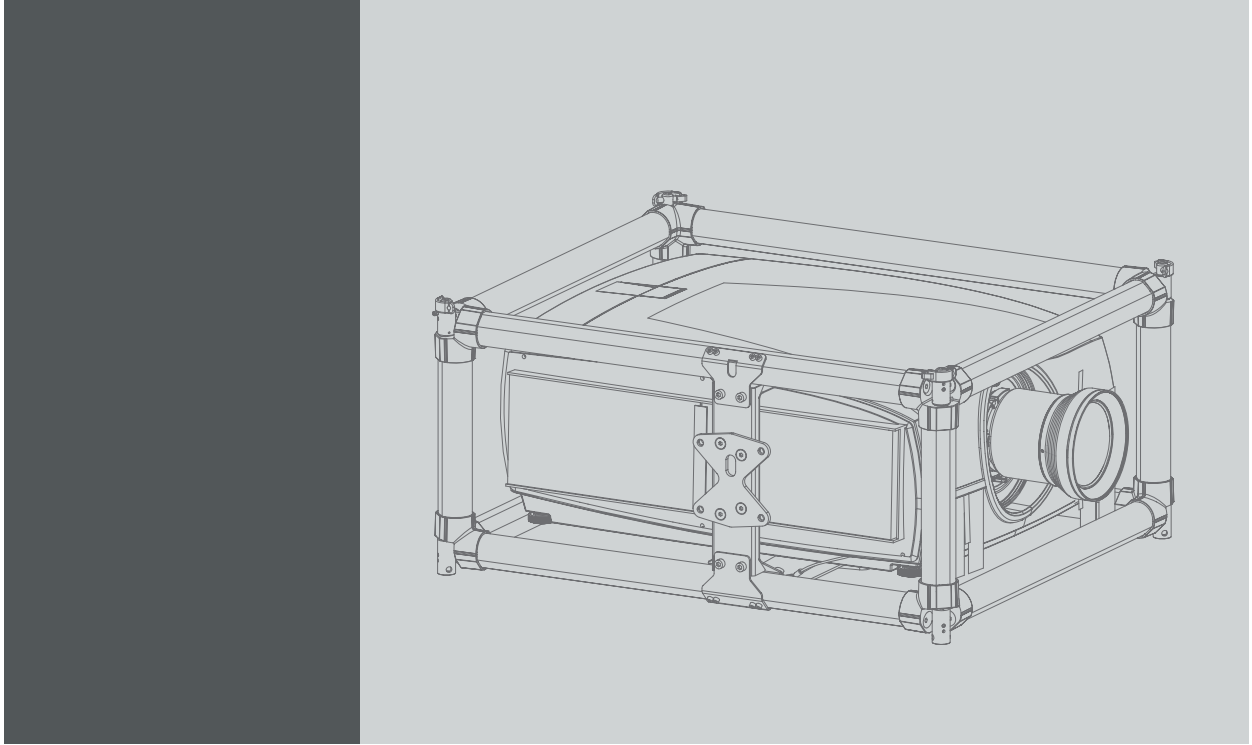

Installation Manual

R5906768/02
13/01/2017

BARCO

visibly yours

Barco NV
President Kennedypark 35, 8500 Kortrijk, Belgium
Phone: +32 56.36.82.11
Fax: +32 56.36.883.86
Support: www.barco.com/en/support
Visit us at the web: www.barco.com

Printed in Belgium

Changes

Barco provides this manual 'as is' without warranty of any kind, either expressed or implied, including but not limited to the implied warranties or merchantability and fitness for a particular purpose. Barco may make improvements and/or changes to the product(s) and/or the program(s) described in this publication at any time without notice.

This publication could contain technical inaccuracies or typographical errors. Changes are periodically made to the information in this publication; these changes are incorporated in new editions of this publication.

The latest edition of Barco manuals can be downloaded from the Barco web site www.barco.com or from the secured Barco web site <https://www.barco.com/en/signin>.

Copyright ©

All rights reserved. No part of this document may be copied, reproduced or translated. It shall not otherwise be recorded, transmitted or stored in a retrieval system without the prior written consent of Barco.

Disposal Information

Waste Electrical and Electronic Equipment



■ This symbol on the product indicates that, under the European Directive 2012/19/EU governing waste from electrical and electronic equipment, this product must not be disposed of with other municipal waste. Please dispose of your waste equipment by handing it over to a designated collection point for the recycling of waste electrical and electronic equipment. To prevent possible harm to the environment or human health from uncontrolled waste disposal, please separate these items from other types of waste and recycle them responsibly to promote the sustainable reuse of material resources.

For more information about recycling of this product, please contact your local city office or your municipal waste disposal service.

For details, please visit the Barco website at: <http://www.barco.com/en/AboutBarco/weee>

Guarantee and Compensation

Barco provides a guarantee relating to perfect manufacturing as part of the legally stipulated terms of guarantee. On receipt, the purchaser must immediately inspect all delivered goods for damage incurred during transport, as well as for material and manufacturing faults Barco must be informed immediately in writing of any complaints.

The period of guarantee begins on the date of transfer of risks, in the case of special systems and software on the date of commissioning, at latest 30 days after the transfer of risks. In the event of justified notice of complaint, Barco can repair the fault or provide a replacement at its own discretion within an appropriate period. If this measure proves to be impossible or unsuccessful, the purchaser can demand a reduction in the purchase price or cancellation of the contract. All other claims, in particular those relating to compensation for direct or indirect damage, and also damage attributed to the operation of software as well as to other services provided by Barco, being a component of the system or independent service, will be deemed invalid provided the damage is not proven to be attributed to the absence of properties guaranteed in writing or due to the intent or gross negligence or part of Barco.

If the purchaser or a third party carries out modifications or repairs on goods delivered by Barco, or if the goods are handled incorrectly, in particular if the systems are operated incorrectly or if, after the transfer of risks, the goods are subject to influences not agreed upon in the contract, all guarantee claims of the purchaser will be rendered invalid. Not included in the guarantee coverage are system failures which are attributed to programs or special electronic circuitry provided by the purchaser, e.g. interfaces. Normal wear as well as normal maintenance are not subject to the guarantee provided by Barco either.

The environmental conditions as well as the servicing and maintenance regulations specified in this manual must be complied with by the customer.

Trademarks

Brand and product names mentioned in this manual may be trademarks, registered trademarks or copyrights of their respective holders. All brand and product names mentioned in this manual serve as comments or examples and are not to be understood as advertising for the products or their manufacturers.

1. F90–SERIES MULTIFUNCTIONAL FRAME

Purpose of the F90-series multifunctional frame

The F90-series multifunctional frame is exclusively designed for the Barco F90 projectors and can thus not be used on any other equipment.

Overview

- Safety
- Introduction
- Before assembling the frame
- Assembling the frame
- Installing the projector onto the multifunctional frame
- Stacking multiple projectors using the multifunctional frame
- Suspending the projector from a truss
- Skewing the projector
- Tilting the projector
- Rotating the projector
- Dimensions

1.1 Safety

About this chapter

Read this chapter attentively. It contains important information to prevent damage to the rigging frame. Ensure that you understand and follow all safety instructions mentioned in this chapter before installing the rigging frame. After this chapter, additional “warnings” and “cautions” are given depending on the installation procedure. Read and follow these “warnings” and “cautions” as well.

Installation personnel

This assembly of the frame and installation of the projector must be performed by authorized and qualified technical personnel only.

Single assembly only

You can only assemble the rigging frame one single time. While you can remove and install other F90 projectors into the frame and it is allowed to replace safety cables, it is not allowed to disassemble the rigging frame itself.

Expiry date provided adhesive

Make sure to check the expiry date of the adhesive, provided with the rigging frame. Make sure the adhesive (high strength threadlocker) is not expired.

If expired, make sure to get new adhesive of similar or higher strength than the one provided in the kit.

Securing all screws and stacking pins

Make sure that the thread of the screws and the stacking pins are provided with the necessary amount of adhesive.

1. F90-Series multifunctional frame



CAUTION: Make sure that all the screws are sufficiently tightened. Respect the torque required to tighten all screws.

Forgetting or neglecting to do this may result in an unsafe rigging frame.

Safety Cables

Two safety cables have been delivered with the rigging frame. The first side of the safety cables are pre-mounted on the bottom frame (reference 1, image 1-1).

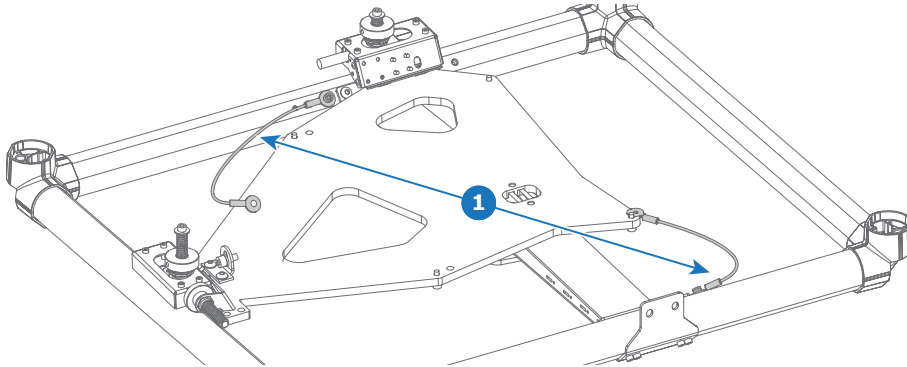

Image 1-1

The other ends of these cables must be installed between the projector fixing screw and the projector support structure (reference 3, image 1-2).

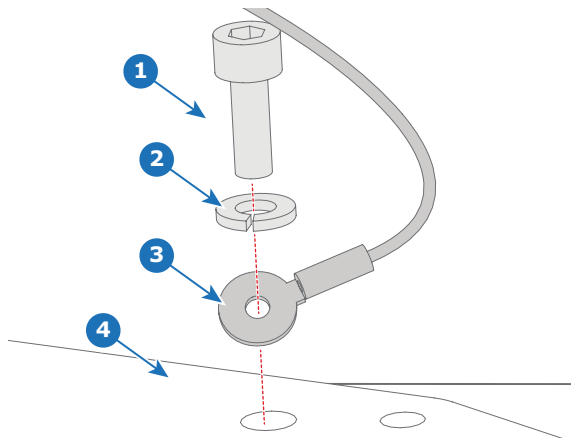

Image 1-2

- 1 M6 Hex screw
- 2 M6 Spring washer
- 3 Safety Cable
- 4 Projector support structure



CAUTION: When the safety cables have undergone a heavy shock, invisible damage may have occurred to the safety cables. In this case the safety cables must be replaced.

Transportation of the frame

Never transport the multifunctional frame in portrait position with a projector mounted. Failure to do so can cause damage the multifunctional frame. Refer to image 1-3 for a bad and good example of transportation.

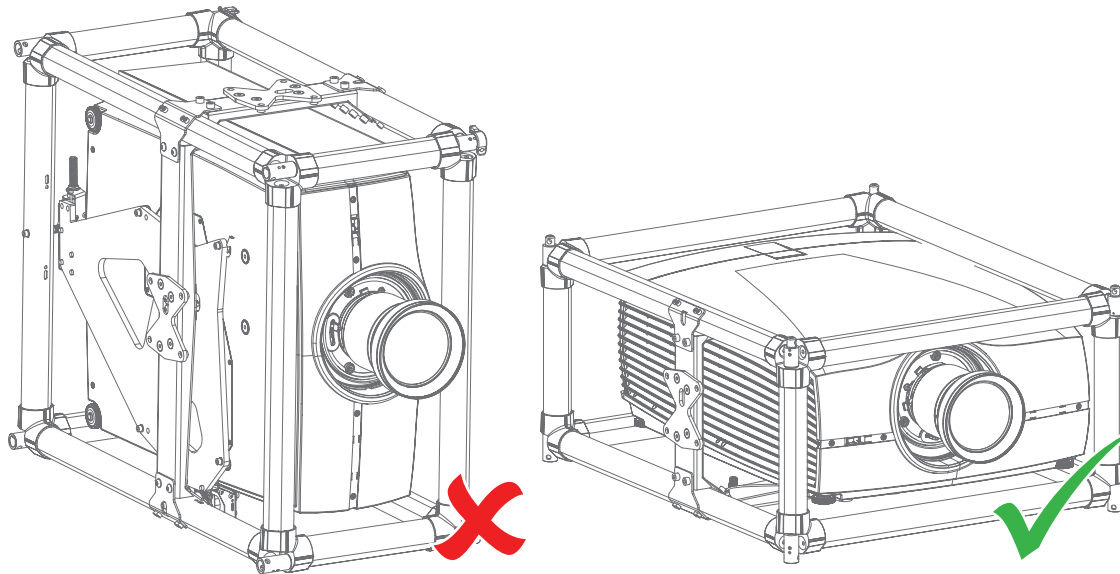

Image 1-3

Maximum stacking and hanging

F90 projectors can be stacked on top of each other on a flat surface, or suspended from a truss using the multifunctional frame.

Keep the following in mind:

- It is allowed to stack **maximum three** projectors.
- It is allowed to suspend **maximum two** projectors.

1.2 Introduction

Functionality

An F90 projector mounted in the multifunctional frame makes the projector more rugged and handy.

The multifunctional frame makes it possible to stack multiple projectors. This can be useful for a dual projection 3D system. In the multifunctional frame, the projector can be rotated around x, y and z axis in order to obtain a seamless adjustment.

Furthermore, the multifunctional frame can be used to suspend the projector from a truss. This can be done either in a upright or upside down position.

Content of the kit

Content	Pieces
Bottom frame	1
Top frame	1
Vertical profile	4
Rigging screw	8
Side bracket	1
Hex screw with socket head M8x20	11
Top stacking pin	4
Safety cable	2
Bottom stacking pin	4
Locking pins	4

1. F90-Series multifunctional frame

Content	Pieces
Set screw M6	8
Orientation rod + nut M3	3
Hex screw with socket head M6 x 25	4
Spring washer M6	4
Hex screw with button head M8 x 20	1
Spring washer M8	1
High strength threadlocker	1

Necessary tools

- Torque Wrench with **large** 17 mm hex socket
- Allen wrench 6 mm
- Allen wrench 5 mm
- Allen wrench 3 mm



The large 17 mm hex socket is not a common type of socket. Make sure you have this at your disposal before assembling the frame.

Parts identification

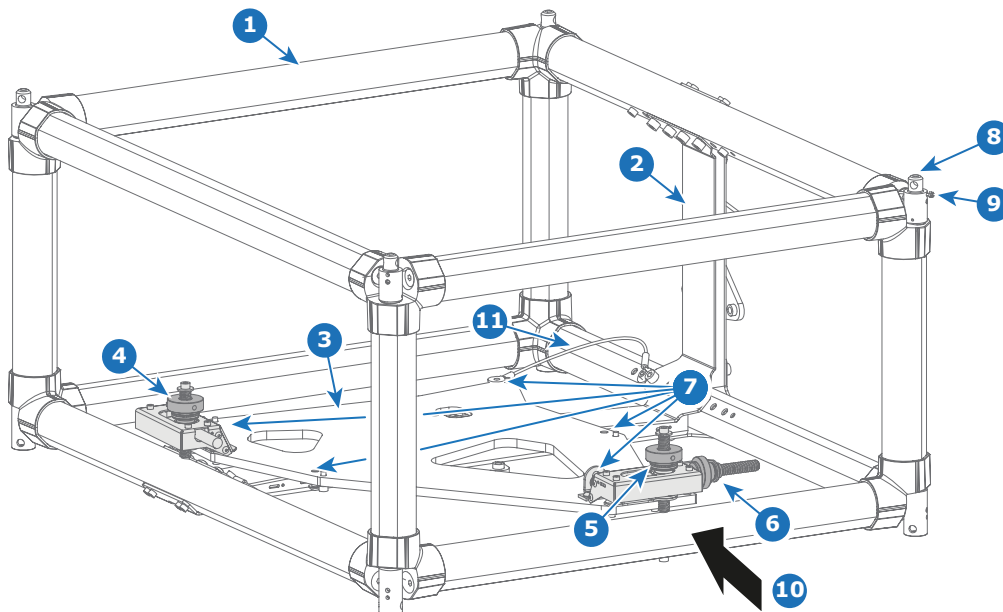

Image 1-4

- 1 Multifunctional frame
- 2 Side bracket
- 3 Projector supporting structure
- 4 Rotate adjustment knob
- 5 Tilt adjustment knob
- 6 Skew adjustment knob
- 7 Projector mounting screws
- 8 Stacking pin
- 9 Orientation rod + nut
- 10 Multifunctional frame rear side
- 11 Safety cable

1.3 Before assembling the frame

Packaging

Be careful not to remove all of the cardboard when removing the rigging frame parts from the packaging. You will need the following parts when trying to place the F90 projector into the rigging frame.

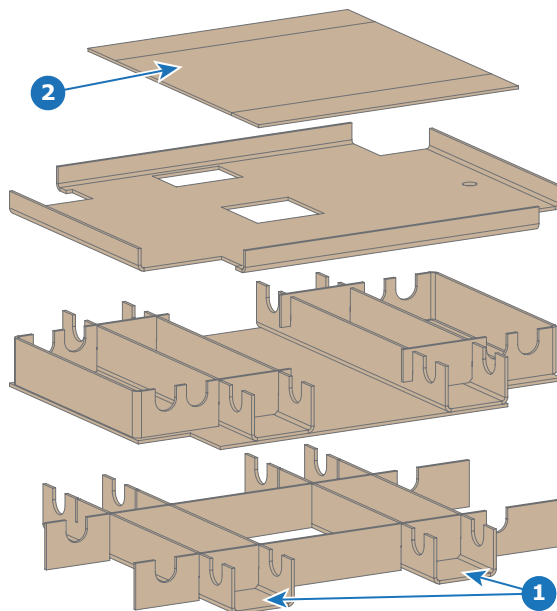

Image 1-5

- 1 Two bottom cardboard pieces
- 2 Bendable top cardboard piece

1.4 Assembling the frame

Necessary tools

- Torque wrench with large 17 mm hex socket
- Allen wrench 3 mm
- Allen wrench 6 mm
- High strength threadlocker (e.g. Loctite 262)

Necessary parts

- Bottom Frame
- Top Frame
- Vertical profile (x4)
- Rigging screw (x8)
- Support frame
- Hex screw with socket head M8x20 (x11)
- Top stacking pin (x4)
- Bottom stacking pin (x4)
- Set screw M6 (x8)
- Orientation rod + nut M3

How to assemble the rigging frame?

1. Lay out the bottom frame as illustrated.

1. F90-Series multifunctional frame

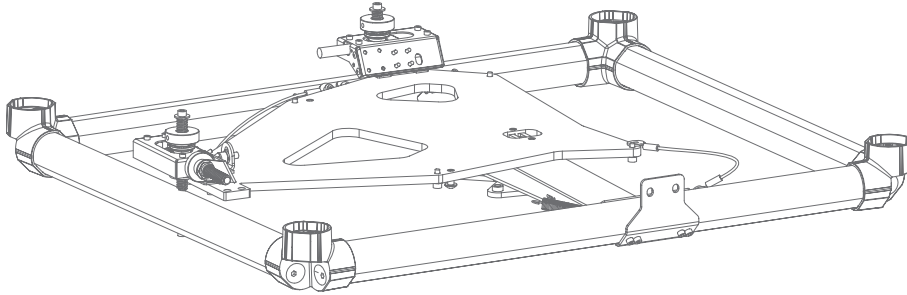

Image 1-6

2. Assemble the vertical frames onto the bottom frame as illustrated. Use the rigging screws to tighten them together.

Caution: Use high strength threadlocker on the rigging screws thread. Tighten the rigging screws with a torque of 40 Nm.

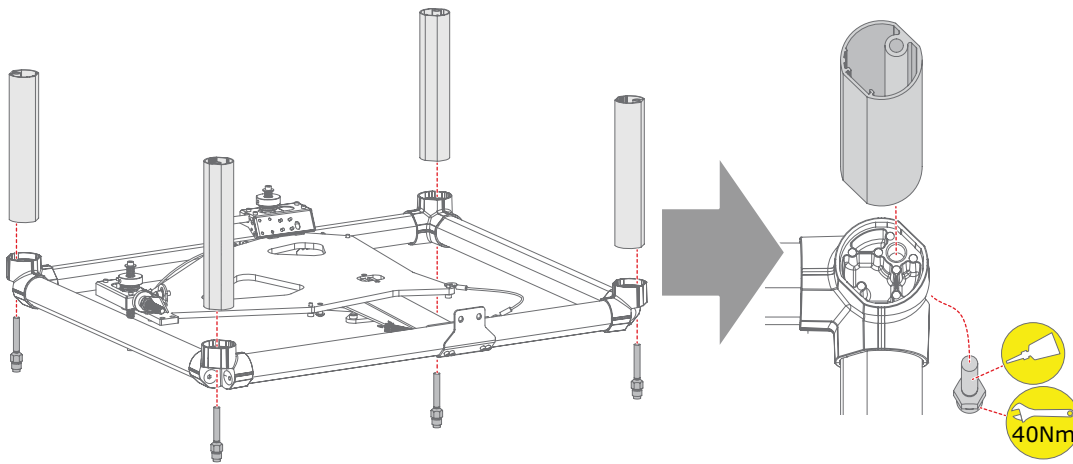

Image 1-7

3. Place the top frame onto the rest of the rigging frame. Make sure that the two side frame brackets are positioned on the same side and opposite of each other (image 1-8). If this is not possible due to mechanical error, contact Barco.

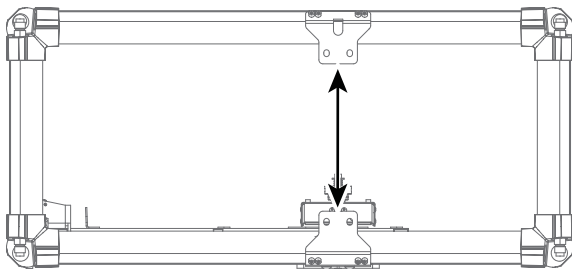

Image 1-8

4. Fixate the top frame onto the rest of the rigging frame. Use the rigging screws to tighten the two together.

Caution: Use high strength threadlocker on the rigging screws thread. Tighten the rigging screws with a torque of 40 Nm.

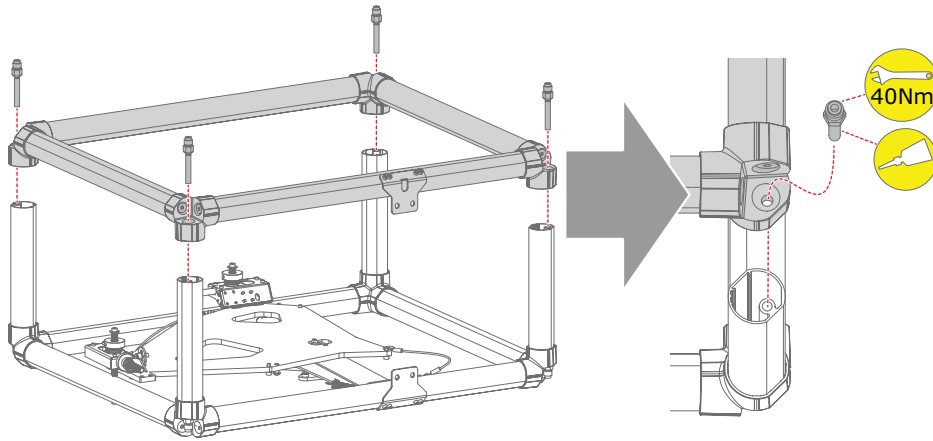

Image 1-9

5. Attach the side frame to the rigging frame as illustrated (image 1-10).

6. Install all 11 hex screws without tightening. Do this as illustrated (image 1-11). Use an 6 mm Allen wrench.

Caution: Use high strength threadlocker on ALL hex screws.

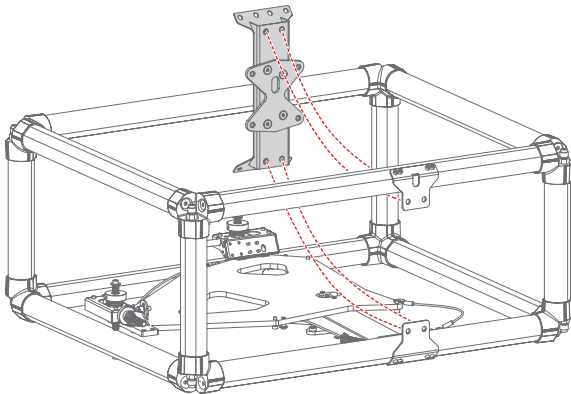

Image 1-10

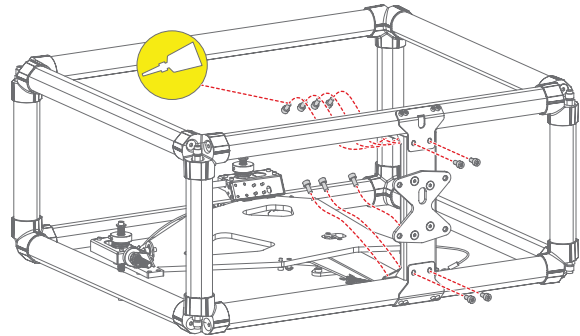

Image 1-11

7. When all screws are installed, tighten the screws.

Caution: Make sure that all 11 screws are well tightened.

How to install the stacking pins?

1. Install the top and bottom stacking pins onto the top side of the frame as illustrated.

Caution: Provide sufficient high strength threadlocker on the inner thread of the stacking pins.

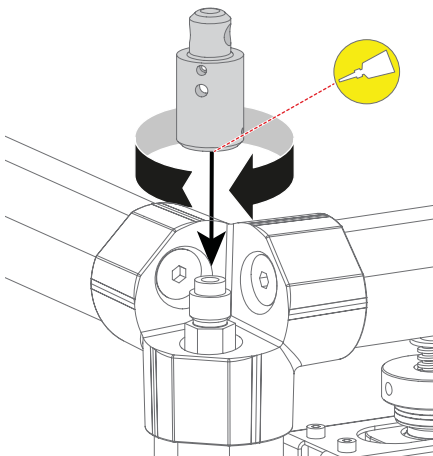

Image 1-12

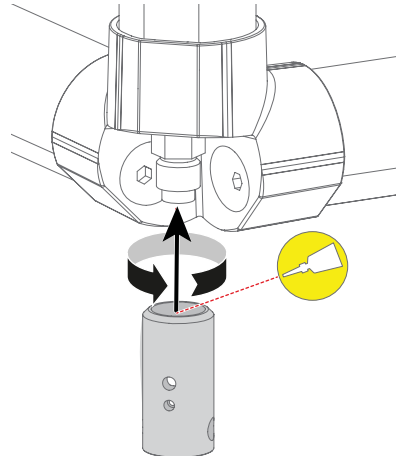

Image 1-13

1. F90-Series multifunctional frame

2. Tighten the stacking pins by hand until you feel it's been fully tightened.
3. Turn the stacking pins back in the opposite direction until you can place the orientation rod + nut as illustrated image 1-14).

Caution: Make sure the orientation rod is pointing precisely in the round of the corner piece. If not done precisely, the frame will not be connectable to other frames. For more info on connecting rigging frames, see "Stacking multiple projectors using the multifunctional frame", page 12.

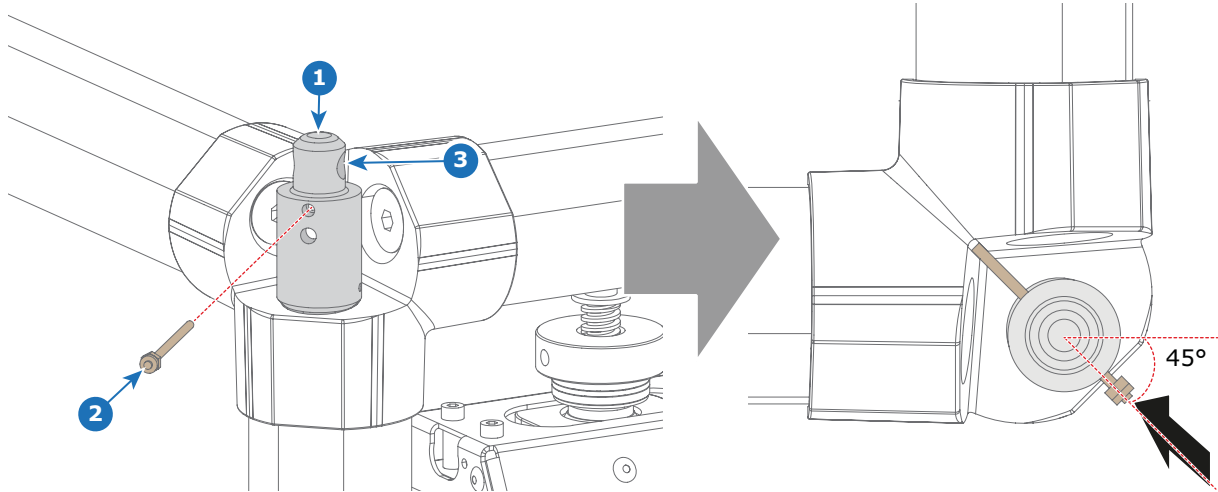

Image 1-14

- 1 Stacking pin
- 2 orientation rod M3 + M3 nut
- 3 Stacking hole

4. Mount the M6 set screws. Use a 3 mm Allen wrench.

Caution: Use sufficient high strength threadlocker on the set screws.

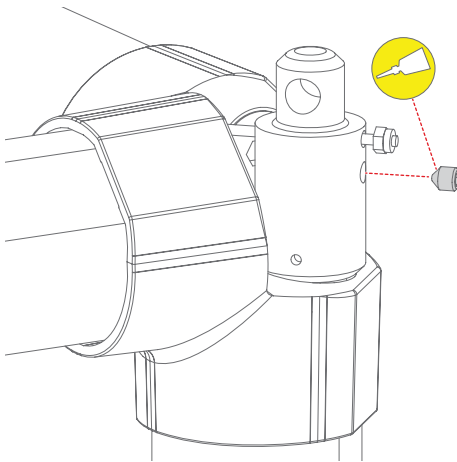

Image 1-15

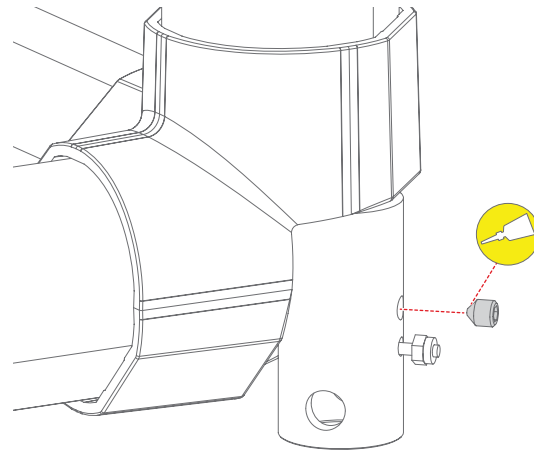

Image 1-16

5. Remove the orientation rod + nut

1.5 Installing the projector onto the multifunctional frame

Necessary tools

Allen wrench 5 mm

Necessary parts

- Rigging frame cardboard packaging
- hex screws with socket head M6 x 25 (x4)
- Spring washer M6 (x4)
- 1 hex screw with button head M8 x 20
- Spring washer M8
- F90 external filter (optional)
- Locking pins (x4)



CAUTION: Don't tighten the five hex screws of the frame until you've positioned all screws into the projector.

How to install the projector onto the multifunctional frame?

1. Set up the packaging in such a way the projector can be placed upside down on it. Do this as illustrated.

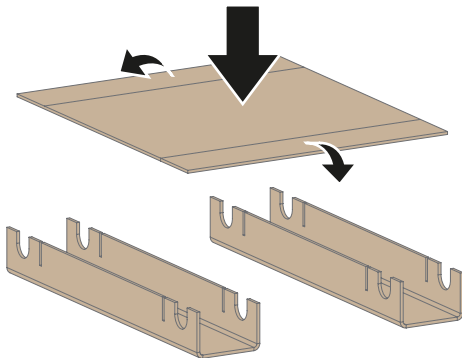

Image 1-17



Image 1-18

2. Place the projector on the packaging, upside down.
Note: Make sure that the openings in the bottom cardboard are left open for the frame itself.
3. Place the rigging frame over the projector as illustrated. Align the mounting holes of the rigging frame to the mounting holes of the projector.

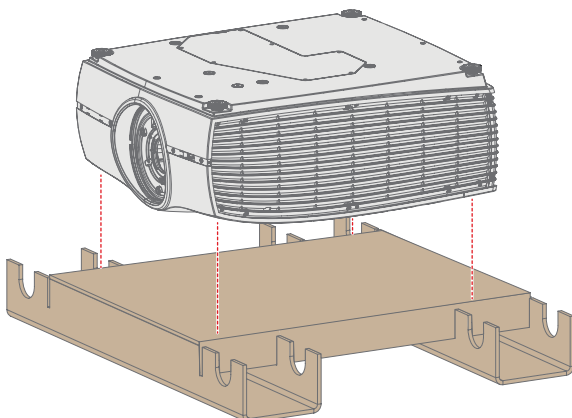

Image 1-19

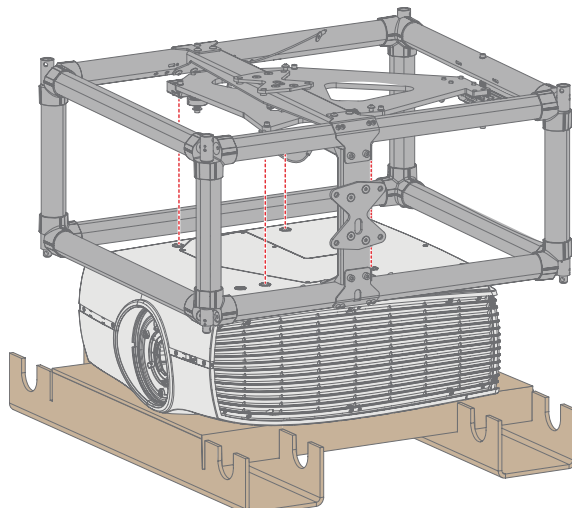

Image 1-20

1. F90-Series multifunctional frame

4. Mount the four M6 hex screws (reference 1 image 1-21) + spring washer on the bottom of the rigging frame to tie the two together.

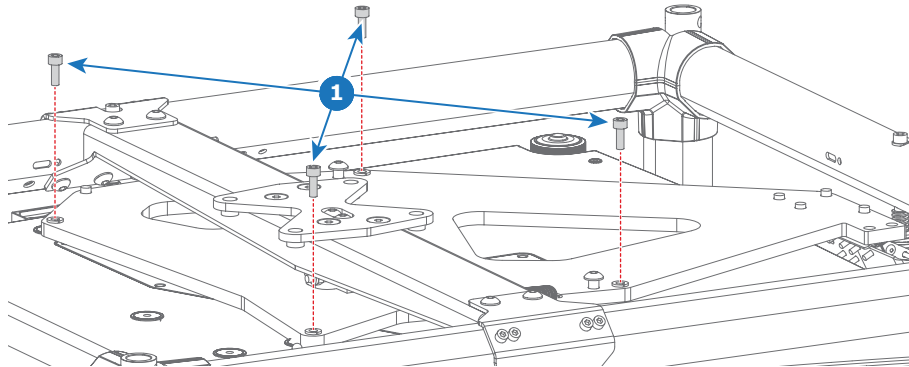

Image 1-21

Caution: Make sure to place the safety cables between the spring washer and the mounting hole.

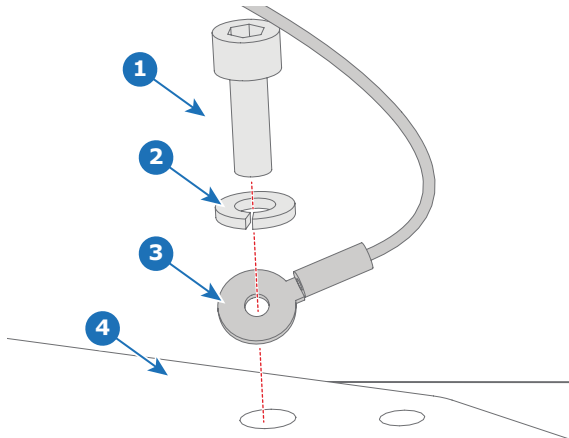

Image 1-22

- 1 M6 Hex screw
- 2 M6 Spring washer
- 3 Safety Cable
- 4 Mounting hole in projector support structure

5. Mount the M8 hex screw with button head + spring washer (reference 2 image 1-23) on the backside of the rigging frame, into the backside of the projector.

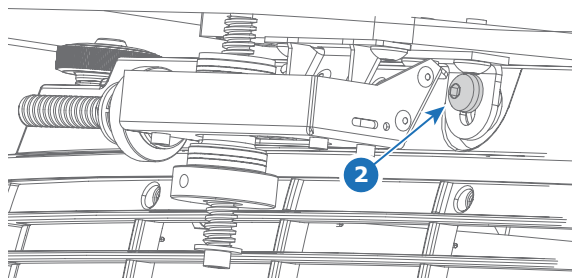

Image 1-23

Caution: Forgetting to tighten the screw in the backside of the projector may cause damage to the projector support platform during transport.

6. Tighten all five screws.

How to install the additional filter

1. Skew the projector to open the side on which the filter has to be added. For more info, see "Skewing the projector", page 18.
2. Place the filter into the frame, from the front side of the rigging frame.

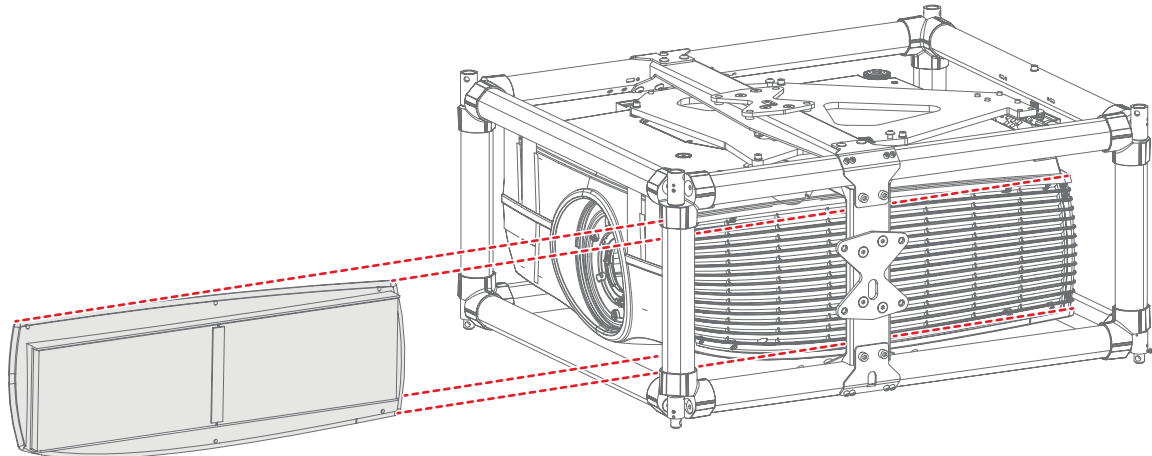

Image 1-24

3. Tighten the filter onto the side of the projector, using the screws provided with the filter.
4. Skew the projector back to its neutral position.

How to finish the installation

1. Make sure that all screws are tightened and all safety cable are firmly attached.
2. Lift the rigging frame with projector up and flip it upside down.
3. Install the four locking pins (reference 1 image 1-25) in the top stacking pins.

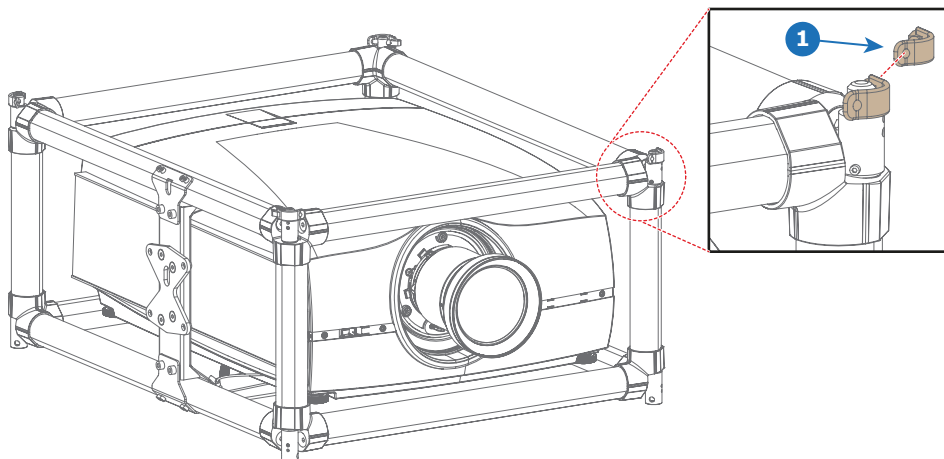

Image 1-25

1 Locking pin

Note: Skip this step if you immediately are going to stack or suspend multiple rigging frames.

1.6 Stacking multiple projectors using the multifunctional frame



WARNING: It is not allowed to stack more than three projectors.

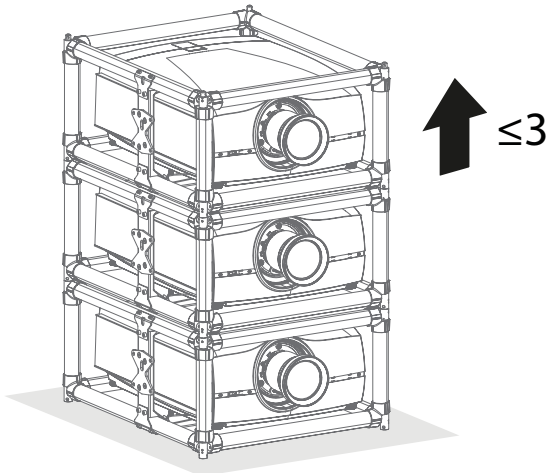

Image 1-26
Example of stacking projectors on a flat surface

Necessary parts

Locking pins

How to stack multiple projectors using the multifunctional frame?

1. Make sure that each projector is installed in their respective rigging frame.
2. If pre-installed, remove all four locking pins (reference 1, image 1-27) from each multifunctional frame, except the frame that will be installed on top of the stack.

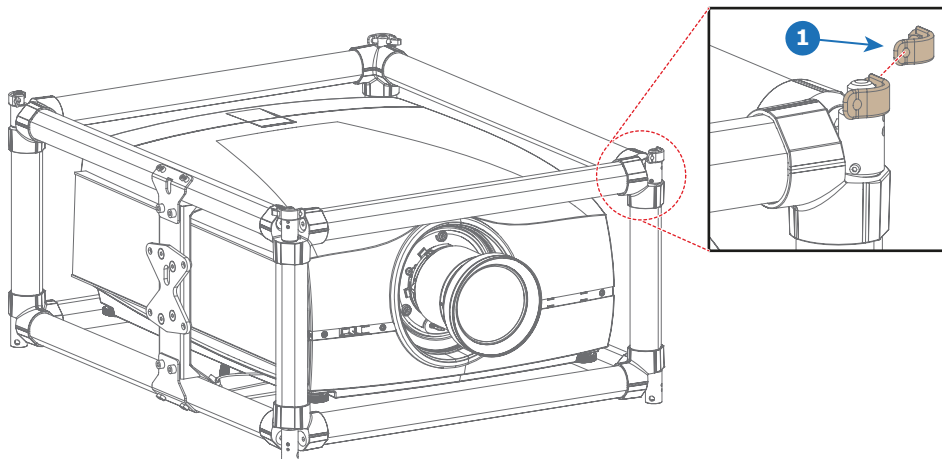

Image 1-27
1 Locking pin

Note: Even if not all pins are necessary in your current setup, it is important to keep all locking pins to their respective rigging frame for future use.

3. Stack the multifunctional frames. Make sure the stacking pins of both frames are aligned.

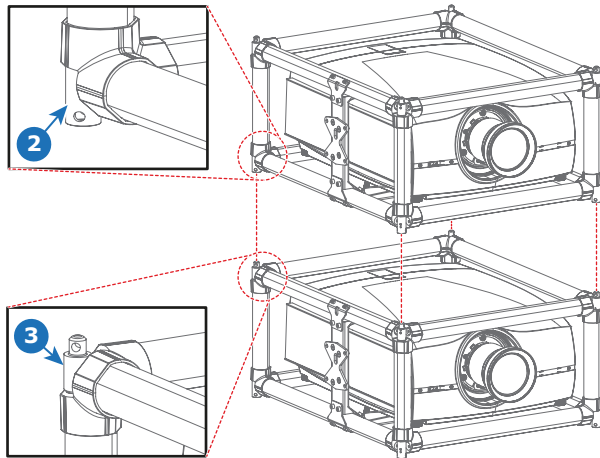

Image 1-28

- 2 Lower stacking pins
- 3 Upper stacking pins

4. Install a locking pin (reference 1, image 1-29) through the overlapping hole of both stacking pins.

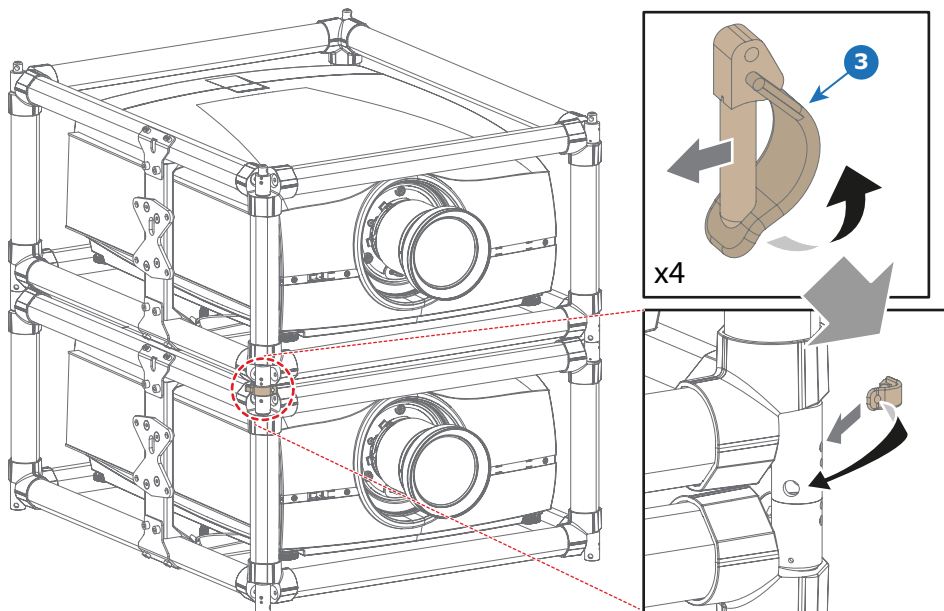

Image 1-29

5. Repeat the previous step for each overlapping corner of all stacked rigging frames.

1.7 Suspending the projector from a truss



WARNING: It is the responsibility of the installer to suspend the rigging frames in a safe and secure fashion.

Suspending the projector from a truss

The projector can be suspended from a truss using the multifunctional frame.

Take the following things into account:

1. F90-Series multifunctional frame

- If suspension clamps are used, they can be placed on any of the round profiles of the frame. The number of clamps required depends on the types of clamps used. Always make sure you use at least 4 clamps: 2 clamps at 2 opposed sides of the frame. Make sure to take into account the total weight of all frames and projectors suspended from the truss.
- It is allowed to suspend **maximum two** projectors.

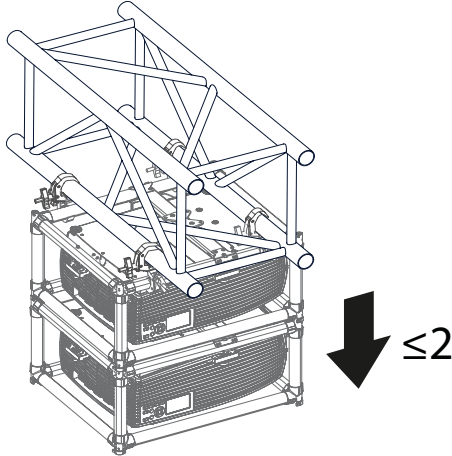

Image 1-30

- Alternatively, when using a single point of connection, you can use one of the two rigging points for suspending the frames. When using this method, also make sure to attach two safety cables. Tie these cables from the truss towards two of the frame bars opposing each other.

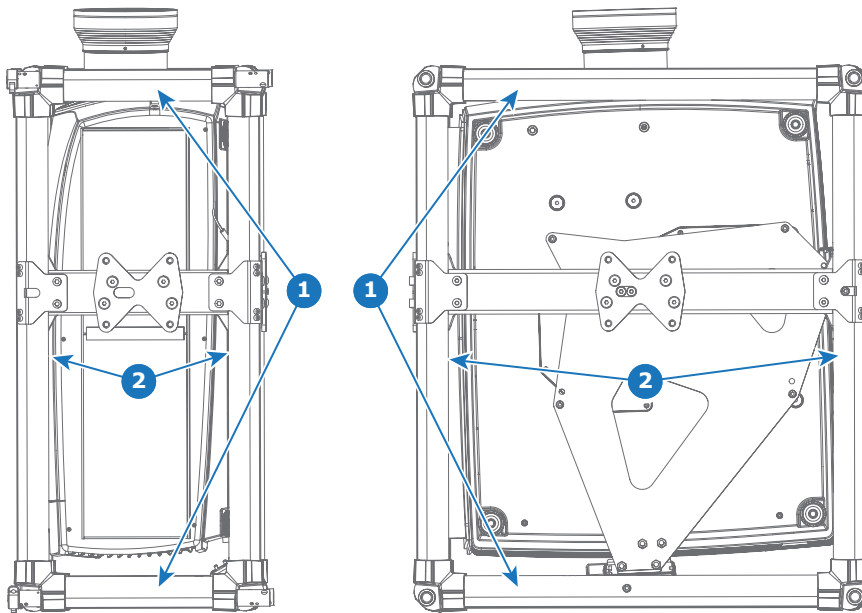

Image 1-31

Attach the safety cables to the bars marked by either 1, or by 2. Do not connect to the bar holding the single point of connection.

- When using a single point of connection, take into account that the 4 bolts connecting to the frame should be M8 bolts that can be inserted at least 15 mm into the frame rigging points.



CAUTION: When using single point suspension (both ceiling or portrait mode), it is not allowed to incline the frame for more than 20° towards the horizon.

How to suspend from a truss, using the rigging clamps

1. Measure the distance between the two used support bars of the truss, using the center tube as reference.

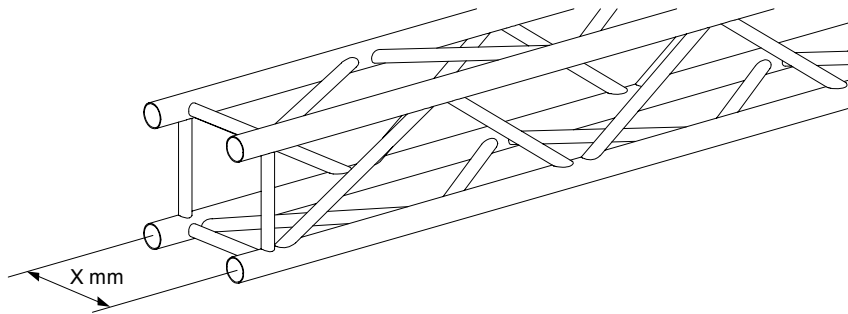

Image 1-32
Example of truss

2. Turn the projector upside down and install the rigging clamps, according the measured distance and secure this position. Ensure that the rigging points are symmetrically lined up, so that the projector will hang in balance.

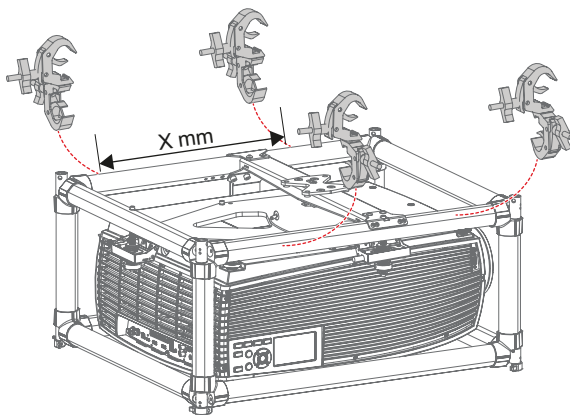

Image 1-33
Example of clamps installation

Warning: Always use four (4) rigging points, equally spread, to suspend the projector.

3. If two projectors are suspended from each other, use the method described in "Stacking multiple projectors using the multifunctional frame", page 12.
4. Place the projector (upside down) under the truss installation and lower the truss until the support bars of the truss are nearby the rigging clamps mounted on the projector.

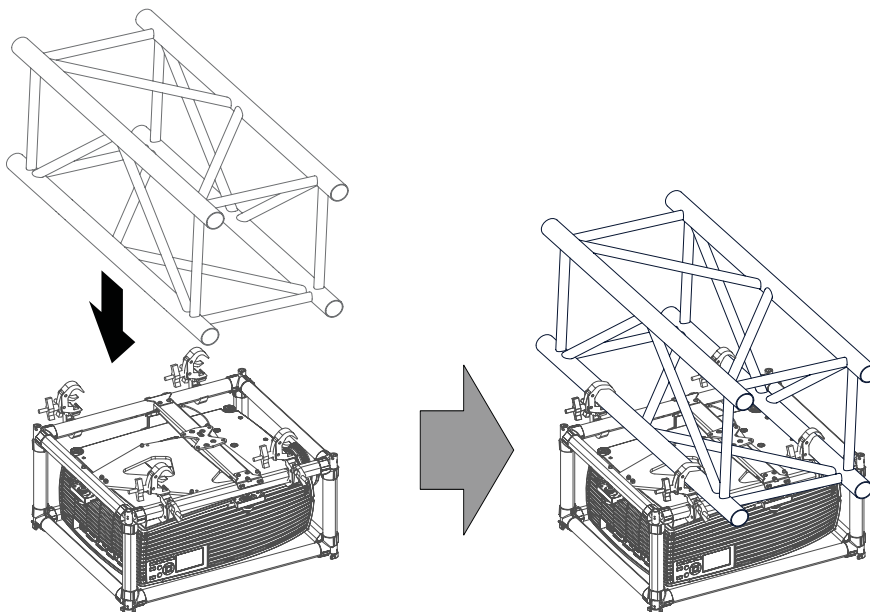

Image 1-34
Example of mounting to truss

1. F90-Series multifunctional frame

Warning: Always secure the rigging points after adjustment.

5. Lock all four rigging clamps by turning the fixation handle clockwise.

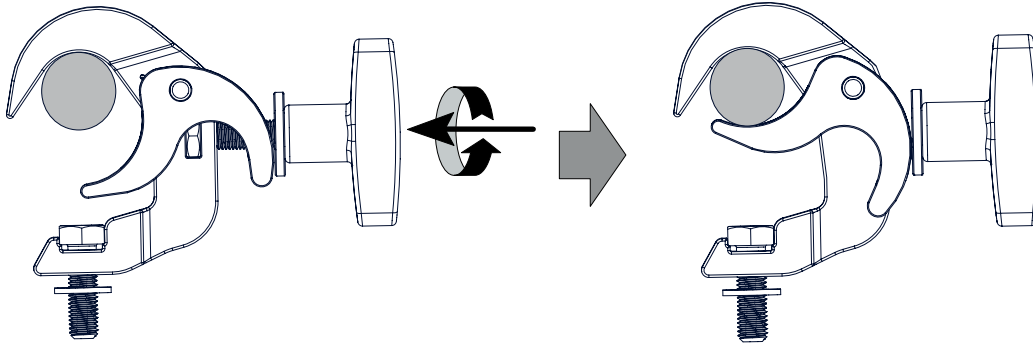

Image 1-35
Example of clamp fixation

6. Install the 2 safety cables, one on both sides of the rigging frame, and around the truss.
Mount the 2 safety cables around the frame bar (push the hook through the loop and then around the truss so that there is not too much play (maximum 20 cm). If necessary turn the cable a few times around the truss before clasping the safety hook around the cable.

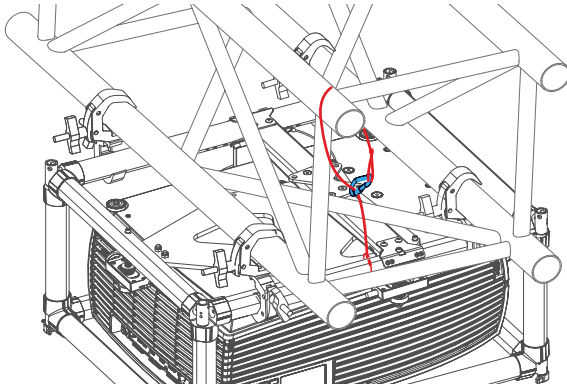

Image 1-36
Example of installation of a safety cable

Note: Mount the 2 safety cables in such a way that when something goes wrong, the projector cannot fall more than 20 cm. If necessary, turn the cables a few times around the truss to obtain this maximum distance.

7. Lift up the truss with the attached projector to the desired height.

How to suspend from a truss, using a single point of contact

1. Turn the projector upside down and install the floor adapter. Use the four big bolts to tighten it to the rigging frame.

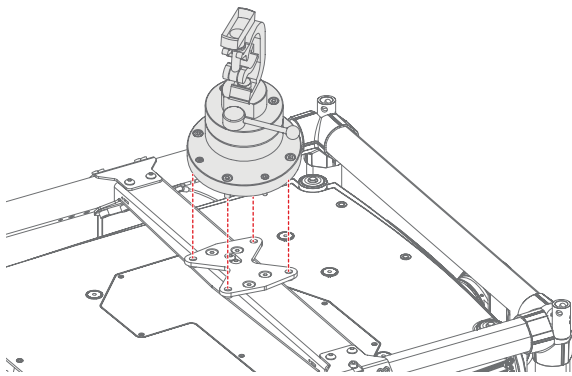

Image 1-37
Example of floor adapter installation in landscape

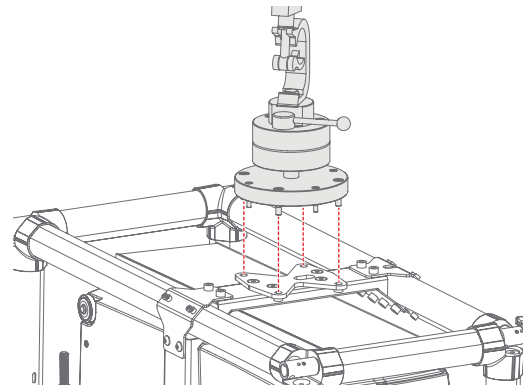

Image 1-38
Example of floor adapter installation in portrait

2. Place the projector (upside down) under the truss installation and lower the truss until the support bars of the truss are nearby the floor adapter mounted on the projector.

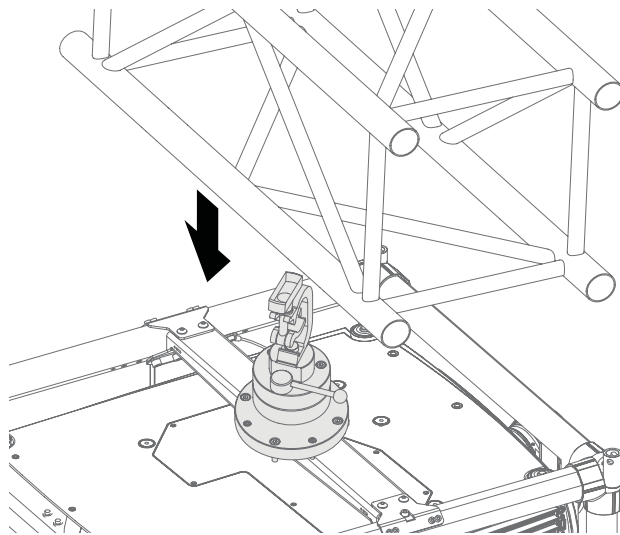

Image 1-39
Example of mounting to truss

3. Lock the floor adapter.
4. Install two safety cables, one on both sides of the rigging frame, and around the truss. Mount safety cables around the frame bar (push the hook through the loop and then around the truss so that there is not too much play (maximum 20 cm). If necessary turn the cable a few times around the truss before clasp the safety hook around the cable.

Note: Mount the 2 safety cables in such a way that when something goes wrong, the projector cannot fall more than 20 cm. If necessary, turn the cables a few times around the truss to obtain this maximum distance.

1. F90-Series multifunctional frame

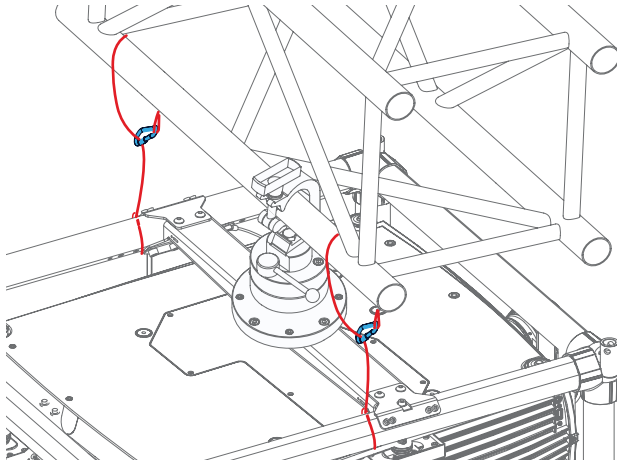

Image 1-40
Example of single point connection with safety cables

5. Lift up the truss with the attached projector to the desired height.

1.8 Skewing the projector

How to skew the projector?

1. Turn the skew knob at the back (reference 1, image 1-41) to skew the projector.

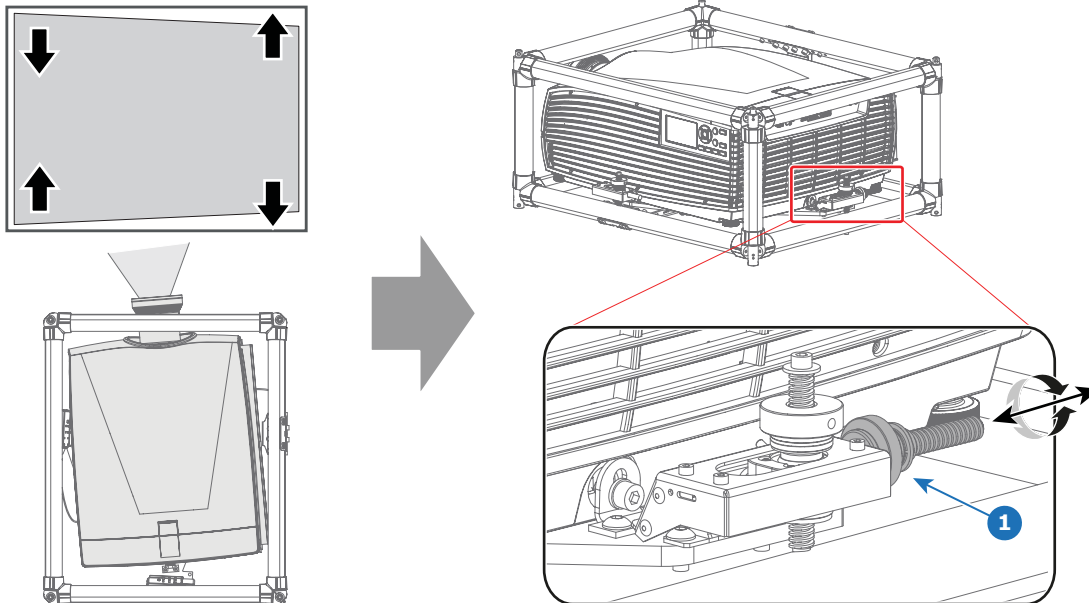

Image 1-41

1.9 Tilting the projector

How to tilt the projector?

1. Turn the tilt adjustment knob at the back (reference 1, image 1-42) to lift the projector up or down.

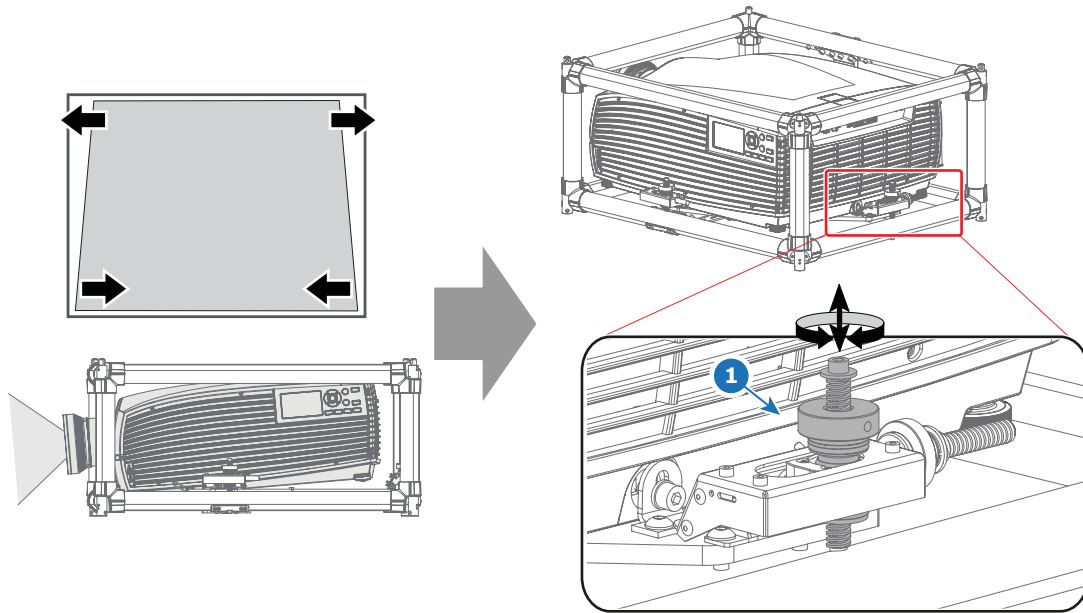

Image 1-42

1.10 Rotating the projector

How to rotate the projector?

1. Turn the rotate adjustment knob on the left side (reference 1, image 1-43) to rotate the projector.

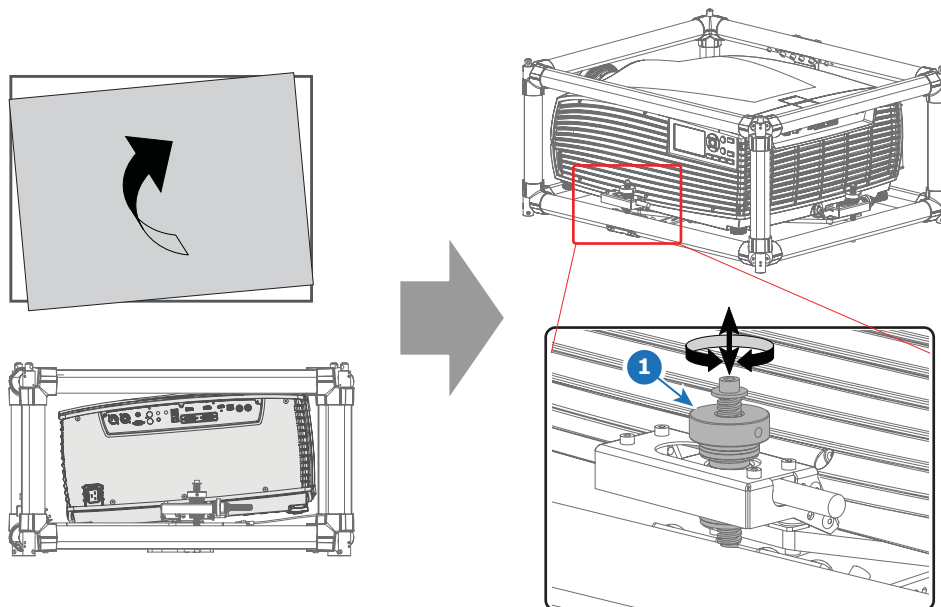

Image 1-43

1.11 Dimensions

Useful Dimensions

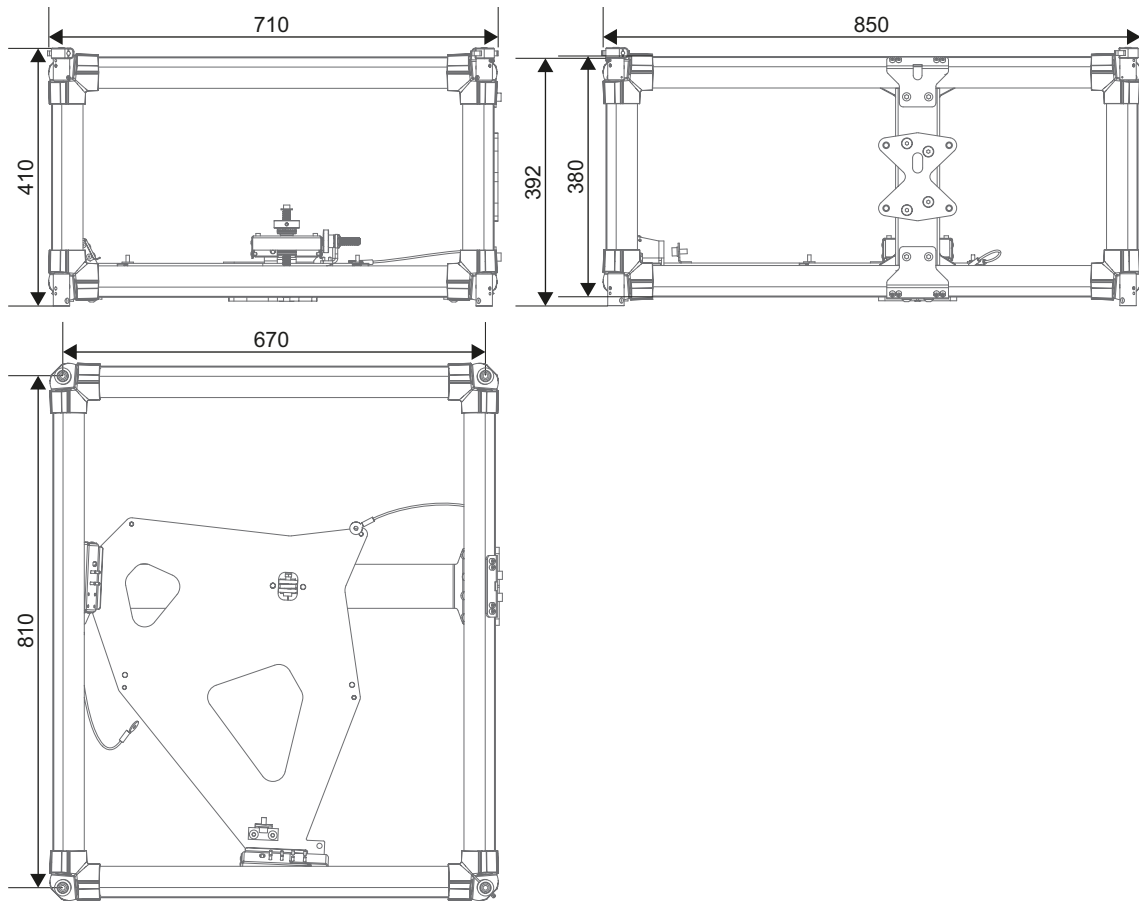

Image 1-44



All dimensions are in mm.

The lens to lens distance when stacking is 392 mm.

Weight

The weight of the fully assembled frame without the projector is 20.6 kg (45.42 lbs).