

WorkForce WF-2510WF



DATASHEET



This all-in-one has a compact design with a small footprint, ideal for any home office environment. Robust and durable, the WF-2510WF offers the ability to print from smartphones and tablet PCs with Epson iPrint.

The WorkForce WF-2510WF uses Epson's fast drying DURABrite Ultra Ink for professional-quality business documents and means that prints are water, smudge and highlighter resistant. Cartridges are also available in XL size, helping to save further on costs, as users can print up to 2.5x more pages*1.

This printer also has flexible connectivity options, as users can connect the printer to their network via Wi-Fi. With automatic Wi-Fi set-up, users don't need to know their network settings or connect with a USB cable during set up, as the printer automatically finds the relevant connection settings in order to configure itself*2.

Epson iPrint*3 allows users to print wirelessly from smartphones and tablet PCs within the office.

The WorkForce WF-2510WF also comes with a robust 100-sheet rear paper tray, providing media flexibility for a variety of paper.

KEY FEATURES

- **Wi-Fi all-in-one**
Print, scan, copy and fax
- **Epson iPrint**
Print from smartphones and tablet PCs
- **Space saving**
Compact footprint
- **Economical**
Print more pages with Epson XL inks*1
- **Durable**
3,000 page duty cycle per month*4

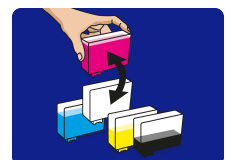

PRODUCT SPECIFICATIONS

TECHNOLOGY

Printing Method	4-colour inkjet printer
Minimum Droplet Size	3 pl, With Variable-Sized Droplet Technology
Ink Technology	DURABrite™ Ultra

PRINT

Printing Speed ISO/IEC 24734	9 Pages/min Monochrome, 4.7 Pages/min Color
Maximum Printing Speed	34 Pages/min Monochrome (plain paper), 18 Pages/min Color (plain paper), 38 Seconds per 10 x 15 cm photo (Epson Premium Glossy Photo Paper)
Printing Resolution	5,760 x 1,440 dpi
Max Duty cycle	3,000 Pages per month
Colours	Black, Cyan, Yellow, Magenta

For detailed information on printing speeds please visit <http://www.epson.eu/testing>.

SCAN

Scanning Resolution	1,200 dpi x 2,400 dpi (Horizontal x Vertical)
Scanner type	Contact image sensor (CIS)

FAX

Fax speed dials (max)	60 names and numbers
Page memory	Up to 180 pages (ITU-T No.1 chart)
Fax Functions	PC Fax, Memory Reception, Auto Redial, Speed Dial

PAPER / MEDIA HANDLING

Paper Formats	A4, A5, A6, B5, C6 (Envelope), DL (Envelope), No. 10 (Envelope), Letter, Letter Legal, 10 x 15 cm, 13 x 18 cm, 16:9
Duplex	Manual
Paper Tray Capacity	100 Sheets Standard, 100 Sheets maximum, 20 Photo Sheets
Number of paper trays	1

CONNECTIVITY

Interfaces	USB 2.0 Type B, Wireless LAN IEEE 802.11b/g/n, USB 2.0 Type A
WLAN Security	WEP 64 Bit, WEP 128 Bit, WPA PSK (TKIP), WPA PSK (AES)

GENERAL

Energy Use	ENERGY STAR® qualified, 11 W (standalone copying, ISO/IEC 24712 pattern), 2.3 W (sleep mode)
Product dimensions	392 x 377 x 177 mm (Width x Depth x Height)

OTHER

Warranty	12 months Carry in Optional warranty extension available
----------	---

LOGISTICS INFORMATION

SKU	C11CC58301
EAN code	8715946514086
Dimensions Single Carton	456 x 457 x 261 mm
Carton Weight	6.3 Kg
Multiple Order Quantity	1 Units
Country of Origin	Indonesia
Pallet Size Euro	16 Units (2 x 8)
Pallet Size Block	32 Units (4 x 8)



For more information please contact:

Telephone: 01952 607111 (UK)+
01 436 7742 (Republic of Ireland)
E-mail: enquiries@epson.co.uk
Chat: etalk.epson-europe.com
Fax: 0871 222 6740
+ Local call rate.

Web: www.epson.co.uk
www.epson.ie

Trademarks and registered trademarks are the property of Seiko Epson Corporation or their respective owners. Product information is subject to change without prior notice.

WorkForce WF-2510WF

WHAT'S IN THE BOX

- Main unit
- Individual Ink Cartridges
- Wi-Fi/network setup guide
- User manual (CD)
- Software (CD)
- Warranty document
- Power cable

INK CARTRIDGE COMPATIBILITY



INK YIELD DATA

	175 pages*	500 pages*
	165 pages*	450 pages*

* Approx. page yield based on ISO/IEC 24711/24712 or ISO/IEC 29102/29103. Actual yield will vary depending on images printed and usage conditions. For more information visit <http://www.epson.eu/pageyield>

1. For more information, please visit www.epson.eu/inkjetsaving
2. Automatic set-up compatible with Windows 8, Windows 7, Windows Vista and Mac OS
3. Requires a wireless connection to the internet. For more information, supported languages and devices please visit www.epsonconnect.eu
4. The maximum number of printed pages per month based on the performance capabilities of the printer, including ISO rated print speeds and paper handling capabilities
5. For more information, please visit www.epson.eu/testing
6. Determined in accordance with ISO/IEC 24734 showing the average of ESAT from the Office Category Test for default simplex. For more information, please visit www.epson.eu/testing

EPSON®