

SONY

4-528-478-11(2)

FM/AM Clock Radio

Operating Instructions



©2014 Sony Corporation Printed in China

ICF-C1PJ



http://www.sony.net/

Before operating the unit, please read this guide thoroughly and retain it for future reference.

For customers who purchased this product in the USA Please register this product on line at http://www.sony.com/productregistration. Proper registration will enable us to send you periodic mailings about new products, services, and other important announcements. Registering your product will also allow us to contact you in the unlikely event that the product needs adjustment or modification. Thank you.

Owner's Record

The model and serial numbers are located on the bottom of the unit. Record these numbers in the space provided below. Refer to them whenever you call upon your Sony dealer regarding this product.

Model No. _____ Serial No. _____

WARNING

To reduce the risk of fire or electric shock, do not expose this apparatus to rain or moisture.

To reduce the risk of fire, do not cover the ventilation of the apparatus with newspapers, tablecloths, curtains, etc. And do not place lighted candles on the apparatus. To reduce the risk of fire or electric shock, do not expose this apparatus to dripping or splashing, and do not place objects filled with liquids, such as vases, on the apparatus.

Do not install the appliance in a confined space, such as a bookcase or built-in cabinet.

Do not expose batteries or apparatus with battery-installed to excessive heat such as sunshine, fire or the like.

As the main plug is used to disconnect the unit from the mains, connect the unit to an easily accessible AC outlet. Should you notice an abnormality in the unit, disconnect the main plug from the AC outlet immediately.

The unit is not disconnected from the AC power source (mains) as long as it is connected to the wall outlet, even if the unit itself has been turned off.

The nameplate and important information concerning safety are located on the bottom exterior.

You are cautioned that any changes or modifications not expressly approved in this manual could void your authority to operate this equipment.

CAUTION

Danger of explosion if battery is incorrectly replaced. Replace only with the same type.

CAUTION RISK OF ELECTRIC SHOCK DO NOT OPEN. This symbol is intended to alert the user to the presence of uninsulated "dangerous voltage" within the product's enclosure that may be of sufficient magnitude to constitute a risk of electric shock to persons. This symbol is intended to alert the user to the presence of important operating and maintenance (servicing) instructions in the literature accompanying the appliance.

The following FCC statement applies only to the version of this model manufactured for sale in the USA. Other versions may not comply with FCC technical regulations.

NOTE

This equipment has been tested and found to comply with the limits for a Class B digital device, pursuant to Part 15 of the FCC Rules. These limits are designed to provide reasonable protection against harmful interference in a residential installation. This equipment generates, uses and can radiate radio frequency energy and, if not installed and used in accordance with the instructions, may cause harmful interference to radio communications. However, there is no guarantee that interference will not occur in a particular installation. If this equipment does cause harmful interference to radio or television reception, which can be determined by turning the equipment off and on, the user is encouraged to try to correct the interference

by one or more of the following measures:

- Reorient or relocate the receiving antenna.
- Increase the separation between the equipment and receiver.
- Connect the equipment into an outlet on a circuit different from that to which the receiver is connected.
- Consult the dealer or an experienced radio/TV technician for help.

WARNING

Do not ingest battery, chemical burn hazard.

This product contains a coin/button cell battery. If the coin/button cell battery is swallowed, it can cause severe internal burns in just 2 hours and can lead to death. Keep new and used batteries away from children. If the battery compartment does not close securely, stop using the product and keep it away from children. If you think batteries might have been swallowed or placed inside any part of the body, seek immediate medical attention.

Important Safety Instructions

- 1) Read these instructions.
2) Keep these instructions.
3) Heed all warnings.
4) Follow all instructions.
5) Do not use this apparatus near water.
6) Clean only with dry cloth.
7) Do not block any ventilation openings.
8) Do not install near any heat sources such as radiators, heat registers, stoves, or other apparatus (including amplifiers) that produce heat.
9) Do not defeat the safety purpose of the polarized or grounding-type plug.
10) Protect the power cord from being walked on or pinched particularly at plugs, convenience receptacles, and the point where they exit from the apparatus.
11) Only use attachments/accessories specified by the manufacturer.
12) Use only with the cart, stand, tripod, bracket, or table specified by the manufacturer, or sold with the apparatus.
13) Unplug this apparatus during lightning storms or when unused for long periods of time.
14) Refer all servicing to qualified service personnel.



NOTES ON LITHIUM BATTERY

- Wipe the battery with a dry cloth to assure a good contact.
• Be sure to observe the correct polarity when installing the battery.
• Do not hold the battery with metallic tweezers, otherwise a short-circuit may occur.
• Do not expose the battery to excessive heat such as direct sunlight, fire or the like.

If you have any questions or problems concerning your unit, please consult your nearest Sony dealer.

General information

About the battery as a backup power source

This unit contains a CR2032 battery as a backup power source to keep the clock and the alarm operating during a power interruption. (No Power No Problem system)



When to replace the battery

When the battery is discharged, "⏻" appears on the display. If a power interruption occurs while the battery is discharged, the current time and alarm will be erased.

- Note
• If "AM 12:00" flashes on the display when the unit is connected to an AC outlet for the first time, the battery may be discharged. In this case, consult your nearest Sony dealer.

Replacing the backup battery

- 1 Keep the AC plug connected to the wall outlet, then open the battery compartment on the bottom of the unit.

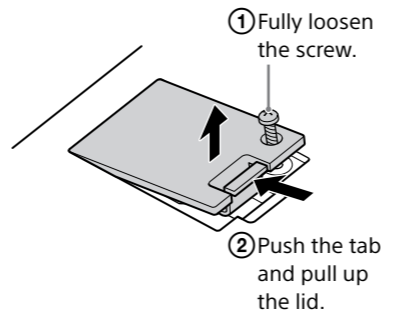

- 2 Remove the old battery by sliding it out and picking it up.

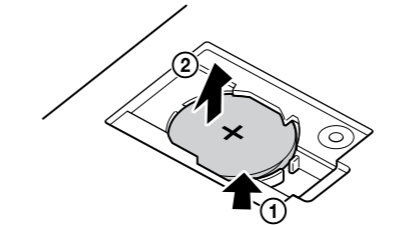

- 3 Insert a new battery into the battery compartment with the + side facing up.

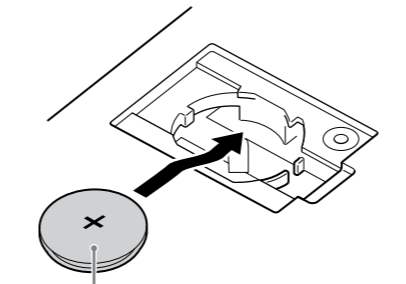

- 4 Replace the battery compartment lid and tighten the screw.
5 Press AM/FM/NATURE SOUND to remove "⏻" from the display.

Notes

- When you replace the battery, do not disconnect the AC plug from the wall outlet. Otherwise, the current date and time, alarm, and station presets will be erased.
• If the clock is erased while you are replacing the battery, set the clock again. (See "Setting the clock manually")
• If the unit will be left unplugged for a long time, remove the battery to avoid any damage that may be caused by leakage or corrosion.

Troubleshooting

Should any problems persist after you have made the following checks, consult your nearest Sony dealer.

The clock flashes "0:00" or "AM 12:00" after a power interruption.

- The battery is discharged. Remove the old battery and insert a new one.

Unsatisfactory reception

- Extend the FM wire antenna fully to increase reception sensitivity.
• Connect the supplied AM loop antenna to the unit. Rotate the antenna horizontally for optimum reception.
• Do not place the AM loop antenna near the unit or other AV equipment, as noise may result.
• Keep digital music players or mobile phones away from the AM loop antenna or the FM antenna, as this may lead to reception interference.

The alarm does not sound at the preset alarm time.

- Check that "A" or "B" appears on the display.

The radio or Nature Sound alarm is activated but no sound is emitted at the preset alarm time.

- Check the alarm volume setting.

When daylight saving time (summer time) begins, the clock does not switch to daylight saving time (summer time) automatically.

- Make sure the clock is set correctly.
• When "Aut -> On" appears on the display after pressing and holding DST for more than 2 seconds, the Automatic DST/summer time function becomes active.

Specifications

Time display

Switch between the 12-hour system (default) and the 24-hour system.

Frequency range

Table with 3 columns: Band, Frequency, Channel step. FM: 87.5 MHz - 108 MHz, 0.1 MHz. AM: 530 kHz - 1,710 kHz, 10 kHz.

Speaker

Approx. 4.0 cm (1 5/8 inches) dia., 8 Ω Power output: 700 mW (at 10% harmonic distortion)

Power requirements

120 V AC, 60 Hz For clock back up: 3 V DC, one CR2032 battery

USB power output

USB port (DC OUT 5 V 1.5 A)

Nature Sounds

Sea Waves, Birds, Rain, Brook, Under the Sea

Dimensions

Approx. 114.5 mm x 104 mm x 100.5 mm (w/h/d) (4 5/8 inches x 4 1/8 inches x 4 inches) including projecting parts and controls

Mass

Approx. 595 g (1 lb 5 oz) including CR2032 battery

Supplied accessories

AM loop antenna (1)

Design and specifications are subject to change without notice.

Getting Started

Connecting the AM loop antenna

The shape and the length of the antenna is designed to receive AM signals. Do not dismantle or roll up the antenna.

- 1 Raise the plastic stand and fit the antenna into the slot of the stand.

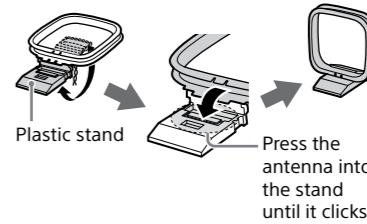

- 2 Insert the AM antenna connector into the AM ANTENNA jack on the unit.

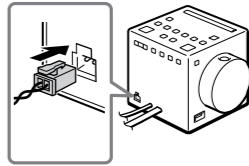

To remove the AM loop antenna

Push and hold down the tab of the antenna terminal clamp, and remove the AM loop antenna.

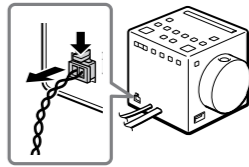

Connecting to an AC power source

Connect the AC power cord to a wall outlet.

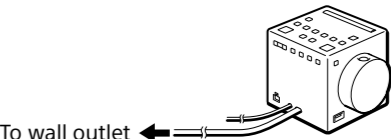

To wall outlet. "month and day" (about 2 seconds) -> "year" (about 2 seconds) -> "current EST (Eastern Standard Time)" appears on the display in turn. (This unit is preset to the current EST at the factory, and is powered by the back-up battery.)

Setting the clock for the first time

All you need to do to set the clock for the first time is select your time zone. If you live in the Eastern Standard Time zone, you do not need to adjust the area setting.

- 1 Press and hold TIME ZONE for more than 2 seconds. Area number "-5:00" appears on the display.
2 Press VOL/SET + or - repeatedly to select a number as follows:

Table with 2 columns: Area number, Time zone. Values include -3:30 (Newfoundland Standard Time), -4:00 (Atlantic Standard Time), -5:00 (Eastern Standard Time), -6:00 (Central Standard Time), -7:00 (Mountain Standard Time), -8:00 (Pacific Standard Time), -9:00 (Alaska Standard Time), -10:00 (Hawaii Standard Time).

- 3 Press SNOOZE/BRIGHTNESS/ENTER to set.

Note

• During shipment and your first use, a clock error may occur. In this case, refer to "Setting the clock manually" to set the correct time.

About Automatic DST/summer time adjustment

This unit automatically adjusts for daylight saving time (summer time). "DST" automatically appears on the display at the beginning of daylight saving time (summer time), and disappears at the end of daylight saving time (summer time).

- Daylight saving time (summer time) begins at 2:00 AM on the second Sunday of March.
• Standard time begins at 2:00 AM on the first Sunday of November.

Notes

• The implementation of DST/summer time and its beginning/ending date and time are subject to circumstances and laws in each country/region. Should this interfere with the desired adjustment, cancel the Automatic DST/summer time adjustment and set the clock manually as necessary. Customers living in a country/region that does not use daylight saving time (summer time) should cancel the Automatic DST/summer time adjustment before using the unit.
• When Hawaii Standard Time is set, the default Automatic DST/summer time adjustment setting is off.

To cancel Automatic DST/summer time adjustment

The Automatic DST/summer time adjustment can be canceled.

Press and hold DST for more than 2 seconds.

"Aut -> OFF" appears on the display.

To reactivate Automatic DST/summer time adjustment

Press and hold DST for more than 2 seconds.

"Aut -> On" appears on the display.

This warranty is valid only in the United States.

SONY LIMITED WARRANTY (U.S. Only) Portable Audio. Sony Electronics Inc. ("Sony") warrants this product against defects in material or workmanship for the time periods and as set forth below when purchased directly from Sony or a Sony Retailer. Includes terms, conditions, and contact information for Laredo Fulfillment Center.

D455714606

This unit includes a preinstalled Sony Lithium battery (CR2032) as a back-up power source for the clock, which is preset to EST (Eastern Standard Time) at the factory. This battery is considered part of the product.

Operations

Setting the clock manually

To change the clock setting manually, operate the unit as follows.

- 1 Press and hold **SET TIME/DATE** for more than 2 seconds. The year will start to flash on the display.
- 2 Press **VOL/SET +** or **-** repeatedly to select the year, and then press **SNOOZE/BRIGHTNESS/ENTER**.
- 3 Repeat step 2 to set the month, day and time. After setting the time, a beep will sound.

Notes

- If you do not press any button for about 1 minute while setting the clock, clock setting mode will be canceled.
- A 100-year calendar (2013 - 2112) is installed in the system.

To change the time format

You can choose between the 12-hour system (default) or the 24-hour system to display the time.

Press and hold **ALARM RESET/OFF** and **SNOOZE/BRIGHTNESS/ENTER** for about 3 seconds.

The time format toggles between the 12-hour system ("AM 12:00" = midnight) and the 24-hour system ("0:00" = midnight).

To display the date and year

Press **SET TIME/DATE** once to display the month and day, and press again to display the year. To return to the current time display, press **SET TIME/DATE** once again; or after a few seconds the clock display will return automatically.

When daylight saving time (summer time) begins/ends while Automatic DST/summer time adjustment is set to off

Change the clock setting manually if you have canceled the Automatic DST/summer time adjustment.

Using the projector

The projector function allows you to display the clock and the currently used alarm icons on a nearby wall or ceiling at a range of 0.5 m - 4 m (1 1/8 feet - 13 1/8 feet).

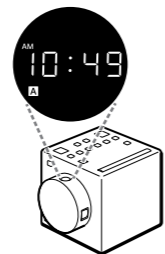

- 1 Rotate the projector unit to point the projector lens in the desired direction.
- 2 Press **PROJECTION**.
- 3 Turn **FOCUS** to adjust the focus. To turn off the projector, press **PROJECTION** again.

To rotate the projection view

Press **ROTATE PROJECTION** repeatedly.

Each time you press **ROTATE PROJECTION**, the projection view rotates as Fig. A.

Notes

- Do not stare into the lens directly.
- The projector function cannot be used unless the clock has been set.
- Certain walls and ceilings may not display the projection properly.
- The projector unit can be rotated 90° forward or backward from the upward position, and clicks when returned to the upward position.
- If the projector unit is rotated beyond its limits, it may be damaged.
- The projector will automatically turn off after 16 hours.

Listening to the radio

- 1 Press **AM/FM/NATURE SOUND** repeatedly to select the desired band (**AM** or **FM**).
- 2 Press **TUNING +** or **-** to tune to the desired station. If you press and hold **TUNING +** or **-**, scanning starts. Scanning pauses when a station is found, and restarts after a few seconds. To stop scanning, press **TUNING +** or **-** (or **SNOOZE/BRIGHTNESS/ENTER**).
- 3 Press **VOL/SET +** or **-** to adjust the volume. To turn off the radio, press **ALARM RESET/OFF**.

To preset radio stations

You can preset 5 stations for FM and 5 stations for AM.

- 1 Tune to the station you wish to preset.
- 2 Press and hold the desired **NATURE SOUND/PRESET (1 to 5)** until you hear a beep.



Example: The following display appears when you preset FM 105.7 MHz to preset number 3 for FM.

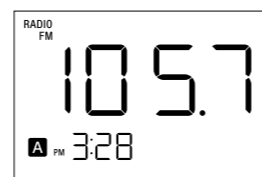
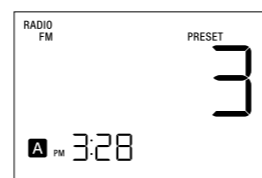

The display shows the frequency for a few seconds and then changes back to the current time.

To change the preset station, tune to the desired station and press and hold the **NATURE SOUND/PRESET (1 to 5)** until you hear a beep.

Note

- If you try to store another station with the same preset number, the previously stored station will be replaced.

To tune to a preset station

- 1 Press **AM/FM/NATURE SOUND** repeatedly to select the desired band (**AM** or **FM**).
- 2 Press **NATURE SOUND/PRESET (1 to 5)** where the desired station is stored.
- 3 Press **VOL/SET +** or **-** to adjust the volume.

Note

- If no station has been preset yet, "Non" appears on the display. Then the unit returns to the same state as in step 1.

Selecting a Nature Sound

This unit includes 5 types of Nature Sounds: Sea Waves, Birds, Rain, Brook, and Under the Sea.

- 1 Press **AM/FM/NATURE SOUND** repeatedly to select the Nature Sound.
- 2 Press the desired **NATURE SOUND/PRESET (1 to 5)**.

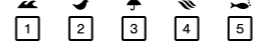

Icons	Sound type
	Sea Waves
	Birds
	Rain
	Brook
	Under the Sea

To turn off the Nature Sound, press **ALARM RESET/OFF**.

Note

- When other functions are in use, Nature Sounds are not available.

Setting the alarm

The dual alarm function allows you to set two alarm programs (**ALARM A** and **ALARM B**). The alarm time can be set for each program and the alarm sound can be selected from "RADIO" (radio), "BUZZ" (buzzer), or "NATURE" (Nature Sound).

Before setting the alarm

- Make sure to set the clock. (See "Setting the clock manually.")
- To set the radio alarm, first preset your favorite station. (See "To preset radio stations.")

- 1 Press and hold **SET ALARM/ALARM A (or B)** for more than 2 seconds. While setting the alarm, "A" (or "B") flashes on the display.
- 2 Press **VOL/SET +** or **-** to select the desired hour, and press **SNOOZE/BRIGHTNESS/ENTER**.

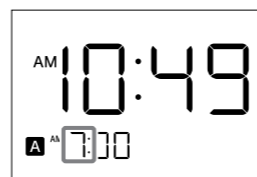

- 3 Press **VOL/SET +** or **-** to select the desired minute, and press **SNOOZE/BRIGHTNESS/ENTER**.
- 4 Press **VOL/SET +** or **-** to select the desired alarm period ("WEEKDAY," "WEEKEND," or every day*), and press **SNOOZE/BRIGHTNESS/ENTER**. * In the case of every day, both "WEEKDAY" and "WEEKEND" are displayed.



- 5 Press **VOL/SET +** or **-** to select the desired alarm mode ("RADIO," "BUZZ," or "NATURE"), and press **SNOOZE/BRIGHTNESS/ENTER**.



When selecting "RADIO"

Proceed to "[A] Setting the radio alarm."

When selecting "BUZZ"

The setting is complete. The buzzer will sound at the set time, gradually increasing in volume. ("A" (or "B") flashes on the display.)

When selecting "NATURE"

Proceed to "[B] Setting the Nature Sound alarm."

[A] Setting the radio alarm

- 6 Press **VOL/SET +** or **-** to select the AM band or FM band, and press **SNOOZE/BRIGHTNESS/ENTER**.

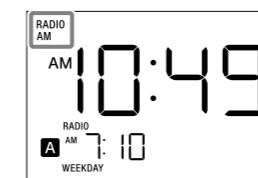

- 7 Press **VOL/SET +** or **-** (or **NATURE SOUND/PRESET (1 to 5)**) to select the preset number of desired station, and press **SNOOZE/BRIGHTNESS/ENTER**.

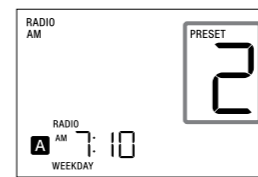

If no station has been preset yet

The preset number and "Non" appear on the display alternately. In this case, the buzzer will sound at the set time.

- 8 Press **VOL/SET +** or **-** to adjust the volume, and press **SNOOZE/BRIGHTNESS/ENTER**.

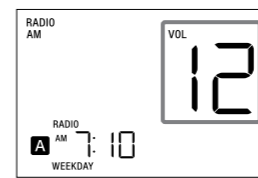

The setting is complete. The radio will turn on at the set time, gradually increasing in volume. ("A" (or "B") flashes on the display.)

[B] Setting the Nature Sound alarm

- 6 Press **VOL/SET +** or **-** (or **NATURE SOUND/PRESET (1 to 5)**) to select the desired Nature Sound, and press **SNOOZE/BRIGHTNESS/ENTER**.

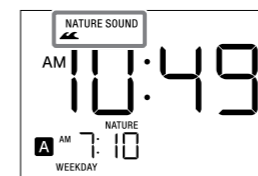

- 7 Press **VOL/SET +** or **-** to adjust the volume, and press **SNOOZE/BRIGHTNESS/ENTER**.

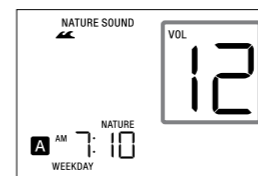

The setting is complete. The Nature Sound will sound at the set time, gradually increasing in volume. ("A" (or "B") flashes on the display.)

To stop the alarm

Press **ALARM RESET/OFF** to turn off the alarm.

The alarm will sound again at the same time the next weekday or the next weekend.

To doze for a few more minutes

Press **SNOOZE/BRIGHTNESS/ENTER**.

The sound turns off, but will automatically come on again after about 10 minutes. Each time you press **SNOOZE/BRIGHTNESS/ENTER**, the snooze time changes as follows:

10 → 20 → 30 → 40 → 50 → 60

The display shows the snooze time for a few seconds and returns to show the current time. ("A" (or "B") flashes on the display.)

To deactivate the alarm

Press **SET ALARM/ALARM A (or B)**.

"A" (or "B") disappears from the display.

To change an alarm setting

Set the alarm again.

Tips

- When the alarm setting is complete, the alarm time setting is displayed.
- If you press and hold **SNOOZE/BRIGHTNESS/ENTER** for more than 2 seconds while setting the alarm, the alarm setting is immediately complete.

Notes

- If a second alarm sounds during a first (or the snooze function is active), the second alarm takes priority.
- If the same alarm time is set for both **ALARM A** and **ALARM B**, **ALARM A** takes priority.
- If no operation is performed while the alarm is sounding, the alarm will stop after about 60 minutes.
- When Automatic DST/summer time adjustment is set, the alarm sounds as follows:
 - If the alarm is set to a time that is skipped as a result of daylight saving time starting, the alarm will sound when daylight saving time is applied.
 - If the alarm is set to a time that is doubled as a result of daylight saving time ending, the alarm will sound twice.

Notes on the alarm in the event of a power interruption

In the event of a power interruption, the alarm functions work until the battery is fully discharged. But certain functions may be affected as follows:

- The display will disappear.
- If the alarm sound is set to "RADIO" or "NATURE," the buzzer will sound.
- If a power interruption occurs while the alarm is sounding, the buzzer will sound.
- If **ALARM RESET/OFF** is not pressed, the alarm will sound for about 5 minutes.
- If "∞" appears on the display, the alarm will not sound in the event of a power interruption. Replace the battery if "∞" appears.
- The snooze function will not work.
- During a power interruption, the alarm will sound only once at the set time.

Setting the sleep timer

You can fall asleep to the radio or Nature Sound using the sleep timer, which turns off the radio or Nature Sound automatically after a preset duration.

Press **SLEEP** while the radio or Nature Sound is playing.

"SLEEP" appears on the display.

Each time you press **SLEEP**, the duration (in minutes) changes on the display as follows:

90 → 60 → 30 → 15
OFF

The radio or Nature Sound will play for the duration you set, then shut off.

To deactivate the sleep timer, press **SLEEP** repeatedly to set the sleep timer to "OFF."

To turn off the radio or Nature Sound before the preset time

Press **ALARM RESET/OFF**.

To use both the sleep timer and alarm

You can fall asleep to the radio or Nature Sound and also be awakened by the alarm at the preset time.

Set the alarm, then set the sleep timer.

Tip

- When you press **SLEEP** while the sleep timer is activated, the remaining time appears on the display.

Note

- When the alarm is set to sound during the sleep timer duration, the sleep timer will be deactivated automatically when the alarm sounds.

Setting the brightness of the display

Three levels of brightness are available.

Press **SNOOZE/BRIGHTNESS/ENTER**.

Each time you press **SNOOZE/BRIGHTNESS/ENTER**, the brightness of the display changes as follows:

High (default) → Middle → Low
Off

Tip

- You can also set the brightness of the display to off by pressing and holding **SNOOZE/BRIGHTNESS/ENTER**.

Notes

- When the alarm is sounding or the snooze function is active, the brightness of the display cannot be changed.
- Even if the brightness is set to off, the display lights at a low brightness level when the alarm sounds.

Charging a smartphone

You can charge a smartphone by connecting it to the unit using a USB cable (not supplied).

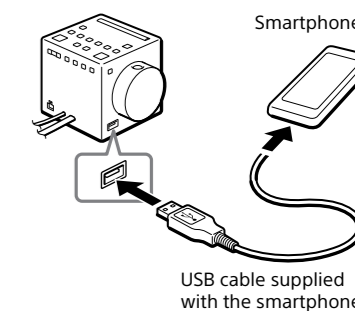

Notes

- There is no guarantee that this unit can be used to charge all products that can be charged via USB.
- This unit does not support power feeds greater than 5 V/1.5 A.
- Check the charge status on the smartphone.
- If a warning tone sounds, remove the smartphone from the unit.
- The reception sensitivity on the radio may worsen when charging a smartphone via USB.

Use the tactile dots on **VOL/SET +** and **TUNING +** and the tactile characters on **3 (NATURE SOUND/PRESET)** and **ALARM RESET/OFF** as a guide when operating the unit.

