

Technical Specifications

55432

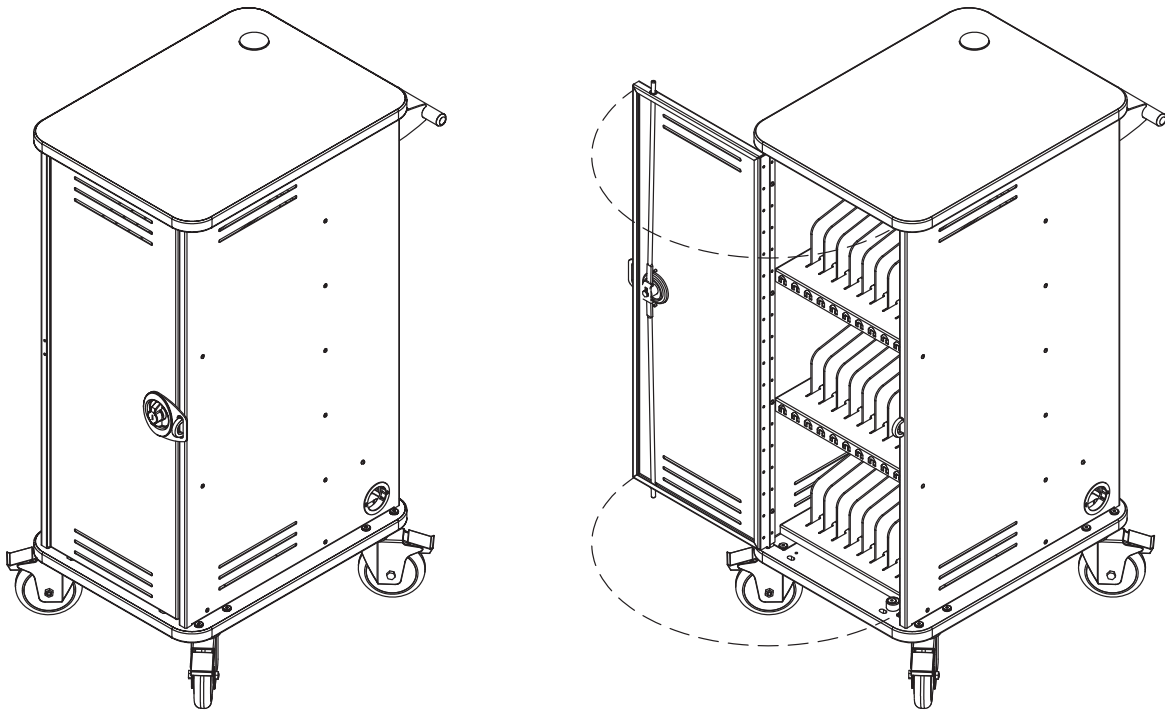

Use the InTouch32 Cart to store and charge up to 32 tablets. The padded shelves and the flexible dividers protect the tablets. Overhead wire management aids the wiring integration, and allows the charging plugs to hang in front of each tablet. The small footprint covers less floor space, and aids in moving the InTouch32 Cart. Also, the handle aids in moving the InTouch32 Cart and is used as a cord wrap. An external switch operates power in the InTouch32 Cart and two external electrical outlets. The InTouch32 Cart is made with powder-coated steel for security and a durable and long-lasting finish. A two-bolt lock on the door and a hasp increases security of the computing device.

Features and Benefits

- Designed for storage and charging of up to 32 tablet computers including iPads® with large cases (up to 1¼" thick)
- Small footprint with inboard casters saves valuable classroom space and allows cart to easily move between student desks
- Access doors provide easy-access to tablet and power-side of cart
- Double-bolt keyed lock, along with a hasp for a padlock, creates a 3-point locking system on both front and rear doors (padlocks not included)
- Tablets and students are separated from all line voltage, wiring, and cords
- Superior overhead cord management system with keeps charge cords organized above each storage slot (tablet power cords should be 3' or longer)
- Ample clearance is provided for easy removal and insertion of tablets
- Durable plastic dividers and padded shelves protect tablets from damage
- One standard handle provides easy maneuverability and doubles as a power cord wrap
- Locking 5" balloon wheel (BW)
- Doors can be flipped to be hinged from the left or right
- Worksurface and side panel grommets placed for effective cord management
- Electrical system consists of UL-listed components
- Two 16-outlet 125V power units with 15-amp breaker and reset button
- Power units have staggered outlet spacing to accommodate a variety of large power plugs
- Junction / power box with a 15-amp breaker, reset button, 15' 3-wire power cord, and externally accessible on/off switch with dual auxilliary outlets for teacher laptop and accessories
- Ventilated doors and side panels keep tablets cool
- Cart is pre-assembled for quick integration and deployment
- Scratch and impact resistant 1¼" high-pressure laminate worksurface and base panel
- Durable powder coated steel chassis provides a long lasting finish
- Warranted to be free of all defects in materials and workmanship with a 10-year warranty
- Electrical system 1-year

Base Options
BW - 5" Balloon Wheels

Options & Accessories
Page 5

Color Options

Standard laminate / color combinations

White Fiesta / Silver Sparkle (WFS) 

Standard color combination refers to the quickest deliverable product color combination. Custom laminates and color combinations are available-additional lead-times and up-charges may apply. Call 1-800-235-1262 for further information.

Construction

- The worksurface and base panel is constructed from 1 1/16" thick NAUF (No Added Urea Formaldehyde) composite board with .030 high-pressure laminate on one face, and a balancing phenolic backer on the opposing face
- 16-gauge steel side panels, and doors
- Worksurface edges are covered with 3mm vinyl
- All metal components are finished with a scratch-resistant powder coat epoxy
- Each InTouch32 Tablet Cart is factory-assembled with balloon wheels, packaged, and shipped on its own skid.
(Handle to be installed by customer).

Specifications

Capacity	32 units
Storage slots	1 1/4"W [3.17 cm] x 13 3/4"D [34.92 cm] (13 1/4"D [33.66cm] at slot directly behind door lock) x 10 3/4"H [27.31 cm]
Electrical	The InTouch32 Cart has two 16-outlet 12-amp, 125 volt, 60Hz power units, each containing a 15-amp breaker. They are hard-wired to a junction / power box with a 15-amp breaker, reset button, 15' 3-wire power cord, and externally accessible on/off switch and dual auxilliary outlets. The on/off switch controls <u>all</u> outlets (external auxilliary outlets are only "hot" when switched on). Power unit outlets are separated from the tablets and accessible from the back (power-side) of the unit via locking door. UL listed components.
5" Balloon Wheels	weight capacity 325 lbs each
Unit weight (nominal)	127 lbs
Shipping weight (nominal)	162 lbs
Meets or exceeds applicable ANSI-BIFMA test standards	

Specifications subject to change without notice

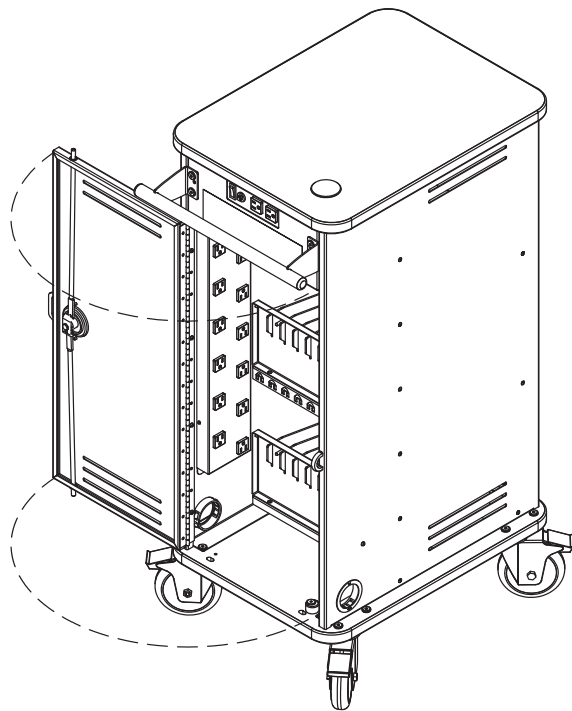

nominal outlet spacing on each 16-outlet power unit

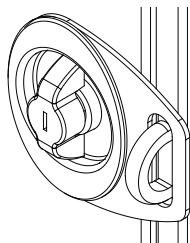
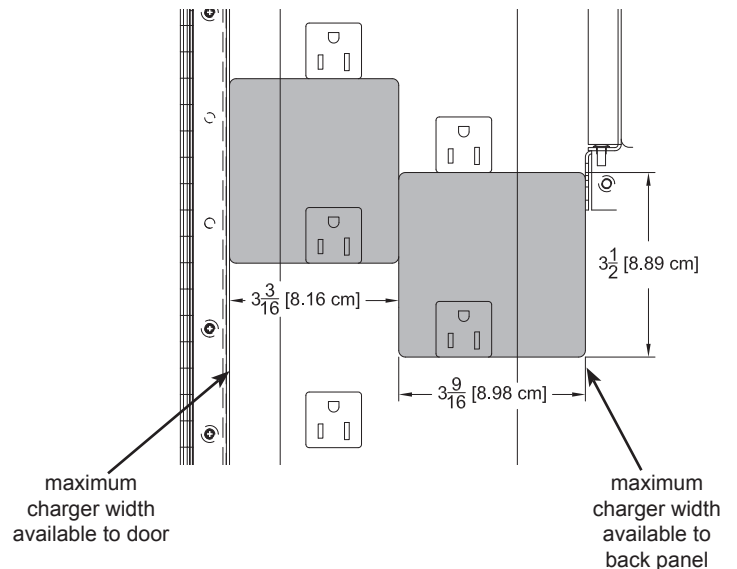

double-bolt lock with hasp for padlock (on both doors) (padlock not included)

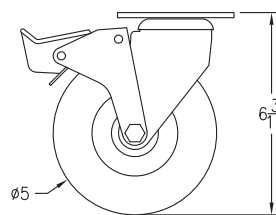

5" balloon wheel (BW)

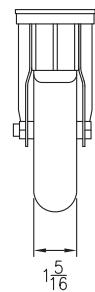

1 5/16"

InTouch32 Tablet Cart

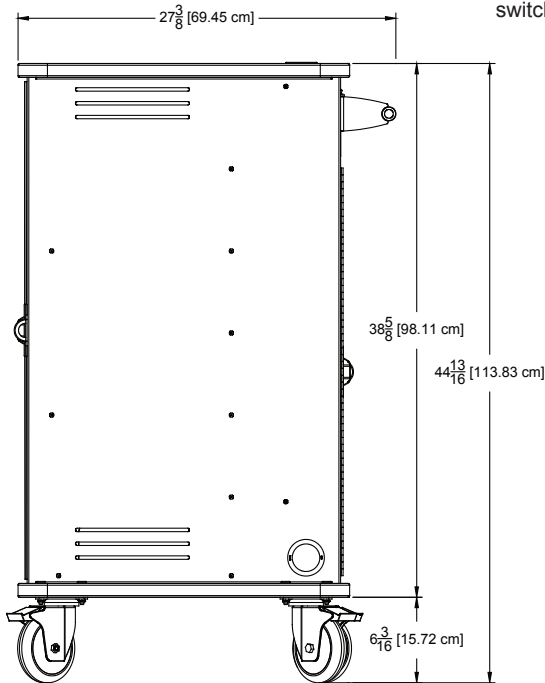
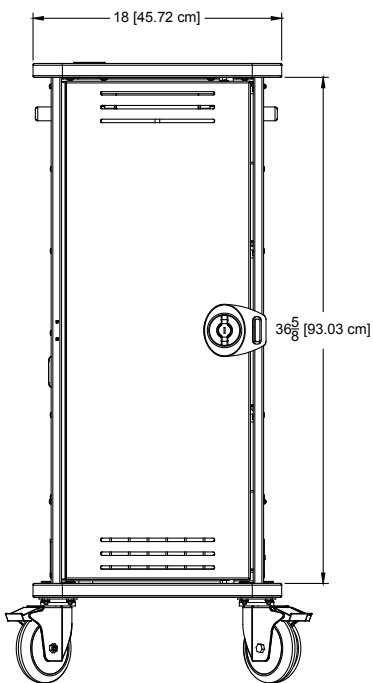
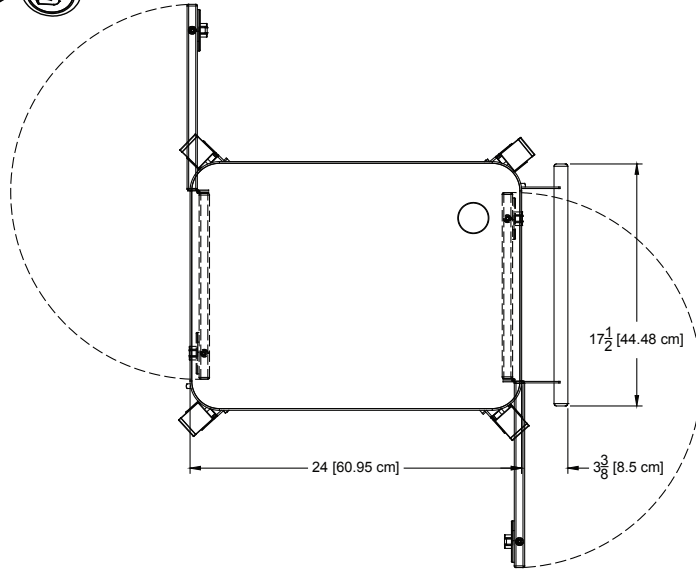
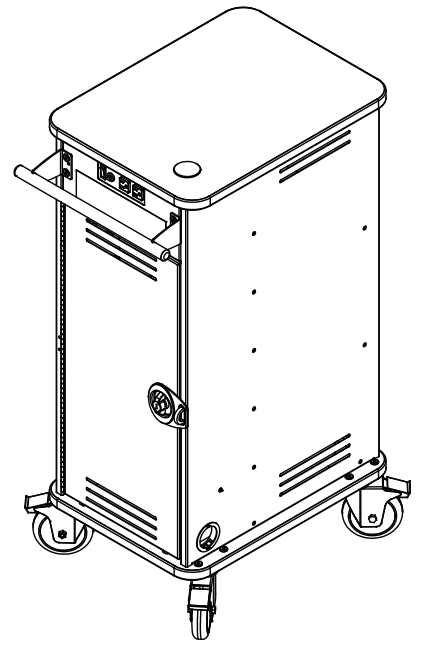
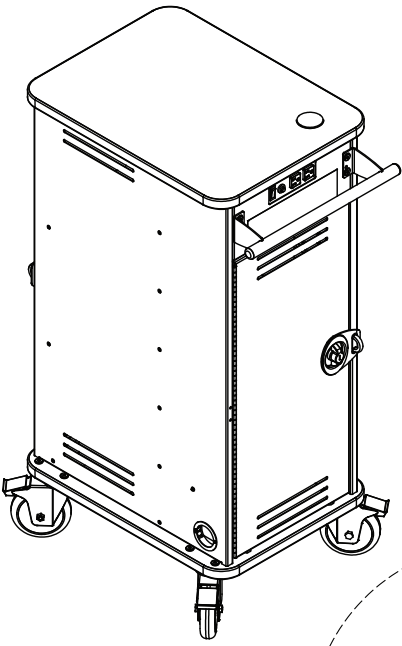

external power switch and 2 AUX outlets

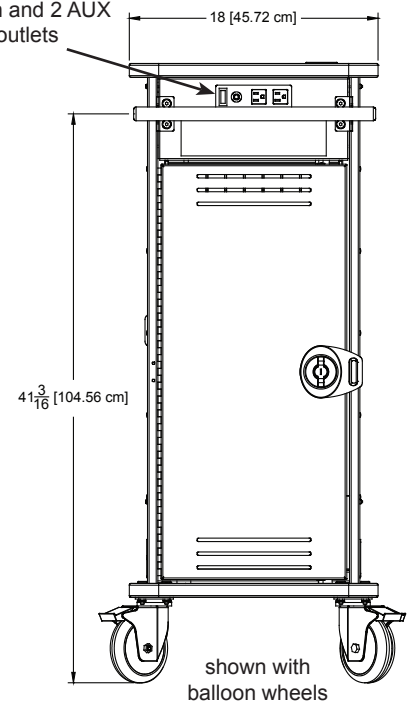

section view

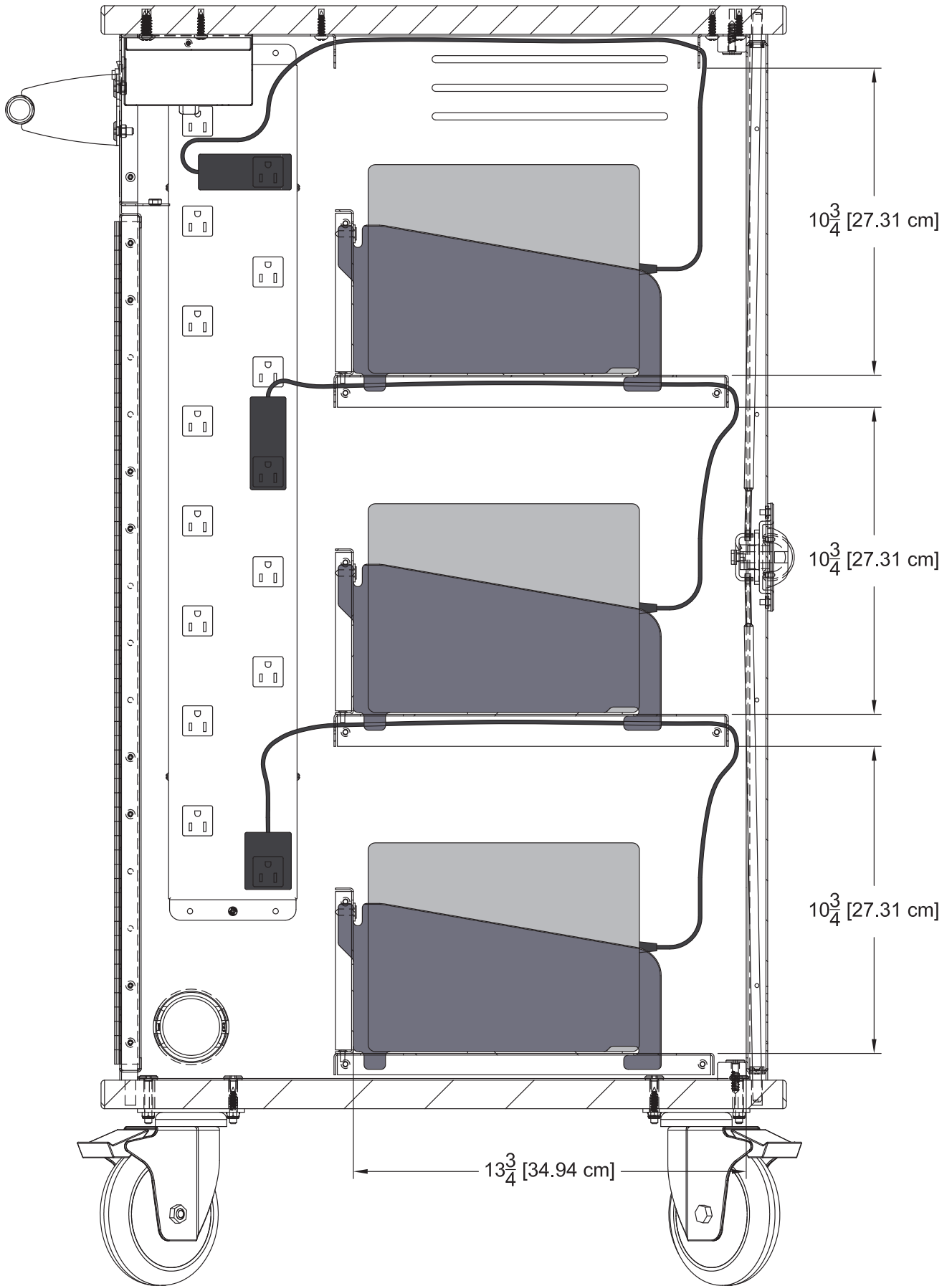

student-side view

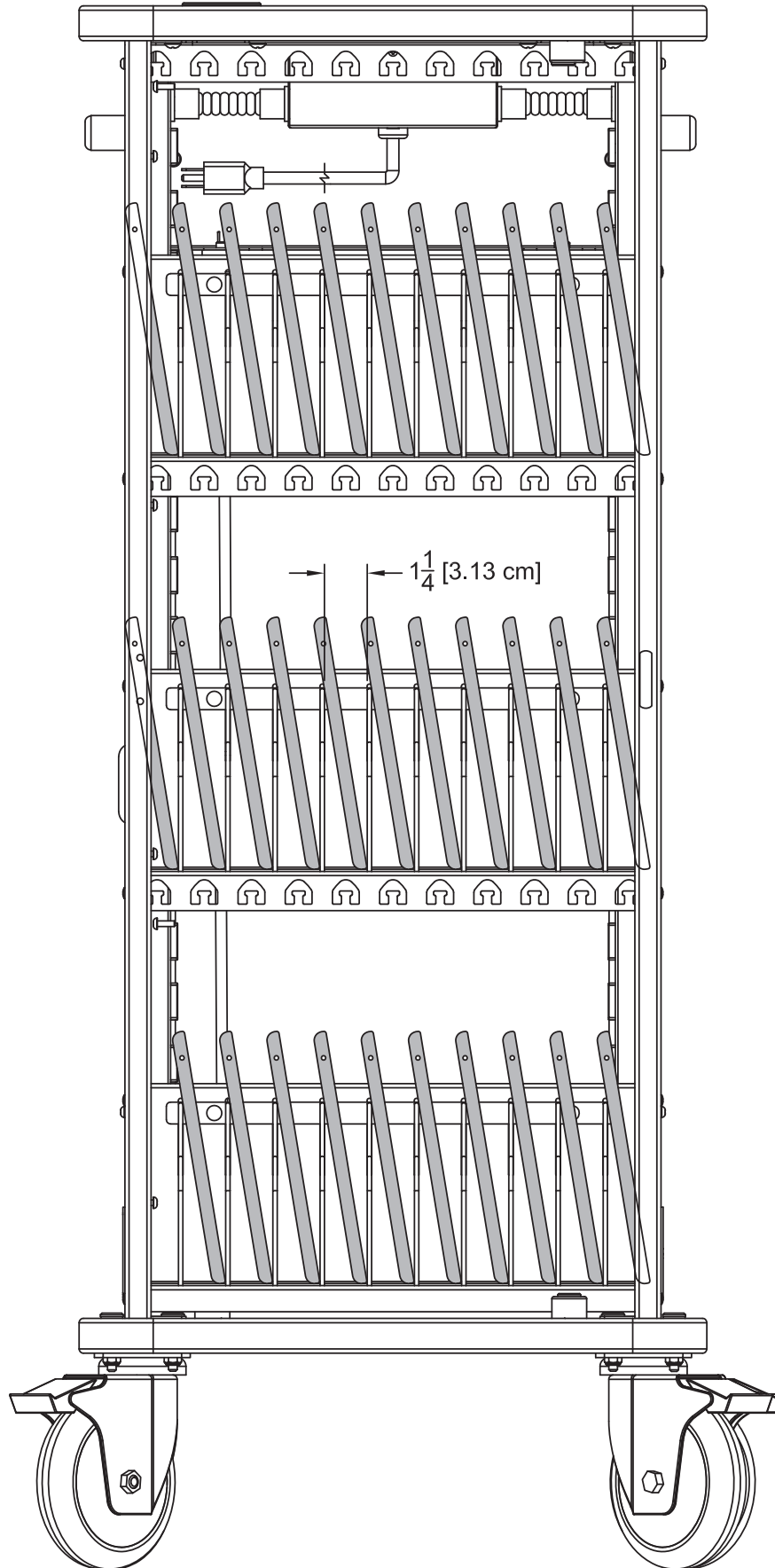

Options



Velcro® strap kit
(16) 3/4" x 12", and (32) 3/4" x 5"
Velcro® straps
95004

Warranty

WE WILL MAKE IT RIGHT FOR YOU!

Spectrum is committed to provide complete customer satisfaction. Each of our products is manufactured from the best materials available and each product is stringently monitored throughout the production process through our P.A.C.E. program (Product Assurance to meet Customer Expectations).

We expressly warrant that Spectrum products will be of good quality and workmanship and free from defect for the period set out in the warranty table below from the date of delivery. This warranty shall not apply to defects or damage resulting from misuse, abuse, neglect, improper care, modification or repair not authorized by Spectrum, or any other cause outside the control of Spectrum. Spectrum will, at its sole option, either repair or replace the defective product.

This warranty is exclusive; no other warranty, written or oral, is expressed or implied. This warranty is given by Spectrum to Buyer and to no other person or legal entity. No Spectrum dealer, distributor, agent or employee is authorized to make any modification or addition to this warranty.

NOTWITHSTANDING ANYTHING TO THE CONTRARY, SPECTRUM WILL NOT UNDER ANY CIRCUMSTANCES BE LIABLE FOR INDIRECT OR LIQUIDATED DAMAGES, INCLUDING CONSEQUENTIAL, INCIDENTAL AND SPECIAL DAMAGES. IN NO EVENT SHALL SPECTRUM'S LIABILITY, WHETHER UNDER CONTRACT OR WARRANTY, IN TORT OR OTHERWISE, EXCEED THE PURCHASE PRICE RECEIVED BY SPECTRUM FOR THE PRODUCT AT ISSUE AND "RECALL ACTION" EXPENSES. SPECTRUM SHALL NOT BE SUBJECT TO ANY OTHER OBLIGATIONS OR LIABILITIES, WHETHER ARISING OUT OF BREACH OF CONTRACT, WARRANTY, TORT (INCLUDING NEGLIGENCE AND STRICT LIABILITY) OR OTHER THEORIES OF LAW, WITH RESPECT TO PRODUCTS SOLD OR SERVICES RENDERED BY SPECTRUM, OR ANY UNDERTAKINGS, ACTS OR OMISSIONS RELATING THERETO.

Our Customer Service Department is ready to provide immediate attention to any questions, comments or concerns. They are available to answer your calls Monday through Friday from 7 am to 5 pm CST. In addition your product comments or concerns are welcome via e-mail at: spectrum@spectrumfurniture.com.

Warranty Table

Item	Warranty Period
• Adjustable Crank/Electric Desk Legs	• 1 Year
• Flat Panel Desk Gas Cylinders	
• Adjustable Height Chair Parts – including frames, gas cylinders, wood and plastic parts, and control handles Adjustable Height Chair Parts Casters	• 7 Years
• Adjustable Height Chair Upholstery	• 2 Years
• In-Stock Upholstery	• 2 Years
• Graded-In Fabrics and Customer Owned Material	• No Warranty
• Height Adjustable Columns and Lifts	• 1 Year
• General Use Casters	
• Electrical	
• Keyboard/Mouse Trays	
• Flat Panel Monitor Arm – General Parts	• 5 Years
• Flat Panel Monitor Arm – Gas Cylinders	• 2 Years
• Computer Desk Chassis	• 10 Years
• Cart Chassis	
• Lectern Chassis	

