

Smart WiFi Outdoor Security Camera



USER MANUAL
Model: ASHBC01F

Thank you for purchasing the Smart WiFi Outdoor Security Camera. We are excited in being a part of making your life easier, safer and bringing peace of mind into your homes.

What's in the package?

- 1 Camera
- 6 Alkaline Batteries
- 1 User Manual
- 2 Screws
- 2 plastic Housing

Let's Get Started!

(please refer to the numbered Parts Guide below)

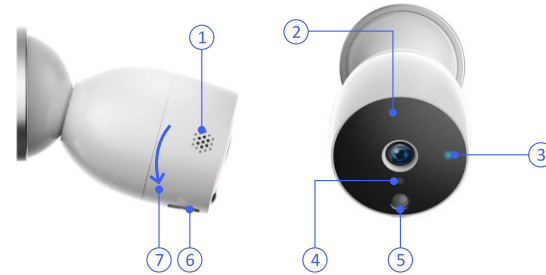

1

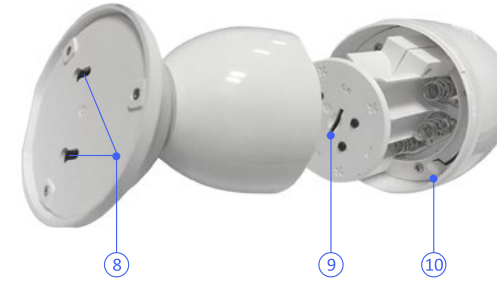

1. **Speaker**
2. **Microphone**
3. **Indicator light:**

Quick Flashing Red Light: Smart configuration mode
Slow Blinking Red Light: AP mode, awaiting WiFi
Flashing Red and Green Light: Failed to connect network
Quick Flashing Green Light: Connecting to WiFi
Solid Green Light: Operating mode
Slow Blinking Green Light: Internet connecting and binding
Solid Red Light: Camera Network is abnormal
Solid Orange Light: Updating Firmware
Light is off: Power saving mode

2

4. **Light Sensor**
5. **Motion Sensor**
6. **Micro USB Port:** To power the camera via USB
7. **Alkaline Battery Box:** Turn this part counter clockwise to insert the alkaline batteries
8. **Camera Base:** The Package comes with 2 screws for wall mounting.
9. **SD Slot**
10. **Reset Button**

WiFi Requirement

The smart home device only supports 2.4Ghz frequency. If your router supports both the 2.4Ghz and 5Ghz frequency, the 5G network is usually labeled as "Router-5G" so please connect to the other one.

3

Install Alkaine Batteries into your Camera

1. Open the camera back cover.
2. Install the 6 pcs alkaline batteries into your Camera, Position the negative pole in between the 2 positive poles of the alkaline batteries. Follow this position on both opposite ends of the battery box.

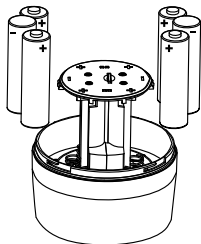

Make sure you have the right positioning of the battery according to the correct polarity as instructed.

Position your camera to optimize its field of view with your Security Camera. In the following images, the green areas show your camera's field of view, both horizontally and vertically.

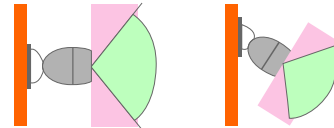

Mount your camera on an elevation of at least 7 feet above the floor or ground area. Tilt and aim it slightly downwards for best motion sensor performance.

Motion Sensor on the Security Camera is more sensitive to a side-by-side movement across its field-of-view than direct movements to and from the camera. Motion detection is at best from 5ft-15ft from the cameras position.

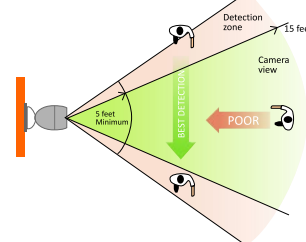

5

Connect Device to Application

- Each smart home device can only be registered to one account but it can be shared with others by using the sharing function of the app.

1. Download the free eco4life app from the Apple App store or Google Play store
2. Follow the on screen instructions to create account for eco4life
3. Insert batteries into the Outdoor Security Camera
4. Press the "+" icon in the top right corner of the app

6

5. Press the "Battery camera" icon from the list

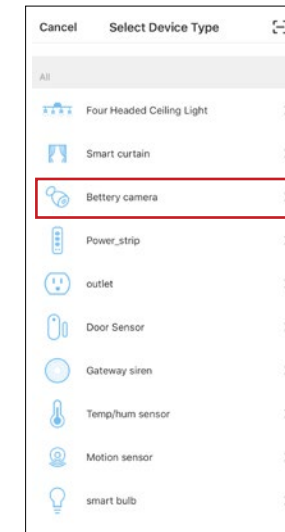

6. Follow the instructions in the app to connect the device

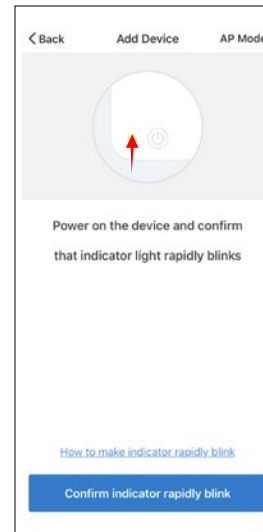

7

Choose a good spot for your camera

Mount and position your Security Camera in a location with a clear, unblocked field of view and good WiFi signal from the wireless router

4