

PACKAGE CONTENTS

Earbuds, amount: 1

Charging cable, amount: 1

User manual, amount: 1

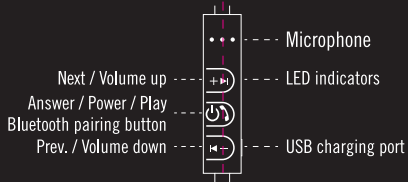

CHARGING THE BATTERY

- Before charging the device, please turn it off first.
- Connect the supplied charging cable to the charge input and a USB port on your computer or USB charger.

The red LED is lit during charging.

When the battery is fully charged, the red LED is turned off.

It can take up to 2 hours for an empty battery to be fully charged.

POWERING THE DEVICE ON AND OFF

- To power On or Off, press and hold the MF/Call button for 3 seconds.

PAIRING THE EARBUDS WITH A BLUETOOTH DEVICE

- Power the earbuds on.
- Press the MF/call button to power the earbuds on.

The blue LED and red LED starts blinking.

The earbuds are now detectable by other Bluetooth devices.

- **On your device, search for Bluetooth devices.**

Refer to your tablet user manual if needed.

- **On your device, select the earbuds.**

The blue LED starts to glow, indicating successful pairing.

HANDSFREE

- **Power the speaker on.**
- **Pair the speaker with Bluetooth to your device.**
- **Press MF/call button once to answer.**

VOLUME AND TRACK SELECTION

- **Press volume up or down to adjust volume.**
- **Hold volume up or down to adjust track.**

STREETZ

MANUAL

HL-573

HL-574

HL-575