



SU10F70 SERIES

Vacuum Cleaner user manual

- * Please read the User Manual thoroughly before operating the vacuum.
- * For indoor use only.

English

imagine the possibilities

Thank you for purchasing a Samsung product.

SAMSUNG

Contents

YOUR VACUUM CLEANER

07

- 07 Product view
- 08 Carton contents

BEFORE USING THE VACUUM CLEANER

09

- 09 Assemble the handy vacuum, pipe, and 2 in 1 accessory
- 10 Using the accessories

OPERATING CLEANER

11

- 11 Stowing the power cord
- 12 Operating the On / Off switch
- 13 Operating the Brush bar On / Off switch
- 13 Resetting the overload protector
- 14 Using the vacuum's handle (The dust bin handle)
- 14 Using the accessory kit (optional)

MAINTENANCE

17

- 17 Emptying the dust bin
- 18 Cleaning the grille
- 19 Cleaning the premotor filter
- 21 Cleaning the filter
- 23 Checking the brush
- 24 Checking for clogs
- 25 Emptying the dust bin of the handy vacuum cleaner
- 26 Cleaning the filter of the handy vacuum cleaner

TROUBLESHOOTING

28



Safety information

SAFETY INFORMATION



 **WARNING** Before operating the appliance, please read this manual thoroughly and retain it for your reference.

 **WARNING** Because the following operating instructions cover various models, the characteristics of your vacuum cleaner may differ slightly from those described in this manual.

CAUTION/WARNING SYMBOLS USED

 WARNING	Indicates that a risk of death or serious injury exists.
 CAUTION	Indicates that a risk of personal injury or material damage exists.

OTHER SYMBOLS USED

	Indicates something you must NOT do.
	Indicates instructions you must follow.
	Indicates that you must disconnect the power plug from the socket.

 **WARNING** This vacuum cleaner is designed for household use only.
Do not use this vacuum cleaner to clean building waste or debris.
Clean the filters regularly to prevent fine dust from collecting in them.
Do not use this vacuum cleaner with any of the filters removed.
Failure to meet these requirements could cause injury, damage the vacuum cleaner, and void your warranty.

Notes on the energy label

- Declared energy efficiency and cleaning performance class on carpet can be met with the motorized brush.
- When the hard floor has joints and gaps, please use the enclosed "Eco Hard Floor" brush with "Pipe (Connector for Eco Hard Floor)" which are designed to meet the energy efficiency and cleaning performance class on hard floor with joints and gaps.
- The values provided on the energy label have been determined according to the prescribed measuring process (in accordance with EN60312 - 1).

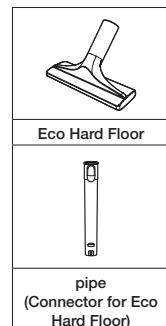

Safety information

IMPORTANT SAFETY INSTRUCTIONS

When using an electrical appliance, you should always follow these basic precautions:

READ ALL INSTRUCTIONS BEFORE USING YOUR UPRIGHT VACCUUM

WARNING – TO REDUCE THE RISK OF FIRE, ELECTRIC SHOCK, OR INJURY:

1. Do not leave the vacuum cleaner unattended when it is plugged in. Unplug it from the outlet when you are not using it and before servicing.
2. Do not use outdoors or on wet surfaces.
3. Do not allow the vacuum to be used as a toy. Pay close attention when the vacuum is used by or near children.
4. Use only as described in this manual. Use only the manufacturer's recommended attachments.
5. Do not use with a damaged cord or plug. If the vacuum is not working as it should, has been dropped, damaged, left outdoors, or dropped into water, bring it to a service center.
6. Do not pull or carry the vacuum by the cord, use the cord as a handle, close a door on the cord, or pull the cord around sharp edges or corners. Do not run the vacuum over the cord. Keep the cord away from heated surfaces.
7. Do not unplug by pulling on the cord. To unplug, grasp the plug, not the cord.
8. Do not handle the plug or vacuum with wet hands.

9. Do not put any object into openings or vents.
Do not use with any opening blocked.
Keep free of dust, lint, hair, and anything that may reduce air flow.
10. Keep hair, loose clothing, fingers, and all parts of your body away from openings and moving parts.
11. Turn off all controls before unplugging.
12. Use extra care when cleaning on stairs.
13. Do not use to pick up flammable or combustible liquids, such as gasoline, or use in areas where they may be present.
14. Do not pick up anything that is burning or smoking, such as cigarettes, matches, or hot ashes.
15. Do not use without the dirt cup and/or filters in place.
16. Do not use the vacuum cleaner in an enclosed space filled with vapors given off by oil base paint, paint thinner, some moth proofing substances, flammable dust, or other explosive or toxic materials.
17. Store your vacuum cleaner indoors, in a cool and dry area.
18. Use only on dry, indoor surfaces.
19. Do not modify the polarized plug to fit a non-polarized outlet or extension cord.
20. Do not touch the brush drum when it is rotating.
21. Keep suction away from your face when using nozzles and pipe.
22. Do not pull the power cord around sharp corners and do not allow it to become trapped.
23. This appliance can be used by children aged from 8 years and above and persons with reduced physical, sensory or mental capabilities or lack of experience and knowledge if they have been given supervision or instruction concerning use of the appliance in a safe way and understand the hazards involved.
Children shall not play with the appliance.
Cleaning and user maintenance shall not be made by children without supervision.
24. Children should be supervised to ensure that they do not play with the vacuum.
25. You must remove the plug from the socket-outlet before cleaning or performing maintenance on the vacuum.

26. If the power cord is damaged, it must be replaced by the manufacturer or its service agent or a similarly qualified person.
27. Hold plug when rewinding onto cord reel.
Do not allow plug to whip when rewinding.
28. Do not pick up hard or sharp objects such as glass, nails, screws, coins, etc.
29. Always turn off the vacuum before connecting or disconnecting the handy vacuum cleaner.
30. Don't touch the exhaust vent when the exhaust temperature is hot.

Your vacuum cleaner

PRODUCT VIEW

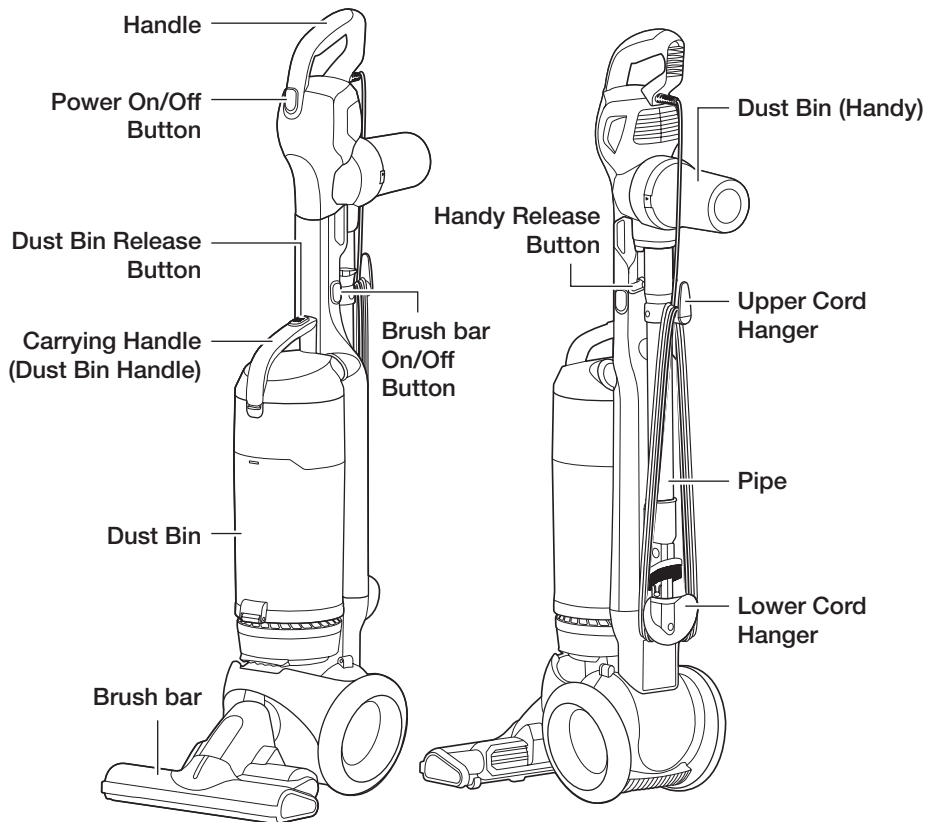

Do not plug in your vacuum cleaner until you are familiar with all instructions and operating procedures.



Plastic film can be dangerous.
To avoid the danger of suffocation, keep the film away from babies and children.

CARTON CONTENTS

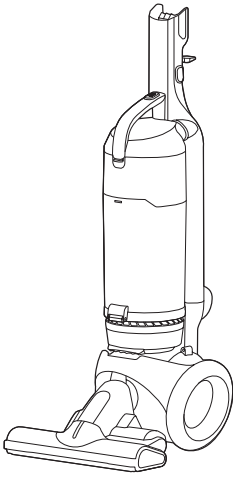

(1)

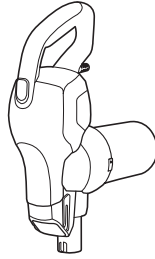

(2)



(3)



(4)



(5)



(6)

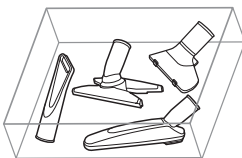

(5)



(6)

- Empty carton. Find the parts shown above before disposing of packing materials.
- 1. Vacuum cleaner body
- 2. Handy Vacuum cleaner
- 3. Pipe
- 4. 2 In 1 Accessory
- 5. Eco Hard Floor(Optional depending on the model)
- 6. Pipe (Connector for Eco Hard Floor) (Optional depending on the model)
- 7. Accessory Kit (Optional depending on the model)
- 8. Users Manual

Before using the vacuum cleaner

ASSEMBLE THE HANDY VACUUM, PIPE, AND 2 IN 1 ACCESSORY

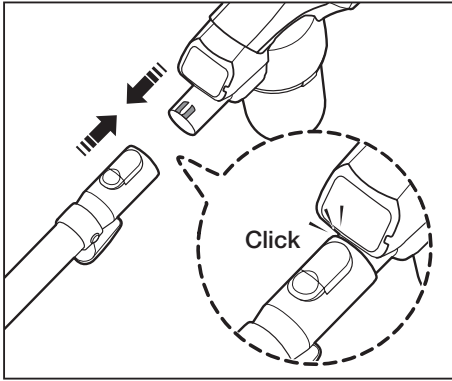

- Connect the Handy Vacuum cleaner and pipe.

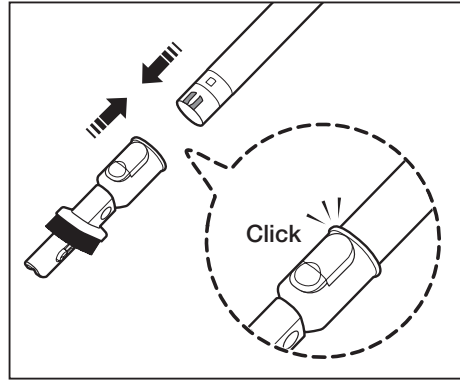

- Connect the 2 In 1 Accessory and the pipe.

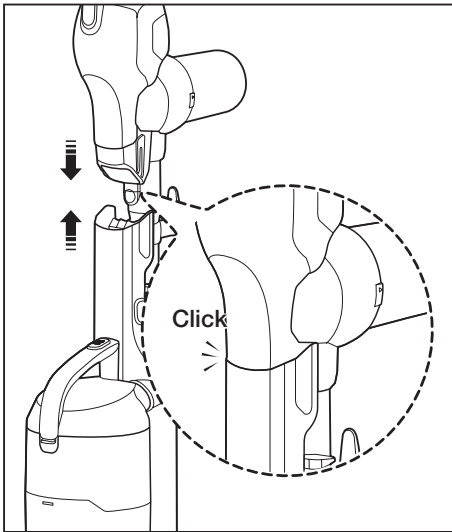

- When inserting the handle (the handy vacuum cleaner) into the top of vacuum body, put in the hole of the lower cord hanger after pull back the dusting brush.

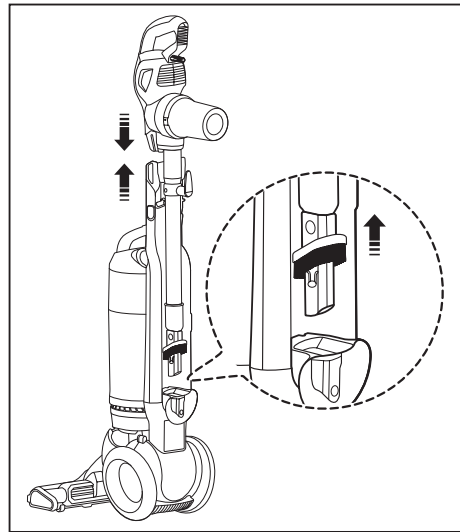

- Wind the cord around the cord hangers and secure with clip.

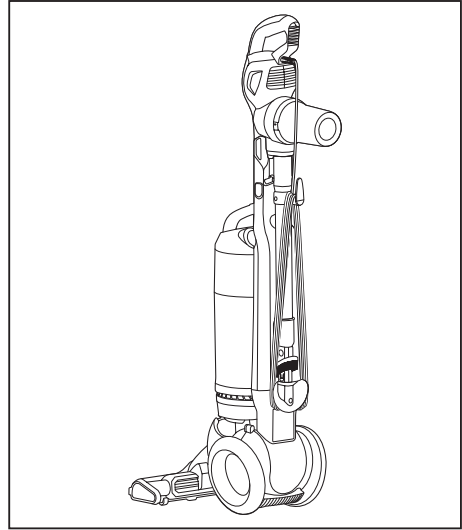

USING THE ACCESSORIES

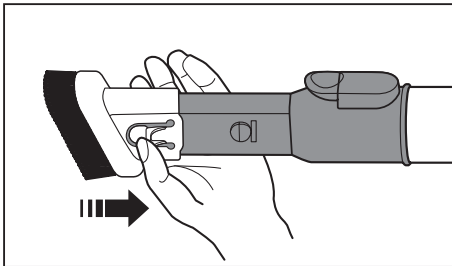

- Crevice tool

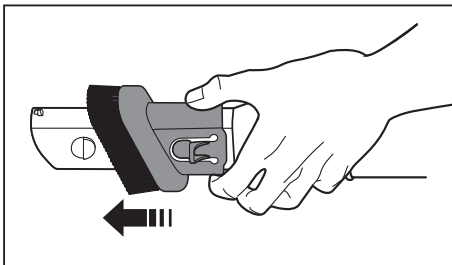
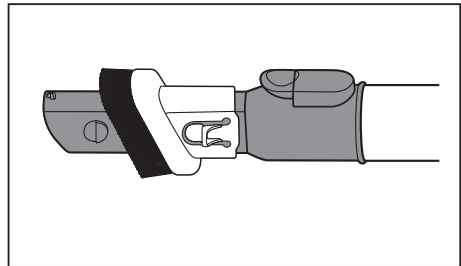

- Dusting Brush

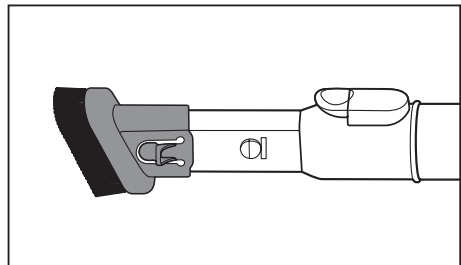

Operating cleaner

STOWING THE POWER CORD

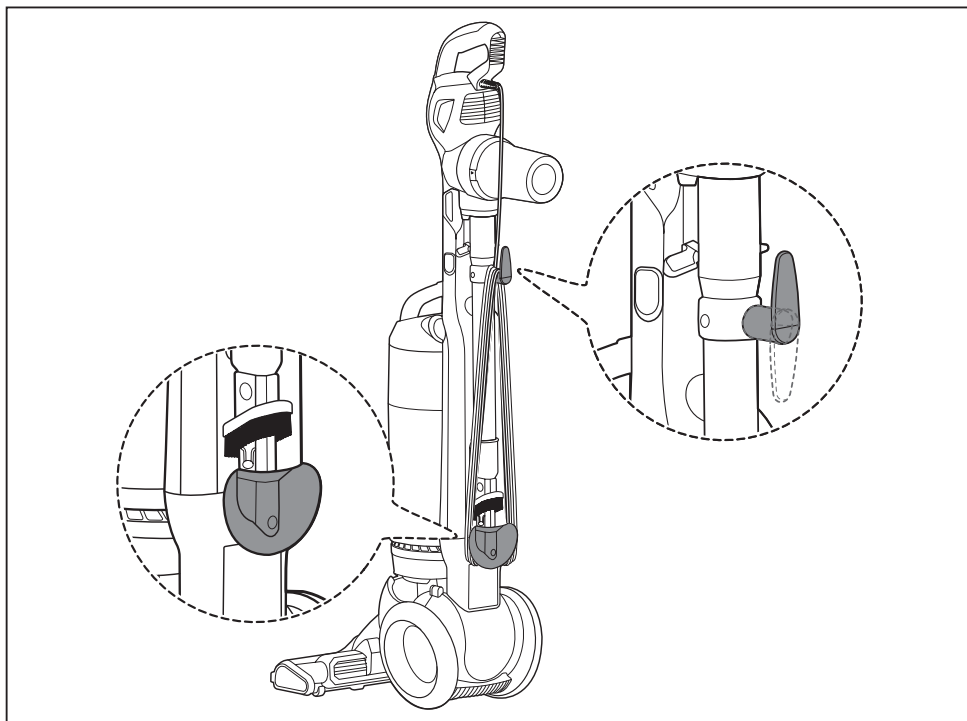

When removing the plug from an electrical outlet, grasp the plug, not the cord.

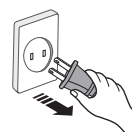

OPERATING THE ON / OFF SWITCH

Handy vacuum cleaner mode

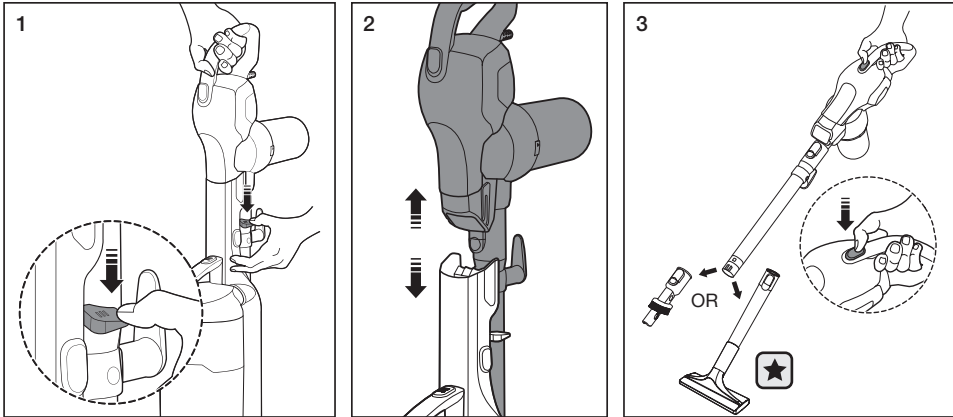

- Push the release button, and then separate the handy vacuum cleaner from the body.
 - Push the power On/Off switch.
- ★ "Eco Hard Floor" brush and Pipe(Connector for Eco Hard Floor) should be connected to the tip of Pipe, not the end of handle.

Upright mode

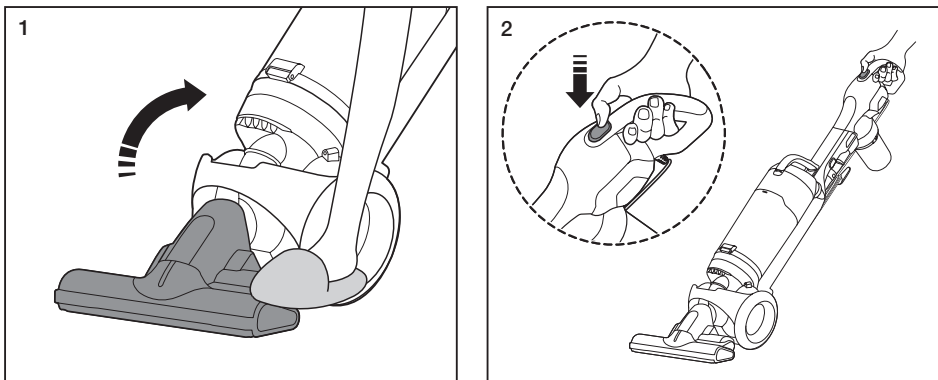

- Place a foot on the brush, and then tilt the handle back gently to release the lock.
- Push the power On/Off switch.

OPERATING THE BRUSH BAR ON / OFF SWITCH

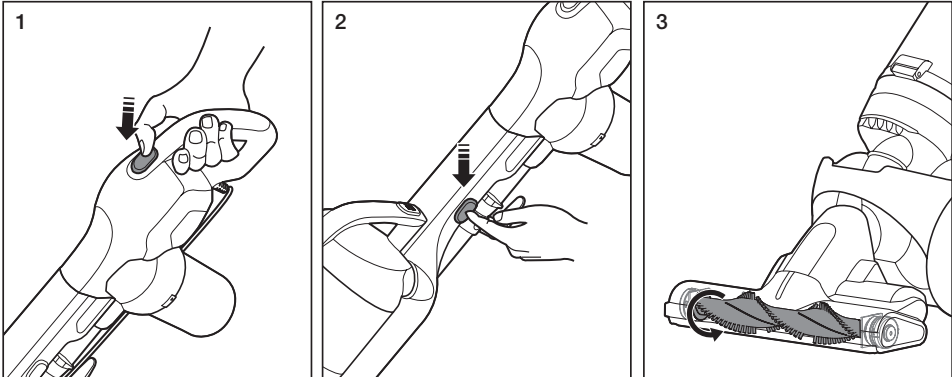

- Push the power On/Off switch, and then push the brush bar On/Off switch.
- The Brush Switch should be in the "On" position for normal carpet cleaning.
- Turn the Brush Switch "Off" for bare floor cleaning or other delicate surfaces.



When the vacuum is in the upright position, the brush bar does not work.

RESETTING THE OVERLOAD PROTECTOR

- The overload protector shuts off the brush motor if the brush bar becomes obstructed.
To reset the overload protector, use a pen tip to press the reset switch.

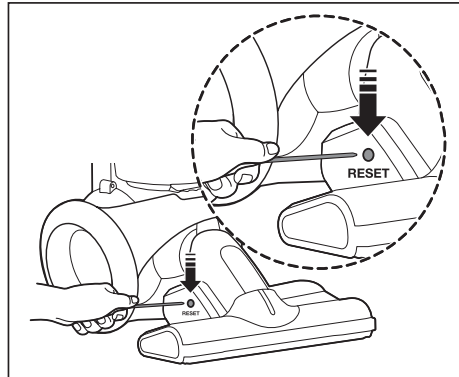

USING THE VACUUM'S HANDLE (THE DUST BIN HANDLE)

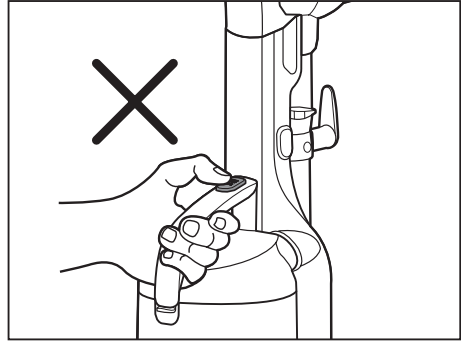
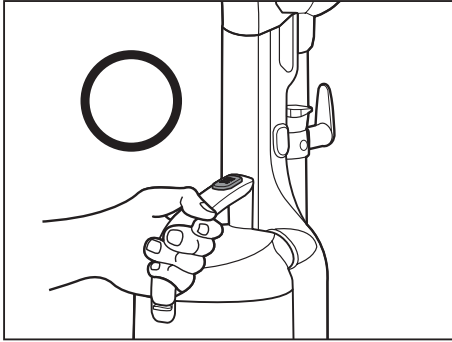

When you carry the vacuum cleaner by the handle, do not push the dust bin release button.

USING THE ACCESSORY KIT (OPTIONAL)

Furniture tool

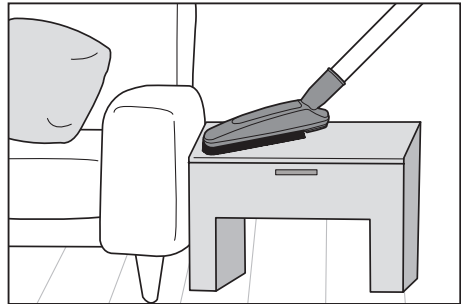
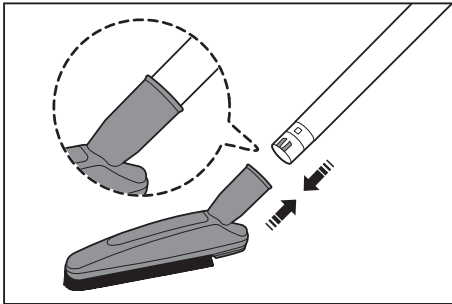

Window tool

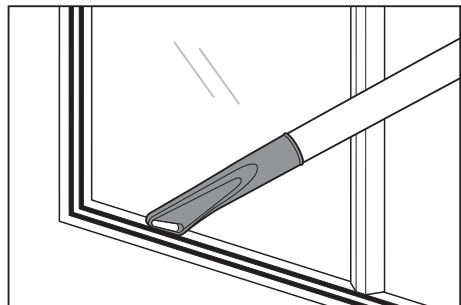
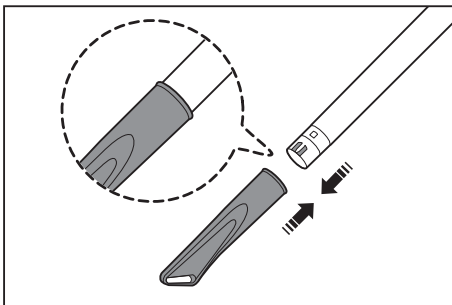

Multiple Angle Stair Tool

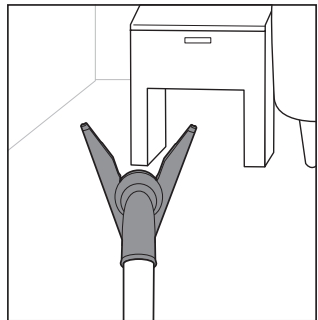
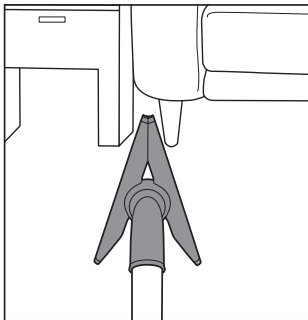
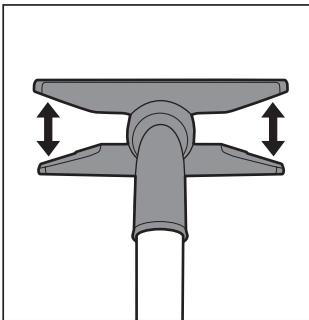
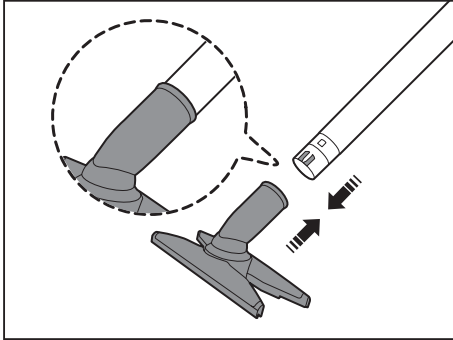

- Cleaning a narrow corner.

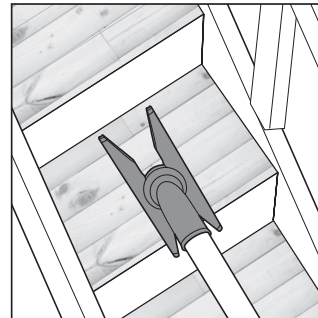
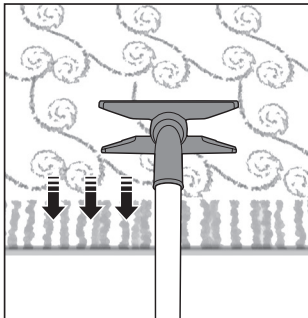
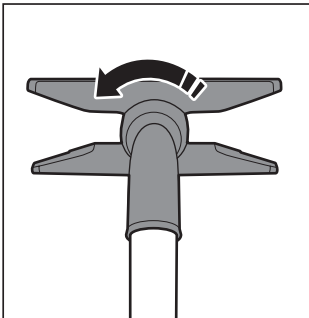

- Cleaning a carpet and stairs.

- Adjust the multiple angle tool manually.
You can rotate the entire tool 90 degrees and change the angle of both wings.

Pet Tool

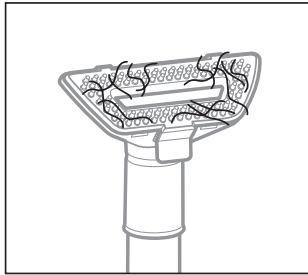
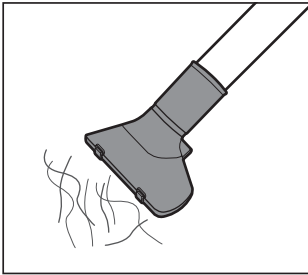
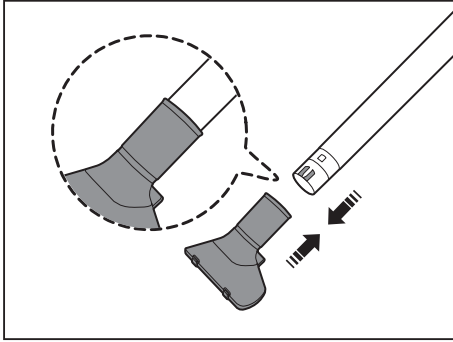

- Rake the hair.

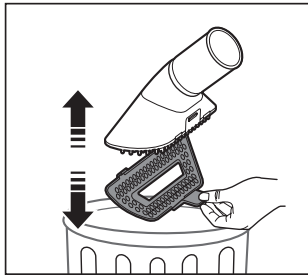
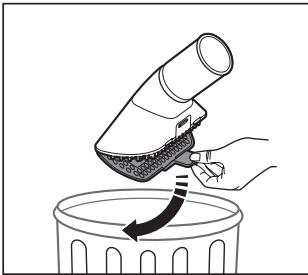

- Separate the cover from the pet tool, and then throw the hair away.

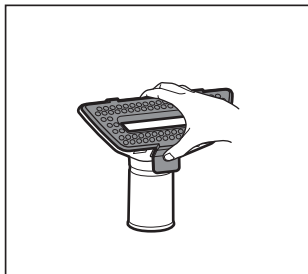
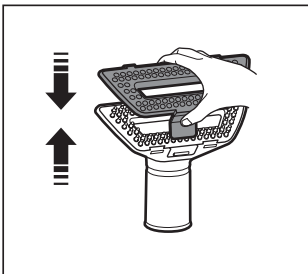

- Re-attach the cover.

Maintenance

EMPTYING THE DUST BIN

- Empty the dust bin when dust reaches the 'MAX' mark.
- Take the dust bin out by pushing the button on the handle.

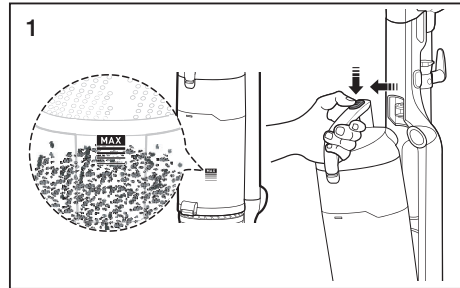

- To empty the dust bin, hold the dust bin over a garbage can, and then push the button near the bottom of the bin.

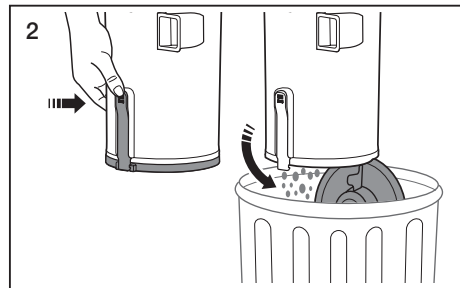

Alternately, for asthma or allergy sufferers:

- To empty the dust bin, place the bottom of the bin into a plastic bag as shown. Holding the bag firmly, push the button near the bottom of the bin.

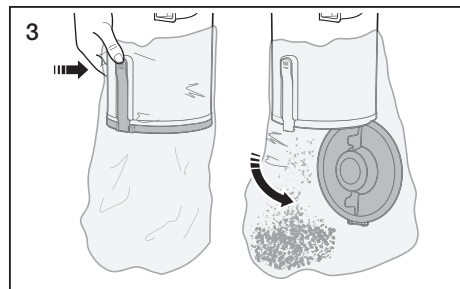

- With the bin still in the plastic bag, close the bottom of the bin. Remove the bin from the plastic bag, seal the bag, and then drop it in the trash can.

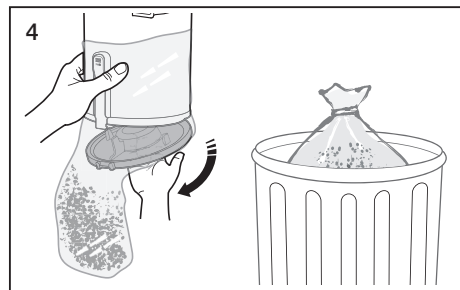

CLEANING THE GRILLE

- Push the button.
Separate the dust bin from the vacuum's body.
- Clean the grille with the dusting brush to remove lint.
- To re-attach the dust bin to the vacuum's body, follow steps 3 and 4.

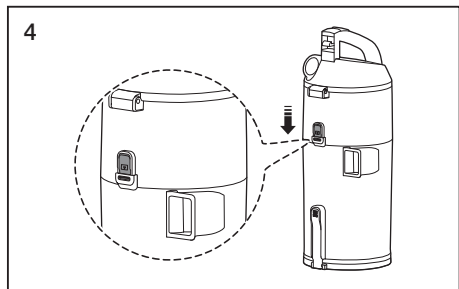
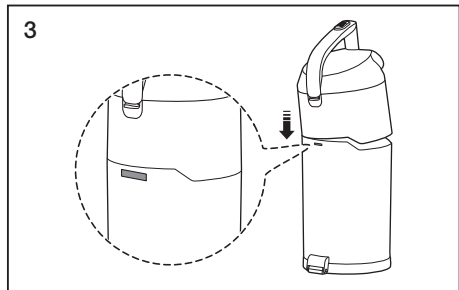
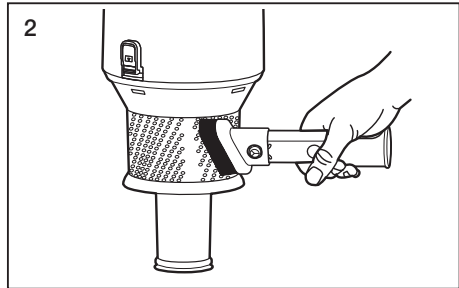
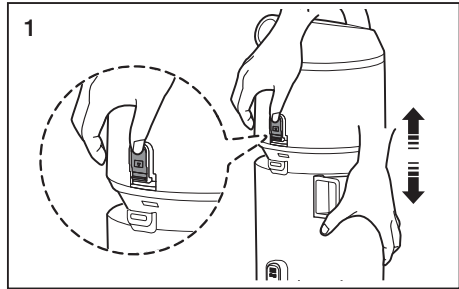

CLEANING THE PREMOTOR FILTER



- Pull the dust bin cover to open.

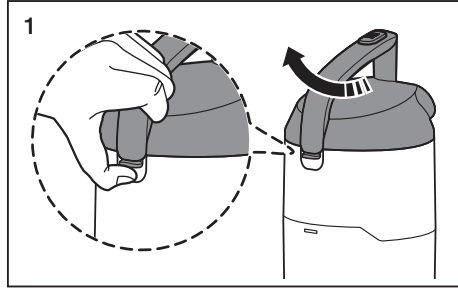

- Remove the filter from the dust bin.

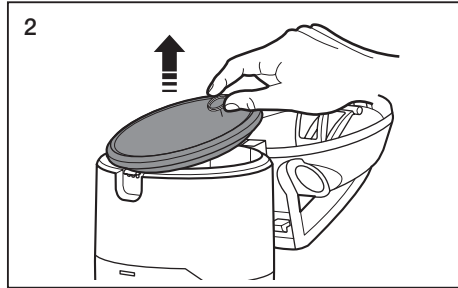

- Shake the filter to remove dust, and then wash the filter.

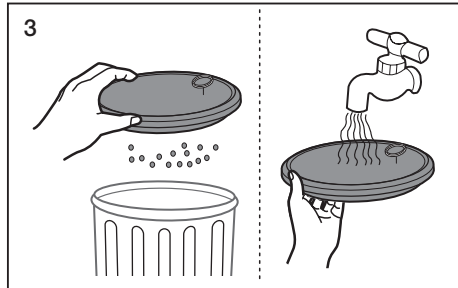

- Leave the filter in the shade until completely dry.

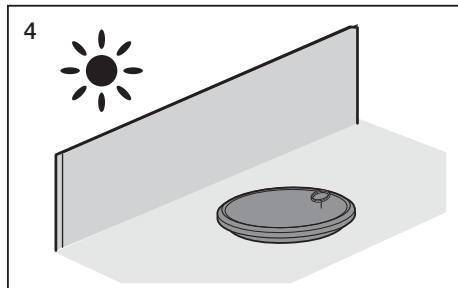

- Put the filter into the dust bin.

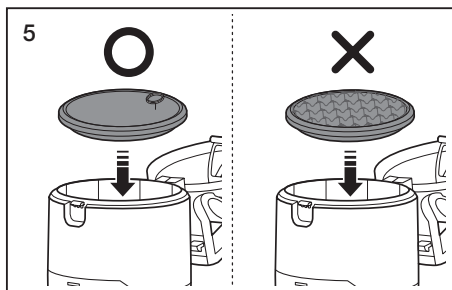

Check the filter regularly and wash every 1~2 months.
Make sure the filter is completely dry before putting it back into the vacuum cleaner.
Allow it to dry for 12 hours.
Do not use a wet filter
Replace the dust filter if it becomes damaged or deformed.
The dust bin cover will not close if the filter is not installed correctly.



CLEANING THE FILTER

- Take the dust bin out by pushing button on the handle.

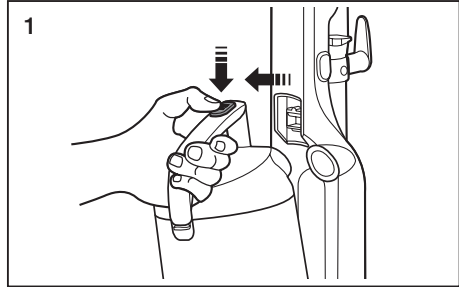

- Remove the filter cover.

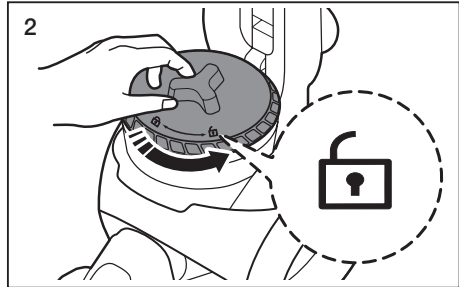

- Separate the filter from the vacuum's body.

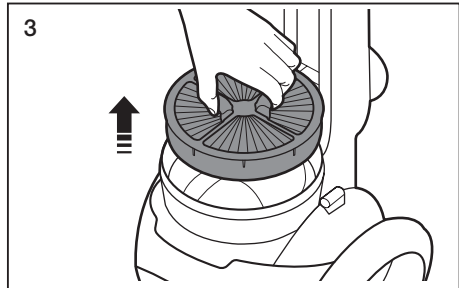

- Shake the filter to remove dust.

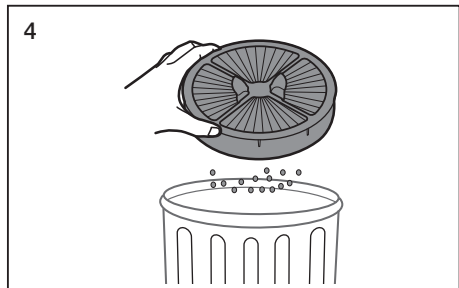

Clean the filter when suction is noticeably and continuously reduced or the vacuum cleaner overheats abnormally.

Note: Filters are not washable.

Replace the filter if cleaning does not resolve the problem.

- Re-insert the filter into the vacuum's body.

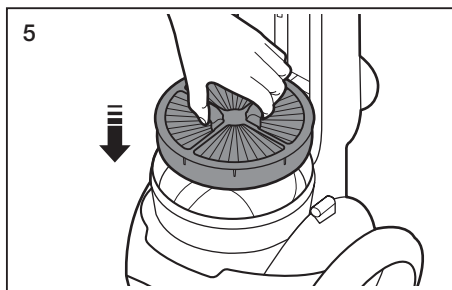

- Re-assemble the filter and filter cover.

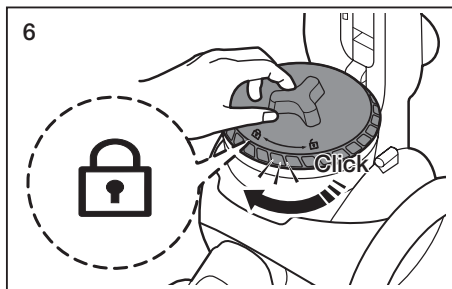

- Re-attach the dust bin to the vacuum.

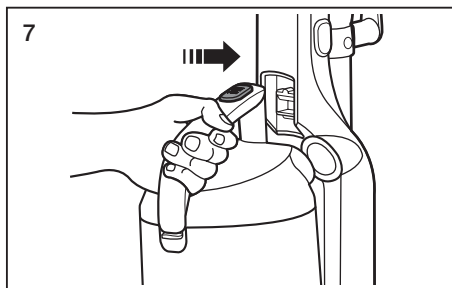

The dust bin will not re-attach to the vacuum if the filter cover is not installed correctly.

CHECKING THE BRUSH

- Turn off and unplug the vacuum.
Lie the vacuum down so its bottom is accessible as shown.

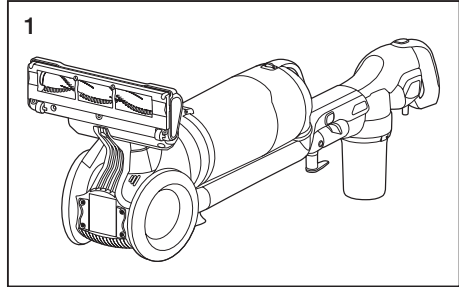

- Carefully cut off any hair or string caught in the brush.

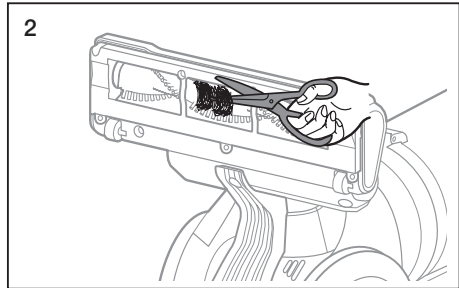

Before inspecting the brush bar, turn off the brush bar and unplug the vacuum.

CHECKING FOR CLOGS



- Place a foot on the brush, and then tilt the handle back gently to release the lock.

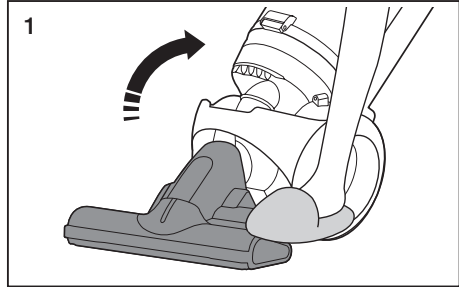

- Push the release button on the brush housing, and then pull the hose out.

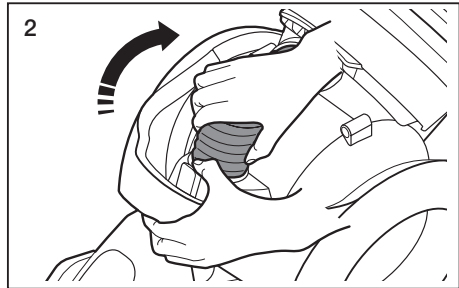

- Check for clogs in the opening of the brush housing and in the hose.

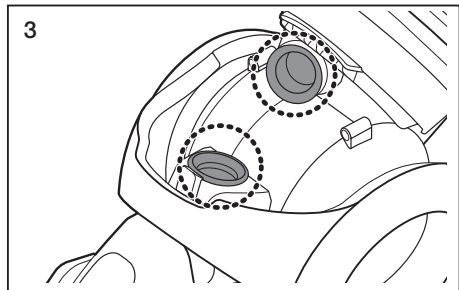

- When done, re-attach the hose to the brush housing.

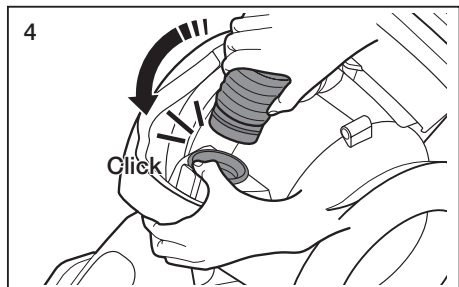

Before checking for clogs, turn off the brush bar and unplug the vacuum.

EMPTYING THE DUST BIN OF THE HANDY VACUUM CLEANER



- Separate the dust bin from the vacuum's body.

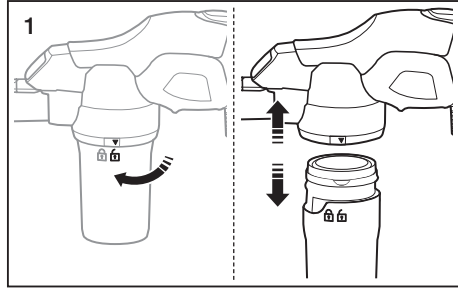

- Remove the filter and grille.

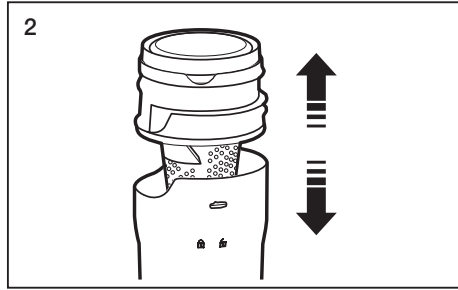

- Empty the dust bin.

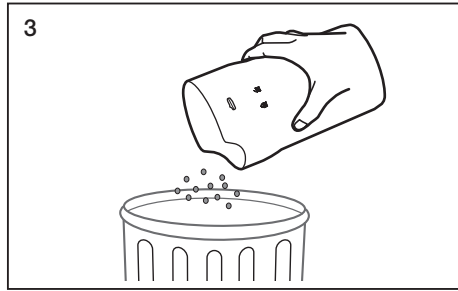

- Re-assemble the filter and grille.

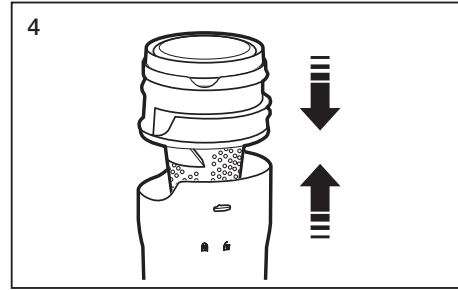

- Re-attach the dust bin to the vacuum body. (Align the open lock symbol on the dust bin with the arrow on the body, and then turn the bin counterclockwise so that the closed lock symbol aligns with the arrow.)

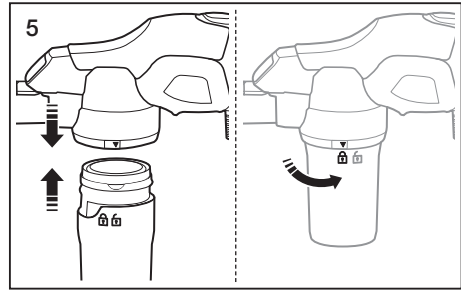

CLEANING THE FILTER OF THE HANDY VACUUM CLEANER

- Separate the dust bin from the vacuum's body, and then remove the filter.

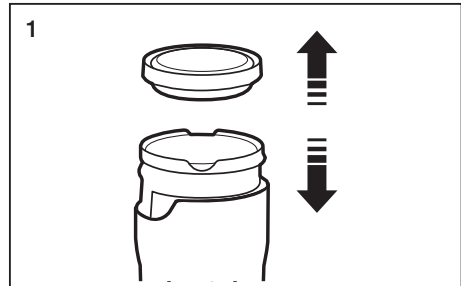

- Shake the filter to remove dust, and then wash the filter.

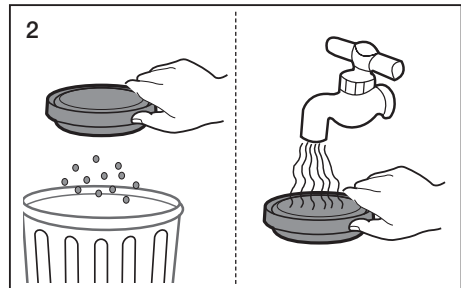

- Leave the filter in the shade until completely dry.

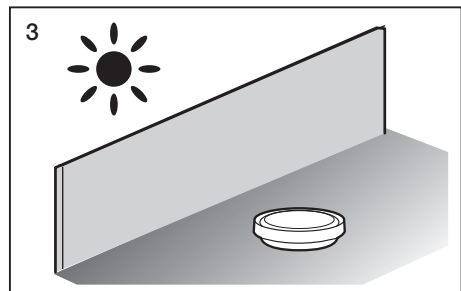

- Re-assemble the dust bin.

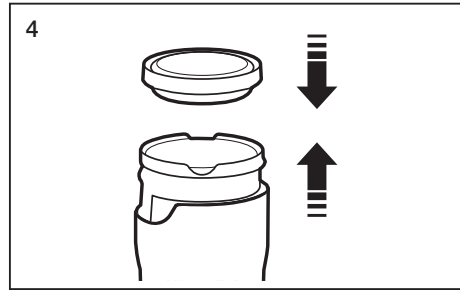

- Re-attach the dust bin to the vacuum body.
(Align the open lock symbol on the dust bin with the arrow on the body, and then turn the bin counterclockwise so that the closed lock symbol aligns with the arrow.)

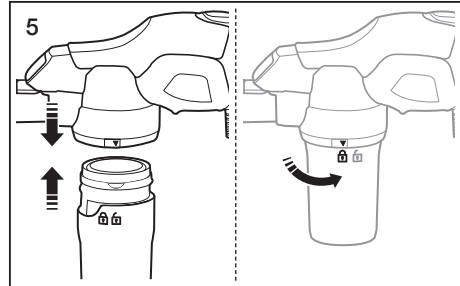

- Make sure the filter is completely dry before putting it back into the vacuum cleaner. Allow it to dry for 12 hours.
Do not use a wet filter.
Replace the dust filter if it becomes damaged or deformed.
Do not operate the vacuum cleaner without the filter in place.



Troubleshooting

Check this list of possible problems and solutions before bringing your vacuum to a service center.

PROBLEM	SOLUTION
Cleaner won't run.	<ul style="list-style-type: none"> • Check the electrical plug. Make sure it is fully plugged in. • Press the Power on/off button. • Reset the overload protector.
Suction Motor does not start. Thermal protector activated.	<ul style="list-style-type: none"> • Allow the vacuum to cool.
Brush Motor does not start.	<ul style="list-style-type: none"> • Check the power ON/OFF button and the brush ON/OFF button. • Cut hair or string off the brush. • Reset the overload protector.
Cleaner won't pick up or low suction.	<ul style="list-style-type: none"> • Empty the dust bin. • Clean the filter and confirm that the filter assembly is positioned properly. • Check the hose connection or flow path.
Dust escaping from cleaner.	<ul style="list-style-type: none"> • Empty the dust bin. • Clean the pre-motor filters. • Clean or replace the exhaust filter. • Confirm that the filter assembly is positioned properly.
Cleaner tools won't pick-up. (Handy vacuum cleaner)	<ul style="list-style-type: none"> • Check inlets, pipe, and dust bin for obstructions. Remove obstruction. • Empty the dust bin. • Remove and clean the filters. • Confirm that the dust bin is locked properly.

This Vacuum cleaner is approved the following.

EMC Directive : 2004/108/EEC

Low Voltage Directive : 2006/95/EC

Product fiche

[English]

According to Commission Regulation (EU) No 665/2013 and No 666/2013

A	Supplier	Samsung Electronics., Co. Ltd				
B	Model	SU10F70SA	SU10F70SB	SU10F70SD	SU10F70SQ	SU10F70SR
C	Energy Efficiency Class	B	B	B	A	A
D	Annual Energy Consumption (kWh/yr)	34	34	34	27	27
E	Carpet Cleaning Performance Class	D	D	D	C	C
F	Hardfloor Cleaning Performance Class	F	F	F	A	A
G	Dust Re-Emission Class	A	A	A	A	A
H	Sound Power Level (dBA)	87	87	87	87	87
I	Rated Input Power (W)	800	800	800	800	800
J	Type	General purpose vacuum cleaner				

- 1) Indicative annual energy consumption (kWh per year), based on 50 cleaning tasks. Actual annual energy consumption will depend on how the appliance is used.**
- 2) Measurements for power consumption and performance are based on methods in EN 60312 - 1 and EN 60704.**

Memo

Memo



If you have any questions or comments relating to Samsung products, please contact the SAMSUNG customer care center.

COUNTRY	CUSTOMER CARE CENTER	WEB SITE
U.K	0330 SAMSUNG (7267864)	www.samsung.com
SOUTH AFRICA	0860 7267864 (SAMSUNG)	www.samsung.com



DJ68-00709C-05