

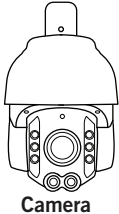

Please visit our website at [www.NightOwlISP.com](http://www.NightOwlISP.com) for all manuals, software, and firmware updates. There are also How-To videos with step-by-step instructions for connecting your device.

### BEFORE YOU GET STARTED YOU WILL NEED



Camera

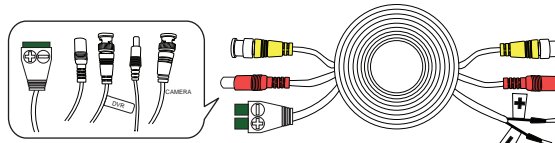

100 ft. Cable (Power / Video / RS-485)



Camera Power Adapter

**WARNING: NIGHT OWL ANALOG HD CAMERAS WILL ONLY FUNCTION WHEN CONNECTED TO A NIGHT OWL ANALOG HD DVR. TEST ALL CONNECTIONS AND ENSURE THE CAMERA IS FULLY FUNCTIONAL PRIOR TO PERMANENT INSTALLATION.**



### WATCH THE VIDEO



[www.NightOwlISP.com/ahd-ptz-qsg](http://www.NightOwlISP.com/ahd-ptz-qsg)

### CONNECTING THE CAMERA TO YOUR DVR

**Test the camera locally before installing the camera permanently.**

Connect the yellow BNC connector to Channel 1 on the DVR. (Default Channel)

Connect the green RS-485 connector to the RS-485 port on the posterior of the DVR.

Connect the red DC 14V to the included power adapter and wall outlet.

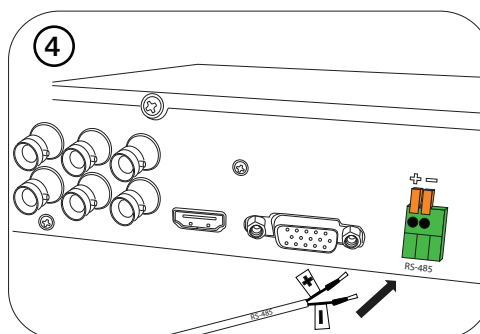
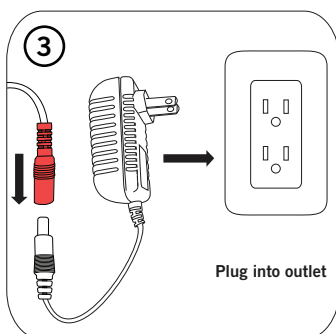
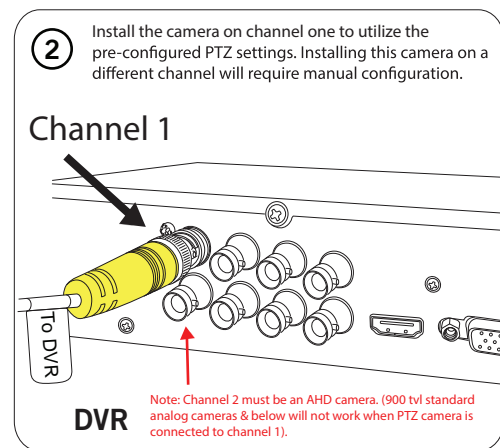
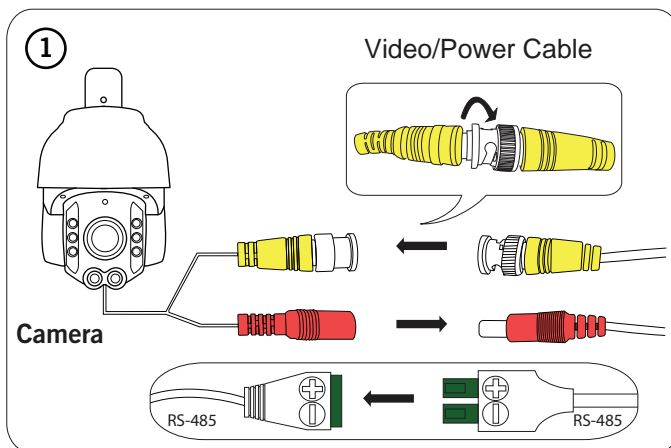

**WARNING: NIGHT OWL ANALOG HD CAMERAS WILL ONLY FUNCTION WHEN CONNECTED TO A NIGHT OWL ANALOG HD DVR. TEST ALL CONNECTIONS AND ENSURE THE CAMERA IS FULLY FUNCTIONAL PRIOR TO PERMANENT INSTALLATION.**



Images used are for reference only. Your product may vary slightly.



Please visit our website at [www.NightOwlSP.com](http://www.NightOwlSP.com) for all manuals, software, and firmware updates. There are also How-To videos with step-by-step instructions for connecting your device.

## TROUBLESHOOTING

### PTZ controls are not functioning properly or not functioning at all:

1. Confirm you are utilizing a Night Owl AHD DVR.
2. Confirm the camera is connected to channel 1 and all cables are properly connected.
3. Confirm the PTZ camera's default settings in the PTZ menu of your DVR's interface:
  - Channel = 1
  - Protocol = PELCO-D
  - Baudrate = 9600
  - Databit = 8
  - Stopbit = 1

### DVR's motion activated recordings are constantly being triggered:

- Turn off the motion activated recordings on the channel of the PTZ camera. DVR's detect motion by looking for changes between frames in the video. If the camera is moving, the DVR will determine this as motion.

### No Picture / Signal are being displayed on screen:

- Ensure all video and power connections are properly connected.
- Ensure the camera's power supply is plugged in. Do not use other power adapters with this product, as this will void the warranty. Check to see that the camera is receiving power by cupping your hands over the lens and you should see a faint red glow from the LEDs.
- Ensure the TV / Monitor is on the correct input channel.

## WHERE TO INSTALL THE CAMERA

- Do not place the camera and / or cabling near high voltage wires or other sources of electrical interference as it can degrade your video quality tremendously.
- You should not install the camera where the lens will be directly exposed to rain or snow. Your camera is weatherproof not waterproof, therefore it cannot be submerged under water. Camera is rated for outdoor use; however we recommend installation in a sheltered location.
- Mounting surface must be sturdy and able to hold at least four times the camera's total weight.
- Do not place the camera behind a window as it can cause a reflection in the window that will obscure events on the other side of the glass. To that point, the camera's IR LEDs will also reflect off the glass and shine into the lens which will result in a poor image.
- Light levels should be approximately the same between the viewing area and camera. It may produce a poor image if you install the camera in a brightly-lit area looking into a shaded area.
- Point the camera where there is the least amount of obstructions.

Images used are for reference only. Your product may vary slightly.