

# Connecting a AV device

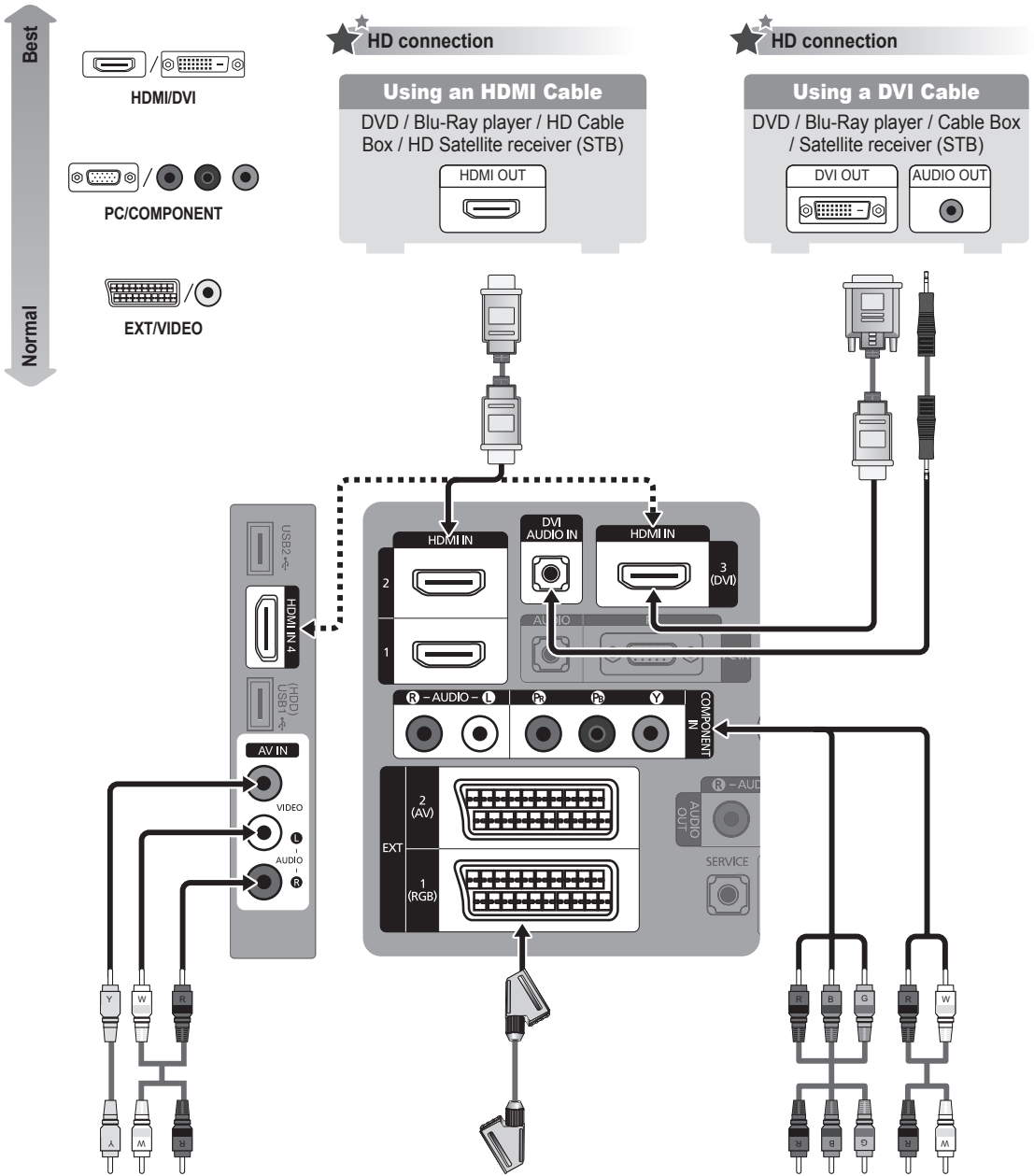

**Audio/Video connection**

**Using an Audio/Video Cable**

VCR

VIDEO OUT    AUDIO OUT

**Using a Scart Cable**

VCR / DVD

EXT

**Component connection**

**Using a Component Cable**

DVD / Blu-Ray player / Cable Box / Satellite receiver

AUDIO OUT    COMPONENT OUT

# LCD TV

## QUICK SETUP GUIDE

### The Supplied Accessories



Remote Control & Batteries (AAA x 2)



Power Cord



(M4 X L16)

Stand Screw X 4  
(Depending on the model)



Cleaning Cloth

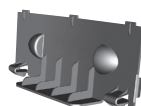

Cover-Bottom



Holder-Wire Cable  
(Depending on the model)



User Manual

### Installing Batteries in the Remote Control

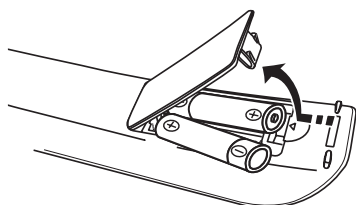

BN68-01894F-01

## Installing the Stand

### Preset

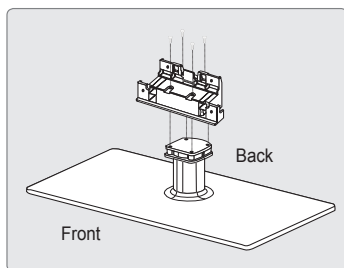

### Step 1

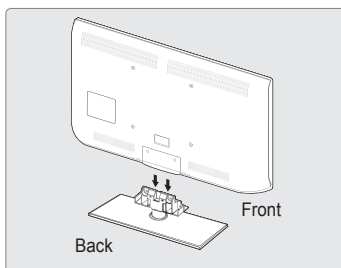

### Step 2

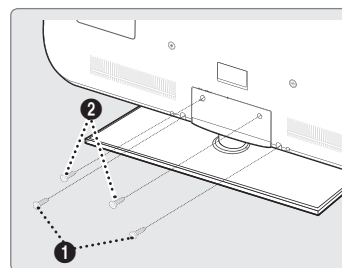

**Preset:** Place the Guide Stand and Cover Neck onto the stand and fasten it using the screws. Applicable to models (Depending on the model)

**Step 1.** Attach your LCD TV to the stand.

- Two or more people should carry the TV.
- Make sure to distinguish between the front and back of the stand when assembling them.
- To make sure the TV is installed on the stand at a proper level, do not apply excess downward pressure to the upper left or right sides of the TV.

**Step 2.** Fasten two screws at position 1 and then fasten two screw at position 2.

- Stand the product up and fasten the screws. If you fasten the screws with the LCD TV placed down, it may lean to one side.

## Assembling the Cables

Enclose the cables in the Holder-Wire Cable so that the cables are not visible through the transparent stand.

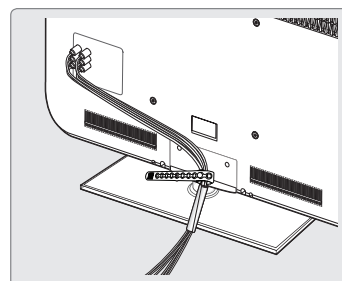

## Using the remote control buttons

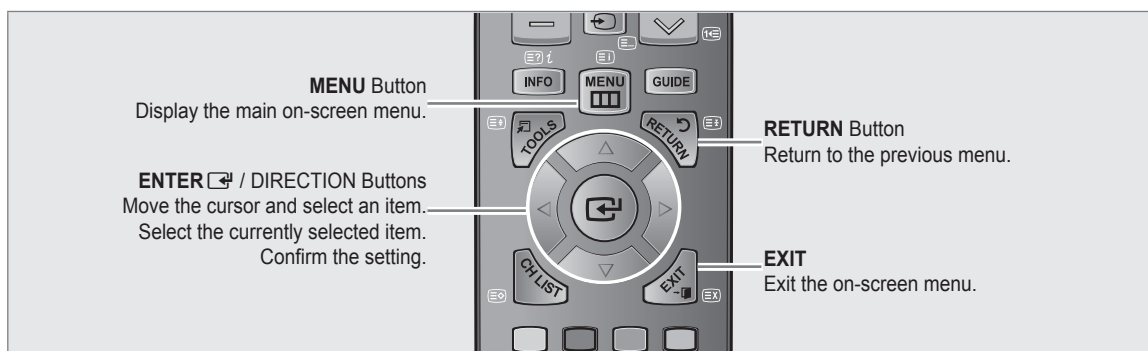

# Plug & Play

When the TV is initially powered on, basic settings proceed automatically and subsequently. If you want to reset this feature, press the **MENU** button to display menu. You can set the Plug & Play by selecting 'Setup → Plug & Play'.

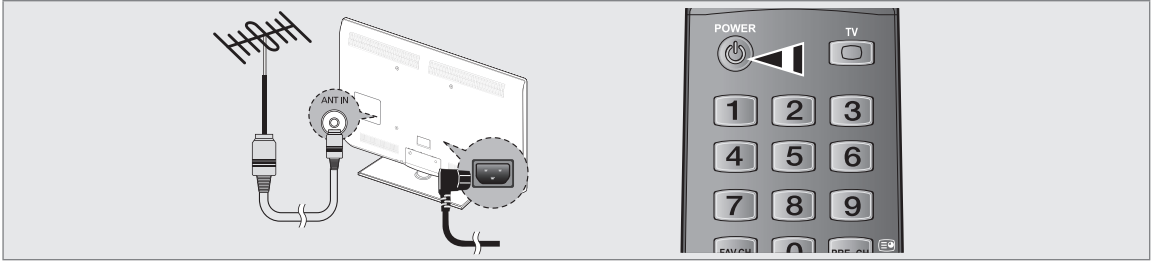

On the screen, you can set as follows.  
☑ The each step may vary depending on the Antenna source.

