



ring

STICK UP CAM

Setup and
Installation Guide

Step 1

Download the Ring App



The Ring app will walk you through setting up and managing your Stick Up Cam.

The Ring app is available for iPhone, iPad, Mac Desktop, Android, and Windows 10.



Search for “Ring” in one of the app stores above, or visit: ring.com/app



We have an online guide with videos and tutorials at: ring.com/setup

Step 2

Meet the Back of your Stick Up Cam

Setup Button – You'll be instructed to push this during the in-app setup.

Charging Port – This port is for charging your Stick Up Cam. Use the orange cable we've provided.

Status Light – This light will pulse when your Stick Up Cam is in setup mode.

For more, visit: ring.com/cam-charging

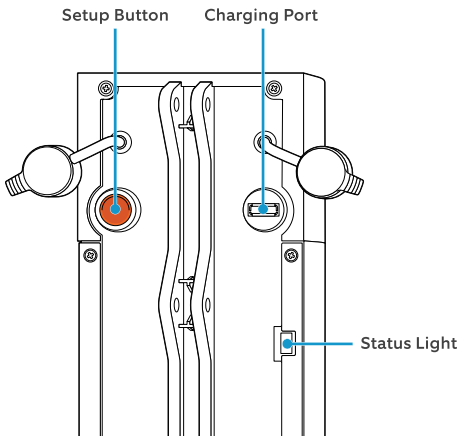

Step 3

Perform the In-App Setup

Select the plus sign in the Ring app to set up a new device.

When prompted, select **Stick Up Cam**.

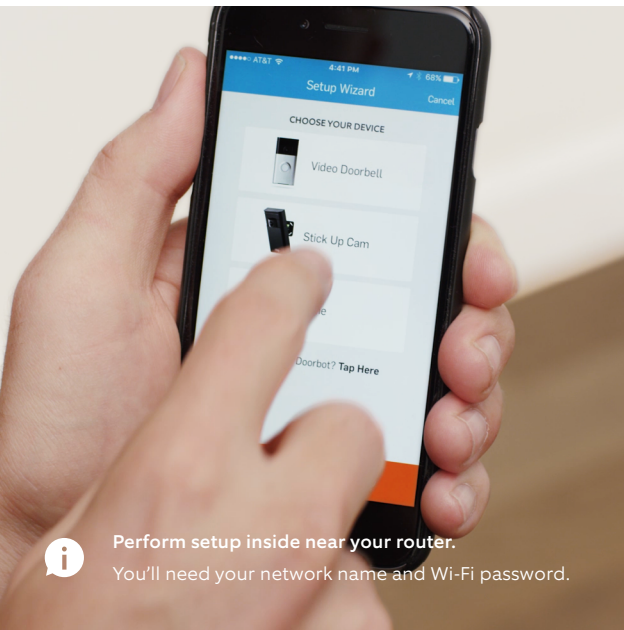

Perform setup inside near your router.

You'll need your network name and Wi-Fi password.

Step 4

Test the Video Quality

Before mounting your Stick Up Cam let's run a quick test. Double press the orange button. This will send an alert to your mobile device. Smile you're on camera.

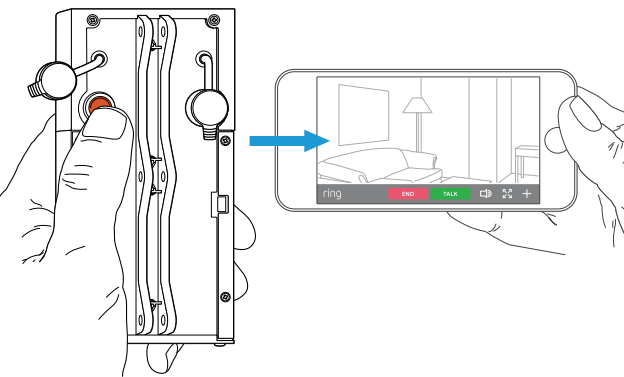

Repeat this test outside. If video quality is not as good, you may need to invest in a Wi-Fi extender.

Learn more at: ring.com/extender

Step 5

Charge your Stick Up Cam (optional)



If you'll be running Stick Up Cam off its internal battery, **charge it fully before mounting it outside.**

You'll also need to charge your Stick Up Cam every 6–12 months **using the supplied orange cable.**

If you receive frequent motion events you may need to charge your Stick Up Cam more often.

The status light will quickly pulse twice every second while charging.

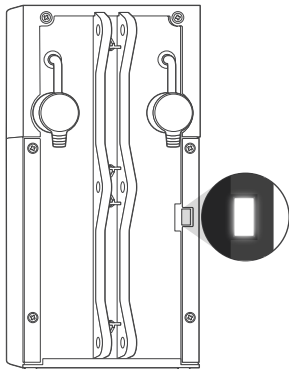

You can power your Stick Up Cam directly from a power source via the USB cable (plug not provided) or purchase Ring Solar Panel from ring.com

Step 6

Select the Mount You'd Like to Use

You have two mounts to choose from.

There's the **quick release mount** and the **security mount**.

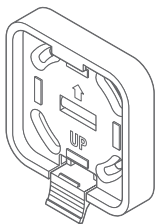

Quick Release Mount

This mount makes it easy to take your Stick Up Cam off the wall for charging.

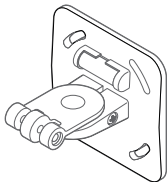

Security Mount

This mount offers a more permanent solution.

Step 7

Remove the Swivel Arm From the Security Mount

- A) Loosen the screw on the side.

- B) Remove the screw completely to set the swivel arm free and set this screw aside for now.

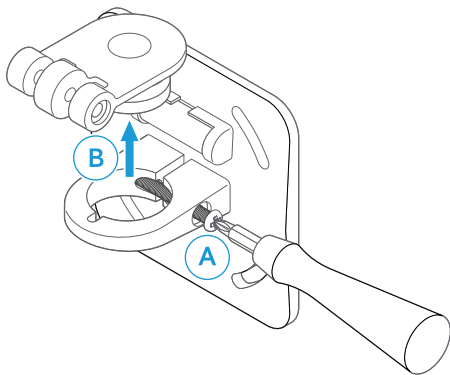

Step 8

Select the Mounting Point You'd Like to Use

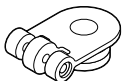

The swivel arm can attach to any of the three points on the back of your Stick Up Cam.

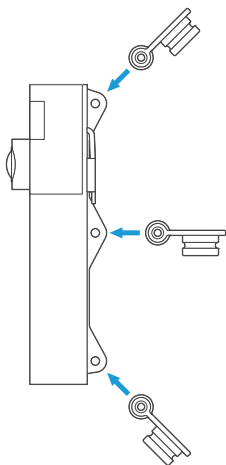

THE TOP MOUNTING POINT is great for installing Stick Up Cam on a ceiling.

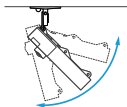

THE MIDDLE MOUNTING POINT is great for installing Stick Up Cam on a wall at eye level.



THE BOTTOM MOUNTING POINT is great for installing Stick Up Cam high on a wall, or placing it on a table.

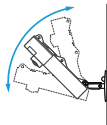

Step 9

Attach the Swivel Arm to your Stick Up Cam

Use the bolt that was provided in the small bag to attach the swivel arm to the mounting point you selected in the previous step.

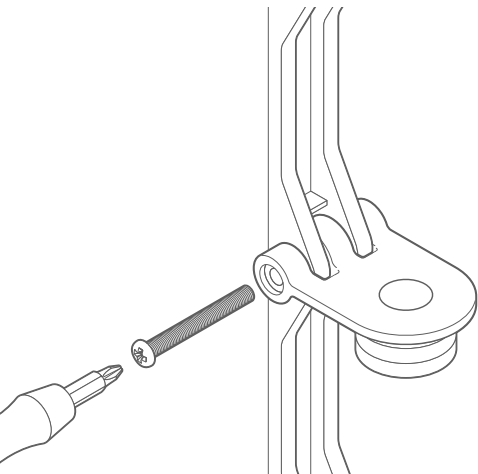

Screw the bolt into the swivel arm on the side with the recess

Step 10

Install the Mount

Take everything to where you'll be installing your Stick Up Cam.

If you're installing on **stucco, brick or concrete**, use the quick release mount as a template to mark the location of 4 holes that you'll drill in the next step.

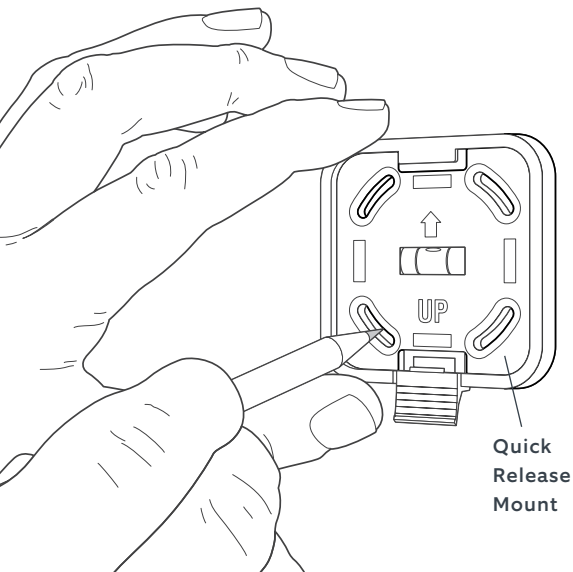

Installing the Mount (continued)

On **stucco, brick, or concrete** use the provided drill bit to drill the 4 holes that you marked in the previous step.

Then insert the wall anchors.

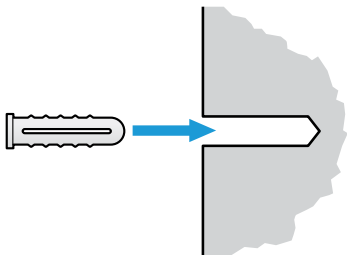

On **wood or siding**, skip this part, and screw the bracket directly into your wall.

Installing the Mount (continued)

Use the Phillips head side of the Ring screwdriver and the provided screws to screw in the bracket you selected in **step 6**.



Step 11

Attach Your Stick Up Cam to the Security Mount

Use the screw you set aside in step 7 to attach the camera to the security mount.

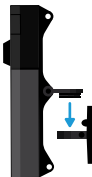

Step 12 (if using the quick release mount)

Snap Your Stick Up Cam into the Quick Release Mount

Push gently down on the tab and snap your Stick Up Cam into place.



Double-press the orange button on the back of your Stick Up Cam to trigger an alert in the Ring app. Use this to find the best point of view for the camera.



Step 13

Bask in the pride of having installed your Stick Up Cam!



Select your Stick Up Cam in the Ring app to add **Shared Users** and customize **Motion Settings**.

Shared Users



You can add friends and family by selecting the **Shared Users** option on the **Settings Screen**.

Enter the email addresses for those you want to add. Shared users can answer live events and view recordings (if you have Cloud Video Recording enabled). They won't be able to delete events or change settings.

Motion Detection



To enable and customize motion detection, select **Motion Settings** on the **Settings Screen**.

Using Stick Up Cam

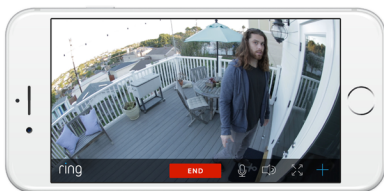

When Stick Up Cam detects motion, you can perform the following actions:



Disable/enable your microphone



Mute/unmute sound in the Ring app



Zoom in/out



Access the Ring Plus menu

Turning off motion alerts:

If you don't want to receive notifications, you can toggle motion alerts off in the Ring app.

MOTION ALERTS — on

MOTION ALERTS — off

Cloud Video Recording

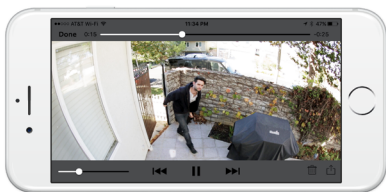

This optional feature saves events captured by your Stick Up Cam.

You can access these events on any device running the Ring app, or by logging into your Ring account at: ring.com/activity

To learn more about Cloud Video Recording, visit:

ring.com/cloud-recording

With Ring, You're **Always** Home

Add Ring Solar Panel for Ultimate Convenience



Ring Solar Panel connects to your Stick Up Cam via a micro USB cable, and with only a few hours of direct sunlight, keeps your Stick Up Cam continuously charged.

Order now at ring.com/solarpanel

For additional help, visit:

ring.com/help

For immediate assistance, we're
available 7 days a week at:

DOMESTIC: 1-800-656-1918

INTERNATIONAL: +1 310-929-7085

help@ring.com

The Ring logo consists of the word "ring" in a lowercase, sans-serif font. A small blue dot is positioned above the letter "i".

Hereby, Bot Home Automation, declares that this consumer electronic is in compliance with the essential requirements and other relevant provisions of Directive 1999/5/EC. The declaration of conformity may be consulted at www.ring.com/DoC.pdf.

Protect the device from direct sunlight. Install the device at dry locations and protect it against rain and humidity. The device may not get contact to salt water or other conductive liquids. The device must be charged only within a building in a dry state.

© 2016 Bot Home Automation, Inc.

RING and ALWAYS HOME are trademarks of Bot Home Automation, Inc., registered in the U.S.

Stick Up Cam and CHIME are trademarks of Bot Home Automation, Inc.

Last updated: 04/13/16