



2-in-1 Security Multi-Flex Stand and Magnetic Wall Mount for 7-14 Inch Tablets

USER MANUAL

PAD-MSKMSB

Contents

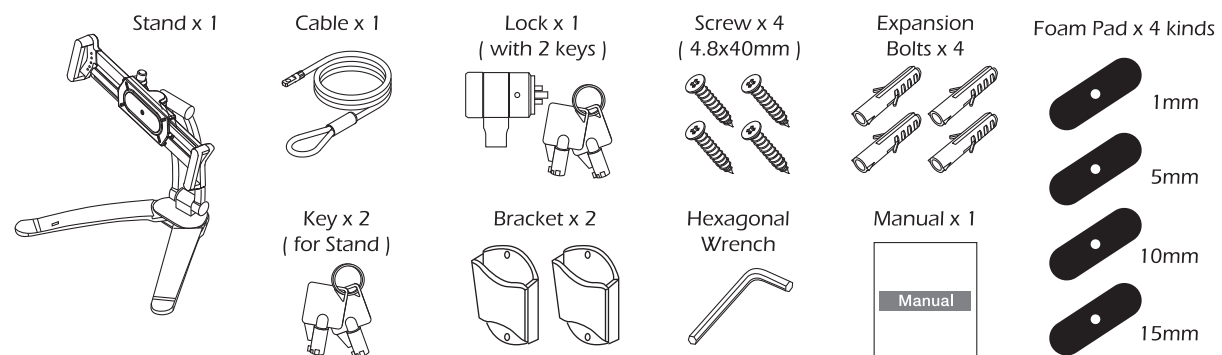

Adjusting the Angle

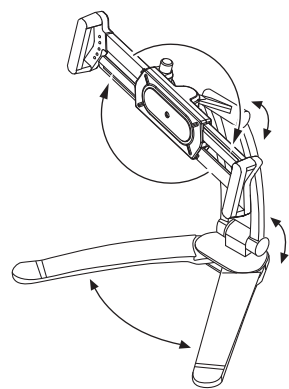

Installing Your Tablet

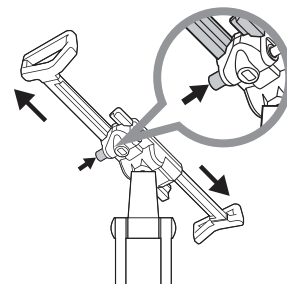

1. Press and hold on the release button to unlock the frame.

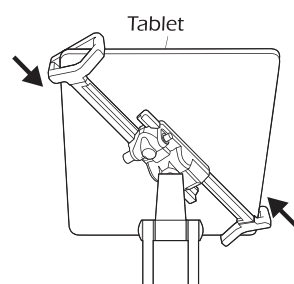

2. Place tablet against corner then slide in until snug.

Using the Lock

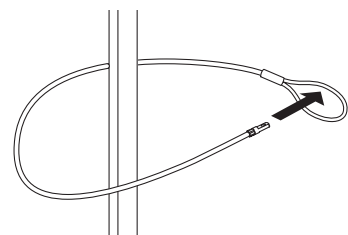

1. Loop the cable around a secure object.

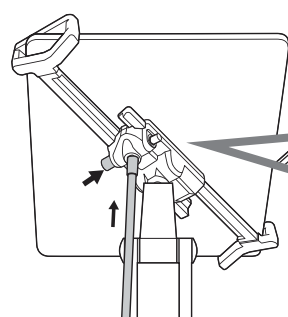

2. Insert the cable into the security slot.

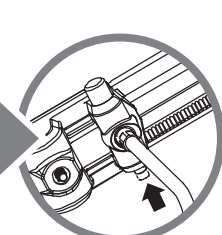

3. Press the lock button to lock the frame and cable.

Unlock The Security Frame

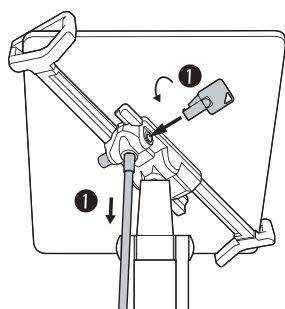

1. Insert the key into the lock button to release the cable.

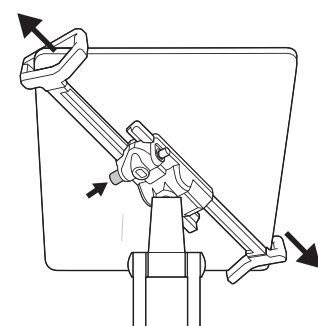

2. Press and hold on the release button to unlock the frame.

Mounting Tablet On The Wall

A - For wooden wall

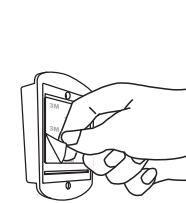

1. Tear off adhesive film on the bottom of the bracket.

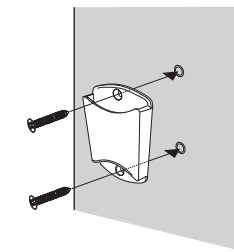

2. Stick to the wall and fix it with screws.

Lock The Stand on Wall

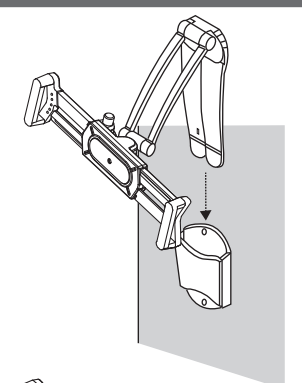

B - For cement wall

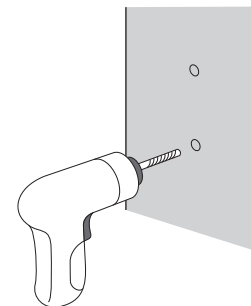

1. Drill a hole on the wall. diameter: 6.5~7mm depth: 40~45mm

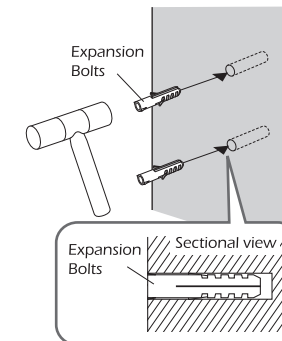

2. Knock the expansion bolts completely into the wall.

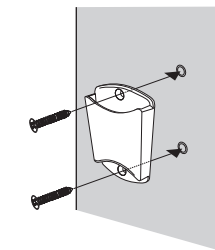

3. Fix it with screws on the wall.

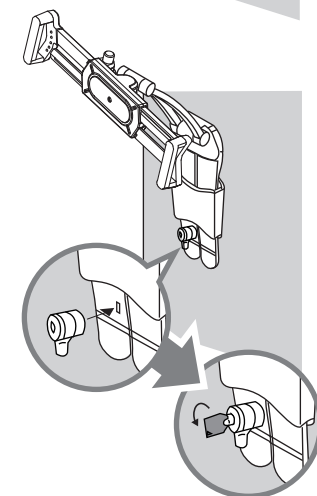

C - For iron product

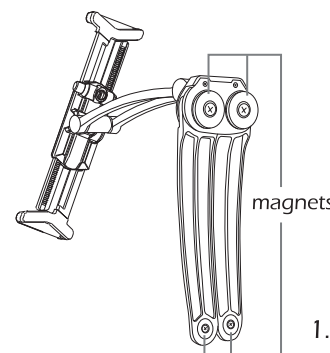

1. There are four round magnets at the bottom.

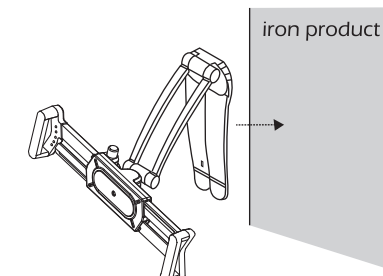

2. The stand can be directly adsorbed on any iron products.

Adjusting the Joint

If the joint is loose, you can tighten it with the hexagonal wrench.

1. Remove the gasket.

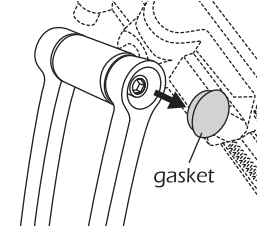

2. Use a hexagonal wrench to adjust the joint.

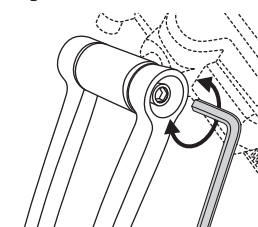

1. Remove the gasket.

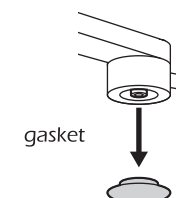

2. Use a hexagonal wrench to adjust the joint.

