

Epson Expression Photo XP-750



DATASHEET



The Expression Photo XP-750*1 all-in-one is ideal for photo enthusiasts who want to print superior-quality photos that can also be shared with the rest of the family. Up to 40 percent smaller*2 than previous models, this printer features an 8.8cm touch-screen, with user-friendly interactive menu, and a motorised control panel and output tray which open automatically before printing.

Epson's new six-colour Claria Photo HD Ink is ideal for keen photographers looking to produce and display superior-quality, long-lasting photographs and delivers smooth tonal gradations, deep natural blacks and rich, vibrant colours.

Experiment with your creative side and print onto card and heavyweight photo paper with the rear speciality media feed. You can also easily switch between photo and A4 printing, thanks to the dual front-loading paper trays, and also personalise family films and digital photo albums, by printing directly onto suitable CD and DVDs.

Epson Connect*3 allows you to print wirelessly from smartphones and tablet PCs within the home, and print from anywhere in the world by emailing documents directly to the printer's unique email address. The Remote Printer Driver offers more flexibility to print from your PC to any Epson Connect printer anywhere in the world, while Scan-to-Cloud enables you to store scanned documents directly in Cloud services. In addition the XP-750 is Apple AirPrint and Google Cloud print ready.

KEY FEATURES

- **Wi-Fi all-in-one**
Print, scan and copy
- **Exceptional photos**
Superior-quality, long-lasting photos
- **Ultra compact**
40% smaller than previous models*2
- **Epson Connect**
Freedom to print and scan anywhere
- **Easy operation**
8.8cm touch-screen and motorised trays

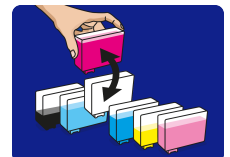

PRODUCT SPECIFICATIONS

TECHNOLOGY	
Printing Method	Epson Micro Piezo™ print head
Minimum Droplet Size	1.5 pl, With Variable-Sized Droplet Technology
Ink Technology	Claria™ Photo HD Ink
Printing Resolution	5,760 x 1,440 dpi
PRINT	
Printing Speed ISO/IEC 24734	9.5 Pages/min Monochrome, 9 Pages/min Color
Maximum Printing Speed	32 Pages/min Monochrome (plain paper), 32 Pages/min Color (plain paper), 10 Seconds per 10 x 15 cm photo (Epson Premium Glossy Photo Paper)
Colours	Black, Light Cyan, Cyan, Yellow, Magenta, Light Magenta
For detailed information on printing speeds please visit http://www.epson.eu/testing .	
SCAN	
Scanning Resolution	2,400 dpi x 4,800 dpi (Horizontal x Vertical)
Scanner type	Contact image sensor (CIS)
PAPER / MEDIA HANDLING	
Number of paper trays	2
Paper Formats	A4, A5, A6, B5, C6 (Envelope), DL (Envelope), No. 10 (Envelope), Letter, 10 x 15 cm, 13 x 18 cm, 13 x 20 cm, 20 x 25 cm, 100 x 148 mm, 16:9, HLT, Legal
Duplex	Yes
Print Margin	0 mm top, 0 mm right, 0 mm bottom, 0 mm left (Wherever margin is defined. Otherwise 3mm top, left, right, bottom.)
Paper Tray Capacity	100 Sheets Standard, 20 Photo Sheets
Media Handling	Automatic duplex, Borderless print, CD/DVD print, Rear specialty media feed
GENERAL	
Energy Use	ENERGY STAR® qualified all-in-one, 20 W (standalone copying, ISO/IEC 24712 pattern), 1.8 W (sleep mode)
Product dimensions	390 x 341 x 141 mm (Width x Depth x Height)
Product weight	7.3 kg
Noise Level	5.1 B (A) with Epson Premium Glossy Photo Paper / Photo RPM mode - 37 dB (A) with Epson Premium Glossy Photo Paper / Photo RPM mode
OTHER	
Warranty	12 months Carry in

LOGISTICS INFORMATION

SKU	C11CC43301
Barcode	8715946515618
Dimensions Single Carton	479 x 235 x 427 mm
Carton Weight	9.4 Kg
Multiple Order Quantity	1 Units
Country of Origin	Indonesia
Pallet Size Euro	18 Units (2 x 9)
Pallet Size Block	36 Units (4 x 9)



For more information please contact:

Telephone: 0871 222 6702 (UK)+
01 436 7742 (Republic of Ireland)
E-mail: enquiries@epson.co.uk
Fax: 0871 222 6740

Web: www.epson.co.uk
www.epson.ie

+ Calls cost 10p per minute plus network extras.

Trademarks and registered trademarks are the property of Seiko Epson Corporation or their respective owners. Product information is subject to change without prior notice.

Epson Expression Photo XP-750

WHAT'S IN THE BOX

- Individual Ink Cartridges
- Main unit
- Setup guide
- Software (CD)
- Warranty document
- Power cable

INK CARTRIDGE COMPATIBILITY



INK YIELD DATA

	Elephant 24	Elephant 24XL
●	240 pages*	500 pages*
● ● ● ● ● ●	360 pages*	740 pages*

* Approx. page yield based on ISO/IEC 24711/24712 or ISO/IEC 29102/29103. Actual yield will vary depending on images printed and usage conditions. For more information visit <http://www.epson.eu/pageyield>

1. This printer and original ink cartridges are for sale and use in EMEAR only
2. Based on total volume of the printer, with trays closed, compared to previous models
3. Requires a wireless connection to the internet. For more information, supported languages and devices please visit www.epsonconnect.eu
4. Automatic set-up compatible with Windows 7, Windows 8, Windows Vista and Mac OS
5. For more information, visit www.epson.eu/testing
6. Wherever margin is defined. Otherwise 3mm top, left, right, bottom
7. Adaptor required (not supplied in box)

EPSON®