

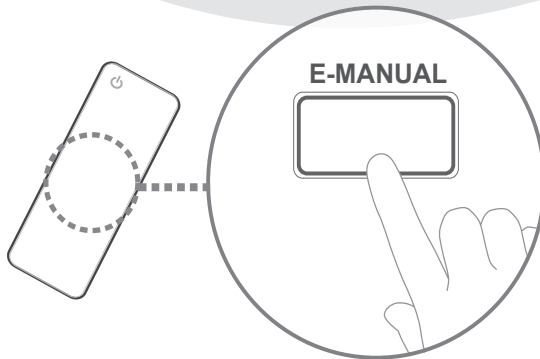

BD-F8500M

BD-F8900M

BD-HDD Combo user manual



imagine the possibilities

Thank you for purchasing this Samsung product.

To receive more complete service,
please register your product at

www.samsung.com/register

For more information on how to use e-Manual (P. 9)

Figures and illustrations in this User Manual are provided for reference only and may differ from actual product appearance. Product design and specifications may be changed without notice.

Available Recording Time for internal HDD

You can record digital broadcast on the internal HDD as below.

Depending on the actual broadcast, available recording time may be different with the table shown below.

In On Screen Display, you can check available recording time as shown in "high" case in the table shown below.





Broadcast Type	Estimated Bitrate	Recording Time	
		BD-F8500M	BD-F8900M
HD	8 Mbps (Normal)	124 Hours	257 Hours
	20 Mbps (High)	49 Hours	102 Hours
SD	5 Mbps (Normal)	199 Hours	411 Hours
	10 Mbps (High)	99 Hours	205 Hours

| NOTE |





- ▶ Since the product's Timeshift and other implemented functions require a certain amount of HDD space allocated internally, the total size shown in the "Storage Device Manager" of Settings menu may differ from the HDD's capacity shown in the manual.

Region Code

Both products and discs are coded by region. These regional codes must match for a disc to play. If the codes do not match, the disc will not play. The Region Number for this product is displayed on the rear panel of the product.

Disc Type	Region Code	Area
Blu-ray Disc		Europe, Greenland, French territories, Middle East, Africa, Australia and New Zealand.
		Europe, Japan, the Middle East, Egypt, Africa, Greenland
DVD-VIDEO		Mexico, South America, Central America, Australia, New Zealand, Pacific Islands, Caribbean
		

Logos of Discs the product can play

	
Blu-ray Disc	3D Blu-ray Disc
	
BD-Live	DivX
	
PAL broadcast System in U.K., France, Germany, etc.	

Accessories

Check for the supplied accessories below.

- RF cable for TV
- Remote Control
- Batteries for Remote Control(AAA Size)
- Power cord
- User Manual

Front Panel or Rear Panel

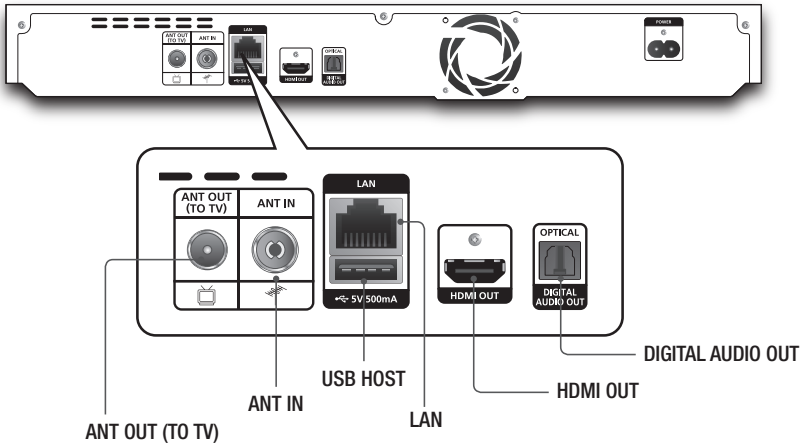
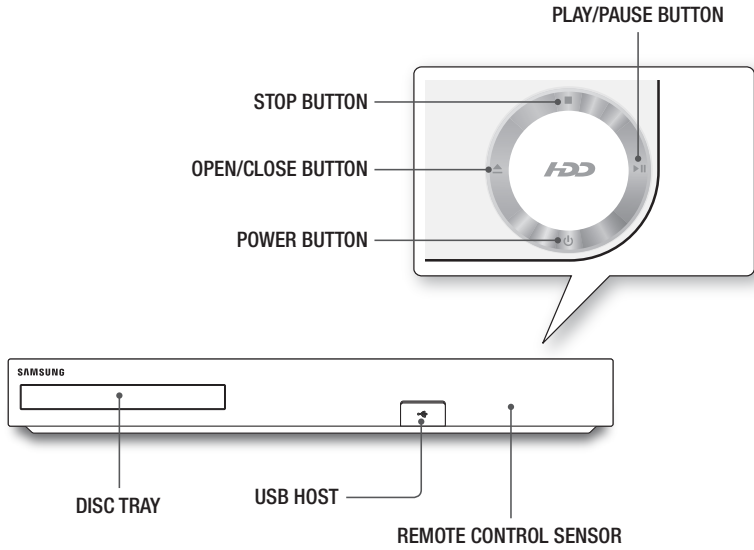

Remote Control

Tour of the Remote Control

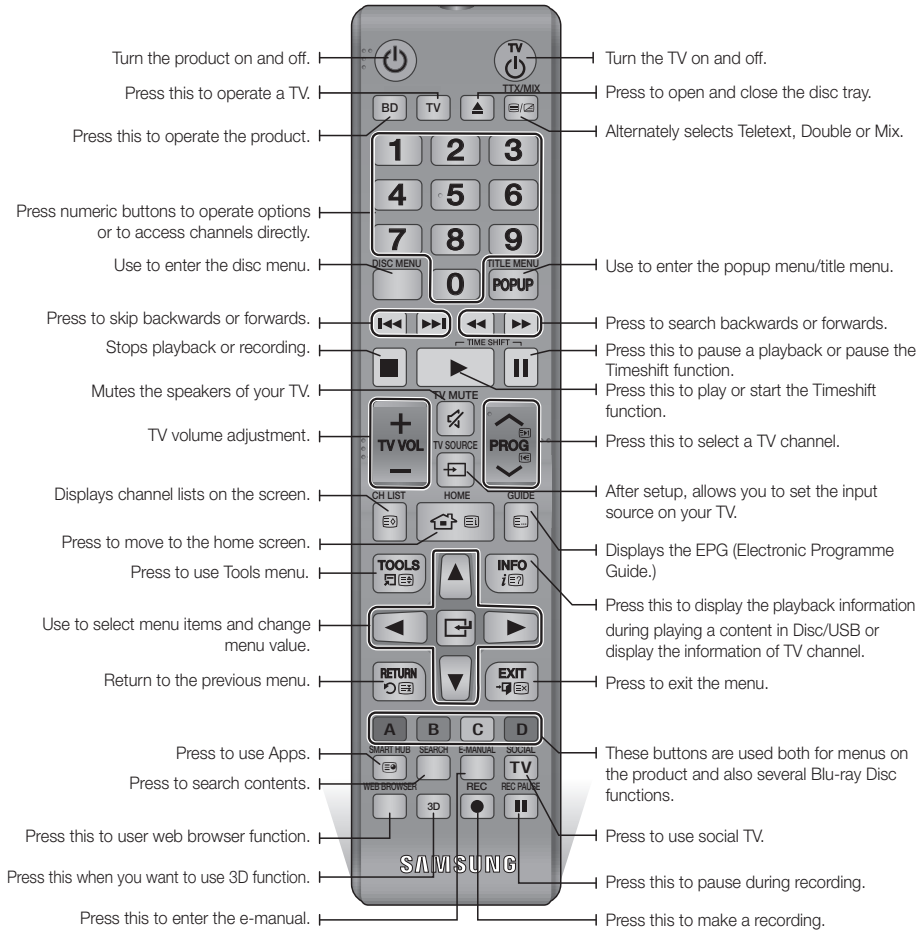

Installing batteries

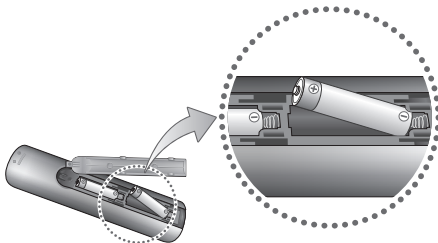

| NOTE |

- ▶ If the remote does not operate properly:
 - Check the polarity +/- of the batteries.
 - Check if the batteries are drained.
 - Check if the remote sensor is blocked by obstacles.
 - Check if there is any fluorescent lighting nearby.

| CAUTION |

- ▶ Dispose of batteries according to local environmental regulations. Do not put them in the household trash.

Setting the Remote Control to Operate Your TV

- To determine whether your television is compatible, follow the instructions below.

1. Turn your television on.
2. Point the remote control towards the television.
3. Press the **TV** button to set the TV mode.
4. Press and hold the **TV POWER** button, and then enter the two-figure code in the table to the right that corresponds to the brand of your television by pressing the appropriate number buttons.

If your television is compatible with the remote control, it will Turn off.

The remote is now programmed to operate the TV.

NOTE I

- ▶ If several codes are listed for your television brand, try each one in turn until you find one that works.
- ▶ If you replace the remote control's batteries, you must set the brand code again.

You can control certain functions of your TV with this remote control.

Button	Function
TV POWER	Used to Turn the television on and off.
Number	Used to input number directly.
TV VOL +/-	Used to adjust the volume of the television.
TV MUTE	Used to toggle the sound on and off.
PROG (▲/▼)	Used to select the desired channel.
TV SOURCE	Used to select an external source connected to the TV.

NOTE I

- ▶ The functions listed above will not necessarily work on all televisions. If you encounter problems, use the TV remote control.

TV Control Codes

Brand	Code	Brand	Code
SAMSUNG	TV POWER+01, +02, +03, +04, +05, +06, +07, +08, +09	NOBLEX	TV POWER+66
AIWA	TV POWER+82	NOKIA	TV POWER+74
ANAM	TV POWER+10, +11, +12, +13, +14, +15, +16, +17, +18	NORDMENDE	TV POWER+72, +73, +75
BANG & OLUFSEN	TV POWER+57	PANASONIC	TV POWER+53, +54, +74, +75
BLAUPUNKT	TV POWER+71	PHILIPS	TV POWER+06, +55, +56, +57
BRANDT	TV POWER+73	PHONOLA	TV POWER+06, +56, +57
BRIONVEGA	TV POWER+57	PIONEER	TV POWER+58, +59, +73, +74
CGE	TV POWER+52	RADIOLA	TV POWER+06, +56
CONTINENTAL EDISON	TV POWER+75	RADIOMARELLI	TV POWER+57
DAEWOO	TV POWER+19, +20, +23, +24, +25, +26, +27, +28, +29, +30, +31, +32, +33, +34	RCA	TV POWER+45, +46
EMERSON	TV POWER+64	REX	TV POWER+74
FERGUSON	TV POWER+73	SABA	TV POWER+57, +72, +73, +74, +75
FINLUX	TV POWER+06, +49, +57	SALORA	TV POWER+74
FORMENTI	TV POWER+57	SANYO	TV POWER+41, +42, +43, +44, +48
FUJITSU	TV POWER+84	SCHNEIDER	TV POWER+06
GRADIENTE	TV POWER+70	SELECO	TV POWER+74
GRUNDIG	TV POWER+49, +52, +71	SHARP	TV POWER+36, +37, +38, +39, +48
HITACHI	TV POWER+60, +72, +73, +75	SIEMENS	TV POWER+71
IMPERIAL	TV POWER+52	SINGER	TV POWER+57
JVC	TV POWER+61, +79	SINUDYNE	TV POWER+57
LG	TV POWER+06, +19, +20, +21, +22, +78	SONY	TV POWER+35, +48
LOEWE	TV POWER+06, +69	TELEAVA	TV POWER+73
LOEWE OPTA	TV POWER+06, +57	TELEFUNKEN	TV POWER+67, +73, +75, +76
MAGNAVOX	TV POWER+40	THOMSON	TV POWER+72, +73, +75
METZ	TV POWER+57	THOMSON ASIA	TV POWER+80, +81
MITSUBISHI	TV POWER+06, +48, +62, +65	TOSHIBA	TV POWER+47, +48, +49, +50, +51, +52
MIVAR	TV POWER+52, +77	WEGA	TV POWER+57
NEC	TV POWER+83	YOKO	TV POWER+06
NEWSAN	TV POWER+68	ZENITH	TV POWER+63

Connections

Connecting to a TV

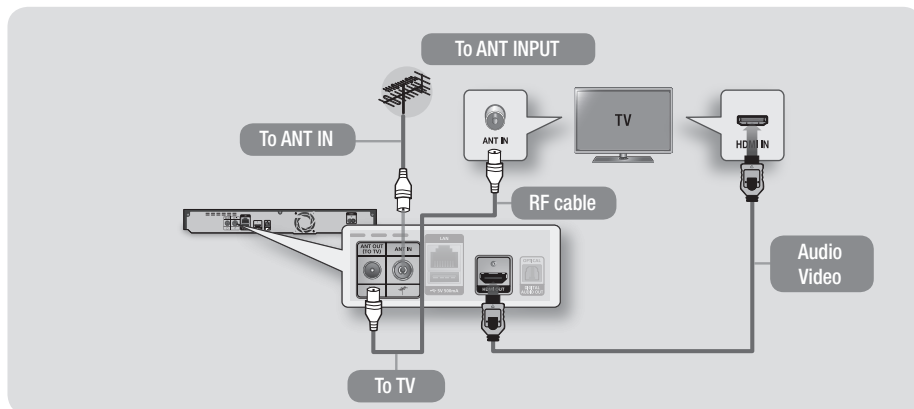

Connecting to an Audio System

Method 1 Connecting to an HDMI supported AV receiver

- Use an HDMI cable (not included)

Method 2 Connecting to an AV receiver with Optical input

- Use an Optical Cable (not included)
- You will hear sound only through the front two speakers with Digital Output set to PCM.

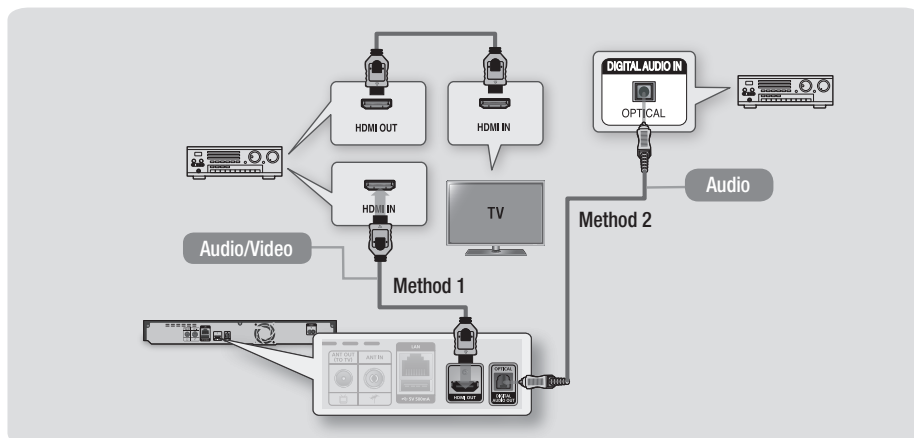

Network Connection

You can connect your product to your network router using one of the methods illustrated below.

Wired Network

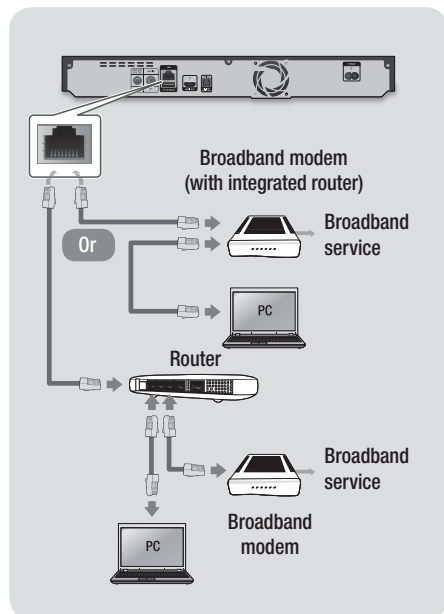

| NOTE |

- ▶ Internet access to Samsung's software update server may not be allowed, depending on the router you use or your ISP's policy. For more information, contact your ISP (Internet Service Provider).
- ▶ DSL users, please use a router to make a network connection.
- ▶ To use the AllShare function with your PC, you must connect your PC.

Wireless Network

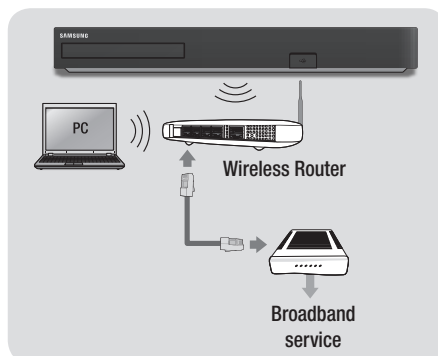

| NOTE |

- ▶ If the wireless router supports DHCP, your product can use a DHCP or static IP address to connect to the wireless network.
- ▶ Set your wireless router to Infrastructure mode. Ad-hoc mode is not supported.
- ▶ The product supports only the following wireless security key protocols:
 - WEP (OPEN/SHARED), WPA-PSK (TKIP/AES), WPA2-AES (TKIP/AES)
- ▶ Select a channel on the wireless router that is not currently being used. If the channel set for the wireless router is currently being used by another device nearby, it will result in interference and communication failure.
- ▶ If you select the Pure High-throughput (Greenfield) 802.11n mode and set the Encryption type on your router or router to WEP, TKIP or TKIP-AES (WPS2Mixed), the product will not support a connection in compliance with new Wi-Fi certification specifications.
- ▶ If your router supports WPS (Wi-Fi Protected Setup), you can connect to the network via PBC (Push Button Configuration) or PIN (Personal Identification Number). WPS will automatically configure the SSID and WPA key in either mode.
- ▶ Wireless LAN, by its nature, may cause interference, depending on the operating conditions (router performance, distance, obstacles, interference by other radio devices, etc).
- ▶ To use the AllShare function with your PC, you must connect your PC.

The Setup Procedure

- The Home screen will not appear if you do not configure the initial settings.
- The OSD (On Screen Display) of this product may change after you upgrade the software version.
- The access steps may differ depending on the menu you selected.

Turn on your TV after connecting the player.
When you connect the player to a TV for the first time, player turns on automatically and the Initial Settings screen appears.
Start the Initial Settings Procedure.

| NOTE |

- ▶ When the product is connected to the TV for the first time, the product turns on automatically. This is normal operation.
- ▶ Password : Enter the desired 4-digit password using the number buttons.
 - Default password is set to 0000.

The Home Screen

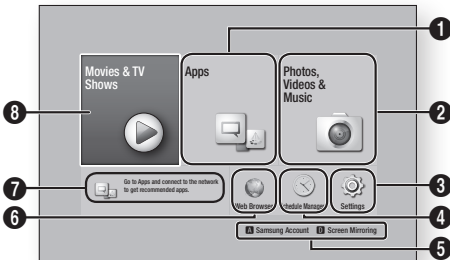

1 Apps : Access various for pay or free-of-charge applications.

2 Photos, Videos & Music : Play videos, photos or music content from Disc, USB, PC or mobile devices.

3	Settings : Set various functions to suit your personal preferences.
4	Schedule Manager : Reserve the desired TV programmes.
5	Navigation Help : Displays remote control buttons available.
6	Web Browser : Access the internet using the Web Browser application.
7	Recommended Apps : Access recommended applications directly.
	Movies & TV Shows : Download movies and TV Shows from the Internet.
8	 NOTE <ul style="list-style-type: none"> ▶ Depending on your country, this menu may not be supported.

| NOTE |

- ▶ In the Home menu screen, it will switch to DTV Channel mode after 3 minutes. When accessing the Settings menu, the screen saver will be activated after 5 minutes. Saves power by turning off product automatically when no user operation is received for 4 hours. If "Auto Power Off" menu is set to **Off**, the power will not turn off automatically .

Accessing the Settings Screen

1. Select **Settings** on the Home screen, and then press **[Enter]** button. The Settings screen appears.

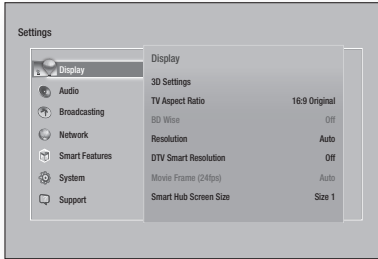

2. To access the Settings menus, sub-menus, and options, please refer to the remote control illustration and the setting table.

Buttons on the Remote Control used for the Settings menu

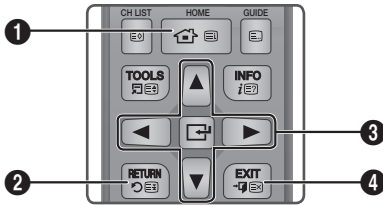

1	HOME Button : Press to move to the Home screen.
2	RETURN Button : Return to the previous menu.
3	[Enter] / DIRECTION Buttons : <ul style="list-style-type: none"> • Press ▲▼◀▶ to move the cursor or select an item. • Press the [Enter] button to activate the currently selected item or confirm a setting.
4	EXIT Button : Press to exit the current menu.

How to use the e-Manual



You can find instructions about your product's features in the e-Manual in your product. To use, press the **E-MANUAL** button on your remote control.

Press the **▲▼◀▶** buttons to highlight a category, and then press the **[Enter]** button.

The E-manual Screen

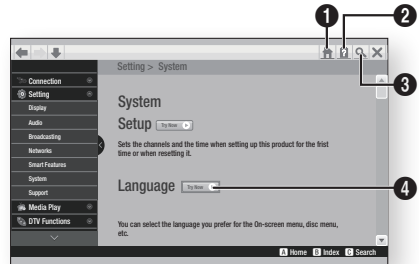



1	Home : Moves to the e-Manual home screen.
2	Index : Displays the index screen.
3	Search : Allows you to search for information by entering words.
4	Try Now : Allows you to go to corresponding OSD menu.

NOTE

- ▶ This function is not enabled in some menus.
- ▶ If displayed E-manual page on your TV screen is incomplete and partially hidden, set the **Smart Hub Screen Size** to **Size 1**.

Troubleshooting

If the BD-HDD combo seems to have a problem, first try this list of possible problems and solutions. If none of these troubleshooting tips apply, visit “www.samsung.com”, then click on Support, or call Samsung customer service centre.

PROBLEM	SOLUTION
The screen is blocked	<ul style="list-style-type: none">• If the HDMI output is set to a resolution your TV cannot support (for example, 1080p), you may not see a picture on your TV.• Press the  (STOP) button (on top panel) for more than 5 seconds with no disc inside on the home screen. All settings will revert to the factory settings.• When the factory default settings are restored, all stored user BD data is deleted.
Forgot password	<ul style="list-style-type: none">• Press the  (STOP) button (on top panel) for more than 5 seconds with no disc inside on the home screen. All settings including the PIN will revert to the factory settings. Don't use this unless absolutely necessary.• When the factory default settings are restored, all stored user BD data is deleted.

Repairs

If you contact us to repair your product, an administration fee may be charged if either:

1. An engineer is called out to your home at your request and there is no defect in the product.
2. You bring the unit to a repair centre and there is no defect in the product.

We will provide you with the amount of the administration fee before we make a home visit or begin any work on your product.

We recommend you read this manually thoroughly, search for a solution on line at www.samsung.com, or contact Samsung Customer Care before seeking to repair your product.

Disc and Format Compatibility

Disc types and contents your product can play

Contents	Media	Details
VIDEO	Blu-ray Disc 3D Blu-ray Disc	BD-ROM or BD-RE/R disc recorded in the BD-RE format.
	DVD-VIDEO DVD±RW/±R CD-RW/R	DVD-VIDEO, DVD±RW/±R discs that have been recorded and finalized. Media containing DivX, MKV or MP4 contents.
MUSIC	CD-RW/R DVD±RW/±R BD-RE/R	Music recorded on CD-RW/R, DVD±RW/±R, BD-RE/R containing MP3 or WMA contents.
PHOTO	CD-RW/R DVD±RW/±R BD-RE/R	Photos recorded on CD-RW/R, DVD±RW/±R, BD-RE/R media containing JPEG contents.
VIDEO MUSIC PHOTO	HDD USB	Video, music and photos stored in HDD or USB.

Disc types your product cannot play

- HD DVD
- DVD-ROM/PD/
MV-Disc, etc
- DVD-RAM
- Super Audio CD
(except CD layer)
- DVD-RW(VR mode)
- CVD/CD-ROM/CDV/
CD-G/CD-I/LD
(CD-Gs play audio only,
not graphics.)
- 3.9 GB DVD-R for
Authoring.

NOTE

- ▶ The product may not play certain CD-RW/R and DVD±RW/±R because of the recording conditions.
- ▶ If a DVD±RW/±R has not been recorded properly in DVD video format, it will not be playable.
- ▶ Your product will not play content that has been recorded on a DVD±RW/±R at a bit-rate that exceeds 10 Mbps.
- ▶ Your product will not play content that has been recorded on a BD-RE/R at a bit rate that exceeds 25 Mbps.
- ▶ Playback may not work for some types of discs, or when you use specific operations, such as angle change and aspect ratio adjustment. Information about the discs is written in detail on the disc box. Please refer to this if necessary.
- ▶ When you play a BD-J title, loading may take longer than a normal title or some functions may perform slowly.

Copy Protection

- Because AACS (Advanced Access Content System) is approved as content protection system for Blu-ray Disc format, similar to use of CSS (Content Scramble System) for DVD format, certain restrictions are imposed on playback, analogue signal output, etc., of AACS protected contents. The operation of this product and restrictions on this product may vary depending on your time of purchase as those restrictions may be adopted and/or changed by AACS after the production of this product. Furthermore, BD-ROM Mark and BD+ are additionally used as content protection system for Blu-ray Disc format, which imposes certain restrictions including playback restrictions for BD-ROM Mark and/or BD+ protected contents. To obtain additional information on AACS, BD-ROM Mark, BD+, or this product, please contact SAMSUNG customer care centre.

- Many Blu-ray Disc/DVDs are encoded with copy protection. Because of this, you should only connect your Product directly to your TV, not to a VCR. Connecting to a VCR results in a distorted picture from copy-protected Blu-ray Disc/DVDs.
- Under the U.S. Copyright laws and Copyright laws of other countries, unauthorized recording, use, display, distribution, or revision of television programmes, videotapes, Blu-ray Discs, DVDs, and other materials may subject you to civil and/or criminal liability.
- **Cinavia Notice** : This product uses Cinavia technology to limit the use of unauthorized copies of some commercially-produced film and videos and their soundtracks. When a prohibited use of an unauthorized copy is detected, a message will be displayed and playback or copying will be interrupted.
More information about Cinavia technology is provided at the Cinavia Online Consumer Information Centre at <http://www.cinavia.com>. To request additional information about Cinavia by mail, send a postcard with your mailing address to: Cinavia Consumer Information Centre, P.O. Box 86851, San Diego, CA, 92138, USA.
This product incorporates proprietary technology under licence from Verance Corporation and is protected by U.S. Patent 7,369,677 and other U.S. and worldwide patents issued and pending as well as copyright and trade secret protection for certain aspects of such technology. Cinavia is a trademark of Verance Corporation.
Copyright 2004-2010 Verance Corporation. All rights reserved by Verance. Reverse engineering or disassembly is prohibited.

Network Service Disclaimer

All content and services accessible through this device belong to third parties and are protected by copyright, patent, trademark and/or other intellectual property laws. Such content and services are provided solely for your personal noncommercial use. You may not use any content or services in a manner that has not been authorized by the content owner or service provider. Without limiting the foregoing, unless expressly authorized by the applicable content owner or service provider, you may not modify, copy, republish, upload, post, transmit, translate, sell, create derivative works, exploit, or distribute in any manner or medium any content or services displayed through this device.

THIRD PARTY CONTENT AND SERVICES ARE PROVIDED "AS IS." SAMSUNG DOES NOT WARRANT CONTENT OR SERVICES SO PROVIDED, EITHER EXPRESSLY OR IMPLIEDLY, FOR ANY PURPOSE. SAMSUNG EXPRESSLY DISCLAIMS ANY IMPLIED WARRANTIES, INCLUDING BUT NOT LIMITED TO, WARRANTIES OF MERCHANTABILITY OR FITNESS FOR A PARTICULAR PURPOSE. SAMSUNG DOES NOT GUARANTEE THE ACCURACY, VALIDITY, TIMELINESS, LEGALITY, OR COMPLETENESS OF ANY CONTENT OR SERVICE MADE AVAILABLE THROUGH THIS DEVICE AND UNDER NO CIRCUMSTANCES, INCLUDING NEGLIGENCE, SHALL SAMSUNG BE LIABLE, WHETHER IN CONTRACT OR TORT, FOR ANY DIRECT, INDIRECT, INCIDENTAL, SPECIAL OR CONSEQUENTIAL DAMAGES, ATTORNEY FEES, EXPENSES, OR ANY OTHER DAMAGES ARISING OUT OF, OR IN CONNECTION WITH, ANY INFORMATION CONTAINED IN, OR AS A RESULT OF THE USE OF ANY CONTENT OR SERVICE BY YOU OR ANY THIRD PARTY, EVEN IF ADVISED OF THE POSSIBILITY OF SUCH DAMAGES.

Third party services may be terminated or interrupted at any time, and Samsung makes no representation or warranty that any content or service will remain available for any period of time. Content and services are transmitted by third parties by means of networks and transmission facilities over which Samsung has no control. Without limiting the generality of this disclaimer, Samsung expressly disclaims any responsibility or liability for any interruption or suspension of any content or service made available through this device.

Samsung is neither responsible nor liable for customer service related to the content and services. Any question or request for service relating to the content or services should be made directly to the respective content and service providers.

Licence

- Manufactured under license from Dolby Laboratories. Dolby and the double-D symbol are trademarks of Dolby Laboratories.



- Manufactured under licence under U.S. Patent Nos: 5,956,674; 5,974,380; 6,226,616; 6,487,535; 7,212,872; 7,333,929; 7,392,195; 7,272,567 & other U.S. and worldwide patents issued & pending. DTS-HD, the Symbol, & DTS-HD and the Symbol together are registered trademarks & DTS-HD Master Audio is a trademark of DTS, Inc. Product includes software. © DTS, Inc. All Rights Reserved.



- DivX

- ABOUT DIVX VIDEO: DivX[®] is a digital video format created by DivX, LLC, a subsidiary of Rovi Corporation. This is an official DivX Certified[®] device that plays DivX video. Visit divx.com for more information and software tools to convert your files into DivX videos.
- ABOUT DIVX VIDEO-ON-DEMAND: This DivX Certified[®] device must be registered in order to play purchased DivX Video-on-Demand (VOD) movies. To obtain your registration code, locate the DivX VOD section in your device setup menu. Go to vod.divx.com for more information on how to complete your registration.
- DivX Certified[®] to play DivX[®] video up to HD 1080p, including premium content. DivX[®], DivX Certified[®] and associated logos are trademarks of Rovi Corporation or its subsidiaries and are used under license. Covered by one or more of the following U.S. patents : 7,295,673; 7,460,668; 7,515,710; 7,519,274



- The terms HDMI and HDMI High-Definition Multimedia Interface, and the HDMI Logo are trademarks or registered trademarks of HDMI Licensing LLC in the United States and other countries.



- Oracle and Java are registered trademarks of Oracle and/or its affiliates. Other names may be trademarks of their respective owners



- Rovi Flow-Down Licence Terms (Terms of Use)
 - This application incorporates software and technology of Rovi Corporation ("Rovi"). The Rovi software and technology (collectively, the "Rovi Technology") allows End Users to access music-related data ("Rovi Data") over the Internet and otherwise from proprietary Rovi databases (the "Rovi Databases") located on Rovi servers (the "Rovi Servers") and to perform other functions. You may access and use Rovi Data only by means of the intended End User functions of this application software.
 - You agree that you will use the Rovi Data, the Rovi Technology, and the Rovi Servers for your own personal non-commercial use only. You agree not to assign, copy, transfer or transmit the Rovi Data to any third party. You agree not to use or exploit Rovi Data, the Rovi Technology, the Rovi Databases, or the Rovi Servers, except as expressly permitted herein.
 - You agree that your non-exclusive licence to access the Rovi Databases and to use the Rovi Data, the Rovi Technology, and the Rovi Servers will terminate if you violate these restrictions. If your licence terminates, you agree to cease any and all use of the Rovi Data, the Rovi Technology, and the Rovi Servers. Rovi reserves all rights in Rovi Data, the Rovi Technology, and Rovi Servers, including all ownership rights. You agree that Rovi may enforce its rights under this Agreement against you directly in its own name.
 - Rovi reserves the right to delete data from the Rovi Databases or to change data categories for any cause that Rovi deems sufficient. No warranty is made that the Rovi Technology or Rovi Servers are error-free or that functioning of Rovi Technology or Rovi Servers will be uninterrupted. Rovi is not obligated to provide you with any new enhanced or additional data types or categories that Rovi may choose to provide in the future and is free to discontinue its online services at any time.

- The data you submit to use will not be personal data or personally identifiable data, but rather only data respecting music albums and associated data that does not appear in the Rovi Lookup Database. You certify that to the best of its knowledge the album to which the submitted data corresponds is commercially available and that you End User are lawfully permitted to submit the data.
- To the extent that you, the End User, provide any information or original works of authorship to be added to Rovi Databases, you represent and warrant that you are the sole author of such work(s) and further hereby assign to Rovi all rights of copyright therein, including the right to register the copyright in such work(s) as part of the Rovi Database.
- THE ROVITECHNOLOGY AND EACH ITEM OF ROVI DATA ARE LICENCED TO YOU "AS IS." ROVI MAKES NO REPRESENTATIONS OR WARRANTIES, EXPRESS OR IMPLIED, REGARDING THE ACCURACY OF ANY ROVI DATA ON THE ROVI SERVERS. ROVI DISCLAIMS ALL WARRANTIES EXPRESS OR IMPLIED, INCLUDING, BUT NOT LIMITED TO, IMPLIED WARRANTIES OF MERCHANTABILITY, FITNESS FOR A PARTICULAR PURPOSE, TITLE AND NON-INFRINGEMENT. ROVI DOES NOT WARRANT THE RESULTS THAT WILL BE OBTAINED BY YOUR USE OF THE ROVI TECHNOLOGY OR ANY ROVI SERVER. IN NO CASE WILL ROVI BE LIABLE TO YOU OR ANY THIRD PARTY FOR ANY CONSEQUENTIAL OR INCIDENTAL DAMAGES OR FOR ANY LOST PROFITS OR LOST REVENUES RESULTING FROM YOUR USE OF ROVI DATA, THE ROVI TECHNOLOGY OR OTHERWISE.
- Open Source Licence Notice
 - In the case of using open source software, Open Source Licences are available on the product menu.
- Blu-ray Disc™, Blu-ray™, and the logos are trademarks of Blu-ray Disc Association.



Recommendation - EU Only

- Hereby, Samsung Electronics, declares that this BD-HDD Combo is in compliance with the essential requirements and other relevant provisions of Directive 1999/5/EC. The official Declaration of Conformity may be found at <http://www.samsung.com>, go to Support > Search Product Support and enter the model name. This equipment may be operated in all EU countries. This equipment may only be used indoors.



Warning

TO REDUCE THE RISK OF ELECTRIC SHOCK, DO NOT REMOVE THE COVER (OR BACK). NO USER-SERVICEABLE PARTS ARE INSIDE. REFER SERVICING TO QUALIFIED SERVICE PERSONNEL.

	CAUTION RISK OF ELECTRIC SHOCK DO NOT OPEN	
This symbol indicates "dangerous voltage" inside the product that presents a risk of electric shock or personal injury.	CAUTION: TO REDUCE THE RISK OF ELECTRIC SHOCK, DO NOT REMOVE COVER (OR BACK) NO USER SERVICEABLE PARTS INSIDE. REFER SERVICING TO QUALIFIED SERVICE PERSONNEL.	This symbol indicates important instructions accompanying the product.

Do not install this equipment in a confined space such as a bookcase or similar unit.

WARNING

- To prevent damage which may result in fire or electric shock hazard, do not expose this appliance to rain or moisture.

CAUTION

- BD-HDD COMBO USES AN INVISIBLE LASER BEAM WHICH CAN CAUSE HAZARDOUS RADIATION EXPOSURE IF DIRECTED. BE SURE TO OPERATE BD-HDD Combo CORRECTLY AS INSTRUCTED.

CAUTION

THIS PRODUCT UTILIZES A LASER. USE OF CONTROLS OR ADJUSTMENTS OR PERFORMANCE OF PROCEDURES OTHER THAN THOSE SPECIFIED HEREIN MAY RESULT IN HAZARDOUS RADIATION EXPOSURE. DO NOT OPEN COVERS AND DO NOT REPAIR YOURSELF. REFER SERVICING TO QUALIFIED PERSONNEL.

This product satisfies CE regulations when shielded cables and connectors are used to connect the unit to other equipment. To prevent electromagnetic interference with electric appliances, such as radios and televisions, use shielded cables and connectors for connections.

IMPORTANT NOTE

The mains lead on this equipment is supplied with a molded plug incorporating a fuse. The value of the fuse is indicated on the pin face of the plug. If it requires replacing, a fuse approved to BS1362 of the same rating must be used.

Never use the plug with the fuse cover omitted if the cover is detachable. If a replacement fuse cover is required, it must be of the same colour as the pin face of the plug. Replacement covers are available from your dealer.

If the fitted plug is not suitable for the power points in your house or the cable is not long enough to reach a power point, you should obtain a suitable safety approved extension lead or consult your dealer for assistance.

However, if there is no alternative to cutting off the plug, remove the fuse and then safely dispose of the plug. Do not connect the plug to a mains jack, as there is a risk of shock hazard from the bared flexible cord.

To disconnect the apparatus from the mains, the plug must be pulled out from the mains socket, therefore the mains plug shall be readily operable.

The product unit accompanying this user manual is licenced under certain intellectual property rights of certain third parties.

CLASS 1 LASER PRODUCT

This Compact Disc player is classified as a CLASS 1 LASER product. Use of controls, adjustments or performance of procedures other than those specified herein may result in hazardous radiation exposure.

CAUTION :

- CLASS 3B VISIBLE AND INVISIBLE LASER RADIATION WHEN OPEN. AVOID EXPOSURE TO THE BEAM (IEC 60825-1)
- THIS product UTILIZES A LASER. USE OF CONTROLS OR ADJUSTMENTS OR PERFORMANCE OF PROCEDURES OTHER THAN THOSE SPECIFIED HEREIN MAY RESULT IN HAZARDOUS RADIATION EXPOSURE. DO NOT OPEN COVER AND DO NOT REPAIR YOURSELF. REFER SERVICING TO QUALIFIED PERSONNEL.

CLASS 1	LASER PRODUCT
KLASSE 1	LASER PRODUKT
LUOKAN 1	LASER LAITE
KLASS 1	LASER APPARAT
PRODUCTO	LÁSER CLASE 1

Precautions

Important Safety Instructions

Read these operating instructions carefully before using the unit. Follow all the safety instructions listed below.

Keep these operating instructions handy for future reference.

1. Read these instructions.
2. Keep these instructions.
3. Heed all warnings.
4. Follow all instructions.
5. Do not use this apparatus near water.
6. Clean only with a dry cloth.
7. Do not block any ventilation openings. Install in accordance with the manufacturer's instructions.
8. Do not install near any heat sources such as radiators, heat registers, stoves, or other apparatus (including AV receivers) that produce heat.

9. Do not defeat the safety purpose of the polarized or grounding-type plug. A polarized plug has two blades with one wider than the other. A grounding type plug has two blades and a third grounding prong. The wide blade or the third prong are provided for your safety. If the provided plug does not fit into your outlet, consult an electrician for replacement of the obsolete outlet.
10. Protect the power cord from being walked on or pinched particularly at plugs, convenience receptacles, and the point where it exits the apparatus.
11. Only use attachments/accessories specified by the manufacturer.
12. Use only with the cart, stand, tripod, bracket, or table specified by the manufacturer, or sold with the apparatus. When a cart is used, use caution when moving the cart/apparatus combination to avoid injury from tip-over.
13. Unplug this apparatus during lightning storms or when unused for long periods of time.
14. Refer all servicing to qualified service personnel. Servicing is required when the apparatus has been damaged in any way, such as when the power-supply cord or plug is damaged, liquid has been spilled or objects have fallen into the apparatus, the apparatus has been exposed to rain or moisture, does not operate normally, or has been dropped.



Disc Storage & Management

- Holding Discs
 - Fingerprints or scratches on the disc may reduce sound and picture quality or cause skipping
 - Avoid touching the surface of a disc where data has been recorded.
 - Hold the disc by the edges so that fingerprints will not get on the surface.
 - Do not stick paper or tape on the disc.



- Cleaning Discs
 - If you get fingerprints or dirt on the disc, clean it with a mild detergent diluted in water and wipe with a soft cloth.
 - When cleaning, wipe gently from the inside to the outside of the disc.
- Disc Storage
 - Do not keep in direct sunlight.
 - Keep in a cool ventilated area.
 - Keep in a clean protection jacket and store vertically.



Handling Cautions

- Do not expose this apparatus to dripping or splashing. Do not put objects filled with liquids, such as vases on the apparatus.
 - To turn this apparatus off completely, you must pull the power plug out of the wall socket. Consequently, the power plug must be easily and readily accessible at all times.
 - Do not plug multiple electric devices into the same wall socket. Overloading a socket can cause it to overheat, resulting in a fire.
 - Before connecting other components to this player, be sure to turn them off.
 - If you move your player suddenly from a cold place to a warm place, condensation may occur on the operating parts and lens and cause abnormal disc playback. If this occurs, unplug the player, wait for two hours, and then connect the plug to the power outlet. Then, insert the disc, and try to play back again.
 - If the product makes an abnormal noise or produces a burning smell or smoke, turn off the power switch immediately and disconnect the power plug from the wall outlet. Then, contact the nearest customer service center for technical assistance. Do not use the product. Using the product as it is may cause a fire or an electric shock.
- Your product supports the FAT16, FAT32, and NTFS files systems (read only).
 - Connect USB devices directly to the product's USB port. Connecting through a USB cable may cause compatibility problems.
 - Inserting more than one memory device into a multi-card reader may cause the reader to operate improperly.
 - The product supports the PTP protocol.
 - Do not disconnect a USB device during a "loading" process.
 - The bigger the image resolution, the longer the image takes to display.
 - This product cannot play MP3 files with DRM (Digital Rights Management) downloaded from commercial sites.
 - Your product only supports video that is under 30fps (frame rate).
 - Your product only supports USB Mass Storage Class (MSC) devices such as thumb drives, flash card readers and USB HDD. (HUB is not supported.)
 - Certain USB HDD Devices, multi-card readers and thumb drives may not be compatible with this product.
 - If some USB devices require excessive power, they may be limited by the circuit safety device.
 - If playback from a USB HDD is unstable, provide additional power by plugging the HDD into a wall socket. If the problem continues, contact the USB HDD manufacturer.
 - During the playback or copying, do not disconnect a USB device.
 - SAMSUNG is not responsible for any data file damage or data loss.
 - Your product does not support compression file, sparse file and encryption file of NTFS
 - You can repair or format a USB device on your Desktop PC. (MS-Windows OS only)

Notes on the USB connection

- Your product supports USB storage media, MP3 products, digital cameras, and USB card readers.
- Some USB/digital camera devices may not be compatible with the product.

Connect a USB device before using the Timeshift and Recorded TV functions

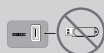

Do not use a USB memory stick. We do not support a USB memory stick.

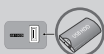

We recommend using a USB HDD with at least 5400 rpm, but a USB HDD of RAID type is not supported.

- To use the Timeshift mode or the Recorded TV function, a connected USB device must be execute the Device Format function to proper form for recording.
 - During the device formatting, do not disconnect the device while formatting is in progress. If you format the device, all files will be deleted.
 - Before formatting your device to this product, please back up your files to prevent them from damage or loss of data. SAMSUNG is not responsible for any data file damage or data loss.
- Recorded videos are DRM (digital rights managements) protected and cannot be played on a PC or other product. Note that files saved on the TV cannot be used after the main board is changed.
- At least 100 MB of free space is required for recording.
- Recording will stop if the storage's free space becomes less than 50 MB.
- If the USB device has failed the Device Performance Test, the USB device must go through the Device Format and Device Performance Test again before you record with the Guide or Channel Manager. If the device has failed the Performance Test, It cannot be used for recording.

Note on the firmware upgrade of CAM

Some CAM in the market with older firmware versions are not fully interoperable with this device that is compliant to v1.3 specification.

It is a problem of legacy CAM, not this CI Plus compliant device.

In this case, this problem can be resolved by applying a firmware upgrade to the CAM.

Please contact your network operator or CAM operator for it.



check whether the firmware of CAM is upgraded for compatibility with CI+ 1.3 Version.

Using the 3D function

IMPORTANT HEALTH AND SAFETY INFORMATION FOR 3D PICTURES.

Read and understand the following safety information before using the 3D function.

- Some viewers may experience discomfort while viewing 3D TV such as dizziness, nausea, and headaches.
If you experience any such symptom, stop viewing 3D TV, remove the 3D Active Glasses, and rest.
- Watching 3D images for an extended period of time may cause eye strain. If you feel eye strain, stop viewing 3D TV, remove your 3D Active Glasses, and rest.
- A responsible adult should frequently check on children who are using the 3D function. If there are any reports of tired eyes, headaches, dizziness, or nausea, have the child stop viewing 3D TV and rest.
- Do not use the 3D Active Glasses for other purposes. (Such as general eyeglasses, sunglasses, protective goggles, etc.)
- Do not use the 3D function or 3D Active Glasses while walking or moving around. Using the 3D function or 3D Active Glasses while moving around may cause you to bump into objects, trip, and/or fall, and cause serious injury.
- When displaying 3D programme with this model, the actual screen may appear as shown below:

Screen Display		Description
	Side by Side	Same screen duplicates horizontally.
	Top & Bottom	Same screen duplicates vertically.

- 3D programme reception, recording and playback of this model may not fully support 3D, due to the 3D broadcast format is not yet standardized worldwide. It is not the product's malfunction or disorder.
- If you want to enjoy 3D content, connect a 3D device (3D compliant AV receiver or TV) to the product's HDMI OUT port using a high-speed HDMI cable. Put on 3D glasses before playing the 3D content.
- The product outputs 3D signals only through HDMI cable connected to the HDMI OUT port.
- As the video resolution in 3D play mode is fixed according to the resolution of the original 3D video, you can not change the resolution to your preference.
- Some functions such as BD Wise, screen size adjustment, and resolution adjustment may not operate properly in 3D play mode.
- You must use a high-speed HDMI cable for proper output of the 3D signal.
- Stay at least three times the width of the screen from the TV when watching 3D images. For example, if you have a 46-inch screen, stay 138 inches (11.5 feet) from the screen.
- Place the 3D video screen at eye level for the best 3D picture.
- When the product is connected to some 3D devices, the 3D effect may not function properly.
- "Blu-ray 3D" and "Blu-ray 3D" logo are trademarks of the Blu-ray Disc Association.

Specifications

General	Weight	2.6Kg
	Dimensions	430 (W) x 282 (D) x 55 (H) mm
	Operating Temperature Range	+5°C to +35°C
	Operating Humidity Range	10 % to 75 %
HDMI	Video	Resolution : 1080p, 1080i, 720p, 576p/480p
	Audio	PCM, Bitstream
Audio Output	Digital	TOS-Link Optical
Network	Ethernet	100BASE-TX Terminal
	Wireless LAN	Built-in
	Security	WEP(OPEN/SHARED) WPA-PSK(TKIP/AES) WPA2-PSK(TKIP/AES)
	WPS(PBC)	Supported
HDD Capacity	BD-F8500M	500 GB
	BD-F8900M	1 TB

- Network speeds equal to or below 10 Mbps are not supported.
- Design and specifications are subject to change without prior notice.
- For the power supply and power consumption, refer to the label attached to the product.
- Weight and dimensions are approximate.



UNITED KINGDOM



EIRE

This Samsung product is warranted for the period of twelve (12) months from the original date of purchase, against defective materials and workmanship. In the event that warranty service is required, you should return the product to the retailer from whom it was purchased.

However, Samsung Authorised Dealers and Authorised Service Centres in other EC Countries will comply with the warranty on the terms issued to purchasers in the country concerned.

In case of difficulty, details of our Authorised Service Centres are available from:

**Customer Support Centre, PO Box 479,
Gatehead, Ne9 9BJ**

**United Kingdom
Tel: 0330 SAMSUNG (7267864)
Fax: 033 07260001
www.samsung.com/uk**

**Eire
Tel: 0818 717100
Fax: +44(0)117 915 6736
www.samsung.com/ie**

■ WARRANTY CONDITIONS

1. The warranty is only valid if, when warranty service is required, the warranty card is fully and properly completed and is presented with the original invoice or sales slip or confirmation, and the serial number on the product has not been defaced.
2. Samsung's obligations are limited to the repair or, at its discretion, replacement of the product or the defective part.
3. Warranty repairs must be carried out by Authorised Samsung Dealers or Authorised Service Centres.
No re-imburement will be made for repairs carried out by non Samsung Dealers and, any such repair work and damage to the products caused by such repair work will not be covered by this warranty.

4. This product is not considered to be defective in materials nor workmanship by reason that it requires adaptation in order to conform to national or local technical or safety standards in force in any Country other than the one for which the product was originally designed and manufactured. This warranty will not cover, and no re-imburement will be made for such adaptation nor any damage which may result.
5. This warranty covers none of the following:
 - a) Periodic check ups, maintenance and repair or replacement of parts due to normal wear and tear.
 - b) Cost relating to transport, removal or installation of the product.
 - c) Misuse, including the failure to use this product for its normal purposes or incorrect installation.
 - d) Damage caused by Lightning, Water, Fire, Acts of God, War, Public Disturbances, incorrect mains voltage, improper ventilation or any other cause beyond the control of Samsung.
6. This warranty is valid for any person who legally acquired possession of the product during the warranty period.
7. The consumers statutory rights in any applicable national legislation whether against the retailer arising from the purchase contract or otherwise are not affected by this warranty. Unless there is national legislation to the contrary, the rights under this warranty are the consumers sole rights and Samsung, its subsidiaries and distributors shall not be liable for indirect or consequential loss or any damage to records, compact discs, videos or audio taper or any other related equipment or material.

SAMSUNG ELECTRONICS (U.K.) LTD.

Contact SAMSUNG WORLD WIDE

If you have any questions or comments relating to Samsung products, please contact the SAMSUNG customer care centre.

Area	Contact Centre ☎	Web Site
ALBANIA	42 27 5755	www.samsung.com
AUSTRIA	0810 - SAMSUNG (7267864, € 0.07/min)	www.samsung.com
BELGIUM	02-201-24-18	www.samsung.com/be (Dutch) www.samsung.com/be_fr (French)
BOSNIA	05 133 1999	www.samsung.com
BULGARIA	07001 33 11	www.samsung.com
CROATIA	062 SAMSUNG (062 726 7864)	www.samsung.com
CZECH	800 - SAMSUNG (800-726786)	www.samsung.com
DENMARK	70 70 19 70	www.samsung.com
FINLAND	030 - 6227 515	www.samsung.com
FRANCE	01 48 63 00 00	www.samsung.com
GERMANY	01805 - SAMSUNG(726-7864 € 0,14/Min)	www.samsung.com
CYPRUS	8009 4000 only from landline	www.samsung.com
GREECE	80111-SAMSUNG (80111 726 7864) only from land line (+30) 210 6897691 from mobile and land line	www.samsung.com
HUNGARY	06-80-SAMSUNG(726-7864)	www.samsung.com
ITALIA	800-SAMSUNG(726-7864)	www.samsung.com
KOSOVO	+381 0113216899	www.samsung.com
LUXEMBURG	261 03 710	www.samsung.com
MONTENEGRO	020 405 888	www.samsung.com

Area	Contact Centre ☎	Web Site
NETHERLANDS	0900-SAMSUNG (0900-7267864) (€ 0,10/Min)	www.samsung.com
NORWAY	815-56 480	www.samsung.com
POLAND	0 801-1SAMSUNG(172-678) +48 22 607-93-33	www.samsung.com
PORTUGAL	808 20-SAMSUNG (808 20 7267)	www.samsung.com
ROMANIA	08010 SAMSUNG (08010 726 7864) only from landline (+40) 21 206 01 10 from mobile and land line	www.samsung.com
SERBIA	0700 Samsung (0700 726 7864)	www.samsung.com
SLOVAKIA	0800 - SAMSUNG(0800-726 786)	www.samsung.com
SPAIN	902 - 1 - SAMSUNG (902 172 678)	www.samsung.com
SWEDEN	0771 726 7864 (SAMSUNG)	www.samsung.com
Switzerland	0848 - SAMSUNG(7267864, CHF 0.08/min)	www.samsung.com/ch www.samsung.com/ch_fr (French)
U.K	0330 SAMSUNG (7267864)	www.samsung.com
EIRE	0818 717100	www.samsung.com
LITHUANIA	8-800-77777	www.samsung.com
LATVIA	8000-7267	www.samsung.com
ESTONIA	800-7267	www.samsung.com



Correct disposal of batteries in this product

(Applicable in the European Union and other European countries with separate battery return systems.)

This marking on the battery, manual or packaging indicates that the batteries in this product should not be disposed of with other household waste at the end of their working life. Where marked, the chemical symbols *Hg*, *Cd* or *Pb* indicate that the battery contains mercury, cadmium or lead above the reference levels in EC Directive 2006/66.

If batteries are not properly disposed of, these substances can cause harm to human health or the environment.

To protect natural resources and to promote material reuse, please separate batteries from other types of waste and recycle them through your local, free battery return system.



Correct Disposal of This Product (Waste Electrical & Electronic Equipment)

(Applicable in the European Union and other European countries with separate collection systems)

This marking on the product, accessories or literature indicates that the product and its electronic accessories (e.g. charger, headset, USB cable) should not be disposed of with other household waste at the end of their working life.

To prevent possible harm to the environment or human health from uncontrolled waste disposal, please separate these items from other types of waste and recycle them responsibly to promote the sustainable reuse of material resources.

Household users should contact either the retailer where they purchased this product, or their local government office, for details of where and how they can take these items for environmentally safe recycling.

Business users should contact their supplier and check the terms and conditions of the purchase contract.

This product and its electronic accessories should not be mixed with other commercial wastes for disposal.

© 2013 Samsung Electronics Co.,Ltd. All rights reserved; No part or whole of this user's manual may be reproduced or copied without the prior written permission of Samsung Electronics Co.,Ltd.



AK68-02350J-01