

PHILIPS

NORELCO

SERIES 7000
SHAVER 7300



S7370

*Rechargeable Cordless
Tripleheader Shaver*

Always here to help you

Register your product and get support at
www.norelco.com/register

BC

Question?
Contact
Philips
Norelco

ENGLISH 4

Congratulations on your purchase and welcome to Philips Norelco!

To fully benefit from the support that Philips Norelco offers, register your product at www.norelco.com/register

S7370

IMPORTANT SAFETY INSTRUCTIONS

When using an electric appliance, basic precautions should always be followed, including the following:

Read all instructions before using this appliance.

DANGER

To reduce the risk of electric shock:

1. Do not reach for a corded shaver/SmartClean System that has fallen into water. Unplug immediately.
2. Power plug and the accessories connected to it are not for immersion or for use in shower.
3. Do not use an extension cord with this appliance.
4. Do not place or store a SmartClean System where it can fall or be pulled into a tub or sink. Do not place or drop a SmartClean System into water or other liquid.
5. Always unplug this shaver/SmartClean System from the electrical outlet immediately after use, except when shaver/SmartClean System is (re)charging.
6. Unplug and remove power supply cord from shaver before cleaning.
7. The batteries used in this device may present a fire or chemical burn hazard if mistreated. Do not disassemble, heat above 100°C (212°F) or incinerate.

WARNING

To reduce the risk of burns, fire, electric shock, or injury to persons:

1. Close supervision is necessary when this shaver/SmartClean System is used by, on, or near children or invalids.
2. Use this shaver/SmartClean System for its intended household use as described in this manual. Do not use attachments or a cleaning cartridge not recommended by Philips Electronics

North America Corporation.

3. Never operate this shaver/SmartClean System if it has a damaged cord or charging plug, if it is not working properly, if it has been dropped or damaged, or dropped into water while plugged in. For assistance call 1-800-243-3050.
4. Keep the shaver/SmartClean System, cord and charging plug away from heated surfaces.
5. Never drop or insert any object into any opening.
6. Do not clean, charge or plug in shaver/SmartClean System outdoors or operate where aerosol (spray) products are being used or where oxygen is being administered.
7. Do not use this shaver with a damaged or broken comb, as facial injury may occur.
8. Always attach plug to shaver/SmartClean System first, then plug into outlet and then put shaver in SmartClean System. Be certain plug is inserted firmly into shaver/SmartClean System, up to mark indicated on plug. To disconnect, turn SmartClean System off, remove charging plug from outlet.
9. Never put the shaver/SmartClean System in direct sunlight or store at a temperature above 140°F (60°C).
10. Keep the cord dry at all times. Do not handle with wet hands.
11. To prevent possible damage to the cord, do not wrap cord around the shaver/SmartClean System.
12. Only use the power plug and other accessories supplied with the appliance.

SAVE THESE INSTRUCTIONS

IMPORTANT: The power plug contains a transformer. Do not cut off the power plug to replace it with another plug, as this will cause a hazardous condition.

PHILIPS

 NORELCO**45 - DAY MONEY-BACK GUARANTEE**

To enjoy the closest and most comfortable shave from your new Philips Norelco Men's Shaver, the shaver should be used **exclusively** for 3 weeks. This allows your hair and skin enough time to adapt to the Philips Norelco Shaving System. If, after that period of time, you are not fully satisfied with your Philips Norelco Men's Shaver, send the product back along with dated sales receipt and we'll refund you the full purchase price. **The shaver must be shipped prepaid by insured mail, insurance prepaid, have the original sales receipt, indicating purchase price, the date of purchase, and the money-back guarantee return authorization form enclosed. We cannot be responsible for lost mail.**

The shaver must be postmarked **no later than 45 days** from the date of purchase. Philips Norelco reserves the right to verify the purchase price of the shaver and limit refunds not to exceed suggested retail price.

To obtain money-back guarantee return authorization form, call 1-800-243-3050 for assistance. Delivery of refund check will occur 6-8 weeks **AFTER** receipt of returned product.

Table of Contents

Features	8-11
LED Display	12-13
Before First Use	13-14
Charging	14-16
Recharging	16
Quick Charge	16
Put It To The Test & Shaving Tips	17
How to Shave	
With An Electric Shaver	17-19
Using the SmartClick Trimmer	20-21
Travel Lock	21-22
Cleaning	22-31
Replacing the Shaving Heads	32-35
Maintenance	35
Storage	36
Assistance	36
Battery Recycling	37
Accessories	38
Warranty	39

Features

DynamicFlex Technology

Shaving Unit

- Hair Chamber captures shaven hair

Comfort Rings

Electronic On/Off Button

Cleaning Indicator

Replacement Shaving Heads Indicator

Travel Lock

'Unplug for use' Indicator

Battery Display

- Battery Charge, Full & Low Indicators

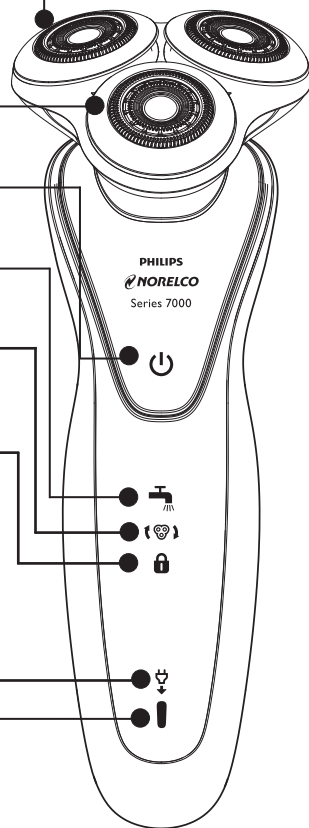

SmartClick Precision Trimmer

Automatic Worldwide Voltage 100V to 240V AC

Travel Case

Rechargeable 1-hour full charge for up to 50 min. of cordless shaving time

Quick Charge - For one shave

Cordless - To shave without a cord

Full 2-Year Warranty

45-Day Money-Back Guarantee

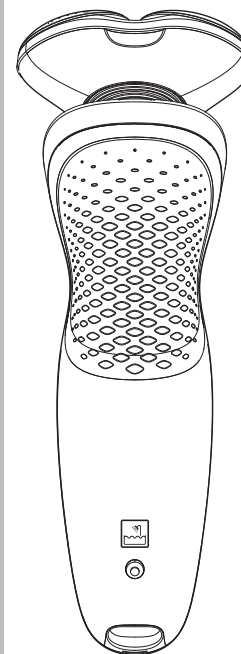

Features

SmartClean System

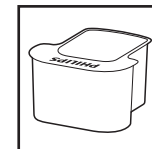
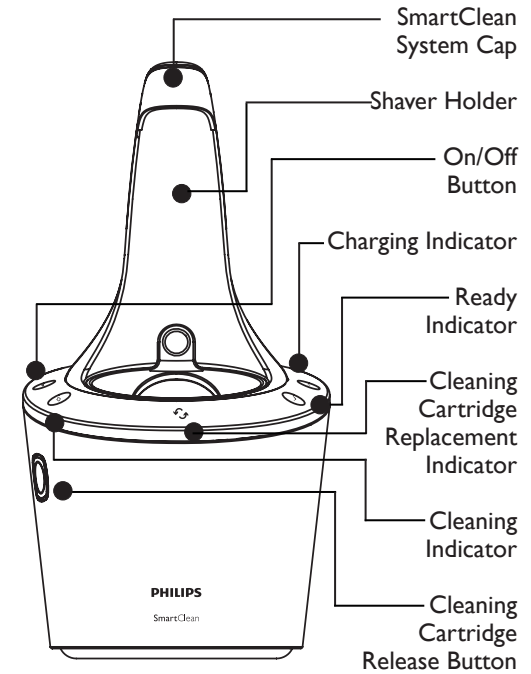

Cleaning Cartridge

LED Display

- ▶ Remove any sticker or protective foil from the display before using shaver.
- ▶ The display provides the following information:

▶ Charging Indicator

- Quick charge: When the shaver does NOT contain enough energy for one shave, the charging light will blink quickly.
- If the shaver does contain enough energy for one shave, the charging light will blink slowly.

▶ Full Charge Indicator

- When the battery has been fully charged, the charging light lights up continuously. After approximately 30 minutes the display automatically switches off again.
- If the on/off button is pressed during or after charging, the 'unplug for use' symbol will blink indicating the shaver is still connected to the outlet.

▶ Low Battery Indicator

- When the battery is almost empty (5 or less shaving minutes left), the charging light blinks orange.

▶ 'Unplug For Use' Indicator

- The 'unplug for use' symbol will blink to remind you the shaver is connected to the outlet.

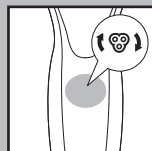
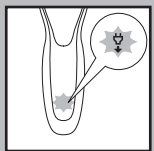
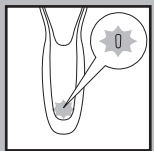
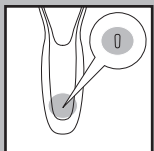
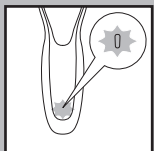

▶ Replacement Shaving Heads Indicator

Every year, depending on your shaving behavior, the replacement shaving heads indicator lights up white continuously. See 'Replacing the Shaving Heads' section for instructions to reset the shaver. This reminds you that with new shaving heads you will guarantee yourself optimal shaving performance.

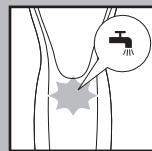

▶ Cleaning Indicator

For optimal shaving performance, we recommend cleaning the shaver after EACH use. The blinking faucet will remind you the shaving unit needs to be cleaned. This happens after each shave.

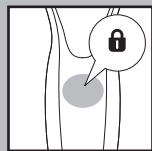

▶ Travel Lock

The shaver is equipped with a travel lock function. You can use the travel lock function when you are going to store the shaver for a longer period or if you are going to take the shaver with you when traveling. See 'Travel Lock' section for instructions on how to use this function.

Before First Use

- ▶ Charge the shaver before you start using it (see 'Charging'). Make sure the shaver is switched off before you start charging it.
- ▶ Remove any sticker or protective foil from the display before using shaver.

Important

- ▶ Only use the power cord or SmartClean System provided to charge the shaver.
- ▶ The power plug transforms 100-240V AC to less than 24V DC.

Charging

- ▶ Charging, recharging or storing at temperatures below 40°F or higher than 95°F adversely affects lifetime of batteries.
- ▶ Charging or recharging requires one full hour.
- ▶ A fully charged shaver has a shaving time of up to 50 minutes.
- ▶ You may recharge when the display indicates the battery is almost empty.
- ▶ This shaver will not operate corded directly from the electrical outlet.
- ▶ Do not charge the shaver in a pouch or travel case.

- 1** Connect cord directly to shaver (1) and connect the power plug into any 100V to 240V AC outlet (2). Use only the power cord provided.

- ▶ An adaptor plug may be necessary for power cord usage in some foreign countries. Use an attachment plug adaptor of the proper configuration for the power outlet.

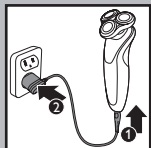

The power cord will automatically convert to work on 100V to 240V AC systems.

- 2** The display on the shaver will indicate shaver is charging.
- 3** Charging requires one full hour. A fully charged shaver has a cordless shaving time of up to 50 minutes.

Charging Shaver with SmartClean System

- 1** Connect the small plug to the SmartClean System. Connect the power plug into any 100V to 240V AC outlet. Use only the power cord provided.
- 2** Press the top cap down to open the SmartClean System.
- 3** Hold the shaver head side down above the shaver holder.

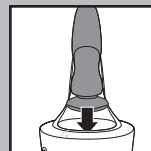
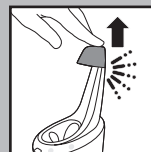

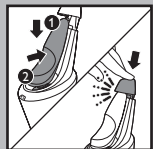

- 4** Place the shaver into the holder (1), push shaver back (2) and press down the top cap to connect the shaver (click).

The shaver will only fit in the SmartClean System in one direction.

- 5** The battery indicator lights up to indicate the shaver is charging.

- 6** Charging requires one full hour. A fully charged shaver has a cordless shaving time of up to 50 minutes.



- 7** Press the top cap down (1), pull the shaver forward (2) and lift shaver from holder (3).

Recharging

- 1** Recharging requires one full hour. Recharge when the display indicates the battery is almost empty.

Quick Charge

When batteries are empty, recharging the shaver for 5 minutes gives enough energy for one cordless shave.

Put It To The Test & Shaving Tips

- ▶ 21 Day Trial and Conversion Process. It is a fact that your skin and beard need time to adjust to a new shaving system.
- ▶ Use your new shaver exclusively for 3 weeks to fully enjoy the closeness of a Philips Norelco shave
- ▶ At first you may not get as close a shave as you expect, or your face may even become slightly irritated. This is normal since your beard and skin will need time to adjust. Invest 3 weeks and you'll soon experience the full joy of your new shaver.
- ▶ Stick with it! If you alternate shaving methods during the adjustment period, it may make it more difficult to adapt to the Philips Norelco shaving system.
- ▶ If you are still not convinced after 21 days, Philips Norelco will refund you the full purchase price as long as the request is received within 45 days of purchase.

How To Shave With An Electric Shaver

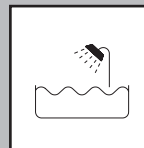

- ▶ This symbol on the shaver indicates that the shaver can be used in the bath or shower.
- ▶ Make sure the SmartClean System does not get wet or near water.
- ▶ Use this shaver for its intended household use as described in this manual.

Shaving

- For best results on skin comfort, pre-trim your beard if you have not shaved for 3 days or longer.



- 1** Turn shaver ON by pressing the on/off button once. Shave against the direction of beard growth using only circular movements.
- 2** Stretch your skin with your free hand so blades can lift and cut whiskers. Gently press shaver to skin so the floating heads can follow the contours of your face. DO NOT press too hard. Too much pressure can pinch the skin into the combs.
- 3** Turn shaver OFF by pressing the on/off button once.
- 4** Clean the shaver after each use (see chapter 'Cleaning').
- 5** Place the shaver in the SmartClean System to protect shaver heads.

Wet Shaving

You can also use the shaver on a wet face with shaving foam or gel.

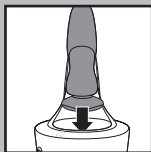

- 1** Apply some water to your skin.



- 2** Apply shaving foam or gel to your skin.

- 3** Rinse the shaving unit under the tap to ensure that the shaving unit glides smoothly over your skin.

- 4** Press the on/off button once to switch on the shaver.

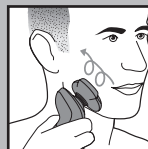

- 5** Move the shaving heads in circular movements over your skin.

NOTE: Rinse the shaver under the tap regularly to ensure that it continues to glide smoothly over your skin.

- 6** Dry your face and thoroughly clean the shaver after each use (see chapter 'Cleaning').

NOTE: Make sure you rinse all foam or gel off the shaver.

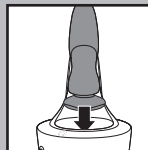

- 7** Place the shaver in the SmartClean System to protect heads.

Using the SmartClick Trimmer

To Groom Sideburns and Moustache



- 1** Pull the shaving unit straight off the shaver.
NOTE: Do not turn the shaving unit while you pull it off the shaver.



- 2** Insert the raised notch of the SmartClick trimmer into the slot in the top of the shaver. Press the trimmer down to attach it to the shaver. You will hear a 'click'.



- 3** Turn shaver ON.
- 4** Hold trimmer to exact hairline desired. Move trimmer downward with gentle pressure.
- 5** Trim beard, moustache or sideburns using the trimmer.

- 6** Turn shaver OFF when finished.

- 7** Thoroughly clean the trimmer (see 'Cleaning').



- 8** Pull the trimmer straight off the shaver.
NOTE: Do not turn or twist the trimmer while you pull it off the shaver.



- 9** Insert the raised notch of the shaving unit into the slot in the top of the shaver. Press the shaving unit down to attach it to the shaver. You will hear a 'click'.

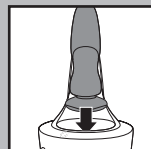

- 10** Place the shaver in the SmartClean System to protect the heads.

Travel Lock

If you are going to store the shaver for a longer time period or if traveling, it is possible to lock the shaver. The travel lock prevents the shaver from being switched on by accident.

Activating the travel lock

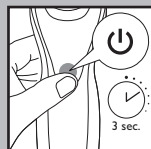

- 1** Press the ON/OFF button for 3 seconds.

▶ The travel lock symbol lights up white continuously and the lock symbol blinks.

- 2** The travel lock has now been activated.

Deactivating the travel lock

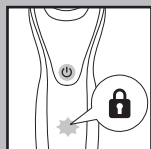

- 1** Press the ON/OFF button for 3 seconds.
- 2** The lock symbol blinks and then lights up continuously. The shaver is now ready for use.

▶ The shaver unlocks automatically when charging in the SmartClean System.

Cleaning

- ▶ Always clean your shaver after each use.
- ▶ Regular cleaning guarantees better shaving results.
- ▶ Never clean, remove or replace shaving unit while motor is on.
- ▶ Do not apply pressure to shaving head combs. Do not touch shaving heads with hard objects as this may dent or damage precision-made slotted combs.
- ▶ Do not use shaver if shaving head combs are damaged or broken. Facial injury may occur.
- ▶ Do not use abrasives, scourers or aggressive liquids such as gasoline or acetone to clean the shaver.

Cleaning the Shaving Unit

The shaving heads may be quickly cleaned after each use by rinsing with hot water. Water from the tap should be on a hot setting, **BUT BE CAREFUL TO TEST WATER FIRST SO AS NOT TO BURN OR SCALD HANDS.**

- ▶ Regular cleaning guarantees better shaving results.
- ▶ While rinsing shaving heads, water may drip out of the base of shaver. This is a normal occurrence.

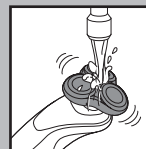

- 1** For best results rinse the shaving unit by running under hot water for a few minutes.

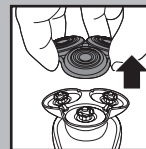

- 2** Pull the top portion of the shaving unit straight off the shaver.

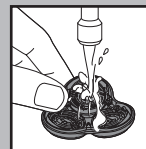

- 3** Rinse the shaving unit under hot tap water.

BE CAREFUL TO TEST WATER FIRST SO AS NOT TO BURN OR SCALD HANDS.

- 4** Carefully shake off excess water and let the shaving unit air dry completely.

NOTE: Do not wipe or dry the shaving unit with a towel or tissue. This could damage the shaving heads.

- 5** Press the top portion of the shaving unit down to attach it to the shaver head holder. You will hear a 'click'.

Preparing SmartClean System For Use

CAUTION: Keep cleaning cartridge(s) out of reach of children. Do not take internally. Avoid contact with eyes. In case of eye contact, thoroughly flush with cold water. If irritation persists, get medical attention.

Important

- ▶ Only use this shaver, SmartClean System and cleaning cartridge provided to charge or clean shaver.
- ▶ Other Philips Norelco shavers may not work with this SmartClean System.
- ▶ For optimal cleaning results, replace the cleaning cartridge every 3 months.
- ▶ To avoid evaporation, do not expose cleaning solution to direct sunlight.
- ▶ The SmartClean System thoroughly cleans but does not disinfect your shaver; therefore, do not share shaver with others.

- ▶ The charging plug converts 100-240V AC to less than 24V DC.
- ▶ Place the SmartClean System on a flat, stable and fluid-resistant surface to avoid any leakage. Be careful not to tip or move the SmartClean System when it is ready for use.
- ▶ Use this appliance for its intended household use as described in this manual.

- 1** Place the SmartClean System on a flat, level surface.

To prevent leaking, do not tilt the SmartClean System.



- 2** While holding the SmartClean System with one hand, press the button located on the side of the SmartClean System (1) and lift the SmartClean System (2).

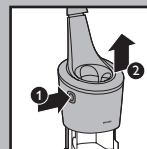

- 3** Remove the seal off the cleaning cartridge.

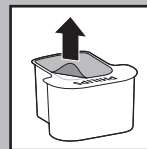

NOTE: ONLY USE PHILIPS NORELCO SMARTCLEAN CARTRIDGE (MODEL JC302) WITH THE SMARTCLEAN SYSTEM.

- ▶ When the cleaning cartridge filter is full, the replacement symbol blinks indicating the cleaning cartridge should be replaced. See 'Replacing the SmartClean System Cartridge'.



- 4** Place the cleaning cartridge in the SmartClean System.

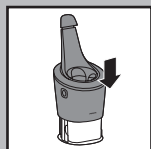

- 5** While holding the SmartClean System with one hand, gently push the top part of the SmartClean System back down. You will hear a 'click'.

When the SmartClean System is ready for use, do not move appliance to prevent leakage.

Cleaning the Shaver in the SmartClean System

- ▶ If the shaver does not contain enough power for one (1) shave, the SmartClean System may not work properly. Charge the shaver in the SmartClean System before using the SmartClean System to clean your shaver.
- ▶ If you use the shaver with shaving foam or gel, quickly rinse under hot water before cleaning in the SmartClean System.

- 1** Connect the small plug to the SmartClean System. Connect the power plug into any 100V to 240V AC outlet. Use only the power cord provided.

- 2** Place the SmartClean System on a flat, level surface. Make sure the seal has been removed from the cleaning cartridge (see 'Preparing SmartClean System For Use').

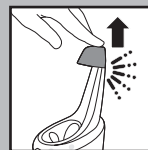

- 3** Press the top cap down to open the SmartClean System.

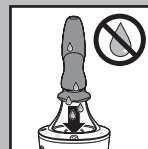

- 4** Shake off any excess water from shaver before placing in the SmartClean System.

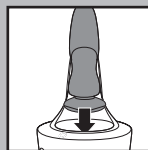

- 5** Hold the shaver head side down above the shaver holder.

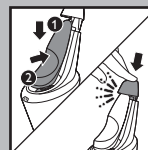

- 6** Place the shaver into the holder (1), push shaver back (2) and press down the top cap to connect the shaver (click).

The shaver will only fit in the SmartClean System in one direction.

- 7** The battery symbol blinks to indicate shaver is charging.

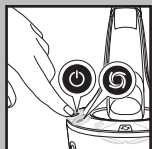

- 8** Press the ON/OFF button (⏻) on the SmartClean System to start the cleaning cycle.
- 9** The ON/OFF button (⏻) and cleaning symbol (🌀) will light up continuously.
- ▶ The cleaning cycle takes approximately 10 minutes.
 - ▶ Do not press the ON/OFF button while the cleaning cycle is running. If this does occur, the cleaning cycle will stop and the cleaning symbol stops blinking. The cleaning cycle can be re-started by pressing the ON/OFF button once.
 - ▶ If the power plug is disconnected before the cleaning cycle is complete, reconnect the plug into the outlet and the cleaning cycle can be re-started by pressing the ON/OFF button once.

NOTE: When the cleaning cartridge filter is full, the replacement symbol blinks orange. (See 'Replacing the SmartClean System Cartridge').

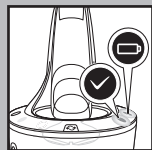

- 10** When the cleaning cycle is complete and the shaver is hygienically clean, the ready symbol lights up continuously. The battery symbol on the shaver will light up to indicate the shaver is fully charged.



- 11** Press the top cap down (1), pull the shaver forward (2) and lift shaver from SmartClean holder (3).
- ▶ The SmartClean System automatically turns off 30 minutes after the cleaning cycle is complete.
- 12** Carefully shake off excess liquid and let the shaving unit air dry completely. You can also leave the shaver in the SmartClean System overnight to dry.

Extra-thorough cleaning method

Do not mix up the cutters and combs as the shaving performance may be adversely affected for several weeks before optimal shaving performance is restored.

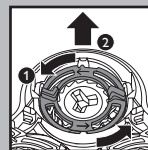
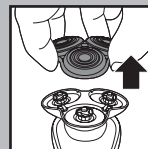

- 1** Turn shaver OFF.
- 2** Pull the top portion of the shaving unit straight off the shaver.
- 3** Turn the retaining ring counterclockwise (1) and lift it off the shaving head (2).

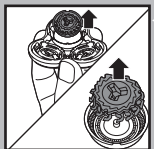

- 4** Remove one shaving head from the shaving head holder. Remove the cutter from the comb.

Do not clean more than one cutter and comb at a time, since they are all matching sets. If you accidentally put a cutter in the wrong comb, it may take several weeks before optimal shaving performance is restored.

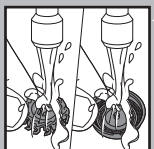

- 5** Clean the cutter and comb under warm tap water.



- 6** After cleaning, place the cutter back into the comb with the cutter legs pointing downwards.

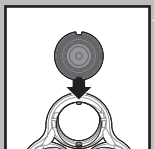

- 7** Put the shaving head back into the shaving head holder.

Make sure the notches of the shaving head fit exactly into the projections on the shaving head holder.

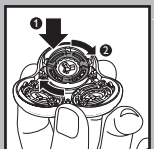

- 8** Hold the shaving head holder in your hand and place the retaining ring on the shaving head holder (1). Turn clockwise (2) to reattach the retaining ring.

Do not place the shaving head holder on a surface, as damage may occur.

- 9** Repeat the process for the other two cutters and combs.
- 10** Reattach the shaving head holder to the bottom part of the shaving unit.

Cleaning the Trimmer

Clean the trimmer after each use.

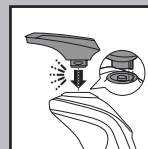

- 1** Attach the trimmer to shaver.

- 2** Turn shaver ON.

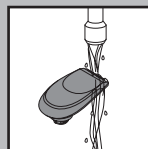

- 3** Rinse the trimmer under hot water. BUT BE CAREFUL TO TEST WATER FIRST SO AS NOT TO BURN OR SCALD HANDS.

- 4** Turn the shaver OFF. Shake off excess water and allow trimmer to air dry thoroughly.

Tip: For optimal trimmer performance, lubricate the trimmer teeth with one drop of mineral oil every 6 months.

Replacing the Shaving Heads

- ▶ Replace the shaving heads once a year for optimal shaving results.
- ▶ Replace damaged or worn shaving heads with model SH70 Philips Norelco shaving heads only.

Replacement Shaving Heads Indication

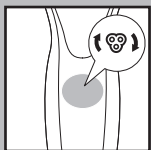

- ▶ The shaving heads symbol lights up continuously when the shaver is turned off to remind you to replace your shaving heads to obtain optimal shaving results.

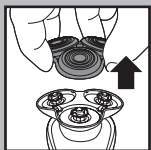

- 1** Pull the top portion of the shaving unit straight off the shaver.

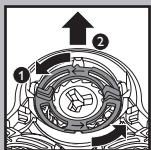

- 2** Turn the retaining ring counterclockwise (1) and lift it off the shaving head (2).

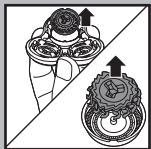

- 3** Remove the shaving heads from the shaving head holder and discard.
DO NOT discard the retaining ring.

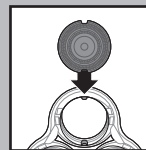

- 4** Place new shaving head in the holder. Make sure the notches of the shaving head fit exactly into the projections on the shaving head holder.

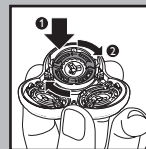

- 5** Hold the shaving head holder in your hand and place the retaining ring on the shaving head holder (1). Turn clockwise (2) to reattach the retaining ring.

Do not place the shaving head holder on a surface, as damage may occur.

- 6** Repeat this process for the other two cutters and combs.

- 7** Reattach the shaving head holder to the bottom part of the shaving unit.

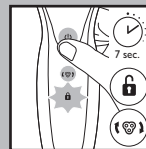

- 8** To reset the shaver, press and hold the On/Off button for approximately 7 seconds.

Replacing the SmartClean System Cleaning Cartridge



- ▶ For optimal cleaning results, replace the cleaning cartridge when the replacement indicator blinks orange or every 3 months.

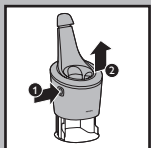

- 1** While holding the SmartClean System with one hand, press the cartridge release button on the side of the SmartClean System (1) and lift the SmartClean System (2).

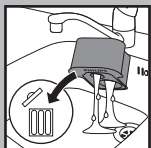

- 2** Remove the empty cleaning cartridge and pour any remaining cleaning fluid out of the cleaning cartridge.

You can safely pour the cleaning fluid down the sink.

- 3** Discard the empty cleaning cartridge. Contact your local town or city officials for recycling information.

- 4** Remove the seal off the new cleaning cartridge.

- 5** Place the new cleaning cartridge in the SmartClean System.

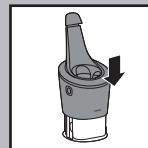

- 6** While holding the SmartClean System with one hand, gently push the top part of the SmartClean System back down. You will hear a 'click'.

When the SmartClean System is ready for use, do not move appliance to prevent leakage.

This shaver/SmartClean System has no other user-serviceable parts. For assistance, call 1-800-243-3050.

Maintenance

- ▶ Always remove shaver from the SmartClean System before cleaning appliance.
- ▶ The SmartClean System and shaver may be wiped clean using a damp cloth.
- ▶ Water from the tap should be on a warm setting to clean any washable parts.

NOTE: DO NOT place or clean any parts of the SmartClean System in a dishwasher.

Storage

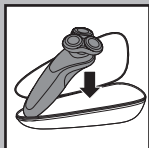

- ▶ The shaver can be placed in the travel case or SmartClean System for safe storage.
- ▶ Be sure shaver is turned off. Remove cord from outlet before storing in a safe, dry location where it will not be crushed, banged, or subject to damage.
- ▶ Do not wrap power cord around shaver or SmartClean System when storing.
- ▶ Store cord in a safe location where it will not be cut or damaged.
- ▶ Do not place or store SmartClean System where it can fall or be pulled into a tub or sink, water or other liquid while plugged in.

Assistance

- ▶ For assistance, visit our website:

**www.philips.com/support or
call toll free 1-800-243-3050**

- ▶ Online information is available 24 hours a day, 7 days a week.

Battery Recycling



- ▶ This Philips Norelco shaver contains a rechargeable Lithium-Ion battery which must be disposed of properly.
- ▶ Contact your local town or city officials for battery disposal information or call 1-800-8-BATTERY or www.rbrbc.com for battery drop-off locations.
- ▶ For assistance, visit our website, www.philips.com/support or call toll free: 1-800-243-3050.

Accessories

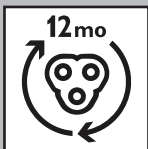

- ▶ **Replacement Shaving Heads**
 Model SH70 - For maximum shaver performance, replace your Philips Norelco shaving heads once a year.
- ▶ **Replacement Cleaning Cartridge**
 Model JC302 - Philips Norelco SmartClean Cleaning Cartridge
- ▶ **Shaving Head Cleaning Spray**
 Model HQ110 - Philips Norelco Shaving Head Cleaning Spray
- ▶ **Philips Norelco Shaver Accessories may be purchased at a store near you, or on our website www.philips.com/store**

FULL TWO YEAR WARRANTY

Philips Electronics North America Corporation warrants each new Philips Norelco Product, Model S7370 (except cutters and combs) against defects in materials or workmanship for a period of two years from the date of purchase, and agrees to repair or replace any defective product without charge.

IMPORTANT: This warranty does not cover damage resulting from accident, misuse or abuse, lack of reasonable care, the affixing of any attachment not provided with the product or loss of parts or subjecting the product to any but the specified voltage.* Use of unauthorized replacement parts will void this warranty.

PHILIPS ELECTRONICS NORTH AMERICA CORPORATION WILL NOT PAY FOR WARRANTY SERVICE PERFORMED BY A NON-AUTHORIZED REPAIR SERVICE AND WILL NOT REIMBURSE THE CONSUMER FOR DAMAGE RESULTING FROM WARRANTY SERVICE PERFORMED BY A NON-AUTHORIZED REPAIR SERVICE. NO RESPONSIBILITY IS ASSUMED FOR ANY SPECIAL, INCIDENTAL OR CONSEQUENTIAL DAMAGES.

In order to obtain warranty service, simply go to www.philips.com/norelco or call 1-800-243-3050 for assistance. It is suggested that for your protection you return shipments of product by insured mail, insurance prepaid. Damage occurring during shipment is not covered by this warranty.

NOTE: No other warranty, written or oral, is authorized by Philips Electronics North America Corporation.

This warranty gives you specific legal rights, and you may also have other rights which vary from state to state. Some states do not allow the exclusion or limitation of incidental or consequential damages, so the above exclusion and limitations may not apply to you.

* Read enclosed instructions carefully.

Manufactured for:

Philips Consumer Lifestyle

A Division of Philips Electronics North America Corporation

P.O.Box 10313, Stamford, CT 06904



This symbol on the product's nameplate means it is listed by Underwriters' Laboratories, Inc.

Norelco, Tripleheader, Lift and Cut, and  are Registered Trademarks of Philips Electronics North America Corporation.



is a Trademark of Philips Electronics North America Corporation.

PHILIPS is a Registered Trademark of Koninklijke Philips N.V.