



*All images are for illustrative purposes only.

LG LED Signage | **Outdoor**

LBS Stadium Series

The LBS Stadium series comes in various formats for different types of stadiums and outdoor venue applications. It is designed and built to provide robust performance with exceptional image quality.



Outstanding Visibility
Our super-bright displays with 6,000 nits (up to 8,500 nits) deliver clear content even under direct sunlight.



Smooth Playback with High Refresh Rate
A high refresh rate of 4,000Hz ensures smooth playback, no black bars, and no blurry vision.



16-bit Color Processing
A high greyscale level with 16-bit color processing provides high densities of colors.



Reliable Weatherproof Design
Our IP65&IP54-certified unit cases allow stable operation under harsh weather conditions.



Front and Rear Serviceability
For easy installation and maintenance, we provide both front and rear access.



Uniform Picture Quality with Accurate Colors
Our strictly managed production enables us to provide seamless content and vivid colors without distortion.



RoHS Certified Safe Product
With RoHS certified, all LG LED signage models are eco-friendly while not using harmful materials.

SPECIFICATIONS

Panel	LBS060DA1D	LBS060DA3D	LBS080DA1D	LBS080DA3D	LBS100DA1D	LBS100DA3D	LBS120DA1D	LBS120DA3D
Physical Parameters	Pixel Configuration	3 in 1 SMD	3 in 1 SMD	3 in 1 SMD	3 in 1 SMD	3 in 1 SMD	3 in 1 SMD	3 in 1 SMD
	Pixel Pitch (mm)	600	600	800	800	10.667	10.667	12.00
	Module Resolution (WxH)	32 x 32	32 x 32	24 x 24	24 x 24	18 x 18	18 x 18	16 x 16
	Module Dimensions (WxH, mm)	192 x 192	192 x 192	192 x 192	192 x 192	192 x 192	192 x 192	192 x 192
	Weight per Module (kg)	0.54	0.54	0.57	0.57	0.56	0.56	0.56
	No. of Modules per Unit Case (WxH)	6 x 4	6 x 4	8 x 8	8 x 8	8 x 8	8 x 8	8 x 8
	Unit Case Resolution (WxH)	192 x 128	192 x 128	192 x 192	192 x 192	144 x 144	144 x 144	128 x 128
	Unit Case Dimensions (WxHxD, mm)	1,152 x 768 x 217	1,152 x 768 x 217	1,536 x 1,536 x 222	1,536 x 1,536 x 222	1,536 x 1,536 x 222	1,536 x 1,536 x 222	1,536 x 1,536 x 223
	Unit Case Surface Area (m ²)	0.885	0.885	2.359	2.359	2.359	2.359	2.359
	Weight per Unit Case (kg/unit)	42.0	42.0	104.0	104.0	104.0	104.0	104.0
	Weight per Square Meter (kg/m ²)	47.5	47.5	44.1	44.1	44.1	44.1	44.1
	Physical Pixel Density (pixels/m ²)	27,777	27,777	15,625	15,625	8,789	8,789	6,944
	Unit Case Material	Aluminum Metal Sheet	Aluminum Metal Sheet	Aluminum Metal Sheet	Aluminum Metal Sheet	Aluminum Metal Sheet	Aluminum Metal Sheet	Aluminum Metal Sheet
Service Access	Front or Rear (One Option Only)	Front or Rear (One Option Only)	Front and Rear	Front and Rear	Front and Rear	Front and Rear	Front and Rear	
Optical Specifications	Min. Brightness (After Calibration)	6,000cd/m ²	6,000cd/m ²	6,000cd/m ²	6,000cd/m ²	6,000cd/m ²	6,000cd/m ²	6,000cd/m ²
	Color Temperature	3,500 - 8,500	3,500 - 8,500	3,500 - 8,500	3,500 - 8,500	3,500 - 8,500	3,500 - 8,500	3,500 - 8,500
	Visual Viewing Angle (HxV)	160 x 135	160 x 135	160 x 135	160 x 135	160 x 145	160 x 145	160 x 125
	Brightness Uniformity	97%	97%	97%	97%	97%	97%	97%
	Color Uniformity	±0.05Cx,Cy	±0.05Cx,Cy	±0.05Cx,Cy	±0.05Cx,Cy	±0.05Cx,Cy	±0.05Cx,Cy	±0.05Cx,Cy
	Contrast Ratio	3,000	3,000	3,000	3,000	3,000	3,000	3,000
	Processing Depth (bit)	16	16	16	16	16	16	16
Electrical Specifications	Power Consumption (W/Unit, Max.)	600	580	1,460	1,380	1,540	1,450	1,360
	Power Consumption (W/Unit, Avg.)	240	232	584	552	616	580	544
	Power Consumption (W/m ² , Max.)	678	656	619	585	653	615	576
	Power Supply (V)	100 to 240	100 to 240	100 to 240	100 to 240	100 to 240	100 to 240	100 to 240
	Frame Rate (Hz)	50 / 60	50 / 60	50 / 60	50 / 60	50 / 60	50 / 60	50 / 60
	Refresh Rate (Hz)	4,000	4,000	4,000	4,000	4,000	4,000	4,000
Operation Specifications	Lifetime (Half Brightness, hrs)*	100,000	100,000	100,000	100,000	100,000	100,000	100,000
	Operating Temperature	-20°C to +50°C	-20°C to +50°C	-20°C to +50°C	-20°C to +50°C	-20°C to +50°C	-20°C to +50°C	-20°C to +50°C
	Operating Humidity	< 90% RH	< 90% RH	< 90% RH	< 90% RH	< 90% RH	< 90% RH	< 90% RH
	IP Rating Front	IP65	IP65	IP65	IP65	IP65	IP65	IP65
	IP Rating Rear	IP54	IP54	IP54	IP54	IP54	IP54	IP54
Certification	IEC 60950-1 / EN 60950-1 / UL 60950-1, FCC Class A / CE / KC	IEC 60950-1 / EN 60950-1 / UL 60950-1, FCC Class A / CE / KC	IEC 60950-1 / EN 60950-1 / UL 60950-1, FCC Class A / CE / KC	IEC 60950-1 / EN 60950-1 / UL 60950-1, FCC Class A / CE / KC	IEC 60950-1 / EN 60950-1 / UL 60950-1, FCC Class A / CE / KC	IEC 60950-1 / EN 60950-1 / UL 60950-1, FCC Class A / CE / KC	IEC 60950-1 / EN 60950-1 / UL 60950-1, FCC Class A / CE / KC	IEC 60950-1 / EN 60950-1 / UL 60950-1, FCC Class A / CE / KC
Environment	RoHS	RoHS	RoHS	RoHS	RoHS	RoHS	RoHS	

*The Lifetime(Half brightness) spec is subject to LED package spec.

SPECIFICATIONS

Panel	LBS160DA1D	LBS160DA3D	LBF160DA1D	LBB160DA1D2	
Physical Parameters	Pixel Configuration	3 in 1 SMD	3 in 1 SMD	3 in 1 SMD	3 in 1 SMD
	Pixel Pitch (mm)	1.600	1.600	1.600	1.600
	Module Resolution (WxH)	12 x 12	12 x 12	12 x 12	12 x 12
	Module Dimensions (WxH, mm)	192 x 192	192 x 192	192 x 192	192 x 192
	Weight per Module (kg)	0.56	0.56	0.56	0.58
	No. of Modules per Unit Case (WxH)	8 x 8	8 x 8	4 x 5	8 x 5
	Unit Case Resolution (WxH)	96 x 96	96 x 96	48 x 60	96 x 60
	Unit Case Dimensions (WxHxD, mm)	1,536 x 1,536 x 227	1,536 x 1,536 x 227	768 x 960 x 254	1,536 x 960 x 215
	Unit Case Surface Area (m ²)	2.359	2.359	0.737	1.475
	Weight per Unit Case (kg/unit)	104.0	104.0	40.0	71.0
	Weight per Square Meter (kg/m ²)	44.1	44.1	54.3	48.1
	Physical Pixel Density (pixels/m ²)	3,906	3,906	3,906	3,906
	Unit Case Material	Aluminum Metal Sheet	Aluminum Metal Sheet	Aluminum Metal Sheet	Aluminum Metal Sheet
Service Access	Front and Rear	Front and Rear	TOP	Front and Rear	
Optical Specifications	Min. Brightness (After Calibration)	6,000cd/m ²	6,000cd/m ²	6,000cd/m ²	6,000cd/m ²
	Color Temperature	3,500 - 8,500	3,500 - 8,500	3,500 - 8,500	3,500 - 8,500
	Visual Viewing Angle (HxV)	160 x 105	160 x 105	160 x 105	160 x 105
	Brightness Uniformity	97%	97%	97%	97%
	Color Uniformity	±0.05Cx,Cy	±0.05Cx,Cy	±0.05Cx,Cy	±0.05Cx,Cy
	Contrast Ratio	3,000	3,000	3,000	3,000
	Processing Depth (bit)	16	16	16	16
Electrical Specifications	Power Consumption (W/Unit, Max.)	1,550	1,460	460	930
	Power Consumption (W/Unit, Avg.)	620	584	184	372
	Power Consumption (W/m ² , Max.)	657	619	624	631
	Power Supply (V)	100 to 240	100 to 240	100 to 240	100 to 240
	Frame Rate (Hz)	50 / 60	50 / 60	50 / 60	50 / 60
	Refresh Rate (Hz)	4,000	4,000	4,000	4,000
Operation Specifications	Lifetime (Half Brightness, hrs)*	100,000	100,000	100,000	100,000
	Operating Temperature	-20°C to +50°C	-20°C to +50°C	-20°C to +50°C	-20°C to +50°C
	Operating Humidity	< 90% RH	< 90% RH	< 90% RH	10 - 90% RH
	IP Rating Front	IP65	IP65	IP65	IP65
	IP Rating Rear	IP54	IP54	IP43	IP54
Certification	IEC 60950-1 / EN 60950-1 / UL 60950-1, FCC Class A / CE / KC	IEC 60950-1 / EN 60950-1 / UL 60950-1, FCC Class A / CE / KC	IEC 60950-1 / EN 60950-1 / UL 60950-1, FCC Class A / CE / KC	IEC 60950-1 / EN 60950-1 / UL 60950-1, FCC Class A / CE / KC	
Environment	RoHS	RoHS	RoHS	RoHS	

Controller	LCLH001	
Input	Interface	DVI
	Resolution	1,920x1,200@60Hz
	EDID Custom	No
Output	Signal	Gigabit Ethernet(4ea)
	Fiber Optical	X
Control	RJ45	O
	USB	O
Electrical	Power Consumption[W]	30
	Power Supply[V]	AC 100-240V
Mechanical	Size[mm]	482(W)x200(D)x44(H) →EIA Standard Rack(1U)
	Weight[Kg]	3
Feature	Signal Redundancy	Yes
	HDR10	X

*The Lifetime(Half brightness) spec is subject to LED package spec.

LBS060

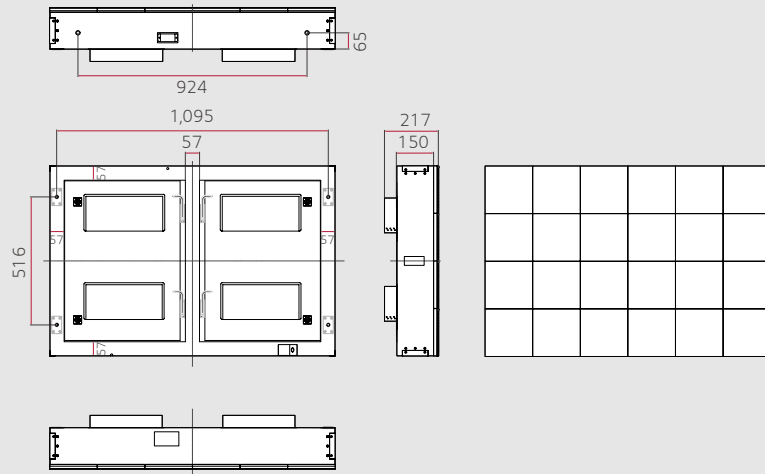

LBS080 / LBS100 / LBS120 / LBS160

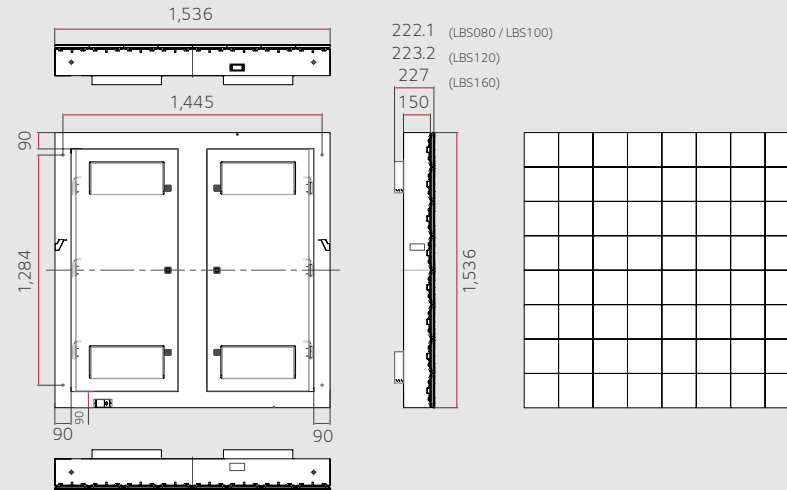

LBF160

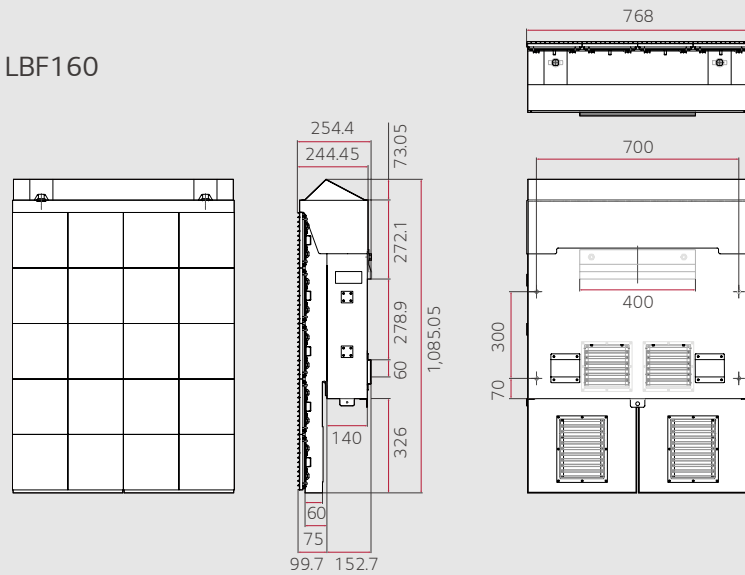

LBB160

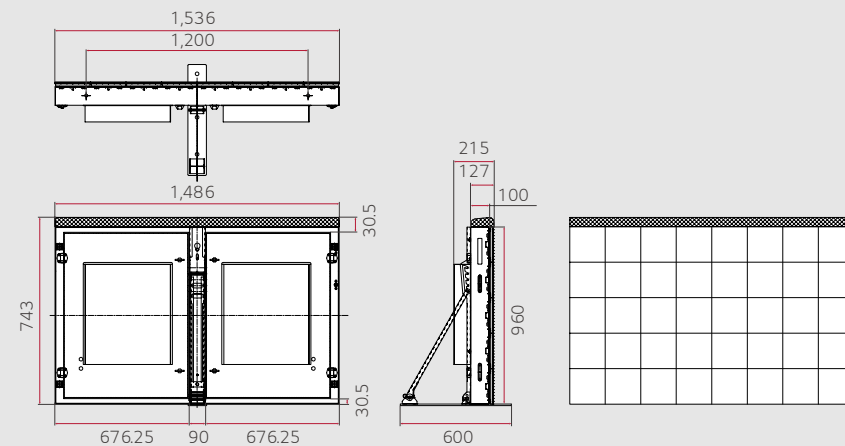

(unit: mm)



Download
LG C-Display+
Mobile App
Google Play Store

- www.lg.com/b2b
- www.youtube.com/c/LGCommercialDisplay
- www.facebook.com/LGInformationDisplay
- www.linkedin.com/company/LGInformationDisplay

LG may make changes to specifications and product descriptions without notice.
Copyright © 2019 LG Electronics Inc. All rights reserved. "LG Life's Good" is a registered trademark of LG Corp.
The names of products and brands mentioned here may be the trademarks of their respective owners.

