



ASUS Hangouts Meet hardware kit

User Guide



E13642

Revised Edition v2

November 2017

COPYRIGHT INFORMATION

No part of this manual, including the products and software described in it, may be reproduced, transmitted, transcribed, stored in a retrieval system, or translated into any language in any form or by any means, except documentation kept by the purchaser for backup purposes, without the express written permission of ASUSTeK COMPUTER INC. ("ASUS").

ASUS PROVIDES THIS MANUAL "AS IS" WITHOUT WARRANTY OF ANY KIND, EITHER EXPRESS OR IMPLIED, INCLUDING BUT NOT LIMITED TO THE IMPLIED WARRANTIES OR CONDITIONS OF MERCHANTABILITY OR FITNESS FOR A PARTICULAR PURPOSE. IN NO EVENT SHALL ASUS, ITS DIRECTORS, OFFICERS, EMPLOYEES OR AGENTS BE LIABLE FOR ANY INDIRECT, SPECIAL, INCIDENTAL, OR CONSEQUENTIAL DAMAGES (INCLUDING DAMAGES FOR LOSS OF PROFITS, LOSS OF BUSINESS, LOSS OF USE OR DATA, INTERRUPTION OF BUSINESS AND THE LIKE), EVEN IF ASUS HAS BEEN ADVISED OF THE POSSIBILITY OF SUCH DAMAGES ARISING FROM ANY DEFECT OR ERROR IN THIS MANUAL OR PRODUCT.

Products and corporate names appearing in this manual may or may not be registered trademarks or copyrights of their respective companies, and are used only for identification or explanation and to the owners' benefit, without intent to infringe.

SPECIFICATIONS AND INFORMATION CONTAINED IN THIS MANUAL ARE FURNISHED FOR INFORMATIONAL USE ONLY, AND ARE SUBJECT TO CHANGE AT ANY TIME WITHOUT NOTICE, AND SHOULD NOT BE CONSTRUED AS A COMMITMENT BY ASUS. ASUS ASSUMES NO RESPONSIBILITY OR LIABILITY FOR ANY ERRORS OR INACCURACIES THAT MAY APPEAR IN THIS MANUAL, INCLUDING THE PRODUCTS AND SOFTWARE DESCRIBED IN IT.

Copyright © 2017 ASUSTeK COMPUTER INC. All Rights Reserved.

LIMITATION OF LIABILITY

Circumstances may arise where because of a default on ASUS' part or other liability, you are entitled to recover damages from ASUS. In each such instance, regardless of the basis on which you are entitled to claim damages from ASUS, ASUS is liable for no more than damages for bodily injury (including death) and damage to real property and tangible personal property; or any other actual and direct damages resulted from omission or failure of performing legal duties under this Warranty Statement, up to the listed contract price of each product.

ASUS will only be responsible for or indemnify you for loss, damages or claims based in contract, tort or infringement under this Warranty Statement.

This limit also applies to ASUS' suppliers and its reseller. It is the maximum for which ASUS, its suppliers, and your reseller are collectively responsible.

UNDER NO CIRCUMSTANCES IS ASUS LIABLE FOR ANY OF THE FOLLOWING: (1) THIRD-PARTY CLAIMS AGAINST YOU FOR DAMAGES; (2) LOSS OF, OR DAMAGE TO, YOUR RECORDS OR DATA; OR (3) SPECIAL, INCIDENTAL, OR INDIRECT DAMAGES OR FOR ANY ECONOMIC CONSEQUENTIAL DAMAGES (INCLUDING LOST PROFITS OR SAVINGS), EVEN IF ASUS, ITS SUPPLIERS OR YOUR RESELLER IS INFORMED OF THEIR POSSIBILITY.

SERVICE AND SUPPORT

Visit our multi-language web site at <https://www.asus.com/support/>

Contents

- About this user guide 5
- Package contents 6
- Getting to know your Chromebox**
- Features 10
 - Front view..... 10
 - Left side view 11
 - Rear view 12
- Using your Hangouts Meet hardware kit**
- Getting started..... 16
 - Connect a display panel to your Chromebox..... 16
 - Connect the speakermic..... 17
 - Connect the camera 18
 - Connect the touchscreen 19
 - Connect the AC power adapter to your Chromebox..... 22
 - Turn on your Chromebox 24
- Configuring your Hangouts Meet hardware kit**
- Before you begin using your device for video conferencing 26
 - Setup requirements..... 26
 - Setup your system..... 28
 - Enroll your device 33
- Manage devices and rooms 36
- Troubleshooting**
- Fix a problem 38
- Help and support 38
- Appendix**
- Safety information 40
 - Setting up your system..... 40
 - Care during use 41
- Regulatory notices..... 42
- ASUS contact information 46

About this user guide

This user guide provides information about the hardware and software features of your Hangouts Meet hardware kit, organized through the following chapters:

Chapter 1: Getting to know your Chromebox

This chapter details the hardware components of your Chromebox.

Chapter 2: Using your Hangouts Meet hardware kit

This chapter provides you with information on using your Chromebox Hangouts Meet.

Chapter 3: Configuring your Hangouts Meet hardware kit

This chapter provides you with information on setting your Chromebox Hangouts Meet for video conferencing.

Troubleshooting

This section includes instructions on how to fix a problem that you may encounter when using your Hangouts Meet hardware kit.

Appendix

This section includes notices and safety statements for your Chromebox.

Conventions used in this user guide

To highlight key information in this user guide, some text are presented as follows:

IMPORTANT! This message contains vital information that must be followed to complete a task.

WARNING! This message contains important information that must be followed to keep you safe while performing certain tasks and prevent damage to your device, data and components.

NOTE: This message contains additional information that can help complete tasks.

Package contents

Your Hangouts Meet hardware kit package contains the following items:

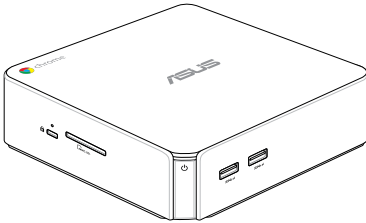

Chromebox

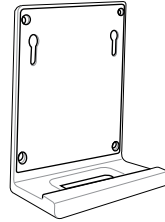

L-mounting bracket

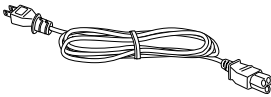

Power cable*



Mounting hardware



AC power adapter*



Technical documentations

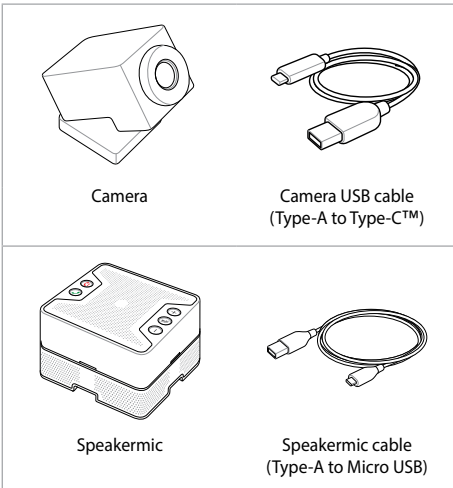

*The bundled power adapter may vary with territories.

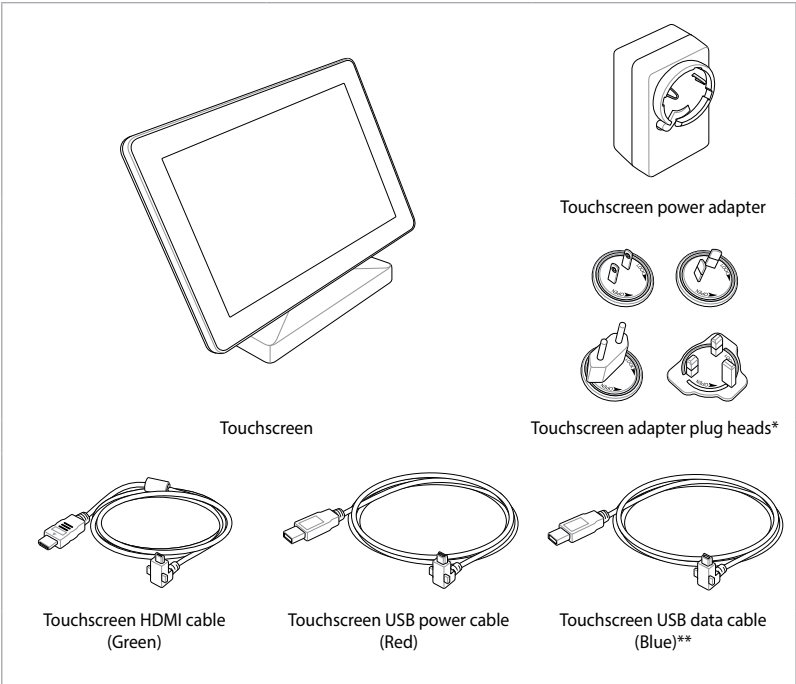

* The bundled power adapter plug heads may vary with territories

** The bundled Touchscreen USB data cable (Blue) may vary with territories

NOTE:

- If the device or its components fail or malfunction during normal and proper use within the warranty period, bring the warranty card to the ASUS Service Center for replacement of the defective components.
- Some bundled accessories may vary with different models. For details on these accessories, refer to their respective user manuals.

1

***Getting to know your
Chromebox***

Features

Front view

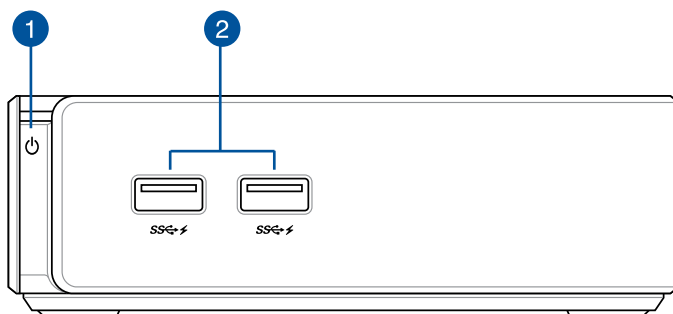

Power button

The power button allows you to turn on, turn off, or lock your Chromebox.

When logged-in, press the power button to lock your Chromebox; you will then be prompted to input the account password.

If you're in the sign-in screen or in Hangouts, press the power button to shut down your Chromebox.



USB 3.1 Gen 1 port

This USB 3.1 Gen 1 (Universal Serial Bus) port provides a transfer rate of up to 5 Gbit/s and is backward compatible to USB 2.0.

Left side view

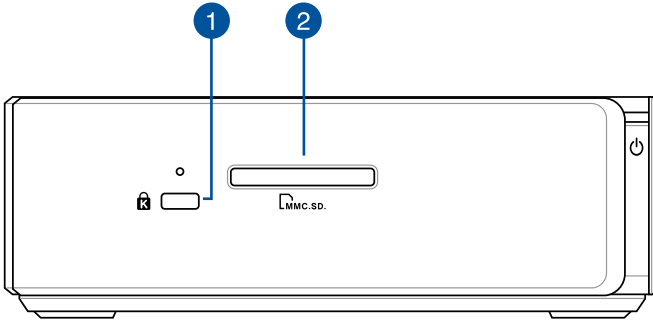

1



Kensington security slot

The Kensington® security slot allows you to secure your Chromebox using Kensington® compatible security products.

2



Memory card slot

The Chromebox has a built-in memory card reader slot that supports MMC, and SD cards.

Rear view

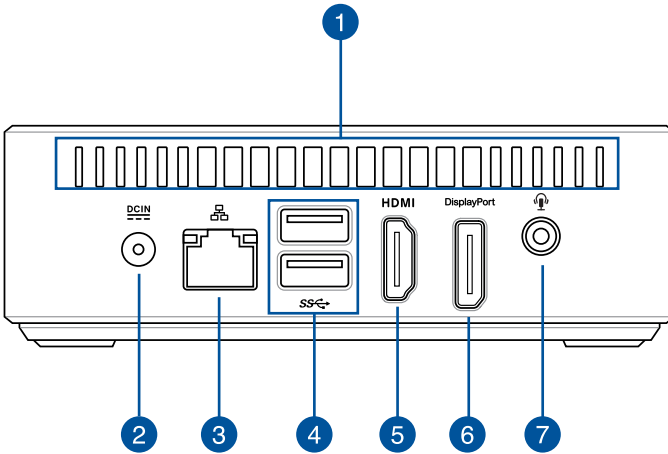

1

Air vents

The air vents allow cooler air to enter your Chromebox chassis.

IMPORTANT! For optimum heat dissipation and air ventilation, ensure that the air vents are free from obstructions.

2



Power input

The bundled power adapter converts AC power to DC power for use with this jack. Power supplied through this jack supplies power to the Chromebox. To prevent damage to the Chromebox, always use the bundled power adapter.

WARNING! The power adapter may become warm to hot when in use. Do not cover the adapter and keep it away from your body.

3



LAN port

The 8-pin RJ-45 LAN port supports a standard Ethernet cable for connection to a local network.

4



USB 3.1 Gen 1 port

This USB 3.1 Gen 1 (Universal Serial Bus) port provides a transfer rate of up to 5 Gbit/s and is backward compatible to USB 2.0.

5



HDMI

HDMI port

The HDMI (High Definition Multimedia Interface) port supports a Full HD device such as an LCD TV or monitor to allow viewing on a larger external display.

6



DisplayPort

DisplayPort

The DisplayPort sends high-performance digital output from your Chromebox to a display device such as an LCD TV or HD monitor.

7



Headphone/Headset/Microphone jack

This port allows you to connect amplified speakers or headphones. You can also use this port to connect your headset or an external microphone.

2

***Using your Hangouts Meet
hardware kit***

Getting started

Connect a display panel to your Chromebox

You can connect a display panel or projector that has the following connectors:

- HDMI connector
- DisplayPort
- DVI connector (used with an HDMI–DVI adapter)

NOTE: The HDMI–DVI adapter is purchased separately.

To connect a display panel to your Chromebox:

Connect a display cable either to the HDMI port or the DisplayPort.

Connect display via HDMI port

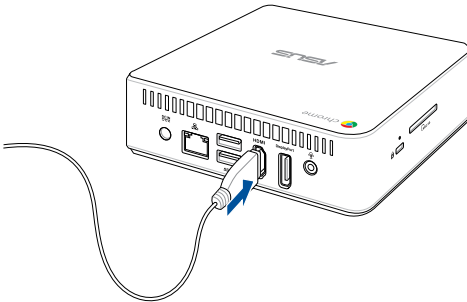

Connect display via DisplayPort

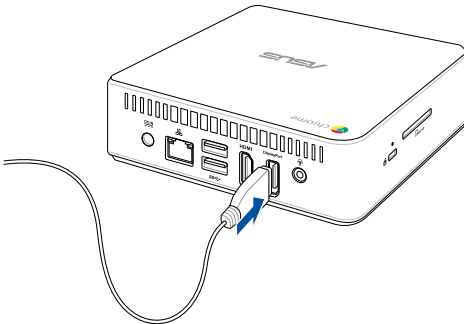

Connect the speakermic

You can connect the speakermic to any of the USB 3.1 Gen 1 ports on your Chromebox.

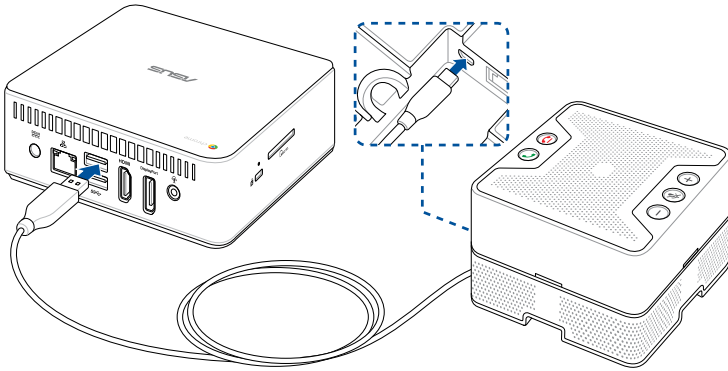

Connect the camera

You can connect the camera to any of the USB 3.1 Gen 1 ports on your Chromebox.

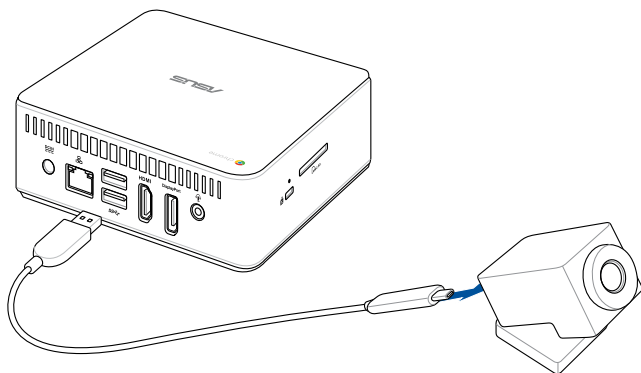

Connect the touchscreen

To connect the touchscreen to your Chromebox

NOTE: Ensure to use the Touchscreen USB data cable (Blue).

- A. Connect the Touchscreen USB data cable (Blue) to the data USB port on your touchscreen.
- B. Connect the touchscreen to any of the USB 3.1 Gen 1 ports on your Chromebox. Ensure to connect the USB 3.1 Gen 1 connector to connect to your Chromebox.

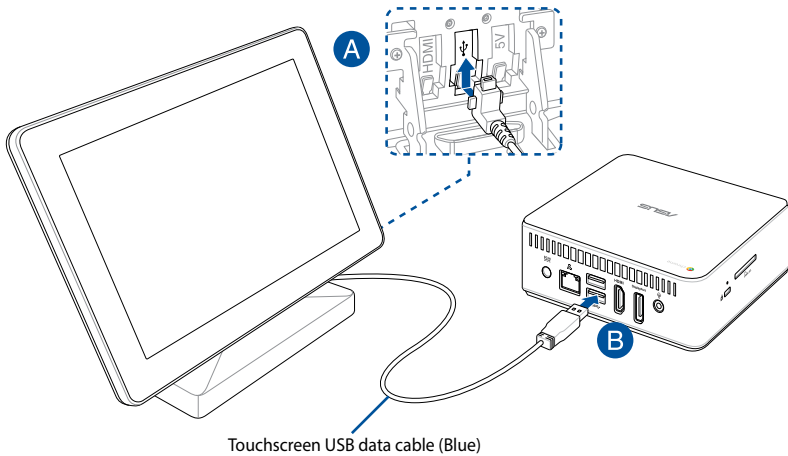

To connect the AC power adapter of your touchscreen

NOTE: Ensure to use the Touchscreen USB power cable (Red).

- A. Connect the Touchscreen USB power cable (Red) to the AC power adapter.
- B. Connect the Touchscreen USB power cable (Red) to the power USB port on your touchscreen.
- C. Attach the appropriate adapter plug head to the adapter, then plug the AC power adapter into a 100V~240V power source.

NOTE: For more information on attaching the adapter plug head to the adapter, refer to the user guide bundled with the touchscreen.

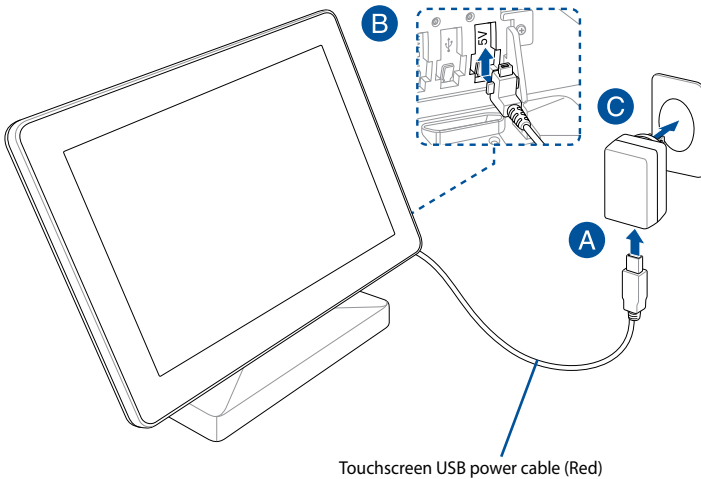

To connect the touchscreen for local presentations (optional)

NOTE: Ensure to use the Touchscreen HDMI cable (Green).

- A. Connect the Touchscreen HDMI cable (Green) to the HDMI port on your touchscreen.
- B. Connect the touchscreen to a device's (such as a laptop) HDMI out port for local presentations.

WARNING! Do not connect the HDMI cable (Green) to your Chromebox.

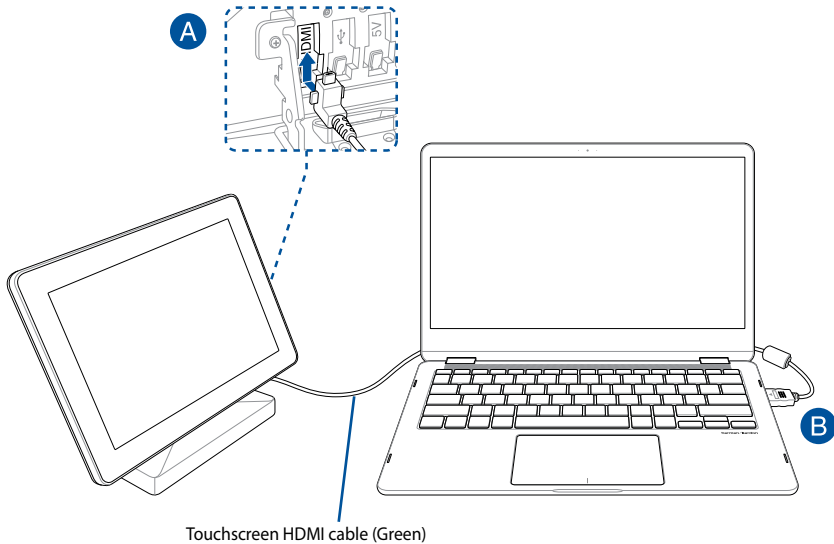

Connect the AC power adapter to your Chromebox

To connect the AC power adapter to your Chromebox:

- A. Connect the AC power cord to the AC/DC adapter.
- B. Connect the DC power connector into your Chromebox's power (DC) input port.
- C. Plug the AC power cord into a 100V~240V power source.

NOTE: The power adapter may vary in appearance, depending on models and your region.

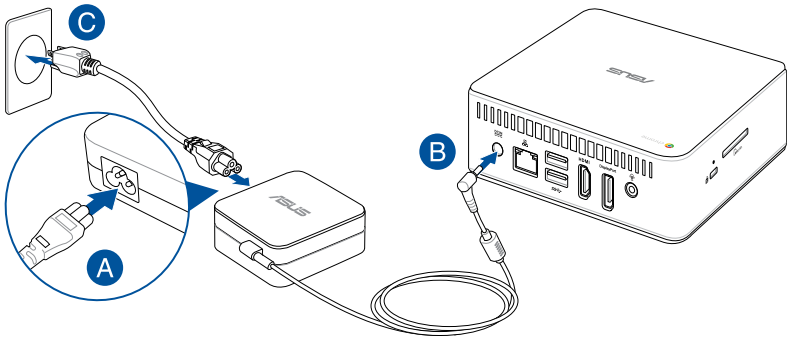

IMPORTANT!

- We strongly recommend that you use only the AC power adapter that came with your Chromebox.
 - We strongly recommend that you use a grounded wall socket while using your Chromebox.
 - The socket outlet must be easily accessible and near your Chromebox.
 - To disconnect your Chromebox from its main power supply, unplug your Chromebox from the power socket.
-

NOTE:

Power adapter information:

- Input voltage: 100-240 Vac
 - Input frequency: 50-60 Hz
 - Rating output current: 3.42 A (65 W)
 - Rating output voltage: 19 V
-

Turn on your Chromebox

Press the power button to turn on your Chromebox.

IMPORTANT! Ensure that all peripherals (speakermic, camera, touchscreen) and AC power adapter are connected properly before you turn on your Chromebox.

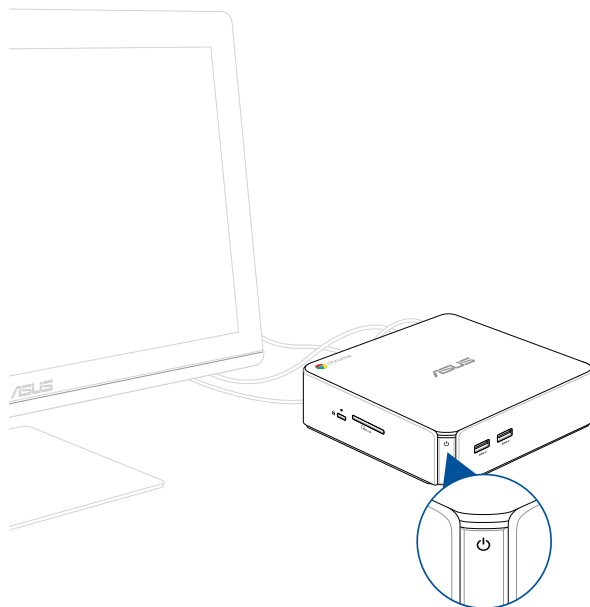

3

Configuring your Hangouts
Meet hardware kit

Before you begin using your device for video conferencing

Setup requirements

Room size and setup

Your Hangouts Meet hardware kit system is designed for a 2-10 person conference room. We recommend a room that contains either a long table with the monitor at one end (optimal), or a round table. We do not recommend using Chromebox with rooms set up in a classroom style.

The room must have the following:

- Live Ethernet port (for wired network connections)
- AC power outlet

Network requirements

Your Chromebox device works with both wired and wireless networks. The network requirements are the same as those for Hangouts. In addition, we recommend a minimum bandwidth of 1 mbps or 2 mbps (up/down) for group video conferencing.

NOTE: Although you can use your Chromebox device over a wireless network connection, we recommend using a wired network connection for best sound and video quality.

Space requirements

- For the Chromebox device, you must have a 50 mm x 145 mm x 145 mm / 1.97 in. x 5.71 in. x 5.71 in. (H x W x L) space available to mount the device or place it on a table.
- For the speakermic, you must have at least a 55 mm x 140 mm x 150 mm / 2.17 in. x 5.51 in. x 5.91 in. (H x W x L) space available to place the unit on the table or mount it on the wall.
- The universal hook mount on the camera fits the width on most standard monitors.

Display requirements and placement

Your Chromebox work with LCD, LED, plasma, and projector-type monitors and televisions. The display must have an HDMI or DisplayPort input. The screen resolution must be at least 1280 x 720 pixels. For best video quality, we recommend a resolution of 1920 x 1080 pixels.

You can place the display on a table against one wall, or mount the display on a wall or ceiling for a projector unit. Note that if you mount the display, you may need to drill holes and conceal cables. If you have an existing video conferencing system in the room, you may be able to repurpose the existing setup for your Chromebox system.

Speakermic placement

The optimal speakermic placement is up to 1.5 meters from all participants, but may also depend on the size and layout of the conference room:

- For rooms where participants sit at one end of the room facing the display, we recommend placing the speakermic at the end of the table closest to the Chromebox and the display.
- In larger rooms where participants sit talking around a table independent of the position of the display, we recommend placing the speakermic in the center of the table.

Connectors and accessories

Depending on your setup, you may need the following:

- CAT5e Ethernet cable for wired network connection
- Chromebox wall mount for wall mounting (included)
- USB extension cable for camera for distances exceeding 5 feet (one cable included)
- USB extension cable for speakermic for distances exceeding 3 feet (one cable included)

NOTE: If you need extension cables for both the camera and the speakermic, you can purchase a second one separately.

- Cable concealers, if needed for wall mounting

NOTE: The cable concealers for wall mounting and CAT5e Ethernet cable are not included in the package and must be purchased separately.

IMPORTANT! The included cable for the camera is 5 feet long, and the included cable for the speakermic is 3 feet long. If your setup of the display, Chromebox, and peripherals requires longer distances, you may need to purchase additional USB extension cables.

Setup your system

Mount your Chromebox

You can mount your Chromebox behind the display. Use a mounting bracket to attach the Chromebox to your display or to any VESA (100 mm)-compatible location. A mounting bracket comes included with your Chromebox package.

Place your camera

You may install your camera below or on top of the display depending on the screen height.

NOTE: Keep the camera as close to eye level as possible.

Recommended meeting room configuration 1

System setup

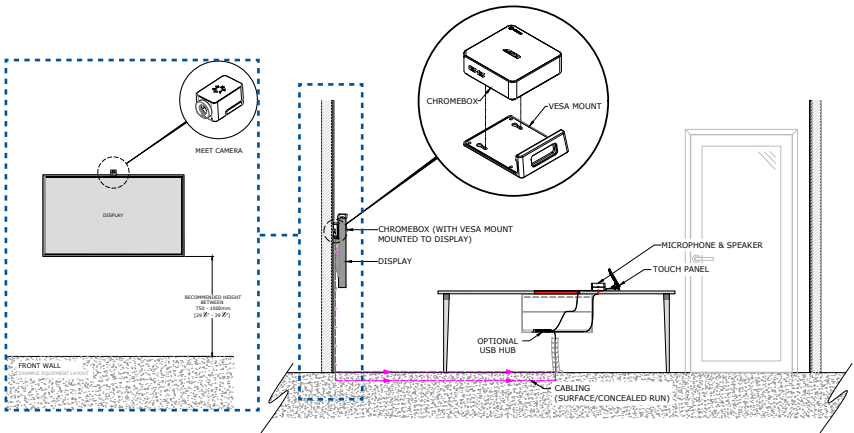

Room layout example

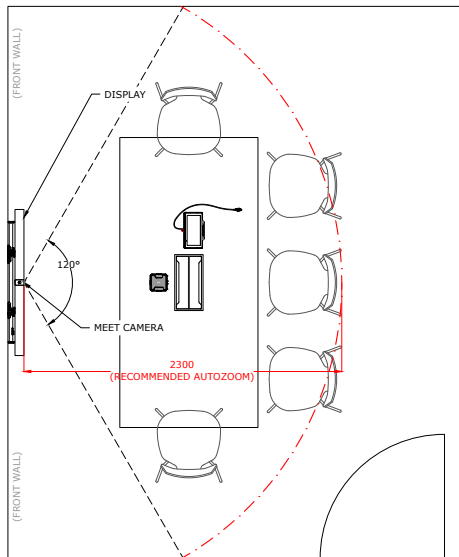

Recommended meeting room configuration 2

System setup

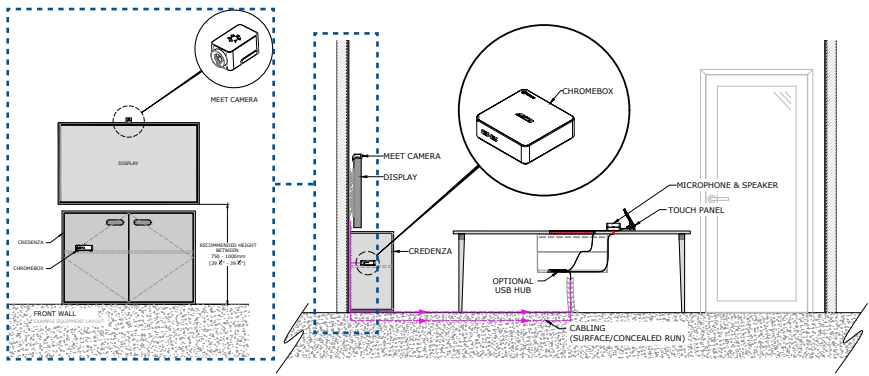

Room layout example

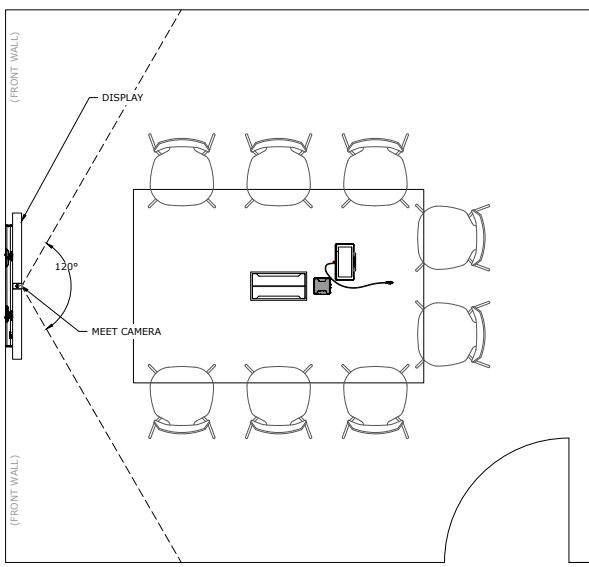

Connect your cables

Using the included cables and sensor, connect your Chromebox to the other system components:

NOTE: The connections shown in the illustrations are recommended, you may adjust the connections accordingly to suit your needs.

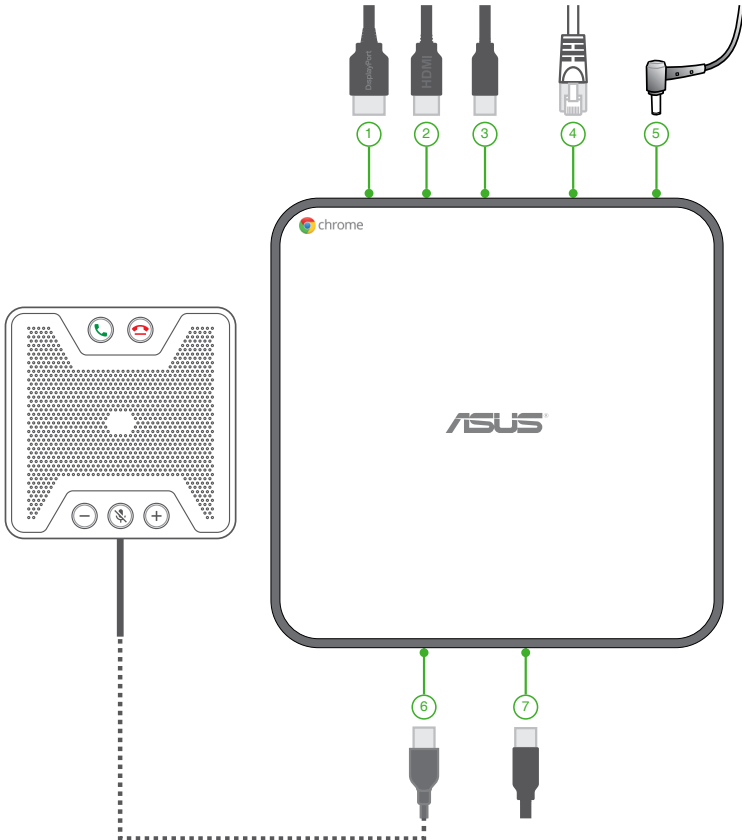

- ① DisplayPort connects a display with DisplayPort connector.
- ② HDMI connects a display with HDMI connector.
- ③ USB 3.1 Gen 1 port connects the camera.

- ④ LAN port connects to a router.

NOTE: Although you can use your Chromebox device over a wireless network connection, we recommend using a wired network connection for optimal sound and video quality.

- ⑤ Power port connects to a power outlet.

IMPORTANT! Be sure to connect to a power outlet last, after you have made all the other connections.

- ⑥ USB 3.1 Gen 1 port connects the speaker/mic assembly.

- ⑦ USB 3.1 Gen 1 port connects to the touchscreen

You can find connection instructions for your specific model on the [Hangouts Meet hardware kit product site](#).

Enroll your device

Complete basic enrollment

This section explains the basic enrollment flow, which works for almost all users. To learn about other options shown during the enrollment process, see **Advanced enrollment options**.

NOTE: We recommend connecting a USB keyboard to make entering the enrollment information easier.

To complete basic enrollment:

1. Turn on the display.
2. Turn on the Chromebox.
3. Verify or change your language, keyboard layout, and network.

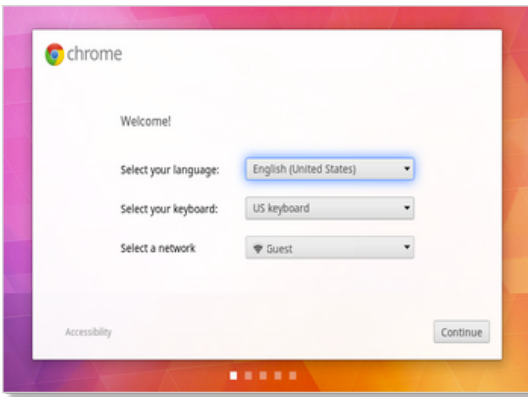

NOTE: If your network doesn't appear in the **Select a network** list, select **Join Network** and enter the correct settings. Ask your network administrator for the settings if you don't know them.

4. Select **Continue**.
5. **Accept** the Google Chrome OS Terms.
6. Sign in with your Google Apps email address and password.
7. The enrollment process takes place automatically. After the process is complete, click **Done**.
8. When the Hangouts screen appears, follow the onscreen instructions to test your camera and speakermic.

NOTE:

If you can't see video or hear audio during the test:

Ensure that your camera and speakermic were connected to your Chromebox before you turned on your device.

- Ensure that your camera and speakermic are connected to your device properly.
 - Unplug the cables and plug them in again, then restart your device.
-

9. Click through the screens to view tips on using Chromebox.

At the end of device enrollment, the screen displays a URL for this device's page in the Chromebox Admin console. Using this URL, an admin user must add the room's online calendar to the device to enable scheduled meetings.

Advanced enrollment options

Users can go through the simple enrollment flow described in [Complete basic enrollment](#) to enroll their device. Additional options are available for users who want to customize the setup experience or learn more. These options appear on the second enrollment screen, except for accessibility, which appears on both the first and second screens:

Accessibility: Accessibility options include larger font and cursor size, voice prompts, and more. The options you select here apply to the setup process and Out-of-box experience (OOBE) process. To select the Accessibility link, press the **Continue** or **Accept and continue** button.

NOTE: High contrast mode only takes effect during enrollment and not in the OOBE process.

Help make Chrome OS better: Allows your device to send usage and crash info to Google helping us improve the Chrome OS experience for all users. To learn more about this option, click the **Learn more** link onscreen.

System security setting: Read more about the Chromebox security settings.

Google Chrome OS Terms: Scroll up and down to review the terms.

Manage devices and rooms

You can view, modify and update your Chromebox and rooms through the Google Admin console. For more details on managing your devices and rooms, please visit the [Chromebox Help](#) website.

Troubleshooting

Fix a problem

Manage devices and rooms

I do not know how to identify the Chromebox device I want on the device list screen.

If you are not sure which device to click, you can identify the correct one by its serial number. You can find your device's serial number on the card that was included in the box and on the bottom of the device itself.

Help and support

Visit support.google.com/chromedevicesformetings for more detailed set-up and provisioning instructions, customizable table mats, or to print guides for your users.

Appendix

Safety information

Your Chromebox is designed and tested to meet the latest standards of safety for information technology equipment. However, to ensure your safety, it is important that you read the following safety instructions.

Setting up your system

- Read and follow all instructions in the documentation before you operate your system.
- Do not use this product near water or a heated source.
- Set up the system on a stable surface.
- Openings on the chassis are for ventilation. Do not block or cover these openings. Make sure you leave plenty of space around the system for ventilation. Never insert objects of any kind into the ventilation openings.
- Use this product in environments with ambient temperatures between 0°C and 35°C.
- If you use an extension cord, make sure that the total ampere rating of the devices plugged into the extension cord does not exceed its ampere rating.
- This equipment should be installed and operated with a minimum distance of 20cm between the radiator and your body.

Care during use

- Do not walk on the power cord or allow anything to rest on it.
- Do not spill water or any other liquids on your system.
- When the system is turned off, a small amount of electrical current still flows. Always unplug the power cord from the power outlets before cleaning the system.
- If you encounter the following technical problems with the product, unplug the power cord and contact a qualified service technician or your retailer.
 - The power cord or plug is damaged.
 - Liquid has been spilled into the system.
 - The system does not function properly even if you follow the operating instructions.
 - The system was dropped or the cabinet is damaged.
 - The system performance changes.

Lithium-Metal Battery Warning

CAUTION: Danger of explosion if battery is incorrectly replaced. Replace only with the same or equivalent type recommended by the manufacturer. Dispose of used batteries according to the manufacturer's instructions.

NO DISASSEMBLY

The warranty does not apply to the products that have been disassembled by users



DO NOT throw the Chromebox in municipal waste. This product has been designed to enable proper reuse of parts and recycling. This symbol of the crossed out wheeled bin indicates that the product (electrical, electronic equipment, and mercury-containing button cell battery) should not be placed in municipal waste. Check local technical support services for product recycling.

Regulatory notices

REACH

Complying with the REACH (Registration, Evaluation, Authorization, and Restriction of Chemicals) regulatory framework, we publish the chemical substances in our products at ASUS REACH website at <http://csr.asus.com/english/REACH.htm>

ASUS Recycling/Takeback Services

ASUS recycling and takeback programs come from our commitment to the highest standards for protecting our environment. We believe in providing solutions for you to be able to responsibly recycle our products, batteries, other components, as well as the packaging materials. Please go to <http://csr.asus.com/english/Takeback.htm> for the detailed recycling information in different regions.

COATING NOTICE

IMPORTANT! To provide electrical insulation and maintain electrical safety, a coating is applied to insulate the device except on the areas where the I/O ports are located.

Federal Communications Commission Statement

This device complies with Part 15 of the FCC Rules. Operation is subject to the following two conditions:

- This device may not cause harmful interference, and
- This device must accept any interference received including interference that may cause undesired operation.

This equipment has been tested and found to comply with the limits for a Class B digital device, pursuant to Part 15 of the FCC Rules. These limits are designed to provide reasonable protection against harmful interference in a residential installation. This equipment generates, uses and can radiate radio frequency energy and, if not installed and used in accordance with manufacturer's instructions, may cause harmful interference to radio communications. However, there is no guarantee that interference will not occur in a particular installation.

If this equipment does cause harmful interference to radio or television reception, which can be determined by turning the equipment off and on, the user is encouraged to try to correct the interference by one or more of the following measures:

- Reorient or relocate the receiving antenna.
- Increase the separation between the equipment and receiver.
- Connect the equipment to an outlet on a circuit different from that to which the receiver is connected.
- Consult the dealer or an experienced radio/TV technician for help.

CAUTION! Any changes or modifications not expressly approved by the grantee of this device could void the user's authority to operate the equipment.

RF exposure warning

This equipment must be installed and operated in accordance with provided instructions and the antenna(s) used for this transmitter must be installed to provide a separation distance of at least 20 cm from all persons and must not be co-located or operating in conjunction with any other antenna or transmitter. End-users and installers must be provide with antenna installation instructions and transmitter operating conditions for satisfying RF exposure compliance.

ISED Radiation Exposure Statement for Canada

This equipment complies with ISED radiation exposure limits set forth for an uncontrolled environment. To maintain compliance with ISED RF exposure compliance requirements, please avoid direct contact to the transmitting antenna during transmitting. End users must follow the specific operating instructions for satisfying RF exposure compliance.

Operation is subject to the following two conditions:

- This device may not cause interference and
- This device must accept any interference, including interference that may cause undesired operation of the device.

Compliance Statement of Innovation, Science and Economic Development Canada (ISED)

This device complies with Innovation, Science and Economic Development Canada licence exempt RSS standard(s). Operation is subject to the following two conditions: (1) this device may not cause interference, and (2) this device must accept any interference, including interference that may cause undesired operation of the device.

Operation in the band 5150–5250 MHz is only for indoor use to reduce the potential for harmful interference to co-channel mobile satellite systems.

CAN ICES-3(B)/NMB-3(B)

Déclaration de conformité de Innovation, Sciences et Développement économique Canada (ISED)

Le présent appareil est conforme aux CNR d'Innovation, Sciences et Développement économique Canada applicables aux appareils radio exempts de licence. L'exploitation est autorisée aux deux conditions suivantes : (1) l'appareil ne doit pas produire de brouillage, et (2) l'utilisateur de l'appareil doit accepter tout brouillage radioélectrique subi, même si le brouillage est susceptible d'en compromettre le fonctionnement.

La bande 5150–5250 MHz est réservée uniquement pour une utilisation à l'intérieur afin de réduire les risques de brouillage préjudiciable aux systèmes de satellites mobiles utilisant les mêmes canaux.

CAN ICES-3(B)/NMB-3(B)

Wireless Operation Channel for Different Domains

N. America	2.412-2.462 GHz	Ch01 through CH11
Japan	2.412-2.484 GHz	Ch01 through Ch14
Europe ETSI	2.412-2.472 GHz	Ch01 through Ch13

Regional notice for Singapore

Complies with
IMDA Standards
DB103778

This ASUS product complies with IMDA Standards.

Regional notice for California



WARNING

Cancer and Reproductive Harm -
www.P65Warnings.ca.gov

ENERGY STAR complied product



ENERGY STAR is a joint program of the U.S. Environmental Protection Agency and the U.S. Department of Energy helping us all save money and protect the environment through energy efficient products and practices.

All ASUS products with the ENERGY STAR logo comply with the ENERGY STAR standard, and the power management feature is enabled by default. The monitor and computer are automatically set to sleep after 10 and 30 minutes of user inactivity. To wake your computer, click the mouse or press any key on the keyboard.

Please visit <http://www.energystar.gov/powermanagement> for detail information on power management and its benefits to the environment. In addition, please visit <http://www.energystar.gov> for detail information on the ENERGY STAR joint program.

NOTE: Energy Star is NOT supported on FreeDOS and Linux-based products.

ASUS contact information

ASUSTeK COMPUTER INC.

Address No. 15, Li-Te Rd., Peitou, Taipei 112, Taiwan
Telephone +886-2-2894-3447
Fax +886-2-2890-7798
Web site <http://www.asus.com>

Technical Support

Telephone +886-2-2894-3447 (0800-093-456)
Online support <http://support.asus.com/techserv/techserv.aspx>

ASUS COMPUTER INTERNATIONAL (America)

Address 800 Corporate Way, Fremont, CA 94539, USA
Telephone +1-510-739-3777
Fax +1-510-608-4555
Web site <http://usa.asus.com>

Technical Support

Support fax +1-812-284-0883
General support +1-812-282-2787
Online support <http://support.asus.com/techserv/techserv.aspx>

ASUS COMPUTER GmbH (Germany and Austria)

Address Harkort Str. 21-23, D-40880 Ratingen, Germany
Fax +49-2102-959991
Web site <http://www.asus.com/de>

Technical Support

Telephone (DE) +49-2102-5789555
Telephone (AT) +43-820-240513
Support Fax +49-2102-959911
Online support <http://support.asus.com/techserv/techserv.aspx>

Call center: <https://www.asus.com/support/CallUs>

Manufacturer	ASUSTeK Computer Inc.	
	Tel:	+886-2-2894-3447
	Address:	4F, No. 150, LI-TE RD., PEITOU, TAIPEI 112, TAIWAN
Authorised representative in Europe	ASUSTeK Computer GmbH	
	Address:	HARKORT STR. 21-23, 40880 RATINGEN, GERMANY

DECLARATION OF CONFORMITY

Per FCC Part 2 Section 2. 1077(a)



Responsible Party Name: **Asus Computer International**

Address: **800 Corporate Way, Fremont, CA 94539.**

Phone/Fax No: **(510)739-3777/(510)608-4555**

hereby declares that the product

Product Name : **Chromebox**

Model Number : **Chromebox XXXXXXXXXXXXXXXXXXXXXXXX**
(X can be 0~9,a~z,A~Z, / or blank)

Conforms to the following specifications:

FCC Part 15, Subpart B, Unintentional Radiators

Supplementary Information:

This device complies with part 15 of the FCC Rules. Operation is subject to the following two conditions: (1) This device may not cause harmful interference, and (2) this device must accept any interference received, including interference that may cause undesired operation.

Representative Person's Name : Steve Chang / President

A handwritten signature in blue ink that reads "Steve Chang". The signature is written in a cursive style and is placed over a light blue rectangular background.

Signature :

Original Declaration Date : Aug. 02, 2017
Corrected Declaration Date : Oct. 11, 2017

Ver. 170324

