

SUUNTO AMBIT3 SPORT 1.0

USER GUIDE

1 SAFETY	6
2 Getting started	8
2.1 Buttons and menus	8
2.2 Set up	9
2.3 Adjusting settings	12
3 Features	14
3.1 Activity monitoring	14
3.2 Autopause	15
3.3 Autoscroll	15
3.4 Backlight	16
3.5 Button lock	17
3.6 Compass	19
3.6.1 Calibrating compass	19
3.6.2 Setting declination	20
3.6.3 Setting bearing lock	22
3.7 Countdown timer	24
3.8 Displays	25
3.8.1 Adjusting display contrast	25
3.8.2 Inverting display color	26
3.9 Exercising with sport modes	26
3.9.1 Using Suunto Smart Sensor	26
3.9.2 Putting on Suunto Smart Sensor	28
3.9.3 Starting an exercise	29
3.9.4 During exercise	30
3.9.5 Recording tracks	31
3.9.6 Making laps	31
3.9.7 Navigating during exercise	32
3.9.8 Using compass during exercise	33

3.10 Find back	34
3.11 Firmware updates	35
3.12 FusedSpeed	35
3.13 Icons	38
3.14 Interval timer	41
3.15 Logbook	42
3.16 Memory left indicator	45
3.17 Movescount	46
3.18 Movescount mobile app	48
3.18.1 Second display on phone	49
3.18.2 Syncing with mobile app	49
3.19 Multisport training	51
3.19.1 Switching sport modes manually	51
3.19.2 Using a multisport mode	52
3.20 Navigating with GPS	53
3.20.1 Getting GPS signal	53
3.20.2 GPS grids and position formats	54
3.20.3 GPS accuracy and power saving	56
3.21 Notifications	56
3.22 PODs and HR sensors	57
3.22.1 Pairing PODs and HR sensors	58
3.22.2 Using foot POD	60
3.22.3 Calibrating power PODs and slope	61
3.23 Points of interest	64
3.23.1 Checking your location	66
3.23.2 Adding your location as a POI	67
3.23.3 Deleting a POI	68
3.24 Routes	69

3.24.1 Navigating a route	70
3.24.2 During navigation	74
3.25 Service menu	76
3.26 Shortcuts	78
3.27 Sport modes	79
3.28 Stopwatch	80
3.29 Suunto Apps	82
3.30 Swimming	82
3.30.1 Pool swimming	83
3.30.2 Swimming styles	84
3.30.3 Swimming drills	87
3.30.4 Openwater swimming	87
3.31 Time	88
3.31.1 Alarm clock	90
3.31.2 Time syncing	92
3.32 Track back	93
3.33 Training programs	94
4 Care and support	97
4.1 Handling guidelines	97
4.2 Water resistance	97
4.3 Charging the battery	98
4.4 Replacing Smart Sensor battery	99
4.5 Getting support	100
5 Reference	102
5.1 Technical specifications	102
5.2 Compliance	103
5.2.1 CE	103
5.2.2 FCC compliance	103

5.2.3 IC	103
5.3 Trademark	104
5.4 Patent notice	104
5.5 Warranty	104
5.6 Copyright	107
Index	109

1 SAFETY

Types of safety precautions

 **WARNING:** - is used in connection with a procedure or situation that may result in serious injury or death.

 **CAUTION:** - is used in connection with a procedure or situation that will result in damage to the product.

 **NOTE:** - is used to emphasize important information.

 **TIP:** - is used for extra tips on how to utilize the features and functions of the device.

Safety precautions

 **WARNING:** ALLERGIC REACTIONS OR SKIN IRRITATIONS MAY OCCUR WHEN PRODUCT IS IN CONTACT WITH SKIN, EVEN THOUGH OUR PRODUCTS COMPLY WITH INDUSTRY STANDARDS. IN SUCH EVENT, STOP USE IMMEDIATELY AND CONSULT A DOCTOR.

 **WARNING:** ALWAYS CONSULT YOUR DOCTOR BEFORE BEGINNING AN EXERCISE PROGRAM. OVEREXERTION MAY CAUSE SERIOUS INJURY.

 **WARNING:** ONLY FOR RECREATIONAL USE.

 **WARNING:** DO NOT ENTIRELY RELY ON THE GPS OR BATTERY LIFETIME, ALWAYS USE MAPS AND OTHER BACKUP MATERIAL TO ENSURE YOUR SAFETY.

 **CAUTION:** DO NOT APPLY SOLVENT OF ANY KIND TO THE PRODUCT, AS IT MAY DAMAGE THE SURFACE.

 **CAUTION:** DO NOT APPLY INSECT REPELLENT ON THE PRODUCT, AS IT MAY DAMAGE THE SURFACE.

 **CAUTION:** DO NOT THROW THE PRODUCT AWAY, BUT TREAT IT AS ELECTRONIC WASTE TO PRESERVE THE ENVIRONMENT.

 **CAUTION:** DO NOT KNOCK OR DROP THE DEVICE, AS IT MAY BE DAMAGED.

2 GETTING STARTED

2.1 Buttons and menus

Suunto Ambit3 Sport has five buttons which allow you to access all the features.

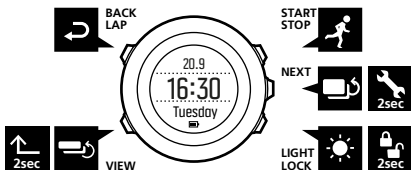

[Start Stop]:

- press to access the start menu
- press to start, pause or resume an exercise or timer
- press to increase a value or move up in the menu
- keep pressed to stop and save an exercise

[Next]:

- press to change displays
- press to accept a setting
- keep pressed to access/exit the options menu
- keep pressed to access/exit the options menu in sport modes

[Light Lock]:

- press to activate the backlight
- press to decrease a value or move down in the menu
- keep pressed to lock/unlock the buttons

[View]:

- press to change bottom row view
- keep pressed to toggle the display between light and dark
- keep pressed to access shortcut (see *3.26 Shortcuts*)

[Back Lap]:

- press return to the previous menu
- press to add a lap during exercise

 **TIP:** When changing values, you can increase the speed by keeping [Start Stop] or [Light Lock] pressed until the values start to scroll faster.

2.2 Set up

Your Suunto Ambit3 Sport wakes up automatically when you attach it to your computer or a USB charger using the supplied USB cable.

To start using your sports watch:

1. Connect your sports watch to a power source with the supplied USB cable.
2. Disconnect the USB cable if you are using a computer (to unlock buttons).
3. Press [Start Stop] or [Light Lock] to scroll to the desired language and press [Next] to select.
4. Pair with Suunto Movescount App (see *3.18 Movescount mobile app*) by pressing [Start Stop] or skip by pressing [Next].

5. Follow the startup wizard to complete initial settings. Set values with [Start Stop] or [Light Lock] and press [Next] to accept and go to the next step.
6. Reconnect USB cable and charge until battery indicator is 100%.

1.

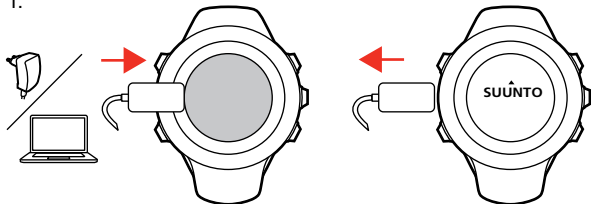

2.

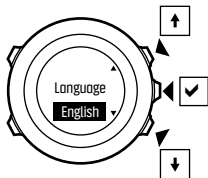

3.

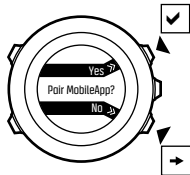

4.

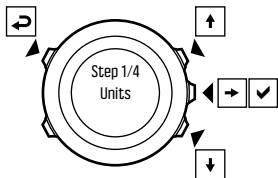

5.



Fully charging an empty battery takes about 2-3 hours. Buttons are locked while the USB cable is attached and connected to a computer.

You can exit the startup wizard at any time by keeping [Next] pressed.

The startup wizard takes you through the following settings:

- Units
- Time
- Date
- Personal settings (gender, age, weight)

2.3 Adjusting settings

You can change the settings of your Suunto Ambit3 Sport directly in the watch, through Movescount, or on the go with Suunto Movescount App (see *3.18 Movescount mobile app*).

To change the settings in the watch:

1. Keep [Next] pressed to enter the options menu.
2. Scroll the menu with [Start Stop] and [Light Lock].
3. Press [Next] to enter a setting.
4. Press [Start Stop] and [Light Lock] to adjust the setting values.
5. Press [Back Lap] to return to the previous menu or keep [Next] pressed to exit.

1.

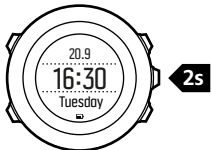

2-5.

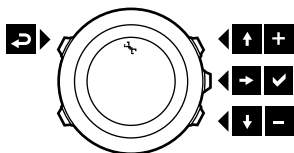

3 FEATURES

3.1 Activity monitoring

In addition to the recovery time shown in your exercise log, Suunto Ambit3 Sport monitors you overall activity, both exercise and daily activity. Activity monitoring gives you a complete picture of your activity, the calories you are burning, and your recovery time.

Activity monitoring is available as a default display in **TIME**. You can view the display by pressing [Next] (last display).

You can show/hide the activity monitoring display from the start menu under **DISPLAYS » Activity**. Toggle with [Next].

The activity monitoring display has three views which you can change by pressing [View].

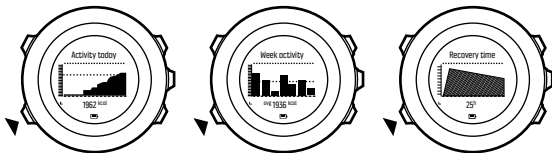

- **Activity today:** calorie consumption today; the dotted line on the bar graph indicates average daily calorie consumption for the past seven days, not including today
- **Week activity:** daily calorie consumption over the last seven days with today furthest to the right; the dotted line on the bar

graph and lower row indicate average daily calorie consumption for the past seven days, not including today

- **Recovery time:** recovery time for the next 24 hours based on recorded exercises and daily activity

3.2 Autopause

Autopause pauses the recording of your exercise when your speed is less than 2 km/h (1.2 mph). When your speed increases to more than 3 km/h (1.9 mph), the recording continues automatically.

You can turn **Autopause** on/off for each sport mode in Movescount under the advanced settings for the sport mode.

You can also turn **Autopause** on/off during exercise without any effect on your Movescount settings.

To turn **Autopause** on/off during exercise:

1. While you are in a sport mode, keep [Next] pressed to access the options menu.
2. Scroll to **ACTIVATE** with [Light Lock] and select with [Next].
3. Scroll to **Autopause** with [Start Stop] and select with [Next].
4. Toggle on/off with [Start Stop] or [Light Lock].
5. Keep [Next] pressed to exit.

3.3 Autoscroll

Set your watch to automatically scroll through your sport mode displays while exercising by using **Autoscroll**.

In Movescount, you can turn **Autoscroll** on/off for each sport mode and define how long the displays are shown.

You can also turn **Autoscroll** on/off during exercise without any effect on your Movescount settings.

To turn **Autoscroll** on/off during exercise:

1. While you are in a sport mode, keep [Next] pressed to access the options menu.
2. Scroll to **ACTIVATE** with [Light Lock] and select with [Next].
3. Scroll to **Autoscroll** with [Start Stop] and select with [Next].
4. Toggle on/off with [Start Stop] or [Light Lock].
5. Keep [Next] pressed to exit.

3.4 Backlight

Pressing [Light Lock] activates the backlight.

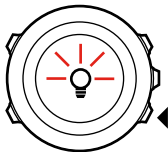

By default, the backlight turns on for a few seconds and turns off automatically. This is the **Normal** mode.

There are three different backlight modes:

Mode:

- **Normal:** The backlight turns on for a few seconds when you press [Light Lock] and when the alarm clock sounds.

- **Off:** The backlight is not switched on by pressing a button or when the alarm clock sounds.
- **Night:** The backlight turns on for a few seconds when you press any button and when the alarm clock sounds.
- **Toggle:** The backlight turns on when you press [Light Lock] and stays on until you press [Light Lock] again.

Your Suunto Ambit3 Sport has two backlight settings: one 'general' setting and one for sport modes.

You can change the general backlight setting in the watch settings under **GENERAL » Tones/display » Backlight**. See *2.3 Adjusting settings*. You can also change the general setting in Movescount.

You sport modes can use the same backlight mode as the general setting (default), or you can define a different mode for each sport mode under the advanced settings in Movescount.

In addition to the mode, you can adjust the backlight brightness (in percent), either in the watch settings under **GENERAL » Tones/display » Backlight** or in Movescount.

 **TIP:** *When the [Back Lap] and [Start Stop] buttons are locked, you can still activate the backlight by pressing [Light Lock].*

3.5 Button lock

Keeping [Light Lock] pressed locks and unlocks buttons.



You can change the button lock behavior in the watch settings under **GENERAL » Tones/display » Button lock**.

Your Suunto Ambit3 Sport has two button lock settings: one for general use, **Time mode lock**, and one for when you are exercising, **Sport mode lock**:

Time mode lock:

- **Actions only:** Start and options menus are locked.
- **All buttons:** All buttons are locked. Backlight can be activated in **Night mode**.

Sport mode lock

- **Actions only:** [Start Stop], [Back Lap] and the options menu are locked during exercise.
- **All buttons:** All buttons are locked. Backlight can be activated in **Night mode**.

 **TIP:** Select the **Actions only** button lock setting for sport modes to avoid accidentally starting or stopping your log. When the [Back Lap] and [Start Stop] buttons are locked, you can still change displays by pressing [Next] and views by pressing [View].

3.6 Compass

Suunto Ambit3 Sport has a digital compass that allows you to orient yourself in relation to magnetic north. The tilt-compensated compass gives you accurate readings even if the compass is not horizontally level.

You can show/hide the compass display from the start menu under **DISPLAYS » Compass**. Toggle with [Next].

The compass display includes the following information:

- middle row: compass heading in degrees
- bottom row: change view to current heading in cardinals, to time or empty with [View]

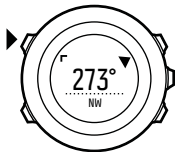

The compass switches to power saving mode after one minute. Reactivate it with [Start Stop].

3.6.1 Calibrating compass

If you have not used the compass before, you must first calibrate it. Turn and tilt the watch in multiple directions until the watch beeps, indicating calibration is complete.

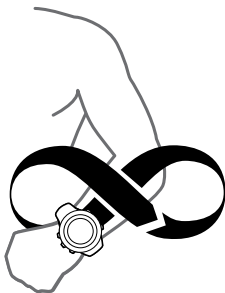

If you have already calibrated the compass and want to re-calibrate it, you can access the calibration option in the options menu.

If the calibration is successful, the text **CALIBRATION SUCCESSFUL** is displayed. If the calibration does not succeed, the text **CALIBRATION FAILED** is displayed. To retry the calibration, press [Start Stop].

To manually start compass calibration:

1. Keep [Next] pressed to enter the options menu.
2. Select to **GENERAL** with [Next].
3. Scroll to **Compass** with [Light Lock] and select with [Next].
4. Press [Next] to select **Calibration**.

3.6.2 Setting declination

To ensure correct compass readings, set an accurate declination value.

Paper maps point to true north. Compasses, however, point to magnetic north – a region above the Earth where the Earth's magnetic fields pull. Because magnetic North and true North are not at the same location, you must set the declination on your compass. The angle in between magnetic and true north is your declination.

The declination value appears on most maps. The location of magnetic north changes yearly, so the most accurate and up-to-date declination value can be obtained from the internet (for example www.magnetic-declination.com).

Orienteering maps, however, are drawn in relation to magnetic north. This means that when you are using orienteering maps you need to turn the declination correction off by setting the declination value to 0 degrees.

To set the declination value:

1. Keep [Next] pressed to enter the options menu.
2. Press [Next] to enter **GENERAL**.
3. Scroll to **Compass** using [Light Lock] and select with [Next].
4. Scroll to **Declination** with [Light Lock] and select with [Next].
5. Turn the declination off by selecting --, or select **W** (west) or **E** (east).
6. Set the declination value with [Start Stop] or [Light Lock].
7. Press [Next] to accept the setting.

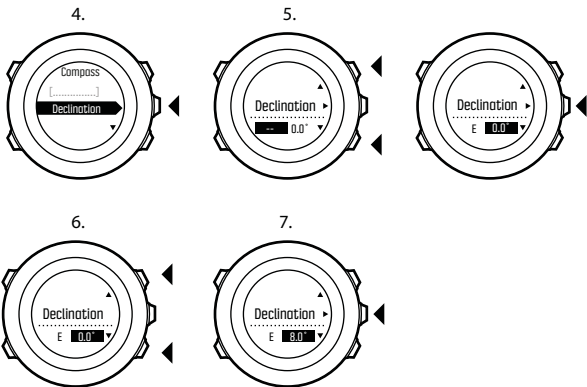

 **TIP:** You can also access the compass settings by keeping [View] pressed in **COMPASS** mode.

3.6.3 Setting bearing lock

You can mark the direction to your target in relation to North with the bearing lock feature.

To lock a bearing:

1. With the compass active, hold the watch in front of you and turn yourself towards your target.

2. Press [Back Lap] to lock the current degree displayed on the watch as your bearing.
3. An empty triangle indicates the locked bearing in relation to the North indicator (solid triangle).
4. Press [Back Lap] to clear the bearing lock.

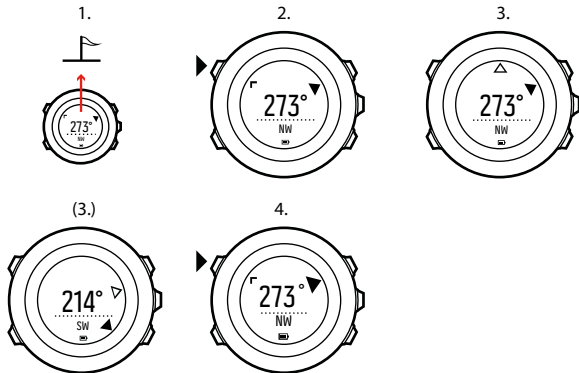

 **NOTE:** While using the compass in an exercise mode, the [Back Lap] button only locks and clears the bearing. Exit the compass view to make a lap with [Back Lap].

3.7 Countdown timer

You can use the countdown timer to count down from a preset time to zero. The timer makes a short sound every second during the last 10 seconds and sounds an alarm when zero is reached.

You can show/hide the countdown timer from the start menu under **DISPLAYS » Countdown**. Toggle with [Next].

To set the countdown time:

1. Press [Next] to until you reach the countdown timer display.
2. Press [View] to adjust the countdown time.
3. Set the hours and minutes with [Start Stop] and [Light Lock]. Accept with [Next].
4. Press [Start Stop] to start the countdown.

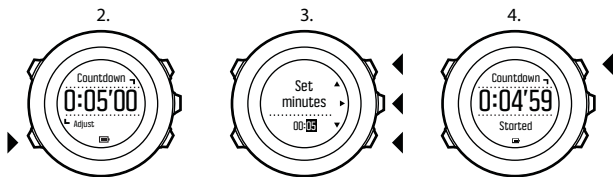

 **TIP:** You can pause/continue the countdown by pressing [Start Stop].

3.8 Displays

Your Suunto Ambit3 Sport comes with several different features, such as compass (see *3.6 Compass*) and stopwatch (see *3.28 Stopwatch*), that are handled as displays that can be viewed by pressing [Next]. Some of them are permanent, and others you can show or hide as you like.

To show/hide displays:

1. Press [Start Stop] to enter the start menu.
2. Scroll to **DISPLAYS** by pressing [Light Lock] and press [Next].
3. In the list of display, toggle any feature on/off by scrolling to it with Start Stop or Light Lock and pressing Next.

Keep [Next] pressed to exit the displays menu if needed.

Your sport modes (see *3.27 Sport modes*) also have multiple displays that that you can customize to view different information while you exercise.

3.8.1 Adjusting display contrast

Increase or decrease the display contrast of your Suunto Ambit3 Sport in the watch settings.

To adjust the display contrast:

1. Keep [Next] pressed to enter the options menu.
2. Press [Next] to enter the **GENERAL** settings.
3. Press [Next] to enter **Tones/display**.
4. Scroll to **Display contrast** with [Light Lock] and enter with [Next].
5. Increase the contrast with [Start Stop], or decrease it with [Light Lock].

6. Keep [Next] pressed to exit.

3.8.2 Inverting display color

Change the display between dark and light through the settings in the watch or in Movescount, or by simply using the default [View] button shortcut (see *2.1 Buttons and menus*). You can also define the display color for a sport mode in Movescount.

To invert the display in the watch settings:

1. Keep [Next] pressed to enter the options menu.
2. Press [Next] to enter the **GENERAL** settings.
3. Press [Next] to enter **Tones/display**.
4. Scroll to **Invert display** with [Start Stop] and invert with [Next].

3.9 Exercising with sport modes

Use sport modes (see *3.27 Sport modes*) to record exercise logs and view various information during your exercise.

You can access the sport modes under **EXERCISE** menu by pressing [Start Stop].

3.9.1 Using Suunto Smart Sensor

A Bluetooth® Smart compatible heart rate sensor, such as the Suunto Smart Sensor, can be used with your Suunto Ambit3 Sport to give you more detailed information about your exercise intensity.

While exercising, the heart rate sensor enables:

- heart rate in real time
- average heart rate in real time

- heart rate in graph form
- calories burned during exercise
- guidance to exercise within defined heart rate limits
- Peak Training Effect

And after exercise, the heart rate sensor provides:

- total calories burned during exercise
- average heart rate
- peak heart rate
- recovery time

If you use the Suunto Smart Sensor, you also have the added advantage of heart rate memory. The Suunto Smart Sensor memory function buffers data whenever the transmission to your Suunto Ambit3 Sport is interrupted.

This allows you to get accurate exercise intensity information in activities such as swimming where water blocks the transmission. It also means you can even leave your Suunto Ambit3 Sport behind after starting a recording. For more information, please refer to the Suunto Smart Sensor User Guide.

Without a heart rate sensor, your Suunto Ambit3 Sport provides calorie consumption and recovery time for running and cycling activities where speed is used to estimate intensity. However, we recommend using a heart rate sensor to get accurate intensity readings.

Refer to the user guide for Suunto Smart Sensor or other Bluetooth Smart compatible heart rate sensor for additional information.

3.9.2 Putting on Suunto Smart Sensor

To start using the Suunto Smart Sensor:

1. Snap the sensor firmly into the strap connector.
2. Adjust the strap length as needed.
3. Moisten the strap electrode areas with water or electrode gel.
4. Put the strap on so that it fits snugly and the Suunto logo is facing up.

1.

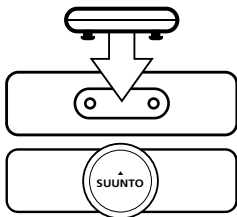

3. - 4.

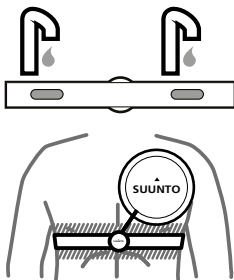

The Smart Sensor turns on automatically when it detects a heart beat.

 **TIP:** Wear the strap against your bare skin for best results.

Refer to the Suunto Smart Sensor User Guide for additional information and troubleshooting.

3.9.3 Starting an exercise

To start exercising:

1. Press [Start Stop] to enter the start menu.
2. Press [Next] to enter **EXERCISE**.
3. Scroll the sport mode options with [Start Stop] or [Light Lock] and select a suitable mode with [Next].
4. The watch automatically starts searching for a heart rate belt signal, if the selected sport mode uses a heart rate belt. Wait for the watch to notify that the heart rate and/or GPS signal have been found, or press [Start Stop] to select **Later**. The watch continues to search the heart rate/GPS signal.
5. Press [Start Stop] to start recording your exercise. To access additional options while exercising, keep [Next] pressed.

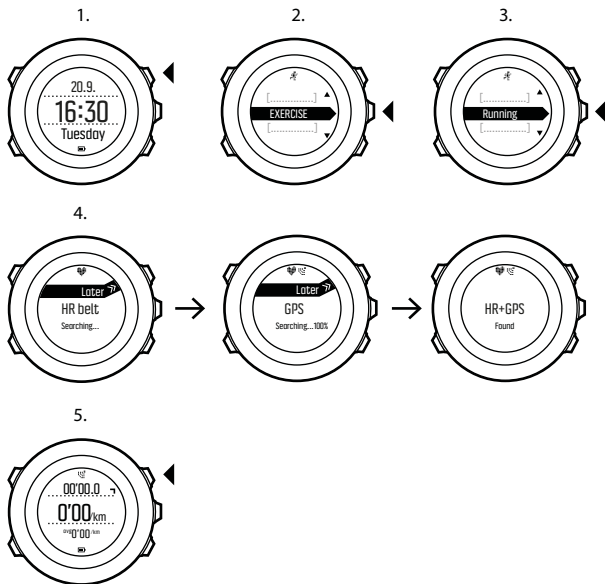

3.9.4 During exercise

Suunto Ambit3 Sport gives you a wealth of information during your exercise. The information varies depending on the sport mode you

have selected (see *3.27 Sport modes*). You get even more information, if you use a heart rate belt and GPS during exercise.

Here are some ideas on how to use the watch during exercise:

- Press [Next] to see scroll through your sport mode displays.
- Press [View] to see different information the bottom row of the display.
- To avoid accidentally stopping your log recording or making unwanted laps, lock the buttons by keeping [Light Lock] pressed.
- Press [Start Stop] to pause recording. To resume recording, press [Start Stop] again.

3.9.5 Recording tracks

Depending on the sport mode you have selected, your Suunto Ambit3 Sport allows you to record various information during exercise.

If your sport mode has GPS enabled, Suunto Ambit3 Sport also records your track during your exercise. You can view the track in Movescount as part of the recorded Move and export it as a route to use later.

3.9.6 Making laps

During your exercise, you can make laps either manually or automatically by setting the autolap interval in Movescount. When you are making laps automatically, Suunto Ambit3 Sport records the laps based on the distance you have specified in Movescount.

To make laps manually, press [Back Lap] during the exercise.

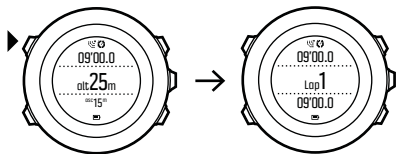

Suunto Ambit3 Sport shows you the following information:

- top row: split time (duration from the start of the log)
- middle row: lap number
- bottom row: lap time

 **NOTE:** *The exercise summary always shows at least one lap, your exercise from start to finish. The laps you have made during the exercise are shown as additional laps.*

3.9.7 Navigating during exercise

If you want to run a route or to a point of interest (POI), you can select a sport mode, such as Run a Route, and begin navigating immediately.

You can also navigate a route or to a POI during your exercise in other sport modes that have GPS activated.

To navigate during exercise:

1. While you are in a sport mode with GPS activated, keep [Next] pressed to access the options menu.
2. Press [Next] to select **NAVIGATION**.

3. Scroll to **POIs (Points of interest)** or **Routes** with [Light Lock] and select with [Next].

The navigation guidance is shown as the last display on the selected sport mode.

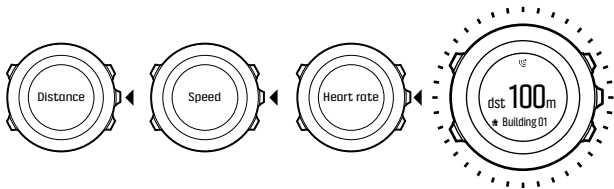

To deactivate navigation, go back to **NAVIGATION** in the options menu and select **End navigation**.

 **NOTE:** If the GPS accuracy setting (see 3.20.3 GPS accuracy and power saving) of your sport mode is **Good** or lower, while navigating GPS accuracy switches to **Best**. Battery consumption is therefore higher.

3.9.8 Using compass during exercise

You can activate the compass and add it to a custom sport mode during your exercise.

To use the compass during exercise:

1. While you are in a sport mode, keep [Next] pressed to access the options menu.

2. Scroll to **ACTIVATE** with [Light Lock] and select with [Next].
3. Scroll to **Compass** with [Light Lock] and select with [Next].
4. The compass is shown as the last display on the custom sport mode.

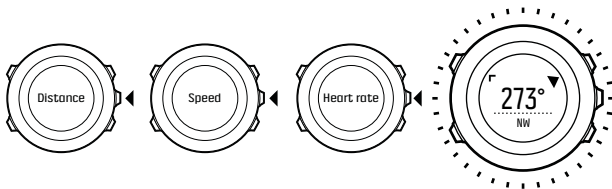

To deactivate the compass, go back to **ACTIVATE** in the options menu and select **End compass**.

3.10 Find back

Suunto Ambit3 Sport automatically saves the starting point of your exercise, if you are using GPS. With Find back, Suunto Ambit3 Sport can guide you directly back to your starting point (or to the location where the GPS fix was established).

To find back:

1. While you are in a sport mode, keep [Next] pressed to access the options menu.
2. Press [Next] to select **NAVIGATION**.
3. Scroll to **Find back** with [Start Stop] and select with [Next].

The navigation guidance is shown as the last display on the selected sport mode.

3.11 Firmware updates

You can update your Suunto Ambit3 Sport software through Movescount. When you update the software, all logs are automatically moved to Movescount and deleted from the watch.

To update your Suunto Ambit3 Sport software:

1. Install Moveslink if you have not done so already.
2. Connect your Suunto Ambit3 Sport to your computer with the supplied USB cable.
3. If an update is available, your watch is updated automatically. Wait for the update to complete before unplugging the USB cable.

3.12 FusedSpeed

FusedSpeed™ is a unique combination of GPS and wrist acceleration sensor readings for measuring your running speed more accurately. The GPS signal is adaptively filtered based on wrist acceleration, giving more accurate readings at steady running speeds and a quicker responses to changes in speed.

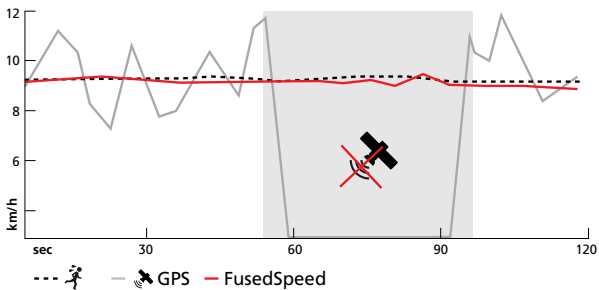

FusedSpeed benefits you the most when you need highly reactive speed readings during training, for example, when running on uneven terrain or during interval training. If you temporarily lose the GPS signal, for example, Suunto Ambit3 Sport is able to continue showing accurate speed readings with the help of the GPS calibrated accelerometer.

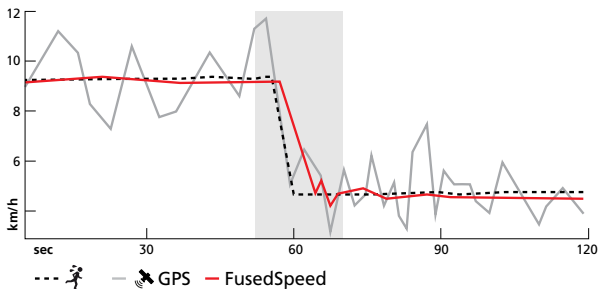

 **TIP:** To get the most accurate readings with FusedSpeed, only glance shortly at the watch when needed. Holding the watch in front of you without moving it reduces the accuracy.

FusedSpeed is automatically enabled for running and other similar types of activities, such as orienteering, floor ball and football (soccer).

To enable FusedSpeed for a custom sport mode, ensure you select an activity that uses FusedSpeed. This is indicated at the end of the sport mode advanced settings section in Movescount.

3.13 Icons

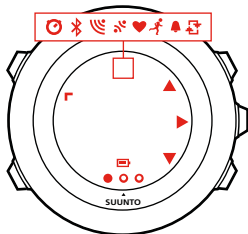

The following icons are displayed in Suunto Ambit3 Sport:



alarm



battery



Bluetooth activity



button lock



button press indicators



chronograph



current display



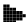

down/decrease

	GPS signal strength
	heart rate
	incoming call
	interval timer
	message/notification
	missed call
	next/confirm
	pairing
	settings
	sport mode
	up/increase

POI icons

The following POI icons are available in Suunto Ambit3 Sport:

	begin
	building/home
	camp/camping

	car/parking
	cave
	crossroad
	end
	food/restaurant/cafe
	forest
	geocache
	lodging/hostel/hotel
	meadow
	mountain/hill/valley/cliff
	road/trail
	rock
	sight
	water/river/lake/coast
	waypoint

3.14 Interval timer

You can add an interval timer to each custom sport mode in Movescount. To add the interval timer to a sport mode, select the sport mode and go to **Advanced settings**. The next time you connect your Suunto Ambit3 Sport to your Movescount account, the interval timer is synchronized to the watch.

You can specify the following information in the interval timer:

- interval types (**HIGH** and **LOW** interval)
- duration or distance for both interval types
- number of times the intervals are repeated

 **NOTE:** *If you do not set the number of repetitions for the intervals in Movescount, the interval timer continues until it has been repeated 99 times.*

You can set an interval timer for each sport included in a multisport mode (see *3.19.2 Using a multisport mode*). The interval timer restarts when the sport changes.

To activate/deactivate the interval timer:

1. While you are in a sport mode, keep [Next] pressed to access the options menu.
2. Scroll to **ACTIVATE** with [Light Lock] and select with [Next].
3. Scroll to **Interval** with [Start Stop] and select with [Next].
4. Press [Start Stop] or [Light Lock] to set the interval timer **On/Off** and accept with [Next].

When the interval timer is active, the interval icon is shown at the top of the display.

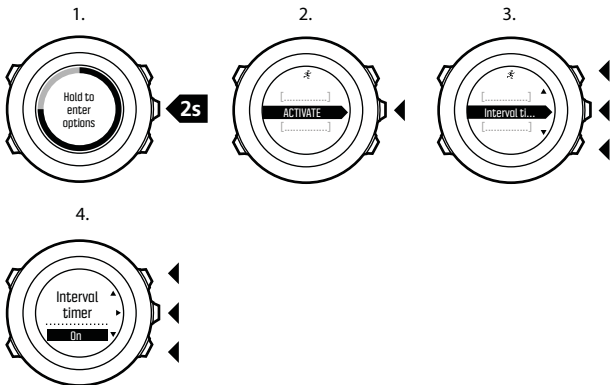

3.15 Logbook

The logbook stores the logs of your recorded activities. The maximum number of logs and the maximum duration of a single log depend on how much information is recorded in each activity. GPS accuracy (see 3.20.3 *GPS accuracy and power saving*) and using the interval timer (see 3.14 *Interval timer*), for example, directly impact the number and duration of logs that can be stored.

You can view the log summary of your activity right after you have stopped recording or through the **LOGBOOK** under the start menu. The information shown in the log summary is dynamic: it changes depending factors such as sport mode and whether or not you used an heart rate belt or GPS. By default, all logs include at minimum the following information:

- sport mode name
- time
- date
- duration
- laps



TIP: You can see many more details of your recorded activities in *Movescount.com*.

To view log summary after stopping a recording:

1. Keep [Start Stop] pressed to stop and save the exercise.

Alternatively, you press [Start Stop] to pause the recording. After pausing, stop by pressing [Back Lap], or continue recording by pressing [Start Stop].

After pausing and stopping the exercise, save the log by pressing [Start Stop]. If you do not want to save the log, press [Light Lock]. If you do not save the log, you can still view the log summary after pressing [Light Lock], but the log is not stored in the logbook for later viewing.

2. Press [Next] to view the log summary.

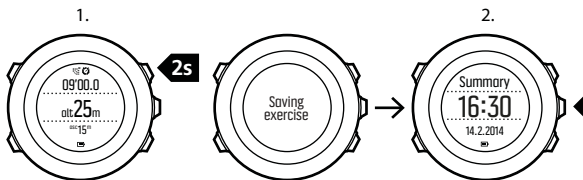

You can also view the summaries of all your saved exercises in the logbook. In the logbook the exercises are listed according to date and time.

To view summary log in the logbook:

1. Press [Start Stop] to enter the start menu.
2. Scroll to **LOGBOOK** with [Light Lock] and enter with [Next]. Your current recovery time is shown.
3. Scroll the logs with [Start Stop] or [Light Lock] and select a log with [Next].
4. Browse the summary views of the log with [Next].

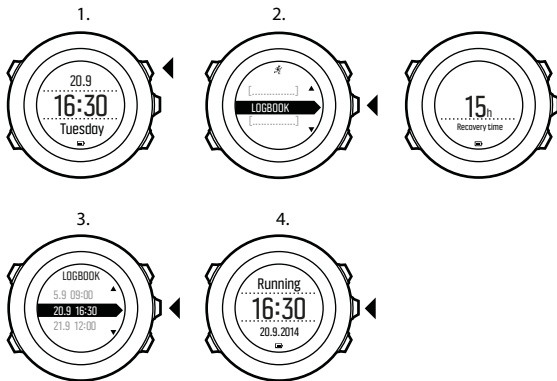

If the log includes multiple laps, you can view lap-specific information by pressing [View].

3.16 Memory left indicator

If more than 50 % of the logbook has not been synchronized with Movescount, Suunto Ambit3 Sport displays a reminder when you enter the logbook.

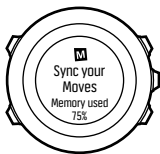

The reminder is not displayed once the unsynced memory is full and Suunto Ambit3 Sport begins overwriting old logs.

3.17 Movescount

Movescount.com is your free personal diary and online sports community that offers you a rich set of tools to manage your daily activities and create engaging stories about your experiences. Movescount allows you to transfer your recorded exercise logs from your Suunto Ambit3 Sport to Movescount and customize the watch to best meet your needs.

 **TIP:** *Connect to Movescount to get the latest firmware update for your Suunto Ambit3 Sport.*

Start by installing Moveslink:

1. Go to www.movescount.com/moveslink.
2. Download, install and open the latest version of Moveslink.

1.

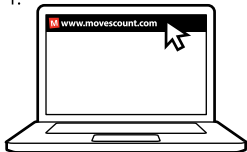

2.



To register to Movescount:

1. Go to www.movescount.com.
2. Create your account.

1.

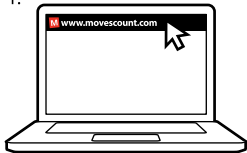

2.



 **NOTE:** The first time your Suunto Ambit3 Sport is connected to Movescount all information (including the watch settings) is transferred from the watch to your Movescount account. The next time you connect your Suunto Ambit3 Sport to your Movescount account, changes in settings and sport modes you make in Movescount and in the watch are automatically synchronized.

3.18 Movescount mobile app

With the Suunto Movescount App, you can further enrich your Suunto Ambit3 Sport experience. Pair with the mobile app to get notifications on your Suunto Ambit3 Sport, change settings and customize sport modes on the go, use your mobile device as a second display, take pictures with data from your move, and create Suunto Movies.

 ***TIP:** With any move that is stored in Movescount, you can add pictures as well as create a Suunto Movie of the move using Suunto Movescount App.*

To pair with Suunto Movescount App:

1. Download and install Suunto Movescount App on your compatible Apple device from the iTunes App Store. The app description includes the latest compatibility information.
2. Start Suunto Movescount App and turn on Bluetooth if it is not on already. Leave the app running in the foreground.
3. If you have not yet set up your Suunto Ambit3 Sport, do so now (see *2 Getting started*) and press [Start Stop] when asked to pair **MobileApp**.

If you are already using your Suunto Ambit3 Sport, keep [Next] pressed to enter the options menu and scroll to **PAIR** with [Light Lock]. Select **MobileApp** with [Next].

4. Enter the passkey shown on your watch display into the pairing request field on your mobile device and tap [Pair].

 **NOTE:** You can change your Suunto Ambit3 Sport general settings offline. Customizing sport modes and keeping time, date and GPS satellite data up to date require an internet connection over Wi-Fi or mobile network. Carrier data connection fees may apply.

3.18.1 Second display on phone

If you are using the Suunto Movescount App, you can use your mobile phone as a second display for your watch.

To use your mobile phone as a second display:

1. Pair your Suunto Ambit3 Sport with Suunto Movescount App if you have not done so already (see *3.18 Movescount mobile app*).
2. Go to a sport mode in your Suunto Ambit3 Sport (see *3.9 Exercising with sport modes*).
3. Open Suunto Movescount App and tap **MOVE**.
4. Select **AMBIT3** from the list and tap **NEXT**.
5. Start and stop your exercise recording as normal.

 **TIP:** Tap on each of the display areas on the phone – middle, upper left, upper right – to change what is displayed.

3.18.2 Syncing with mobile app

If you have paired your Suunto Ambit3 Sport with Suunto Movescount App, changes in settings, sport modes, and new moves are automatically synced default when the Bluetooth connection is

active. The Bluetooth icon on your Suunto Ambit3 Sport flashes when data is being synced.

This default setting can be changed from the options menu.

To turn off automatic syncing:

1. Keep [Next] pressed to enter the options menu.
2. Scroll to **CONNECTIVITY** with [Light Lock] and select with [Next].
3. Press Next again to enter the **MobileApp sync** setting.
4. Toggle off with [Light Lock] and keep [Next] pressed to exit.

When automatic syncing is off, you need to manually start syncing to transfer settings or new moves to the app.

To manually sync with mobile app:

1. Ensure Suunto Movescount App is running and Bluetooth is on.
2. Press [Start Stop] to enter the start menu.
3. Scroll to **MOBILEAPP** with [Light Lock] and select with [Next].
4. Press Next to **Sync now**.

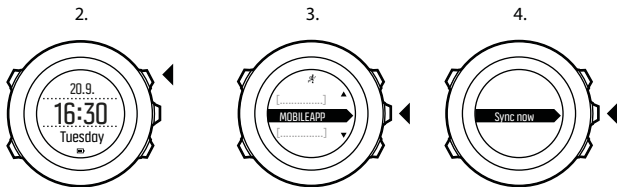

If your mobile device has an active data connection and your app is connected to your Movescount account, settings and moves are

synced with your account. If there is no data connection, syncing is delayed until a connection is available.

Unsynced moves recorded with your Suunto Ambit3 Sport are listed in the app, but you cannot view the move details until they are synced with your Movescount account. Moves that you record with the app are immediately viewable.

 **NOTE:** *Carrier data connection fees may apply when syncing between Suunto Movescount App and your Movescount account.*

3.19 Multisport training

You can use Suunto Ambit3 Sport for multisport training, easily switching between different sport modes (see *3.27 Sport modes*) while exercising and viewing sport-specific data during your exercise and in the log summary.

You can change the sport manually during the exercise, or create a multisport mode to change sports in a specific order such as for a triathlon.

3.19.1 Switching sport modes manually

Suunto Ambit3 Sport allows you to switch to another sport mode during exercise without having to stop recording. All the sport modes you have used during the exercise are included in the log.

To switch the sport mode manually during exercise:

1. While you are recording your exercise, keep [Back Lap] pressed to access the sport modes.

2. Scroll the list of sport mode options with [Start Stop] or [Light Lock].
3. Select a suitable sport mode with [Next]. Suunto Ambit3 Sport continues recording the log and the data for the selected sport mode.

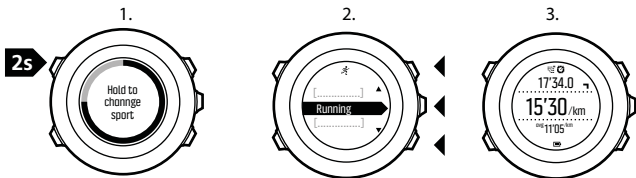

 **NOTE:** Suunto Ambit3 Sport makes a lap each time you switch to another sport mode.

 **NOTE:** The log recording is not paused when you switch to another sport mode. You can pause the recording manually by pressing [Start Stop].

3.19.2 Using a multisport mode

You can create your own multisport mode or use an existing default sport mode like **Triathlon**. The multisport mode can comprise a number of different sport modes in a specific order. Each sport can also have its own interval timer.

To use a multisport mode:

1. Press [Start Stop] to start recording the log.
2. Keep [Back Lap] pressed to change to the next sport while exercising.

3.20 Navigating with GPS

Suunto Ambit3 Sport uses the Global Positioning System (GPS) to determine your current position. GPS incorporates a set of satellites that orbit the Earth at an altitude of 20,000 km at the speed of 4 km/s.

The built-in GPS receiver in Suunto Ambit3 Sport is optimized for wrist use and receives data from a very wide angle.

3.20.1 Getting GPS signal

Suunto Ambit3 Sport activates GPS automatically when you select a sport mode with the GPS functionality, determine your location, or start navigating.

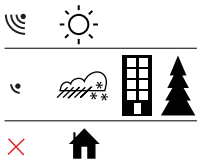

 **NOTE:** When you activate GPS for the first time, or have not used it for a long time, it might take longer than usual to get a GPS fix. Subsequent GPS starts will take less time.

 **TIP:** To minimize GPS initiation time, hold the watch steady with GPS facing up and make sure you are in an open area so that the watch has a clear view of the sky.

Troubleshooting: No GPS signal

- For an optimal signal, point the GPS part of the watch upwards. The best signal can be received in an open area with a clear view of the sky.
- The GPS receiver usually works well inside tents and other thin covers. However, objects, buildings, dense vegetation or cloudy weather can reduce the GPS signal reception quality.
- GPS signal does not penetrate any solid constructions or water. Therefore do not try to activate GPS for example inside buildings, caves, or under water.

3.20.2 GPS grids and position formats

Grids are lines on a map that define the coordinate system used on the map.

Position format is the way the GPS receiver's position is displayed on the watch. All the formats relate to the same location, they only express it in a different way. You can change the position format in the watch settings under **GENERAL » Format » Position format**.

You can select the format from the following grids:

- latitude/longitude is the most commonly used grid and has three different formats:
 - **WGS84 Hd.d°**
 - **WGS84 Hd°m.m'**
 - **WGS84 Hd°m's.s**
- **UTM** (Universal Transverse Mercator) gives a two-dimensional horizontal position presentation.
- **MGRS** (Military Grid Reference System) is an extension of UTM and consists of a grid zone designator, 100,000-meter square identifier and a numerical location.

Suunto Ambit3 Sport also supports the following local grids:

- **British (BNG)**
- **Finnish (ETRS-TM35FIN)**
- **Finnish (KKJ)**
- **Irish (IG)**
- **Swedish (RT90)**
- **Swiss (CH1903)**
- **UTM NAD27 Alaska**
- **UTM NAD27 Conus**
- **UTM NAD83**
- **NZTM2000 (New Zealand)**

 **NOTE:** Some grids cannot be used in the areas north of 84°N and south of 80°S, or outside the countries that they are intended for.

3.20.3 GPS accuracy and power saving

When customizing sport modes, you can define the GPS fix interval using the GPS accuracy setting in Movescount. The shorter the interval, the better the accuracy during exercise.

By increasing the interval and lowering the accuracy, you can extend the battery life.

The GPS accuracy options are:

- Best: ~ 1 sec fix interval, highest power consumption
- Good: ~ 5 sec fix interval, moderate power consumption
- OK: ~ 60 sec fix interval, lowest power consumption
- Off: no GPS fix

3.21 Notifications

If you have paired your Suunto Ambit3 Sport with Suunto Movescount App (see *3.18 Movescount mobile app*), you can get call, message and push notifications on the watch.

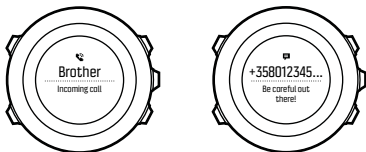

To get notifications on your watch:

1. Keep [Next] pressed to enter the options menu.
2. Press [Light Lock] to scroll to **CONNECTIVITY** and press [Next].

3. Press [Light Lock] to scroll to **Notifications**.
4. Toggle **Notifications** On/Off with [Light Lock].
5. Exit by keeping [Next] pressed.

With **Notifications** on, your Suunto Ambit3 Sport gives an audible alert and displays a notification icon in the bottom row with each new event.

To view notification on your watch:

1. Press [Start Stop] to enter the start menu.
2. Scroll to **MOBILEAPP** with [Light Lock] and select with [Next].
3. Scroll to **NOTIFICATIONS** with [Light Lock] and select with [Next].
4. Scroll through the notifications with [Start Stop] or [Light Lock].

Up to 10 notifications can be listed. Notifications remain in your watch until you clear them from your mobile device. However, notifications older than one day are hidden from view in the watch.

3.22 PODs and HR sensors

Pair your Suunto Ambit3 Sport with Bluetooth® Smart compatible bike, foot and Power PODs to receive additional information during exercise. You can pair up to five PODs at a time:

- three bike PODs, these can be speed, distance and/or cadence bike PODs, but only one can be connected at a time
- one foot POD
- one power POD

The Suunto Smart Sensor included in your Suunto Ambit3 Sport package (optional) is already paired. Pairing is required only if you

want to use a different Bluetooth Smart compatible heart rate sensor.

3.22.1 Pairing PODs and HR sensors

Pairing procedures may vary depending on the POD or heart rate (HR) sensor type. Please refer to the user guide for the device you are pairing with your Suunto Ambit3 Sport before continuing.

To pair a POD or heart rate sensor:

1. Activate the POD or heart rate sensor.

If you are pairing a Suunto Smart Sensor, see *3.9.2 Putting on Suunto Smart Sensor*.

2. Keep [Next] pressed to enter the options menu.
3. Scroll to **PAIR** with [Light Lock] and select with [Next].
4. Scroll the options with [Start Stop] and [Light Lock] and press [Next] to select a POD or heart rate sensor to pair.
5. Hold your Suunto Ambit3 Sport close to the device you are pairing and wait for Suunto Ambit3 Sport to notify that pairing was successful.

If the pairing fails, press [Start Stop] to retry, or [Light Lock] to return to the pairing setting.

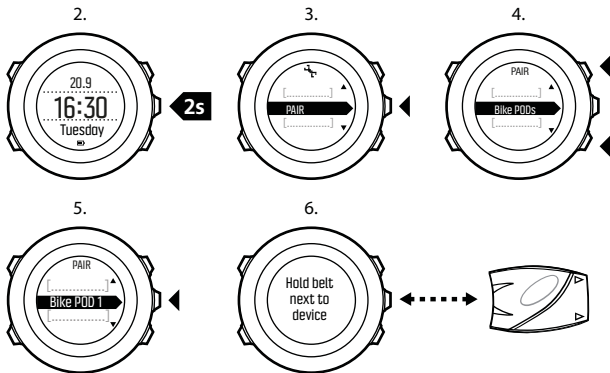

If you pair a power POD, you may need to define additional parameters in your Suunto Ambit3 Sport. These include, but are not limited to:

- **Left crank or Right crank**
- **Left pedal or Right pedal**
- **Rear dropout**
- **Chainstay**
- **Rear wheel or Rear hub**

3.22.2 Using foot POD

When using a foot POD, the POD is auto calibrated by GPS at short intervals during exercise. However, the foot POD always remains the source of speed and distance when it is paired and active for the given sport mode.

Foot POD auto calibration is on by default. It can be turned off in the sport mode options menu under **ACTIVATE**, if the foot POD is paired and is used for the selected sport mode.

For more accurate speed and distance measurements, you can manually calibrate the foot POD. Perform the calibration on an accurately measured distance, for instance, on a 400 meter running track.

To calibrate foot POD with Suunto Ambit3 Sport:

1. Attach foot POD to your shoe. For more information, see user guide for the foot POD you are using.
2. Choose a sport mode (for example **Running**) in the start menu.
3. Start running at your usual pace. When you cross the starting line, press [Start Stop] to start the recording.
4. Run a distance of 800–1000 meters (about 0.500–0.700 miles) at your usual pace (for example two laps on a 400 meter track).
5. Press [Start Stop] when you reach the finish line to pause the recording.
6. Press [Back Lap] to stop recording. After stopping the exercise, save the log by pressing [Start Stop]. If you do not want to save the log, press [Light Lock].

Scroll with [Next] through summary views, until you reach the distance summary. Adjust the distance shown on the display to the actual distance you ran with [Start Stop] and [Light Lock]. Confirm with [Next].

7. Confirm the POD calibration by pressing [Start Stop]. Your foot POD has now been calibrated.

 **NOTE:** *If the foot POD connection was unstable during the calibration exercise, you might not be able to adjust the distance in the distance summary. Make sure that foot POD is attached properly according to instructions and try again.*

If you are running without a foot POD, you can still get running cadence from the your wrist. Running cadence measured from wrist is used together with FusedSpeed (see *3.12 FusedSpeed*) and is always on for specific sport modes including running, trail running, treadmill, orienteering, and track and field.

If a foot POD is found at start of an exercise, running cadence measured from wrist is overwritten by foot POD cadence.

3.22.3 Calibrating power PODs and slope

Suunto Ambit3 Sport automatically calibrates your power POD when it finds the POD. You can also calibrate the power POD manually at any time during an exercise.

To manually calibrate a power POD:

1. While you are in a sport mode, keep [Next] pressed to access the options menu.

2. Stop pedaling and lift your feet off the pedals.
3. Scroll to **CALIBRATE POWER POD** with [Light Lock] and select with [Next].

Suunto Ambit3 Sport starts calibrating the POD and indicates if the calibration succeeded or failed. The bottom row of the display shows the current frequency used with the power POD. The previous frequency is shown in parentheses.

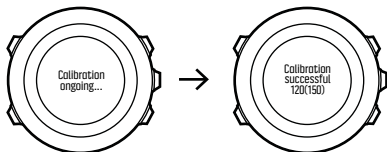

If your power POD has an auto zero feature, you can turn this on/off through your Suunto Ambit3 Sport.

To set auto zero on/off:

1. After the calibration is completed, press [Start Stop].
2. Set auto zero **On/Off** with [Light Lock] and accept with [Next].
3. Wait until the setting is completed.
4. Repeat procedure if setting fails or power POD is lost.

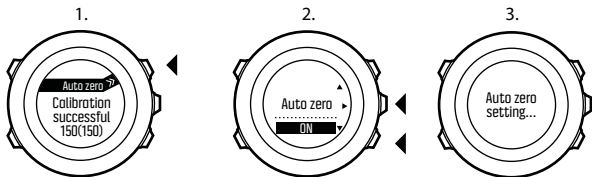

You can calibrate the slope for power PODs that use Crank Torque Frequency (CTF).

To calibrate the slope:

1. After the power POD calibration is complete, press [Start Stop].
2. Set the correct value according to your power POD manual with [Light Lock] and accept with [Next].
3. Wait until the setting is completed.
4. Repeat procedure if setting fails or power POD is lost.

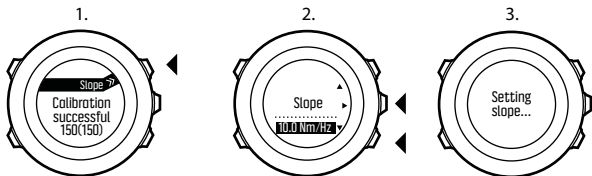

3.23 Points of interest

Suunto Ambit3 Sport includes GPS navigation which allows you to navigate to a pre-defined destination stored as a point of interest (POI).

 **NOTE:** *You can also navigate when you are recording an exercise (see 3.9.7 Navigating during exercise).*

To navigate to a POI:

1. Press [Start Stop] to enter the start menu.
2. Scroll to **NAVIGATION** using [Start Stop] and enter with [Next].
3. Scroll to **POIs (Points of interest)** using [Light Lock] and select with [Next].

The watch displays the number of saved POIs and free space available for new POIs.

4. Scroll to the POI you wish to navigate to with [Start Stop] or [Light Lock] and select with [Next].
5. Press [Next] to select **Navigate**.

If you are using the compass for the first time, you need to calibrate it (see 3.6.1 *Calibrating compass*). After activating the compass, the watch starts searching for a GPS signal and displays **GPS found** after acquiring the signal.

6. Start navigating to the POI. The watch displays the following information:
 - indicator showing the direction to your target (see further explanation below)

- your distance from the target
7. The watch informs you that you have arrived at your target.

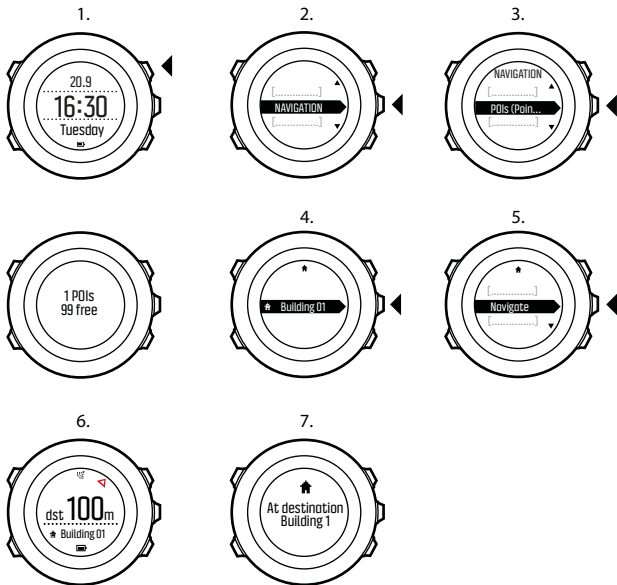

When stationary or moving slowly (<4 km/h), the watch shows you the direction to the POI (or waypoint if navigating a route) based on the compass bearing.



While moving (>4 km/h), the watch shows you the direction to the POI (or waypoint if navigating a route) based on GPS.

The direction to your target, or bearing, is shown with the empty triangle. Your direction of travel, or heading, is indicated by the solid lines at the top of the display. Aligning these two ensures you are moving in the correct direction.

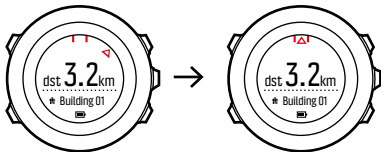

3.23.1 Checking your location

Suunto Ambit3 Sport allows you to check the coordinates of your current location using GPS.

To check your location:

1. Press [Start Stop] to enter the start menu.
2. Scroll to **NAVIGATION** using [Start Stop] and enter with [Next].
3. Press [Next] to select **Location**.
4. Press [Next] to select **Current**.
5. The watch starts searching for a GPS signal and displays **GPS found** after acquiring the signal. After that your current coordinates are shown on the display.

 ***TIP:** You can also check your location while you are recording an exercise by keeping [Next] pressed to access the options menu.*

3.23.2 Adding your location as a POI

Suunto Ambit3 Sport allows you to save your current location or define a location as a POI. You can navigate to a saved POI anytime, for example, during your exercise.

You can store up to 100 POIs in the watch. Note that also routes take up this quota. For example, if you have a route with 60 waypoints, you can additionally store 40 POIs in the watch.

You can select a POI type (icon) and POI name from a pre-defined list, or freely name the POIs in Movescount.

To save a location as a POI:

1. Press [Start Stop] to enter the start menu.
2. Scroll to **NAVIGATION** using [Start Stop] and enter with [Next].
3. Press [Next] to select **Location**.

4. Select **CURRENT** or **DEFINE** to manually change longitude and latitude values.
5. Press [Start Stop] to save the location.
6. Select a suitable POI type for the location. Scroll through the POI types with [Start Stop] or [Light Lock]. Select a POI type with [Next].
7. Select a suitable name for the location. Scroll through the name options with [Start Stop] or [Light Lock]. Select a name with [Next].
8. Press [Start Stop] to save the POI.

 **TIP:** You can create POIs in Movescount by selecting a location on a map or inserting the coordinates. POIs in your Suunto Ambit3 Sport and in Movescount are always synchronized when you connect the watch to Movescount.

3.23.3 Deleting a POI

You can delete a POI directly in the watch or through Movescount. However, when you delete a POI in Movescount and synchronize your Suunto Ambit3 Sport, the POI is deleted from the watch but only disabled in Movescount.

To delete a POI:

1. Press [Start Stop] to enter the start menu.
2. Scroll to **NAVIGATION** using [Start Stop] and enter with [Next].
3. Scroll to **POIs (Points of interest)** using [Light Lock] and select with [Next].

The watch displays the number of saved POIs and free space available for new POIs.

4. Scroll to the POI you wish to delete with [Start Stop] or [Light Lock] and select with [Next].
5. Scroll to **Delete** with [Start Stop]. Select with [Next].
6. Press [Start Stop] to confirm.

3.24 Routes

You can create a route in Movescount, or import a route created with another watch from your computer to Movescount. You can also record a route with your Suunto Ambit3 Sport and upload it to Movescount (see *3.9.5 Recording tracks*).

To add a route:

1. Go to www.movescount.com and log in.
2. Under **PLAN & CREATE**, browse to **ROUTES** to search and add existing routes or browse to **ROUTE PLANNER** to create your own route.
3. Sync your Suunto Ambit3 Sport with Movescount using Suunto Movescount App (manually start sync, see *3.18.2 Syncing with mobile app*) or by using Moveslink and the supplied USB cable.

Routes are also deleted through Movescount.

To delete a route:

1. Go to www.movescount.com and log in.
2. Under **PLAN & CREATE**, browse to **ROUTE PLANNER**.
3. Under **MY ROUTES**, click on the route you want to delete and click **DELETE**.

4. Sync your Suunto Ambit3 Sport with Movescount using Suunto Movescount App (manually start sync, see *3.18.2 Syncing with mobile app*) or by using Moveslink and the supplied USB cable.

3.24.1 Navigating a route

You can navigate a route you have downloaded to your Suunto Ambit3 Sport from Movescount (see *3.24 Routes*) or recorded from an exercise (see *3.9.5 Recording tracks*).

 **TIP:** You can also navigate as a sport mode (see *3.9.7 Navigating during exercise*).

To navigate a route:

1. Press [Start Stop] to enter the start menu.
2. Scroll to **NAVIGATION** with [Start Stop] and enter with [Next].
3. Scroll to **Routes** with [Start Stop] and enter with [Next].
The watch displays the number of saved routes and after that a list of all your routes.
4. Scroll to the route you want to navigate with [Start Stop] or [Light Lock]. Select with [Next].
5. The watch displays all the waypoints on the selected route. Scroll to the waypoint you want to use as the starting point with [Start Stop] or [Light Lock]. Accept with [Next].
6. Press [Next] to select **Navigate**.
7. If you selected a waypoint in the middle of the route, Suunto Ambit3 Sport prompts you to select the direction of the

navigation. Press [Start Stop] to select **Forwards** or [Light Lock] to select **Backwards**.

If you selected the first waypoint as the starting point, Suunto Ambit3 Sport navigates the route forward (from the first to the last waypoint). If you selected the last waypoint as the starting point, Suunto Ambit3 Sport navigates the route backwards (from the last to the first waypoint).

8. If you are using the compass for the first time, you need to calibrate it (see *3.6.1 Calibrating compass*). After activating the compass, the watch starts searching for a GPS signal and displays **GPS found** after acquiring the signal.
9. Start navigating to the first waypoint on the route. The watch informs you when you are approaching the waypoint and automatically starts navigating to the next waypoint on the route.
10. Before the last waypoint on the route the watch informs you that you have arrived at your destination.

1.



2.

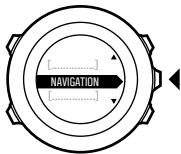

3.

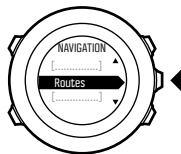

4.

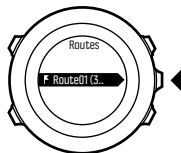

5.



6.

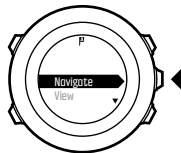

7.

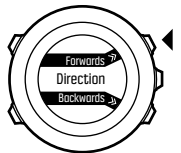

8.



9.

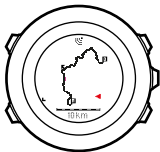

10.

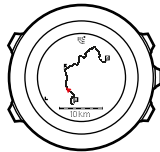
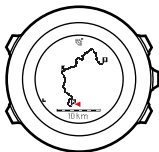

...

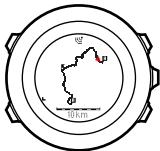

To skip a waypoint on a route:

1. While you are navigating a route, keep [Next] pressed to access the options menu.

2. Press [Next] to select **NAVIGATION**.
3. Scroll to **Skip waypoint** with [Start Stop] and select with [Next].
The watch skips the waypoint and starts navigating directly to the next waypoint on the route.

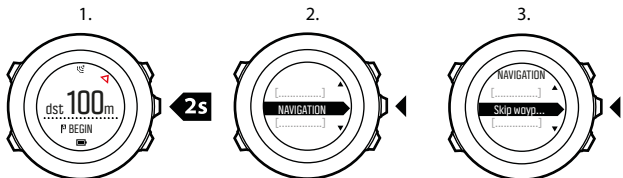

3.24.2 During navigation

During navigation, press [View] to scroll the following views:

1. the full track view showing the whole route
2. zoomed-in view of the route. By default, the zoomed-in view is scaled to a 200 m (0.125 mi) scale, or larger if you are far away from the route. You can change the map orientation in the watch settings under **GENERAL » Map**.
3. waypoint navigation view

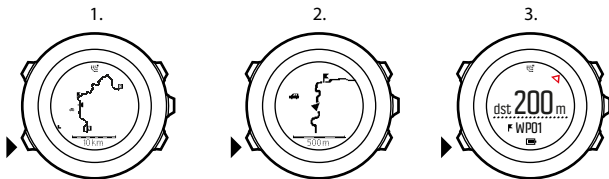

Full track view

The full track view shows you the following information:

- (1) arrow indicating your location and pointing to the direction of your heading.
- (2) the next waypoint on the route
- (3) the first and last waypoint on the route
- (4) The closest POI is shown as an icon.
- (5) scale on which the full track view is shown

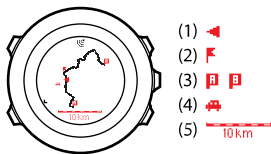

 **NOTE:** In the full track view the north is always upwards.

Waypoint navigation view

The waypoint navigation view shows you the following information:

- (1) arrow pointing to the direction of the next waypoint
- (2) your distance to the next waypoint
- (3) the next waypoint you are headed towards



3.25 Service menu

To access the service menu, keep [Back Lap] and [Start Stop] pressed simultaneously until the watch enters the service menu.





The service menu includes the following items:

- **INFO:**
 - **BLE:** shows the current Bluetooth Smart version.

- **Version:** shows the current software and hardware version.
- **TEST:**
 - **LCD test:** allows you to test that the LCD works properly.
- **ACTION:**
 - **Power off:** allows you to put the watch into deep sleep.
 - **GPS reset:** allows you to reset GPS.

 **NOTE:** *POWER OFF* is a low power state. Connect the USB cable (with power source) to wake up the watch. The initial setup wizard starts. All settings except time and date are maintained. Just confirm them through the startup wizard.

 **NOTE:** The watch switches to power saving mode when it is static for 10 minutes. The watch re-activates when moved.

 **NOTE:** Service menu content is subject to change without notice during updates.

Resetting GPS

In case the GPS unit cannot find a signal, you can reset GPS data in the service menu.

To reset GPS:

1. In the service menu, scroll to **ACTION** with [Light Lock] and enter with [Next].
2. Press [Light Lock] to scroll to **GPS reset** and enter with [Next].

3. Press [Start Stop] to confirm GPS reset, or press [Light Lock] to cancel.

 **NOTE:** *Resetting GPS resets GPS data, compass calibration values and recovery time. Saved logs are not removed.*

3.26 Shortcuts

By default, when you keep [View] pressed in **TIME** mode, you toggle the display between light and dark. This shortcut can be changed to a different menu item.

To define a shortcut:

1. Keep [Next] pressed to enter the options menu or press [Start Stop] to enter the start menu.
2. Browse to the menu item to which you want to create a shortcut.
3. Keep [View] pressed to create the shortcut.

 **NOTE:** *Shortcuts cannot be created to all possible menu items, such as individual logs.*

In other modes, keeping [View] pressed accesses predefined shortcuts. For example, when the compass is active, you can access the compass settings by keeping [View] pressed.

3.27 Sport modes

Sport modes are your way to record exercises and other activities with your Suunto Ambit3 Sport. For any activity, you can select a sport mode from the set of predefined sport modes that came with your watch. If you cannot find a suitable sport mode, create your own custom sport modes through Movescount and Suunto Movescount App.

Different information is shown on the displays during exercise depending on the sport mode. The selected sport mode also affects exercise settings, such as heart rate limits and autolap distance.

In Movescount you can create custom sport modes, edit the predefined sport modes, delete sport modes, or simply hide them so that they are not shown in your exercise menu (see *3.9.3 Starting an exercise*).

Custom sport modes

A custom sport mode can contain 1 to 8 different sport mode displays. You can choose which data appears on each display from a comprehensive list. You can customize, for example, sports-specific heart rate limits, what PODs to search for, or the recording interval to optimize accuracy and battery duration.

Any sport mode with GPS activated can also use the **QUICK NAVIGATION** option. By default, this option is off. When you select POI or Route, you get a pop-up list of the POIs or routes you have defined in your watch at the start of your exercise.

You can transfer up to 10 different sport modes created in Movescount to your Suunto Ambit3 Sport.

3.28 Stopwatch

The stopwatch is a display that can be turned on or off from the start menu.

To activate the stopwatch:

1. Press [Start Stop] to enter the start menu.
2. Scroll to **DISPLAYS** with [Light Lock] and press [Next].
3. Scroll to **Stopwatch** with [Light Lock] and press [Next].

You can now start to use the stopwatch or press [Next] to go back to the **TIME** display. To get back to the stopwatch, press [Next] to scroll through the displays until you see the stopwatch.

To use the stopwatch:

1. In the activated stopwatch display, press [Start Stop] to start measuring time.
2. Press [Back Lap] to make a lap, or press [Start Stop] to pause the stopwatch. To view the lap times, press [Back Lap] when the stopwatch is paused.
3. Press [Start Stop] to continue.
4. To reset the time, keep [Start Stop] pressed when the stopwatch is paused.

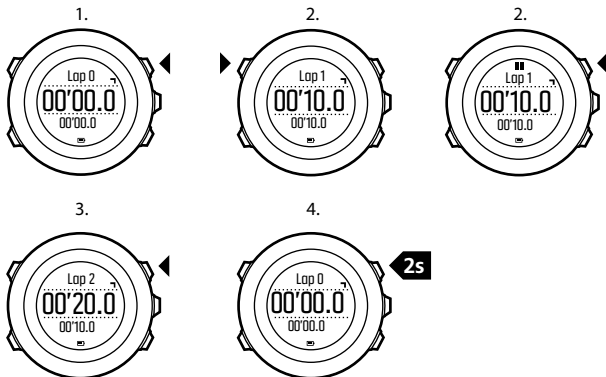

While the stopwatch is running, you can:

- press [View] to switch between the time and lap time shown on the bottom row of the display.
- switch to **TIME** mode with [Next].
- enter the options menu by keeping [Next] pressed.

If you no longer want to see the stopwatch display, deactivate the stopwatch.

To deactivate the stopwatch:

1. Press [Start Stop] to enter the start menu.
2. Scroll to **DISPLAYS** with [Light Lock] and press [Next].
3. Scroll to **End stopwatch** with [Light Lock] and press [Next].

3.29 Suunto Apps

Suunto Apps allow you to further customize your Suunto Ambit3 Sport. Visit Suunto App Zone in Movescount to find Apps, such as various timers and counters, available for your use. If you cannot find what you need, create your own App with Suunto App Designer. You can create Apps, for example, for calculating your estimated marathon result, or the slope grade of your skiing route.

To add Suunto Apps to your Suunto Ambit3 Sport:

1. Go to the **PLAN & CREATE** section in Movescount community and select **App Zone** to browse existing Suunto Apps. To create your own App, go to the **PLAN & CREATE** section of your profile and select **App Designer**.
2. Add Suunto App to a sport mode. Connect your Suunto Ambit3 Sport to your Movescount account to synchronize Suunto App to the watch. The added Suunto App will show the result of its calculation while you exercise.

 **NOTE:** You can add up to five Suunto Apps to each sport mode.

3.30 Swimming

You can use your Suunto Ambit3 Sport for recording swimming exercises in a pool or openwater.

When used together with the Suunto Smart Sensor, you can also record your heart rate while you are swimming. The heart rate data

is automatically uploaded to your Suunto Ambit3 Sport once you get out of the water.

3.30.1 Pool swimming

When using the pool swimming sport mode, Suunto Ambit3 Sport measures your swimming speed based on the pool length. Each pool length creates a lap that is shown in Movescount as part of the log.

To record pool swimming:

1. Press [Start Stop] to enter the start menu.
2. Press [Next] to enter **EXERCISE**.
3. Scroll to **Pool swimming** using [Light Lock] and select with [Next].
4. Select the pool length. You can select the pool length from the predefined values, or select the **custom** option to specify the pool length. Scroll the values with [Start Stop] and [Light Lock] and accept with [Next].
5. Press [Start Stop] to start recording your swimming.

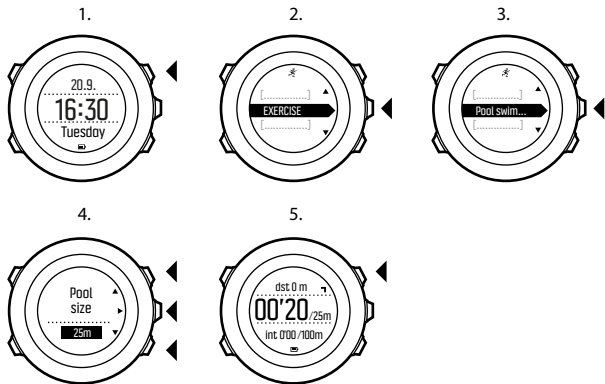

3.30.2 Swimming styles

You can teach your Suunto Ambit3 Sport to recognize your swimming style. After teaching the swimming styles, Suunto Ambit3 Sport detects them automatically when you start swimming.

To teach swimming styles:

1. While you are in the **Pool swimming** sport mode, keep [Next] pressed to enter the options menu.
2. Press [Next] to select **SWIMMING**.
3. Press [Next] to select **Teach swim style**.

4. Scroll the swimming style options with [Light Lock] and [Start Stop]. Select a suitable swimming style with [Next]. You can exit the setting and continue your exercise by selecting **END**.

The available swimming style options are:

- **FLY** (butterfly)
 - **BACK** (backstroke)
 - **BREAST** (breaststroke)
 - **FREE** (freestyle)
5. Swim the pool length in the swimming style you selected.
 6. After you have finished swimming, press [Start Stop] to save the style. If you do not want to save the style, press [Light Lock] to return to the swimming style selection.

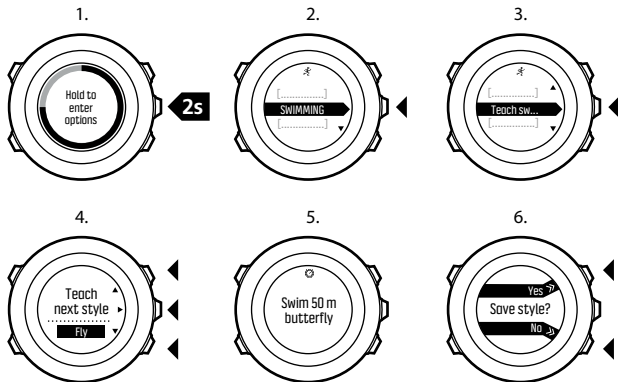

 **TIP:** You can exit teaching swimming styles any time by keeping [Next] pressed.

To reset taught swimming styles back to defaults:

1. In the **Pool swimming** mode, keep [Next] pressed to enter the options menu.
2. Press [Next] to select **SWIMMING**.
3. Scroll to **Reset taught styles** with [Start Stop] and select with [Next].

3.30.3 Swimming drills

You can do swimming drills any time during your swimming workout. If you do a drill with a swimming style that the watch does not detect as swimming (for example, using only your legs), you can add the pool length manually for each drill to keep your total distance correct.

 **NOTE:** Do not add the drill distance until you have finished your drill.

To do a drill:

1. While you are recording your pool swimming, keep [Next] pressed to access the options menu.
2. Press [Next] to enter **SWIMMING**.
3. Press [Next] to select **Drill** and start swimming your drill.
4. After you have finished your drill, press [View] to adjust the total distance, if necessary.
5. To end the drill, go back to **SWIMMING** in the options menu and select **End drill**.

3.30.4 Openwater swimming

When using the openwater swimming mode, Suunto Ambit3 Sport measures your swimming speed using GPS and shows you real-time data during the swim.

To record an outdoor swimming log:

1. Press [Start Stop] to enter the start menu.
2. Press [Next] to enter **EXERCISE**.

3. Scroll to **Openwater swim** with [Light Lock] and select with [Next].
4. Wait for the watch to notify that a GPS signal has been found.
5. Press [Start Stop] to start recording your swimming log.

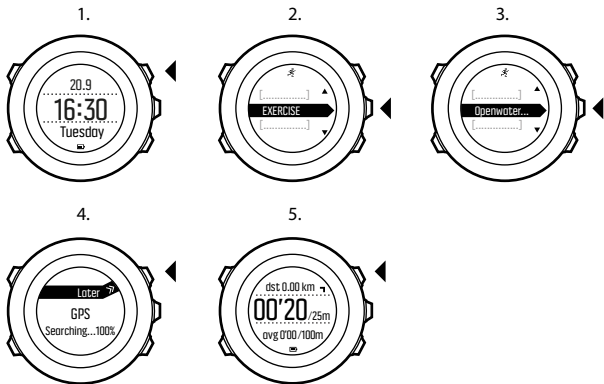

 **TIP:** Press [Back Lap] to add laps manually during the swim.

3.31 Time

The time display on your Suunto Ambit3 Sport shows the following information:

- top row: date
- middle row: time
- bottom row: change with [View] to show additional information such as weekday, dual time, and battery level.



To access the time settings:

1. Keep [Next] pressed to enter the options menu.
2. Press [Next] to enter **GENERAL**.
3. Scroll to **Time/date** using [Start Stop] and enter with [Next].

Under the **Time/date** menu you can set the following:

- Time
- Date
- GPS timekeeping
- Dual time
- Alarm

To change time settings:

1. In the **Time/date** menu, scroll to the desired setting with [Start Stop] or [Light Lock] and select the setting with [Next].
2. Change the values with [Start Stop] and [Light Lock] and save with [Next].

3. Go back to the previous menu with [Back Lap], or keep [Next] pressed to exit.

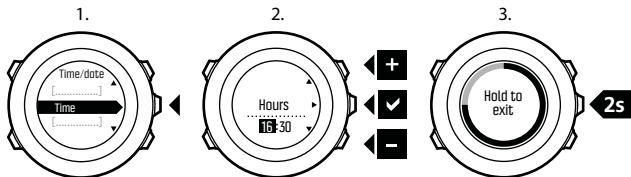

3.31.1 Alarm clock

You can use your Suunto Ambit3 Sport as an alarm clock.

To access the alarm clock and set the alarm:

1. In the options menu, go to **GENERAL**, then to **Time/date** and **Alarm**.
2. Set the alarm on or off with [Start Stop] or [Light Lock]. Accept with [Next].
3. Set the hours and minutes with [Start Stop] and [Light Lock]. Accept with [Next].
4. Go back to the settings with [Back Lap], or keep [Next] pressed to exit the options menu.

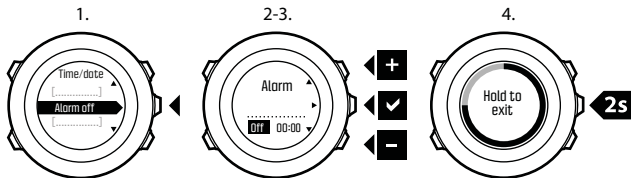

When the alarm is switched on, the alarm symbol is shown on most of the displays.

When the alarm sounds, you can:

- Select **Snooze** by pressing [Light Lock]. The alarm stops and restarts every five minutes until you stop it. You can snooze up to 12 times for a total of one hour.
- Select **Stop** by pressing [Start Stop]. The alarm stops and restarts the same time the following day, unless you switch the alarm off in the settings.

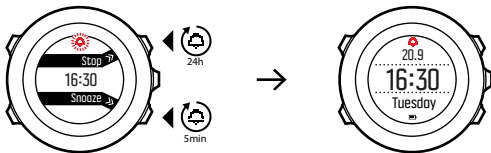

 **NOTE:** When snoozing, the alarm icon blinks in the **TIME** display.

3.31.2 Time syncing

Your Suunto Ambit3 Sport time can be updated through your mobile phone, computer (Moveslink) or GPS time. If you have paired your watch with the Suunto Movescount App, time and time zone are automatically synced with your mobile phone.

When you connect your watch to the computer with the USB cable, Moveslink by default updates your watch time and date according to the computer clock. This feature can be turned off in the Moveslink settings.

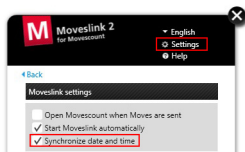

GPS timekeeping

GPS timekeeping corrects the offset between your Suunto Ambit3 Sport and the GPS time. GPS timekeeping corrects the time automatically once a day, or after you have adjusted the time manually. Also the dual time is corrected.

 **NOTE:** *GPS timekeeping corrects the minutes and seconds, but not the hours.*

 **NOTE:** *GPS timekeeping corrects the time accurately, if it is less than 7.5 minutes wrong. If the time is wrong more than that, GPS timekeeping corrects it to the closest 15 minutes.*

GPS timekeeping is activated by default. To deactivate it:

1. In the options menu, go to **GENERAL**, then to **Time/date** and **GPS timekeeping**.
2. Set the GPS timekeeping on or off with [Start Stop] and [Light Lock]. Accept with [Next].
3. Go back to the settings with [Back Lap], or keep [Next] pressed to exit.

3.32 Track back

With **Track back**, you can retrace your route at any point during an exercise. Suunto Ambit3 Sport creates temporary waypoints to guide you back to your starting point.

To track back during exercise:

1. While you are in a sport mode that uses GPS, keep [Next] pressed to access the options menu.
2. Press [Next] to select **NAVIGATION**.
3. Scroll to **Track back** with [Start Stop] and select with [Next].

You can now start navigating your way back the same way as during route navigation. For more information about route navigation, see *3.24.1 Navigating a route*.

Track back can also be used from the logbook with exercises that include GPS data. Follow the same procedure as in

3.24.1 Navigating a route. Scroll to **Logbook** instead of **Routes**, and select a log to start navigating.

3.33 Training programs

You can plan individual moves or use training programs and download them to your Suunto Ambit3 Sport. With planned moves, your Suunto Ambit3 Sport guides you to reach your training targets. Store up to 60 planned moves in your watch.

To use a planned move:

1. Plan individual moves under **MY MOVES** or use (or create) a training program under **PLAN & CREATE** in Movescount.com and add the program to your planned moves.
2. Resync with Movescount.com to download planned moves to your watch.
3. Follow daily guidance as well as the guidance during your planned moves to reach your targets.

To start a planned move:

1. Press [Next] to check your watch to see if you have a planned target for the day.
2. If you have multiple planned moves for the day, press [View] to see each move target.

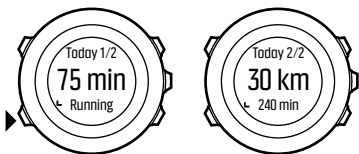

3. Press [Start Stop] to start a planned move or press [Next] again to return to **TIME** mode.

During a planned move, your Suunto Ambit3 Sport provides guidance based on speed or heart rate:

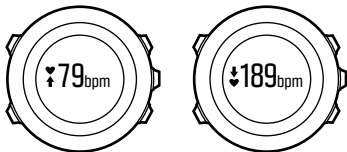

Your Suunto Ambit3 Sport also indicates when 50% and 100% of your planned target is complete.

When your target is complete or you have a rest day, future targets are indicated by weekday if the next planned move is within a week or by date if it is more than a week away:



4 CARE AND SUPPORT

4.1 Handling guidelines

Handle the unit with care – do not knock or drop it.

Under normal circumstances the watch does not require servicing. After use, rinse it with fresh water, mild soap, and carefully clean the housing with a moist soft cloth or chamois.

Use only original Suunto accessories - damage caused by non-original accessories is not covered by warranty.



***TIP:** Remember to register your Suunto Ambit3 Sport at www.suunto.com/support to get personalized support.*

4.2 Water resistance

Suunto Ambit3 Sport is water resistant to 50 meters/164 feet/5 bar. The meter value relates to an actual diving depth and is tested in the water pressure used in the course of the Suunto water resistance test. This means you can use the watch for swimming and snorkeling, but it should not be used for any form of diving.



***NOTE:** Water resistance is not equivalent to functional operating depth. The water resistance marking refers to static air/water tightness withstanding shower, bathing, swimming, poolside diving and snorkeling.*

To maintain water resistance, it is recommended to:

- never use the device for other than intended use.
- contact an authorized Suunto service, distributor or retailer for any repairs.
- keep the device clean from dirt and sand.
- never attempt to open the case yourself.
- avoid subjecting the device to rapid air and water temperature changes.
- always clean your device with fresh water if subjected to salt water.
- never knock or drop the device.

4.3 Charging the battery

The duration on a single charge depends on how Suunto Ambit3 Sport is used and in what conditions. Low temperatures, for example, reduce the duration of a single charge. In general, the capacity of rechargeable batteries decreases over time.

 **NOTE:** *In case of abnormal capacity decrease due to defective battery, Suunto warranty covers the battery replacement for one year or for at maximum 300 charging times, whichever comes first.*

The battery icon indicates the charge level of the battery. When the battery charge level is less than 10 %, the battery icon blinks for 30 seconds. When the battery charge level is less than 2 %, the battery icon blinks continuously.

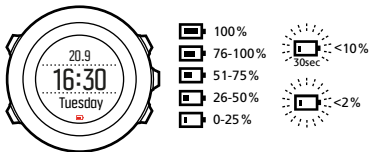

Charge the battery by attaching it to your computer with the supplied USB cable, or charge with a USB-compatible wall charger. It takes approximately 2-3 hours to fully charge an empty battery.

 **TIP:** Go to Movescount to change the GPS fix interval of your sport modes to save battery life. For more information, see 3.20.3 GPS accuracy and power saving.

4.4 Replacing Smart Sensor battery

The Suunto Smart Sensor uses a 3-Volt lithium cell (CR 2025).

To replace the battery:

1. Remove the sensor from the belt strap.
2. Open the battery cover with a coin.
3. Replace the battery.
4. Firmly close the battery cover.

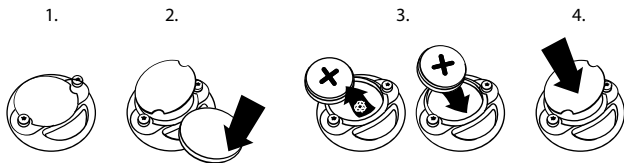

4.5 Getting support

To get additional support, visit www.suunto.com/support. There you will find a comprehensive range of support materials, including Questions and Answers and instruction videos. You can also post questions directly to Suunto or email/call Suunto support professionals.

There are also many how-to videos on the Suunto YouTube channel at www.youtube.com/user/MovesCountbySuunto.

We recommend registering your product to get the best personalized support from Suunto.

To get support from Suunto:

1. Register at www.suunto.com/support/MySuunto, or if you have already, login and add Suunto Ambit3 Sport to **My Products**.
2. Visit Suunto.com (www.suunto.com/support) to see if your question has been asked/answered already.
3. Go to **CONTACT SUUNTO** to submit a question or call us at any of the listed support numbers.

Alternatively, send us an email to support@suunto.com. Please include the product name, serial number and a detailed description of the issue.

Suunto's qualified customer support staff will help you and, if needed, troubleshoot your product during the call.

5 REFERENCE

5.1 Technical specifications

General

- operating temperature: -20° C to +60° C / -5° F to +140° F
- battery charging temperature: 0° C to +35° C / +32° F to +95° F
- storage temperature: -30° C to +60° C / -22° F to +140° F
- weight: 80 g/2.82 oz (Black, Blue, White), 86 g/3.03 oz (Sapphire)
- water resistance (watch): 50 meters/164 feet/5 bar
- water resistance (HR belt): 20 m/66 ft (ISO 2281)
- lens: mineral crystal glass (sapphire crystal in Sapphire models)
- power: rechargeable lithium-ion battery
- Battery life: ~ 8 - 25 hours depending on selected GPS accuracy

Memory

- Point of Interest (POIs): max. 250

Radio receiver

- BLUETOOTH SMART compatible
- communication frequency: 2.4 GHz
- range: ~3 m/9.8 ft

Thermometer

- display range: -20° C to +60° C / -4° F to +140° F
- resolution: 1°

Chronograph

- resolution: 1 s until 9:59:59, after that 1 min

Compass

- resolution: 1 degree/18 mils

GPS

- technology: SiRF star V
- resolution: 1 m/3 ft

5.2 Compliance

5.2.1 CE

Suunto Oy hereby declares that this Suunto Ambit3 Sport is in compliance with the essential requirements and other relevant provisions of Directive 1999/5/EC.

5.2.2 FCC compliance

This device complies with Part 15 of the FCC Rules. Operation is subject to the following two conditions:

- (1) this device may not cause harmful interference, and
- (2) this device must accept any interference received, including interference that may cause undesired operation. This product has been tested to comply with FCC standards and is intended for home or office use.

Changes or modifications not expressly approved by Suunto could void your authority to operate this device under FCC regulations.

5.2.3 IC

This device complies with Industry Canada licence-exempt RSS standard(s). Operation is subject to the following two conditions:

- (1) this device may not cause interference, and
- (2) this device must accept any interference, including interference that may cause undesired operation of the device.

5.3 Trademark

Suunto Ambit3 Sport, its logos, and other Suunto brand trademarks and made names are registered or unregistered trademarks of Suunto Oy. All rights are reserved.

5.4 Patent notice

This product is protected by pending patent applications and their corresponding national rights: EP 11008080, EU designs 001332985-0001 or 001332985-0002, US 13/833,755, US 61/649,617, US 61/649,632 (HR belt: US 13/071,624, US 13/618,481, US 13/832,049, US 13/832,598, US 13/917,668, US 13/832,736, US 13/397,872, USD 667,127). Additional patent applications have been filed.

5.5 Warranty

SUUNTO LIMITED WARRANTY

Suunto warrants that during the Warranty Period Suunto or a Suunto Authorized Service Center (hereinafter Service Center) will, at its sole discretion, remedy defects in materials or workmanship free of charge either by a) repairing, or b) replacing, or c) refunding, subject to the terms and conditions of this Limited Warranty. This Limited Warranty is only valid and enforceable in the country of purchase, unless local law stipulates otherwise.

Warranty Period

The Limited Warranty Period starts at the date of original retail purchase. The Warranty Period is two (2) years for display devices. The Warranty Period is one (1) year for accessories including but not limited to PODs and heart rate transmitters, as well as for all consumable parts.

The capacity of rechargeable batteries decreases over time. In case of abnormal capacity decrease due to defective battery, Suunto warranty covers the battery replacement for 1 year or for at maximum 300 charging times, whichever comes first.

Exclusions and Limitations

This Limited Warranty does not cover:

1. a) normal wear and tear, b) defects caused by rough handling, or c) defects or damage caused by misuse contrary to intended or recommended use;
2. user manuals or any third-party items;
3. defects or alleged defects caused by the use with any product, accessory, software and/or service not manufactured or supplied by Suunto;

This Limited Warranty is not enforceable if item:

1. has been opened beyond intended use;
2. has been repaired using unauthorized spare parts; modified or repaired by unauthorized Service Center;
3. serial number has been removed, altered or made illegible in any way, as determined at the sole discretion of Suunto;

4. has been exposed to chemicals including but not limited to mosquito repellents.

Suunto does not warrant that the operation of the Product will be uninterrupted or error free, or that the Product will work with any hardware or software provided by a third party.

Access to Suunto warranty service

You must have proof of purchase to access Suunto warranty service. For instructions how to obtain warranty service, visit www.suunto.com/support. If you have questions or doubts, a comprehensive range of support materials is available there, or you can post a question directly to Suunto Contact Center. Alternatively, you may contact Suunto Contact Center at the phone number listed on the last page of this document. Suunto's qualified customer support staff will help you and, if needed, troubleshoot your product during the call.

Limitation of Liability

To the maximum extent permitted by applicable mandatory laws, this Limited Warranty is your sole and exclusive remedy and is in lieu of all other warranties, expressed or implied. Suunto shall not be liable for special, incidental, punitive or consequential damages, including but not limited to loss of anticipated benefits, loss of data, loss of use, cost of capital, cost of any substitute equipment or facilities, claims of third parties, damage to property resulting from the purchase or use of the item or arising from breach of the warranty, breach of contract, negligence, strict tort, or any legal or equitable theory, even if Suunto knew of the likelihood of such

damages. Suunto shall not be liable for delay in rendering warranty service.

5.6 Copyright

Copyright © Suunto Oy. All rights reserved. Suunto, Suunto product names, their logos and other Suunto brand trademarks and names are registered or unregistered trademarks of Suunto Oy. This document and its contents are proprietary to Suunto Oy and are intended solely for the use of clients to obtain knowledge and information regarding the operation of Suunto products. Its contents shall not be used or distributed for any other purpose and/or otherwise communicated, disclosed or reproduced without the prior written consent of Suunto Oy. While we have taken great care to ensure that information contained in this documentation is both comprehensive and accurate, no warranty of accuracy is expressed or implied. This document content is subject to change at any time without notice. The latest version of this documentation can be downloaded at www.suunto.com.

INDEX

A

- activity monitor
 - recovery time, 14
- alarm clock, 90
 - snooze, 90
- auto calibration, 60
- autopause, 15
- autoscroll, 15

B

- backlight, 16
 - brightness, 16
 - mode, 16
- battery
 - charging, 98
- bearing
 - bearing lock, 22
- bike POD, 57
- button lock, 17
- buttons, 8

C

- calibrating
 - compass, 19
 - foot POD, 60
 - power POD, 61

- care, 97
- charging, 9
- compass, 19
 - bearing lock, 22
 - calibrating, 19
 - declination, 20
 - during exercise, 33
- countdown timer, 24
- current location, 66

D

- display
 - invert display, 25, 26
 - invert display, 25, 26
- displays, 25
 - show/hide displays, 25
- during exercise, 30
 - compass, 33
 - navigating, 32

E

- exercise
 - sport modes, 26
 - starting exercise, 29

F

- find back, 34
- firmware, 35
- foot POD, 57, 60
 - auto calibration, 60
- FusedSpeed, 35

G

- GPS, 53
 - GPS signal, 53
- GPS accuracy, 56
- GPS timekeeping, 92
- grids, 54

H

- handling, 97
- heart rate belt, 26
 - pairing, 58
- heart rate memory, 26
- heart rate sensor, 26, 57

I

- icons, 38
- interval timer, 41

L

- laps, 31
- logbook, 42

M

- memory left indicator, 45
- menu
 - shortcut, 78
- menus, 8
- Movescount, 46, 48
 - Suunto App, 82
 - Suunto App Designer, 82
 - Suunto App Zone, 82
- Moveslink, 46
- multisport, 51, 52
 - interval timer, 41
 - switching sport modes manually, 51

N

- navigating
 - during exercise, 32
 - find back, 34
 - point of interest (POI), 64
 - route, 70

P

- pairing
 - heart rate sensor, 58
 - POD, 58
- paring, 57
- Planned moves, 94
- POD, 57
 - pairing, 58

- point of interest (POI)
 - adding current location, 67
 - deleting, 68
 - navigating, 64
- position formats, 54
- power POD, 61
 - auto zero, 61
 - calibrating, 61
- Power POD, 57

R

- recording tracks, 31
- route
 - navigating, 70
- routes
 - adding a route, 69
 - deleting a route, 69

S

- second display, 49
- service menu, 76
- settings, 12
 - adjust settings, 12
 - GPS timekeeping, 92
- shortcut, 8, 78
- slope, 61
- sport mode, 29
 - during exercise, 30
 - logbook, 42

- sport modes, 79
- startup wizard, 9
- stopwatch, 80
- support, 100
- Suunto App, 82
- Suunto App Designer, 82
- Suunto App Zone, 82
- Suunto Movescount App, 48
 - second display, 49
 - syncing, 49
- Suunto Smart Sensor, 26, 28
- troubleshooting, 28
- swimming, 82
 - drills, 87
 - openwater swimming, 87
 - pool swimming, 83
 - teaching swimming styles, 84

T

- time, 88
 - alarm clock, 90
 - GPS timekeeping, 92
- timers
 - countdown timer, 24
- Track back, 93
- Training program, 94

W

- waypoints, 70



SUUNTO CUSTOMER SUPPORT

1. www.suunto.com/support
www.suunto.com/mysuunto
2. support@suunto.com
3.

AUSTRALIA	+61 1800 240 498
AUSTRIA	+43 720 883 104
CANADA	+1 800 267 7506
FINLAND	+358 9 4245 0127
FRANCE	+33 4 81 68 09 26
GERMANY	+49 89 3803 8778
ITALY	+39 02 9475 1965
JAPAN	+81 3 4520 9417
NETHERLANDS	+31 1 0713 7269
NEW ZEALAND	+64 9887 5223
RUSSIA	+7 499 918 7148
SPAIN	+34 91 11 43 175
SWEDEN	+46 8 5250 0730
SWITZERLAND	+41 44 580 9988
UK	+44 20 3608 0534
USA	+1 855 258 0900

SUUNTO

© Suunto Oy 09/2014
Suunto is a registered trademark of Suunto Oy.
All Rights reserved.