

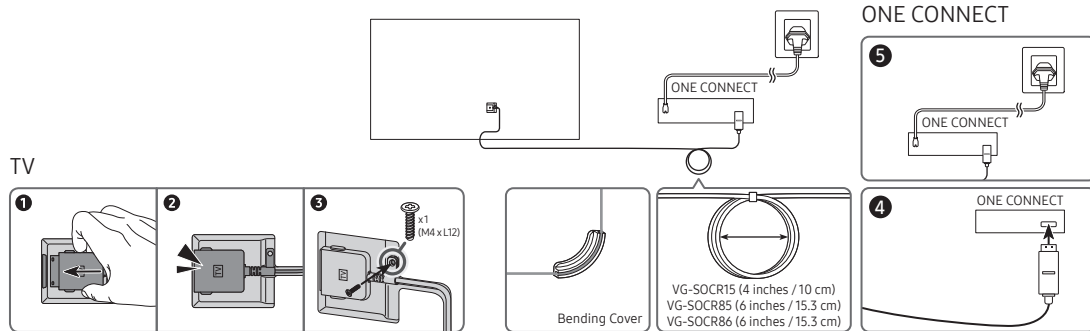

One Clear Connection Guide



Refer to the figures and connect the One Clear Connection, supplied as an accessory, to the TV and the One Connect.

1. Connect the One Clear Connection to the TV, and then connect the One Clear Connection (the  icon-shaped connector) to the One Connect.
2. Connect the One Connect AC power cord to the One Connect, and then connect the cord to a wall outlet.

CLASS1 LASER PRODUCT

- **Caution - Invisible laser radiation when open. Do not stare into beam.**
 - Do not bend or cut cables excessively.
 - Do not place heavy objects on the cable.
 - Do not disassemble the connector of the cable.
- **Caution - Use of controls or adjustments or performance of procedures other than those specified herein may result in hazardous radiation exposure.**