

Quick Start Guide

Lyra Voice
Wireless-AC2200 Tri Band Gigabit Router

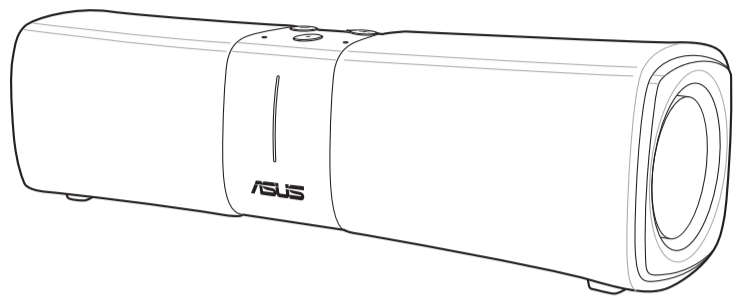

Hardware Explanations

- 1 Plug the adapter into the DCIN port, and press the power switch.
- 2 The blue LED light will start to spin for about 1~2 minutes, the light bar will then change to a white LED and start spinning after booting up.

Button Explanations

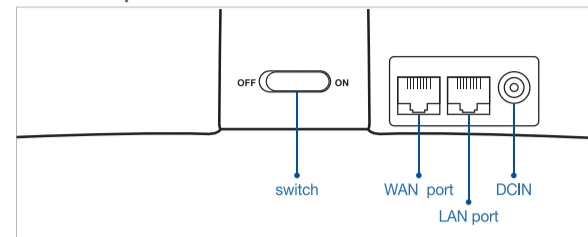

- WAN PORT
Connect your modem to this port with a network cable.
- LAN PORT
Connect your PC to this LAN port with a network cable.

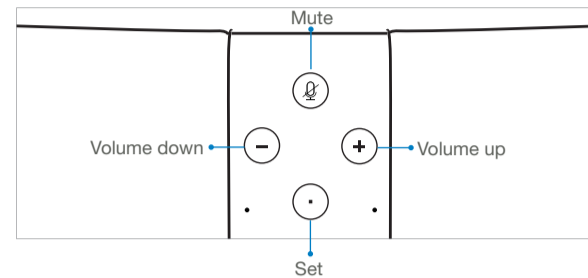

BEFORE SETTING WE SUGGEST...

01 If you are preparing to setup a stand alone router

- 1 Go to **SETUP LYRA VOICE AS ROUTER**.

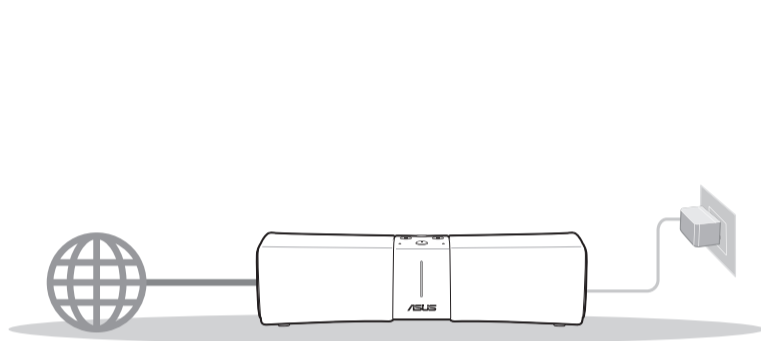

02 If you are preparing to setup an AiMesh WiFi system

- 1 To be the 1st router of AiMesh System.

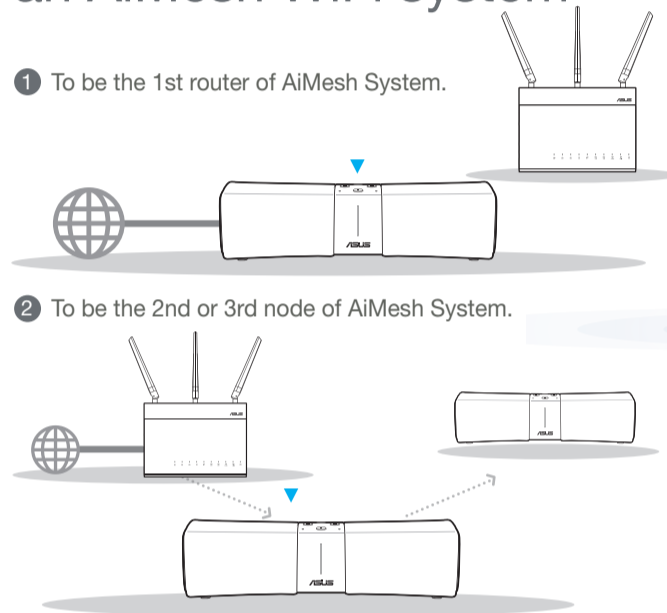

- 2 To be the 2nd or 3rd node of AiMesh System.

03 If you are preparing to setup Lyra Voice as a repeater

- 1 Go to **SETUP LYRA VOICE AS REPEATER**.

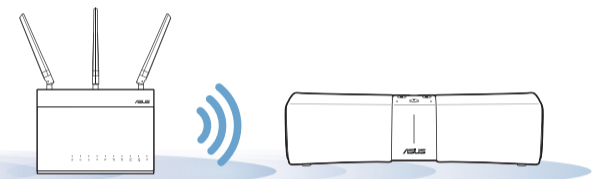

SETUP LYRA VOICE AS A ROUTER

01 Connect First Lyra Voice Node to Modem

- 1 Download the free ASUS Router app.

** Make sure your device supports BLE, Bluetooth 4.0 or above.



Search for

ASUS Router app



- 2 Unplug the power cable from your DSL modem.

** Remove the battery if it has one.

** If you are using DSL for internet, you will need a username/password from your internet service provider (ISP) to properly configure your router.

- 3 Connect your modem to any Lyra Voice node using the network cable provided via the port labeled "WAN".

- 4 Power on your modem and check its LED lights to ensure the connection is active.

- 5 Plug in the power adapter to the Lyra Voice node and wait until the LED turns to white and starts spinning to ensure that your Lyra Voice is ready for setup. The node connected to the modem directly will become your primary Lyra Voice node.

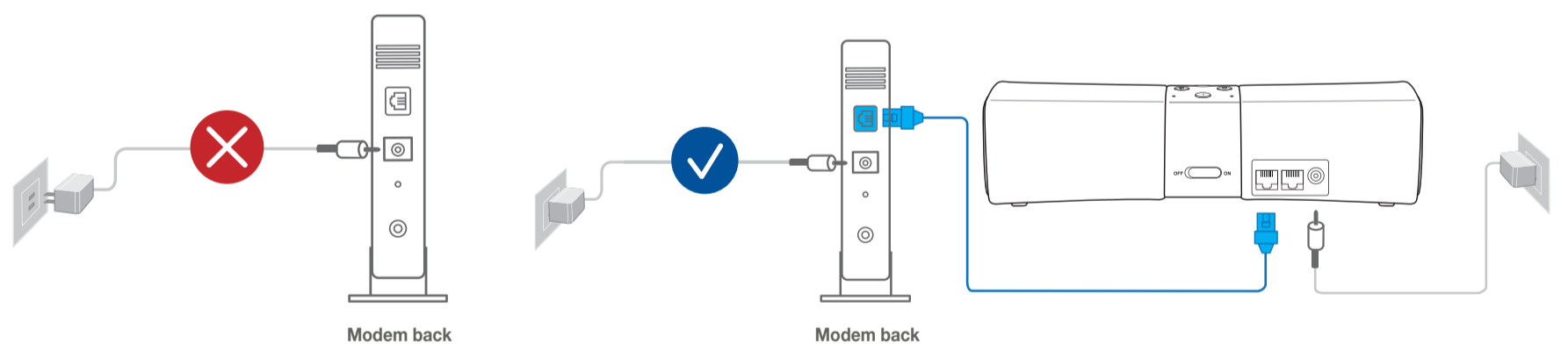

02 Setting Up Your Lyra Voice Wi-Fi System

- 1 Launch the ASUS Router app on your mobile device, and follow the instructions.

SETUP AS AN AiMesh SYSTEM

01 Set up your router

- 1 Refer to **Setup Lyra Voice as Router**

02 Adding Lyra Voice Nodes

- 1 Launch the ASUS Router app and click the "+" icon on the upper right corner. Choose **Add AiMesh node** to current network and follow the instructions to complete.

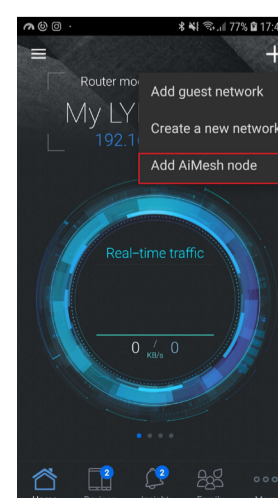

03 Amazon Account Linking

- 1 Your Amazon account can be changed or set after completing the QIS (Quick Internet Setup), remember to enable your Amazon account on each node to enjoy using Amazon Alexa.

Note: You will need to sign-in to your Amazon account to use Amazon Alexa with your Lyra Voice device. Please refer to the section **"Just Ask Alexa"** for more details on using Alexa.

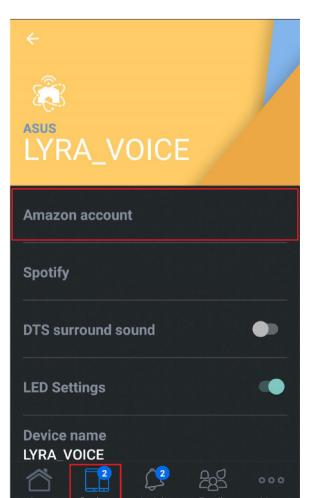

SETUP LYRA VOICE AS A REPEATER

01 Placing your Lyra Voice

1 Download the free ASUS Router app.

** Make sure your device supports BLE, Bluetooth 4.0 or above.

2 Place your Lyra Voice near your router/AP.

3 Plug in the power adapter to the Lyra Voice node and wait until the LEDs turn to white and start spinning to ensure that your Lyra Voice is ready for setup.



Search for

ASUS Router app

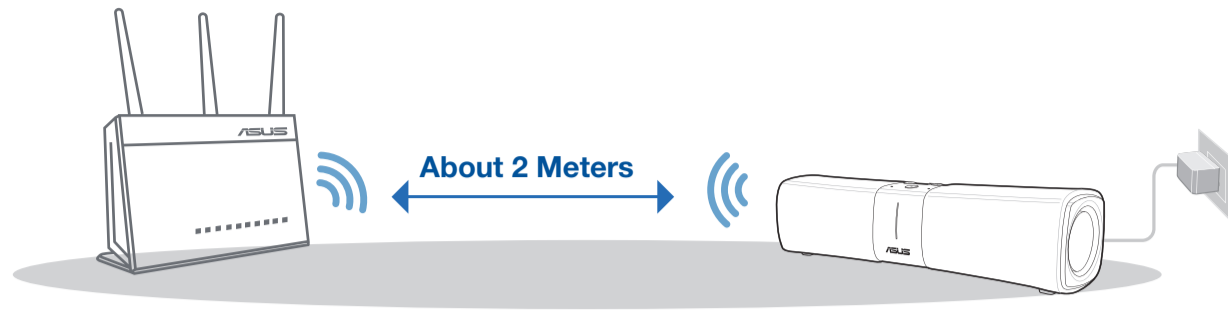

02 Setting Up Your Lyra Voice Wi-Fi System

1 Connect your mobile device to Lyra Voice SSID, then launch the ASUS Router app on your mobile device and follow the instructions to set up your Lyra Voice as the repeater.

Indications

1 Booting up

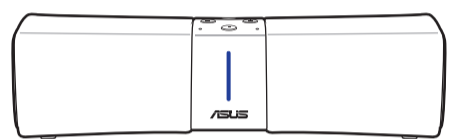

Blue LED spinning around 1 to 2 minutes

2 Ready for setup by Lyra App

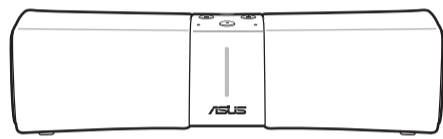

White LED spinning

3 Waiting for Amazon account linking

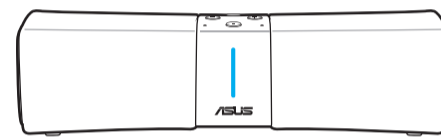

Solid Cyan LED

4 Setup complete

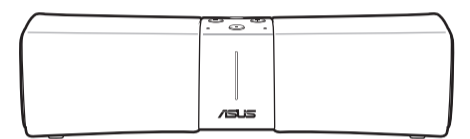

All LED turns off

Reset to factory defaults: Press and simultaneously for around 6 seconds.

Mute: Press Mute button to turn off the microphones. The Mute button will turn red. Press it again to turn the microphones back on.

Bluetooth pairing: Press and simultaneously for around 5 seconds to enter Bluetooth pairing mode or say "Alexa, pair my phone".

If you want to switch to a different mode (such as Router mode, Repeater mode, AiMesh mode) or if you encounter any setup issues, reset your system and redo the setup process.

Internet disconnected

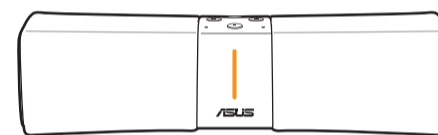

Solid orange LED, check if the ethernet cable is well connected.

Just Ask Alexa

01 Download the Amazon Alexa App

1 Download the free Amazon Alexa app from Amazon Appstore, Google Play, or Apple App Store to begin using Alexa on your device, you can use the Amazon Alexa app to set up your Alexa-enabled devices, listen to music, create shopping lists, get news updates, and much more.



Amazon Alexa

Basic commands

"Alexa, let's chat."
"Alexa, mute"
"Alexa, stop."
"Alexa, repeat."
"Alexa, set the volume to 5."
"Alexa, turn up the volume."

Purchasing

"Alexa, track my order."
"Alexa, order a Lyra Trio."
"Alexa, add garbage bags to my cart."

Skills

"Alexa, what kid's skills do you have?"
"Alexa, enable [skill name]!"
"Alexa, disable [skill name]."

Media controls

"Alexa, play some music."
"Alexa, play music by [Artist]."
"Alexa, play today's hits."
"Alexa, play Bossa Nova station on Pandora."
"Alexa, play [playlist] on Spotify."
"Alexa, play [title] on Audible."

News and weather

"Alexa, what's my Flash Briefing?"
"Alexa, what's traffic like?"
"Alexa, what's in the news?"
"Alexa, what's the weather like?"

Search

"Alexa, what is a mesh router?"
"Alexa, how many people live in America?"

"Alexa, play some music."

"Alexa, what's in the news?"

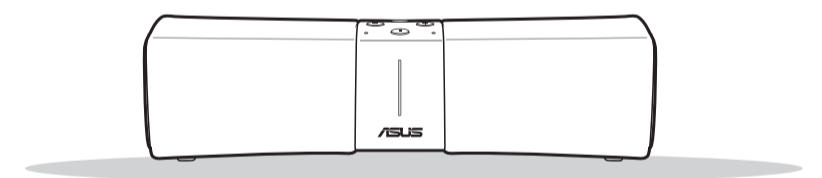

Time and date

"Alexa, set an alarm for 7 a.m."
"Alexa, wake me up at 7 in the morning."
"Alexa, set a repeating alarm for weekdays at 7 a.m."
"Alexa, set a timer for 15 minutes."
"Alexa, what time is it?"

Sports

"Alexa, when does [your favorite team] play?"
"Alexa, did [your favorite team] win?"
"Alexa, give me my Sports Update."

Smart home

"Alexa, turn on the lights."
"Alexa, dim the lights to 50 percent."
"Alexa, raise the temperature 1 degree."

Spotify Connect

Listen out loud with Spotify Connect

1. Connect your Lyra Voice to your wifi network.
2. Open up the Spotify app on your phone, tablet or laptop using the same wifi network.
3. Play a song and select Devices Available.
4. Select your Lyra Voice and start listening.



The Spotify Software is subject to third party licenses found here:
www.spotify.com/connect/third-party-licenses.