

FM/AM CLOCK RADIO

Operating Instructions

ICF-C414

DREAM MACHINE

Dream Machine is a trademark of Sony Corporation.

©2009 Sony Corporation

Printed in China



* 4 1 3 5 6 4 4 6 1 * (1)

<http://www.sony.net/>

WARNING

To reduce the risk of fire or electric shock, do not expose this apparatus to rain or moisture.

To reduce the risk of fire, do not cover the ventilation of the apparatus with newspapers, tablecloths, curtains, etc. And do not place lighted candles on the apparatus.

To reduce the risk of fire or electric shock, do not expose this apparatus to dripping or splashing, and do not place objects filled with liquids, such as vases, on the apparatus.

Do not install the appliance in a confined space, such as a bookcase or built-in cabinet.

Do not expose the batteries (battery pack or batteries installed) to excessive heat such as sunshine, fire or the like for a long time.

As the main plug is used to disconnect the unit from the mains, connect the unit to an easily accessible AC outlet. Should you notice an abnormality in the unit, disconnect the main plug from the AC outlet immediately.

CAUTION

Danger of explosion if battery is incorrectly replaced. Replace only with the same or equivalent type.

Notice for customers: the following information is only applicable to equipment sold in countries applying EU directives

The manufacturer of this product is Sony Corporation, 1-7-1 Konan, Minato-ku, Tokyo, Japan. The Authorized Representative for EMC and product safety is Sony Deutschland GmbH, Hedelfinger Strasse 61, 70327 Stuttgart, Germany. For any service or guarantee matters please refer to the addresses given in separate service or guarantee documents.

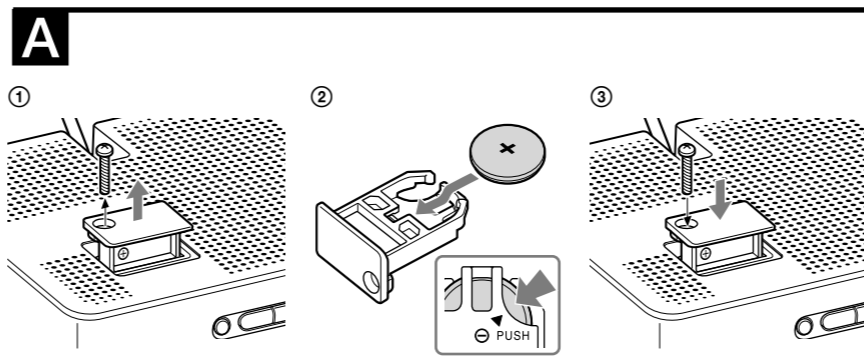

Precautions

- Operate the unit on the power source specified in “Specifications”.
- To disconnect the AC power cord (mains lead), pull it out by the plug, not the cord.
- The unit is not disconnected from the AC power source (mains) as long as it is connected to the wall outlet, even if the unit itself has been turned off.
- The nameplate and important information concerning safety are located on the bottom exterior.
- Do not leave the unit in a location near a heat source such as a radiator or airduct, or in a place subject to direct sunlight, excessive dust, mechanical vibration, or shock.
- Allow adequate air circulation to prevent internal heat build-up. Do not place the unit on a surface (a rug, a blanket, etc.) or near materials (a curtain) which might block the ventilation holes.
- Should any solid object or liquid fall into the unit, unplug the unit and have it checked by qualified personnel before operating it any further.
- To clean the casing, use a soft cloth dampened with a mild detergent solution.
- Never touch the wire of the external FM aerial during a thunderstorm. Furthermore, immediately disconnect the AC power cord from the radio.

NOTES ON LITHIUM BATTERY

- Wipe the battery with a dry cloth to assure a good contact.
- Be sure to observe the correct polarity when installing the battery.
- Do not hold the battery with metallic tweezers, otherwise a short-circuit may occur.

Disposal of Old Electrical & Electronic Equipment (Applicable in the European Union and other European countries with separate collection systems)



This symbol on the product or on its packaging indicates that this product shall not be treated as household waste. Instead it shall be handed over to the applicable collection point for the recycling of electrical and electronic equipment. By ensuring this product is disposed of correctly, you will help prevent potential negative consequences for the environment and human health, which could otherwise be caused by inappropriate waste handling of this product. The recycling of materials will help to conserve natural resources. For more detailed information about recycling of this product, please contact your local Civic Office, your household waste disposal service or the shop where you purchased the product.

Disposal of waste batteries (applicable in the European Union and other European countries with separate collection systems)



This symbol on the battery or on the packaging indicates that the battery provided with this product shall not be treated as household waste.

By ensuring these batteries are disposed of correctly, you will help prevent potentially negative consequences for the environment and human health which could otherwise be caused by inappropriate waste handling of the battery. The recycling of the materials will help to conserve natural resources.

In case of products that for safety, performance or data integrity reasons require a permanent connection with an incorporated battery, this battery should be replaced by qualified service staff only. To ensure that the battery will be treated properly, hand over the product at end-of-life to the applicable collection point for the recycling of electrical and electronic equipment. For all other batteries, please view the section on how to remove the battery from the product safely. Hand the battery over to the applicable collection point for the recycling of waste batteries.

For more detailed information about recycling of this product or battery, please contact your local Civic Office, your household waste disposal service or the shop where you purchased the product.

If you have any questions or problems concerning your unit, please consult your nearest Sony dealer.

Troubleshooting

Should any problem occur with the unit, make the following simple checks to determine whether or not servicing is required.

If the problem persists, consult your nearest Sony dealer.

The clock flashes “AM12:00”.

- A power interruption occurred and the backup battery is low. Replace the battery. Remove the old battery and install a new one.

The buzzer, radio or melody alarm does not sound at the preset alarm time.

- Check that the buzzer, radio or melody alarm is activated (the ALARM A (or B) indicator lights up).

The radio alarm is activated but does not sound at the preset alarm time.

- Check that the volume is not set to minimum.

Specifications

Time display

12-hour System

Frequency range

| Band | Frequency |
|------|-----------------|
| FM | 87.5 – 108 MHz |
| AM | 530 – 1 710 kHz |

Speaker

Approx. 6.6 cm (2 ⁵/₈ inches) dia., 8 Ω

Power output

180 mW (at 10% harmonic distortion)

Power requirements

230 V AC, 50 Hz

For power backup: 3 V DC, one CR2032 battery

Dimensions

Approx. 178.9 × 121.8 × 88.5 mm (w/h/d)
(7 ¹/₈ × 4 ⁷/₈ × 3 ¹/₂ inches) incl. projecting parts and controls

Mass

UK model:

Approx. 663 g (1 lb 7.4 oz) incl. CR2032 battery

Australian and New Zealand model:

Approx. 651 g (1 lb 7 oz) incl. CR2032 battery

Design and specifications are subject to change without notice.

About the backup battery

To keep good time, as backup power source, this unit has one CR2032 battery inside of the unit in addition to the house current. (The battery is supplied with the unit for Australian and New Zealand model.)

The battery keeps the clock and the alarm operating in the event of a power interruption.

Note for customers in the UK

The clock is preset at the factory, and its memory is powered by the preinstalled Sony CR2032 battery. If the “AM12:00” appears in the display when the unit is connected to AC outlet for the first time, the battery may be weak. In this case, consult a Sony dealer. The preinstalled CR2032 battery is considered part of the product, and is covered by the warranty.

You are required to show “Note for customers in the UK” (in this instruction) to a Sony dealer in order to validate the warranty for this product.

Knowing when to replace the battery

When the battery becomes weak, the “ ” indicator appears in the display.

In the event of a power interruption when the battery is weak, the current time and alarm will be initialized.

Replace the battery with a Sony CR2032 lithium battery. Use of another battery may present a risk of fire or explosion.

Installing and replacing the backup battery

- 1 Keep the AC plug connected to the AC outlet, remove the screw that secures the battery compartment at the rear of the unit using a screwdriver, and remove the battery compartment (See Fig. **A-①**).
- 2 Insert a new battery in the battery compartment with the **+** side facing up. To remove the battery from the battery compartment, push it out from the side marked PUSH (See Fig. **A-②**).
- 3 Insert the battery compartment back into the unit and secure it with the screw (See Fig. **A-③**).
- 4 When you are replacing the battery, press **RADIO ON** to turn the “ ” indicator off in the display.

Notes

- If you replace the battery, do not disconnect the AC plug from the AC outlet. Otherwise, the current time and alarm will be initialized.
- Be sure to observe the correct polarity when installing the battery.

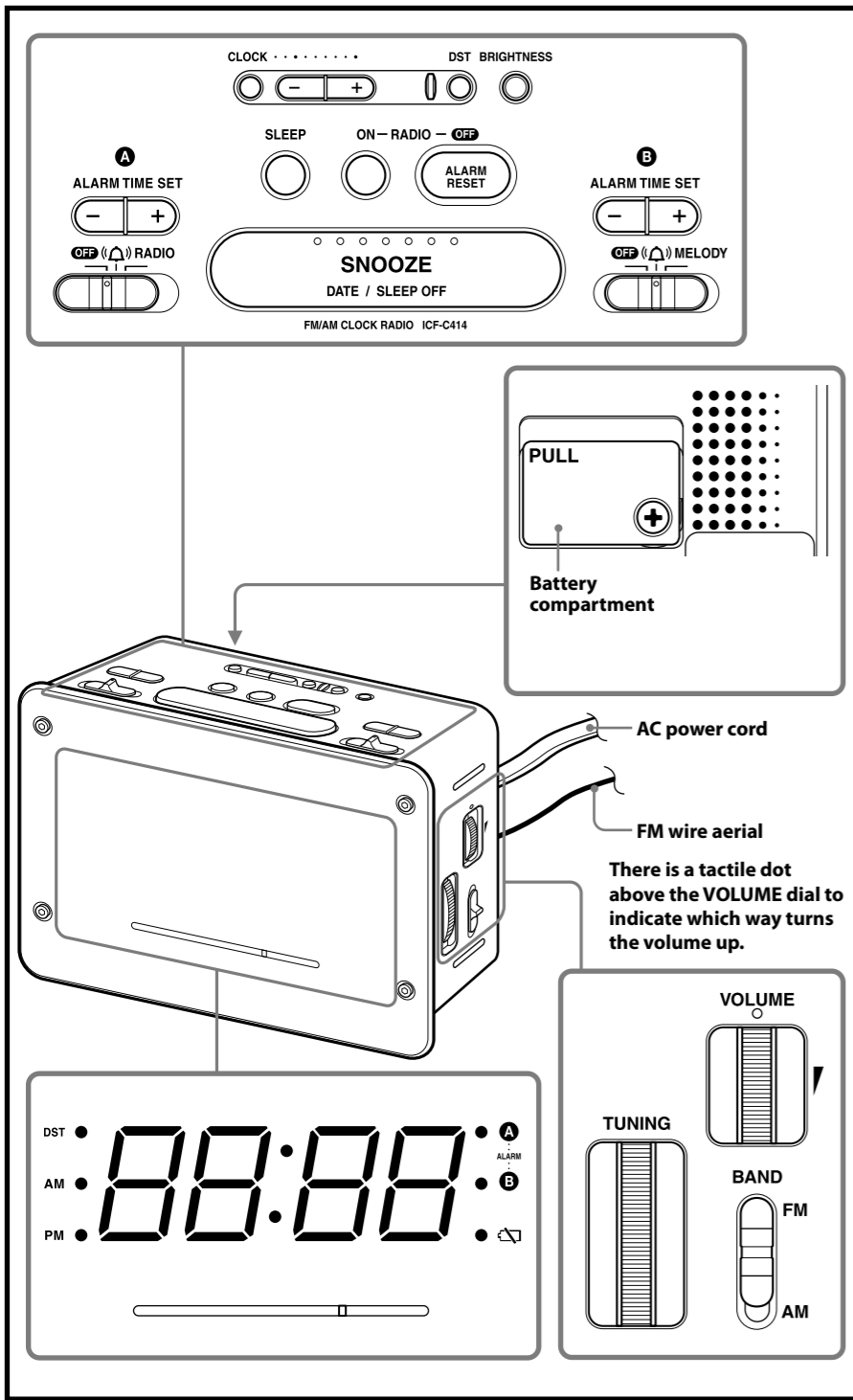

Setting the clock for the first time (UK model only)

This unit is preset to the current date and time at the factory, and is powered by the back up battery. All you need to do is just plug it in.

Plug in the unit.

First, the month and date appear, then the year, and then the current time appears in the display.

Note

During the shipment and your first use, a clock error may occur. In this case, refer to “Setting the clock and date” to set the correct time.

When daylight saving time (summer time) begins

This unit employs Automatic Daylight Saving Time/Summer Time adjustment. The DST indicator appears in the display at the beginning of the daylight saving time (summer time), and disappears at the end of it.

Automatic DST/summer time adjustment is based on GMT (Greenwich Mean Time).

- Daylight saving time (summer time) begins at: 1:00 AM on the final Sunday of March.
- Standard time begins at: 2:00 AM on the final Sunday of October.

To cancel the automatic DST/summer time adjustment and to set DST display manually

The automatic DST/summer time adjustment can be cancelled.

Press and hold **DST** for at least 3 seconds while the clock is displayed.

A beep sounds, and “Aut → OFF” appears in the display to show that the automatic DST/summer time adjustment is cancelled. The display returns to the clock.

Notes

- Daylight Saving Time depends on the law in each country/region, and your area may not use it. In such a case, cancel the automatic DST/summer time adjustment before using the set and set the time manually as necessary.
- To activate the automatic DST/summer time adjustment again, press and hold **DST** for at least 3 seconds. A beep sounds, and “Aut → On” appears in the display to show that the automatic DST/summer time adjustment is activated. The display returns to the clock.
- To change the display to the daylight saving time (summer time) manually, see “To change the display to the daylight saving time (summer time) indication.”

Setting the clock and date

Follow the procedure from step **1** for Australian and New Zealand model. To change the setting for UK model, follow the procedure from step **2**.

- 1** Plug in the unit.
The display will flash “AM12:00”.
- 2** Press **CLOCK** for at least 2 seconds.
You will hear a beep and the year will start to flash in the display.
- 3** Press **+** or **-** until the correct year appears in the display.
- 4** Press **CLOCK**.
- 5** Repeat steps **3** and **4** to set the month, day and time.
After setting the time, two short beeps sound and the clock starts from 0 seconds.

- Pressing and holding **+** or **-** changes the year, month or day rapidly.
When setting the current time, time changes rapidly by 1 minute-increments up to 10 minutes, and then by 10 minute-increments.
- While setting the clock, you must perform each step within 65 seconds, or the clock setting mode will be cancelled.

To display the year and date

Press **SNOOZE/DATE/SLEEP OFF** once for the date, and within about 3 seconds press it again for the year.

The display shows the date or year for about 3 seconds and then changes back to the current time.

If you connect the AC plug to an AC outlet while this unit is powered from the backup power source, the current date and time appears in the following order (the same as when the unit is powered on after a power interruption).
“month and date” (about 1 second) → “year” (about 1 second) → “current time”

To change the display to the daylight saving time (summer time) indication

Change the daylight saving time (summer time) adjustment setting according to the following procedures if:
– you have Australian and New Zealand model.
– you have cancelled the automatic DST/summer time adjustment.

Press **DST**.

The DST indicator appears in the display and the time indication changes to the daylight saving time (summer time).

To deactivate the daylight saving time (summer time) adjustment, press **DST** again.

Setting the brightness of the display

Three levels of brightness are available by pressing **BRIGHTNESS**.

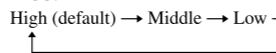

Operating the radio

- 1** Press **RADIO OFF** to turn on the radio.
- 2** Adjust the volume using **VOLUME**.
- 3** Select **BAND**.
- 4** Tune in to a station using **TUNING**.

To turn off the radio

Press **RADIO OFF/ALARM RESET**.

Improving the reception

FM:

Extend the FM wire aerial fully to increase reception sensitivity.

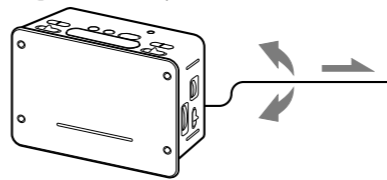

AM:

Rotate the unit horizontally for optimum reception. A ferrite bar AM aerial is built-in to the unit.

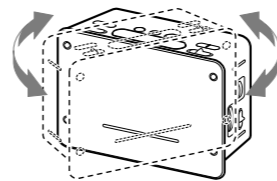

Do not operate the unit over a steel desk or metal surface, as this may lead to interference of reception.

Setting the alarm

The dual alarm function allows you to set two alarm programmes (ALARM A and ALARM B). The alarm time can be set for each programme and the alarm sound is selectable from buzzer, radio or melody.

Notes

- Before setting the alarm, make sure to set the clock (see “Setting the clock and date”).
- The factory set alarm time is “PM12:00”.
- To set the radio alarm, first tune in to a station and adjust the volume (see “Operating the radio”).

To set the alarm time

- 1** Set **ALARM A (or B)** to the desired alarm sound ((**buzzer**), **RADIO** or **MELODY**).

The alarm time appears for a few seconds, and then the ALARM A (or B) indicator lights up in the display. (It does not appear when the switch is set to **OFF**.)

When you set the alarm to **MELODY**, the alarm sounds the melody- “Spring” from “The Four Seasons” by Antonio Lucio Vivaldi.

- 2** Press **ALARM TIME SET A (or B) + or -** to set the desired time.

Each press of **ALARM TIME SET A (or B) + or -** changes the indication by 1 minute. If you press and hold **ALARM TIME SET A (or B) + or -**, the alarm time goes forward (or backward) by 1 minute up to 10 minutes, and then by 10 minutes increments. While setting the alarm time, the ALARM A (or B) indicator flashes in the display. The following example is when setting the ALARM A.

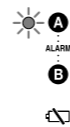

When the alarm time setting is complete, the display returns to the clock after a few seconds and the ALARM A (or B) indicator changes from flashing to fully lit.

- While **ALARM A (or B)** is set to , **RADIO** or **MELODY**, the alarm time setting can be changed by **ALARM TIME SET A (or B) + or -**. One press of **ALARM TIME SET A (or B) + or -** displays the alarm time for about 4 seconds. By pressing **ALARM TIME SET A (or B) + or -** while the alarm time appears in the display, the alarm time will be changed.
- For the buzzer alarm, the beeping of the alarm becomes more rapid after every few seconds in three progressive stages.

- The ALARM A (or B) indicator flashes in the display while:
 - The alarm time appears in the display.
 - The alarm sounds.
 - The snooze function is turned on.
- The alarm time setting cannot be changed if **ALARM A (or B)** is set to **OFF**. If you press **ALARM TIME SET A (or B) + or -**, “OFF” appears in the display for about 0.5 seconds.
- If a second alarm sounds during a first (or the snooze function is active), the second alarm takes priority.
- **CLOCK** and **DST** are unavailable while the alarm sounds or when the snooze function is turned on.
- The alarm function works as usual at the first and last day of daylight saving time (summer time). As a result, if the automatic DST/summer time adjustment is set (UK model only) and the alarm is set at a time skipped when the daylight saving time begins, the alarm is skipped; if the alarm is set at a time overlapping when daylight saving time ends, the alarm will sound twice.
- If the same alarm time is set for both ALARM A and B, the ALARM A takes priority.

To doze for a few more minutes

Press **SNOOZE/DATE/SLEEP OFF**.

The alarm sound stops but will automatically come on again after about 10 minutes. Each time you press **SNOOZE/DATE/SLEEP OFF**, the snooze time changes as follows:

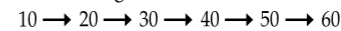

The maximum snooze time is 60 minutes.

The display shows the snooze time for about 4 seconds and returns to show the current time. When you press **SNOOZE/DATE/SLEEP OFF** after the current time appears, the snooze time starts from 10 minutes again.

To stop the Alarm

Press **RADIO OFF/ALARM RESET** to turn off the alarm.

The alarm will come on again at the same time the next day.

If **RADIO OFF/ALARM RESET** is not pressed, the alarm sounds continuously for about 60 minutes, and then it will stop automatically.

To deactivate the Alarm

Set **ALARM A (or B)** to **OFF**.

The ALARM A (or B) indicator disappears from the display.

Note on alarm in the event of a power interruption

In the event of a power interruption, the alarm functions work until the battery is empty. However, the following functions differ:

- Nothing will appear on the display.
- When the alarm sound is set to radio, it will change to buzzer automatically.
- If the power returns while the alarm sounds, the alarm sounds continuously for about 60 minutes (or until turned off).
- The alarm buzzes for about one minute, stops temporarily, and will buzz again after about five minutes if neither **SNOOZE/DATE/SLEEP OFF** or **RADIO OFF/ALARM RESET** are pressed while the alarm is buzzing.
If the alarm buzzes and stops (either automatically after 1 minute or by pressing **SNOOZE/DATE/SLEEP OFF**) five times, the alarm is automatically reset in the case of a power interruption. The alarm will buzz for 30 minutes (or until turned off) after power is resumed if the power is resumed within 60 minutes from the alarm time.
- If you press **SNOOZE/DATE/SLEEP OFF** while the alarm sounds, the snooze time is set to 10 minutes. During a power interruption, snooze time cannot be set to more than 10 minutes.
- If the indicator appears in the display, the alarm will not work in the event of a power interruption. Replace the battery if the indicator appears.

Setting the sleep timer

You can fall asleep to the radio using the built-in sleep timer that turns off the radio automatically after a preset duration.

Press **SLEEP**.

The radio turns on. You can set the sleep timer to 90, 60, 30, or 15 minutes. Each press changes the display as follows:

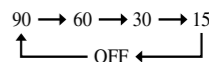

Two short beeps sound when the display returns to “90”.

The radio will play for the duration you set, then shut off.

To turn off the radio before the preset time

Press **RADIO OFF/ALARM RESET** or **SNOOZE/DATE/SLEEP OFF**.

To use both sleep timer and alarm

You can fall asleep to the radio and also be awakened by the buzzer, radio or melody alarm at the preset time.

- 1** Set the alarm. (See “Setting the alarm”.)
- 2** Set the sleep timer. (See “Setting the sleep timer”.)