



DGX STATION

DU-08255-001 _v4.5 | February 2020

User Guide



TABLE OF CONTENTS

About this Guide.....	v
Chapter 1. Introduction to the NVIDIA® DGX Station™	1
1.1. What's in the Box.....	2
1.2. DGX OS Desktop Software Summary.....	2
1.3. DGX Station Hardware Summary.....	3
Chapter 2. Setting Up the NVIDIA DGX Station.....	4
2.1. Siting the DGX Station.....	4
2.2. Removing or Replacing the Packing Inside the DGX Station.....	5
2.3. Connecting and Powering on the DGX Station.....	7
2.4. Completing the Initial Ubuntu OS Configuration.....	12
2.5. Adding Support for Additional Languages to the DGX Station.....	12
2.6. Registering Your DGX Station.....	13
2.7. Configuring the DGX Station To Use Multiple Displays.....	13
2.8. Enabling Multiple Users to Access the DGX Station Remotely.....	16
2.9. Preparing the DGX Station for Use with Docker.....	17
2.9.1. Enabling Users To Run Docker Containers.....	17
2.9.2. Preventing IP Address Conflicts Between Docker and the DGX Station.....	17
Chapter 3. Upgrading DGX OS Desktop Software on DGX Station.....	19
3.1. Upgrading Within the Same DGX OS Desktop Major Release.....	19
3.1.1. Upgrading Within the Same DGX OS Desktop Major Release from the Details Window.	20
3.1.2. Upgrading Within the Same DGX OS Desktop Major Release from the Command Line.	23
3.2. Upgrading to a New DGX OS Desktop Major Release.....	23
3.3. Opting in to DGX OS Desktop Patch Updates.....	27
3.4. Available DGX Station Software Updates.....	28
3.4.1. Updates to Docker and Software Exclusive to the DGX Station.....	28
3.4.2. Updates to the Ubuntu Software on the DGX Station.....	29
3.5. Checking for Updates to DGX Station Software.....	30
3.6. Getting Release Information for DGX Station.....	31
3.7. Updating Software on an Air-Gapped DGX Station System.....	32
3.7.1. Providing DGX Station Software Updates from a Private Repository.....	32
3.7.2. Loading a Container Image onto an Air-Gapped DGX Station System.....	33
Chapter 4. Maintaining and Servicing the NVIDIA DGX Station.....	34
4.1. Problem Resolution and Customer Care.....	34
4.2. Cleaning the Mesh Filter Under the DGX Station.....	34
4.3. Collecting Information for Troubleshooting the.....	35
4.4. Checking the Health of the.....	36
4.5. Replacing the System and Components.....	37
4.5.1. Replacing the System.....	37
4.5.2. Repacking the DGX Station for Shipment.....	38
4.5.3. Replacing a DIMM.....	41

4.5.4. Replacing the CMOS Power Cell in the DGX Station.....	45
4.6. Maintaining the DGX Station Persistent Storage.....	49
4.6.1. Changing the RAID Level of the RAID Array.....	49
4.6.2. Checking the Status of the DGX Station RAID Array.....	50
4.6.3. Checking the Status of the DGX Station SSDs.....	51
4.6.4. Replacing an SSD.....	52
4.6.5. Rebuilding the RAID Array.....	56
4.6.6. Configuring the SSDs for Data Storage as an NFS Cache.....	57
4.6.7. Sanitizing the DGX Station Persistent Storage.....	59
4.6.7.1. Running an Ubuntu Desktop LiveCD Session on the DGX Station.....	59
4.6.7.2. Sanitizing All DGX Station SSDs.....	60
4.7. Restoring the DGX Station Software Image.....	62
4.7.1. Obtaining the DGX Station Software ISO Image and Checksum File.....	63
4.7.2. Creating a Bootable Installation Medium.....	63
4.7.2.1. Creating a Bootable USB Flash Drive by Using Startup Disk Creator.....	64
4.7.2.2. Creating a Bootable USB Flash Drive by Using Akeo Rufus.....	65
4.7.3. Verifying the Bootable Installation Medium.....	66
4.7.3.1. Verifying a Bootable USB Flash Drive.....	66
4.7.3.2. Verifying a Bootable DVD-ROM.....	67
4.7.4. Installing the DGX Station Software Image from a USB Flash Drive or DVD-ROM.....	68
4.8. Updating the DGX Station System BIOS.....	69
4.9. Maintaining the GPU Liquid Cooling System.....	70
4.9.1. Monitoring GPU Temperatures.....	70
4.9.2. Checking the Level of the Liquid in the GPU Cooling System.....	71
4.9.3. Replenishing the Liquid in the GPU Cooling System.....	74
Appendix A. Safety.....	78
A.1. Intended Application Uses.....	79
A.2. General Precautions.....	79
A.3. Electrical Precautions.....	79
A.4. Communications Cable Precautions.....	80
A.5. Other Hazards.....	81
Appendix B. Connections, Controls, and Indicators.....	82
B.1. Front-Panel Connections and Controls.....	82
B.2. Rear-Panel Connections and Controls.....	82
B.3. LAN Port Indicators.....	84
B.4. Audio I/O Connections.....	85
Appendix C. Compliance.....	87
C.1. DGX Station Model Number.....	87
C.2. Argentina.....	87
C.3. Australia/New Zealand.....	87
C.4. Brazil.....	88
C.5. Canada.....	88
C.6. China.....	89

C.7. European Union.....	90
C.8. India.....	91
C.9. Israel.....	91
C.10. Japan.....	92
C.11. Russia.....	92
C.12. South Africa.....	92
C.13. South Korea.....	93
C.14. Taiwan.....	93
C.15. United States.....	94
C.16. United States/Canada.....	95
C.17. Vietnam.....	95
Appendix D. DGX Station Hardware Specifications.....	96
D.1. Environmental Conditions.....	96
D.2. Component Specifications.....	96
D.3. Mechanical Specifications.....	97
D.4. Power Specifications.....	97
Appendix E. Customer Support for the NVIDIA DGX Station.....	98

ABOUT THIS GUIDE

DGX Station User Guide explains how to install, set up, and maintain the NVIDIA® DGX Station™.

This guide is aimed at users and administrators who are familiar with the Ubuntu Desktop Linux OS, including use of the command line and the `sudo` command.



The instructions in this guide for software administration apply only to the DGX OS Desktop. They don't apply if the DGX OS Desktop software that is supplied with the DGX Station has been replaced with the DGX software for Red Hat Enterprise Linux or CentOS.

For additional information to help you use the DGX Station, see the following table.

Task	Additional Information
Use the Ubuntu Desktop Linux OS	<ul style="list-style-type: none">▶ Ubuntu 18.04 Desktop Guide (https://help.ubuntu.com/18.04/ubuntu-help/index.html)▶ Ubuntu 16.04 Desktop Guide (https://help.ubuntu.com/16.04/ubuntu-help/index.html)
Find out about the DGX OS Desktop software for the DGX Station	DGX OS Desktop Release Notes
Use the DGX Station to download and run containers for deep learning frameworks	NGC Container Registry for DGX User Guide
Use deep learning frameworks optimized for NVIDIA DGX systems	NVIDIA Deep Learning Frameworks Documentation (http://docs.nvidia.com/deeplearning/dgx/)
Use the tools and libraries in the DGX OS Desktop for development of deep learning frameworks	NVIDIA Deep Learning SDK Documentation (http://docs.nvidia.com/deeplearning/sdk/)

Chapter 1.

INTRODUCTION TO THE NVIDIA® DGX STATION™

The NVIDIA DGX Station is a fast, multi-GPU workstation for deep learning and AI analytics. You can use the DGX Station to run neural networks, and deploy deep learning models. Because the DGX Station is software compatible with the NVIDIA DGX-1 server, you can also use the DGX Station to optimize applications to run on a production DGX-1 cluster.



1.1. What's in the Box

- ▶ DGX Station
- ▶ Accessory boxes containing:
 - ▶ Quick Start Guide
 - ▶ AC power cable
 - ▶ 3 DisplayPort™ 1.2 to HDMI 2.0 adapters
 - ▶ USB recovery flash drive containing a backup copy of the operating system image and CUDA toolkit
 - ▶ DVD-ROM containing source code of open-source software installed on the DGX Station
 - ▶ Toxic Substance Notice and Safety Instructions
 - ▶ Declaration of Conformity
 - ▶ Repacking Instructions/Intra-Transit

Inspect each piece of equipment in the packing box. If anything is missing or damaged, contact your supplier.

1.2. DGX OS Desktop Software Summary

The DGX OS Desktop software that is supplied with the DGX Station includes the software that you need for downloading and running containers for deep learning frameworks. The software is already installed on the DGX Station, except where licensing requirements mandate that the software be supplied separately. Any software that must be supplied separately is installed automatically when the DGX Station is first powered on.

For details about the DGX OS Desktop software, refer to [DGX OS Desktop Release Notes](#).



You can replace the DGX OS Desktop software that is supplied with the DGX Station by installing the DGX software for Red Hat Enterprise Linux or CentOS. For instructions, see:

- ▶ [DGX Software for Red Hat Enterprise Linux 7 - Installation Guide](#)
- ▶ [DGX Software for CentOS - Installation Guide](#)

1.3. DGX Station Hardware Summary

Processors

Component	Qty	Description
CPU	1	Intel Xeon E5-2698 v4 2.2 GHz (20-Core)
GPU - current units	4	NVIDIA Tesla® V100-DGXS-32GB with 32 GB per GPU (128 GB total) of GPU memory
GPU - earlier units	4	NVIDIA Tesla V100-DGXS-16GB with 16 GB per GPU (64 GB total) of GPU memory

System Memory and Storage

Component	Qty	Unit Capacity	Total Capacity	Description
System memory	8	32 GB	256 GB	ECC Registered RDIMM DDR4 SDRAM
Data storage	3	1.92 TB	5.76 TB	2.5" 6 Gb/s SATA III SSD in RAID 0 configuration
OS storage	1	1.92 TB	1.92 TB	2.5" 6 Gb/s SATA III SSD

Chapter 2.

SETTING UP THE NVIDIA DGX STATION

Before using the DGX Station, ensure that its initial set-up is complete.

2.1. Siting the DGX Station



Caution

The DGX Station weighs 88 lbs (40 kg). Do not attempt to lift the DGX Station. Instead, remove the DGX Station from its packaging and move it into position by rolling it on its fitted casters.

To prevent damage to components inside the DGX Station, do not subject the DGX Station to excessive vibration or mechanical shock. After moving or transporting the DGX Station, visually inspect the NVLINK bridge, which connects the GPUs, and the drive trays in the drive cage to see if they have shifted out of position. If any of these components has shifted, reseal the component before operating the DGX Station.

Site the DGX Station in a location that is clean, dust-free, well ventilated, and near an appropriately rated, grounded AC power outlet.

Leave approximately 5" (12.5 cm) of clearance behind and at the sides of the DGX Station to allow sufficient airflow for cooling the unit.

When operating the DGX Station, keep the ambient temperature and relative humidity within the following ranges:

- ▶ **Ambient temperature:** 10°C to 30°C (50°F to 86°F)
- ▶ **Relative humidity:** 10% to 80% (non-condensing)

Always keep the DGX Station upright. Do not lay the unit on its side.

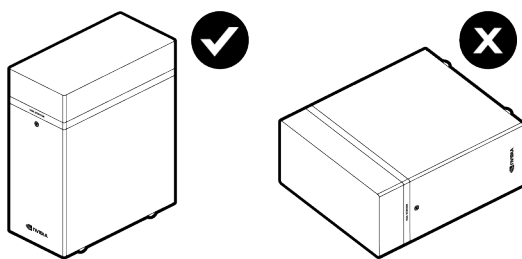

2.2. Removing or Replacing the Packing Inside the DGX Station

To prevent damage to components inside the DGX Station during transit, a foam packing piece is packed inside the DGX Station. Before you connect and power on the DGX Station, you **must** remove this packing piece from inside the DGX Station. If you are returning the DGX Station to NVIDIA under a return merchandise authorization (RMA), replace this packing piece before repacking the DGX Station.

Before you begin, ensure that:

- ▶ The DGX Station is shut down and powered off.
 - ▶ The power cable, all communications cables, and any peripheral devices such as displays and keyboards are disconnected from the DGX Station.
1. Push the button on the right side of the DGX Station back panel to release the side panel on the right of the DGX Station when viewed from the rear.

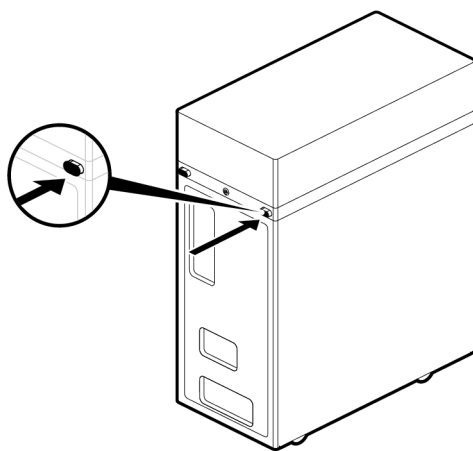

2. Lift the panel to remove it.

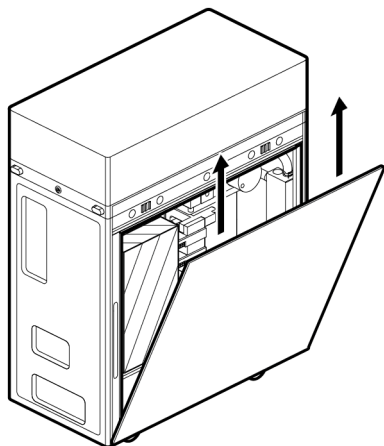

Caution To prevent damage from electrostatic discharge, avoid touching any of the components inside the DGX Station.

3. Remove or replace the foam packing piece that surrounds the GPU cards inside the DGX Station.

- ▶ To remove the foam packing piece, gently grasp it and pull it towards you.

If you are unpacking an advance-shipped replacement for a unit that you are returning to NVIDIA under an RMA, retain this foam packing piece with all other DGX Station packaging. You will need the packaging to repack your original DGX Station for shipment to NVIDIA.

- ▶ To replace the foam packing piece, gently push it into position around the GPU cards inside the DGX Station.

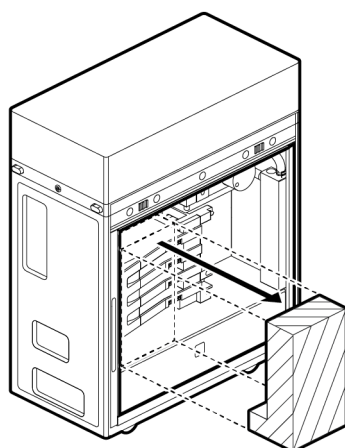

4. Align the bottom edge of the side panel with the bottom edge of the DGX Station.

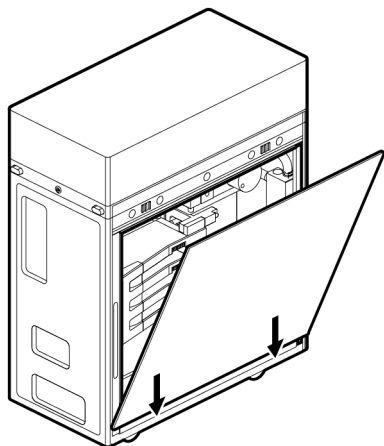

5. Firmly push the panel back into place to re-engage the latches.

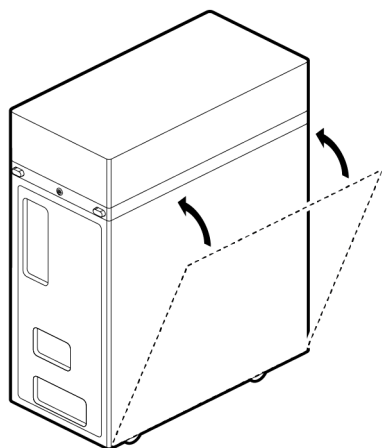

2.3. Connecting and Powering on the DGX Station

To complete this task you need the following items, which are not supplied with the DGX Station:

- ▶ Display with power cable and connector cable terminated in a DisplayPort[™] connector or HDMI connector

If your display connector cable is terminated in an HDMI connector, you can use one of the supplied adapters to connect the cable to the DGX Station.

- ▶ USB keyboard
- ▶ USB mouse
- ▶ Ethernet cable

1. Connect a display to any DisplayPort connector and a keyboard and mouse to any two USB ports.

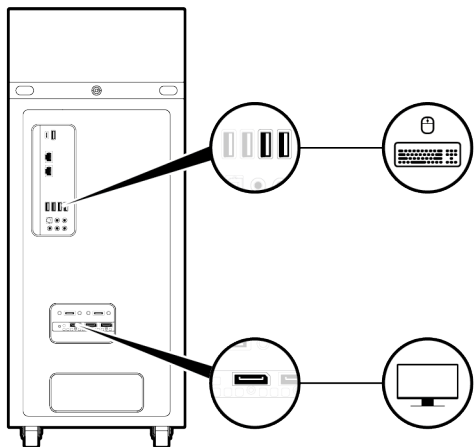

For initial setup, connect only **one** display to the DGX Station. After you complete the initial Ubuntu OS configuration, you can configure the DGX Station to use multiple displays. For details, see [Configuring the DGX Station To Use Multiple Displays](#).

2. Use any of the two Ethernet ports to connect the DGX Station to your LAN with Internet connectivity.

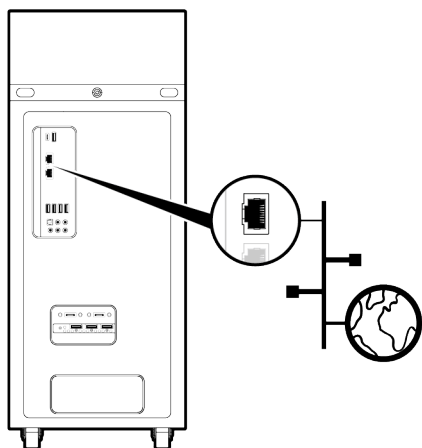

Connect only **one** Ethernet port on the DGX Station to the Internet **unless** you plan to configure the ports manually and disable DHCP on at least one of the ports.

By default, both Ethernet ports on the DGX Station are configured for DHCP. If both the ports are connected simultaneously, each port will get its own IP address. The IP address that the Linux operating system (OS) uses will

then alternate between these addresses, causing the OS and applications to malfunction.

3. Make sure that the power supply rocker switch is in the OFF position.

Current units:

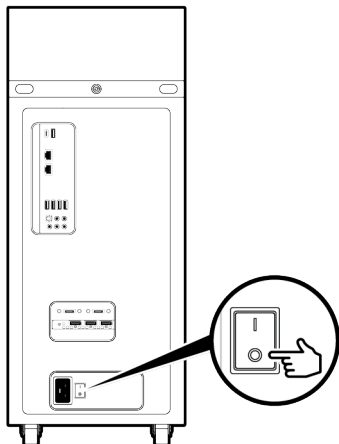

Earlier units:

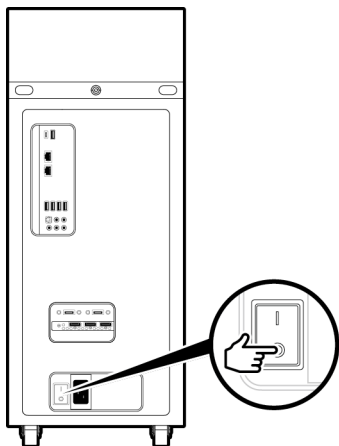

4. Connect the supplied power cable from the power socket at the back of the unit to an appropriately rated, grounded AC outlet.
For details of the power consumption, input voltage, and current rating of the DGX Station, see [Power Specifications](#).

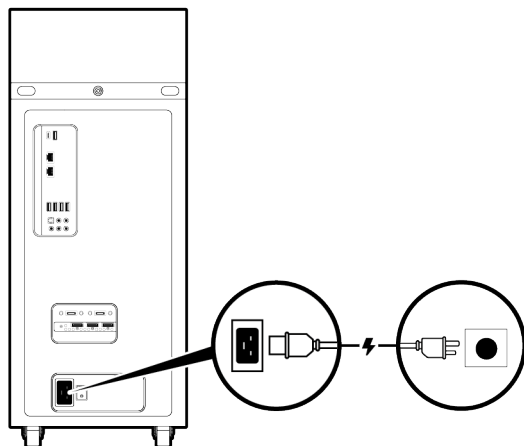
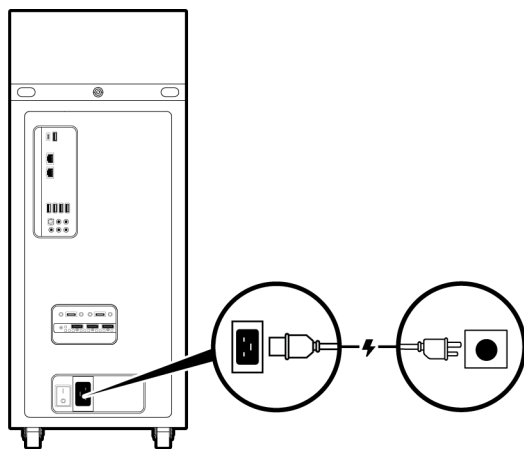
Current units:**Earlier units:****Caution**

Use **only** the supplied power cable and do not use this power cable with any other products or for any other purpose. Not all power cables have the same current ratings.

Do **not** use household extension cables with your product. Household extension cables do not have overload protection and are not intended for use with computer systems.

5. Connect the display to a suitable AC outlet and power on the display.
6. Move the DGX Station power supply rocker switch to the ON position.

Current units:

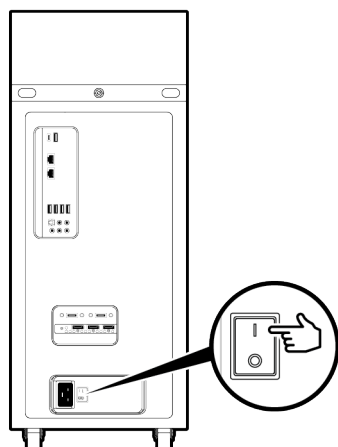

Earlier units:

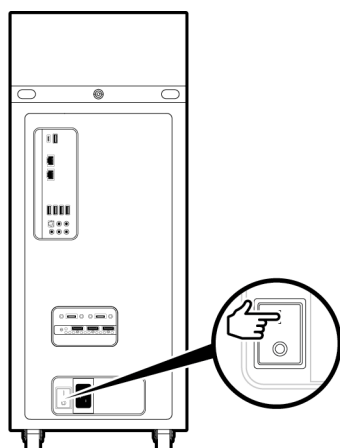

7. Push the Power button on the front of the unit to power on the DGX Station.

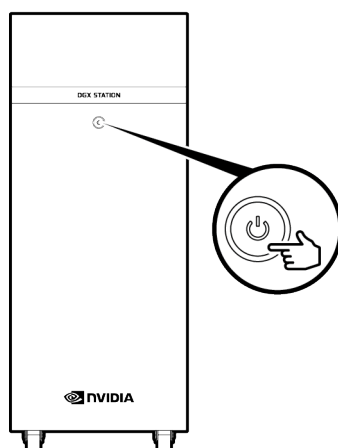

2.4. Completing the Initial Ubuntu OS Configuration

When you power on the DGX Station for the first time, you are prompted to accept end user license agreements for NVIDIA software. You are then guided through the process for completing the initial Ubuntu OS configuration. As part of this process, you are prompted to create your user name and password for logging in to the DGX Station.



To protect the DGX Station from unauthorized access, choose a strong password. The strength of the password you choose is indicated as you type it.

After the Ubuntu OS configuration is complete, you can log in to the DGX Station to access your Ubuntu desktop.



Updates to the DGX Station software might have been made available after your DGX Station was manufactured. To ensure that you have the latest DGX Station software, including security updates, check for updates and install any available updates before using your DGX Station. For more information, see [Upgrading Within the Same DGX OS Desktop Major Release](#).

2.5. Adding Support for Additional Languages to the DGX Station

During the initial Ubuntu OS configuration, you are prompted to select the default language on the DGX Station. If the language that you select is included in the DGX OS Desktop software image, it is installed in addition to English and you will see that language after you log in to access your desktop. If the language that you select is not included, you will still see English after logging in and you will need to install the language separately.

The following languages are included in the DGX OS Desktop software image:

- ▶ English
- ▶ Chinese (Simplified)
- ▶ French
- ▶ German
- ▶ Italian
- ▶ Portuguese
- ▶ Russian
- ▶ Spanish

For information about how to install languages, see the Ubuntu Official Documentation for the release included in your DGX OS Desktop release:

- ▶ **DGX OS Desktop 4 releases:** Ubuntu 18.04: Install languages (<https://help.ubuntu.com/16.04/ubuntu-help/prefs-language-install.html>)
- ▶ **DGX OS Desktop 3 releases:** Ubuntu 16.04: Install languages (<https://help.ubuntu.com/16.04/ubuntu-help/prefs-language-install.html>)

2.6. Registering Your DGX Station

Be sure to register your DGX Station with NVIDIA as soon as you receive your purchase confirmation e-mail. By registering your DGX Station, you will be entitled to receive technical support, warranty services, and software updates. You will also be able to set up an NGC Container Registry account.

To register your DGX Station, you will need information provided in your purchase confirmation e-mail. If you do not have the information, send an e-mail to NVIDIA Enterprise Support at enterprisesupport@nvidia.com.

1. From a browser, go to the [NVIDIA DGX Product Registration](http://www.nvidia.com/object/dgx-product-registration) (<http://www.nvidia.com/object/dgx-product-registration>) page.
2. Enter all required information and then click **SUBMIT** to complete the registration process and receive all warranty entitlements and, if applicable, DGX Station support services entitlements.

2.7. Configuring the DGX Station To Use Multiple Displays

One of the NVIDIA Tesla V100 GPU cards in the DGX Station provides three DisplayPort connectors, enabling you to connect up to three displays to the DGX Station. If you want to use more than one display with the DGX Station, configure it to use multiple displays **after** you complete the initial Ubuntu OS configuration.

1. Connect the displays that you want to use to the DisplayPort connectors at the rear of the DGX Station.

Each display is automatically detected as you connect it.

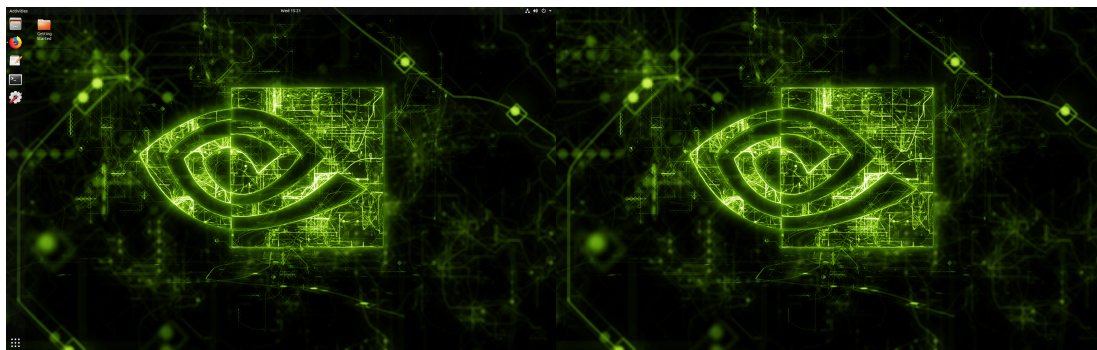

2. Optional: If necessary, adjust the display configuration, such as switching the primary display, or changing monitor positions or orientation.
 - a) Open the **Displays** window.
 - ▶ **DGX OS Desktop 4 releases:** Open the **Ubuntu system menu** at the right of the desktop menu bar, click the tools icon, and in the **Settings** window that opens, choose **Devices > Displays**.
 - ▶ **DGX OS Desktop 3 releases:** From the **Ubuntu system menu** at the right of the desktop menu bar, choose **System Settings** and in the **System Settings** window that opens, click **Displays**.
 - b) In the **Displays** window that opens, make the changes to the display settings that you want and click **Apply**.

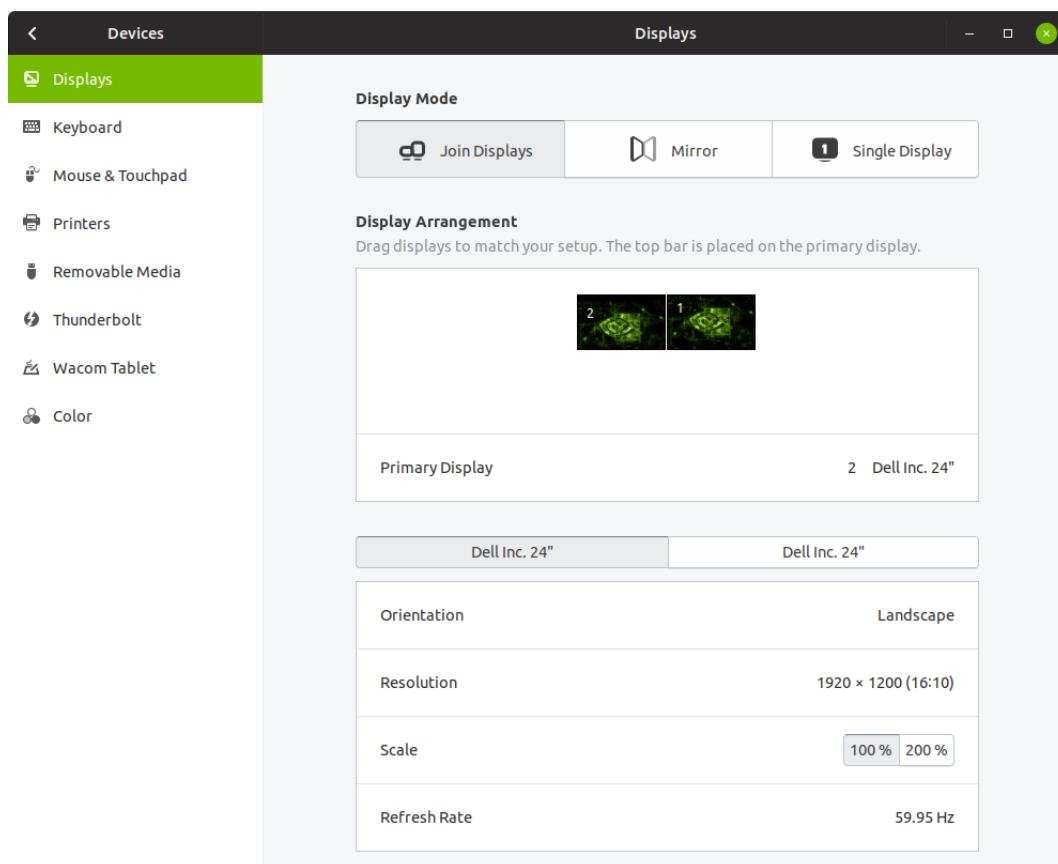

High-resolution displays consume a large quantity of GPU memory. If you have connected three 4K displays to the DGX Station, they may consume most of the GPU memory on the NVIDIA Tesla V100 GPU card to which they are connected, especially if you are running graphics-intensive applications.

If you are running memory-intensive compute workloads on the DGX Station and are experiencing performance issues, consider conserving GPU memory by reducing or minimizing the graphics workload.

- ▶ To reduce the graphics workload, disconnect any additional displays you connected and use only one display with the DGX Station.

If you disconnect a display from the DGX Station, the disconnection is automatically detected and the display settings are automatically adjusted for the remaining displays.

- ▶ To minimize the graphics workload, shut down the display manager and use secure shell (SSH) to log in to the DGX Station remotely.
 - ▶ **DGX OS Desktop 4 releases:** To shut down the GNOME display manager, type the following command:

```
$ sudo telinit 3
```

- ▶ **DGX OS Desktop 3 releases:** To shut down the LightDM display manager, type the following command:

```
$ sudo service lightdm stop
```

To start the display manager, log in to the DGX Station remotely and type the command for your DGX OS Desktop release:

- ▶ **DGX OS Desktop 4 releases:**

```
$ sudo telinit 5
```

- ▶ **DGX OS Desktop 3 releases:**

```
$ sudo service lightdm start
```

2.8. Enabling Multiple Users to Access the DGX Station Remotely

To enable multiple users to access the DGX Station remotely, secure shell (SSH) server is installed and enabled on the DGX Station.

Add other Ubuntu OS users to the DGX Station to allow them to log in remotely to the DGX Station through SSH.

For information about how to add a user, see the Ubuntu Official Documentation for the release included in your DGX OS Desktop release:

- ▶ **DGX OS Desktop 4 releases:** [Ubuntu 18.04: Add a new user account \(https://help.ubuntu.com/16.04/ubuntu-help/user-add.html\)](https://help.ubuntu.com/16.04/ubuntu-help/user-add.html)
- ▶ **DGX OS Desktop 3 releases:** [Ubuntu 16.04: Add a new user account \(https://help.ubuntu.com/16.04/ubuntu-help/user-add.html\)](https://help.ubuntu.com/16.04/ubuntu-help/user-add.html)

For information about how to log in remotely through SSH, see [Connecting to an OpenSSH Server \(https://help.ubuntu.com/community/SSH/OpenSSH/ConnectingTo\)](https://help.ubuntu.com/community/SSH/OpenSSH/ConnectingTo) on the Ubuntu Community Help Wiki.



The DGX Station does **not** provide any additional isolation guarantees between users beyond the guarantees that the Ubuntu OS offers. For guidelines about how to secure access to the DGX Station over SSH, see [Configuring an OpenSSH Server \(https://help.ubuntu.com/community/SSH/OpenSSH/Configuring\)](https://help.ubuntu.com/community/SSH/OpenSSH/Configuring) on the Ubuntu Community Help Wiki.

2.9. Preparing the DGX Station for Use with Docker

Some initial setup of the DGX Station is required to ensure that users have the required privileges to run Docker containers and to prevent IP address conflicts between Docker and the DGX Station.

2.9.1. Enabling Users To Run Docker Containers

To prevent the `docker` daemon from running without protection against escalation of privileges, the Docker software requires `sudo` privileges to run containers. Meeting this requirement involves enabling users who will run Docker containers to run commands with `sudo` privileges. Therefore, you should ensure that only users whom you trust and who are aware of the potential risks to the DGX Station of running commands with `sudo` privileges are able to run Docker containers.

Before allowing multiple users to run commands with `sudo` privileges, consult your IT department to determine whether you would be violating your organization's security policies. For the security implications of enabling users to run Docker containers, see [Docker daemon attack surface](#).

You can enable users to run the Docker containers in one of the following ways:

- ▶ Add each user as an administrator user with `sudo` privileges.
- ▶ Add each user as a standard user without `sudo` privileges and then add the user to the **`docker`** group. This approach is inherently insecure because any user who can send commands to the docker engine can escalate privilege and run root-user operations.

To add an existing user to the **`docker`** group, run this command:

```
$ sudo usermod -aG docker user-login-id
```

user-login-id

The user login ID of the existing user that you are adding to the **`docker`** group.

2.9.2. Preventing IP Address Conflicts Between Docker and the DGX Station

To ensure that the DGX Station can access the network interfaces for Docker containers, configure the containers to use a subnet distinct from other network resources used by the DGX Station. By default, Docker uses the `172.17.0.0/16` subnet. If addresses within this range are already used on the DGX Station network, change the Docker network to specify the bridge IP address range and container IP address range to be used by Docker containers.

This task requires `sudo` privileges.

1. Open the `/etc/systemd/system/docker.service.d/docker-override.conf` file in a plain-text editor, such as `vi`.

```
$ sudo vi /etc/systemd/system/docker.service.d/docker-override.conf
```

2. Append the following options to the line that begins **`ExecStart=/usr/bin/dockerd`**, which specifies the command to start the `dockerd` daemon:

- ▶ **`--bip=bridge-ip-address-range`**
- ▶ **`--fixed-cidr=container-ip-address-range`**

bridge-ip-address-range

The bridge IP address range to be used by Docker containers, for example, **`192.168.127.1/24`**.

container-ip-address-range

The container IP address range to be used by Docker containers, for example, **`192.168.127.128/25`**.

This example shows a complete `/etc/systemd/system/docker.service.d/docker-override.conf` file that has been edited to specify the bridge IP address range and container IP address range to be used by Docker containers.

```
[Service]
ExecStart=
ExecStart=/usr/bin/dockerd -H fd:// -s overlay2 --default-shm-size=1G --
bip=192.168.127.1/24 --fixed-cidr=192.168.127.128/25
LimitMEMLOCK=infinity
LimitSTACK=67108864
```



Starting with DGX OS Desktop release 3.1.4, the option **`--disable-legacy-registry=false`** is removed from the Docker CE service configuration file `docker-override.conf`. The option is removed for compatibility with Docker CE 17.12 and later.

3. Save and close the `/etc/systemd/system/docker.service.d/docker-override.conf` file.
4. Reload the Docker settings for the `systemd` daemon.

```
$ sudo systemctl daemon-reload
```

5. Restart the `docker` service.

```
$ sudo systemctl restart docker
```

Chapter 3.

UPGRADING DGX OS DESKTOP SOFTWARE ON DGX STATION

Updates to DGX OS Desktop software are made available through standard Ubuntu repositories and are available from several sources. You are responsible for upgrading the software on the DGX Station to install the updates from these sources.

Upgrading DGX OS Desktop software can involve upgrading within the same major DGX OS Desktop release or to a new major DGX OS Desktop release.

- ▶ **Upgrading within the same major release** upgrades between two DGX OS Desktop releases with the same first digit in their release identifiers, for example, from 3.1.6 to 3.1.7. Upgrading within the same major release of DGX OS Desktop upgrades all the packages to the latest version in the repositories for that release.
- ▶ **Upgrading to a new major release** upgrades between two DGX OS Desktop releases with different first digits in their release identifiers, for example, from DGX OS Desktop 3.1.7 to 4.0.4. Upgrading to a new major DGX OS Desktop release upgrades all the packages to the latest version in the repositories for the new DGX OS Desktop release.

For details about the available updates, see [Available DGX Station Software Updates](#). These updates may contain important security updates. To protect your DGX Station, keep your system up to date with the latest important security updates. For information about security updates for the Ubuntu OS, see [Ubuntu Security Notices \(https://usn.ubuntu.com/\)](https://usn.ubuntu.com/).

3.1. Upgrading Within the Same DGX OS Desktop Major Release

Perform this task to upgrade between two DGX OS Desktop releases with the same first digit in their release identifiers, for example, from 3.1.6 to 3.1.7. The upgrade process does not update your package sources. Future updates are obtained from repositories for the current major release.

You can use any of the standard means provided by the Ubuntu Desktop OS to upgrade within the same DGX OS Desktop major release. For examples, see:

- ▶ [Upgrading Within the Same DGX OS Desktop Major Release from the Details Window](#)
- ▶ [Upgrading Within the Same DGX OS Desktop Major Release from the Command Line](#)



Caution When you use these means to upgrade software on the DGX Station, you upgrade **all** software for which updates are available from your configured software sources, including applications that you installed yourself. If you want to prevent an application from being upgraded, you can instruct the Ubuntu package manager to keep the current version. For more information, see [Introduction to Holding Packages \(https://help.ubuntu.com/community/PinningHowto#Introduction_to_Holding_Packages\)](https://help.ubuntu.com/community/PinningHowto#Introduction_to_Holding_Packages) on the Ubuntu Community Help Wiki.

3.1.1. Upgrading Within the Same DGX OS Desktop Major Release from the **Details** Window

When you open the **Details** window to get information about your DGX Station, the system checks for updates and, if any updates are available, gives you the option to install them.

Ensure that you are logged in to your Ubuntu desktop on the DGX Station as an administrator user.

1. Open the **Details** window.
 - ▶ **DGX OS Desktop 4 releases:** Open the **Ubuntu system menu** at the right of the desktop menu bar, click the tools icon, and in the **Settings** window that opens, choose **Details > About**.
 - ▶ **DGX OS Desktop 3 releases:** From the Ubuntu **system** menu at the top right of the desktop, choose **About This Computer**.

The **Details** window opens and the system checks for updates.

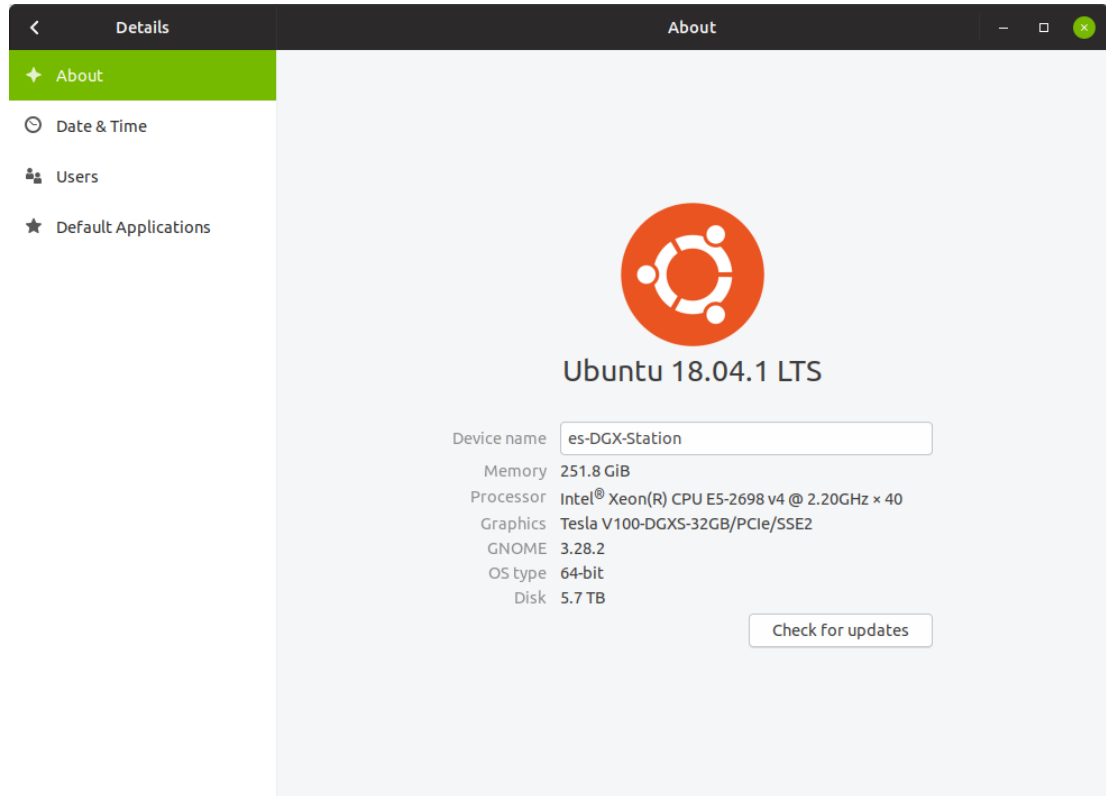

2. In the **Details** window, click **Install Updates**.
3. In the **Software Updater** window that opens, review the available updates and click **Install Now**.

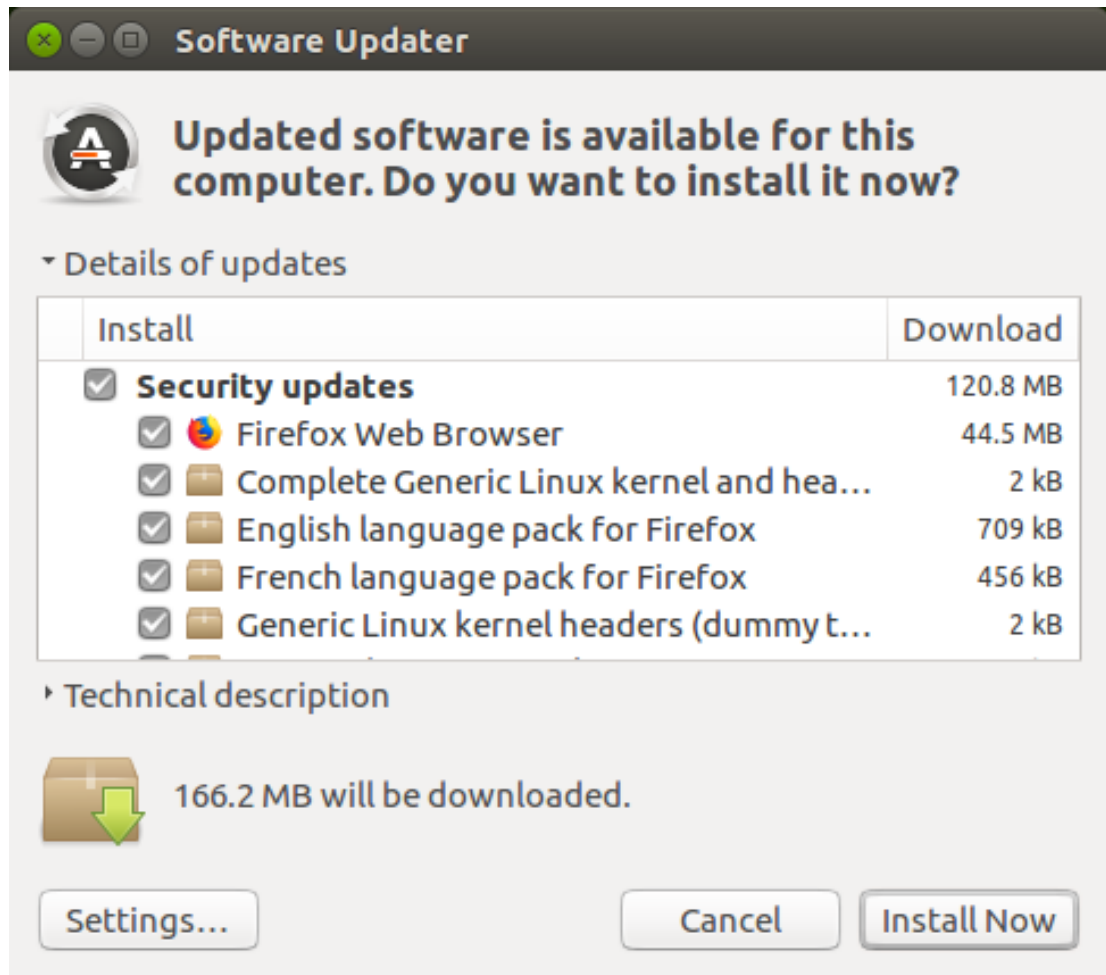

If no updates are available, the **Software Updater** informs you that your software is up to date.

If an update requires the removal of obsolete packages, you will be warned that not all updates can be installed. To continue with the update, perform these steps:

- a) Click **Partial Upgrade**.
- b) Review the list of packages that will be removed.

To identify obsolete DGX OS Desktop packages, see the lists of obsolete packages in the [DGX OS Desktop Release Notes](#) for all releases after your current release.
- c) If the list contains only packages that you want to remove, click **Start Upgrade**.
4. When prompted to authenticate, type your password into the **Password** field and click **Authenticate**.
5. When the update is complete, restart your DGX Station.

Restart the system even if you are not prompted to restart it to complete the updates.

Any update to the NVIDIA Graphics Drivers for Linux requires a restart.

If you update the NVIDIA Graphics Drivers for Linux without restarting the DGX Station, running the `nvidia-smi` command displays an error message.

```
$ nvidia-smi
Failed to initialize NVML: Driver/library version mismatch
```

3.1.2. Upgrading Within the Same DGX OS Desktop Major Release from the Command Line

Use the `apt` (<http://manpages.ubuntu.com/manpages/bionic/en/man8/apt.8.html>) command to upgrade DGX Station software within the same major release from the command line.

Ensure that you are logged in to your Ubuntu desktop on the DGX Station as an administrator user.

1. Download information from all configured sources about the latest versions of the packages.

```
$ sudo apt update
```

2. Review the available updates by simulating an upgrade of the packages.

```
$ sudo apt -s full-upgrade
```

3. Install all available updates for your current DGX OS Desktop release.

```
$ sudo apt -y full-upgrade
```

4. When the upgrade is complete, restart your DGX Station.

Any upgrade to the NVIDIA Graphics Drivers for Linux requires a restart.

If you upgrade the NVIDIA Graphics Drivers for Linux without restarting the DGX Station, running the `nvidia-smi` command displays an error message.

```
$ nvidia-smi
Failed to initialize NVML: Driver/library version mismatch
```

3.2. Upgrading to a New DGX OS Desktop Major Release

Perform this task to upgrade between two DGX OS Desktop releases with different first digits in their release identifiers, for example from 3.1.7 to 4.0.4. The upgrade process updates your package sources to obtain future updates from repositories for the new release.



During the upgrade, the **Ubuntu LTS Upgrade Available** dialog box might open to notify you that a new version of Ubuntu is available, for example:

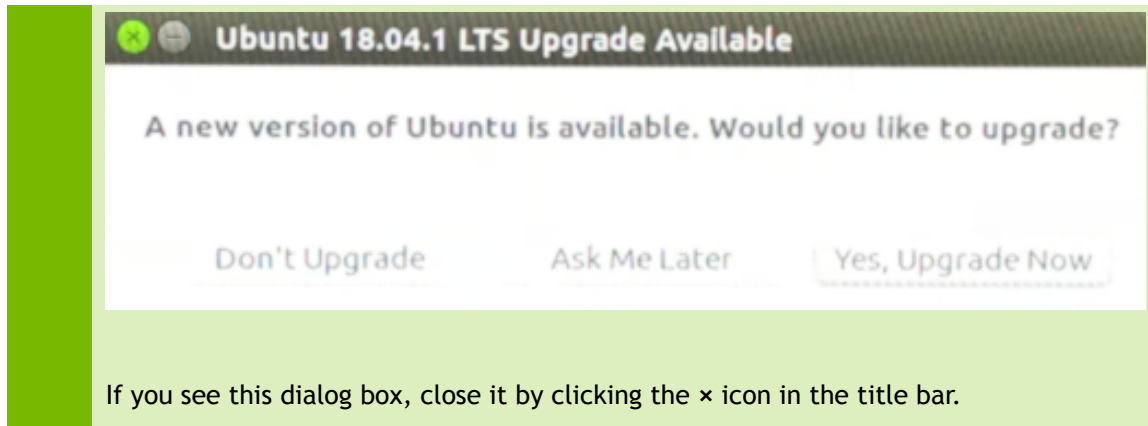

Ensure that the following prerequisites are met:

- ▶ Your current DGX OS Desktop release is on a supported update path for the release that you are upgrading to. For more information, see [DGX OS Desktop Release Notes](#).
- ▶ You are logged in to the DGX Station as an administrator user.

1. Download information from all configured sources about the latest versions of the packages.

```
$ sudo apt update
```

2. Install all available updates for your current DGX OS Desktop release.

```
$ sudo apt -y full-upgrade
```

3. Install the **dgx-release-upgrade** package.

```
$ sudo apt install -y dgx-release-upgrade
```

4. Start the DGX OS Desktop release upgrade process.

```
$ sudo dgx-release-upgrade
```

If you are logged in to the DGX Station remotely through secure shell (SSH), you are asked if you want to continue running under SSH.

```
Continue running under SSH?
```

```
This session appears to be running under ssh. It is not recommended
to perform a upgrade over ssh currently because in case of failure it
is harder to recover.
```

```
If you continue, an additional ssh daemon will be started at port
'1022'.
```

```
Do you want to continue?
```

```
Continue [yN]
```

- a) Enter **y** to continue.

An additional `sshd` daemon is started and the following message is displayed:

```
Starting additional sshd
```

```
To make recovery in case of failure easier, an additional sshd will
be started on port '1022'. If anything goes wrong with the running
```

```
ssh you can still connect to the additional one.
If you run a firewall, you may need to temporarily open this port. As
this is potentially dangerous it's not done automatically. You can
open the port with e.g.:
'iptables -I INPUT -p tcp --dport 1022 -j ACCEPT'
```

To continue please press [ENTER]

- b) In response to the prompt, press **Enter** to continue.

You are warned that third-party sources are disabled.

Third party sources disabled

Some third party entries in your sources.list were disabled. You can re-enable them after the upgrade with the 'software-properties' tool or your package manager.

To continue please press [ENTER]

Canonical and DGX repositories are preserved for the upgrade, but any other repositories, for example, Google Chrome or VSCode, will be disabled. After the upgrade, you must manually re-enable any third-party sources that you want to keep.

5. In response to the prompt, press **Enter** to continue.
You are asked to confirm that you want to start the upgrade.

```
Do you want to start the upgrade?
...
Installing the upgrade can take several hours. Once the download has
finished, the process cannot be canceled.
Continue [yN] Details [d]
```

6. In response to the prompt, enter **y** to start the upgrade.
You are warned that lock screen is disabled.

Lock screen disabled

Your lock screen has been disabled and will remain disabled until you reboot.

To continue please press [ENTER]
Inhibiting until Ctrl+C is pressed...

7. Press **Enter** to continue.

Do **not** press **Ctrl+C** in response to this warning. Pressing **Ctrl+C** terminates the upgrade process.

8. When prompted to resolve conflicts in configuration files, evaluate the changes before accepting the maintainer's version, keeping the local version, or manually resolving the difference.

Conflicts in some configuration files might be the result of customizations to the Ubuntu Desktop OS made for DGX OS Desktop. For guidance about how to resolve these conflicts, see the chapter in the [DGX OS Desktop Release Notes](#) for the release family that you are upgrading to.

You are asked to confirm that you want to remove obsolete packages.

Remove obsolete packages?

371 packages are going to be removed.

Removing the packages can take several hours.

Continue [yN] Details [d]

9. Determine whether to remove obsolete packages and continue with the upgrade.

- a) Review the list of packages that will be removed.

To identify obsolete DGX OS Desktop packages, see the lists of obsolete packages in the [DGX OS Desktop Release Notes](#) for all releases after your current release.

- b) If the list contains only packages that you want to remove, enter **y** to continue with the upgrade.

When the system upgrade is complete, you are prompted to restart the system.

System upgrade is complete.

Restart required

To finish the upgrade, a restart is required.
If you select 'y' the system will be restarted.

Continue [yN]

10. In response to the prompt, enter **y** to restart the system.

After the system is restarted, the upgrade process takes several minutes to perform some final installation steps.

11. Confirm the Linux kernel version.

```
$ uname -a
```

For example, for an upgrade to DGX OS Desktop 4.0.4, the Linux kernel version is at minimum **4.15.0-36-generic**:

```
Linux es-DGX-Station 4.15.0-36-generic #39-Ubuntu SMP Mon Sep 24 16:19:09
UTC
2018 x86_64 x86_64 x86_64 GNU/Linux
```

For the minimum Linux kernel version of the release that you are upgrading to, consult the release notes for that release.

12. Confirm the NVIDIA Graphics Drivers for Linux version.

```
$ nvidia-smi
```

For example, for an upgrade to DGX OS Desktop 4.0.4, the NVIDIA Graphics Drivers for Linux version is 410.79:

```
Tue Dec 11 18:03:56 2018
+-----+
| NVIDIA-SMI 410.79      Driver Version: 410.79      CUDA Version: 10.0      |
|-----+-----+-----+-----+
...

```

For the NVIDIA Graphics Drivers for Linux version of the release that you are upgrading to, consult the release notes for that release.

3.3. Opting in to DGX OS Desktop Patch Updates

Patch updates are package upgrades to individual components in DGX OS Desktop software that are delivered through the DGX OS Desktop update repository. You must opt in to receive patch updates. When you opt in, any available patch updates are installed. After you opt in, the distribution for DGX OS Desktop patch updates is added to your configured sources from which packages are obtained.

Ensure that the following prerequisites are met:

- ▶ You are logged in to your Ubuntu desktop on the DGX Station as an administrator user.
 - ▶ Your DGX Station is upgraded to DGX OS Desktop release .
1. Download information from all configured sources about the latest versions of the packages.

```
$ sudo apt update
```

2. Install the **dgxstation-release-updates-repo** package.

```
$ sudo apt install -y dgxstation-release-updates-repo
```

release

The code name of the Ubuntu OS release on which your DGX OS Desktop release is based. For example, if you are running a DGX OS Desktop 4 release, which is based on Ubuntu 18.04, *release* is **bionic**.

This example installs the **dgxstation-bionic-updates-repo**.

```
$ sudo apt install -y dgxstation-bionic-updates-repo
```

3. After installing the **dgxstation-release-updates-repo** package, download information from all configured sources about the latest versions of the packages again.

```
$ sudo apt update
```

4. Review the available updates by simulating an upgrade of the packages.

```
$ sudo apt -s full-upgrade
```

5. Install all available updates for your current DGX OS Desktop release.

```
$ sudo apt -y full-upgrade
```

6. When the upgrade is complete, restart your DGX Station.

Any upgrade to the NVIDIA Graphics Drivers for Linux requires a restart.

If you upgrade the NVIDIA Graphics Drivers for Linux without restarting the DGX Station, running the `nvidia-smi` command displays an error message.

```
$ nvidia-smi
Failed to initialize NVML: Driver/library version mismatch
```

3.4. Available DGX Station Software Updates

Updates to DGX Station are made available through standard Ubuntu repositories.

DGX Station is preset to obtain from these repositories updates to the following software:

- ▶ Docker
- ▶ Software that is exclusive to the DGX Station, including the CUDA Toolkit and CUDA Drivers packages
- ▶ Ubuntu software

For more information about repositories, see [Repositories/Ubuntu \(https://help.ubuntu.com/community/Repositories/Ubuntu\)](https://help.ubuntu.com/community/Repositories/Ubuntu) on the Ubuntu Community Help Wiki.

3.4.1. Updates to Docker and Software Exclusive to the DGX Station

Updates to Docker and to software that is exclusive to the DGX Station, including the CUDA Toolkit and CUDA Drivers packages, are available from a repository maintained by NVIDIA.



Caution

- ▶ Do **not** obtain updates to the CUDA Toolkit and CUDA Drivers packages from the public CUDA package repository for Ubuntu. Updates from the public repository may be incompatible with the DGX Optimized Frameworks that are available from the NVIDIA® GPU Cloud (NGC) Container Registry.
- ▶ Do **not** obtain updates to Docker from Docker's repositories. NVIDIA Container Runtime for Docker has strict dependencies on the Docker CE version and updates from Docker's repository may cause NVIDIA Container Runtime for Docker to be removed.

The repository maintained by NVIDIA is enabled by default in **Ubuntu Software & Updates, Other Software** on the DGX Station, as shown in the following screen capture.



Although a Docker repository is also enabled, DGX Station no longer uses this repository to obtain updates to Docker because the repository maintained by NVIDIA takes precedence over the Docker repository.

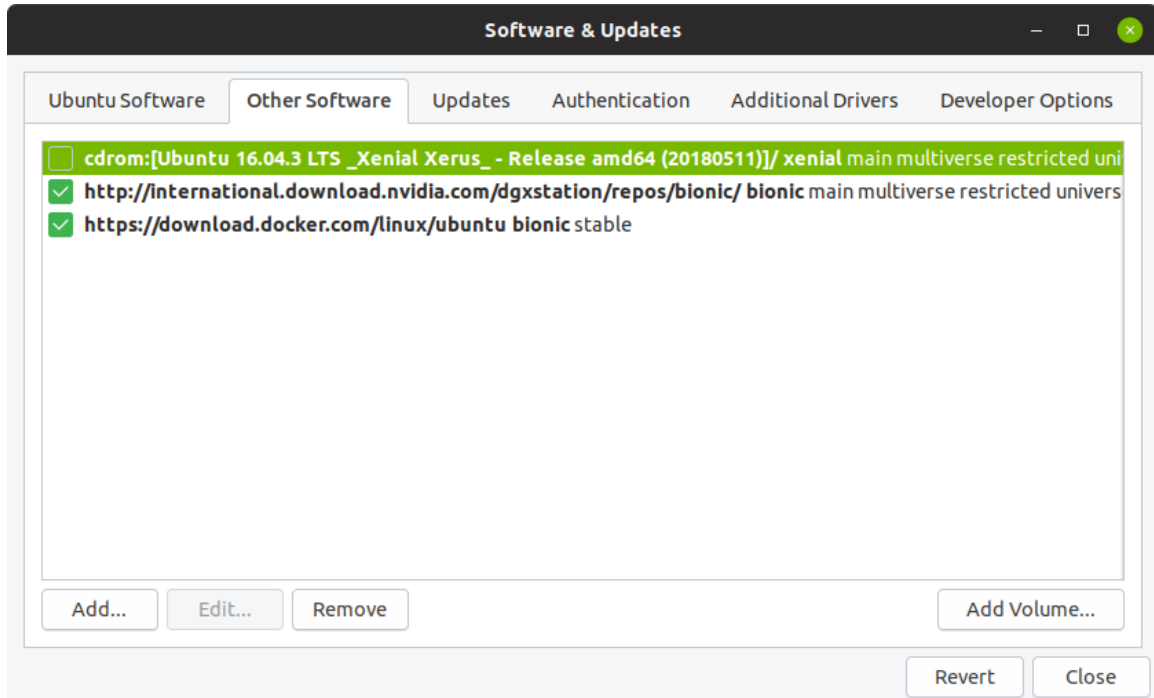

The following distributions are available from this repository:

release-main

Contains major and minor DGX OS Desktop releases.

release-update

Contains patch updates that distribute security updates, fixes to critical issues, and other updates. This distribution is active only if you have opted in to patch updates as explained in [Opting in to DGX OS Desktop Patch Updates](#).

release is the code name of the Ubuntu OS release on which your DGX OS Desktop release is based. For example, if you are running a DGX OS Desktop 4 release, which is based on Ubuntu 18.04, *release* is **bionic**.

3.4.2. Updates to the Ubuntu Software on the DGX Station

Updates to the Ubuntu software on the DGX Station are available from the Canonical repositories.

The repositories that are enabled by default in **Ubuntu Software & Updates**, **Ubuntu Software** on the DGX Station are shown in the following screen capture.

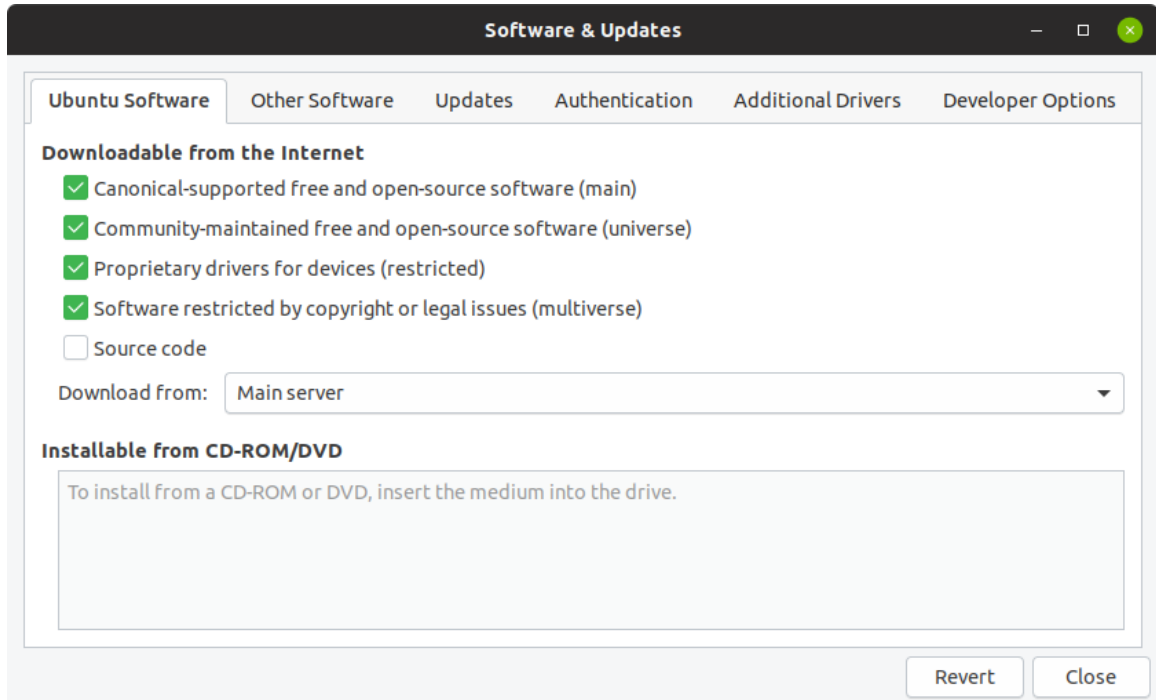

By default, the DGX Station does not notify you of available updates or automatically install any updates, including important security updates. To minimize the risk to your DGX Station from security vulnerabilities, you **must** ensure that it is kept up to date with the latest important security updates.

Updates to another LTS base OS version are blocked because they can disrupt the DGX Station software and disable the NVIDIA graphics drivers.

3.5. Checking for Updates to DGX Station Software

To check for software updates and to configure updates from the Ubuntu software repositories, use **Software & Updates**. You can configure your DGX Station to notify you of important security updates more frequently than other updates.

In the following example, the DGX Station is configured to check for updates daily, to display important security updates immediately, and to display other updates every two weeks.

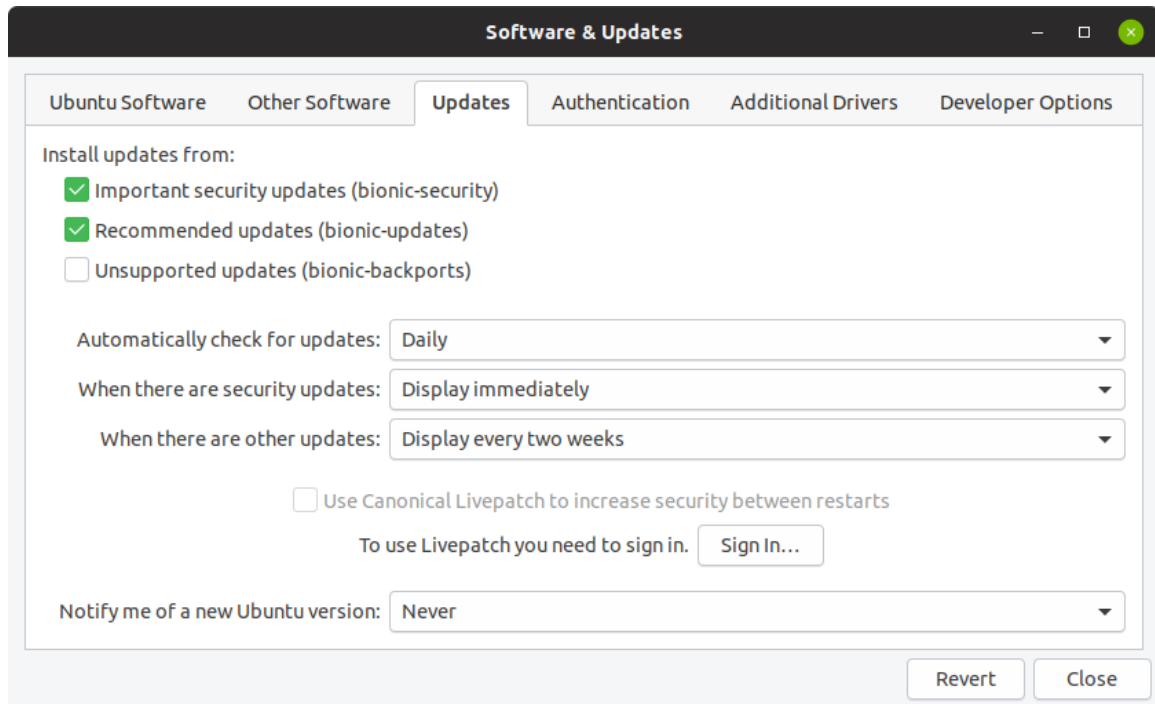

3.6. Getting Release Information for DGX Station

The file `/etc/dgx-release` provides release information for the DGX Station, such as the product name and serial number.

This file also tracks the history of DGX OS Desktop software updates by providing the following information:

- ▶ The version number and installation date of the last version to be installed from an ISO image
- ▶ The version number and update date of each over-the-network update applied since the software was last installed from an ISO image

You can use this information to determine if your DGX Station is running the current version of the DGX OS Desktop software.

To get release information for the DGX Station, view the content of the file `/etc/dgx-release`.

For example:

```
$ more /etc/dgx-release
DGX_NAME="DGX Station"
DGX_PRETTY_NAME="NVIDIA DGX Station"
DGX_SWBUILD_DATE="2017-09-18"
DGX_SWBUILD_VERSION="3.1.2"
DGX_COMMIT_ID="15cd1f473bb53d9b64503e06c5fee8d2e3738ece"
DGX_SERIAL_NUMBER=XXXXXXXXXXXXXX
```

```
DGX_OTA_VERSION="3.1.3"
DGX_OTA_DATE="Wed Nov 15 15:35:25 PST 2017"

DGX_OTA_VERSION="3.1.4"
DGX_OTA_DATE="Fri Jan 19 13:49:06 PST 2018"

DGX_OTA_VERSION="3.1.7"
DGX_OTA_DATE="Tue Jun 19 14:23:18 PDT 2018"

DGX_OTA_VERSION="4.0.4"
DGX_OTA_DATE="Tue Dec 11 17:45:30 PST 2018"
```

3.7. Updating Software on an Air-Gapped DGX Station System

For security purposes, some installations require that the DGX Station be an air-gapped system. An air-gapped system is not connected to any unsecured networks, such as the public Internet or an unsecured LAN, or to any other computers connected to an unsecured network. The default mechanisms for updating software on the DGX Station and loading container images from the NGC Container Registry require an Internet connection. On an air-gapped system, which is isolated from the Internet, you must provide alternative mechanisms for updating software and loading container images.

3.7.1. Providing DGX Station Software Updates from a Private Repository

The public NVIDIA and Canonical repositories that provide software updates to the DGX Station are Ubuntu repositories. Access to these repositories requires an Internet connection. On an air-gapped system, which is isolated from the Internet, you must provide these updates from a private repository that mirrors the public repositories.

1. Identify the sources corresponding to the public NVIDIA and Canonical repositories that provide updates to the DGX Station software.

You can identify these sources from the `/etc/apt/sources.list` file and the contents of `/etc/apt.sources.list.d/` directory, or by using **System Settings, Software & Updates**.

2. Create and maintain a private repository that mirrors the sources that you identified in the previous step.

For detailed instructions, refer to [Debian Repository Setup \(https://wiki.debian.org/DebianRepository/Setup\)](https://wiki.debian.org/DebianRepository/Setup) on the Debian wiki.

3. Update the sources that provide updates to the DGX Station to use your private repository instead of the public repositories.

You can update these sources by modifying the `/etc/apt/sources.list` file and the contents of `/etc/apt.sources.list.d/` directory, or by using **System Settings, Software & Updates**.

Future updates to the DGX Station software will be obtained from your private repository.

3.7.2. Loading a Container Image onto an Air-Gapped DGX Station System

Loading a container image from the NGC Container Registry requires an Internet connection. On an air-gapped system, which is isolated from the Internet, you must use a removable medium to copy the container image from a system with an Internet connection to the air-gapped system.

1. On a system with an Internet connection, log in to the NGC Container Registry and load the container image that you want.
For instructions, refer to [NGC Container Registry for DGX User Guide](#).
2. Save the container image as a `tar` archive.

```
$ docker save nvcr.io/registry-space/repository:tag > archive-file.tar
```

registry-space

The name of the space within the registry that contains the container image. For container images provided by NVIDIA, the registry space is **nvidia**.

repository

The repository that contains the container image. A repository is a collection of all versions of a container image with the same name. The repository name is the main container image name.

tag

A tag that identifies the version of the container image.

archive-file

Your choice of name for the archive file to which you are saving the container image.

3. Transfer the image to the air-gapped system by using a removable medium such as a USB flash drive or DVD-ROM.
4. On the air-gapped system, load the container image from the local copy of the archive file that contains the image.

```
$ docker load -i framework.tar
```

5. Confirm that the image is loaded on the air-gapped system.

```
$ docker images
```

Chapter 4.

MAINTAINING AND SERVICING THE NVIDIA DGX STATION

Be sure to familiarize yourself with the NVIDIA Terms & Conditions documents before attempting to perform any modification or repair to the DGX Station. These Terms & Conditions for the DGX Station can be found through the [NVIDIA DGX Systems Support \(http://www.nvidia.com/object/dgxsystems-support.html\)](http://www.nvidia.com/object/dgxsystems-support.html) page.



Caution The DGX Station is designed as an integrated system and does **not** support the installation of additional PCIe devices such as GPU cards. Any attempt to modify the DGX Station by installing additional PCIe devices is an unauthorized modification and will void the DGX Station hardware warranty. Any such modification will also impair the performance of the system, may overload the system's electrical circuits, and may cause it to overheat.

4.1. Problem Resolution and Customer Care

Log on to the [NVIDIA Enterprise Support \(https://nvid.nvidia.com/dashboard/\)](https://nvid.nvidia.com/dashboard/) site for assistance with troubleshooting, diagnostics, or to report problems with your DGX Station.

Refer to [Customer Support for the NVIDIA DGX Station](#) for additional contact information.

4.2. Cleaning the Mesh Filter Under the DGX Station

To prevent dust from entering the DGX Station through the ventilation holes under the unit, a mesh filter is fitted to the underside of the DGX Station. Clean this mesh filter periodically to prevent the accumulation of dust on the filter from impeding the flow of air through the DGX Station.

1. Reach under the front of the DGX Station and grasp the mesh filter by its handle.
2. Pull the mesh filter towards you to slide it out from the front of the unit.

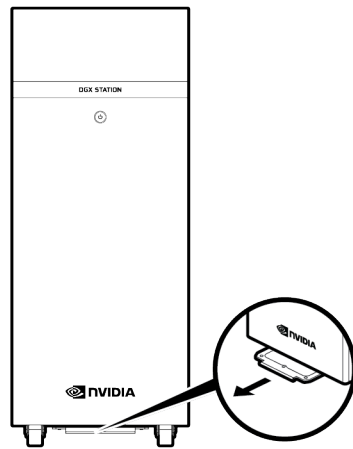

3. Use compressed air to blow the dust from the mesh filter.
4. Line up the mesh filter with the runners under the DGX Station and slide it back into position under the unit.

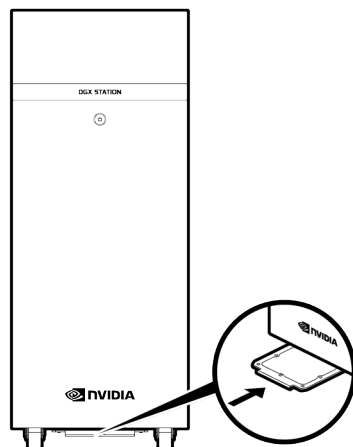

4.3. Collecting Information for Troubleshooting the

To help diagnose and resolve issues, the provides a tool to collect troubleshooting information for NVIDIA Support Enterprise Services.

The tool verifies basic functionality and performance of the and collects the following information in an xz-compressed tar archive:

- ▶ Log files
- ▶ Hardware inventory
- ▶ SW inventory

To collect information for troubleshooting the , run the following command:

```
sudo nvsysinfo [-o output-file]
```

output-file

The path of the file in which the information is written.

Use any method that is convenient for you to send the file to NVIDIA Support Enterprise Services. For example, send the file as an e-mail attachment.

4.4. Checking the Health of the

The provides the NVIDIA System Health Checker (`nvhealth`) tool to exercise the system and verify its health. The output of `nvhealth` is an itemized list of checks and their status, typically Healthy or Unhealthy. On a healthy system, all checks should return Healthy. You should investigate any checks that return Unhealthy to determine their root cause and resolve them.

To check the health of the , run the following command:

```
$ sudo nvhealth [-k output-file]
```

output-file

The name and the path of the file in which the raw state of the system is written. The `nvhealth` command displays this file name at the end of the output from the command.

If you omit the output file, the information is written to the file `/tmp/nvhealth-log.random-string.jsonl`, for example, `/tmp/nvhealth-log.6wf3WriAC3.jsonl`.



If you run the `nvhealth` command while the RAID array is being rebuilt after a change in RAID level to RAID 5, `nvhealth` reports the status of the RAID volume as unhealthy. To avoid this potentially misleading result, wait until RAID array is rebuilt before running `nvhealth`.

To check the progress of the rebuild and show the percentage complete and an estimate of the time to completion, run this command:

```
# cat /proc/mdstat

Personalities : [raid6] [raid5] [raid4] [linear] [multipath] [raid0]
                [raid1] [raid10]
md0 : active raid5 sdb[0] sdc[1] sdd[2]
```

```
181764096 blocks super 1.2 level 5, 512k chunk, algorithm 2 [4/3]
[UUU_]
[==>.....]  recovery = 17.2% (10426232/60588032)
finish=45.8min speed=18238K/sec
```

4.5. Replacing the System and Components

Be sure to familiarize yourself with the NVIDIA Terms & Conditions documents before attempting to perform any modification or repair to the DGX Station. These Terms & Conditions for the DGX Station can be found through the [NVIDIA DGX Systems Support \(http://www.nvidia.com/object/dgxsystems-support.html\)](http://www.nvidia.com/object/dgxsystems-support.html) page.

Contact NVIDIA Enterprise Support to obtain an RMA number for any system or component that needs to be returned for repair or replacement. When replacing a component, use **only** the replacement supplied to you by NVIDIA unless you are directed otherwise.

The following components are customer-replaceable:

- ▶ Solid State Drives (SSDs)
- ▶ DIMMs
- ▶ CMOS power cell



Obtain the replacement CMOS power cell yourself, not from NVIDIA Enterprise Support.

Return failed high-value components to NVIDIA. Low-cost items such as CMOS power cells do not need to be returned.

4.5.1. Replacing the System

When returning a DGX Station under RMA, consider the following points.

Packaging

To prevent damage during shipping, repack the DGX Station in the packaging in which the replacement unit was advanced shipped by following the instructions in [Repacking the DGX Station for Shipment](#).

SSDs

If necessary, you can remove and keep the SSDs prior to shipping the system back for replacement. If you already received a replacement system and you want to keep the original SSDs, install the new SSDs into the defective system when shipping it back.

AC Power Cable

Do **not** return the AC power cable when returning the DGX Station.

Accessories

Include all supplied accessories **except** the AC power cable when returning the DGX Station.

4.5.2. Repacking the DGX Station for Shipment

If you are returning the DGX Station to NVIDIA under an RMA, repack it in the packaging in which the replacement unit was advanced shipped to prevent damage during shipment.



Caution The DGX Station weighs 88 lbs (40 kg). Do not attempt to lift the DGX Station. Instead, move it into position by rolling it on its fitted casters.

Before you begin, ensure that the foam packing piece that surrounds the GPU cards inside the DGX Station has been replaced. For detailed instructions, see [Removing or Replacing the Packing Inside the DGX Station](#).

1. Place the bottom tray of the DGX Station shipping carton on the floor and ensure that the flap at the front of the tray is pulled down to form a ramp.
2. Roll the DGX Station up the ramp into the bottom tray of its shipping carton.



Caution Ensure that you have a second person to help you roll the DGX Station into position.

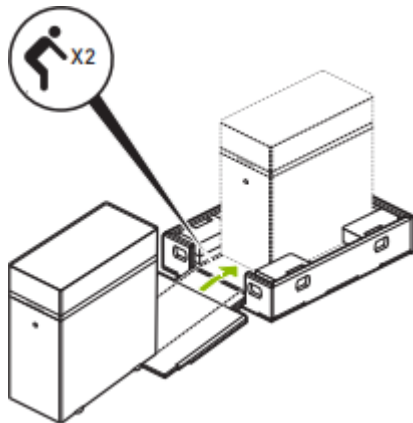

3. Insert the front packing piece into the tray, ensuring that the lip of the packing piece is under the DGX Station.

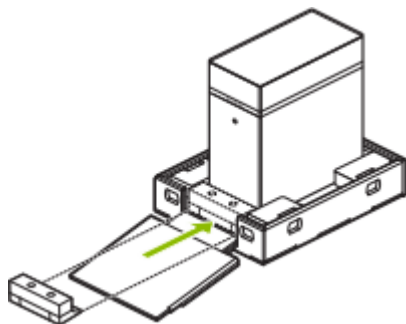

4. Insert the side packing pieces into the tray, ensuring that the lip of each piece is under the DGX Station.

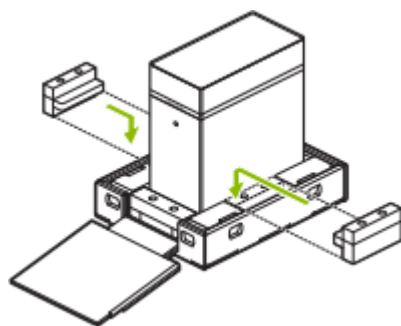

5. Pack all supplied accessories in the accessory boxes **except** the AC power cable. Keep the AC power cable to use with your replacement DGX Station.
6. Place **both** accessory boxes in the slots in the tray on each side of the DGX Station. Ensure that the lugs that protrude from the edges of each accessory box are facing away from the DGX Station.

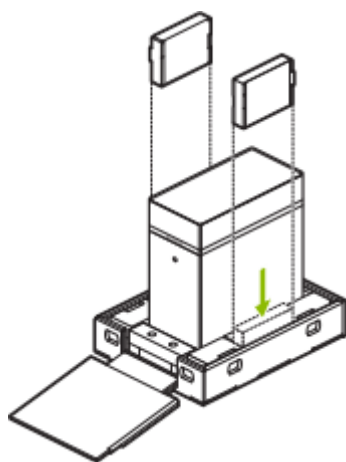

The accessory boxes are required to help hold the DGX Station in place in its packaging during shipment. Be sure to place both accessory boxes in the slots in the tray, even if one or both boxes are empty.

7. Pull up the flap at the front of the bottom tray of the DGX Station shipping carton.

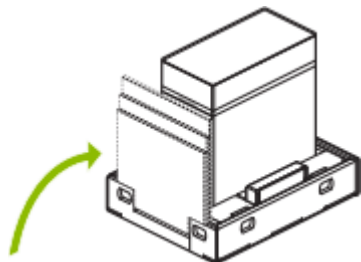

8. Lower the top cover of the shipping carton into position so that the holes in the top cover and the holes in the bottom tray are aligned.

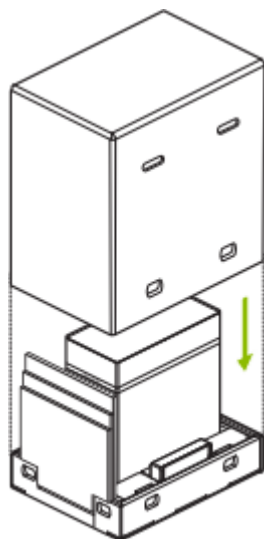

9. Insert the packing clasps into the cutouts in the top cover of the shipping carton and engage the clasps to secure the top cover in place.

To prevent the packing clasps from becoming jammed inside the shipping carton, do not use excessive force when inserting them into the cutouts.

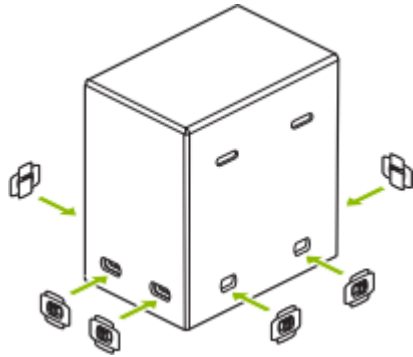

4.5.3. Replacing a DIMM

Before attempting to replace any of the dual inline memory modules (DIMMs), contact NVIDIA Enterprise Customer support for help in determining the location ID of the faulty DIMM that needs replacement.

The location ID is one of the following alphanumeric designators:

- ▶ DIMM_A1
- ▶ DIMM_A2
- ▶ DIMM_B1
- ▶ DIMM_B2
- ▶ DIMM_C1
- ▶ DIMM_C2
- ▶ DIMM_D1
- ▶ DIMM_D2



Caution The components inside the DGX Station are static-sensitive devices. Protect these devices against electrostatic discharge (ESD) by wearing a wrist strap connected to the DGX Station chassis ground and placing components on static-free work surfaces.

The DIMMs are located on the motherboard inside the DGX Station.

1. Turn off the DGX Station and disconnect the network and power cables.
2. Remove the side panel on the right of the DGX Station when viewed from the rear.
 - a) Push the button on the right side of the DGX Station back panel to release the panel.

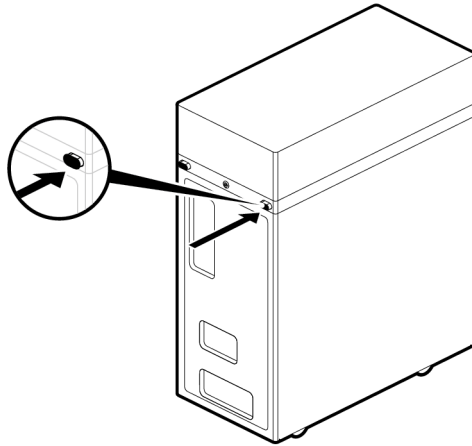

b) Lift the panel to remove it.

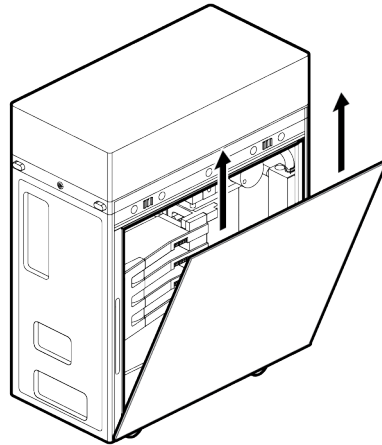

 **Caution** To prevent damage from electrostatic discharge, avoid touching any of the components inside the DGX Station other than any components that you are replacing or servicing.

3. Using the following figure as a guide, locate the faulty DIMM.

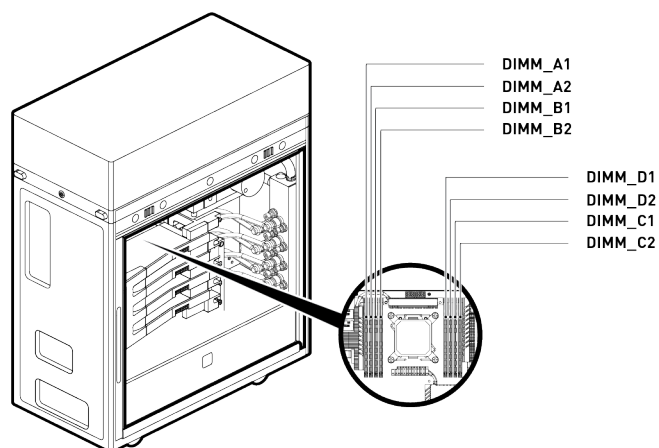

4. Remove the faulty DIMM.

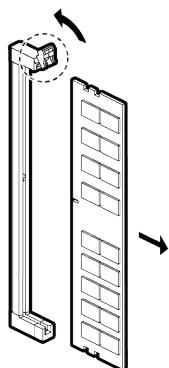

- a) Press upwards on the latch at the upper end of the DIMM socket to open the latch and unseat the DIMM from the socket.
 - b) Pull the DIMM towards you to remove it from the socket.
5. Carefully insert the replacement DIMM.

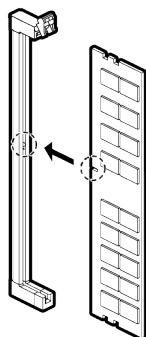

- a) Make sure the socket latch is open.
- b) Position the replacement DIMM over the socket, making sure that the notch on the DIMM lines up with the key in the slot, then press the DIMM into the socket until the latch clicks into place.

When the DIMM is correctly seated, the latch should be closed as shown in the following figure.

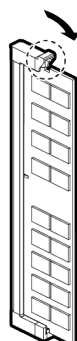

6. Replace the side panel of the DGX Station.
 - a) Align the bottom edge of the side panel with the bottom edge of the DGX Station.

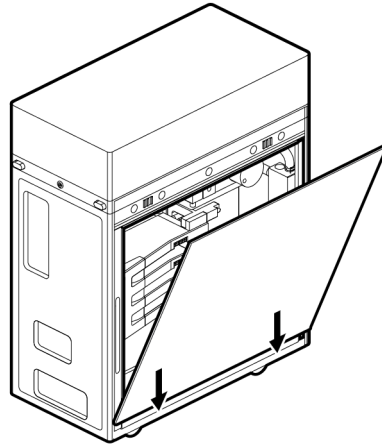

- b) Firmly push the panel back into place to re-engage the latch.

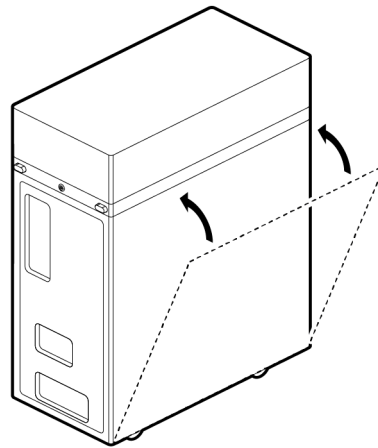

7. Reconnect the network and power cables and power on the DGX Station.
The DGX Station stops at its power-on self-test (POST) and then shuts down.
8. After the DGX Station shuts down, power it on again.
When powered on a second time, the DGX Station starts up normally.

4.5.4. Replacing the CMOS Power Cell in the DGX Station

The CMOS power cell in the DGX Station provides power to the Real Time Clock (RTC) to maintain BIOS settings such as the system time and date while DGX Station is disconnected from the AC power supply. If the DGX Station is restarted after being disconnected from the AC power supply and the CMOS power cell is discharged, you

are warned that the RTC has been reset and that the settings must be updated in the BIOS. To avoid these warnings, replace the CMOS power cell in the DGX Station.



Caution The components inside the DGX Station are static-sensitive devices. Protect these devices against electrostatic discharge (ESD) by wearing a wrist strap connected to the DGX Station chassis ground and placing components on static-free work surfaces.

To complete this task, you need the following tools and materials:

- ▶ 1 small flat head screwdriver
 - ▶ 1 fresh CR2032 power cell
1. Turn off the DGX Station and disconnect the network and power cables.
 2. Remove the side panel on the right of the DGX Station when viewed from the rear.
 - a) Push the button on the right side of the DGX Station back panel to release the panel.

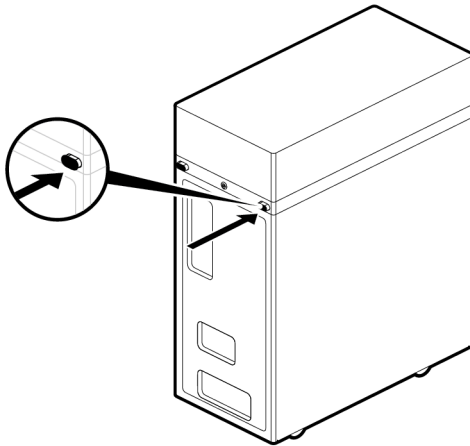

- b) Lift the panel to remove it.

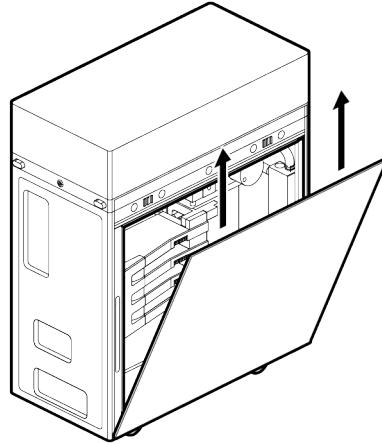

Caution To prevent damage from electrostatic discharge, avoid touching any of the components inside the DGX Station other than any components that you are replacing or servicing.

3. Remove the old CMOS power cell.

The CMOS power cell is located in the top left corner of the motherboard inside the DGX Station.

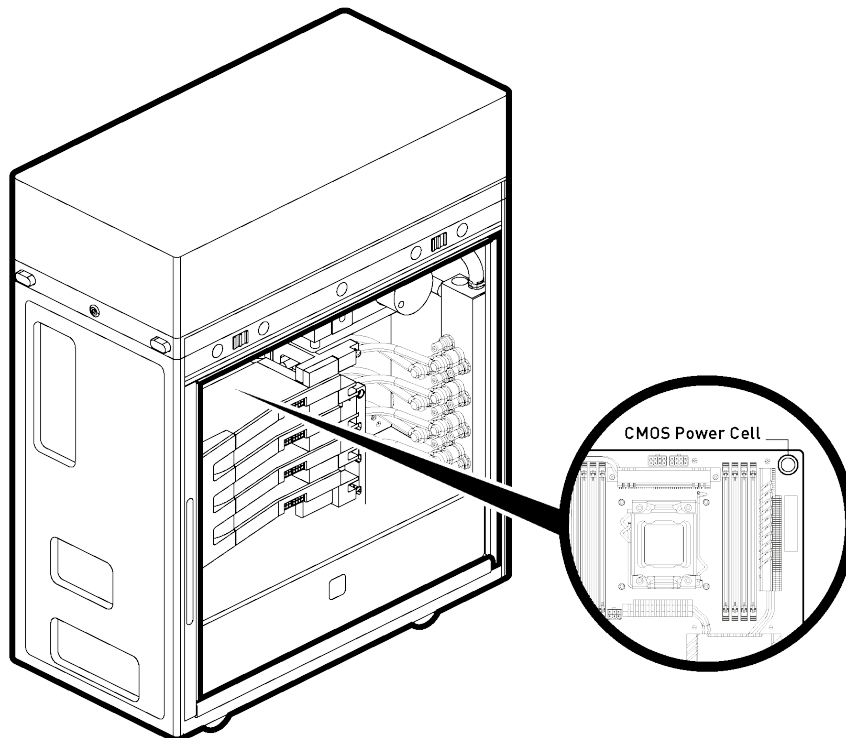

- a) Carefully insert the blade of the small flat head screwdriver between the motherboard and the CMOS power cell.
- b) Use the small flat head screwdriver to pry the CMOS power cell from the motherboard.

Do **not** dispose of the old CMOS power cell in municipal waste.

4. Carefully align the replacement CR2032 CMOS power cell in the receptacle on the motherboard with the + sign facing you and press it into position.
5. Replace the side panel of the DGX Station.
 - a) Align the bottom edge of the side panel with the bottom edge of the DGX Station.

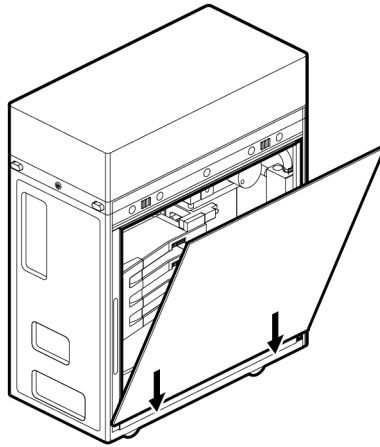

- b) Firmly push the panel back into place to re-engage the latch.

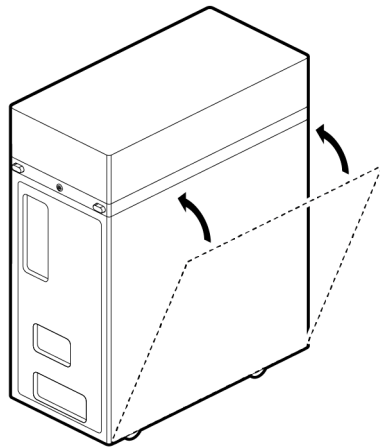

6. Reconnect the network and power cables and power on the DGX Station. The DGX Station stops at its power-on self-test (POST) and then shuts down.
7. After the DGX Station shuts down, power it on again. When powered on a second time, the DGX Station starts up normally.

8. If necessary, set the system date and system time to the current time and date.
 - a) At the first NVIDIA screen to appear while the system is rebooting, press **F2** to access the **UEFI BIOS Utility - EZ Mode** screen.
 - b) Click the date and time displayed in the top left corner of the **UEFI BIOS Utility - EZ Mode** screen.

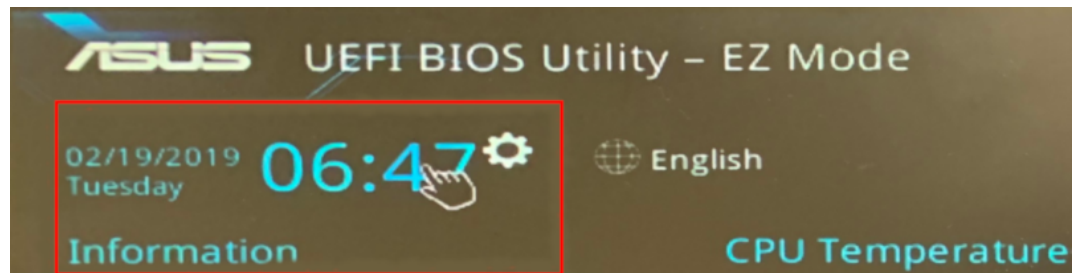

- c) In the **System Date & Time setting** screen that pops up, fill in the current date and time and click **Save**.

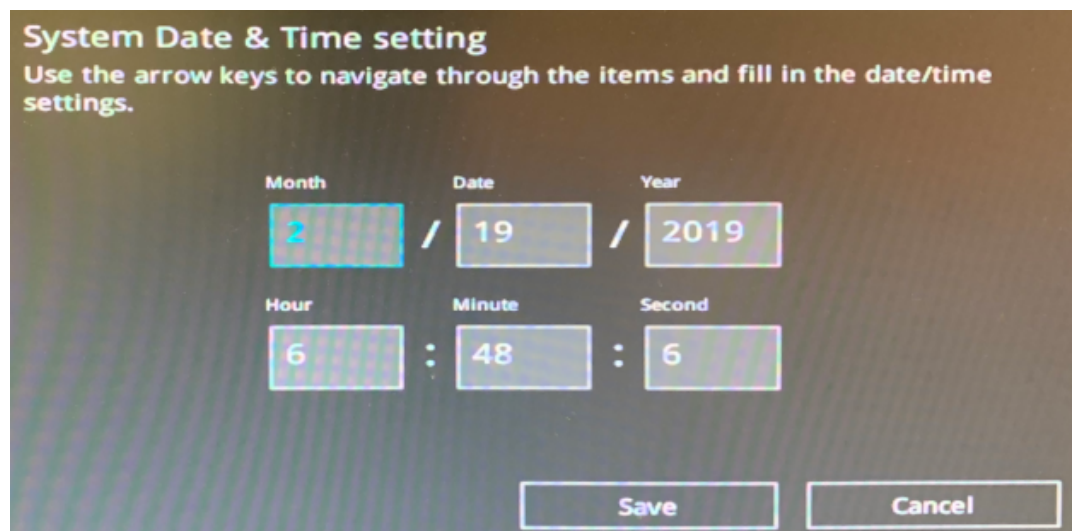

- d) Press **F10** and, when prompted, select **OK** to save your changes and exit.

4.6. Maintaining the DGX Station Persistent Storage

The DGX Station persistent storage consists of SSDs for data storage and the operating system. As supplied from the factory, these SSDs are configured as described in [System Memory and Storage](#).

4.6.1. Changing the RAID Level of the RAID Array

Before changing the RAID level of the RAID array, back up all data on the array that you want to preserve. Changing the RAID level of the RAID array erases all data stored on the array.

The software includes the custom script `configure_raid_array.py`, which you can use to change the level of the RAID array without unmounting the RAID volume.

- To change the RAID level to RAID 5, run the following command:

```
$ sudo configure_raid_array.py -m raid5
```



After you change the RAID level to RAID 5, the RAID array is rebuilt. A RAID array that is being rebuilt is online and ready to be used, but a check on the health of the reports the status of the RAID volume as unhealthy. Therefore, avoid checking the health of the while the RAID array is being rebuilt. For more information, see [Checking the Health of the](#).

The time required to rebuild the RAID array depends on the workload on the system. On an idle system, the rebuild might be complete within 30 minutes.

- To change the RAID level to RAID 0, run the following command:

```
$ sudo configure_raid_array.py -m raid0
```

To confirm that the RAID level was changed as required, run the `lsblk` command. The entry in the **TYPE** column for each SSD in the RAID array indicates the RAID level of the array.

The following example shows that the RAID level of the array is RAID 0. The name of the RAID volume is **md0** and the mount point of the volume is `/raid`.

```
~$ lsblk
NAME        MAJ:MIN RM  SIZE RO TYPE  MOUNTPOINT
sda          8:0    0  1.8T  0 disk
├─sda1       8:1    0   487M  0 part  /boot/efi
├─sda2       8:2    0  1.8T  0 part  /
sdb          8:16   0  1.8T  0 disk
├─md0        9:0    0   5.2T  0 raid0 /raid
sdc          8:32   0  1.8T  0 disk
├─md0        9:0    0   5.2T  0 raid0 /raid
sdd          8:48   0  1.8T  0 disk
├─md0        9:0    0   5.2T  0 raid0 /raid
```

4.6.2. Checking the Status of the DGX Station RAID Array

Use the `mdadm` command to print details of the **md0** device.

```
$ sudo mdadm -D /dev/md0
```

This example shows the status of a RAID array that is functioning properly.

```
$ sudo mdadm -D /dev/md0
Version : 1.2
```



```

Creation Time : Mon Jun  5 17:40:48 2017
Raid Level : raid0
Array Size : 374964224 (357.59 GiB 383.96 GB)
Raid Devices : 3
Total Devices : 3
Persistence : Superblock is persistent

Update Time : Mon Jun  5 17:40:48 2017
State : clean
Active Devices : 3
Working Devices : 3
Failed Devices : 0
Spare Devices : 0

Chunk Size : 512K
Name : lab-VirtualBox:0 (local to host lab-VirtualBox)
UUID : c8ba911a:8634bd99:2eb3ea3d:c9a7db4c
Events : 0

Number    Major    Minor    RaidDevice State
  0         8       16         0      active sync  /dev/sdb
  1         8       32         1      active sync  /dev/sdc
  2         8       48         2      active sync  /dev/sdd

```

This example shows the status of a RAID array in which one SSD has failed or is missing. The failed or missing SSD is identified by the empty **RaidDevice State** column.

```
$ sudo mdadm -D /dev/md0
```

```
...
```

```

Number    Major    Minor    RaidDevice State
  0         8       16         0      active sync  /dev/sdb
  1         8       32         1      active sync  /dev/sdc
  2         8       48         2      active sync  /dev/sdd

```

4.6.3. Checking the Status of the DGX Station SSDs

LEDs on the DGX Station SSDs indicate the status of the SSDs. The SSDs are mounted inside the DGX Station and are visible only when the side panel that covers the SSDs is removed.

1. Remove the side panel on the left of the DGX Station when viewed from the rear.
 - a) Push the button on the left side of the DGX Station back panel to release the panel.
 - b) Lift the panel to remove it.



Caution To prevent damage from electrostatic discharge, avoid touching any of the components inside the DGX Station other than any components that you are replacing or servicing.

2. Examine each SSD to determine its status from the state of the LED on the SSD.

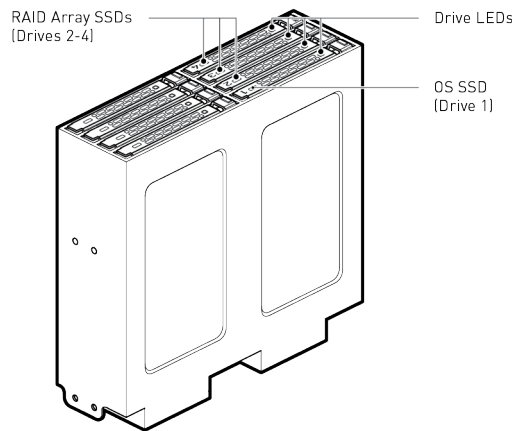
**On (steady)**

The SSD is operational but is idle.

On (blinking)

The SSD is being read from or written to.

Off

The SSD has failed and must be replaced.

3. Replace the side panel of the DGX Station.
 - a) Align the bottom edge of the side panel with the bottom edge of the DGX Station.
 - b) Firmly push the panel back into place to re-engage the latches.

If an SSD has failed, you must replace it as explained in [Replacing an SSD](#).

4.6.4. Replacing an SSD

If an SSD in the DGX Station fails, replace the SSD to return the system to operation.



Caution The default RAID level of the array in the DGX Station is RAID 0, which does not provide any redundancy. If a single SSD in the array fails, all data stored on the array is lost. To prevent the failure of an SSD from causing a loss of data, ensure that any data on the array that you want to preserve is backed up.

1. Remove the side panel on the left of the DGX Station when viewed from the rear.
 - a) Push the button on the left side of the DGX Station back panel to release the panel.
 - b) Lift the panel to remove it.



Caution To prevent damage from electrostatic discharge, avoid touching any of the components inside the DGX Station other than any components that you are replacing or servicing.

2. On the SSD that you want to replace, press the drive-tray eject button to loosen the drive-tray latch.

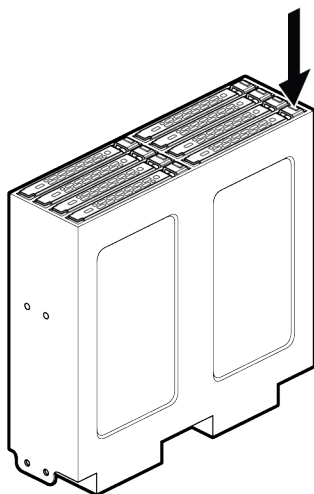

3. Pull the drive-tray latch upwards to unseat the drive tray.

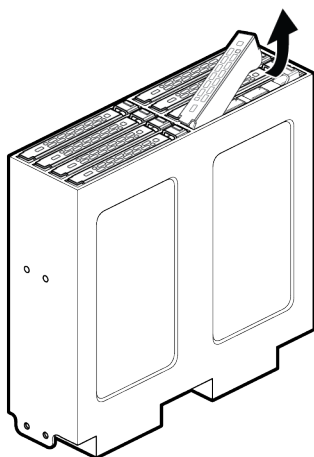

4. Slide the drive tray upwards to completely remove it from the unit.

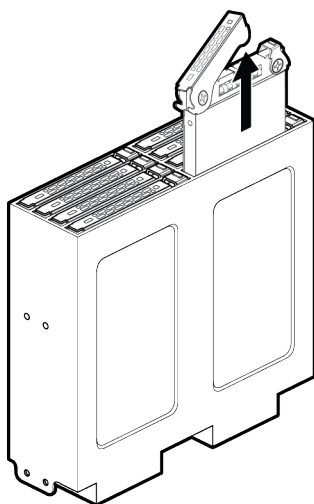

5. Using a Phillips screwdriver, remove the four screws attaching the SSD to the drive tray.

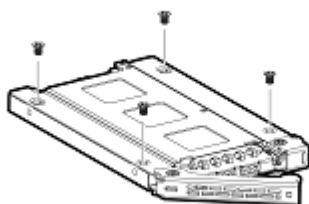

Save the screws for the replacement SSD.

6. Slide the SSD out of the drive tray.
7. Slide the replacement SSD into the drive tray.

Make sure that the connector is on the open edge side of the tray.

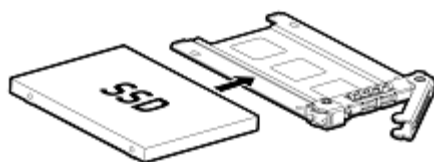

8. Secure the replacement SSD to the drive tray using the four screws.

9. With the drive-tray eject button at the right, insert the drive tray into the appropriate drive bay, then slide the drive tray all the way into the drive bay.

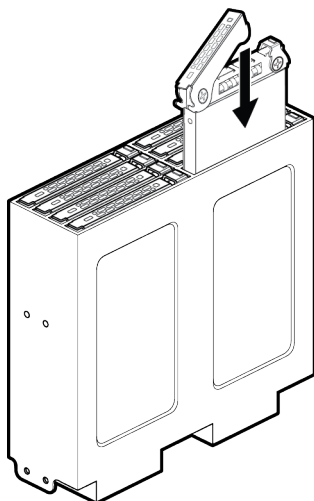

10. Press the drive-tray latch downwards until you hear a click to completely seat the drive tray.

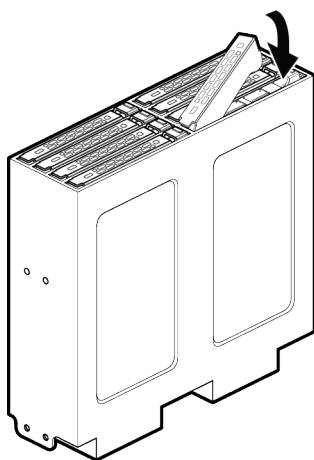

11. Replace the side panel of the DGX Station.
 - a) Align the bottom edge of the side panel with the bottom edge of the DGX Station.
 - b) Firmly push the panel back into place to re-engage the latches.

What you need to do to return the DGX Station to service depends on whether you replaced an SSD in the RAID array the OS SSD.

- ▶ If you replaced an SSD in the RAID array, rebuild the RAID array as explained in [Rebuilding the RAID Array](#).
- ▶ If you replaced the OS SSD, restore the software image as explained in [Restoring the DGX Station Software Image](#).

4.6.5. Rebuilding the RAID Array

If the RAID array is degraded because an SSD failed, replace the SSD as explained in .

After replacing a failed SSD in the RAID array, you must rebuild the array to add the new SSD to a RAID 0 array or to regenerate the lost data on the new SSD in a RAID 5 array. The software includes the custom script `configure RAID array.py` for this purpose.

To rebuild the array, run the following command:

```
$ sudo configure RAID array.py -r
```



The time required to rebuild a RAID 5 array depends on factors such as system load, SSD capacity, and the number of SSDs in the array. Rebuilding the array of three 1.92-terabyte SSDs in the may require several hours.

You can monitor the progress of a long-running rebuild by examining the contents of the `/proc/mdstat` file:

```
$ cat /proc/mdstat
Personalities : [raid0] [linear] [multipath] [raid1] [raid6] [raid5] [raid4]
[raid10]
md0 : active raid5 sdb[0] sdd[3] sdc[1]
      3750486016 blocks super 1.2 level 5, 512k chunk, algorithm 2 [3/2] [UU_]
      [>.....] recovery = 4.0% (75580956/1875243008)
      finish=438.3min speed=68419K/sec
      bitmap: 2/14 pages [8KB], 65536KB chunk

unused devices: <none>
```

In this example, the rebuild is 4.0% complete and the rebuild is estimated to finish in 438.3 minutes.

The RAID array is rebuilt with its existing RAID level.

- ▶ If the array is a RAID 0 array, all data that was on the array is erased after array is rebuilt.
- ▶ If the array is a RAID 5 array, the data on the array is preserved after array is rebuilt.

If you have rebuilt a RAID 0 array and have a backup of data on the array that you want to preserve, restore the data from the backup.

4.6.6. Configuring the SSDs for Data Storage as an NFS Cache

As supplied from the factory, the SSDs in the DGX Station for data storage are configured for local persistent storage. If your application data is stored in remote NFS-mounted file systems, you can improve application performance by configuring the data SSDs as an NFS cache and configuring the NFS-mounted file systems to use this cache.

If any data that you want to preserve is stored on the SSDs for data storage, move this data to another file system.

1. Optional: If the SSDs in the DGX Station for data storage are configured in a RAID 5 array, change the RAID level of the array to RAID 0.

```
$ sudo configure RAID array.py -m raid0
```

Because cache data is volatile, you can use the full capacity of the RAID array without redundancy and not risk loss of any persistent data.

2. Download information from all configured sources about the latest versions of the packages.

```
$ sudo apt update
```

3. Install the **cachefilesd** package, which contains the cache daemon and its associated files, such as the startup and configuration files.

```
$ sudo apt install cachefilesd
```

4. Enable the cache daemon to run.

- a) In a plain text editor such as **vi**, **nano**, or **gedit**, open the file `/etc/default/cachefilesd` with **sudo** user privileges.

For example:

```
$ sudo vi /etc/default/cachefilesd
```

- b) Uncomment the **RUN=yes** line.
- c) Save your changes and quit the editor.

5. Configure the cache daemon by editing the cache daemon configuration file.

- a) In a plain text editor such as **vi**, **nano**, or **gedit**, open the file `/etc/cachefilesd.conf` with **sudo** user privileges.

For example:

```
$ sudo vi /etc/cachefilesd.conf
```

- b) Set the cache directory to `/raid` and the FS-Cache tag to **dgxcache**.

```
dir /raid
tag dgxcache
```

- c) Set the culling limits to values that are optimized for deep learning workloads and provide the fastest throughput for training from large datasets.

```
brun 25%
bcull 15%
bstop 5%
frun 10%
```

```
fcull 7%
fstop 3%
```

d) Save your changes and quit the editor.

For information about all the options that you can set in this file, see the [etc/cachefilesd.conf](http://manpages.ubuntu.com/manpages/bionic/man5/cachefilesd.conf.5.html) (<http://manpages.ubuntu.com/manpages/bionic/man5/cachefilesd.conf.5.html>) man page.

This example shows a complete `/etc/cachefilesd.conf` file for configuring the cache daemon for the DGX Station. The LSM security context is the default security context of the `cachefilesd` daemon.

```
#####
#
# Copyright (C) 2006,2010 Red Hat, Inc. All Rights Reserved.
# Written by David Howells (dhowells@redhat.com)
#
# This program is free software; you can redistribute it and/or
# modify it under the terms of the GNU General Public License
# as published by the Free Software Foundation; either version
# 2 of the License, or (at your option) any later version.
#
#####

dir /raid
tag dgxcache
brun 25%
bcull 15%
bstop 5%
frun 10%
fcull 7%
fstop 3%

# Assuming you're using SELinux with the default security policy included in
# this package
secctx system_u:system_r:cachefiles_kernel_t:s0
```

6. Start the cache daemon.

```
$ sudo systemctl start cachefilesd
```

7. Confirm that the cache daemon started properly.

```
$ sudo systemctl status cachefilesd
● cachefilesd.service - LSB: CacheFiles daemon
   Loaded: loaded (/etc/init.d/cachefilesd; generated)
   Active: active (running) since Thu 2020-01-30 18:05:39 PST; 13s ago
     Docs: man:systemd-sysv-generator(8)
  Process: 3973 ExecStop=/etc/init.d/cachefilesd stop (code=exited,
 status=0/SUCCESS)
  Process: 4014 ExecStart=/etc/init.d/cachefilesd start (code=exited,
 status=0/SUCCESS)
    Tasks: 1 (limit: 4915)
   CGroup: /system.slice/cachefilesd.service
           └─4041 /sbin/cachefilesd

Jan 30 18:05:39 mydgxstation systemd[1]: Starting LSB: CacheFiles daemon.
Jan 30 18:05:39 mydgxstation cachefilesd[4014]: * Starting FilesCache
 daemon cachefilesd
Jan 30 18:05:39 mydgxstation cachefilesd[4039]: About to bind cache
Jan 30 18:05:39 mydgxstation cachefilesd[4039]: Bound cache
Jan 30 18:05:39 mydgxstation cachefilesd[4041]: Daemon Started
Jan 30 18:05:39 mydgxstation cachefilesd[4014]: ...done.
Jan 30 18:05:39 mydgxstation systemd[1]: Started LSB: CacheFiles daemon.
```

8. Press **Ctrl+C** to return to the shell prompt.

After configuring the SSDs for data storage as an NFS cache, ensure that the mount option **fsc** is set for all NFS-mounted file systems that you want to use the cache.

This example shows an entry in `/etc/fstab` for mounting a file system for which the **fsc** option is set.

```
myfileserv.example.com:/mnt/shares/dldata /var/local/dldata nfs
rw,noatime,rsize=32768,wsiz=32768,nolock,tcp,intr,fsc,nofail 0 0
```

4.6.7. Sanitizing the DGX Station Persistent Storage

Sanitizing the DGX Station persistent storage permanently destroys all the data that was stored there. After the data is destroyed, it cannot be recovered. Sanitizing the DGX Station persistent storage involves sanitizing **all** the SSDs for data storage **and** the SSD for the operating system.

Deleting all files in the DGX Station persistent storage or reformatting all the DGX Station SSDs does **not** sanitize the DGX Station persistent storage because data that was stored there can still be recovered by data-recovery tools.

Before sanitizing the DGX Station persistent storage, prepare the following bootable installation media:

- ▶ A bootable installation medium that contains the Ubuntu Desktop OS LiveCD image. See [Preparing your LiveCD \(https://help.ubuntu.com/community/LiveCD#Preparing_your_LiveCD\)](https://help.ubuntu.com/community/LiveCD#Preparing_your_LiveCD) on the Ubuntu Community Help Wiki.

You'll need this installation medium to run an Ubuntu Desktop LiveCD session on the DGX Station.

- ▶ A bootable installation medium that contains the current DGX OS Desktop image. See:

- ▶ [Obtaining the DGX Station Software ISO Image and Checksum File](#)
- ▶ [Creating a Bootable Installation Medium](#)

You'll need this installation medium to return the DGX Station to service after sanitizing its persistent storage.

4.6.7.1. Running an Ubuntu Desktop LiveCD Session on the DGX Station

To be able to sanitize the OS SSD, you must run an Ubuntu Desktop LiveCD session on the DGX Station from a bootable installation medium, such as a USB flash drive or DVD-ROM. You must use the Ubuntu Desktop OS instead of DGX OS Desktop because you must run the OS without installing it and DGX OS Desktop lacks this option.

To complete this task, you need a bootable installation medium, such as a USB flash drive or DVD-ROM, that contains the Ubuntu Desktop OS LiveCD image. For instructions, see [Preparing your LiveCD \(https://help.ubuntu.com/community/LiveCD#Preparing_your_LiveCD\)](https://help.ubuntu.com/community/LiveCD#Preparing_your_LiveCD) on the Ubuntu Community Help Wiki.

1. Shut down the DGX Station.

2. Load the USB flash drive or DVD-ROM into the DGX Station.
 - ▶ If you are using a USB flash drive, plug it into one of the USB ports of the DGX Station.
 - ▶ If you are using a DVD-ROM, connect an external optical drive to the DGX Station and load the DVD-ROM into the drive.
3. Power on the DGX Station.
4. At the first NVIDIA screen to appear, press **F8** to select the boot device.
5. In the menu for selecting the boot device, use the arrow keys to select **UEFI: usb-key-or-dvd-rom-name, Partition *n* (size)** and press **Enter**.
6. When the **GNU GRUB** menu appears, select **Try Ubuntu Without Installing** and press **Enter**.
You are logged in to the Ubuntu desktop.



The standard Ubuntu OS graphics drivers are incompatible with the NVIDIA Tesla V100 GPU cards in the DGX Station. As a result, the Ubuntu desktop might be incorrectly sized and applications might not accept input from the keyboard and mouse. Overcome this compatibility issue by switching to a text-only TTY session.

7. Press **Ctrl+Alt+F2** to switch to a text-only TTY session.
8. At the Ubuntu login prompt, log in as user **ubuntu**.
No password is required.

4.6.7.2. Sanitizing All DGX Station SSDs

Sanitize the DGX Station persistent storage by sanitizing **all** the SSDs for data storage **and** the SSD for the operating system. All SSDs that NVIDIA supplies with the DGX Station support the ATA `SANITIZE` command. Therefore, you can use the Ubuntu OS command `hdparm` to sanitize the DGX Station SSDs.

Ensure that you are running an Ubuntu Desktop LiveCD session on the DGX Station as explained in [Running an Ubuntu Desktop LiveCD Session on the DGX Station](#).

This task requires `sudo` privileges.

Perform this task in a text-only TTY session from the Ubuntu Desktop LiveCD session.

1. Obtain the device IDs of the SSDs by searching for the word `disk` in the output from the `lsblk` (<http://manpages.ubuntu.com/manpages/bionic/man8/lsblk.8.html>) command.

```
$ lsblk | grep disk
```

You can identify the SSDs from their size, which is much larger than the size of any removable media that might be connected to the DGX Station, such as the USB flash drive from which you are running the Ubuntu Desktop LiveCD session.

In the following example, the device IDs of the SSDs are `sda`, `sdb`, `sdc`, and `sdd`. The device ID `sde` is the device ID of a USB flash drive.

```
$ lsblk | grep disk
sda      8:0    0   1.8T    0 disk
```

```
sdb      8:16    0    1.8T  0 disk
sdc      8:32    0    1.8T  0 disk
sdd      8:48    0    1.8T  0 disk
sde      8:64    1    1.9G  0 disk /cdrom
```

2. Confirm that all the SSDs support the ATA `SANITIZE` command.

For each SSD, run the `hdparm` command with the `-I` option.

```
$ sudo hdparm -I /dev/device-id | grep SANIT
```

device-id

The device ID of the SSD, for example, `sdc`.

This example confirms that SSD `sdc` supports the ATA `SANITIZE` command. The asterisk (*) in the output from the `hdparm` command denotes support.

```
$ sudo hdparm -I /dev/sdc | grep SANIT
* SANITIZE_ANTI_FREEZE_LOCK_EXT command
* SANITIZE feature set
```

3. Issue the ATA `SANITIZE` command to all the SSDs.

For each SSD, run the `hdparm` command with the `--yes-i-know-what-i-am-doing` and `--sanitize-block-erase` options.

```
# sudo hdparm \
--yes-i-know-what-i-am-doing \
--sanitize-block-erase /dev/device-id
```

device-id

The device ID of the SSD, for example, `sdc`.

This example issues the ATA `SANITIZE` command to SSD `sdc`.

```
$ sudo hdparm \
--yes-i-know-what-i-am-doing \
--sanitize-block-erase /dev/sdc

/dev/sdc:
Issuing SANITIZE_BLOCK_ERASE command
Operation started in background
You may use `--sanitize-status` to check progress
```

Sanitizing a single SSD takes several minutes.

4. Check the status of the sanitization.

For each SSD, run the `hdparm` command with the `--sanitize-status` option repeatedly until sanitization of the SSD is completed without error.

```
$ sudo hdparm --sanitize-status /dev/device-id
```

device-id

The device ID of the SSD, for example, `sdc`.

This example shows that sanitization of SSD `sdc` is still in progress.

```
$ sudo hdparm --sanitize-status /dev/sdc

/dev/sdc:
Issuing SANITIZE_STATUS command
Sanitize status:
  State:      SD2 Sanitize operation In Process
```

```
Progress: 0x72aa (44%)
```

This example confirms that sanitization of SSD `sdc` was completed without error.

```
$ sudo hdparm --sanitize-status /dev/sdc

/dev/sdc:
Issuing SANITIZE_STATUS command
Sanitize status:
  State:      SD0 Sanitize Idle
  Last Sanitize Operation Completed Without Error
```

5. Shut down the DGX Station.

```
$ sudo shutdown -P now
```

6. When prompted by the Ubuntu Desktop OS, remove the installation medium and press **Enter**.

After sanitizing all the DGX Station SSDs, return the DGX Station to service by installing the DGX Station software and re-initializing the RAID array.

For instructions, see [Installing the DGX Station Software Image from a USB Flash Drive or DVD-ROM](#). When you are prompted for the option for installing the DGX Station software, select **Install DGX OS Desktop *release* and re-initialize RAID0 volume**.

After installing the DGX Station software and re-initializing the RAID array, you can change the RAID level of the RAID array to RAID 5 if necessary. For instructions, see [Changing the RAID Level of the RAID Array](#).

4.7. Restoring the DGX Station Software Image

If the DGX Station software image becomes corrupted or the OS SSD was replaced after a failure, restore the DGX Station software image to its original factory condition from a pristine copy of the image.

A USB flash drive is supplied from which you can restore the DGX Station software image. Before using this USB drive to restore the DGX Station software image, contact NVIDIA Enterprise Support to see if a later version of the software image is available. If a later version of the image is available, prepare a bootable installation medium that contains the current software image as explained in the following topics:

- ▶ [Obtaining the DGX Station Software ISO Image and Checksum File](#)
- ▶ [Creating a Bootable Installation Medium](#)

When you have a bootable installation medium that contains the current software image, install the image as explained in [Installing the DGX Station Software Image from a USB Flash Drive or DVD-ROM](#).



Updates to the DGX Station software might have been made available after the latest available ISO image file was created. To ensure that you have the latest DGX Station software, including security updates, check for updates and install any

available updates after you restore the software image. For more information, see [Upgrading Within the Same DGX OS Desktop Major Release](#).

4.7.1. Obtaining the DGX Station Software ISO Image and Checksum File

To ensure that you restore the latest available version of the DGX Station software image, obtain the current ISO image file from NVIDIA Enterprise Support. A checksum file is provided for the image to enable you to verify the bootable installation medium that you create from the image file.

1. Log on to the [NVIDIA Enterprise Support \(https://nvid.nvidia.com/dashboard/\)](https://nvid.nvidia.com/dashboard/) site.
2. Click the **Announcements** tab to locate the download links for the DGX Station software image.
3. Download the ISO image and its checksum file and save them to your local disk.
The ISO image is also available in an archive file. If you download the archive file, be sure to extract the ISO image before proceeding.

4.7.2. Creating a Bootable Installation Medium

After obtaining an ISO file that contains the DGX OS Desktop software image from NVIDIA Enterprise Support, create a bootable installation medium, such as a USB flash drive or DVD-ROM, that contains the image.

- ▶ If you are creating a bootable USB flash drive, follow the instructions for the platform that you are using:
 - ▶ On Ubuntu Desktop, see [Creating a Bootable USB Flash Drive by Using Startup Disk Creator](#).
 - ▶ On Windows, see [Creating a Bootable USB Flash Drive by Using Akeo Rufus](#).
- ▶ If you are creating a bootable DVD-ROM, you can use any of the methods described in [Burning the ISO on to a DVD \(https://help.ubuntu.com/community/BurningIsoHowto#Burning_the_ISO_on_to_a_DVD\)](https://help.ubuntu.com/community/BurningIsoHowto#Burning_the_ISO_on_to_a_DVD) on the Ubuntu Community Help Wiki.



The ISO file that contains software image for some DGX OS Desktop releases is greater than the 4.7 GB capacity of a single-layer DVD-ROM. You cannot install these releases from a bootable DVD-ROM because installation of DGX OS Desktop from a dual-layer DVD-ROM is **not** supported. Check the size of the ISO file that contains the DGX OS Desktop software image before creating a bootable DVD-ROM.

4.7.2.1. Creating a Bootable USB Flash Drive by Using Startup Disk Creator

On an Ubuntu Desktop system, you can use **Startup Disk Creator** to create a bootable USB flash drive that contains the DGX Station software image.

Ensure that the following prerequisites are met:

- ▶ The correct DGX Station software image is saved to your local disk. For more information, see [Obtaining the DGX Station Software ISO Image and Checksum File](#).
 - ▶ The USB flash drive has a capacity of at least 8 GB.
1. Plug the USB flash drive into one of the USB ports of your Ubuntu Desktop system.
 2. Search for **Startup Disk Creator**.
 - ▶ **Ubuntu 18.04 Desktop:** Open **Activities** overview, and in the search box, type **Startup Disk Creator**.
 - ▶ **Ubuntu 16.04 Desktop:** Open the **Dash**, and in the search box, type **Startup Disk Creator**.
 3. Click the **Startup Disk Creator** icon.
 4. In the **Make Startup Disk** window that opens, from the **Source disc image (.iso)** list, select the DGX Station software image file.

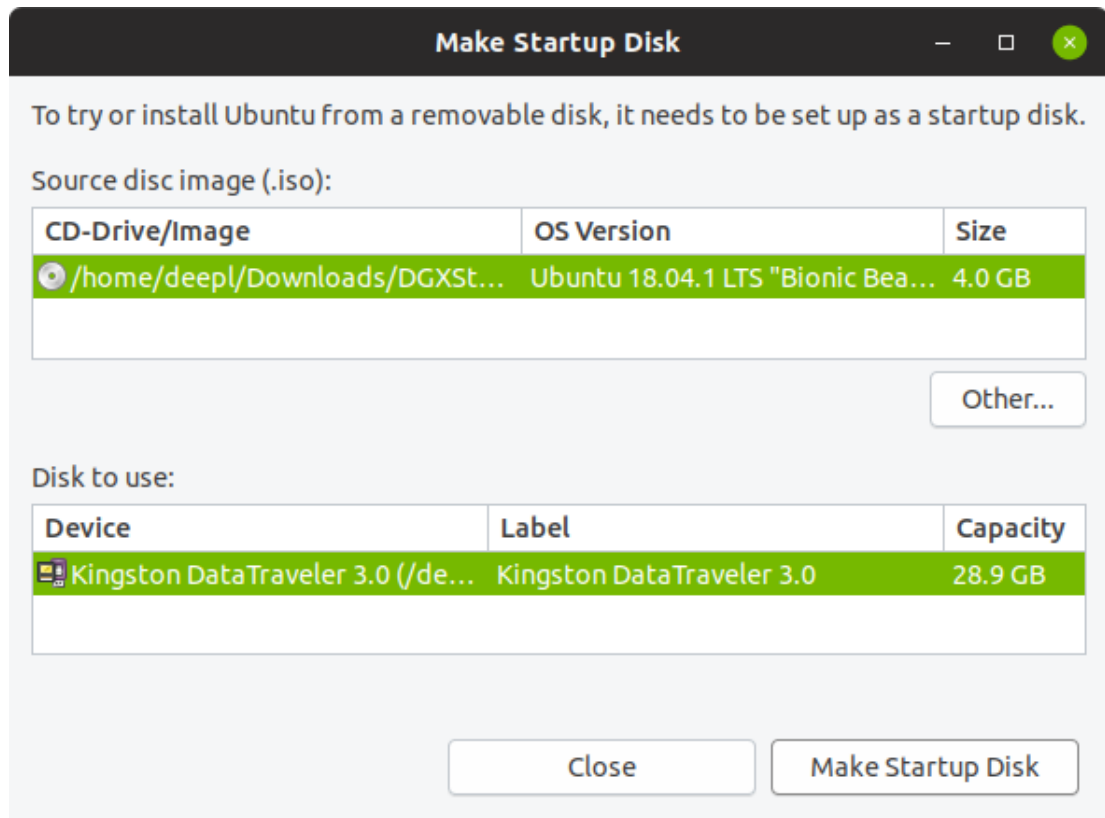

If the DGX Station software image file is not listed, click **Other** and in the window that opens, navigate to the file, select the file, and click **Open**.

5. From the **Disk to use** list, select the USB flash drive and click **Make Startup Disk**.

4.7.2.2. Creating a Bootable USB Flash Drive by Using Akeo Rufus

On a Windows system, you can use the [Akeo Reliable USB Formatting Utility \(Rufus\)](https://rufus.akeo.ie/) (<https://rufus.akeo.ie/>) to create a bootable USB flash drive that contains the DGX Station software image.

Ensure that the following prerequisites are met:

- ▶ The correct DGX Station software image is saved to your local disk. For more information, see [Obtaining the DGX Station Software ISO Image and Checksum File](#).
 - ▶ The USB flash drive has a capacity of at least 8 GB.
1. Plug the USB flash drive into one of the USB ports of your Windows system.
 2. Download and launch the [Akeo Reliable USB Formatting Utility \(Rufus\)](https://rufus.akeo.ie/) (<https://rufus.akeo.ie/>).

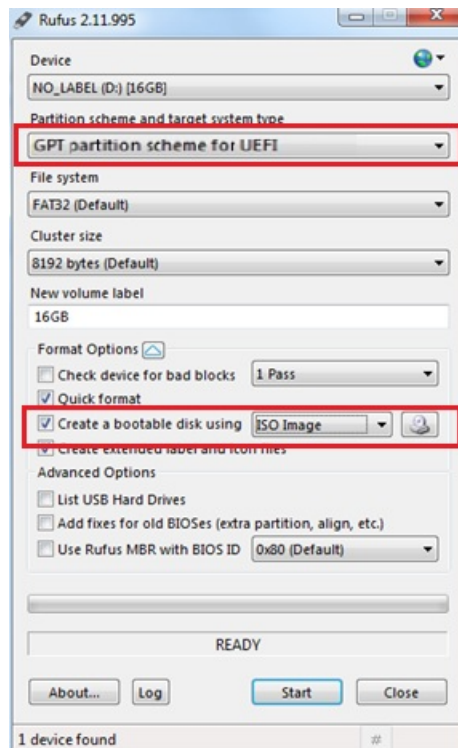

3. Under **Partition scheme and target system type**, select **GPT partition scheme for UEFI**.
4. Select the **Create a bootable disk using** option and from the dropdown menu, select **ISO image**.
5. Click the optical drive icon and open the DGX Station software ISO image.

6. Click **Start**.

Because the image is a hybrid ISO file, you are prompted to select whether to write the image in ISO Image (file copy) mode or DD Image (disk image) mode.

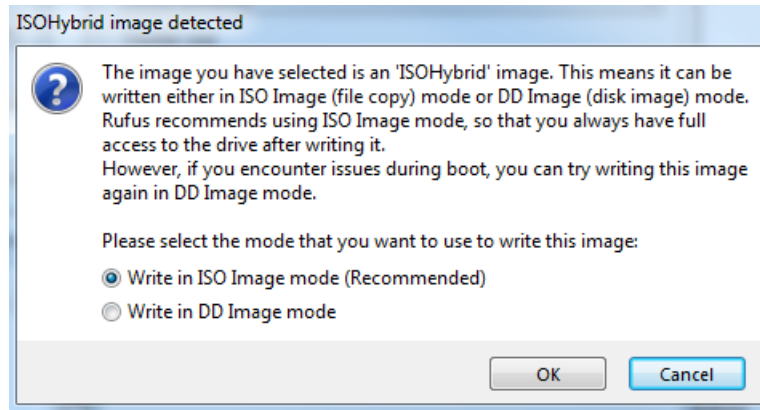

7. Select **Write in ISO Image mode** and click **OK**.

4.7.3. Verifying the Bootable Installation Medium

On a Linux system, you can use the checksum file provided for the DGX Station software image to verify the installation medium that you created from the image.

Ensure that the following prerequisites are met:

- ▶ The checksum file for the DGX Station software image is saved to your local disk. For more information, see [Obtaining the DGX Station Software ISO Image and Checksum File](#).
- ▶ You have created a bootable installation medium from the image. For more information, see [Creating a Bootable Installation Medium](#).

How to verify a bootable installation medium depends on whether it is a USB flash drive or a DVD-ROM.

4.7.3.1. Verifying a Bootable USB Flash Drive

1. Plug the USB flash drive into one of the USB ports of your Linux system.
2. Obtain the device ID of the USB flash drive by running the `lsblk` (<http://manpages.ubuntu.com/manpages/bionic/man8/lsblk.8.html>) command.

```
$ lsblk
```

You can identify the USB flash drive from its size, which is much smaller than the size of the SSDs in the DGX Station, and from the mount points of any partitions on the drive, which are under `/media`.

In the following example, the device ID of the USB flash drive is **sde1**.

```
$ lsblk
NAME MAJ:MIN RM SIZE RO TYPE MOUNTPOINT
```



```

sda      8:0    0  1.8T  0 disk
|_sda1   8:1    0  487M  0 part  /boot/efi
|_sda2   8:2    0  1.8T  0 part  /
sdb      8:16   0  1.8T  0 disk
|_md0    9:0    0  5.2T  0 raid0  /raid
sdc      8:32   0  1.8T  0 disk
|_md0    9:0    0  5.2T  0 raid0  /raid
sdd      8:48   0  1.8T  0 disk
|_md0    9:0    0  5.2T  0 raid0  /raid
sde      8:64   1  3.7G  0 disk
|_sde1   8:65   1  3.2G  0 part  /media/deepl/DGXSTATION
|_sde2   8:66   1  2.3M  0 part
$

```

3. Compute the checksum of the image on the USB flash drive.

```
$ sudo dd if=device-id bs=block-size | cksum
```

device-id

The device ID of the USB flash drive, for example, **/dev/sde1**.

block-size

The block size to be used by the dd command, for example, **1M**.

This example computes the checksum of an image on the USB flash drive with device ID **/dev/sde1** using a block size of 1 MB.

```

$ sudo dd if=/dev/sde1 bs=1M | cksum
3299+1 records in
3299+1 records out
3459317760 bytes (3.5 GB, 3.2 GiB) copied, 164.369 s, 21.0 MB/s
3992706625 3459317760

```

4. Obtain the checksum value from the checksum file.

```
$ cat checksum-file
```

checksum-file

The path, including the file name, to the checksum file.

This example obtains the checksum value for the image DGXStation-3.1.2_56d4a9.iso from the checksum file DGXStation-3.1.2_56d4a9.crc in the current working directory.

```

$ cat DGXStation-3.1.2_56d4a9.crc
3992706625 3459317760 DGXStation-3.1.2_56d4a9.iso

```

If the value obtained from the checksum file matches the value computed from the image, the integrity of the installation medium has been successfully verified.

4.7.3.2. Verifying a Bootable DVD-ROM

1. Load the DVD-ROM into an optical drive connected to your Linux system.
2. Compute the checksum of the image on the DVD-ROM.

```
$ cksum < /dev/sr0
```

This example computes the checksum of an image on a DVD-ROM.

```

$ cksum < /dev/sr0
3992706625 3459317760

```

3. Obtain the checksum value from the checksum file.

```
$ cat checksum-file
```

checksum-file

The path, including the file name, to the checksum file.

This example obtains the checksum value for the image `DGXStation-3.1.2_56d4a9.iso` from the checksum file `DGXStation-3.1.2_56d4a9.crc` in the current working directory.

```
$ cat DGXStation-3.1.2_56d4a9.crc
3992706625 3459317760 DGXStation-3.1.2_56d4a9.iso
```

If the value obtained from the checksum file matches the value computed from the image, the integrity of the installation medium has been successfully verified.

4.7.4. Installing the DGX Station Software Image from a USB Flash Drive or DVD-ROM

Before installing the DGX Station software image, ensure that you have a bootable USB flash drive or DVD-ROM that contains the current DGX Station software image.



Caution Installing the DGX Station software image erases all data stored on the OS SSD. The `/home` partition, where all users' documents, software settings, bookmarks, and other personal files are stored, resides on the OS SSD and will be erased. However, if you chose to install the DGX Station software and preserve the RAID array contents, persistent data stored in the RAID array is unaffected.

1. Shut down the DGX Station.
2. Load the USB flash drive or DVD-ROM into the DGX Station.
 - ▶ If you are using a USB flash drive, plug it into one of the USB ports of the DGX Station.
 - ▶ If you are using a DVD-ROM, connect an external optical drive to the DGX Station and load the DVD-ROM into the drive.
3. Power on the DGX Station.
4. At the first NVIDIA screen to appear, press **F8** to select the boot device.
5. In the menu for selecting the boot device, use the arrow keys to select **UEFI: usb-key-or-dvd-rom-name, Partition n (size)** and press **Enter**.
6. When the **GNU GRUB** menu appears, select the option you want for installing the DGX Station software and press **Enter**.
 - ▶ To install the software while preserving persistent data stored in the RAID array, select **Install DGX OS Desktop release and preserve RAID contents**.

- To install the software and re-initialize the RAID array, select **Install DGX OS Desktop *release* and re-initialize RAID0 volume**.



Caution If you chose this option, all data stored in the RAID array will be erased.

The installation requires several minutes to complete.



Licensing requirements prevent some DGX Station software, such as the NVIDIA Graphics Drivers, from being supplied in the software image. The DGX Station automatically installs this software when installation from the software image is complete.

7. When the installation is complete, respond to the prompts to accept end user license agreements for NVIDIA software and to configure the Ubuntu OS, including creating your user name and password for logging in to the DGX Station.
8. After the Ubuntu OS configuration is complete, log in to the DGX Station to access your Ubuntu desktop.
9. Eject the USB flash drive or DVD-ROM.
10. Unplug the USB flash drive or optical drive from the DGX Station.

4.8. Updating the DGX Station System BIOS

If you need to update the DGX Station system BIOS, you can obtain the current version of it from NVIDIA Support Enterprise Services.



Caution

Update the system BIOS **only** if required to resolve an issue with the DGX Station or if you are directed to by NVIDIA Support Enterprise Services to address a specific issue. If your DGX Station is operating normally and you have not been directed by NVIDIA Support Enterprise Services, do **not** update the system BIOS. An error during an attempt to update the system BIOS may leave your DGX Station unable to boot.

If you must update the system BIOS, be sure to obtain the BIOS file from NVIDIA Support Enterprise Services. Do not obtain a BIOS file from the motherboard manufacturer or any other source.

To complete this task, you need a USB flash drive formatted to a single FAT 16 or FAT 32 partition.

1. Obtain the system BIOS file.
 - a) Log on to [NVIDIA Enterprise Support \(https://nvid.nvidia.com/dashboard/\)](https://nvid.nvidia.com/dashboard/).
 - b) Click the **Announcements** tab to locate the download links for the archive file containing the DGX Station system BIOS file.
 - c) Download the archive file and extract the system BIOS file.

2. Copy the system BIOS file to the USB flash drive.
3. Shut down the DGX Station.
4. Plug the USB flash drive into one of the USB ports of the DGX Station.
5. Power on the DGX Station.
6. At the first NVIDIA screen to appear, press **Delete** or **F2** to enter the UEFI BIOS setup.
7. In the **UEFI BIOS Utility - EZ Mode** screen, click **Advanced Mode**.
8. From the **Tool** menu, choose **EZ 3 Flash Utility** and press **Enter**.
9. In the **EZ 3 Flash Update** screen, select **via Storage Device(s)** as the BIOS update method and press **Enter**.
10. In the **Drive** list, use the up arrow and down arrow keys to select the USB flash drive that contains the BIOS file and press **Enter**.
11. In the **Folder** list, use the up arrow and down arrow keys to select the BIOS file.
12. Press **Enter** to start the BIOS update process.



Caution To avoid the risk of leaving your DGX Station unable to boot, do **not** shut down or reset the DGX Station during the BIOS update process.

13. When the BIOS update process is complete, reboot the DGX Station.

4.9. Maintaining the GPU Liquid Cooling System

A liquid cooling system keeps the GPUs in the DGX Station within their required operating temperature range. To ensure reliable operation of the cooling system, you must maintain it periodically.

4.9.1. Monitoring GPU Temperatures

1. Search for **NVIDIA X Server Settings**.
 - ▶ **DGX OS Desktop 4 releases:** Open **Activities** overview, and in the search box, type **NVIDIA X Server Settings**.
 - ▶ **DGX OS Desktop 3 releases:** Open the **Dash**, and in the search box, type **NVIDIA X Server Settings**.
2. Click the **NVIDIA X Server Settings** icon.
3. Under each GPU in the list of GPUs in the **NVIDIA X Server Settings** window, click **Thermal Settings**.

Thermal sensor information for the GPU is displayed, including its current temperature and an indication of whether the temperature is within the GPU's operating range.

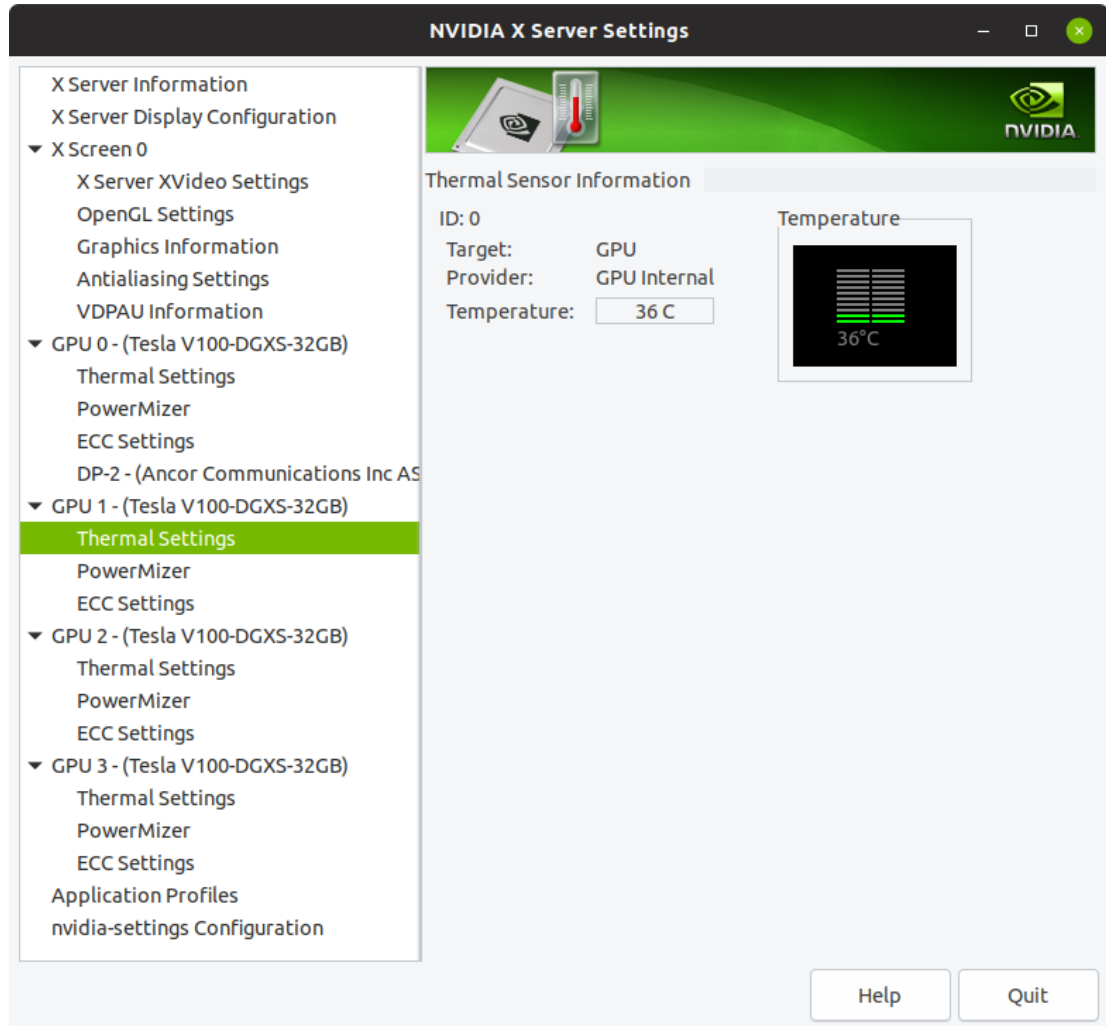

If the GPUs are running too hot, check the level of the liquid in the GPU cooling system as explained in [Checking the Level of the Liquid in the GPU Cooling System](#).

4.9.2. Checking the Level of the Liquid in the GPU Cooling System

In normal operation, some coolant liquid may be lost from system. Every 12 months, check the level of the liquid in the cooling system to ensure that it remains at the required level.

1. Remove the side panel on the right of the DGX Station when viewed from the rear.
 - a) Push the button on the right side of the DGX Station back panel to release the panel.

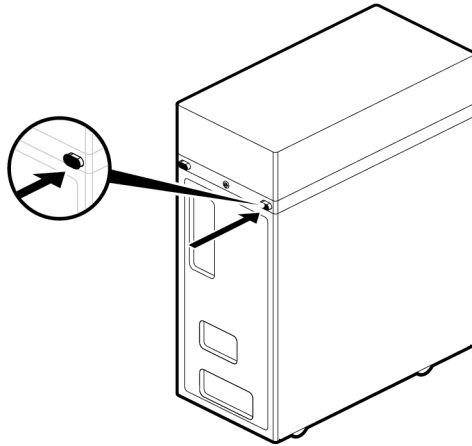

b) Lift the panel to remove it.

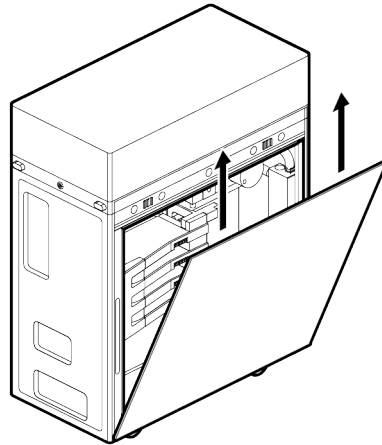

Caution To prevent damage from electrostatic discharge, avoid touching any of the components inside the DGX Station other than any components that you are replacing or servicing.

2. Look at the gauge on the side of the cooling system pump to determine the level of the liquid in the cooling system.

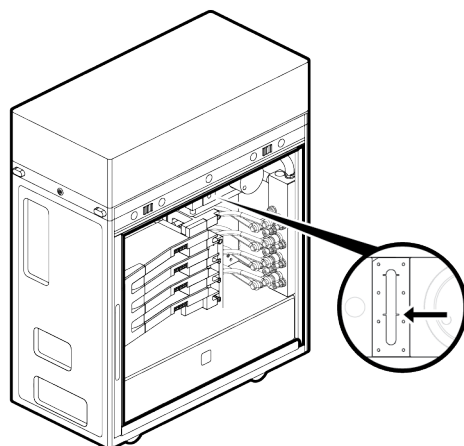

- ▶ If level of the liquid in the cooling system is at or above the Minimum Level in the reservoir, go to the next step.
 - ▶ If the liquid has fallen below the Minimum Level in the reservoir, replenish it as explained in [Replenishing the Liquid in the GPU Cooling System](#).
3. Replace the side panel of the DGX Station.
- a) Align the bottom edge of the side panel with the bottom edge of the DGX Station.

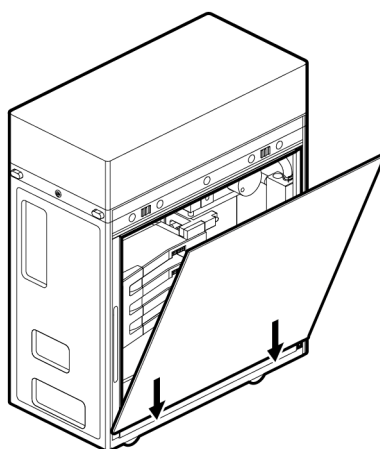

- b) Firmly push the panel back into place to re-engage the latch.

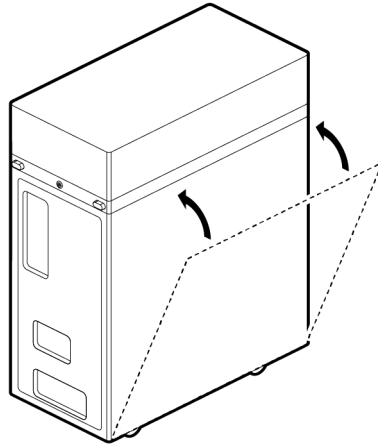

4.9.3. Replenishing the Liquid in the GPU Cooling System

Replenish the liquid in the GPU cooling system if the liquid is below the required level or to refill the cooling system after draining it to renew the cooling liquid.

Contact NVIDIA Enterprise Support to obtain a DGX Station coolant kit, which contains:

- ▶ 6 mm Allen wrench
- ▶ 1 bottle of EK-CryoFuel Clear Premix coolant



Caution Use **only** the coolant that is supplied with the kit. Do **not** use any other type of coolant. Use of other types of coolant will void the DGX Station hardware warranty and may cause damage to or impair the performance of the system.

- ▶ Flexible plastic filling bottle with delivery tube
- 1. Ensure that the DGX Station is powered off.
- 2. Fill the plastic filling bottle with the mixture.
- 3. Use the Torx T20 Allen wrench to loosen the filler cap at top of the cooling system pump and when the cap is loose, remove it.

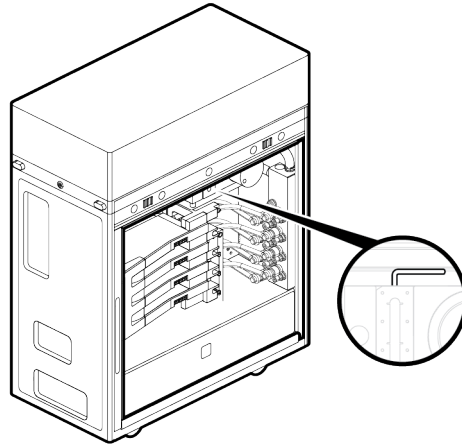

4. Insert the delivery tube of the filling bottle into the open filler cap at the top of the pump.
5. Gently squeeze the filler bottle to dispense the coolant liquid into the pump until the liquid reaches the Maximum Level in the reservoir.

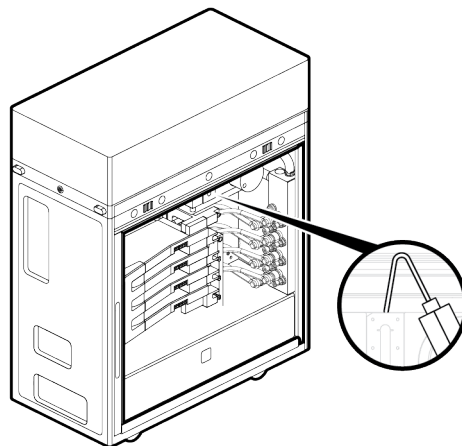

6. Replace the filler cap at top of the pump and use the Torx T20 Allen wrench to tighten the cap until it is finger tight.
Do **not** over tighten the filler cap.
7. Power on the DGX Station and let it run for one minute.
If the pump makes a grinding noise, power off and power on the DGX Station four times.
8. Ensure that the level of the liquid in the cooling system is at the Maximum Level in the reservoir.

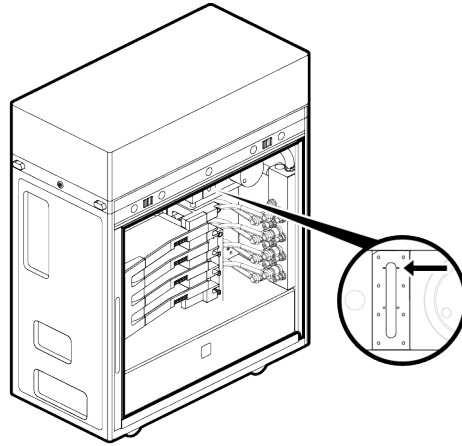

If the liquid has fallen below the Maximum Level in the reservoir, repeat the following sequence of steps until level of the liquid in the cooling system remains at the Maximum Level.

- a) Remove the filler cap at top of the cooling system pump.
 - b) Dispense more coolant liquid into the pump until the liquid reaches the Maximum Level in the reservoir again.
 - c) Replace the filler cap at top of the pump.
 - d) Power on the DGX Station and let it run for one minute.
 - e) Check the level of the liquid in the cooling system.
9. Power off the DGX Station.
 10. Replace the side panel of the DGX Station.
 - a) Align the bottom edge of the side panel with the bottom edge of the DGX Station.

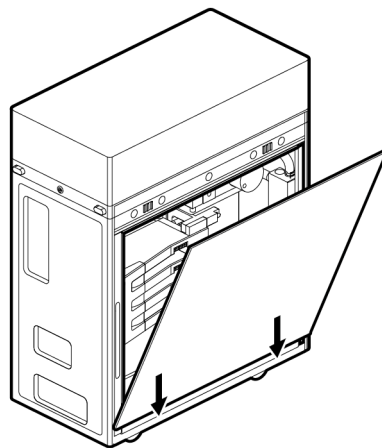

- b) Firmly push the panel back into place to re-engage the latch.

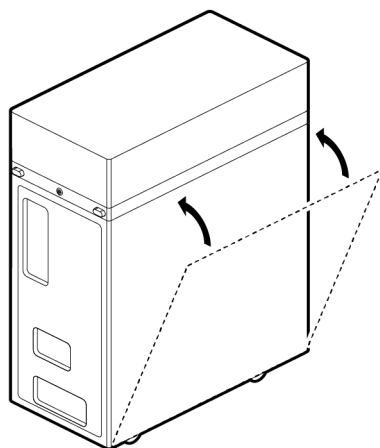

Appendix A.

SAFETY

To reduce the risk of bodily injury, electrical shock, fire, and equipment damage, read this document and observe all warnings and precautions in this guide before installing or maintaining your product. NVIDIA products are designed to operate safely when installed and used according to the product instructions and general safety practices. The guidelines included in this document explain the potential risks associated with computer operation and provide important safety practices designed to minimize these risks.

The product is designed and tested to meet IEC 60950-1, the Standard for the Safety of Information Technology Equipment. This also covers the national implementation of IEC 60950-1 based safety standards around the world, for example, UL 60950-1. These standards reduce the risk of injury from the following hazards:

- ▶ **Electric shock:** Hazardous voltage levels contained in parts of the product
- ▶ **Fire:** Overload, temperature, material flammability
- ▶ **Mechanical:** Sharp edges, moving parts, instability
- ▶ **Energy:** Circuits with high energy levels (240 volt amperes) or potential as burn hazards
- ▶ **Heat:** Accessible parts of the product at high temperatures
- ▶ **Chemical:** Chemical fumes and vapors
- ▶ **Radiation:** Noise, ionizing, laser, ultrasonic waves

Retain and follow all product safety and operating instructions. Always refer to the documentation supplied with your equipment. Observe all warnings on the product and in the operating instructions.



WARNING: FAILURE TO FOLLOW THESE SAFETY INSTRUCTIONS COULD RESULT IN FIRE, ELECTRIC SHOCK OR OTHER INJURY OR DAMAGE. ELECTRICAL EQUIPMENT CAN BE HAZARDOUS IF MISUSED. OPERATION OF THIS PRODUCT, OR SIMILAR PRODUCTS, MUST ALWAYS BE SUPERVISED BY AN ADULT. DO NOT ALLOW CHILDREN ACCESS TO THE INTERIOR OF ANY ELECTRICAL PRODUCT AND DO NOT PERMIT THEM TO HANDLE ANY CABLES.

A.1. Intended Application Uses

This product was evaluated as Information Technology Equipment (ITE), which may be installed in offices, schools, computer rooms, and similar commercial type locations. The suitability of this product for other product categories and environments (such as medical, industrial, residential, alarm systems, and test equipment), other than an ITE application, may require further evaluation.

A.2. General Precautions

To reduce the risk of personal injury or damage to the equipment:

- ▶ Shut down the product and disconnect all AC power cables before installation.
- ▶ Do not connect or disconnect any cables when performing installation, maintenance, or reconfiguration of this product during an electrical storm.
- ▶ Never turn on any equipment when there is evidence of fire, water, or structural damage.
- ▶ Place the product away from radiators, heat registers, stoves, amplifiers, or other products that produce heat.
- ▶ Never use the product in a wet location.
- ▶ Avoid inserting foreign objects through openings in the product.
- ▶ Do not use conductive tools that could bridge live parts.
- ▶ Do not make mechanical or electrical modifications to the equipment.
- ▶ Use the product only with approved equipment.
- ▶ Follow all cautions and instructions marked on the equipment. Do not attempt to defeat safety interlocks (where provided).
- ▶ Operate the DGX Station in a place where the temperature is always in the range 10°C to 30°C (50°F to 86°F).

A.3. Electrical Precautions

Power Cable

To reduce the risk of electric shock, fire, or damage to the equipment:

- ▶ Use only the supplied power cable and do not use this power cable with any other products or for any other purpose. Not all power cables have the same current ratings.
- ▶ Do not use household extension cables with your product. Household extension cables do not have overload protection and are not intended for use with computer systems.
- ▶ If you lose or damage the supplied power cable, or have to change the power cable for any reason, use a cable rated for your product and for the voltage and current

marked on the electrical ratings label of the product. The voltage and current rating of the cable must be greater than the voltage and current rating marked on the product.

- ▶ Plug the power cable into a grounded (earthed) electrical outlet that is easily accessible at all times. The product is equipped with a three-wire electrical grounding-type plug which has a third pin for ground. This plug fits only into a grounded electrical power outlet.
- ▶ Do not disable the power cable grounding plug. The grounding plug is an important safety feature.
- ▶ Do not place objects on power cables. Arrange them so that no one may accidentally step on or trip over them.
- ▶ Do not pull on a cable. When unplugging the product from the electrical outlet, grasp the plug.
- ▶ When possible, use one hand only to connect or disconnect cables.
- ▶ Do not modify power cables or plugs. Consult a licensed electrician or your power company for site modifications.

Power Supply

- ▶ Ensure that the voltage and frequency of your power source match the voltage and frequency inscribed on the equipment's electrical rating label. If you have a question about the type of power source to use, contact your authorized service provider.
- ▶ Connect the equipment to a properly wired and grounded electrical outlet and always follow your local or national wiring rules.
- ▶ Ensure that the socket outlet is near the equipment and is readily accessible for disconnection.
- ▶ To help protect your system from sudden, transient increases and decreases in electrical power, consider using a surge suppressor or line conditioner.
- ▶ Never force a connector into a port. Check for obstructions on the port. If the connector and port don't join with reasonable ease, they probably don't match. Make sure that the connector matches the port and that you have positioned the connector correctly in relation to the port.
- ▶ Do not open the power supply. Hazardous voltage, current and energy levels are present inside the power supply. The power supply in this product contains no user-serviceable parts. Return to manufacturer for servicing.

A.4. Communications Cable Precautions

To reduce the risk of exposure to electrical shock hazards from communications cables:

- ▶ Do not connect communications cables during an electrical storm. There may be a risk of electric shock from lightning.
- ▶ Do not connect or use communications cables in a wet location.

- ▶ Disconnect the communications cables before opening a product enclosure, or touching or installing internal components.

A.5. Other Hazards

Proposition 65 Warning

This product contains chemicals known to the State of California to cause cancer and birth defects or other reproductive harm.

California Department of Toxic Substances Control

Perchlorate Material – special handling may apply. See www.dtsc.ca.gov/hazardouswaste/perchlorate.

Perchlorate Material: Lithium battery (CR2032) contains perchlorate. Please follow instructions for disposal.

Nickel



The decorative metal foam on the DGX Station casework contains some nickel. The metal foam is not intended for direct and prolonged skin contact. While nickel exposure is unlikely to be a problem, you should be aware of the possibility in case you're susceptible to nickel-related reactions.

Appendix B.

CONNECTIONS, CONTROLS, AND INDICATORS

B.1. Front-Panel Connections and Controls

ID	Type	Qty	Description
1	Power Button	1	Press to turn the DGX Station on or off

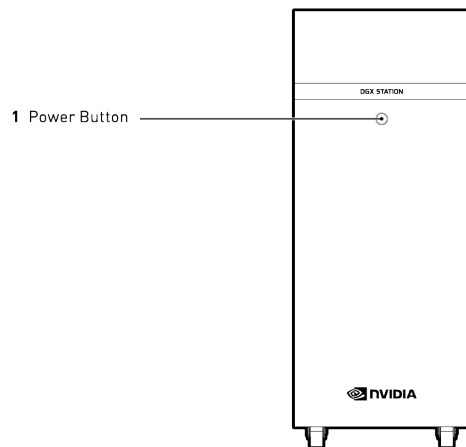

B.2. Rear-Panel Connections and Controls

Current Units

ID	Type	Qty	Description
1	USB 3.1 Type-C	1	USB 3.1 Type-C port
2	Ethernet	2	10G LAN ports (see LAN Port Indicators):

ID	Type	Qty	Description
			<ul style="list-style-type: none"> ▶ Lower port: LAN 1 ▶ Upper port: LAN 2
3	USB 3.0	4	USB 3.0 ports
4	S/PDIF Audio Output	1	Optical S/PDIF out port
5	eSATA	2	eSATA ports for connecting external storage devices, such as hard drives or optical drives, with an external power supply
6	AC Input	1	Power supply input
7	Reset Button	1	Press to reboot the system without turning off the system power
8	USB 3.1 Type-A	1	USB 3.1 Type-A port
9	Audio I/O	5	3.5 mm I/O ports for 2-, 4-, 6-, or 8-channel audio (see Audio I/O Connections)
10	DisplayPort	3	Ports for connecting up to 3 displays
11	Power Supply Switch	1	Turn the power supply on and off

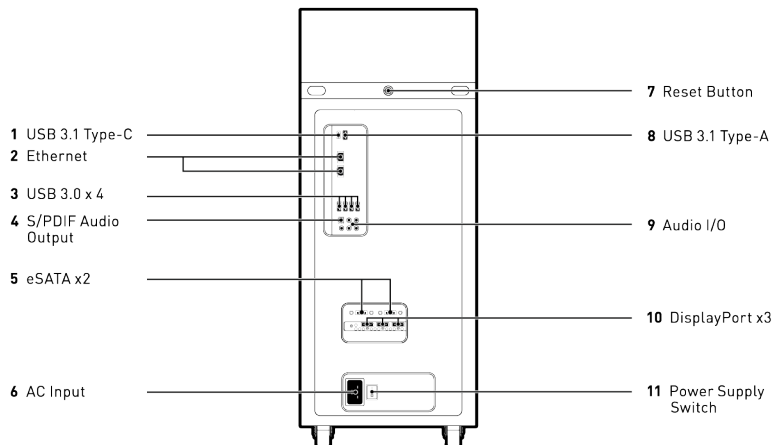

Earlier Units

ID	Type	Qty	Description
1	USB 3.1 Type-C	1	USB 3.1 Type-C port
2	Ethernet	2	10G LAN ports (see LAN Port Indicators): <ul style="list-style-type: none"> ▶ Lower port: LAN 1 ▶ Upper port: LAN 2

ID	Type	Qty	Description
3	USB 3.0	4	USB 3.0 ports
4	S/PDIF Audio Output	1	Optical S/PDIF out port
5	eSATA	2	eSATA ports for connecting external storage devices, such as hard drives or optical drives, with an external power supply
6	Power Supply Switch	1	Turn the power supply on and off
7	Reset Button	1	Press to reboot the system without turning off the system power
8	USB 3.1 Type-A	1	USB 3.1 Type-A port
9	Audio I/O	5	3.5 mm I/O ports for 2-, 4-, 6-, or 8-channel audio (see Audio I/O Connections)
10	DisplayPort	3	Ports for connecting up to 3 displays
11	AC Input	1	Power supply input

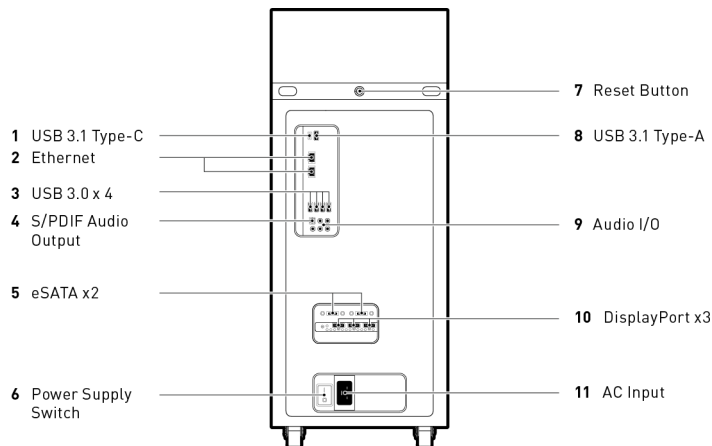

B.3. LAN Port Indicators

LEDs on each Ethernet LAN port indicate the connection status as illustrated in the following figure and described in the following tables.

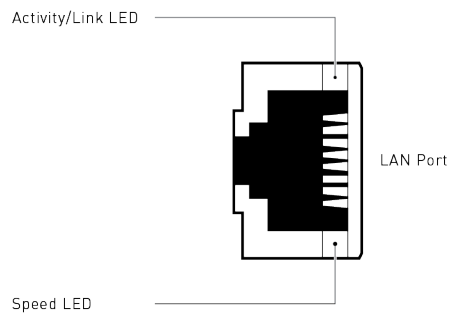

Speed LED

Status	Description
Off	100 Mbps connection
Orange	1 Gbps connection
Green	10 Gbps connection

Activity/Link LED

Status	Description
Off	No link
Green	Linked
Green (blinking)	Data activity

B.4. Audio I/O Connections

ID	Port Color	2-Channel	4-Channel	6-Channel	8-Channel
1	Pink	Mic In	Mic In	Mic In	Mic In
2	Black	N/A	Rear Speaker	Rear Speaker	Rear Speaker
3	Orange	N/A	N/A	Center/Subwoofer	Center/Subwoofer
4	Light Blue	Line In	Line In	Line In	Side Speaker
5	Lime Green	Line Out	Front Speaker	Front Speaker	Front Speaker

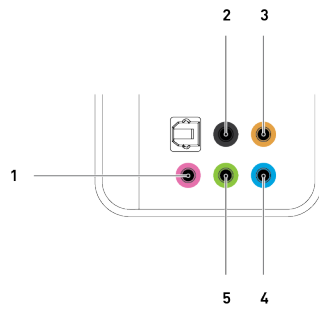

Appendix C. COMPLIANCE

The NVIDIA DGX Station is compliant with the regulations listed in this section.

C.1. DGX Station Model Number

Model: P2587

C.2. Argentina

S-Mark



C.3. Australia/New Zealand

RCM



C.4. Brazil

INMETRO



C.5. Canada

Innovation, Science and Economic Development Canada (ISED)

CAN ICES-3(A)/NMB-3(A)

The Class A digital apparatus meets all requirements of the Canadian Interference-Causing Equipment Regulation.

Cet appareil numérique de la classe A respecte toutes les exigences du Règlement sur le matériel brouilleur du Canada.

C.6. China

RoHS Material Content

 <p>产品中有害物质的名称及含量 The Table of Hazardous Substances and their Content 根据中国《电器电子产品有害物质限制使用管理办法》 as required by China's Management Methods for Restricted of Hazardous Substances Used in Electrical and Electronic Products</p>						
部件名称 Parts	有害物质 Hazardous Substances					
	铅及其化合物 (Pb and its compounds)	汞及其化合物 (Hg and its compounds)	镉及其化合物 (Cd and its compounds)	六价铬化合物 (Cr(VI) compounds)	多溴联苯 (PBB)	多溴二苯醚 (PBDE)
机箱 Chassis	X	O	O	O	O	O
印刷电路部件 PCA	X	O	O	O	O	O
图形处理器 GPU	X	O	O	O	O	O
中央处理器 CPU	X	O	O	O	O	O
主板 Motherboard	X	O	O	O	O	O
电源设备 Power supply	X	O	O	O	O	O
存储设备 System memory	X	O	O	O	O	O
硬盘驱动器 Hard drive	X	O	O	O	O	O
机械部件 (风扇、散热器、面板等) Mechanical parts (fan, heat sink, bezel...)	X	O	O	O	O	O
线材/连接器 Cables/Connectors	X	O	O	O	O	O
焊接金属 Soldering material	O	O	O	O	O	O
助焊剂, 锡膏, 标签及其他耗材 Flux, Solder Paste, label and other consumable materials	O	O	O	O	O	O

本表格依据SJ/T 11364-2014 的规定编制
The table according to SJ/T 11364-2014

O: 表示该有害物质在该部件所有均质材料中的含量均在GB/T 26572-2011 标准规定的限量要求以下。
O: Indicates that this hazardous substance contained in all of the homogeneous materials for this part is below the limit requirement in GB/T 26572-2011.
X: 表示该有害物质至少在该部件的某一均质材料中的含量超出GB/T 26572-2011 标准规定的限量要求。
X: Indicates that this hazardous substance contained in at least one of the homogeneous materials used for this part is above the limit requirement in GB/T 26572-2011.

此表中所有名称中含“X”的部件均符合欧盟 RoHS 立法。
All parts named in this table with an “X” are in compliance with the European Union’ s RoHS Legislation.

注: 环保使用期限的参考标识取决于产品正常工作的温度和湿度等条件
Note: The referenced Environmental Protection Use Period Marking was determined according to normal operating use conditions of the product such as temperature and humidity.

C.7. European Union

European Conformity; Conformité Européenne (CE)



This is a Class A product. In a domestic environment this product may cause radio frequency interference in which case the user may be required to take adequate measures.

The product has been marked with the CE Mark to illustrate its compliance.

This device complies with the following Directives:

- ▶ EMC Directive (2014/30/EU) for Class A, I.T.E equipment.
- ▶ Low Voltage Directive (2014/35/EU) for electrical safety.
- ▶ RoHS Directive (2011/65/EU) for hazardous substances.
- ▶ ErP Directive (2009/125/EC) for European Ecodesign.

A copy of the Declaration of Conformity to the essential requirements may be obtained directly from NVIDIA GmbH (Floessergasse 2, 81369 Munich, Germany).

C.8. India

BIS

IS 13252 (Part 1)/
IEC 60950-1



R-41078743

Self Declaration - Conforming to IS13252:2010, R-41078743

C.9. Israel

אזהרה משפט

והתקע החשמל כבל ותקינות שלמות ודא

רטובות בידיים החשמל מרשת התקע את להוציא או להכניס אין .

הקרובה השירות למעבדת לפנות יש כלשהו בעיה של במקרה , המכשיר את לפתוח אין .

מנוזלים המכשיר את להרחיק יש .

שירות למעבדת ולפנות החשמל מרשת מיידית לנתקו יש , במכשיר שמקורם רעשים , מזור ריח של במקרה .

לחה בסביבה לשימוש ולא חיצוני לשימוש ולא , המבנה בתוך לשימוש מיתעד המכשיר .

החשמל הכבל את ולעקם , לשבור , לחתוך אין .

או דליקה , לנזק לגרום עלול שכן , המידה על יתר להתחמם לו להניח או החשמל הכבל על חפצים להניח אין

התחשמלות .

לשימוש מוכן תפעולי במצב הניתוק התקן את לחזק להקפיד יש .

אזהרה :

המשתמש להתחשמלות לגרום עלול לקוי חיבור , מקוריים לא בתחליפים הזינה כבל את להחליף אין .

שבכבל הארקה מוליך תקינות לוודא יש מאריך כבל על בשימוש .

C.10. Japan

VCCI

この装置は、クラス A 情報技術装置です。この装置を家庭環境で使用する
と電波妨害を引き起こすことがあります。この場合には使用者が適切な対策
を講ずるよう要求されることがあります。

VCCI-A

C.11. Russia

CU-TR



C.12. South Africa

LOA

Compliant with SANS IEC 60950

SABS

Compliant with SANS 222 CISPR 22



SANS 222

C.13. South Korea

KC



MSIP-REM-NVA-P2587

<p>A급 기기 (업무용 방송통신기자재)</p>	<p>이 기기는 업무용(A급) 전자파적합기기로서 판매자 또는 사용자는 이 점을 주의하시기 바라며, 가정외의 지역에서 사용하는 것을 목적으로 합니다.</p>
--------------------------------	--

C.14. Taiwan

BSMI



R33088

RoHS

<p>警告使用者: 此為甲類資訊技術設備，於居住環境中使用時，可能會造成射頻擾動，在此種情況下，使用者會被要求採取某些適當的對策</p>
--

限用物質含有情況標示聲明書 Declaration of the presence condition of the Restricted Substances Marking						
設備名稱: DGX工作站 Equipment Name: DGX Station						
單元 Parts	限用物質及其化學符號 Restricted substances and their chemical symbols					
	鉛 (Pb)	汞 (Hg)	鎘 (Cd)	六價鉻 (Cr(VI))	多溴聯苯 (PBB)	多溴二苯醚 (PBDE)
機箱 Chassis	-	○	○	○	○	○
印刷電路部件 PCA	-	○	○	○	○	○
圖形處理器 GPU	-	○	○	○	○	○
中央處理器 CPU	-	○	○	○	○	○
主板 Motherboard	-	○	○	○	○	○
電源設備 Power supply	-	○	○	○	○	○
存儲設備 System memory	-	○	○	○	○	○
硬盤驅動器 Hard drive	-	○	○	○	○	○
機械部件(風扇、散熱器、面板、水冷裝置等) Mechanical parts (fan, heat sink, bezel, cooler...)	-	○	○	○	○	○
線材/連接器 Cables/Connectors	-	○	○	○	○	○
焊接金屬 Soldering material	○	○	○	○	○	○
助焊劑、錫膏、標籤及其他耗材 Flux, Solder Paste, label and other consumable materials	○	○	○	○	○	○
備考1: ○: 系指該限用物質未超出百分比含量標準值 Note 1: ○: indicates that the percentage content of the restricted substance does not exceed the percentage of reference value of presence. 備考2: -: 系指該項限用物質為除外項目。 Note 2: -: indicates that the restricted substance corresponds to the exemption. 此表中所有名稱中含“-”的部件均符合歐盟 RoHS 立法。 All parts named in this table with an “-” are in compliance with the European Union's RoHS Legislation. 注: 環保使用期限的參考標準取決於產品正常工作的溫度和濕度等條件 Note: The referenced Environmental Protection Use Period Marking was determined according to normal operating use conditions of the product such as temperature and humidity.						

C.15. United States

Federal Communications Commission (FCC)

FCC Marking (Class A)

This device complies with part 15 of the FCC Rules. Operation is subject to the following two conditions: (1) this device may not cause harmful interference, and (2) this device must accept any interference received, including any interference that may cause undesired operation of the device.

NOTE: This equipment has been tested and found to comply with the limits for a Class A digital device, pursuant to part 15 of the FCC Rules. These limits are designed to provide reasonable protection against harmful interference when the equipment is operated in a commercial environment. This equipment generates, uses, and can radiate

radio frequency energy and, if not installed and used in accordance with the instruction manual, may cause harmful interference to radio communications. Operation of this equipment in a residential area is likely to cause harmful interference in which case the user will be required to correct the interference at his own expense.

C.16. United States/Canada

cULus Listing Mark



C.17. Vietnam

ICT



Phù hợp quy chuẩn kỹ thuật, tiêu chuẩn: TCVN 7189:2009 - Thiết bị công nghệ thông tin
– Đặc tính nhiễu tần số vô tuyến – Giới hạn và phương pháp đo

Appendix D.

DGX STATION HARDWARE SPECIFICATIONS

D.1. Environmental Conditions

Condition	Operating Range	Nonoperating Range
Ambient temperature	10° C to 30° C (50° F to 86° F)	5° C to 40° C (41° F to 104° F)
Relative humidity	10% to 80% (non-condensing)	8% to 90% (non-condensing)

D.2. Component Specifications

Component	Qty	Description
CPU	1	Intel Xeon E5-2698 v4 2.2 GHz (20-Core)
GPU- current units	4	NVIDIA Tesla V100-DGXS-32GB, featuring: <ul style="list-style-type: none">▶ 4×125 TeraFLOPS (500 TeraFLOPS total), FP16▶ 4×32 GB (128 GB total) GPU memory▶ 4×640 (2,560 total) NVIDIA Tensor Cores▶ 4×5,120 (20,480 total) NVIDIA CUDA® cores
GPU - earlier units	4	NVIDIA Tesla V100-DGXS-16GB, featuring: <ul style="list-style-type: none">▶ 4×125 TeraFLOPS (500 TeraFLOPS total), FP16▶ 4×16 GB (64 GB total) GPU memory▶ 4×640 (2,560 total) NVIDIA Tensor Cores▶ 4×5,120 (20,480 total) NVIDIA CUDA® cores
System memory	8	8×32 GB (256 GB total) ECC Registered RDIMM DDR4 SDRAM
Data storage	3	3×1.92 TB (5.76 TB total) 2.5" 6 Gb/s SATA III SSD in RAID 0 configuration
OS storage	1	1.92 TB 2.5" 6 Gb/s SATA III SSD

D.3. Mechanical Specifications

Specification	Value
Height	25" (639 mm)
Width	10" (256 mm)
Depth	20" (518 mm)
Gross weight	88 lbs (40 kg)

D.4. Power Specifications

Input	Comments
115 - 240 VAC, 12-8A, (50 - 60 Hz)	The DGX Station power consumption can reach 1,500 W (ambient temperature 30°C) with all system resources under a heavy load. Be aware of your electrical source's power capability to avoid overloading the circuit.

Appendix E.

CUSTOMER SUPPORT FOR THE NVIDIA DGX STATION

There are several options for contacting NVIDIA Customer Support for assistance reporting, troubleshooting, or diagnosing problems with your DGX Station.

NVIDIA Enterprise Support Portal

The best way to file an incident is to log on to

NVIDIA Enterprise Support (<https://nvid.nvidia.com/dashboard/>).

NVIDIA Enterprise Support Email

enterprisesupport@nvidia.com

NVIDIA Enterprise Support - Local Language Phone Numbers

Visit NVIDIA Enterprise Customer Support (<https://www.nvidia.com/en-us/support/enterprise/>)

Our support team can help collect appropriate information about your issue and involve internal resources as needed.

Notice

THE INFORMATION IN THIS GUIDE AND ALL OTHER INFORMATION CONTAINED IN NVIDIA DOCUMENTATION REFERENCED IN THIS GUIDE IS PROVIDED “AS IS.” NVIDIA MAKES NO WARRANTIES, EXPRESSED, IMPLIED, STATUTORY, OR OTHERWISE WITH RESPECT TO THE INFORMATION FOR THE PRODUCT, AND EXPRESSLY DISCLAIMS ALL IMPLIED WARRANTIES OF NONINFRINGEMENT, MERCHANTABILITY, AND FITNESS FOR A PARTICULAR PURPOSE. Notwithstanding any damages that customer might incur for any reason whatsoever, NVIDIA's aggregate and cumulative liability towards customer for the product described in this guide shall be limited in accordance with the NVIDIA terms and conditions of sale for the product.

THE NVIDIA PRODUCT DESCRIBED IN THIS GUIDE IS NOT FAULT TOLERANT AND IS NOT DESIGNED, MANUFACTURED OR INTENDED FOR USE IN CONNECTION WITH THE DESIGN, CONSTRUCTION, MAINTENANCE, AND/OR OPERATION OF ANY SYSTEM WHERE THE USE OR A FAILURE OF SUCH SYSTEM COULD RESULT IN A SITUATION THAT THREATENS THE SAFETY OF HUMAN LIFE OR SEVERE PHYSICAL HARM OR PROPERTY DAMAGE (INCLUDING, FOR EXAMPLE, USE IN CONNECTION WITH ANY NUCLEAR, AVIONICS, LIFE SUPPORT OR OTHER LIFE CRITICAL APPLICATION). NVIDIA EXPRESSLY DISCLAIMS ANY EXPRESS OR IMPLIED WARRANTY OF FITNESS FOR SUCH HIGH RISK USES. NVIDIA SHALL NOT BE LIABLE TO CUSTOMER OR ANY THIRD PARTY, IN WHOLE OR IN PART, FOR ANY CLAIMS OR DAMAGES ARISING FROM SUCH HIGH RISK USES.

NVIDIA makes no representation or warranty that the product described in this guide will be suitable for any specified use without further testing or modification. Testing of all parameters of each product is not necessarily performed by NVIDIA. It is customer's sole responsibility to ensure the product is suitable and fit for the application planned by customer and to do the necessary testing for the application in order to avoid a default of the application or the product. Weaknesses in customer's product designs may affect the quality and reliability of the NVIDIA product and may result in additional or different conditions and/or requirements beyond those contained in this guide. NVIDIA does not accept any liability related to any default, damage, costs or problem which may be based on or attributable to: (i) the use of the NVIDIA product in any manner that is contrary to this guide, or (ii) customer product designs.

Other than the right for customer to use the information in this guide with the product, no other license, either expressed or implied, is hereby granted by NVIDIA under this guide. Reproduction of information in this guide is permissible only if reproduction is approved by NVIDIA in writing, is reproduced without alteration, and is accompanied by all associated conditions, limitations, and notices.

Trademarks

NVIDIA, the NVIDIA logo, DGX, DGX-1, DGX-2, and DGX Station are trademarks and/or registered trademarks of NVIDIA Corporation in the United States and other countries. Other company and product names may be trademarks of the respective companies with which they are associated.

Copyright

© 2017-2020 NVIDIA Corporation. All rights reserved.