

SAMSUNG LED TV user manual

SERIES 4

Figures and illustrations in this User Manual are provided for reference only and may differ from actual product appearance. Product design and specifications may be changed without notice.

Still image warning

Avoid displaying still images (like jpeg picture files) or still image element (like TV programme logo, panorama or 4:3 image format, stock or news bar at screen bottom etc.) on the screen. Constant displaying of still picture can cause ghosting of LED screen, which will affect image quality. To reduce risk of this effect, please follow below recommendations:

- Avoid displaying the same TV channel for long periods.
- Always try to display any image on full screen, use TV set picture format menu for best possible match.
- Reduce brightness and contrast values to minimum required to achieve desired picture quality, exceeded values may speed up the burnout process.
- Frequently use all TV features designed to reduce image retention and screen burnout, refer to proper user manual section for details.

Securing the Installation Space

Keep the required distances between the product and other objects (e.g. walls) to ensure proper ventilation. Failing to do so may result in fire or a problem with the product due to an increase in the internal temperature of the product.

- When using a stand or wall-mount, use parts provided by Samsung Electronics only.
- If you use parts provided by another manufacturer, it may result in a problem with the product or an injury due to the product falling.
- The appearance may differ depending on the product.
- Be careful when you contact the TV because some parts can be somewhat hot.

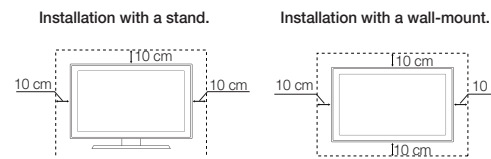

| Country | Customer Care Centre | Web Site |
|-------------|---|--|
| AUSTRALIA | 1300 362 603 | www.samsung.com |
| NEW ZEALAND | 0800 SAMSUNG (0800 726 786) | www.samsung.com |
| CHINA | 400-810-5858 | www.samsung.com |
| HONG KONG | (852) 3698-4698 | www.samsung.com/hk www.samsung.com/hk_en/ |
| INDIA | 1800 1100 11 3030 6262 1800 3000 8282 1800 266 8282 | www.samsung.com |
| INDONESIA | 0800-112-8888 021-5699-7777 | www.samsung.com |
| JAPAN | 0120-327-527 | www.samsung.com |
| MALAYSIA | 1800-88-9999 | www.samsung.com |
| PHILIPPINES | 1-800-10-SAMSUNG(726-7864) for PLDT 1-800-3-SAMSUNG(726-7864) for Digital 1-800-8-SAMSUNG(726-7864) for Globe 02-5805777 | www.samsung.com |
| SINGAPORE | 1800-SAMSUNG(726-7864) | www.samsung.com |
| THAILAND | 1800-29-3232 02-589-3232 | www.samsung.com |
| TAIWAN | 0800-329-9999 0266-026-066 | www.samsung.com |
| VIETNAM | 1 800 588 889 | www.samsung.com |



Getting Started

Accessories

- Remote Control & Batteries (AAA x 2)
- Owner's Instructions
- Warranty Card / Safety Guide (Not available in some locations)
- Holder-Wire stand
- Power Cord

Input Cables (Sold Separately)

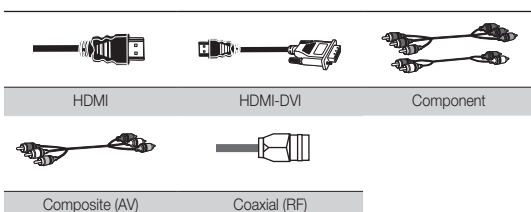

TV Controller (Panel Key)

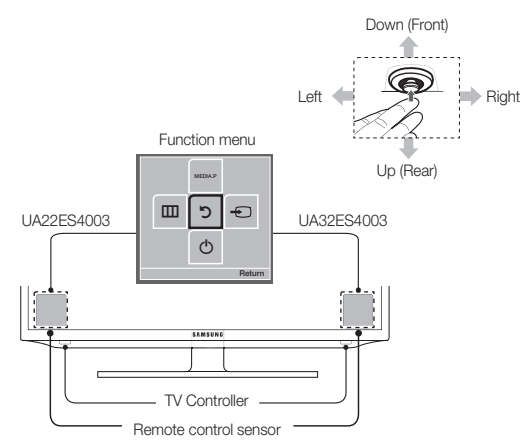

| | |
|---------------------------------|---|
| Power on | Turns the TV on by pressing the controller in standby mode. |
| Adjusting the volume | Adjusts the volume by moving the controller from side to side when the power is on. |
| Selecting a channel | Presses a channel by moving the controller up and down when the power is on. |
| Using the function menu | Presses the controller when the power is on, then the function menu screen appears. If you press it again, the function menu screen disappears. |
| Using the Menu (M) | Selects the Menu (M) by moving the controller in the function menu screen. The OSD (On-Screen Display) of your TV's feature appears. |
| Selecting the Source (S) | Selects the Source (S) by moving the controller in the function menu screen. The Source List screen appears. |
| Selecting the Media Play | Selects the MEDIA P by moving the controller in the function menu screen. The MEDIA Play main screen appears. |
| Power Off (O) | Selects the Power Off (O) to turn the TV off by moving the controller in the function menu screen. |

• Exits the menu when pressing the controller more than 1 second.

• When selecting the function by moving the controller to the up/down/left/right directions, be sure not to press the controller. If you press it first, you cannot operate it to move the up/down/left/right directions.

Plug & Play

When you turn the TV on for the first time, a sequence of on-screen prompts will assist in configuring basic settings. Press the POWER button. **Plug & Play** is available only when the input source is set to TV.

- Connecting the power cord and antenna. (refer to 'Connections')

Selecting a language

Select the desired OSD (On-Screen Display) language.

Selecting a Home Use mode

Select the **Home Use mode**. **Store Demo** mode is for retail environments.

When pressing TV controller, the function menu screen appears. Select the **Menu** (M) and press it more than 5 seconds using the controller. The **Store Demo** mode is set. Cancel the **Store Demo** by selecting **Source** (S) and pressing it more than 5 seconds.

Selecting an Area

Press the **▶** / **ENTER** (C) button. Press the **▲** or **▼** button, then press the **ENTER** (C) button to select the appropriate area.

Auto Store

The channel search will start automatically.

Setting the Clock Set

Press the **◀** or **▶** button to select **Day**, **Month**, **Year**, **Hour** and **Minute**. Set these by pressing the **▲** / **▼** / **▶** / **◀** button, and press the **ENTER** (C) button to go next step.

Viewing the HD Connection Guide

The connection method for the best HD screen quality is displayed.

Enjoy your TV.

Press the **ENTER** (C) button.

Connections

Power Input UA32EH4003

AV Device (1) Using an HDMI Cable (up to 1080p)

AV Device (2) Using a Component Cable (up to 1080p)

AV Device (3) Using Audio/Video Cables

Media Play Using a USB Drive

PC Using an HDMI Cable or an HDMI to DVI Cable. Use the PC speakers for audio.

Note

- For better picture and audio quality, connect to a digital device using an HDMI cable.
- The picture may not display normally (if at all) or the audio may not work if an external device that uses an older version of HDMI mode is connected to the TV. If such a problem occurs, ask the manufacturer of the external device about the HDMI version and, if out of date, request an upgrade.
- Be sure to purchase a certified HDMI cable. Otherwise, the picture may not display or a connection error may occur.
- PC/DVI AUDIO IN input is not supported.
- DIGITAL AUDIO OUT(OPTICAL) is not supported.
- For HDMI/DVI cable connection, you must use the HDMI/DVI IN jack.
- Connecting through the HDMI cable may not be supported depending on the PC.
- If an HDMI to DVI cable is connected to the HDMI/DVI IN port, the audio does not work.
- **SERVICE**: Connector for service only.

For UA22ES4003 connection, you can refer to UA32EH4003 according to connection numbers.

Changing the Input Source

Source List

Use to select TV or other external input sources such as DVD / Blu-ray players / cable box / STB satellite receiver connected to the TV.

1. Press the SOURCE button.
2. Select a desired external input source.

TV / AV / Component / HDMI/DVI

You can only choose external devices that are connected to the TV. In the **Source List**, connected inputs will be highlighted.

How to use Edit Name

Edit Name lets you associate a device name to an input source. To access **Edit Name**, press the **TOOLS** button in **Source List**. The following selections appear under **Edit Name**:

Remote Control

This remote control has Braille points on the Power, Channel, and Volume buttons and can be used by visually impaired persons.

Turns the TV on and off.

Displays and selects the available video sources.

Press to directly access to channels.

Returns to the previous channel.

Alternately select Teletext ON, Double, Mix or OFF.

Cuts off the sound temporarily.

Adjusts the volume.

Changes channels.

Displays the main on-screen menu.

Displays channel lists on the screen.

Views the **MEDIA Play**.

Selects the HDMI mode directly.

Quickly select frequently used functions.

Displays information on the TV screen.

Selects the on-screen menu items and changes the values seen on the menu.

Exits the menu.

Returns to the previous menu.

Use these buttons according to the direction on screen.

PMODE: Selects the picture mode.
PSIZE: Selects the picture size.
SRS: Turns the SRS TruSurround on and off.

Use these buttons in a specific feature.

Installing batteries (Battery size: AAA)

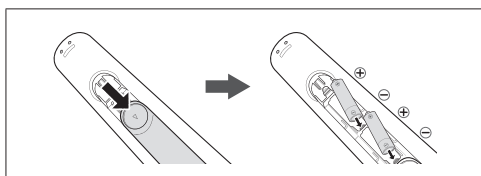

NOTE

- Use the remote control within 23 feet from TV.
- Bright light may affect the performance of the remote control. Avoid using nearby special fluorescent light or neon signs.
- The Colour and shape may vary depending on the model.

Channel Menu

Seeing Channels

Channel List

Select a channel in the **All Channels**, **Added Channels**, **Favourites** or **Programmed** screen by pressing the **▲** / **▼** buttons, and pressing the **ENTER** (C) button. Then you can watch the selected channel.

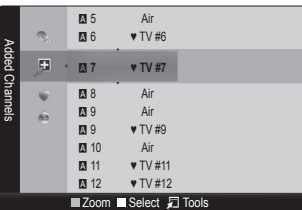

- **All Channels**: Shows all currently available channels.
- **Added Channels**: Shows all added channels.
- **Favourites**: Shows all favourite channels.
- **Programmed**: Shows all currently reserved Programmes.
- Using the remote control buttons with the **Channel List**
- **Green (Zoom)**: Enlarges or shrinks a channel number.
- **Yellow (Select)**: Selects multiple channel lists. Select desired channels and press the Yellow button to set all the selected channels at the same time. The **✓** mark appears to the left of the selected channels.
- **Tools**: Displays the **Channel List** option menu. (The Options menus may differ depending on the situation.)

Channel Status Display icons

| Icons | Operations |
|-------|-------------------------------|
| ✓ | A channel selected. |
| ▲ | A channel set as a favourite. |
| Ⓛ | A locked channel. |
| Ⓞ | A reserved programme. |

Returning Channels

Area

You can change the desired area.

Auto Store

(depending on the country)

Scans for a channel automatically and stores in the TV.

Automatically allocated programme numbers may not correspond to actual or desired programme numbers. If a channel is locked, the PIN input window appears.

Manual Store

Scans for a channel manually and stores in the TV.

- If a channel is locked, the PIN input window appears.
- According to channel source, **Manual Store** may be supported.

Programme, Colour System, Sound System, Channel Search, Store

If there is abnormal sound or no sound, reselect the sound standard required.

Channel mode

- **P** (Programme): When tuning is complete, the broadcasting stations in your area have been assigned to position numbers from PO to P99. You can select a channel by entering the position number in this mode.
- **C** (aerial channel mode) / **S** (cable channel mode): These two modes allow you to select a channel by entering the assigned number for each aerial broadcasting station or cable channel.

Channel List Option Menu

Set each channel using the **Channel List** menu options (**Add/Delete**, **Add to Favourite/Delete from Favourite**, **Timer Viewing**, **Lock/Unlock**, **Edit Channel Name**, **Sort**, **Select All/Deselect All**, **Auto Store**). Option menu items may differ depending on the channel status.

Set each channel using the **Channel List** menu options. Option menu items may differ depending on the channel status.

- **Add / Delete**: Delete or add a channel to display the channels you want.
- All deleted channels will be shown on the **All Channels** menu.
- A gray-Coloured channel indicates the channel has been deleted.
- The **Add** menu only appears for deleted channels.
- Delete a channel from the **Added Channels** or **Favourites** menu in the same manner.
- **Add to Favourite / Delete from Favourite** (TOOLS F): Set channels you watch frequently as favourites
- **Timer Viewing**: You can set a desired channel to be displayed automatically at the set time; even when you are watching another channel. Set the current time first to use this function.
- **Edit Channel Name**: Assign your own channel name.
- **Sort**: This operation allows you to change the programme numbers of the stored channels. This operation may be necessary after using the auto store.
- **Lock / Unlock**: Lock a channel so that the channel cannot be selected and viewed.

This function is available only when the **Channel Lock** is set to **On**.

The PIN input screen appears. Enter your 4-digit PIN, the default of which is "0-0-0-0". Change the PIN using the **Change PIN** option.

Select All / Deselect All: You can select or deselect all channels in the channel list.

Auto Store: Scans for a channel automatically and stores in the TV.

Channel Mode

Programmes will be switched within the favourite or memorised channel list.

Added Channels: Shows all added channels.

Favourite Ch.: Shows all favourite channels.

Fine Tune

If the reception is clear, you do not have to fine tune the channel, as this is done automatically during the search and store operation. If the signal is weak or distorted, fine tune the channel manually.

Fine tuned channels that have been saved are marked with an asterisk "*" on the right-hand side of the channel number in the channel banner.

To reset the fine-tuning, select **Reset**.

Picture Menu

Mode

Select your preferred picture type.

- **Dynamic**: Suitable for a bright room.
- **Standard**: Suitable for a normal environment.
- **Movie**: Suitable for watching movies in a dark room.

Samsung MagicAngle

Adjust screen viewing Angle to optimize screen quality according to your viewing position.

Samsung MagicAngle: When viewing the screen at an angle from below or above by setting the appropriate mode for each position you can obtain a similar picture quality as viewing the screen directly from the front.

Off: Select when viewing from the front position.

Lean Back Mode: Select when viewing from a slightly lower position.

Standing Mode: Select when viewing from the upper position.

Mode: Adjust screen viewing angle.

When **Samsung MagicAngle** is set to **Lean Back Mode** or **Standing Mode**, **Gamma** is not available.

Backlight / Contrast / Brightness / Sharpness / Colour / Tint (G/R)

Your television has several setting options for picture quality control.

Advanced Settings

(available in **Standard** / **Movie** mode)

Compared to previous models, new Samsung TVs have a more precise picture.

Colour Space (Auto / Native): Adjusts the range of colours available to create the image.

White Balance: Adjust the colour temperature for a more natural picture.

R-Offset / G-Offset / B-Offset: Adjust each colour's (red, green, blue) darkness.

R-Gain / G-Gain / B-Gain: Adjust each colour's (red, green, blue) brightness.

Reset: Resets the **White Balance** to its default settings.

Gamma: Adjusts the primary colour intensity.

Dynamic Contrast (Off / Low / Medium / High): Adjusts the screen contrast.

Black Tone (Off / Dark / Darker / Darkest): Select the black level to adjust the screen depth.

Flesh Tone: Emphasize pink "Flesh Tone".

Motion Lighting (Off / On): Reduce power consumption by brightness control adapted motion.

Only available in **Standard** mode.

Picture Options

Colour Tone (Cool / Standard / Warm1 / Warm2)

Warm1 or **Warm2** will be deactivated when the picture mode is **Dynamic**.

Size: Your cable box/satellite receiver may have its own set of screen sizes as well. However, we highly recommend you use 16:9 mode most of the time.

16:9: Sets the picture to 16:9 wide mode.

Wide Zoom: Magnifies the picture size more than 4:3.

Adjusts the Position by using **▲**, **▼** buttons.

Zoom: Magnifies the 16:9 wide pictures vertically to fit the screen size.

4:3: Sets the picture to basic (4:3) mode.

Do not watch in 4:3 format for a long time. Traces of borders displayed on the left, right and centre of the screen may cause image retention (screen burn) which are not covered by the warranty.

Screen Fit: Displays the full image without any cut-off when HDMI (720p / 1080i / 1080p) or Component (1080i / 1080p) signals are inputted.

NOTE

After selecting **Screen Fit** in HDMI (1080i / 1080p) or Component (1080i / 1080p) mode: Adjusts the Position or Size by using **▲**, **▼**, **▶**, **◀** button.

Depending on the input source, the picture size options may vary.

The available items may differ depending on the selected mode.

Settings can be adjusted and stored for each external device connected to an input on the TV.

If you use the **Screen Fit** function with HDMI 720p input, 1 line will be cut at the top, bottom, left and right as in the overscan function.

Digital Noise Filter (Off / Low / Medium / High / Auto): If the broadcast signal received by your TV is weak, you can activate the **Digital Noise Filter** feature to reduce any static and ghosting that may appear on the screen.

When the signal is weak, try other options until the best picture is displayed.

HDMI Black Level (Normal / Low): Selects the black level on the screen to adjust the screen depth.

Available only in **HDMI** mode (RGB signals).

Film Mode (Off / Auto): Sets the TV to automatically sense and process film signals from all sources and adjust the picture for optimum quality.

Available in TV mode, AV, COMPONENT (480i / 1080i) and HDMI (480i / 1080i).

LED Motion Plus (Off / On): Removes drag from fast scenes with a lot of movement to provide a clear picture.

Picture Reset

Resets your current picture mode to its default settings.

Reset Picture Mode: Returns all picture values in the currently selected mode to the default settings.

Sound Menu

Mode

- **Standard**: Selects the normal sound mode.
- **Music**: Emphasizes music over voices.
- **Movie**: Provides the best sound for movies.
- **Clear Voice**: Emphasizes voices over other sounds.
- **Amplify**: Increase the intensity of high-frequency sound to allow a better listening experience for the hearing impaired.

Equalizer

(standard sound mode only)

- **Balance**: Adjusts the balance between the right and left speaker.
- **100Hz / 300Hz / 1KHz / 3KHz / 10KHz** (Bandwidth Adjustment): Adjusts the level of specific bandwidth frequencies.
- **Reset**: Resets the equalizer to its default settings.

SRS TruSurround HD

(standard sound mode only)

This function provides a virtual 5.1 channel surround sound experience through a pair of speakers using HRTF (Head Related Transfer Function) technology.

Auto Volume

Because each broadcasting station has its own signal conditions, the volume may fluctuate each time channel is changed. This feature lets you automatically adjust the volume of the desired channel by lowering the sound output when the modulation signal is high or by raising the sound output when the modulation signal is low.

Selecting the Sound Mode

When you set to **Dual I-II**, the current sound mode is displayed on the screen.

| | Audio Type | Dual I-II | Default |
|--------------|------------|----------------------------|------------------|
| A2 Stereo | Stereo | Stereo ↔ Mono | Automatic change |
| | Dual I | Dual I ↔ Dual II | Dual I |
| | Mono | Mono | Automatic change |
| NICAM Stereo | Stereo | Mono ↔ Stereo | Automatic change |
| | Dual I | Mono ↔ Dual I ↔ Dual II | Dual I |

If the stereo signal is weak and an automatic switching, occurs, then switch to the mono.

Only activated in stereo sound signal.

This function is available for all input sources.

Sound Reset

Reset All: Reset all sound settings to the factory defaults.

Setup Menu

Media Play

Enjoy photos, music and/or movie files saved on a USB Mass Storage Class (MSC) device.



Connecting a USB Device

- Turn on your TV.
- Connect a USB device containing photo, music and/or movie files to the USB jack on the side of the TV.
- When USB is connected to the TV, you can select **Media Play**.

Using the Media Play Menu



- Press the MENU button. Press the **▲** or **▼** button to select **Application**, then press the ENTER **↵** button.
- Press the **▲** or **▼** button to select **Media Play (USB)**, then press the ENTER **↵** button.
- Press the **◀** or **▶** button to select an icon (**Videos**, **Music**, **Photos**, **Settings**), then press the ENTER **↵** button.

It might not work properly with unlicensed multimedia files.

If you want to view detailed information of the file or connected device, press TOOLS button in the file list, and then select **Detailed Information** or **Device Information**.

Need-to-Know List before using **Media Play (USB)**

- The file system supports NTFS (Read Only), FAT16 and FAT32.
- Certain types of USB Digital camera and audio devices may not be compatible with this TV.

Media Play only supports USB Mass Storage Class (MSC) devices. MSC is a Mass Storage Class Bulk-Only Transport device. Examples of MSC are Thumb drives and Flash Card Readers. Devices should be connected directly to the TV's USB port. USB HDD is not supported.

- Before connecting your device to the TV, please back up your files to prevent them from damage or loss of data. SAMSUNG is not responsible for any data file damage or data loss.

A USB device that requires high power (more than 0.5A) may not be supported.

- Do not disconnect the USB device while it is loading.

The higher the resolution of the image, the longer it takes to display on the screen.

If a file is corrupted or the TV does not support the file type, the "Not Supported File Format" message appears.

- If a USB extension cable is used, the USB device may not be recognized or the files on the device may not be read.

The TV cannot play MP3 files with DRM that were downloaded from a for-pay site. Digital Rights Management (DRM) is a technology that supports the creation, distribution, and management of digital content in an integrated and comprehensive way, including protecting the rights and interests of content providers, preventing illegal copying of contents, and managing billings and settlements.

- PTP device is not supported.

If an over-power warning message is displayed while you are connecting or using a USB device, the device may not be recognized or may malfunction.

If the TV has no input during the time set in **Auto Protection Time**, the Screensaver will run.

The power-saving mode of some external hard disk drives may be released automatically when you connect them to the TV.

If a USB device connected to the TV is not recognized, the list of files on the device is corrupted, or a file in the list is not played, connect the USB device to a PC, format the device, and check the connection.

If a file you deleted from the PC is still found when you run **Media Play**, use the "Empty the Recycle Bin" function on the PC to permanently delete the file.

Photos only supports sequential jpeg format.

The scene search and thumbnail functions are not supported in the **Videos**.

If the number of files and folders saved on a USB storage device is approximately over 4000, the files and folders may not appear and some folders may not be opened.

The maximum displayed number of files, including sub folders, in one folder of USB storage device is 2000.

The media may not be playing smoothly when using the device lower than USB 2.0.

Videos



- Press the **◀** or **▶** button to select **Videos**, then press the ENTER **↵** button in the **Media Play** menu.
- Press the **◀|▶/▲/▼** button to select the desired video in the file list.
 - Press the ENTER **↵** button or **▶** (Play) button.
 - The selected file is displayed on the top with its playing time.
 - If video time information is unknown, playing time and the progress bar are not displayed.
 - During video playback, you can search using the **◀** and **▶** button.
 - You can use **⏮** (REW) and **⏭** (FF) buttons during playback.
 - In this mode, you can play movie clips contained in a game, but you cannot play the game itself.
- Press the ENTER **↵** button or **▶** (Play) button.
 - The selected file is displayed on the top with its playing time.
 - If video time information is unknown, playing time and the progress bar are not displayed.
 - During video playback, you can search using the **◀** and **▶** button.
 - You can use **⏮** (REW) and **⏭** (FF) buttons during playback.

Supported Subtitle Formats

- External

| Name | File extension |
|---------------------------|----------------|
| MPEG-4 Timed text | .txt |
| SAMI | .smi |
| Subrip | .srt |
| Subviewer | .sub |
| Micro DVD | .sub or .txt |
| SubStation Alpha | .ssa |
| Advanced SubStation Alpha | .ass |

- Internal

| Name | Container | Format |
|---------------------------|-----------|----------------|
| Xsub | AVI | Picture Format |
| SubStation Alpha | MKV | Text Format |
| Advanced SubStation Alpha | MKV | Text Format |
| Subrip | MPV | Text Format |
| MPEG-4 Timed text | MP4 | Text Format |

Supported Video Formats

| File Extension | Container | Video Codec | Resolution | Frame rate/pts | Bit rate(Mbps) | Audio Codec |
|----------------|-------------|--------------------|------------|----------------|----------------|--------------------------------|
| *.mp4 | MP4 | DxV 1:11.4x5:11.6 | 1024x1080 | 6-30 | 30Mbps | |
| | | H264 | 1024x1080 | 6-30 | 30Mbps | MP3 / AAC |
| | | MPEG2 | 640x480 | 6-30 | 10Mbps | MP3 / AAC / LPCM / DTS / DSR |
| *.avi | AVI | DxV 1:11.4x5:11.6 | 1024x1080 | 6-30 | 30Mbps | MP3 / AC3 / LPCM / AAC |
| | | MPEG4 SP / ASP | 1024x1080 | 6-30 | 30Mbps | LPCM / AAC / MP3 / DTS / DSR |
| | | MPEG2 | 640x480 | 6-30 | 10Mbps | |
| *.mov | MOV | DxV 1:11.4x5:11.6 | 1024x1080 | 6-30 | 30Mbps | MP3 / AC3 / LPCM / AAC |
| | | MPEG4 SP / ASP | 1024x1080 | 6-30 | 30Mbps | AAC / MP3 / WMA / WMA Pro |
| | | MPEG2 | 640x480 | 6-30 | 10Mbps | |
| *.ts | TS | MPEG2 | 1024x1080 | 6-30 | 30Mbps | AC3 / AAC / MP3 / DTS / HE-AAC |
| | | H.264 SP / MP / HP | 1024x1080 | 6-30 | 30Mbps | |
| *.mpg | PS | MPEG1 | 1024x1080 | 24/25/30 | 30Mbps | AC3 / MPEG / LPCM / AAC |
| | | MPEG2 | 1024x1080 | 24/25/30 | 30Mbps | |
| *.3gp | 3GPP | MPEG4 SP / ASP | 1024x1080 | 6-30 | 30Mbps | MP3 |
| | | H.264 | 1024x1080 | 6-30 | 30Mbps | |
| *.m | Mach format | H.264 | 1024x1080 | 6-30 | 30Mbps | MP3 |
| | | Screenwriter H.263 | 1024x1080 | 6-30 | 30Mbps | |

Other Restrictions

☞ **NOTE**

Video content will not play, or not play correctly, if there is an error in the content or the container.

Sound or video may not work if the contents have a standard bit rate/ frame rate above the compatible Frame/sec listed in the table above.

If the Index Table is in error, the Seek (Jump) function is not supported.

The menu may take longer to appear if the video's bit rate exceeds 10Mbps.

Video content can not be played, if there are many contents in one file.

| Video Decoder |
|--|
| Supports up to H.264, Level 4.1 |
| H.264 FMO / ASD / RS, VC1 SP / MP / AP L4 and AVCHD are not supported. |
| MPEG4 SP ASP |
| - Below 1280 x 720 : 60 frame max |
| - Above 1280 x 720 : 30 frame max |
| H.263 is not supported. |
| GMC is not supported. |

| Audio Decoder |
|---|
| Supports up to WMA7, 8, 9 STD, 9 PRO, 10 PRO |
| WMA 9 PRO and WMA 10 PRO support: 5.1 channel. (LBR mode of WMA Pro is not supported) |
| WMA Lossless is not supported. |

Music

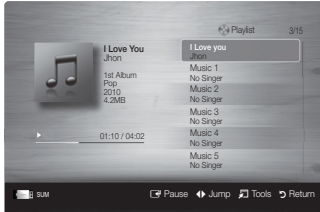

- Press the **◀** or **▶** button to select **Music**, then press the ENTER **↵** button in the **Media Play** menu.
- Press the **◀|▶/▲/▼** button to select the desired Music in the file list.
 - During music playback, you can search using the **◀** and **▶** button.
 - ⏮** (REW) and **⏭** (FF) buttons do not function during play.
 - Only displays the files with MP3 and PCM file extension. Other file extensions are not displayed, even if they are saved on the same USB device.
 - If the sound is abnormal when playing MP3 files, adjust the **Equalizer** in the **Sound** menu. (An over-modulated MP3 file may cause a sound problem.)
- Press the ENTER **↵** button or **▶** (Play) button.
 - During music playback, you can search using the **◀** and **▶** button.

Photos

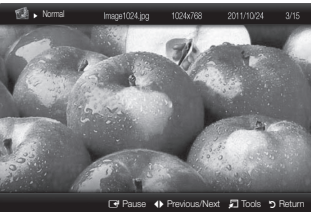

- Press the **◀** or **▶** button to select **Photos**, then press the ENTER **↵** button in the **Media Play** menu.
- Press the **◀|▶/▲/▼** button to select the desired photo in the file list.
- Press the ENTER **↵** button or **▶** (Play) button.

☞ **NOTE**

While a photo list is displayed, press the **▶** (Play) / ENTER **↵** button on the remote control to start the slide show.

All files in the file list section will be displayed in the slide show.

During the slide show, files are displayed in order.

During the slide show, you can adjust the slide show speed using **⏮** (REW) or **⏭** (FF) button.

You can move to other file using **◀** or **▶** button.

Music files can be automatically played during the Slide Show if the **Background Music** is set to **On**.

The **Mode in Background Music** cannot be changed until the BGM has finished loading.

• Supported Photo Formats

| Image | Photo | Resolution |
|-------|-------------|-------------|
| JPEG | Basic file | 1330 x 8704 |
| | Progressive | 1024 x 768 |

Other Restrictions

- CMYK, YCC Colour space JPEG are not supported.

Playing selected video/music/photo files

1. Press the Yellow button in the file list to select the desired file.

- Repeat the above operation to select multiple files.

☞ **NOTE**

The **•** mark appears to the left of the selected files.

To cancel a selection, press the Yellow button again.

To deselect all selected files, press the TOOLS button and select **Deselect All**.

3. Press the TOOLS button, and then select **Play Selected Contents**.

■ **Playing the video/music/photo file group**

While a file list is displayed, move to any file in desired group.

Media Play - Additional Functions

■ **Videos/Music/Photos Play Option menus**

When playing a file, press the TOOLS button.

| Category | Operation | Videos | Music | Photos |
|---|--|--------|-------|--------|
| Title | You can move the other file directly. | ✓ | | |
| Repeat Mode | You can play movie and music files repeatedly. | ✓ | ✓ | |
| Picture Size | You can adjust the picture size to your preference. | ✓ | | |
| Picture Mode | You can adjust the picture setting. | ✓ | ✓ | ✓ |
| Sound Mode | You can adjust the sound setting. | ✓ | ✓ | ✓ |
| Subtitle Setting | You can play the video with Subtitle. This function only works if the subtitles are the same file name as the video. | | | ✓ |
| Audio Language | You can change the audio language if the video has more than one language. | ✓ | | |
| Stop Slide Show / Start Slide Show | You can start or stop a Slide Show. | | | ✓ |
| Side Show Speed | You can select the slide show speed during the slide show. | | | ✓ |
| Background Music | You can set and select background music when watching a Slide Show. | | | ✓ |
| Zoom | You can zoom into images in full screen mode. | | | ✓ |
| Rotate | You can rotate images in full screen mode. | | | ✓ |
| Information | You can see detailed information about the played file. | ✓ | ✓ | ✓ |

Settings

Using the Setup Menu

■ **Information**: Select to view information on the connected device.

Other Information

Installing the Wall Mount Kit

The wall mount kit (sold separately) allows you to mount the TV on the wall. For detailed information on installing the wall mount, see the instructions provided with the wall mount. Contact a technician for assistance when installing the wall mount bracket.

Samsung Electronics is not responsible for any damage to the product or injury to yourself or others if you elect to install the TV on your own.

Wall Mount Kit Specifications (VESA)

The wall mount kit is not supplied, but sold separately.

Install your wall mount on a solid wall perpendicular to the floor. When attaching to other building materials, please contact your nearest dealer. If you install the TV on a ceiling or slanted wall, it may fall and result in severe personal injury.

☞ **NOTE**

Standard dimensions for wall mount kits are shown in the table below.

When purchasing our wall mount kit, a detailed installation manual and all parts necessary for assembly are provided.

Do not use screws that do not comply with the VESA standard screw specifications.

Do not use screws longer than the standard dimension, as they may cause damage to the inside of the TV set.

For wall mounts that do not comply with the VESA standard screw specifications, the length of the screws may differ depending on the wall mount specifications.

Do not fasten the screws too firmly. This may damage the product or cause the product to fall, leading to personal injury. Samsung is not liable for these kinds of accidents.

Samsung is not liable for product damage or personal injury when a non-VESA or non-specified wall mount is used or the consumer fails to follow the product installation instructions.

Do not mount the TV at more than a 15 degree tilt.

Always have two people mount the TV on a wall.

| Product Family | TV size in inches | VESA screw hole apcacs (A * B) in millimeters | Standard Screw | Quantity |
|----------------|-------------------|---|----------------|----------|
| LED-TV | 19-22 | 75 X 75 | M4 | 4 |
| | 26 | 100 X 100 | | |
| | 32-40 | 200 X 200 | M6 | |
| | 46-60 | 400 X 400 | M8 | |

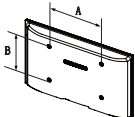

Do not install your Wall Mount Kit while your TV is turned on. It may result in personal injury due to electric shock.

Securing the TV to the Wall

Caution: Pulling, pushing, or climbing onto the TV may cause the TV to fall. In particular, ensure that your children do not hang over or destabilize the TV, doing so may cause the TV to tip over, resulting in serious injuries or death. Follow all safety precautions provided on the included Safety Flyer. For added stability, install the anti-fall device for safety purposes, as follows.

Troubleshooting

If you have any questions about the TV, first refer to this list. If none of these troubleshooting tips apply, please visit "www.samsung.com," then click on Support, or contact the call centre listed on the back-cover of this manual.

| Problem | Possible Solution |
|---|--|
| Picture Quality | |
| The TV image does not look as good as it did in the store. | <ul style="list-style-type: none">If you have an analogue cable/set top box, upgrade to a digital set top box. Use HDMI or Component cables to deliver HD (high definition) picture quality. Cable/Satellite subscribers: Try HD stations from the channel line up. Antenna connection: Try HD stations after performing Auto tuning. <ul style="list-style-type: none">Many HD channels are up scaled from SD(Standard Definition) contents. Adjust the Cable/Set top box video output resolution to 1080i or 720p. Make sure you are watching the TV at the minimum recommended distance based on the size and definition of the signal. |
| The picture is distorted: macroblock error, small block, dots, pixelization | <ul style="list-style-type: none">Compression of video contents may cause picture distortion especially in fast moving pictures such as sports and action movies. Low signal level or bad quality can cause picture distortion. This is not a TV issue. Mobile phones used close to the TV (cca up to 1m) may cause noise in picture on analogue and digital TV. |
| Colour is wrong or missing. | <ul style="list-style-type: none">If you're using a component connection, make sure the component cables are connected to the correct jacks. Incorrect or loose connections may cause colour problems or a blank screen. |
| There is poor colour or brightness. | <ul style="list-style-type: none">Adjust the Picture options in the TV menu. (go to Picture mode / Colour / Brightness / Sharpness) Adjust Energy Saving option in the TV menu. (go to MENU -> Setup - Eco Solution - Energy Saving) Try resetting the picture to view the default picture settings. (go to MENU - Picture - Picture Reset) |
| There is a dotted line on the edge of the screen. | <ul style="list-style-type: none">If the picture size is set to Screen Fit, change it to 16:9. Change cable/satellite box resolution. |
| The picture is black and white. | <ul style="list-style-type: none">If you are using an AV composite input, connect the video cable (yellow) to the Green jack of component input 1 on the TV. |
| When changing channels, the picture freezes or is distorted or delayed. | <ul style="list-style-type: none">If connected with a cable box, please try to reset the cable box. Reconnect the AC cord and wait until the cable box reboots. It may take up to 20 minutes. Set the output resolution of the cable box to 1080i or 720p. |
| Sound Quality | |
| There is no sound or the sound is too low at maximum volume. | <ul style="list-style-type: none">Please check the volume of the external device connected to your TV. |
| The picture is good but there is no sound. | <ul style="list-style-type: none">Set the Speaker Select option to TV Speaker in the sound menu. If you are using an external device, make sure the audio cables are connected to the correct audio input jacks on the TV. If you are using an external device, check the device's audio output option (ex. you may need to change your cable box's audio option to HDMI when you have a HDMI connected to your TV). If you are using a HDMI cable, a separate audio cable is required. If your TV has a headphone jack, make sure there is nothing plugged into it. |
| The speakers are making an inappropriate noise. | <ul style="list-style-type: none">Check the cable connections. Make sure a video cable is not connected to an audio input. For antenna or cable connections, check the signal strength. Low signal level may cause sound distortion. |
| No Picture, No Video | |
| The TV will not turn on. | <ul style="list-style-type: none">Make sure the AC power cord is securely plugged in to the wall outlet and the TV. Make sure the wall outlet is working. Try pressing the POWER button on the TV to make sure the problem is not the remote. If the TV turns on, refer to "The remote control does not work" below. |
| The TV turns off automatically. | <ul style="list-style-type: none">Ensure the Sleep Timer is set to Off in the Time menu. If your PC is connected to the TV, check your PC power settings. Make sure the AC power cord is plugged in securely to the wall outlet and the TV. When watching TV from an antenna or cable connection, the TV will turn off after 10 - 15 minutes if there is no signal. |
| There is no picture/video. | <ul style="list-style-type: none">Check cable connections (remove and reconnect all cables connected to the TV and external devices). Set your external devices' (Cable/Set top Box, DVD, Blu-ray etc) video outputs to match the connections to the TV input. For example, if an external device's output is HDMI, it should be connected to an HDMI input on the TV. Make sure your connected devices are powered on. Be sure to select the TV's correct source by pressing the SOURCE button on the TV remote. |

| Problem | Possible Solution |
|--|---|
| RF(Cable/Antenna) Connection | |
| The TV is not receiving all channels. | <ul style="list-style-type: none">Make sure the Antenna cable is connected securely. Please try Plug & Play (initial setup) to add available channels to the channel list. Go to MENU - Setup - Plug & Play (initial setup) and wait for all available channels to be stored. Verify the Antenna is positioned correctly. |
| The picture is distorted: macroblock error, small block, dots, pixelization | <ul style="list-style-type: none">Compression of video contents may cause picture distortion, especially on fast moving pictures such as sports and action movies. A low signal can cause picture distortion. This is not a TV issue. |
| PC Connection | |
| A "Mode Not Supported" message appears. | <ul style="list-style-type: none">Set your PC's output resolution so it matches the resolutions supported by the TV. |
| The video is OK but there is no audio. | <ul style="list-style-type: none">If you are using a HDMI connection, check the audio output setting on your PC. |
| Others | |
| The picture will not display in full screen. | <ul style="list-style-type: none">HD channels will have black bars on either side of the screen when displaying up scaled SD (4:3) contents. Black bars on the top and bottom will appear during movies that have aspect ratios different from your TV. Adjust the picture size options on your external device or TV to full screen. |
| The remote control does not work. | <ul style="list-style-type: none">Replace the remote control batteries with the poles (+/-) in the right direction. Clean the transmission window located on the top of the remote control. Try pointing the remote directly at the TV from 5-8 feet away. |
| The cable/set top box remote control does not turn the TV on or off, or adjust the volume. | <ul style="list-style-type: none">Programme the Cable/Set top box remote control to operate the TV. Refer to the Cable/Set top box user manual for the SAMSUNG TV code. |
| A "Mode Not Supported" message appears. | <ul style="list-style-type: none">Check the supported resolution of the TV, and adjust the external device's output resolution accordingly. Refer to resolution settings in this manual. |
| There is a plastic smell from the TV. | <ul style="list-style-type: none">This smell is normal and will dissipate over time. |
| TV is tilted to the right or left side. | <ul style="list-style-type: none">Remove the stand base from the TV and reassemble it. |
| There are difficulties assembling the stand base. | <ul style="list-style-type: none">Make sure the TV is placed on a flat surface. It is necessary to use magnetized screw driver if you cannot remove the screws from the TV. |
| The Channel menu is grey out (unavailable). | <ul style="list-style-type: none">The Channel menu is only available when the TV source is selected. |
| Your settings are lost after 30 minutes or every time the TV is turned off. | <ul style="list-style-type: none">If the TV is in the Store Demo mode, it will reset audio and picture settings every 30 minutes. Change the settings from Store Demo</ |