



Quick Start Guide

EN



READ ME FIRST

Window/ Door Sensor

At a Glance

Thank you for choosing the SwannOne™ Window/Door Sensor. The SwannOne Window/Door Sensor monitors the opening and closing of doors and windows, notifying you when changes occur via the SwannOne system.

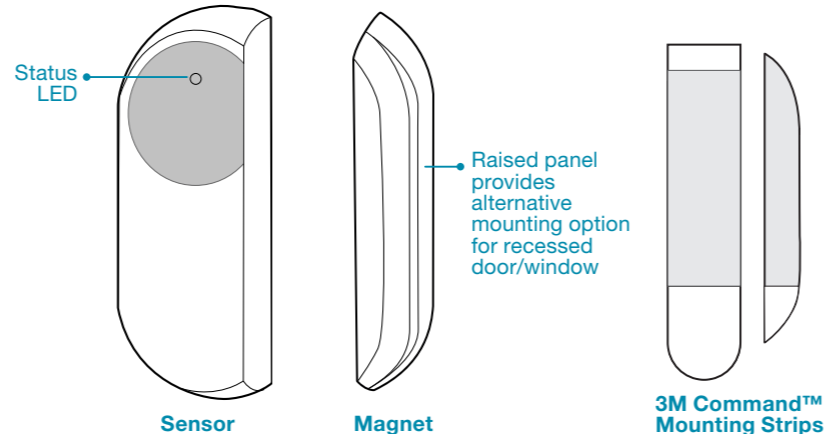

Compliance Information

FCC Statement

This device complies with part 15 of the FCC Rules. Operation is subject to the following two conditions: (1) This device may not cause harmful interference, and (2) This device must accept any interference received, including interference that may cause undesired operation.

Disposal and Recycling Information

Correct Disposal of this product. This marking indicates that this product should not be disposed with other household wastes throughout the EU. To prevent possible harm to the environment or human health from uncontrolled waste disposal, recycle it responsibly to promote the sustainable reuse of material resources. To return your used device, please use the return and collection systems or contact the retailer where the product was purchased. They can take this product for environment safe recycling.

Battery Safety Information

CAUTION: KEEP BATTERIES AWAY FROM SMALL CHILDREN. RISK OF EXPLOSION IF BATTERY IS REPLACED BY AN INCORRECT TYPE. DISPOSE OF USED BATTERIES PROMPTLY IN ACCORDANCE WITH LOCAL REGULATIONS.

SwannOne Warranty

SwannOne products are backed by a full 12 month guarantee from the date of purchase. In the unlikely event of anything going wrong, you can have confidence that your purchase is protected. Refer to swannone.com for terms and conditions.

Need Help?

	USA & Canada	1800 627 2799
	UK & Europe	0808 168 9031
	Australia	1800 788 210
	New Zealand	0800 479 266
	support@swannone.com	



© Swann Communications 2016

QSGWS170316E

1 Activate Sensor

- 1 Open the sensor by pushing back the release catch on top. The front panel should come off easily.
- 2 Remove the battery tab to activate the sensor.

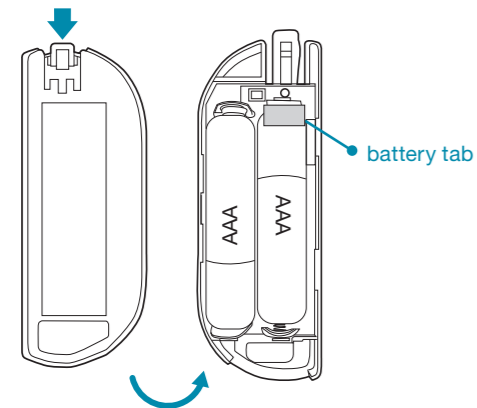

2 Pair Sensor

- 1 Sign in to your SwannOne account at home.swannone.com.
- 2 From your account dashboard, go to [My Settings > Window/Door Sensors](#) and add a device.
- 3 When the Setup page appears, put your Smart Hub in pairing mode by selecting [Learn devices](#).
- 4 Press the [Connect](#) button on the sensor. The status LED blinks once. When pairing is complete, the status LED blinks twice.

Check the Setup page to confirm the sensor was paired successfully, and then finish the setup process by following the on-screen instructions.

i If the sensor is not connecting as expected, perform a sensor reset by pressing and holding the **Connect** button until the status LED blinks rapidly, and then try pairing the sensor again.

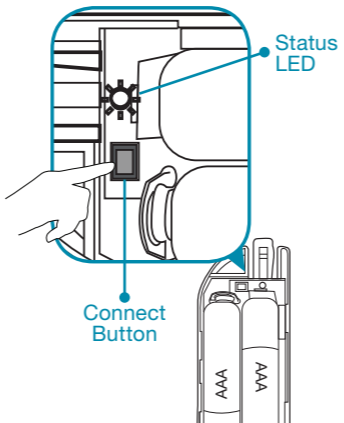

3 Mount Sensor



Take time to choose a location and properly check the orientation of the sensor and magnet. See **Sensor Placement Examples**. The sensor and magnet should ideally be positioned in a way that when the window/door is closed, they are aligned side by side, within $\frac{5}{16}$ " from each other.

- 1 Before applying Command™ strips, clean the surface where the sensor and magnet will be mounted with an alcohol/cleaning wipe, and let dry.
- 2 Fit the sensor and magnet with appropriate sized strips, and then firmly press onto surface for 30 seconds each to secure.

4 Test Sensor

To test if the sensor is working properly, simply open and then close the window/door. The status LED blinks each time the window/door is opened or closed. You will also receive notifications via the SwannOne app on your smartphone.

Sensor Placement Examples

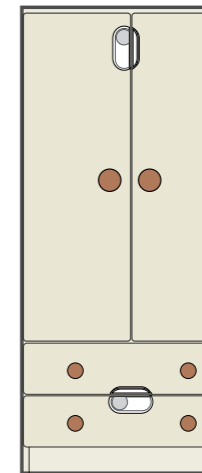

Cupboard

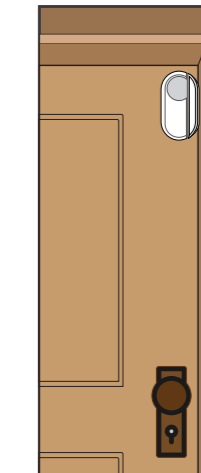

Recessed door

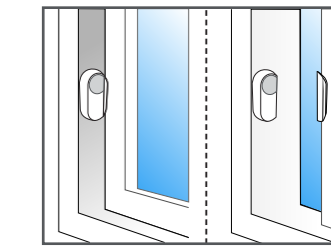

Sliding window