



HP Color LaserJet Enterprise MFP M681, M682 series

The pinnacle of performance and security



The world's most secure printing¹



Maximum productivity.
High-speed performance.



Powerful printing.
Energy smart.²

The world's most secure printing¹



Only HP enterprise printers repair themselves from attacks in real time while offering outstanding manageability. Automatically monitor threats, detect intrusions, and validate operating software while centrally managing your fleet with ease.



Always on guard

Only HP Enterprise printers offer built-in security features that are always on guard.¹

- With HP Sure Start, each device regularly checks its operating code and repairs itself from attempted hacks.
- Whitelisting checks firmware during startup to help ensure it's authentic, good code—digitally signed by HP.
- Run-time intrusion detection continually monitors activity to detect and stop attacks, then automatically reboots.
- HP Connection Inspector inspects outgoing network connections to stop suspicious requests like malware.

Thwart potential attacks by receiving instant notification of security issues. These devices work with leading Security Information and Event Management (SIEM) tools like Splunk, ArcSight, McAfee, and SIEMonster.

[▶ For more information](#)

Fleet management

HP Web Jetadmin visit: hp.com/go/wja

Solution brief: <http://h20195.www2.hp.com/V2/GetPDF.aspx/4AA5-2718ENW.pdf>

Video: <http://hp.brightcovegallery.com/solutions/detail/video/4271055504001/>

HP Universal Print Driver visit: hp.com/go/upd

Solution brief: <http://h20195.www2.hp.com/V2/GetPDF.aspx/4AA2-4781ENW.pdf>



Take security to the next level

Help protect your MFP with more than 250 embedded security features.³ Protect information on the MFP and in transit over the network. Store data on the 256-bit encrypted HP High-Performance Secure Hard Disk.

Easily develop, deploy, and integrate HP and third-party solutions with the HP Open Extensibility Platform. Add features such as card readers and more through the Hardware Integration Pocket.⁴ Equip your MFP to store and protect larger files with the optional 1 GB memory upgrade. Further safeguard data stored on the device, using the optional HP Trusted Platform Module.⁵



Centralize control to help build business efficiency

Centralize control of your printing environment with HP Web Jetadmin.⁶ Optional HP JetAdvantage Security Manager offers an effective, policy-based approach to help secure HP devices.⁷ Easily set security configuration policies and automatically validate settings across the fleet.

HP JetAdvantage Secure Print⁸ and HP Access Control (HPAC) help secure documents by requiring authentication to release print jobs. In addition, extend capabilities and easily customize with HPAC—integrate job accounting, manage rights, and establish quotas for things such as color use.⁹ Save IT time and make printing easy for the entire enterprise by using a single driver for all HP devices.¹⁰

Security

HP JetAdvantage Security Solutions visit: hp.com/go/printsecurity

Solution overview: <http://h20195.www2.hp.com/V2/GetPDF.aspx/4AA3-1295ENW.pdf>

Video: <http://hp.brightcovegallery.com/products/detail/video/4270905124001/>

HP JetAdvantage Security Manager visit: hp.com/go/securitymanager

Brochure: <http://h20195.www2.hp.com/V2/GetPDF.aspx/4AA3-9275ENW.pdf>

Video: <http://hp.brightcovegallery.com/products/detail/video/4270837770001/>

Maximum productivity. High-speed performance.

Get brilliant color prints with an MFP equipped for high-speed performance and designed for energy efficiency. Be confident that your employees can speed through their tasks without interruption.

Keep business moving

Breeze through tasks—the Flow MFP M682z prints your first page from ready as fast as 5.7 seconds, black/color.¹¹ Print two-sided documents as quickly as one-sided documents—up to 60 pages per minute (ppm) (M682z).¹²



Print directly from your smartphone, tablet, or notebook PC to your Wi-Fi Direct^{®13}/Bluetooth[®] Low Energy¹⁴ enabled MFP—without accessing the company network. Or choose a managed mobile print solution such as HP Access Control for advanced management and reporting capabilities.¹⁵

Loaded for productivity

Spend less time loading paper with a 3,200-sheet maximum capacity.¹⁶ Paper-handling options for this series include a 1x550-sheet/2,000-sheet HCI feeder and stand, 3x550-sheet feeder and stand, 550-sheet feeder with stand and cabinet, and 550-sheet feeder.¹⁷ The 550-sheet input trays fit a whole ream of paper and support paper sizes from 4 x 6 inch to legal (A6 to 216 x 356 mm).



Equip employees to breeze through tasks using the new, intuitive interface on the 9.0-inch (22.8 cm) functional touchscreen with 8.0-inch (20.3 cm) Color Graphics Display. For more information, see Appendix A on page 14. The 3-bin stapler/stacker with job offset allows you to set up each bin for a different department or option, such as face down, fax,¹⁸ and copy (Flow M681z and M682z models only).

Designed to conserve

Help keep productivity up and energy use down. This efficient MFP is designed for exceptionally low energy consumption—thanks to its innovative design and specially formulated toner.¹⁹



Help cut costs with HP Auto-On/Auto-Off Technology²⁰ and HP Instant-on Technology²¹—intelligence that readies your MFP right when you need it and turns it off when you don't. Print efficiently on lightweight, high-performance HP EcoFFICIENT paper—designed to save energy.

Powerful printing. Energy smart.²



Get exceptional print quality and help protect your printer, using Original HP Toner cartridges with JetIntelligence.



Exceptional print quality

Continue to count on consistently vibrant, professional-quality results. Specially formulated HP ColorSphere 3 toner is precisely tuned to match the powerful performance of your HP printer. Get the most from your cartridge with page maximizer technology that manages efficient toner use and cartridge performance.



Help protect your investment

Don't put your MFP—and print quality—at risk. Help retain the consistent Original HP quality you paid for with innovative, anti-fraud technology. Enable office-wide adherence to printing policies with cartridge authentication technology.



Ready to work, right away

Speed through print jobs right out of the box. This MFP is shipped with preinstalled, specially designed Original HP LaserJet toner cartridges with JetIntelligence. Auto seal removal enables simple and seamless cartridge replacement, so you can get back to business fast—without costly delays or frustrating messes.



Print uninterrupted with optional high-yield cartridges²² (black/color: 28,000/23,000 pages²³).

Give workgroups the speed they need



Accelerate workflow, improve accuracy, and easily connect people throughout your organization. Complete high-volume scan jobs fast—up to 180 ipm for Flow models²⁴—and avoid extra steps with an MFP designed for maximum productivity.

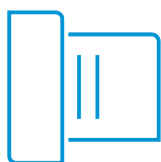

Fast, unattended scanning

Turn stacks of paper documents into digital files. Load up to 150 pages into the automatic document feeder for fast two-sided, single-pass scanning.²⁵ Spend less time waiting with two-sided scan speeds up to 120 images per minute (ipm), black and color²⁴ (up to 180 ipm²⁴ for the Flow models). Choose Flow models for advanced workflow features such as HP EveryPage and a pull-out keyboard.²⁶



Easily scan, copy, and fax

Easily make copies or send faxes using the scanner glass or the ADF. Scan a variety of media sizes from the ADF—from checks (2.7 x 5.8 in) to banners (8.5 x 34 in). Send scanned documents directly to email, network folders, LAN fax addresses,¹⁸ or Microsoft® SharePoint®. Walk up and print from or scan to a memory device using the easy-access USB.²⁷



Every page, every time

Capture every page easily—with confidence. HP EveryPage gives employees smooth paper-handling capabilities to detect potential errors or missed pages on the spot—for scan jobs of all kinds.²⁶

Help ensure every scanned document is properly oriented, cropped to size, and grayscale-optimized.

Flow MFP features²⁶



HP EveryPage featuring ultrasonic multi-feed detection



Faster scan speeds



Automatic page orientation, auto-crop, and auto-tone



Pull-out keyboard



Built-in OCR



Extended Life ADF

Get to know the HP Color LaserJet Enterprise MFP M681 series

HP Color LaserJet Enterprise Flow MFP M681z shown

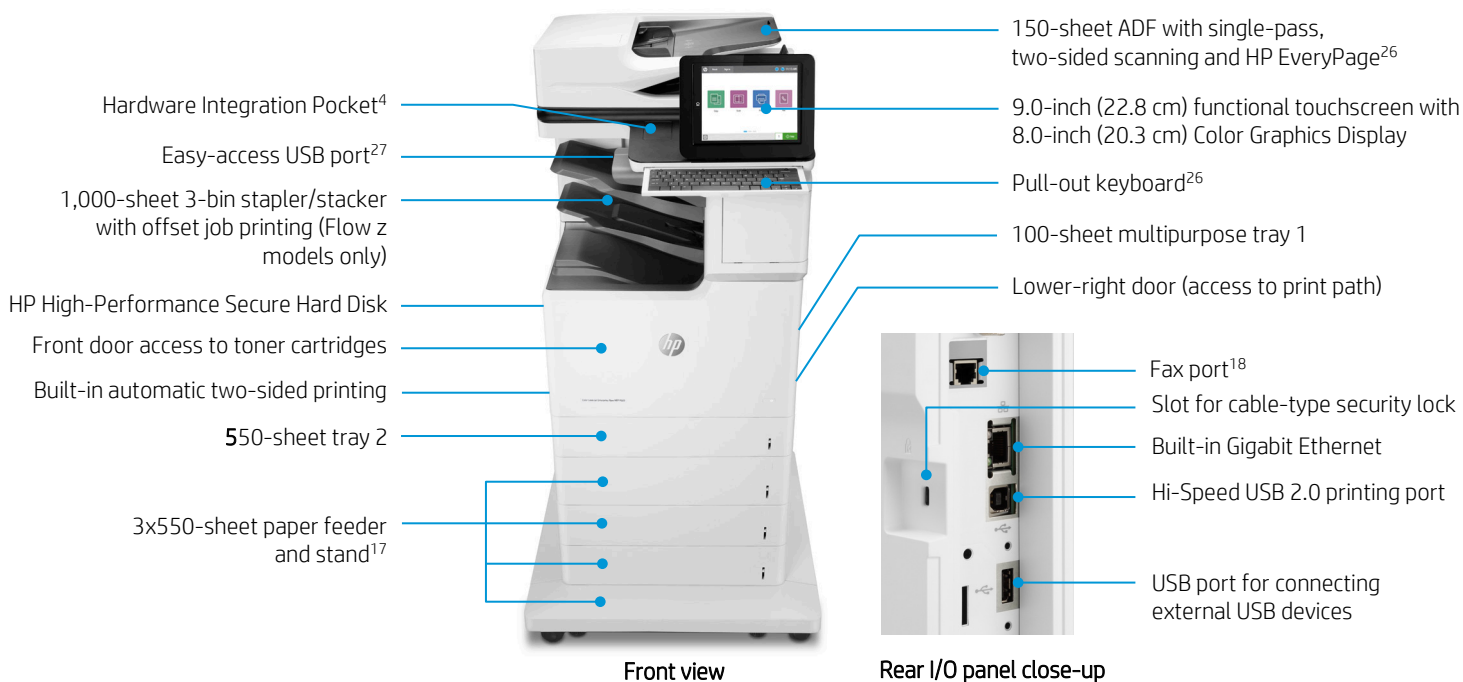

Series at a glance



MFP M681dh



MFP M681f



Flow MFP M681f



Flow MFP M681z



Flow MFP M682z

	MFP M681dh	MFP M681f	Flow MFP M681f	Flow MFP M681z	Flow MFP M682z
Part number	J8A10A	J8A11A	J8A12A	J8A13A	J8A17A
Print speeds (LTR/A4) ¹²	Up to 50/47 ppm	Up to 50/47 ppm	Up to 50/47 ppm	Up to 50/47 ppm	Up to 60/56 ppm
Fax capabilities	Optional	✓	✓	✓	✓
100-sheet tray 1, 550-sheet tray 2	✓	✓	✓	✓	✓
550-sheet paper feeder	Optional (up to two) ²⁸	Not available	Optional (up to two)	Not available	Not available
550-sheet paper feeder with stand and cabinet	Optional ²⁸	✓	Optional	Not available	Not available
3x550-sheet paper feeder and stand	Optional ²⁸	Not available	Optional	✓	Not available
1x550-sheet/2,000-sheet HCI feeder and stand	Optional ²⁸	Not available	Optional	Not available	✓
3-bin stapler/stacker with offset job printing	Not available	Not available	Not available	✓	✓
Advanced workflow features including pull-out keyboard	Not available	Not available	✓	✓	✓
Direct mobile printing	Optional wireless direct ¹³ /NFC ²⁹	Optional wireless direct ¹³ /NFC ²⁹	Optional wireless direct ¹³ /NFC ²⁹	Optional wireless direct ¹³ /NFC ²⁹	Embedded Wi-Fi Direct ¹³ /Bluetooth Low Energy ¹⁴
Wireless networking	Optional ³⁰	Optional ³⁰	Optional ³⁰	Optional ³⁰	Optional ³⁰

Get to know the HP Color LaserJet Enterprise Flow MFP M682z

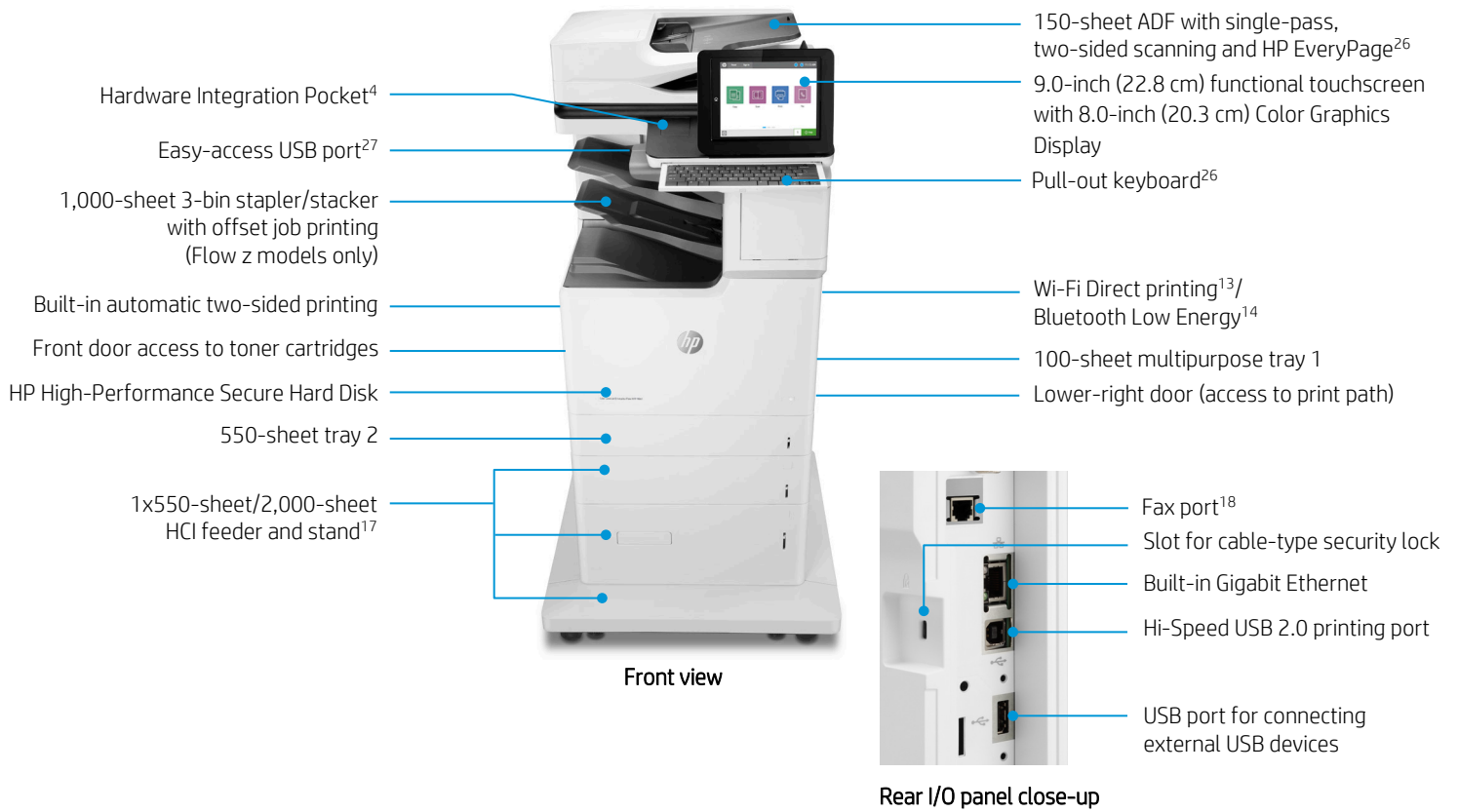

Paper-handling accessories



550-sheet Paper Feeder (P1B09A)

550-sheet Paper Feeder with Stand and Cabinet (P1B10A)

3x550-sheet Paper Feeder and Stand (P1B11A)

1x550-sheet/2,000-sheet HCI Feeder and Stand (P1B12A)

3-bin stapler/stacker

Standard		M681f	Flow M681z	Flow M682z	Flow M681z, Flow M682z
Optional	Add up to two: M681dh, ²⁸ Flow M681f	M681dh, Flow M681f	M681dh, Flow M681f	M681dh, Flow M681f	Not available

What's new



HP Color LaserJet Enterprise Flow MFP M682z



HP Color LaserJet Enterprise Flow MFP M680z

Benefits

Up to 60 ppm, simplex and duplex, black and color ¹²	Up to 45 ppm, simplex; up to 40 ipm, duplex ¹²	Save time with 33% faster simplex and 50% faster duplex output—with 100% duplex efficiency
Scanning up to 90 ipm, simplex and 180 ipm, duplex, black and color ²⁴ (Flow models)	Up to 65/63 ipm (black/color, simplex) and 89/66 ipm (black/color, duplex) ²⁴	Work more quickly with 43% faster simplex and 173% faster duplex color scanning
FPO (black) as fast as 5.7/12.5 seconds from ready/sleep ^{11,31}	FPO (black) as fast as 9.2/18.4 seconds from ready/sleep ^{11,31}	Less wait time with 38% faster FPO from ready and 32% faster from sleep
250+ embedded security settings, ³ including HP Sure Start, run-time intrusion detection, and whitelisting	HP Sure Start not available; Whitelisting and run-time intrusion detection available with firmware upgrade	Enhanced protection with key security technologies designed to thwart attackers' efforts and self-heal
3-bin stapler/stacker with job offset and up to 3,200-sheet input capacity; standard input trays hold 550 sheets	Offset job printing not available; up to 3,100-sheet input capacity; standard input trays hold 500 sheets	Improved paper-handling options; with 550-sheet trays, you can add a whole ream before the paper runs completely out
Original HP Toner cartridges with JetIntelligence; High-yield black/color (~28,000/23,000 pages) ^{22,23}	Original HP toner cartridges; High-yield black cartridge (~21,000 pages); ²³ no high-yield color	Get peak printing performance and anti-fraud technology

Technical specifications

	HP CLJ Enterprise MFP M681 dh	HP CLJ Enterprise MFP M681 f	HP CLJ Enterprise Flow MFP M681 f	HP CLJ Enterprise Flow MFP M681 z	HP CLJ Enterprise Flow MFP M682 z
Product number	J8A10A	J8A11A	J8A12A	J8A13A	J8A17A
Control panel/data entry	9.0-inch (22.8 cm) functional touchscreen with 8.0-inch (20.3 cm) Color Graphics Display; easy-access USB; Hardware Integration Pocket ⁴				
	Plus: pull-out keyboard (<i>Flow models</i>)				
Print speed (black and color, letter/A4)¹²	Simplex and duplex: up to 50/47 ppm				Simplex and duplex: up to 60/56 ppm
First page out (black and color)	From ready: ¹¹ as fast as 6.4/6.5 seconds (letter/A4) From sleep: ³¹ as fast as 8.9/9.0 seconds (letter/A4)		From ready: ¹¹ as fast as 6.4/6.5 seconds (letter/A4) From sleep: ³¹ as fast as 13.2/13.3 seconds (letter/A4)	From ready: ¹¹ as fast as 5.7/5.8 seconds (letter/A4) From sleep: ³¹ as fast as 12.5/12.6 seconds (letter/A4)	
Print resolution	Up to 600 x 600 dpi; up to 1200 x 1200 dpi (Fine lines); HP ImageREt 3600, PANTONE® calibrated				
Scanning resolution	Up to 600 dpi (<i>all models</i>)				
ADF scan speed (black and color)²⁴					
Single-sided	Up to 75/69 ipm (letter/A4)		Up to 90/83 ipm (letter/A4)		
Two-sided	Up to 120/111 ipm (letter/A4)		Up to 180/167 ipm (letter/A4)		
Features					
Printing	Print preview, duplex printing, print multiple pages per sheet (2, 4, 6, 9, 16), collation, watermarks, store print jobs				
Scanning	Flatbed scanner, up to 8.5 x 14 in (216 x 356 mm); 150-sheet ADF with two-sided, single-pass scanning; Advanced features: Optimize text/picture, image adjustments, job build, output quality setting, selectable scan resolution 75 to 600 dpi, auto detect color, edge erase, job notification, blank page suppression, Quick Sets				
	Plus: HP EveryPage with ultrasonic multi-feed detection, Embedded Optical Character Recognition (OCR), auto-orientation, auto-crop-to-page, auto-tone				
Digital sending	Scan to email, save-to-network folder, save-to-USB drive, send to Microsoft SharePoint, send to FTP, send to LAN fax (except M681 dh model), send to Internet fax, local address book, SMTP over SSL, blank page removal, edge erase, auto color sense, auto crop to content, compact PDF				
	Plus: OCR, auto-tone, auto-orientation, multi-pick detect, auto-straighten, auto-crop-to-page				
File formats ³²	PDF, JPEG, TIFF, MTIFF, XPS, PDF/A; Scan to easy-access USB: PDF, JPEG, TIFF, MTIFF, XPS, PDF/A; Print from easy-access USB: PDF, PS, Print Ready files (.prn, .pcl, .cht)				
	Plus: TEXT (OCR), Unicode TEXT (OCR), RTF (OCR), Searchable PDF (OCR), Searchable PDF/A (OCR), HTML (OCR), CSV (OCR); Scan to easy access USB: TEXT (OCR), Unicode TEXT (OCR), RTF (OCR), Searchable PDF (OCR), Searchable PDF/A (OCR), HTML (OCR), CSV (OCR)				
Copying	Auto scale, Reduce/Enlarge from scanner glass (25 to 400%), Collate, Auto-color detection, Two-sided copying, Job build, image adjustments (darkness, background clean-up, sharpness); Copy resolution: Up to 600 x 600 dpi				
Faxing	Fax speed: ³³ 3 seconds per page/33.6 kbps (letter/A4); fax forwarding, receive fax polling, broadcasting to up to 210 locations, speed dial up to 1000 numbers, each with 210 destinations, auto-fax reduction, auto-redialing, stored faxes, fax archiving, scale-to-fit, fax address book, LAN/Internet fax, fax number confirmation, holiday fax schedule Fax resolution: Standard 203 x 98 dpi, superfine 300 x 300 dpi, 256 levels of gray				
Processor	1.2 GHz (<i>all models</i>)				
Memory	1.5 GB upgradeable to 2 GB (printer), 512 MB (scanner)		1.5 GB upgradeable to 2 GB (printer), 1 GB (scanner)		
Storage	High-Performance Secure Hard Disk (AES 256 hardware encryption or greater); Secure erase capabilities: Secure File Erase-Temporary Job Files, Secure Erase-Job Data, Secure ATA Erase-Disk				

	HP CLJ Enterprise MFP M681dh	HP CLJ Enterprise MFP M681f	HP CLJ Enterprise Flow MFP M681f	HP CLJ Enterprise Flow MFP M681z	HP CLJ Enterprise Flow MFP M682z
Durability ratings					
RMPV ³⁴	2,000 pages to as high as 14,000 pages				3,000 pages to as high as 17,000 pages
RMSV ²⁵	14,250 pages to as high as 23,750 pages		26,750 pages to as high as 44,500 pages		
Duty cycle ³⁵	Up to 100,000 pages				Up to 120,000 pages
Media specifications					
Input capacity	Up to 650 sheets (up to 3,200 sheets maximum ¹⁶)	Up to 1,200 sheets (standard and maximum)	Up to 650 sheets (up to 3,200 sheets maximum ¹⁶)	Up to 2,300 sheets (standard and maximum)	Up to 3,200 sheets (standard and maximum)
	Tray 1: up to 100 sheets	Tray 1: up to 100 sheets	Tray 1: up to 100 sheets	Tray 1: up to 100 sheets	Tray 1: up to 100 sheets
	Tray 2: up to 550 sheets	Tray 2: up to 550 sheets	Tray 2: up to 550 sheets	Tray 2: up to 550 sheets	Tray 2: up to 550 sheets
		550-sheet feeder with stand and cabinet		3x550-sheet feeder and stand	1x550-sheet/2,000-sheet HCl feeder and stand
Output capacity	Up to 500 sheets			Up to 1,000 sheets with 3-bin stapler/stacker	
Two-sided printing	Automatic (<i>all models</i>)				
Media sizes	Tray 1: Letter, legal, executive, statement, Oficio, 3 x 5 in, 4 x 6 in, 5 x 7 in, 5 x 8 in, envelopes (No. 9, No. 10, Monarch); A4, A5, A6, RA4, B5, B6, 16K, 10 x 15 cm, Oficio, postcards (JIS single and double), envelopes (DL, C5, C6, B5); Custom media sizes: 3 x 5 to 8.5 x 14 in (76 x 127 to 216 x 356 mm)				
	Tray 2 and optional trays 3, 4, and 5: Letter, legal, executive, statement, Oficio, 4 x 6 in, 5 x 7 in, 5 x 8 in; A4, A5, A6, RA4, B5, B6, 10 x 15 cm, Oficio, 16K, Dpostcard; Custom media sizes: 4 x 5.8 to 8.5 x 14 in (102 x 148 to 216 x 356 mm)				
	Optional 2,000-sheet HCl (standard on Flow M682z, optional on M681dh and Flow M681f models only): Letter, legal; A4; Custom sizes not supported in this tray				
	Duplex: Letter, legal, executive, Oficio; A4, A5, RA4, B5, Oficio, 16K				
	ADF: Letter; legal, Oficio, executive, statement, 16K, 4 x 6 in, 5 x 7 in, 5 x 8 in; A4, RA4, A5, A6, B5, B6 (JIS), postcard (JIS), Dpostcard (JIS); Custom media sizes: 2.7 x 5.8 to 8.5 x 34 in (68 x 147 to 216 x 864 mm)				
Media weights	Tray 1: 16 to 58 lb (60 to 220 g/m ²) (plain); 32 to 58 lb (120 to 220 g/m ²) (glossy)				
	Tray 2, optional trays 3, 4, and 5, duplex: 16 to 90 lb (60 to 163 g/m ²) (plain); 32 to 58 lb (120 to 220 g/m ²) (glossy)				
	Optional 2,000-sheet high-capacity tray: 16 to 90 lb (60 to 163 g/m ²) (plain)				
	ADF: 12 to 53 lb (45 to 199 g/m ²)				
Media types	Paper (plain, light, bond, recycled, mid-weight, heavy, mid-weight glossy, heavy glossy, extra heavy, extra heavy glossy, cardstock, card glossy), color transparency, labels, letterhead, envelope, pre-printed, pre-punched, colored, rough, opaque film, user-defined				
Print languages					
	HP PCL 6; HP PCL 5c; HP postscript level 3 emulation, native PDF printing (v 1.7)				
Fonts					
	105 internal TrueType fonts scalable in HP PCL, 92 internal scalable fonts in HP Postscript level 3 emulation (Euro symbol built-in); 1 internal Unicode fonts (Andale Mono WorldType); 2 Internal Windows Vista® 8 fonts (Calibri, Cambria); additional font solutions available via third-party flash memory cards; HP LaserJet fonts and IPDS Emulation available at hp.com/go/laserjetfonts				
Connectivity					
	1 Hi-Speed Device USB 2.0; 2 Hi-Speed USB 2.0 Host (1 walk-up and 1 external accessible); 1 Gigabit Ethernet 10/100/1000T network; 1 Hardware Integration Pocket ⁴				
	Plus: Fax				
Mobile printing					
	HP ePrint, ³⁶ Apple® AirPrint®, ³⁷ Mopria-certified, Google Cloud Print™ 2.0 (<i>all models</i>)				
	Optional: Wireless direct printing ¹³ and NFC touch-to-print ²⁹ (with purchase of HP Jetdirect 3000w NFC/Wireless Accessory)				Plus: Wi-Fi Direct 802.11b/g/n ¹³ and Bluetooth Low Energy ¹⁴
Network capabilities					
	Standard: via HP Jetdirect Ethernet embedded print server supports: 10Base-T, 100Base-Tx, 1000Base-T; 802.3az (EEE) support on Fast Ethernet and Gigabit Ethernet; IPsec				
	Optional: 802.11a/b/g/n wireless networking (with purchase of optional HP Jetdirect 2900nw Print Server) ³⁰				
Network protocols					
	Via built-in networking solution: TCP/IP, IPv4, IPv6; Print: TCP-IP port 9100 Direct Mode, LPD (raw queue support only), Web Services Printing, IPP 2.0, Apple AirPrint, HP ePrint, FTP Print, Google Cloud Print; Discovery: SLP, Bonjour®, Web Services Discovery; IP Config: IPv4 (BootP, DHCP, AutoIP, Manual, TFTP Config, ARP-Ping), IPv6 (Stateless Link-Local and via Router, Statefull via DHCPv6); Management: SNMPv2/v3, HTTP/HTTPS, Telnet, TFTP Config, FTP FW Download, Syslog; Security: SNMPv3, SSL Cert Management, Firewall, ACL, 802.1x				

	HP CLJ Enterprise MFP M681dh	HP CLJ Enterprise MFP M681f	HP CLJ Enterprise Flow MFP M681f	HP CLJ Enterprise Flow MFP M681z	HP CLJ Enterprise Flow MFP M682z
Security	<p>Identity Management: Kerberos authentication, LDAP authentication, 1000 user PIN codes, optional HP and third-party advanced authentication solutions (e.g., badge readers)</p> <p>Network: IPsec/firewall with Certificate, Pre-Shared Key, and Kerberos authentication, Supports WJA-10 IPsec configuration Plug in, 802.1X authentication (EAP-PEAP, EAP-TLS), SNMPv3, HTTPS, Certificates, Access Control List</p> <p>Data: Storage Encryption, Encrypted PDF & Email (uses FIPS 140 validated cryptographic libraries from Microsoft), Secure Erase, SSL/TLS (HTTPS), Encrypted Credentials</p> <p>Device: Security lock slot, USB port disablement, Hardware Integration Pocket for security solutions,⁴ Intrusion Detection with Red Balloon Security Technology (Constant in-device monitoring for attacks), HP Sure Start Secure Boot (BIOS integrity checking with self-healing capability), Whitelisting (loads only known good code (DLLs, EXEs, etc.))</p> <p>Security Management: Compatible with HP JetAdvantage Security Manager,⁷ Device Security Syslog Messages processed and accessible in ArcSight and Splunk SIEMs</p>				
Compatible operating systems³⁸	<p>Windows® OS: Windows 10 all 32- and 64-bit editions (excluding RT OS for Tablets), Windows 7 all 32- and 64-bit editions, Windows 8/8.1 all 32- and 64-bit editions (excluding RT OS for Tablets), Windows Vista all 32-bit editions (Home Basic, Premium, Professional, etc.), Windows XP SP3 32-bit editions (XP Home, XP Pro, etc.)</p> <p>Mac OS: 10.12 Sierra, OS X 10.10 Yosemite, OS X 10.11 El Capitan</p> <p>Mobile OS: Android™</p> <p>Linux® Boss (5.0), Linux Debian (7.0, 7.1, 7.2, 7.3, 7.4, 7.5, 7.6, 7.7, 7.8, 7.9, 8.0, 8.1, 8.2, 8.3, 8.4, 8.5, 8.6), Linux Fedora (22, 23, 24), Linux Mint (17, 17.1, 17.2, 17.3, 18), Linux Red Hat Enterprise (6.0, 7.0), Linux SUSE (13.2, 42.1), Linux Ubuntu (12.04, 14.04, 15.10, 16.04, 16.10)</p> <p>Other OS: UNIX®</p>				
Compatible network operating systems	<p>Citrix® MetaFrame Presentation Server 3.0, Citrix MetaFrame XP Presentation Server (Feature Release 1, 2, and 3), Citrix on Windows Server® 2003/2003R2, Citrix on Windows Server 2008/2008R2/2008 R2 SP1, Citrix on Windows Server 2012/2012R2, Citrix Presentation Server 4.0/4.5, Citrix XenApp 5.0 (Plus Feature Pack 2 & 3) for Windows Server 2008 Terminal Services 32- and 64-bit, Citrix XenApp 6.0/6.5 [for Windows Server 2008 R2 Terminal Services, 32- and 64-bit], Citrix XenApp 6.0/6.5/7.5 [for Windows Server 2008 R2 SP1 Terminal Services, 32- and 64-bit], Citrix XenApp 7.5 [for Windows Server 2012 and 2012 R2 Terminal Services, 64-bit], Citrix XenDesktop® 5.6 [for Windows Server 2008 R2 Terminal Services, 32- and 64-bit], Citrix XenDesktop 5.6/7.0/7.5 [for Windows Server 2008 R2 SP1 Terminal Services, 32- and 64-bit], Citrix XenDesktop 7.0/7.5 [for Windows Server 2012 and 2012 R2 Terminal Services, 64-bit]</p> <p>Novell NetWare 6.5/SP8 Novell Clients novell.com/iprint, Novell iPrint Appliance v1.0, Novell Open Enterprise Server 11/SP1, Novell Open Enterprise Server 2 for Linux, Novell Servers novell.com/iprint</p> <p>Windows Server 2003/2003 R2 32-/64-bit (SP1/SP2) Standard/Enterprise/Datacenter (+ Cluster & Terminal Services), Windows Server 2003/2003 R2 32-bit (SP1/SP2), Standard/Enterprise (+ Cluster & Terminal Services), Windows Server 2008 32-/64-bit (SP2) Standard/Enterprise (+ Cluster & Terminal Services), Windows Server 2008 R2 64-bit (SP1) Standard/Enterprise (+ Cluster & Terminal Services), Windows Server 2008/2008 R2 32-/64-bit (SP1/SP2) Standard/Enterprise/Datacenter (+ Cluster & Terminal Services), Windows Server 2012/2012 R2 64-bit Standard/Foundation/Essentials/Datacenter (+ Cluster & Terminal Services), Windows Server 2016/ 64-bit Standard/ Essential/Datacenter (+ Cluster & Terminal Services)</p>				
System requirements, Windows	A compatible operating system (see above); 2 GB available hard disk space; OS hardware requirements (see microsoft.com)				
System requirements, Macintosh	A compatible operating system (see above); Internet; 1.3 GB available hard disk space; OS hardware requirements (see apple.com)				
Dimensions (width x depth x height)	Operating: 20.08 x 21.85 x 25.91 in (510 x 555 x 658 mm) Maximum: ³⁹ 37.91 x 30.31 x 35.83 in (963 x 770 x 910 mm)	Operating: 25.87 x 25.87 x 43.62 in (657 x 657 x 1108 mm) Maximum: ³⁹ 39.06 x 37.32 x 53.54 in (992 x 948 x 1360 mm)	Operating: 20.08 x 21.85 x 25.91 in (510 x 555 x 658 mm) Maximum: ³⁹ 37.91 x 30.31 x 35.83 in (963 x 770 x 910 mm)	Operating: 25.87 x 25.87 x 50.00 in (657 x 657 x 1270 mm) Maximum: ³⁹ 39.06 x 38.07 x 60.20 in (992 x 967 x 1529 mm)	Operating: 25.87 x 25.87 x 50.00 in (657 x 657 x 1270 mm) Maximum: ³⁹ 39.06 x 38.07 x 60.20 in (992 x 967 x 1529 mm)
Weight (with print cartridges)	93.2 lb (42.3 kg)	135.4 lb (61.5 kg)	94.4 lb (42.8 kg)	168.1 lb (76.3 kg)	168.1 lb (76.3 kg)
What's in the box	HP Color LaserJet Multifunction Printer; HP Black Original LaserJet Toner Cartridge (~12,500 yield), ²³ HP Cyan, Magenta and Yellow Original LaserJet Toner Cartridges (~10,500 yield each) ²³ (toner cartridges installed), CD with software drivers and documentation, Documentation (Hardware Install Guide), Power cord				
Warranty	One-year, next-business day, onsite warranty; Warranty and support options vary by product, country, and local legal requirements. Go to hp.com/support to learn about HP world-class service and support options in your region.				
Software included³²	HP Connected, HP Device Experience (DXP), HP PCL 6 (XPS) Printer Driver, HP Software Installer/Uninstaller, Mac OS Welcome Screen (directs users to 123.HP.com or OS App Source for printer software), Online user manuals				

	HP CLJ Enterprise MFP M681dh	HP CLJ Enterprise MFP M681f	HP CLJ Enterprise Flow MFP M681f	HP CLJ Enterprise Flow MFP M681z	HP CLJ Enterprise Flow MFP M682z
Downloadable software	HP Easy Start (Guided Software Install for Windows OS and Mac); HP ePrint Software (ePrint Mobile Driver for Windows); HP ePrint Software (for Windows); HP JetAdvantage Security Manager; ⁷ HP Mobile Printing hp.com/us/en/ads/mobility/overview.html ; HP PCL6 (XPS) print driver only (No installer for "Add Printer" installs); HP PCL6 (XPS) print driver with installer, Product Documentation and Support; HP Proxy Agent Software; HP Universal Print Drivers ¹⁰ (PCL6 and PS for Windows); Linux/Unix Print Drivers; Mac Software Solution; Printer Administrator Resource Kit; SAP (PS Print Drivers); HP Web Jetadmin; ⁶ Windows driver only solution; Windows Full Software Solution				
HP SureSupply supported	HP SureSupply alerts you when your print cartridge is running low and helps you purchase online or locally through HP or a participating retailer. Only available with Original HP supplies; Internet access required. To learn more, visit hp.com/go/SureSupply .				

Environmental and power specifications

	HP CLJ Enterprise MFP M681dh	HP CLJ Enterprise MFP M681f	HP CLJ Enterprise Flow MFP M681f	HP CLJ Enterprise Flow MFP M681z	HP CLJ Enterprise Flow MFP M682z
Environmental ranges					
Temperatures	Recommended operating: 63.5 to 77° F (17.5 to 25° C); Operating: 59 to 86° F (15 to 30° C); Storage: -4 to 104° F (-20 to 40° C)				
Relative Humidity	Recommended operating range: 30 to 70% RH; Operating range: 10 to 80% RH; Non-operating range: 10 to 90% RH				
Acoustic pressure emissions	Ready mode: 32 dB(A); Active print: 52 dB(A); Active copy: 56 dB(A); Active scan: 58 dB(A)				Ready mode: 32 dB(A); Active print: 53 dB(A); Active copy: 57 dB(A); Active scan: 57 dB(A)
Acoustic power emissions⁴⁰	Ready mode: 4.6 B(A); Active print: 6.6 B(A); Active copy: 7.0 B(A); Active scan: 7.3 B(A)				Ready mode: 4.6 B(A); Active print: 6.8 B(A); Active copy: 7.2 B(A); Active scan: 7.2 B(A)
Power specifications⁴¹					
Power supply	Built-in 110 or 240 VAC; Input voltage: 100 -127 VAC 50/60 Hz or 220 - 240 VAC 50/60 Hz				
Power consumption	Printing/copying: 900 watts; Ready: 47 watts; Sleep: 0.9 watts, Auto-Off/Manual On: 0.9 watts; Manual Off: 0.1 watts				
Typical Electricity Consumption (TEC)	2.72 kWh/week				
Energy-saving features	HP Auto-On/Auto-Off Technology; ²⁰ Instant-on Technology; Instant-on Copy				
Environmental specifications	ENERGY STAR® certified; CECP; EPEAT® Silver ⁴²				
				Plus: EPEAT® Gold ⁴² (Options AAZ, 201)	
Safety and regulatory compliance	EC 60950-1:2005 +A1:2009 +A2:2013 (International); EN60950-1:2006 +A11:2009 +A1:2010 +A12:2011 +A2:2013 (EU); EN 60825-1:2014 / IEC 60825-1:2014 (Class 1 Laser Product); EN 62479:2010 / IEC 62479:2010; Low Voltage Directive 2014/35/EU with CE Mark (Europe); GS Certificate (Germany, Europe); UL/cUL Listed and UC CoC (US/Canada); CAN/CSA C22.2 No. 60950-1-07 Amendment 2:2014; Other safety approvals as required by individual countries				Plus: EN 62311:2008 / IEC 62311:2007
Electromagnetic emission standard	CISPR 22:2008 (International) - Class A, CISPR 32:2012 (International) - Class A, EN 55032: 2012 (EU) - Class A, EN 61000-3-2: 2014, EN 61000-3-3: 2013, EN 55024: 2010, EMC Directive 2014/30/EU, FCC CFR 47 Part 15 Class A / ICES-003, Issue 6 Class A, Other EMC approvals as required by individual countries				
Telecom compliance	ES 203 021-1 v2.1.1; ES 203 021-2 v2.1.2; ES 203 021-3 v2.1.2; FCC Rules and Regulations 47 CFR Part 68; Other Telecom approvals as required by individual countries				Plus: EN 300 328 V1.9.16; EN 300 330-2 V1.6.1; EN 301 893 V1.8.1; R&TTE 1999/5/EC

Ordering information

Use accessories and supplies specifically designed for the MFP to help provide efficient performance. To order the accessories and supplies listed here, go to hp.com. To contact HP by country, please visit hp.com/go/contact. If you don't have access to the Internet, contact your qualified HP dealer or call HP (U.S.) at (800) 282-6672.

LaserJet	HP Color LaserJet Enterprise MFP M681 dh	J8A10A
	HP Color LaserJet Enterprise MFP M681 f	J8A11A
	HP Color LaserJet Enterprise Flow MFP M681 f	J8A12A
	HP Color LaserJet Enterprise Flow MFP M681 z	J8A13A
	HP Color LaserJet Enterprise Flow MFP M682z	J8A17A
Supplies²³	HP 655A Black Original LaserJet Toner Cartridge (~12,500 pages)	CF450A
	HP 657X High Yield Black Original LaserJet Toner Cartridge (~28,000 pages)	CF470X
	HP 655A Cyan Original LaserJet Toner Cartridge (~10,500 pages)	CF451A
	HP 657X High Yield Cyan Original LaserJet Toner Cartridge (~23,000 pages)	CF471X
	HP 655A Yellow Original LaserJet Toner Cartridge (~10,500 pages)	CF452A
	HP 657X High Yield Yellow Original LaserJet Toner Cartridge (~23,000 pages)	CF472X
	HP 655A Magenta Original LaserJet Toner Cartridge (~10,500 pages)	CF453A
	HP 657X High Yield Magenta Original LaserJet Toner Cartridge (~23,000 pages)	CF473X
	HP LaserJet 110V Maintenance Kit (~150,000 pages)	P1B91A
	HP LaserJet 220V Maintenance Kit (~150,000 pages)	P1B92A
	HP LaserJet Image Transfer Belt Kit (~150,00 pages)	P1B93A
	HP LaserJet Toner Collection Unit (~100,000 pages)	P1B94A
HP 300 ADF Roller Replacement Kit (~150,000 pages)	J8J95A	
HP Staple Cartridge Refill (5,000 staples)	J8J96A	
Accessories	HP Color LaserJet 550-sheet Paper Feeder	P1B09A
	HP Color LaserJet 550-sheet Paper Feeder with Stand and Cabinet	P1B10A
	HP Color LaserJet 3x550-sheet Paper Feeder and Stand	P1B11A
	HP Color LaserJet 1x550-sheet/2,000-sheet HCl Feeder and Stand	P1B12A
	HP LaserJet Keyboard Overlay Kit for Simplified Chinese and Traditional Chinese (Flow models only)	A7W12A
	HP LaserJet Keyboard Overlay Kit for Danish/French-Switzerland/German-Switzerland (in the box when ordering the BAZ option) (Flow models only)	A7W13A
	HP LaserJet Keyboard Overlay Kit for Swedish (Flow models only)	A7W14A
	HP 1GB DDR3 x32 144-Pin 800MHz SODIMM	E5K48A
	HP Trusted Platform Module Accessory	F5S62A
	HP Foreign Interface Harness	B5L31A
	HP Jetdirect 2900nw Print Server	J8031A
	HP Jetdirect 3000w NFC/Wireless Accessory ^{13,29}	J8030A
	HP LaserJet MFP Analog Fax Accessory 500	CC487A
HP Internal USB ports	B5L28A	
HP Services	Make sure your imaging and printing investments are protected with Care Pack, part of HP Care. Pick your package of services to keep your MFP running and your business moving. Now your office can spend less time trouble-shooting and more time getting things done. For details, visit hp.com/go/cpc . ⁴³	
Boost performance—it's your choice. HP Care provides options to help you manage imaging and printing—from Care Pack services to customizable and advisory services. With HP Managed Print Services, we oversee everything for you.	HP Installation Service with Network Workgroup Printer	U9JT2E
	HP 3 year Next Business Day Onsite	U9NP3E
	HP 5 year Next Business Day Onsite	U9NP5E
	HP 3 year 4 Hour 9x5 Onsite	U9NP6E
Solutions	HP Web Jetadmin: hp.com/go/wja	
	HP Universal Print Driver: hp.com/go/upd	
	HP JetAdvantage Security Manager: hp.com/go/securitymanager	
	HP JetAdvantage On Demand Cloud Solutions: hp.com/go/jetadvantageondemand	
	HP LaserJet fonts, barcodes, and IPDS Emulation available at hp.com/go/laserjetfonts To learn more about available infrastructure, management, and workflow solutions, visit hp.com/go/printing_solutions	

Appendix A: Control panel features

Upgrade to a modern interface

The HP Color LaserJet Enterprise MFP M681/M682 series is powered by HP FutureSmart 4.0 firmware. Its modern, tablet-like interface keeps things simple and intuitive across your fleet of Enterprise devices. A scalable control panel interface improves future extensibility and allows for customization, along with a robust set of new apps and usability features. You can even customize with your own wallpaper image and company logo. The new Message Center, with more detailed information and helpful animations, makes it easy to address device events. The simplified home screen displays just four core apps by default (three apps for products without fax). Additional apps are easily accessed by swiping right to left, like with a smartphone or tablet.

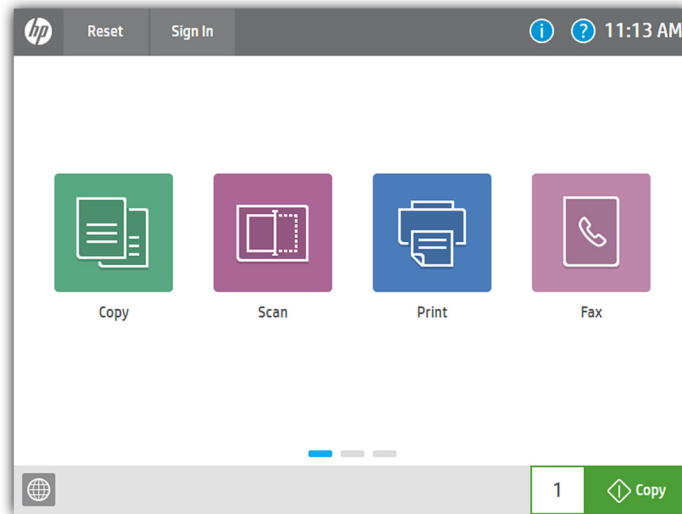

Edit jobs right at the MFP

The control panel features an enhanced image preview—now for both copies and scans. Right from the device's 9.0-inch (22.8 cm) functional touchscreen with 8.0-inch (20.3 cm) Color Graphics Display, you can easily preview and edit scans before sending them. You can apply changes (like rotating) to a single page, or to multiple pages at once. Batch separation allows users to create separate PDF or PDF/A files from scanned pages. The Flow MFP M681f, M681z, and M682z models can also create PDF OCR and PDF/A OCR files.



The new user interface enables **swiping**, **rotate**, and **drag-and-drop** capabilities

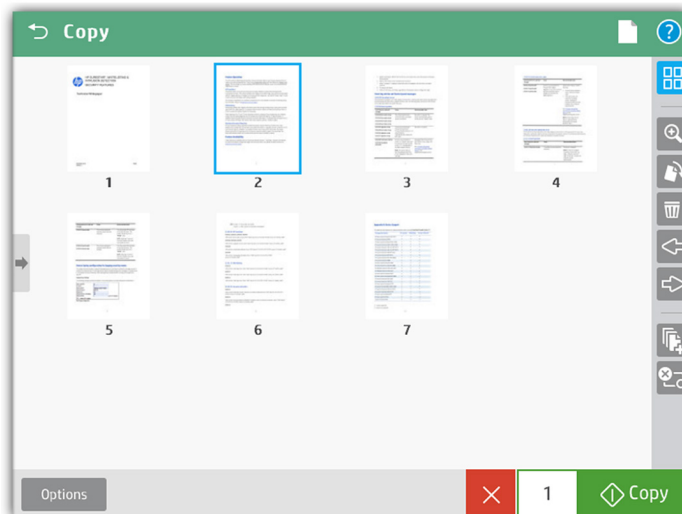

- Zoom
- Rotate pages
- Delete pages
- Change page order
- Add pages (job build)
- Cancel job

You can start a **preview** prior to committing to the copy job

Use Quick Sets to launch automated workflows

The MFP's digital sending capability allows users to route documents to a variety of destinations like email recipients, network folders, fax, FTP, a USB device, or Microsoft SharePoint.

Quick Sets automate all of the steps of a complicated workflow and provide easy access to the configurations you use most, such as page size, resolution, and file format. You can also specify security settings, such as encrypted PDFs to be delivered through encrypted and signed emails.

Help users find what they need by moving individual Quick Sets to any screen or folder using the home screen customization feature. With Quick Sets, IT can promote or block access to certain device features. Calls to the helpdesk can be reduced when users have everything they need and are restricted from accessing settings they shouldn't tamper with.

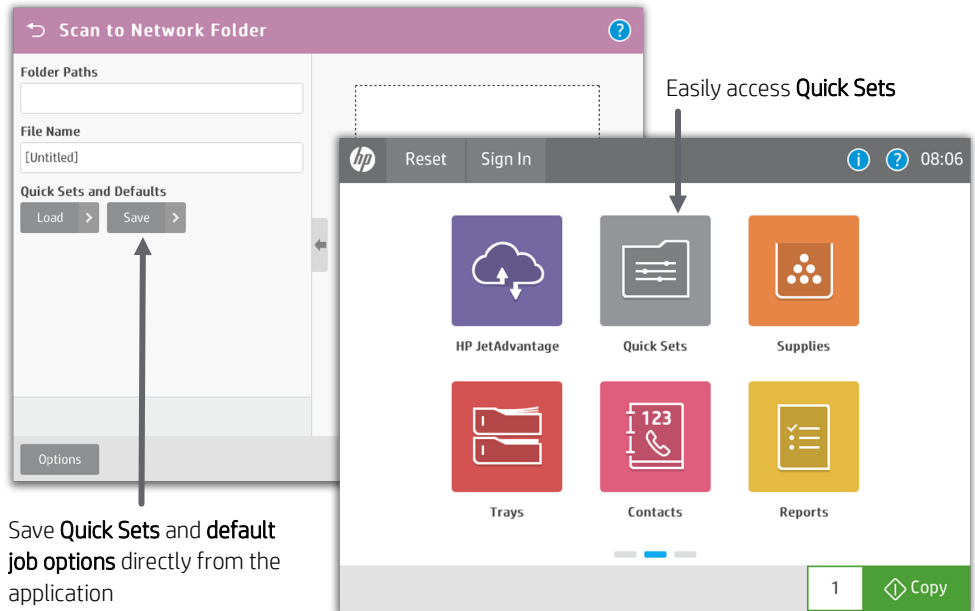

Save **Quick Sets** and **default job options** directly from the application

Troubleshoot with ease

The HP Color LaserJet Enterprise MFP M681/M682 series can help save your IT department valuable time when it comes to troubleshooting problems. The Remote Control Panel allows users to operate the user interface remotely, so IT can troubleshoot problems without running to the MFP.⁴⁴ Users can also quickly troubleshoot technical issues with HP's innovative, cloud-based Online Help services that are relevant and up to date. Easily solve problems from your PC or mobile device. A Quick Response (QR) code on the touchscreen links to Online Help using smart phones and tablets.⁴⁵ You can also find these links in the HP Embedded Web Server event log.

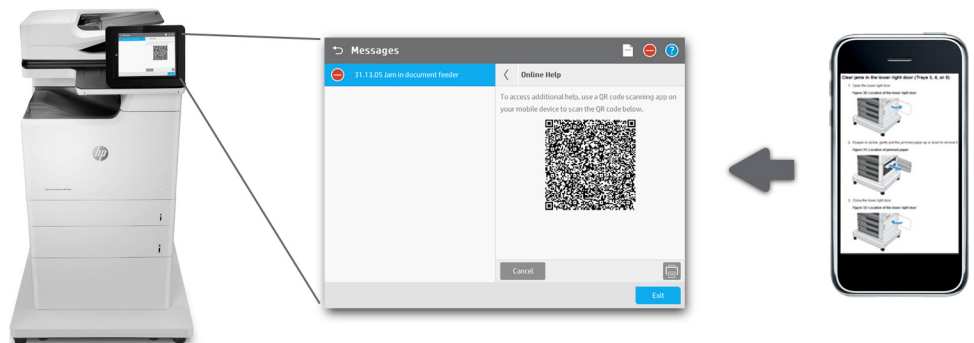

¹ Based on HP review of 2018 published security features of competitive in-class printers. Only HP offers a combination of security features that can monitor to detect and automatically stop an attack then self-validate software integrity in a reboot. For a list of printers, visit hp.com/go/PrintersThatProtect. For more information: hp.com/go/printersecurityclaims.

² Based on the reduced energy use of HP LaserJet printers and cartridges with JetIntelligence introduced since 2015 compared to previous toner versions without JetIntelligence, using ENERGY STAR[®] methodology.

³ Some features require additional purchase. A FutureSmart service pack update may be required to activate security features. Learn more at hp.com/go/printsecurity.

⁴ Solutions deployed through the Hardware Integration Pocket (HIP) may require additional purchase.

⁵ Use of the optional HP Trusted Platform Module accessory may require a firmware upgrade.

⁶ HP Web Jetadmin is available for download at no additional charge at hp.com/go/wja.

⁷ HP JetAdvantage Security Manager must be purchased separately. For details, see hp.com/go/securitymanager.

⁸ HP JetAdvantage Secure Print works with any network-connected printer or MFP. On-device authentication is available for many HP LaserJet, PageWide, and OfficeJet Pro devices and selected non-HP devices. Some devices may require a firmware upgrade. Internet connection required for cloud storage and retrieval of print jobs. Print-job release from a mobile device requires a network connection and QR code. For more information and a list of supported printers and MFPs, see hp.com/go/JetAdvantageSecurePrint.

⁹ Color access control capabilities vary from device to device.

¹⁰ The HP Universal Print Driver is available for download at no additional charge at hp.com/go/upd.

¹¹ Measured using ISO/IEC 17629. For more information, see hp.com/go/printerclaims. Exact speed varies depending on the system configuration, software application, driver, and document complexity.

¹² Measured using ISO/IEC 24734; excludes first set of test documents. For more information, see hp.com/go/printerclaims. Exact speed varies depending on the system configuration, software application, driver, and document complexity.

¹³ Wi-Fi Direct printing is embedded in the HP Color LaserJet Enterprise Flow MFP M682z model. All other models can add wireless direct by purchasing the optional HP Jetdirect 3000w NFC/Wireless Direct Accessory. Mobile device needs to be connected directly to the signal of a Wi-Fi Direct[®] supported MFP or printer prior to printing. Depending on mobile device, an app or driver may also be required. For details, see hp.com/go/mobileprinting. Wi-Fi Direct is a registered trademark of Wi-Fi Alliance[®].

¹⁴ Bluetooth[®] Low Energy is standard only on the HP Color LaserJet Enterprise Flow MFP M682z, and it cannot be added to other models.

¹⁵ Requires purchase of server software such as HP Access Control Secure Pull Printing. Learn more at hp.com/go/businessmobileprinting.

¹⁶ Purchase of optional paper trays may be required to reach maximum input capacity.

¹⁷ Standard and optional paper-handling accessories vary by model. See Series at a glance, page 6, for details.

¹⁸ Fax capability is optional on the HP Color LaserJet Enterprise MFP M681dh model; it is included on all other models.

¹⁹ Energy claim based on TEC data reported on energystar.gov as of January 2017. Data normalized to determine energy efficiency of in-class laser printers with published speed of 50 to 60 ppm. Subject to device settings. Actual results may vary.

²⁰ HP Auto-On/Auto-Off Technology capabilities are subject to printer and settings.

²¹ Compared with products that use traditional fusing.

²² HP 657X High Yield Original LaserJet Toner cartridges are not included in printer purchase; purchase separately. Learn more at hp.com/go/learnaboutsplies.

²³ Toner cartridge yields established using ISO/IEC test standards. Actual yields and costs vary considerably depending on images printed, number of color pages printed, and other factors.

²⁴ Scan speed measured from ADF at default 300 dpi (black-and-white, grayscale, and color). Actual processing speeds may vary depending on scan resolution, network conditions, computer performance, and application software.

²⁵ The Recommended Monthly Scan Volume (RMSV) is up to 23,750 pages for the M681dh/f models and up to 44,500 for the Flow models. HP recommends that the number of scanned pages per month be within the stated range for optimum device performance, based on factors including supplies replacement intervals and device life over an extended warranty period.

²⁶ The pull-out keyboard and HP EveryPage are only available on the HP Color LaserJet Enterprise Flow MFP M681f/z and Flow MFP M682z models.

²⁷ An administrator must enable the easy-access USB port before use.

²⁸ All models come standard with the 100-sheet multipurpose tray 1 and 550-sheet tray 2. In addition, the M681dh can add up to two additional 550-sheet paper feeders; or, it can add one of the other accessories (550-sheet paper feeder with stand and cabinet, 3x550-sheet paper feeder and stand, or 1x550-sheet/2,000-sheet HCl feeder and stand).

²⁹ Touch-to-print capability is optional for all models (except the Flow MFP M682z) with the purchase of the optional HP Jetdirect 3000w NFC/Wireless Direct Accessory. Mobile device must support Near Field Communication (NFC)-enabled printing. For more information, see hp.com/go/businessmobileprinting.

³⁰ All models can add wireless networking with the purchase of the optional HP Jetdirect 2900nw Print Server. Wireless performance is dependent on physical environment and distance from access point, and may be limited during active VPN connections.

³¹ Measured after 15 minutes in sleep. Exact speed varies depending on the system configuration, software application, driver, document complexity, and time in sleep.

³² Scan software not included in box. HP Scan and TWAIN driver available for download: hp.com/support.

³³ Based on standard ITU-T test image #1 at standard resolution and MMR encoding, the HP fax device can transmit at 3 sec/page for V.34 and 6 sec/page for V.17.

³⁴ Recommended Monthly Page Volume: HP recommends that the number of printed pages per month be within the stated range for optimum device performance, based on factors including supplies replacement intervals and device life over an extended warranty period.

³⁵ Duty cycle is defined as the maximum number of pages per month of imaged output. This value provides a comparison of product robustness in relation to other HP LaserJet or HP Color LaserJet devices, and enables appropriate deployment of printers and MFPs to satisfy the demands of connected individuals or groups.

³⁶ Printer requires ePrint account registration. App or software may be required. Wireless operations are compatible with 2.4 GHz operations only. Learn more at hp.com/go/mobileprinting.

³⁷ Supports the following devices running iOS 4.2 or later: iPad[®], iPad[®] 2, iPhone[®] (3GS or later), iPod[®] touch[®] (3rd generation or later). Works with HP's AirPrint[®]-enabled printers and requires the printer be connected to the same network as your iOS device. Wireless performance is dependent on physical environment and distance from the access point.

³⁸ Full solution software available only for Windows 7 and newer, UPD software available only for Windows 7 and newer, HP Software for Mac and Windows is no longer included on the CD, but can be downloaded from 123.hp.com. Legacy Windows Operating Systems (XP, Vista, and equivalent servers) get print and scan drivers only with a reduced feature set, Windows RT OS for Tablets (32- and 64-bit) uses a simplified HP print driver built into the RT OS.

³⁹ Maximum dimensions of the device are measured with all paper trays folded out and standard accessories installed.

⁴⁰ Printing mono simplex A4 at 47 ppm (M681 series) and 57 ppm (M682 series). Scanning mono simplex A4 at 96 ppm. Acoustic values are subject to change. For current information, see hp.com/support.

⁴¹ Power requirements are based on the country/region where the printer is sold. Do not convert operating voltages. This will damage the printer and void the product warranty.

⁴² EPEAT[®] registered where applicable. EPEAT registration varies by country. See epeat.net for registration status by country.

⁴³ Service levels and response times may vary depending on your geographic location. Service starts on date of hardware purchase. Restrictions and limitations apply. For details, visit hp.com/go/cnc.

⁴⁴ Availability dependent on firmware or software updates or upgrades.

⁴⁵ Online Help must be enabled on the printer or MFP. Mobile device must have an Internet connection to access online services.

Sign up for updates
hp.com/go/getupdated



© Copyright 2017, 2019 HP Development Company, L.P. The information contained herein is subject to change without notice. The only warranties for HP products and services are set forth in the express warranty statements accompanying such products and services. Nothing herein should be construed as constituting an additional warranty. HP shall not be liable for technical or editorial errors or omissions contained herein.

AirPrint, Apple, Bonjour, iPad, iPhone, and iPod touch are trademarks of Apple Inc. Android and Google Cloud Print are trademarks of Google Inc. Bluetooth is a trademark owned by its proprietor and used by HP Inc. under license. Citrix and XenDesktop are registered trademarks of Citrix Systems, Inc. and/or one more of its subsidiaries, and may be registered in the United States Patent and Trademark Office and in other countries. ENERGY STAR is a registered trademark owned by the U.S. Environmental Protection Agency. Linux is the registered trademark of Linus Torvalds in the U.S. and other countries. Microsoft, Windows, Windows Server, and Windows Vista are U.S. registered trademarks of the Microsoft group of companies. UNIX is a registered trademark of The Open Group.

4AA6-9307ENUC, October 2019, Rev. 2

