

# LABELWORKS LW-Z700

## User's Guide Ver.01



Read this document carefully to use this product safely and correctly. If your product is faulty, please read the included warranty card and contact the store you purchased it from. If you require further assistance, contact your local Epson customer support center.

Please also visit the support page of your local Epson website. You can download the latest version of this User's Guide from the website.

Portions of this software are copyright 2016 The FreeType Project (www.freetype.org). All rights reserved.

### International ENERGY STAR® Compliance Statement

The purpose of the International ENERGY STAR® Program is to promote the development and popularization of energy-efficient office equipment. As an ENERGY STAR® Partner, Seiko Epson Corporation has determined that this product meets the ENERGY STAR® guidelines for energy efficiency.



### Notation used in this manual

**⚠ DANGER** Handling the product improperly by ignoring this symbol can result in immediate danger of death or serious injury.

**⚠ WARNING** Handling the product improperly by ignoring this symbol can lead to death or serious injury.

**⚠ CAUTION** Handling the product improperly by ignoring this symbol can lead to injury and property damage.

**Attention** Important information.

**MEMO** Supplementary note

Reference page in this manual.

Example of label artwork.

Buttons on the product.

"Name" Menus and messages shown on the display, and manual names are enclosed in double quotes.

## Included Items

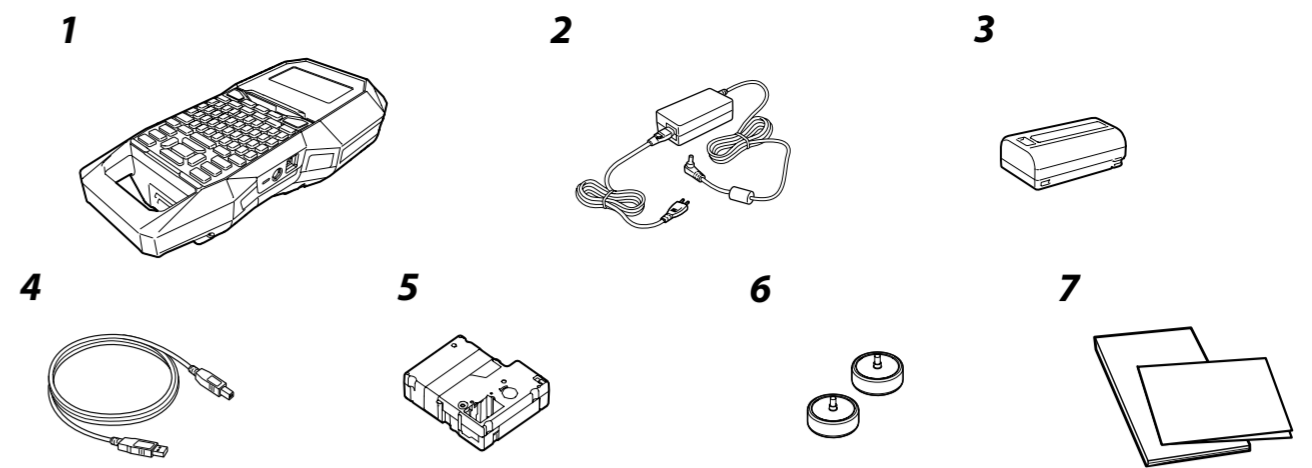

The included items differ depending on the type of printer package you purchased. Use the following table to check the items.

No.	Included item name	Package name
		LW-Z700 FK
1	LW-Z700	✓
2	AC adapter	✓
3	Li-ion battery (CS2CE97010)	✓
4	USB cable	✓
5	LK tape cartridge	✓
6	Magnetic attachment	✓
7	Documents	✓

### MEMO

You can download "Label Editor" (PC application for editing labels), printer drivers, "Label Editor User's Guide" and LW-Z700 User's Guide (PDF version) from your local Epson website.

## Specifications

### Body

Dimensions	Approx. 136 (W) x 298 (D) x 90 (H) (mm)
Weight	Approx. 1,110 g (excluding batteries, tape cartridge)

### Usage conditions

Operating temperature	5 to 35 degrees C
Storage temperature	-10 to 55 degrees C

### Supported tape width

4 mm, 6 mm, 9 mm, 12 mm, 18 mm, 24 mm

### Power supply

#### Battery

Li-ion battery x 1 / AA alkaline battery x 6

#### AC adapter

Type	AST1116Z2-1
Manufacturer	Seiko Epson Corp.
Input	AC100-240V, 0.4A, 50-60Hz (dedicated adapter, power cable only)
Output	DC11V, 1.64A
Total output power	18 W

### Li-ion battery specifications

#### Ambient temperature

During operation	0 to 40 degrees C	
Charge	0 to 40 degrees C	
During storage	Less than 1 month	-20 to 50 degrees C
	Less than 3 month	-20 to 40 degrees C
	Less than 1 year	-20 to 20 degrees C

### Charging information

Nominal specifications	Charging current (Std.)	1.0 A
	Charging voltage (Std.)	8.05 V
	Charging time	Approx. 3 hours
Charge limits	Battery pack model	CS2CE97010
	Maximum charge current, A	1.0 A
	Maximum charge voltage, V	8.4 V

### Rated time when using alkaline batteries

Rated operating time / Rated resting time	0.5h / 1.0h
-------------------------------------------	-------------

## Safety Instructions

For your safety, read the attached documents carefully to use this product correctly. After you have read all instructions, keep this manual handy for future reference and to make your concerns clear. Items below indicate safety precautions to protect users, their surroundings and their property from possible injury or damage.

### Meaning of the symbols

	This indicates an important reminder.
	This indicates a prohibited item.
	This indicates a mandatory procedure.

### ⚠ DANGER

#### When handling batteries

If any liquid from the battery gets into your eyes, promptly wash it with clean water for more than 10 minutes and consult your doctor at once. If you do not, the liquid may cause loss of eyesight. Never disassemble or modify the battery pack. This may cause fire, explosion, leakage, overheating or damage. Do not expose the battery to fire or heat it. This may cause fire, explosion, leakage, overheating or damage.

### ⚠ WARNING

#### When using the AC adapter and power cable

The cords included with this product contain chemicals, including lead, known to the State of California to cause birth defects or other reproductive harm. **Wash hands after handling.** (This notice is provided in accordance with Proposition 65 in Cal. Health & Safety Code §25249.5 and following.)

Do not use any AC adapter or power cable other than the dedicated AC adapter and power cable. Do not use the AC adapter with other than the specified voltage also. Otherwise, damage, overheating, fire or electric shock may occur.

Take the following precautions when handling the AC adapter and power cable.

- Make sure to avoid using multi-socket adapters.
- Make sure the plug is not dusty before inserting it into an outlet. Insert the plug firmly into the outlet.
- Do not hold the AC adapter or the plug with wet hands.
- Do not pull the power cable when disconnecting the plug. Be sure to hold the plug when disconnecting it.
- Do not make any modification to the AC adapter or power cable.
- Do not apply strong shocks to or put a heavy object on the AC adapter or power cable.
- Do not bend or twist the AC adapter or power cable forcibly.
- Do not place the AC adapter or power cable near a heater.

Do not use any damaged AC adapter or power cable. Otherwise, damage, overheating or smoking may occur, which may result in fire or electric shock.

Do not touch the plug during thunderstorms.

#### When handling batteries

- Keep the battery pack away from fire or flame if it produces a strange odor or leakage. Otherwise fire or explosion may occur.
- Should any battery liquid get on skin or clothing, promptly wash it off with clean water. If you do not, the liquid may damage your skin.
- Do not expose the battery to water. Do not allow water to contact the terminals. This may cause fire, overheating, or electric shock.
- Keep batteries out of reach of children. They are extremely dangerous if swallowed. Contact a doctor immediately if swallowed.

#### When using this product

Do not apply any strong force or shocks to the product such as standing on, dropping or hitting it. Otherwise, the product may be broken, which may result in fire or electric shock. If it is damaged, turn off the power immediately, unplug the AC adapter and remove the batteries, and then contact the Epson customer support center. Continuous use may result in fire or electric shock.

Take care not to spill any beverage such as tea, coffee or juice onto the product, or to spray aerosol insecticide. It may cause malfunction, fire, or electric shock. If any liquid has been spilled on the product, turn off the power, unplug the AC adapter and remove the batteries immediately, and then contact the Epson customer support center. Continuous use may result in fire or electric shock.

Do not touch the printhead because it becomes very hot. Otherwise, there is a risk of burns.

Do not open any covers other than the top cover or battery cover. Doing so may result in fire or electric shock. Always use the product as instructed in this manual. Otherwise, damage or injury may occur.

Never modify or disassemble this product. Doing so may cause fire or electric shock. Do not carry out any operations not described in this manual, or the product may break or cause injury.

If any of the following abnormalities is observed, turn off the power immediately, unplug the AC adapter and remove the batteries, and then contact the Epson customer support center.

- If smoke, strange odors or unexpected noises come from the product
- If liquid or foreign objects get inside the product
- If the product has been dropped or damaged

Do not touch the tape eject slot, during printing or when the auto cutter is in operation. Otherwise there is a risk of injury.

### Others

Do not use or store the product, batteries, AC adapter, power cable, or tape cartridges in the following places.

- In direct sunlight.
- Where it may become extremely hot such as in a vehicle with the windows closed.
- Where it may become extremely hot such as near a heater or the temperature becomes very unstable such as near the exhaust duct of an air conditioner.
- Where the product may get wet due to a shower or rain such as in a bathroom or outdoors.
- In a dusty place or where the product may be exposed to smoke or steam such as near the kitchen or a humidifier.
- On an unstable place such as on a shaky table or on an inclined place.
- Where it might be subjected to vibration or shock.
- Near high-voltage power lines or something that generates a magnetic field.

Keep the plastic bags used to contain the product or this manual out of reach of children. Children may suffocate if they swallow them or put their heads into the bags.

### ⚠ CAUTION

#### When handling batteries

If liquid leaks from a battery, wipe it off with a cloth and replace it with a new one. If the liquid comes in contact with your skin, wash it away with water immediately.

If the batteries are used incorrectly, they may cause leakage, overheating, explosion, erosion, or damage to the product, which may result in fire or injury.

- Do not use new ones and old batteries together, or mix different types of batteries.
- Use AA alkaline batteries.
- Use batteries in the correct directions.
- Take the batteries out immediately when they have no power remaining.
- Take the batteries out if you do not use the product for a long time.
- Do not heat batteries or throw them in fire or water.
- Do not pinch the batteries with metal tweezers or use any pointed sharp metal object such as the tip of a mechanical pen or ball-point pen when taking the batteries out.

When disposing of used batteries, make sure to follow the regulations.

#### When using the AC adapter

- Do not unplug the AC adapter while the product is in operation, otherwise printing may not be successful.
- Do not use the AC adapter in a small, confined space, or cover it with a cloth. Otherwise, the AC adapter may overheat and deteriorate.

#### When using this product

Do not stand or put anything heavy on the product or place it on an unstable place such as on a shaky table or on an incline. Otherwise, the product may fall and cause injury.

To ensure safety, unplug this product before leaving it unused.

Before cleaning, make sure to unplug the AC adapter from the outlet, and remove the batteries.

Do not use a moistened cloth or solvents such as alcohol, thinner or benzene.

Do not block or insert objects into the supplied AC adapter socket or the tape eject slot.

### ■ When handling tape cartridges

- Make sure to use a dedicated LK Tape.
- Some types of tape cannot be cut by the cutter. For the latest information on the Auto cut and/ or Half cut disabled tape types, see the box of tapes or visit your local Epson website.
- Do not drop it or disassemble it. Doing so may cause damage.
- Do not pull out the tape forcibly by hand. But make sure to feed the tape with . Otherwise, the tape cartridge may be broken and unusable.
- Avoid using a tape cartridge without remaining tape. Doing so may cause overheating of the printhead, which may result in damage or malfunction.

### MEMO

Tape cartridges contain ink ribbons in them. When disposing of tape cartridges, make sure to follow the local regulations for disposal.

### ■ Other cautions

#### Notes on usage

- Do not touch the thermal head. Static electricity may damage the thermal head.
- Do not plug in and unplug the AC adapter while printing. Power may be cut off.
- The Li-ion battery cannot be charged while printing.
- Operate the keyboard gently.
- Take care not to cut your fingers when cutting the label with scissors.
- Do not attach a label on human bodies, living things, public facilities or other people's belongings.
- Be sure to turn the power off after use.
- Powering off message is displayed while turning off the product. Do not remove the AC adapter until the message disappears.
- Be sure to replace batteries with the power turned off. If you replace the batteries while the product is powered, files or data stored on it may be deleted.

### ■ Recycling the Battery

Contains a lithium-ion battery. Must be recycled or disposed of properly.

### MEMO

Do not disassemble the battery pack.

## Troubleshooting

### ■ Messages

This section explains the remedies when the following messages appear on the display.

Check battery Charge Li-ion!	The battery runs out of power. Connect the AC adapter to the printer and charge the battery. For details, see "Charging the Li-ion battery".
Check battery Change alkaline	The batteries run out. Turn off the power and replace all batteries with new ones.
Cover open!	Top cover is open. Close the top cover.
Insert tape	Check if the tape cartridge is loaded or correctly set. For details, see "Installing a tape cartridge".
Check tape cartridge	The loaded tape is not supported. Insert a correct cartridge.
No more sequence No.!	Only up to 2 sequence numbers can be inserted.
No more barcode!	Only up to 2 barcodes can be inserted.
QR CODE too big!	Perform either of the following: Use a wider tape. Reduce the text or cell size. Lower "ECC Level".
Overheated!	The printhead is overheated. Turn off the power and remove the tape cartridge, then leave the printer until it cools down.
Trash at slot Remove trash	Tape remains in the tape eject slot. Remove the tape.
Remove cut tape	Unable to start printing because cut tape remains in the tape eject slot. Remove the tape from the tape eject slot.

### ■ Problem

#### Unable to charge Li-ion battery

Is the Li-ion battery correctly installed? Check that the Li-ion battery is correctly installed.

Is the AC adapter securely connected? Connect the AC adapter and the power cable firmly to the power socket of the printer, the AC adapter connector and the outlet.

#### Unable to detect the tape correctly

Is the tape cartridge correctly installed? Check that the tape cartridge is correctly installed.

Is the label for detecting the tape cartridge clean? If not, wipe the dirt off with a soft cloth.

Is the detection sensor of the printer clean? If not, wipe the dirt off with a soft cloth.

### MEMO

If none of the above has solved the problem or the symptom is other than the above, contact the Epson customer support center.

### Tape colors and ribbon colors shown on the display

Display	Color	Display	Color
WHT	White	GRY	Gray
YEL	Yellow	BLK	Black
RED	Red	PNK	Pink
BLE	Blue	SLV	Silver
CLR	Clear/Transparent	GLD	Gold
GRN	Green	BRW	Brown
ORN	Orange	OTH	Colors other than mentioned here.
VIO	Violet/Purple		

### MEMO

Depending on tape type used, the tape color or ribbon color is not displayed.

# Part Names and Functions

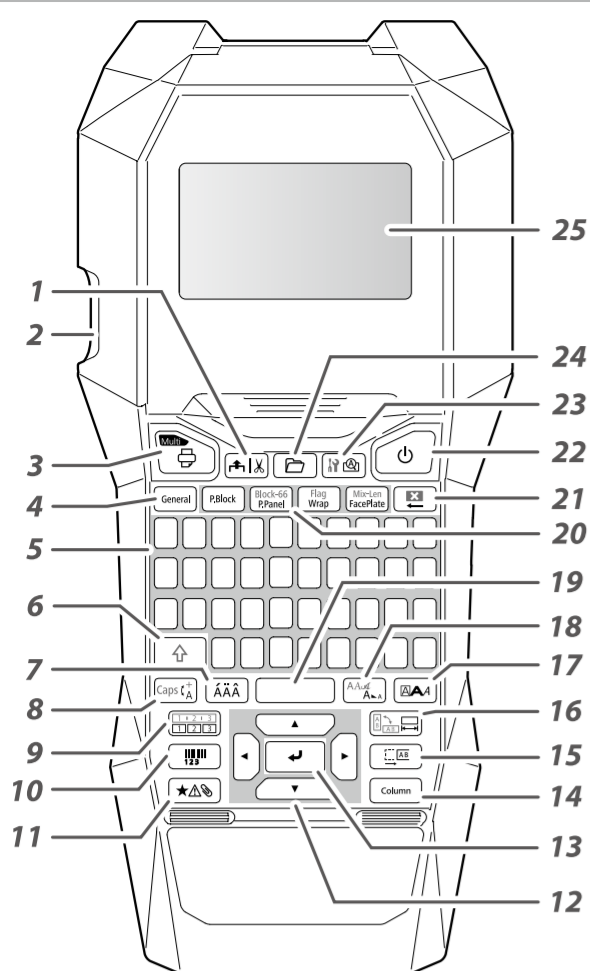

1. Feeds and then cuts the tape.
2. Tape eject slot
3. Prints a label. Hold down [F] and press this to print with a special print function.
4. Creates a general label, or escapes from special label mode.
5. Character keys
6. Shift
7. Enters a character with an accent.
8. Changes the input method of the character keys. Hold down [C] and press this for caps lock.
9. Creates a label with a sequence number. Hold down [S] and press this to create with block sequence numbers.
10. Creates a barcode label.
11. Enters a symbol.
12. Cursor keys
13. Confirms the settings.
14. Adds a block.
15. Sets the margins.
16. Sets the tape length. Hold down [L] and press this to change the text orientation.
17. Sets the format and style.
18. Changes the font size. Hold down [M] and press this to change the font type.
19. Space
20. Creates a special label.
21. Delete. Hold down [X] and press this to clear all text and/or setting.
22. Turns the printer on and off.
23. Previews the created label. Hold down [P] and press this to display preference.
24. Saves and recalls the label.
25. Display

## Symbol Description

	On/Stand-by		Hot surface
	Direct current		Polarity of D.C. power connector

## Display

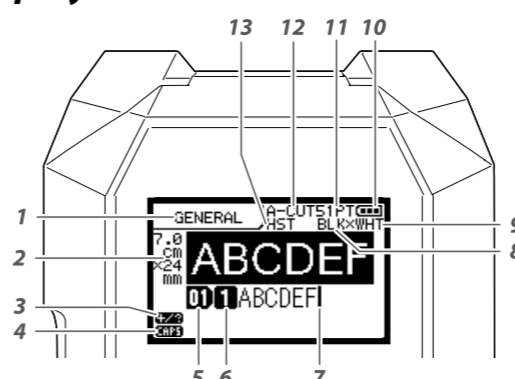

The display shows the current settings and characters you have entered. You can change the language shown on the setting screen and menu.

☞ 4 "Language" of "Changing the Printer Settings"

1. Form name
2. Set tape width and length. The unit can be switched between inch and cm. ☞ 4 "inch:cm" of "Changing the Printer Settings"
3. Symbol input mode
4. Caps Lock ON
5. Block number
6. Row number
7. Cursor
8. Color of text to be printed
9. Set tape color
10. Remaining battery level
11. Font size
12. Label cut method
13. Set tape type

# Cleaning

## CAUTION

Turn off the printer and remove the batteries before cleaning. If the AC adapter is connected, disconnect the AC adapter cable from the printer.

## Exterior

Wipe the dirt off with a soft cloth. If it is very dirty, use a cloth damp.

## CAUTION

Never use chemicals or solvents such as benzine, thinner, or alcohol, or use a chemical duster.

## Printhead

Clean the printhead with a cotton swab.

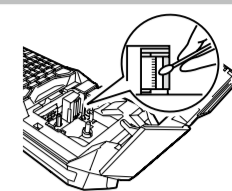

# Initializing the Settings

Initialize the settings if the printer does not operate normally such as the display is interrupted.

## Attention

This function initializes the settings. Take extreme care before initializing it. All the created text will be lost and the settings you made will be reset.

1. If the power is on, press [P] to turn it off.
2. Press and hold [X] + [C], and press [P].
3. When a message appears, press [C]. The settings will be initialized.

## MEMO

To cancel initialization, press a key other than [C].

# Start Here

## 1. Installing the Li-ion battery

Before using the printer for the first time, charge the Li-ion battery (C52CE97010). Read also the safety precautions for the rechargeable battery described previously in this manual. For details on the handling of Li-ion battery, see "C52CE97010 Lithium-ion Battery Pack User's Manual".

## WARNING

Be sure to use the dedicated Li-ion battery (C52CE97010). Using a battery other than the one specified may cause fire, explosion, leakage, overheating or other damage.

## CAUTION

When disposing of used batteries, make sure to follow the regulations.

### 1. Open the battery cover.

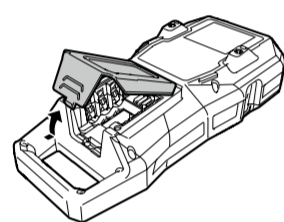

### 2. Install the Li-ion battery in the correct orientation.

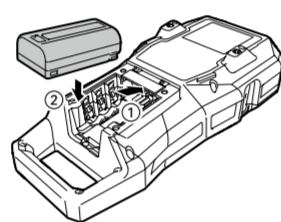

### 3. Close the battery cover.

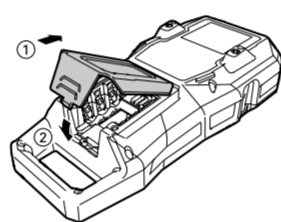

## Charging the Li-ion battery

You can charge the dedicated Li-ion battery (C52CE97010) with the printer. To charge the battery, connect the AC adapter to the printer with the Li-ion battery installed.

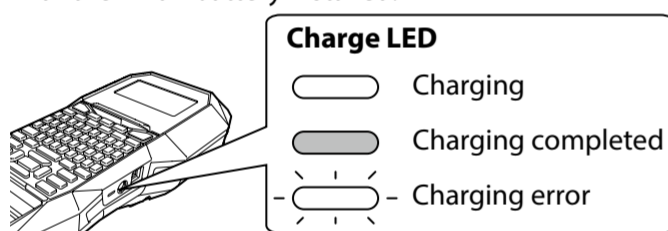

### Charge LED

- Charging
- Charging completed
- Charging error

## MEMO

- The Li-ion battery cannot be charged while printing.
- When the power of the charged Li-ion battery seems to run out quickly, replace it with new ones.
- There is likely to be a charging error or battery error in the following cases. Contact Epson customer support center.
  - The charge LED flashes during charging.
  - New Li-ion battery takes significantly longer to charge than the estimated charging time (less than 3 hours).

## Using alkaline batteries

You can use alkaline batteries instead of Li-ion battery. When using alkaline batteries, install them in the correct orientation.

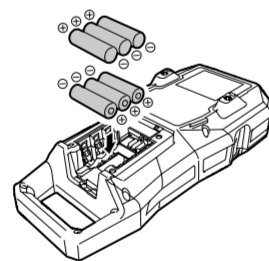

## CAUTION

When you have printed continuously for 30 minutes using alkaline batteries, leave the printer for at least one hour to allow the batteries to cool down.

## Connecting the AC adapter

Connect the AC adapter as shown below.

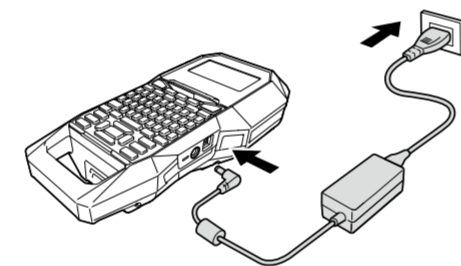

## Using Label Editor

Label Editor is an application software for editing label. When this software is installed on your computer, you can transfer the created cable label data to the printer. For how to install and operate the software, see "Label Editor User's Guide".

1. Connect the USB cable to the printer.
2. Connect the other connector of the USB cable to the computer.

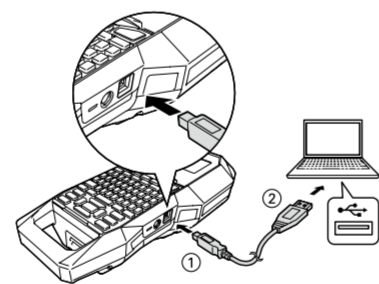

## MEMO

For how to transfer cable label data, see LW-Z700 User's Guide (PDF version) which can be downloaded from your local Epson website.

## 3. Turning the power on

1. Press [P].

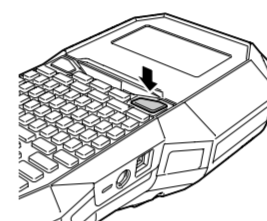

### Auto power-off

If there is no key operation within five minutes, the printer automatically turns off. (The characters you have entered in the current session are stored.) Furthermore, if there is no key operation within an hour while connected to a computer, the printer automatically turns off.

## Feeding the tape

### CAUTION

Be sure to feed the tape every time after you install a tape cartridge.

1. Press [C].
2. Select a function with [L]/[R] and then press [C].
  - Tape feed: Feeds the tape.
  - Feed and cut: Feeds the tape and then cuts the tape.

## 4. Entering text

1. Press [F] + [C].
2. Press [A].
3. Press [AAA].
4. Select a character with [D]/[E] and press [C]. "a" is entered.
5. Press keys: [D], [E], [F]. "Câble" appears on the screen.
6. Press [F] + [C].
7. Press keys: [D], [E], [F].

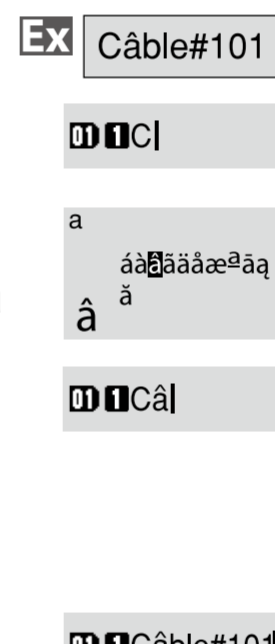

Save the created label: ☞ 4 "Saving Frequently Used Labels"  
 Change the font: ☞ 4 "Changing the Font"  
 Change the font size: ☞ 4 "Changing the Font Size"

## Deleting text

1. Press [X]. A character is deleted backward.

## Deleting all text

1. Press [F] + [X].
2. Select a function with [L]/[R] and then press [C].
  - Text Only: Deletes all text.
  - Text & Setting: Deletes all text and restores the font size and other settings to the initial settings.
  - All Format: Deletes all text and displays the General editing screen. Depending on the label type you create, "All Format" may not be displayed.

## 5. Printing label

1. Press [P].

### Setting the label auto cut to Off

☞ 4 "Auto cut" of "Changing the Printer Settings"

### Printing with special print functions

☞ 4 "Utilizing Print Functions"

## Checking the print image

1. Press [P]. The print image scrolls on the entire screen. When the preview ends, the editing screen reappears.

## CAUTION

- Do not insert your fingers into the tape eject slot.
- Do not pull the tape until the printing is completed.

## Attention

- "Insert tape" will appear on the display if the tape cartridge is not loaded or not correctly set.
- Length of the label shown on the display is a guide and may not match the length of the printed label exactly.
- Label over 16m in length cannot be printed.

## MEMO

- To cancel the printing, press [P].
- Depending on your margin setting or the label type, tape may be fed and cut before printing.

## 2. Installing a tape cartridge

### CAUTION

- Make sure that the power is turned off.
- You cannot use tape other than LK-tape.
- Make sure the top cover is closed firmly.
- If you opened the top cover while a tape cartridge is installed, check that the tape end is put into the tape eject slot before beginning operation.
- Take care to keep the label for detecting the tape cartridge and the sensor of the printer clean. Otherwise, tape may no longer be detected correctly.
- Do not touch the sensor directly with your fingers.

### 1. Rewind the ink ribbon.

Use a pen or a pencil.

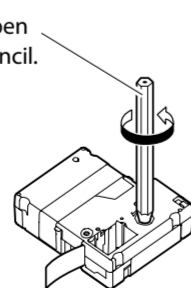

### 3. Install a tape cartridge.

Put the tape end into the tape eject slot.

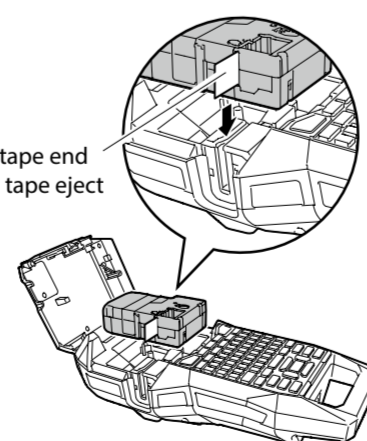

### 2. Open the top cover.

Top cover

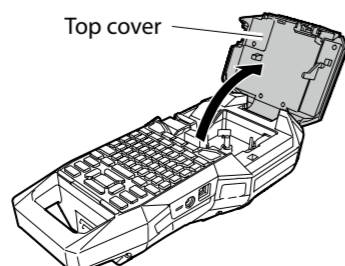

### 4. Close the top cover.

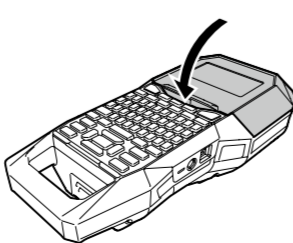

## 6. Attaching label

1. Peel off the backing paper.
2. Attach the label and rub it firmly.



## CAUTION

Depending on the environment where you use labels and the nature of the adhered surface, the labels may be peeled or discoloured, and the adhesive may remain on or damage the adhered surface. Be sure to check the environment and the nature of the adhered surface before use. Epson takes no responsibility for any damage or loss due to the above mentioned causes.

## 7. Turning the Power Off

1. Press [P].

The characters you have entered in the current session are stored even after the printer is turned off. They are displayed when it is turned on again.

2. Open the battery cover and then remove the Li-ion battery.

If the AC adapter is connected, disconnect the AC adapter from the printer.

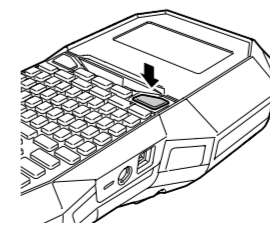

## CAUTION

- "Powering off" is displayed while turning off this printer. Do not remove the Li-ion battery or disconnect the AC adapter until this message disappears.
- When you don't use the printer for a long period of time, remove the batteries (Li-ion battery or alkaline batteries), disconnect the AC adapter, and remove the tape cartridge from the printer.

# Creating Special Labels

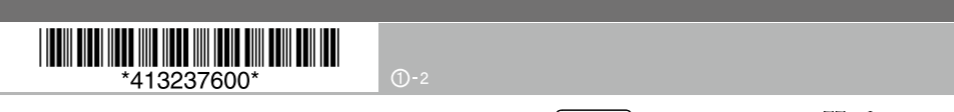

## Creating Labels for Patch Panel



You can create the optimal labels for your patch panel by setting the label length and number of blocks.

**Ex**

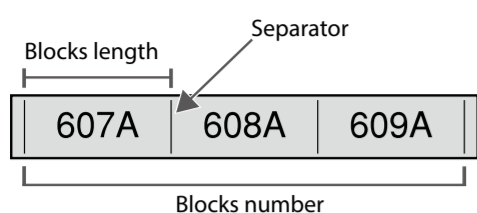

1. Press **[Block]**.
2. Select the length type with **[<] / [>]** and then press **[OK]**.  
In this example, we will select "Blocks".  
**Blocks:** Sets the length by block length.  
**Label:** Sets the length by label length.
3. Enter the blocks length and then press **[OK]**.  
Setting range: 0.25 to 30 cm
4. Enter the blocks number and then press **[OK]**.  
In this example, we will enter "3".  
Setting range: 1 to 50
5. Select the type of separator with **[<] / [>]** and then press **[OK]**.  
In this example, we will select "Line".
6. Select the orientation with **[<] / [>]** and then press **[OK]**.  
In this example, we will select "Hori."

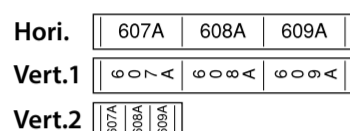

7. Enter the text.  
You can create labels with sequence numbers.  
For details, see "Creating Labels with Block Sequence Numbers Assigned"
8. Press **[Print]**.

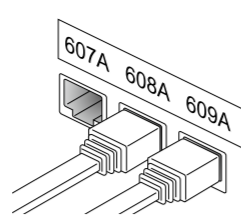

## Creating Labels for Punch Block



You can create labels to identify at a glance the numbers for the wires or pins connected to a punch block.

**Ex**

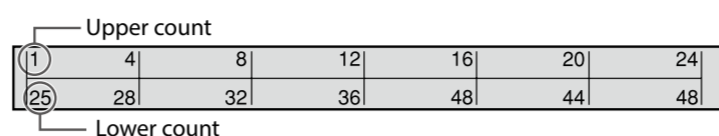

1. Press **[Block]**.
2. Select the blocks type with **[<] / [>]** and then press **[OK]**.  
In this example, we will select "4pairs".  
**Blank:** Creates a table of two rows and one column.
3. Select the text type with **[<] / [>]** and then press **[OK]**.  
In this example, we will select "Pins".
4. Enter the upper count and then press **[OK]**.  
In this example, we will enter "1".
5. Enter the lower count and then press **[OK]**.  
In this example, "25" is entered automatically.
6. Enter the label length and then press **[OK]**.  
Setting range: 1 to 99.9 cm
7. Press **[Print]**.

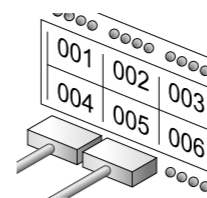
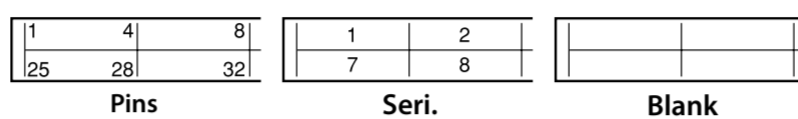

## Creating Multiple Labels at Once

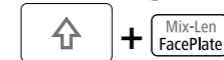

You can create many labels at once.

**Ex**

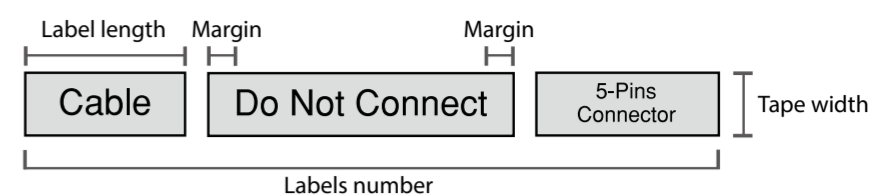

1. Press **[Up] + [Block]**.
2. Select the label length with **[<] / [>]** and then press **[OK]**.  
**Auto:** Automatically adjusts the label length depending on the length of text.  
**Set:** Sets the label length.  
Setting range: 1 to 99.9 cm
3. Enter the labels number and then press **[OK]**.  
In this example, we will enter "3".
4. Select the type of margins with **[<] / [>]** and then press **[OK]**.
5. Select the orientation with **[<] / [>]** and then press **[OK]**.  
In this example, we will select "Hori."
6. Enter "Cable" and then press **[Enter]**.  
Similarly for other labels, enter text and press **[Enter]**.
7. Press **[Print]**.

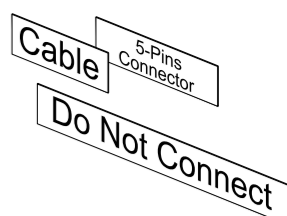

## Creating Labels for Block-66



You can create labels for Block-66 so that large numbers of connectors can easily be identified.

**Ex**

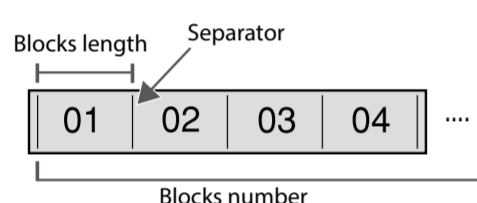

1. Press **[Up] + [Block]**.
2. Select the length type with **[<] / [>]** and then press **[OK]**.  
In this example, we will select "Blocks".  
**Blocks:** Sets the length by block length.  
**Label:** Sets the length by label length.
3. Enter the blocks length and then press **[OK]**.  
Setting range: 0.25 to 30 cm
4. Enter the blocks number and then press **[OK]**.  
In this example, we will enter "4".  
Setting range: 1 to 50
5. Select the type of separator with **[<] / [>]** and then press **[OK]**.  
In this example, we will select "Line".
6. Select the orientation with **[<] / [>]** and then press **[OK]**.  
In this example, we will select "Hori."
7. Enter the text.  
You can create labels with sequence numbers.  
For details, see "Creating Labels with Block Sequence Numbers Assigned"
8. Press **[Print]**.

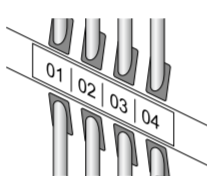

## Creating Labels to Wrap Around Cable



You can repeatedly print text so that it can be seen regardless of the angle from which the cable is viewed.

**Ex**

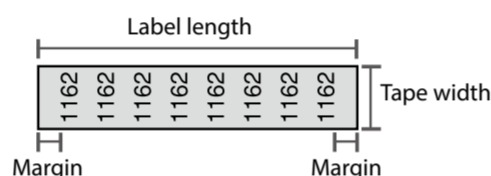

1. Press **[Block]**.
2. Select the length type with **[<] / [>]** and then press **[OK]**.  
In this example, we will select "Length".  
**Dia:** Sets the length by cable diameter.  
**Length:** Sets the length by label length.
3. Enter the label length and then press **[OK]**.  
Setting range: 1 to 99.9cm
4. Select On or Off of repeat text with **[<] / [>]** and then press **[OK]**.  
In this example, we will select "On".
5. Select the type of margins with **[<] / [>]** and then press **[OK]**.  
In this example, we will select "Long".
6. Enter the text.
7. Press **[Print]**.

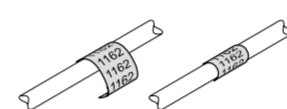
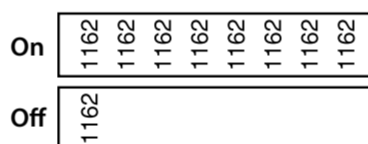

## Creating Labels for Faceplate



Text can be automatically placed at the center of a block. This enables you to easily create a label suitable for the size of the area where it will be affixed.

**Ex**

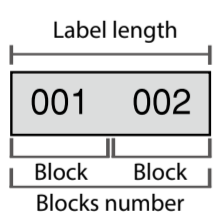

1. Press **[Block]**.
2. Enter the label length and then press **[OK]**.  
Setting range: 1 to 99.9 cm
3. Enter the blocks number and then press **[OK]**.  
In this example, we will enter "2".  
Setting range: 1 to 50
4. Select the orientation with **[<] / [>]** and then press **[OK]**.  
In this example, we will select "Hori."
5. Enter the text.
6. Press **[Print]**.

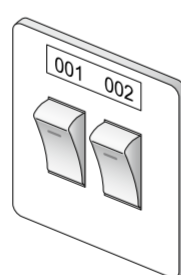

## Creating Labels to Wrap around Cable like a Flag



This label is useful for differentiating cables because the flag portion of the label wrapped around the cable is easy to see.

**Ex**

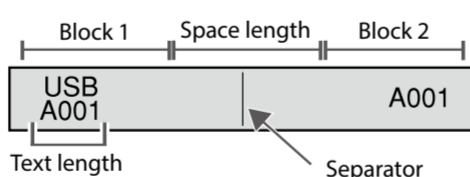

1. Press **[Up] + [Block]**.
2. Select the setting method of space length with **[<] / [>]** and then press **[OK]**.  
In this example, we will select "Length".  
**Dia:** Sets the length by cable diameter.  
**Length:** Sets the length by space length.
3. Enter the space length and then press **[OK]**.  
Setting range: 0.25 to 30 cm
4. Enter the text length and then press **[OK]**.  
Setting range: 0.25 to 30cm
5. Select the type of separator with **[<] / [>]** and then press **[OK]**.  
In this example, we will select "Line".
6. Select the orientation with **[<] / [>]** and then press **[OK]**.  
In this example, we will select "Hori.2".
7. Enter the text of block 1.
8. Enter the text of block 2.
9. Press **[Print]**.

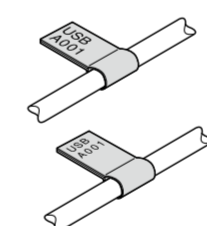
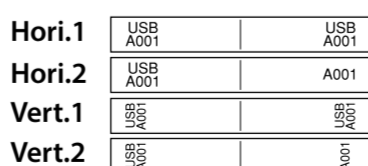

## Creating Labels with Block Sequence Numbers Assigned

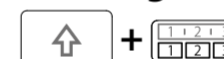

You can assign sequential numbers to blocks. Up to four digits including numbers (0 to 9) and alphabet letters (a to z and A to Z) can be entered.

**Ex**

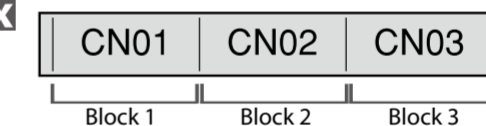

1. Create the blocks in advance.  
In this example, we have created three blocks.
1. Press **[Up] + [Block]**.
2. Enter the start value of the sequential numbers and then press **[OK]**.  
In this example, we will enter "CN01".  
Sequential numbers are automatically assigned to block 2 and block 3.
3. Select the number of repetition with **[<] / [>]** and then press **[OK]**.  
In this example, we will select "1 time".
4. Press **[Print]**.

## Creating Labels with Symbol



1. Press **[Symbol]**.
2. Select a category with **[<] / [>]** and press **[OK]**.
3. Select a symbol with **[<] / [>]** and press **[OK]**.
4. Press **[Print]**.

**MEMO**

- For available symbols, see "Symbol List" on the separate sheet.
- If you transfer your original symbols from your computer, the symbols are saved in the "Downloaded" category. For more details, see LW-Z700 User's Guide (PDF version), which is available from your local Epson website.

## Creating Barcode Labels



**MEMO**

- You may not be able to add a barcode depending on the label type you create.
- Only up to two barcodes can be inserted in one label.

Supported barcode types:

EAN-8, EAN-13, CODE128, CODE39, QR CODE, ITF, CODABAR, UPC-A, UPC-E

1. Press **[Barcode]**.
2. Select an item with **[<] / [>]** and press **[OK]**.  
Move on to the next options until the setting is complete.
3. Enter the alphanumeric characters for the barcode and then press **[OK]**.
4. Press **[Print]**.



# Customizing Labels

## Setting the Format and Style (Edit menu)

You can decorate your label by setting the following.

**MEMO**  
The setting items displayed when you press differ depending on the label type you create.

**Layout**  
Left, Center, Justify, Right  
Adjusts the layout when multiple lines are used.

**Frame & Table**  
Decorates the text with a frame or inserts a table.

**Style**  
Outline, Normal, Shadow, S+O  
Applies a character style to text.

**Char. spacing**  
None, Narrow, Normal, Wide  
Sets the inter-character spacing.

**Border & Line**  
Strikeout, Underline, None, Border, Round brdr, Shading, Brdr mesh, Round mesh  
Applies border, underline, shade etc. to text.

**Char. Width**  
Smaller, Small, Narrow, Normal, Wide  
This allows you to change the width or height of characters.

**Bold & Italic**  
Italic, Normal, Bold, B+I  
Changes the text in bold or italics.

**Length**  
This setting is the same as when is pressed.  
4 "Setting the Label Length"

**Margins**  
This setting is the same as when is pressed.  
4 "Setting the Margins"



**Orientation**  
|AB|A , |< >|  
Sets the orientation of the text.

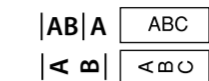

**Font size**  
This setting is the same as when is pressed.  
4 "Changing the Font Size"

**Font**  
This setting is the same as when + is pressed.  
4 "Changing the Font"

### Procedure for setting

- Place the cursor.**  
Place the cursor on the left of the characters to which you want to apply a function. If you apply the function to a specific line or block, confirm that the cursor is in the line or block.
- Press .**  
Example: to apply "Bold & Italic"
- Select "Bold & Italic" with and press .**
- Select "B + I" with and press .**
- Select an area to which you want to apply the function with and press .**  
When "Character" is selected, the function is applied to all characters on the right of the cursor.

## Changing the Font Size

You can change the font size of text or a block line by line. Among the preset setting items, select one with the same number of lines as that of the text or block you want to change.

**MEMO**  
You may not be able to change the font size depending on the label type you create.

- Press .
- Each time you press , the font size changes.

## Changing the Font

Changes the font type of text.

- Press + .
- Each time you press + , the font changes.



## Changing the Text Orientation

Changes the text orientation to vertical or horizontal.

**MEMO**  
You may not be able to change the text orientation depending on the label type you create.

- Press + .  
Each time you press + , the setting switches between "Horizontal" and "Vertical".

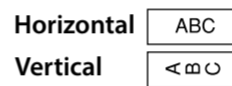

### When creating "Patch Panel", "Block-66", "Faceplate", or "Mix-Len"

- Press + .
- Select the orientation with and press .

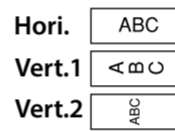

## Setting the Label Length

You can set the length of label or block.

**MEMO**  
When creating a special label, you can set the length again. Setting items for special label is displayed after pressing .

- Press .
- Select the setting method of the length with and press .  
Auto: Automatically adjusts the label length depending on the length of text.  
Set: Sets the label length. Setting range: 1 to 99.9 cm
- Select the alignment for the text with and press .  
Left, Center, Justify, Right

## Setting the Margins

Sets the left and right margins.

**MEMO**  
You may not be able to set the margins depending on the label type you create.

- Press .
- Select the type of margins with and press .

## Adding Block

By dividing text into blocks, you can change the style and the number of lines block-by-block.

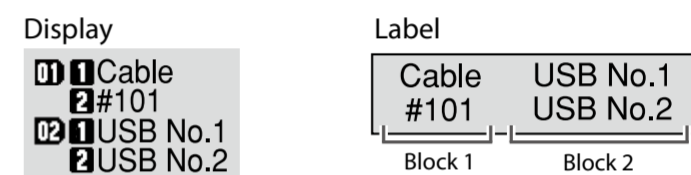

- Press .  
A new block is started from the character next to the cursor.

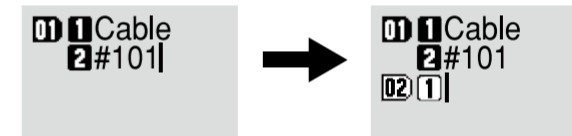

## Saving Frequently Used Labels

By saving frequently used labels, you will be able to easily recall and print from them next time. Up to 100 labels can be saved.

### Saving a label

- Press .
- Select "Save" with and press .
- Select a registration number with or the number keys and then press .  
The registration confirmation screen appears.
- Confirm the registration number and then press .

### Recall the saved label

- Press .
- Select "Recall" with and press .
- Select a registration number with or the number keys and then press .  
The recall confirmation screen appears.
- Confirm the registration number and then press .

### Deleting the saved label

- Press .
- Select "Delete" with and press .
- Select a registration number with or the number keys and then press .  
The deletion confirmation screen appears.
- Confirm the registration number and then press .

## Utilizing Print Functions

### Enlarge print

You can create a label that is larger than the width of a single label. Print the created content separately on multiple labels and then put them together to use as a single label.



- Press + .
- Select "Enlarge print" with and press .
- Select "\*2size" with and press .
- Select "2/2" with and press .
- Select "Start print?" with and press .  
Printing starts.

**MEMO**  
The function remains enabled even after printing. To disable the function, select "Off".

### Mirror print



- Press + .
- Select "Mirror print" with and press .
- Select "On" with and press .
- Select "Start print?" with and press .  
Printing starts.

**MEMO**  
The function remains enabled even after printing. To disable the function, select "Off".

### Print copies



- Press + .
- Select "Print copies" with and press .
- Enter the number of print copies and then press .
- Select "Start print?" with and press .  
Printing starts.

**MEMO**  
The function remains enabled even after printing. To disable the function, set the number of print copies to "1".

## Changing the Printer Settings

### Auto cut

Auto cut:  
Sets whether or not to cut automatically.

Half cut:  
When "Auto cut" is set to "On", the function "Half cut" for precutting just the label part to make the backing paper easy to peel off can be set.

### Print density

Sets the print density.

### Drop stop

This function is useful for affixing consecutively printed labels one at a time. Select "On" to avoid a printed label from dropping. A printed label stays at the tape eject slot. When printing multiple copies, printing of the second or later labels starts each time you remove a printed label. This function is only available when the label length is 28 mm or more, "Auto cut" is set to "On", and "Half cut" is set to "Off".

### Backlight

Sets the display backlight to On or Off.

### Language

You can select the language shown on the display from the following:  
Dansk, Deutsch, English, Español, Français, Italiano, Nederlands, Norsk, Português-Br, Português-EU, Suomi, Svenska, Türkçe

### inch:cm

The unit of length used to indicate the label size can be switched between inch and cm.

**MEMO**  
Version: To make sure the version number that has been installed in the printer.

### Procedure for setting

- Press + .
- Select the desired function with and press .
- Select the desired item with and press .